

Geological Report on  
"CHALCO" (92J/10E)  
mineral claims - Piebiter Cr.,  
Bridge River, Lillooet Mining Div.,  
B.C.

owner: - 50° 122° NE by: -  
D.C. Noel. July 1954 - Dec. D.K.W.H. Patmore, P.Eng.

1236 Bidwell St.,  
Vancouver 5, B.C.

January 3, 1955.

Mining Recorder,  
Lillooet,  
B.C.

Dear Sir:

I herewith submit for your approval two reports (copies) of a set of four maps showing in detail the geology of the "CHALCO GROUP" of Mineral Claims owned by Mrs. D. C. Noel of the above address. Each of the two bound reports also contains a copy of this covering letter.

The reports include maps only, because the geology is all shown on these maps which are self-explanatory, and the cash value of the work done to date on the Chalco Group by the writer (a registered P.Eng.) for Mrs. Noel amounts to far more than the FOUR HUNDRED DOLLARS worth of assessment work herewith recorded. In detail, forty days of close geological survey was completed during the Summer, aside from time spent in actual labour on trail and open cuts. Another week was spent in making the maps. This gives a total of forty-seven days at \$25.00 per day (\$1,175.00), plus \$650.00 on sampling and assaying, or \$1,825.00. This is almost five times the value needed, as Mrs. Noel is only recording geological work on the "Chalco D Fr." at the West, and on the Chalco #36, #37 and #38 at the East end of the group (\$400.00). Thus, it is respectfully suggested that no written report other than this letter and the maps is

*H.P.*

necessary. Mrs. Noel and the writer, with the maps, made a personal visit to Dr. H. Sargent, Dr. Wm. Bacon and Dr. J. F. Walker at Victoria, and they are in full agreement with the writer's suggestion.

It may be seen that the "Chalco D Fr." mineral claim is mostly covered by heavy valley-bottom overburden, there being only one natural outcrop of Peridotite as shown on the separate Chalco D Fr. map. There are, however, several large rock outcrops closely adjoining, as shown, and these can be mentally projected across the claim in question. Apparently there are two separate bands of intrusive peridotite cutting north westerly across and near this fractional claim and conforming fairly well with the strike of the older rocks (very red-stained highly quartzose cherty sediments of the Fergusson series showing knife-blade thickness of diotite banding.) The new tunnel site portal lies on the extreme north-west corner of the Chalco D Fr. This, too, exposes peridotite highly-sheared and cut by two narrow crushed red lamprophyre dikes.

On the whole, the geology shown is "outcrop" mapping and only the main granodiorite batholith contact has been projected across the valley bottom (deep gravel and lower talus slopes). All outcrops are shown either as areas enclosed by dotted lines or by bluff outlines. This is especially true for the map marked as Chalco Group - East End. This map covers the Chalco #36, #37 and #38 claims, and shows one of the new discoveries, a fairly large (1,000' x 10') low grade tungsten-bearing skarn band, mainly garnetite and diopside with epidote and bull quartz. Although the assays from this zone are mostly in the "trace category", a surprising amount of scheelite may be seen at any point along the entire length with the aid

*M. H. P.*

of a fluorescent lamp.

The main claims, previously crown-granted are shown on the large map, and the major new discovery on Lime Creek is shown IN DETAIL on the sampling map.

At least \$300.00 worth of this geological work was done directly on the Chalco #36, #37 and #38, and at least \$100.00 worth was completed on the Chalco D Fr.

Respectfully submitted

*W. H. Patmore*

(Dr. W. H. Patmore, P.Eng.)

Maps

- #1 Sketch of showings on Chalco  
No. 5 of Chalco Group.  
1" = 20'
- #2 Geological map of Chalco  
mineral claims  
1" = 100'
- #3 Geological map of Chalco  
"D" Fr.  
1" = 400'
- #4 Geological map of Chalco Group  
East End.  
1" = 400'

SAMPLING DETAIL

NUMBER	WIDTH FEET	GOLD OZ./TON	NICKEL %
1	25		TR
2	23		0.13
3	2.0		TR
4	6.0	7%	TR
5	3.0	7%	TR
12	6.0	0.11	TR

NUMBER	WIDTH FEET	TUNGSTEN % WO <sub>3</sub>	COPPER %
6	4.0	0.13	TR
7	6.0	0.14	0.3
8	3.0	TR	1.5
9	5.0	TR	
10	8.0	TR	
11	25	TR	
13	6.0	TR	
14	9.0	TR	
15	8.0	3.01	0.6
16	2.2	1.16	
17	6.5	TR	
18	1.0	1.24	
19	8.0	0.11	
20	11.0	0.35	
21	6.0	TR	0.4
22	9.0	0.24	1.8
23	7.5	0.39	
24	9.0	TR	
25	16.0	0.18	
26	2.5	1.72	
27	5.5	TR	
28	8.5	0.11	
33	5.0	0.21	

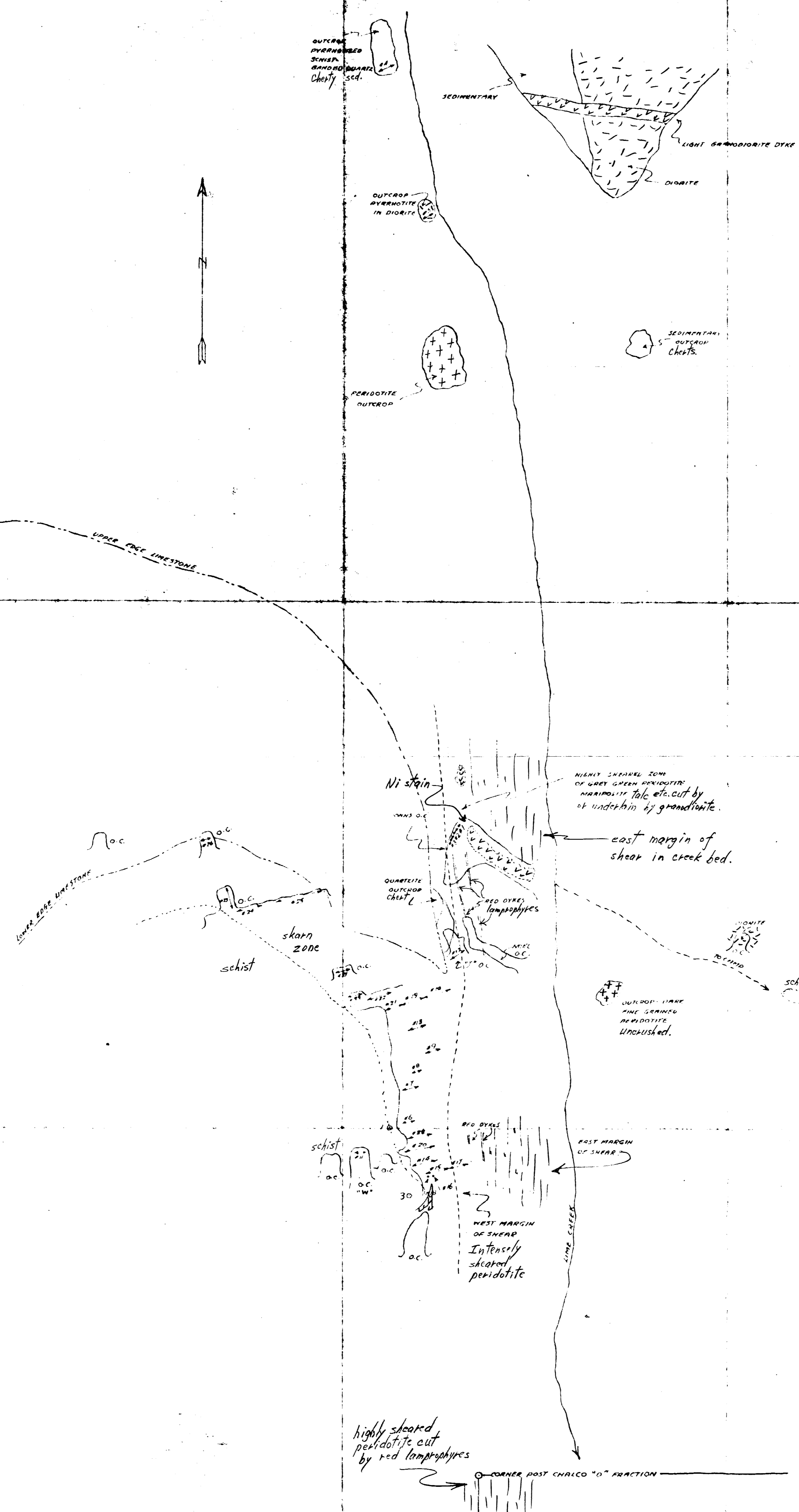

SKETCH OF SHOWINGS ON  
 CHALCO NO 5 OF CHALCO GROUP  
 BRIDGE RIVER AREA  
 GEOLOGY BY W.H. HARRIS  
 SCALE 1" = 20'

R.S. Mason

Department of  
 Mines and Petroleum Resources  
 ASSESSMENT REPORT  
 NO. 105 MAP #1

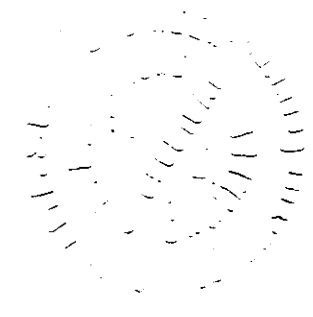

**CHALCO MINERAL CLAIMS.  
BRIDGE RIVER DISTRICT.**

GEOLOGY BY W. H. PATMORE.

Department of  
Mines and Petroleum Resources  
ASSESSMENT REPORT  
NO. 105 MAP #2

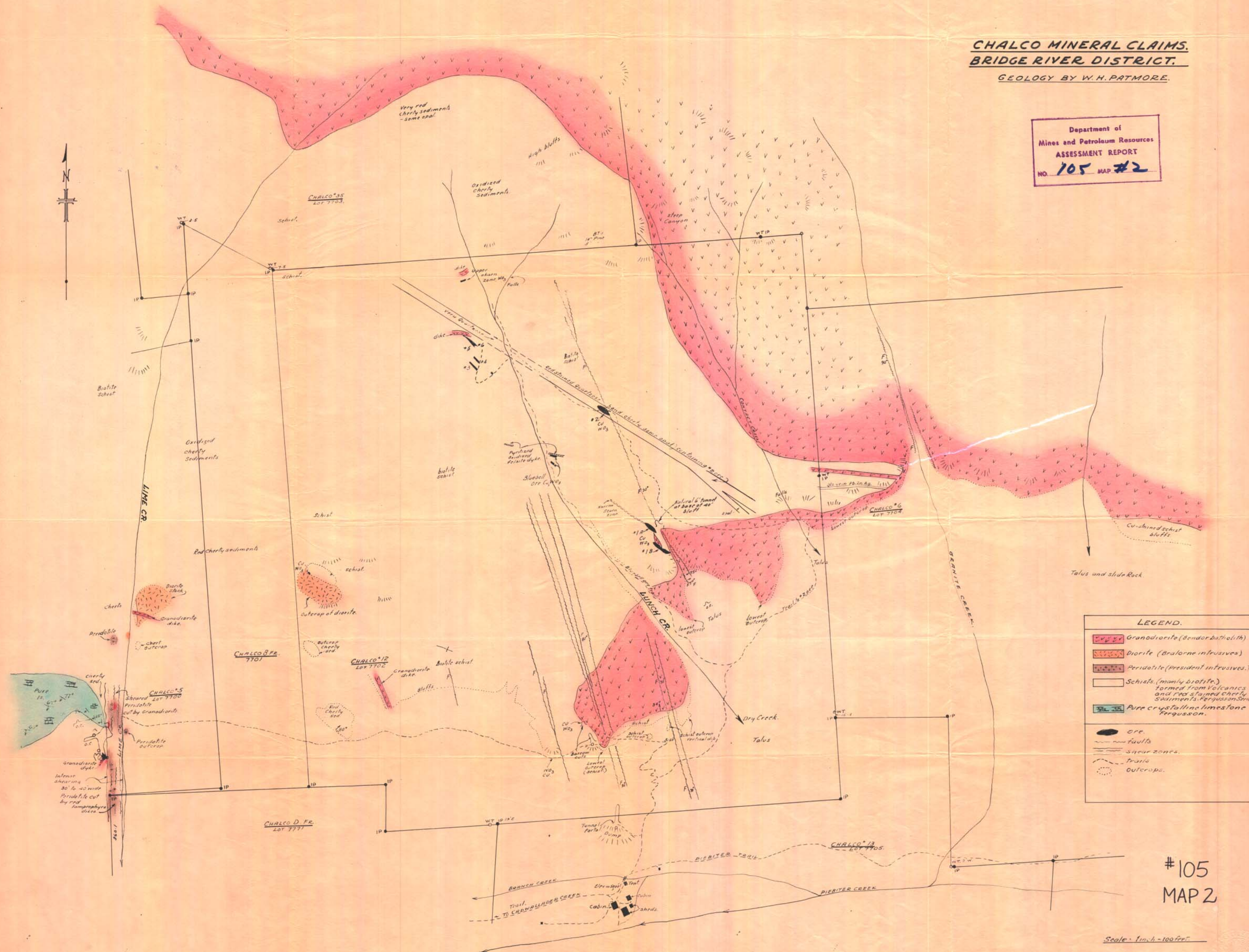

**LEGEND.**

	Granodiorite (Bendor batholith)
	Diorite (Oratorne intrusives)
	Peridotite (president intrusives)
	Schists, (mainly biotite) formed from Volcanics and red stained cherty sediments. Ferguson Series.
	Pure crystalline limestone Ferguson.
	ore.
	faults
	shear zones.
	trails
	Outcrops.

#105  
MAP 2

Scale - 1 inch = 100 feet

# CHALCO "D" FR.

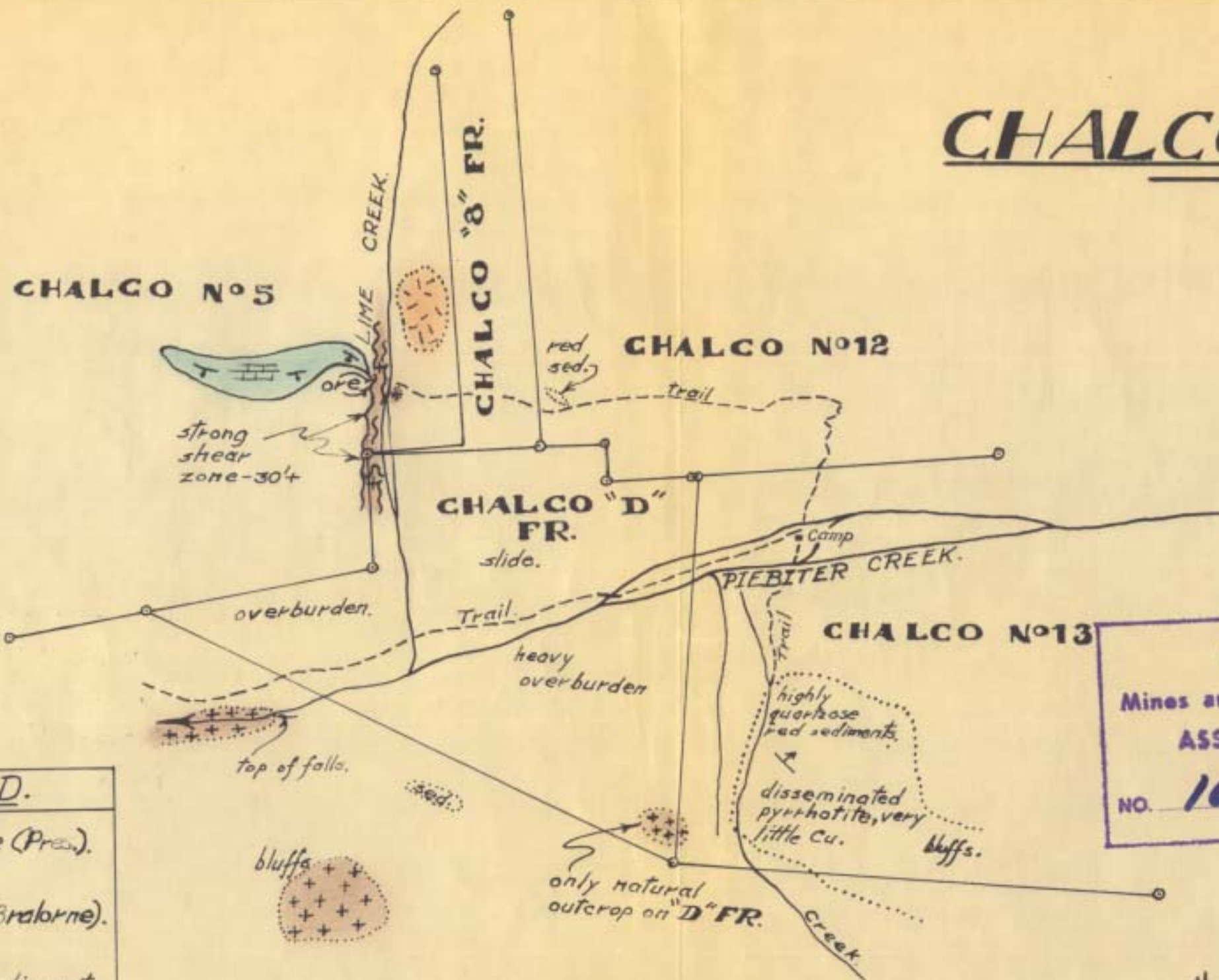
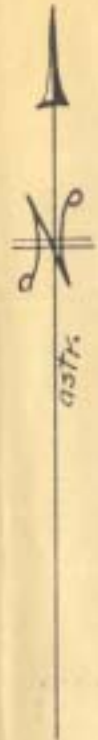

Department of  
Mines and Petroleum Resources  
**ASSESSMENT REPORT**  
NO. **105** MAP **#3**

LEGEND.	
	- peridotite (Pres.).
	- diorite (Braburne).
	- cherty sediments (Fergusson).
	- pure limestone (Fergusson).
	- fault zone.
	- outcrop.

Scale :- 1" = 400'

#105  
MAP 3  
**GEOLOGY :-**  
by  
W.H. Patmore, P.Eng.  
1954.



# CHALCO GROUP

— East End. —

LEGEND.	
	granodiorite-Bendor bath.
	cherty sed. or volcanics - (Ferguson).
	contact.
	bluffs.

#4 6000' Sk - WO<sub>3</sub> - skarn.

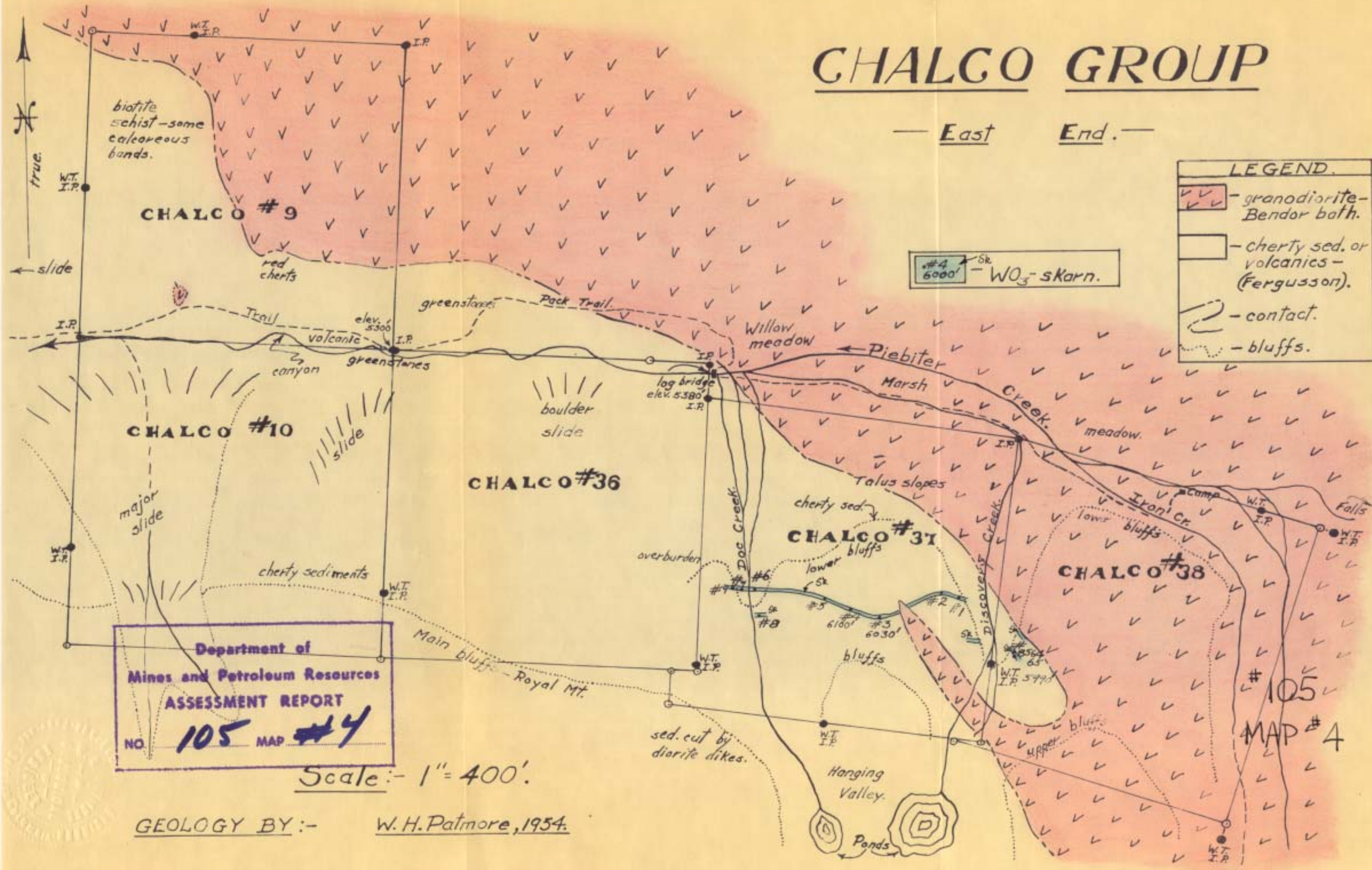

Department of  
Mines and Petroleum Resources  
ASSESSMENT REPORT  
NO. 105 MAP #4

Scale: - 1" = 400'

GEOLOGY BY: - W. H. Patmore, 1954.

#105  
MAP #4