

117

NORANDA EXPLORATION COMPANY LIMITED

Magnetometer Survey

of the

Eholt Copper Property

Groups A, B and C

Eholt, 8 miles northeast of Greenwood, B.C.

49° 118° S.W.

M. M. Menzies, P. Eng.

November 19 1955 - January 19 1956

Table of Contents

Cost Statement 1 page
Affidavit of Salaries and Wages . . . 1 page
Magnetometer Report 3 pages

Appended

#1-3 Magnetic Map (sheets 1, 2 and 3) 1" = 200'

#4 - *Access Group map*

Noranda Exploration Company Limited

Cost of Magnetic survey of Groups A,
B and C, Eholt Copper Property, 8 miles
northeast of Greenwood, B. C.
1955 - 1956

Engineering Supervision and Geophysical Work:

1 Professional Engineer

45 days @ \$35.00 per day \$ 1,575.00

Line Cutting:

9 men - 200 man days @ \$12.00 per day \$ 2,400.00

Total \$ 3,975.00

Affidavit detailing days worked by persons employed,
their rates in salary or wages, and the total paid to
each man

<u>Name</u>	<u>Days Worked</u>	<u>Rate</u>	<u>Wages Paid</u>
M. M. Menzies	1½ months	\$435 per month	\$ 650.00
C. Noel	1 month	\$300 per month	300.00
A. MacIsaac	1 month	\$300 per month	300.00
J. Puddy	29 days	\$12.00 per day	348.00
R. Meyers	14 days	\$12.00 per day	168.00
F. Matias	18 days	\$12.00 per day	216.00
W. E. McArthur Jr.	25 days	\$12.00 per day	300.00
G. Kamada	28 days	\$12.00 per day	336.00
T. Walker	15 days	\$12.00 per day	180.00
W. Puritch	15 days	\$12.00 per day	<u>180.00</u>
			\$ 2,978.00

M M Menzies

M. M. Menzies, P. Eng.,

January 1956

Eholt Copper Property

Noranda Exploration Company Limited

Grand Forks Mining Division

Grand Forks, B. C.

The Eholt Copper Property is situated on the old Summit Camp of the Boundary District, 8 miles northeasterly from Greenwood, B. C. The surfaced Provincial Highway No. 3 runs north-south through the property and the Canadian Pacific Railway marks the northern boundary of the claims.

Elevations of the Eholt Copper Property range from 3,000 to 4,000 feet. Slopes are moderate to steep but not precipitous. The country was logged off many years ago but is now covered by tamarac, cedar, spruce, cottonwood and Douglas fir. Thick cedar and brush in the lower areas make line cutting and prospecting difficult.

Seventeen Crown Grants and 51 located claims and fractions comprise the Eholt Copper Property. Forty four claims and fractions were staked by Noranda Exploration Company Limited and the remainder are held by the company under lease or option.

The Eholt Group covers the northern portion of the B. C. Basin. Rocks are Palaeozoic limestones and basalts of the Brooklyn formation, mesozoic quartz diorite and tertiary dykes, sills and flows. The Brooklyn limestone is the productive host of the Boundary District and in both the B. C. and Deadwood Camps ore deposits are found closely associated with quartz diorite intrusives. Tertiary flows are not mineralized and form a capping over the Palaeozoics in many places.

Two or three hundred thousand tons of copper ore were mined during the early 1900's from the three main properties in the B. C. Basin. The B. C. mine produced 100,000 tons averaging nearly 6 percent copper and was the only high grade deposit of commercial size in the Boundary District. The Ore Denoro was a larger, low grade operation, the old workings of which are now marked by abundant hematite staining. The Emma ore was essentially magnetite running one percent copper or less and was mined economically for a time because of its fluxing qualities.

Renewed activity in the Boundary District is primarily due to the current heavy demand for copper and the resultant rapid rise in value of the metal during the past year. However, known ore bodies had not been entirely exhausted and the geology of the area, when studied in the light of the district's productive history, is favourable for the discovery of additional economic copper deposits.

Work could not be started for various reasons on the Eholt Copper Property until late fall of 1955. A programme was planned to prepare the property for systematic investigation commencing early in the spring of 1956. Three groups of 8 claims each, comprising the northwesterly part of the property, were trenched across the trend of the formations by a D8 bulldozer in an effort to uncover mineralized float, determine the underlying rock types and expose favourable geological contacts. A magnetometer survey was decided upon for the remaining three groups, two of 8 claims each and a third of 4 claims.

A well cut grid would make an early start on the spring programme much easier and it was hoped that magnetic results would also help in formulating exploration plans.

A point just south of the B. C. mine was selected as the grid zero and the base line was run 6,000 feet at a bearing of south 21 degrees west and 9,000 feet at a bearing of north 22 degrees east. From this carefully cut and chained base line section lines were turned off at right angles to the base and spaced at 400 foot intervals along it. Direction of the section lines was maintained by frequent picketing and stations were established at 100 foot intervals. The area thus gridded was surveyed by a Sharpe DIN magnetometer, an instrument of low sensitivity but quite suitable for most mining exploration requirements.

No strong magnetic anomalies were discovered by our preliminary programme and, because of an unusually heavy snowfall, weak anomalies have not yet been correlated with the geology. It is proposed to complete the gridding of the property by early spring so that thorough geological and magnetic surveys can be made.

Respectfully submitted,

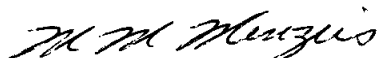

Merris M. Menzies, P. Eng.

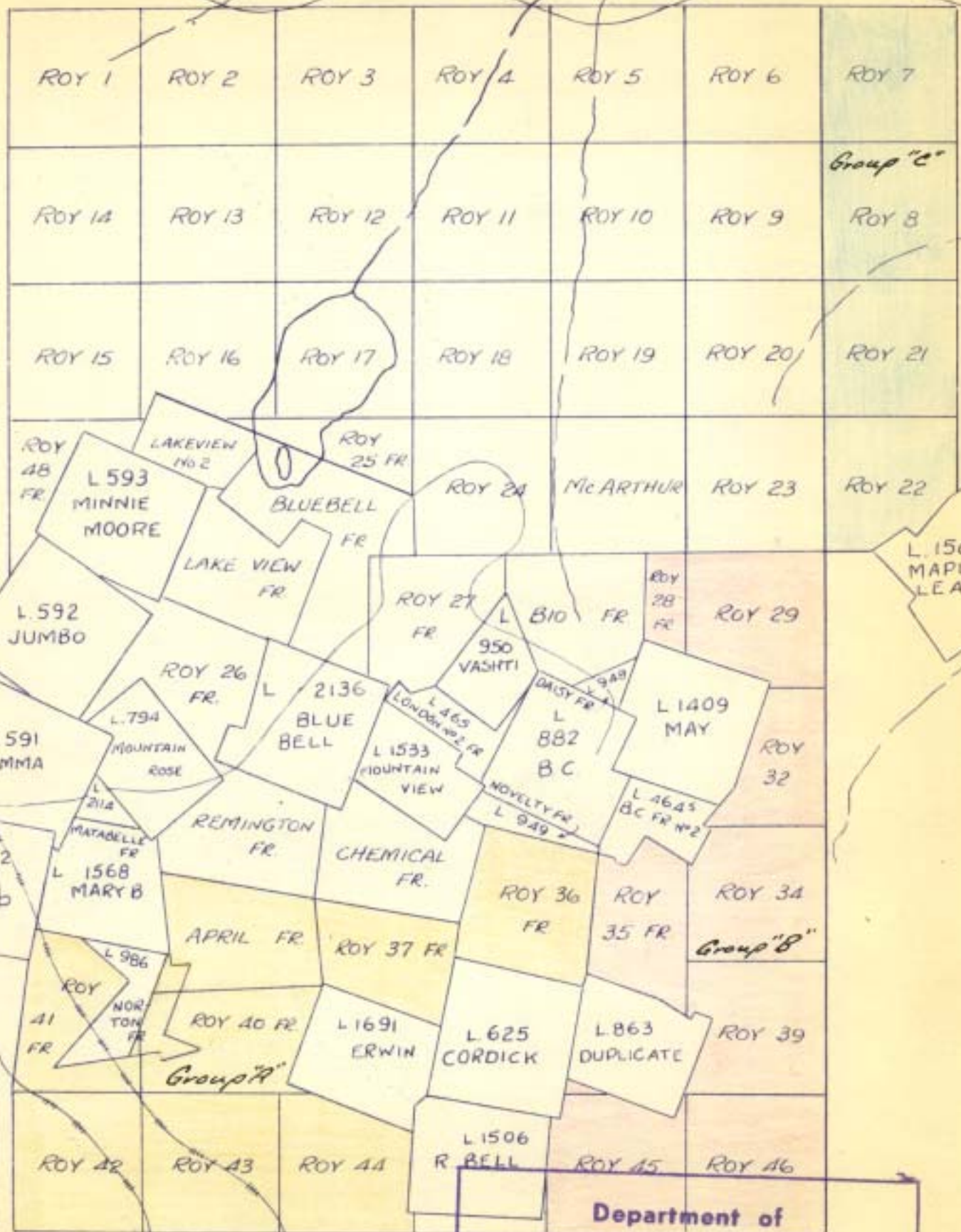

Department of
 Mines and Petroleum Resources
 ASSESSMENT REPORT
 NO. 117 MAP #4



MAGNETOMETER SURVEY
 EHOLT PROPERTY
 NORANDA EXPLORATION COMPANY LIMITED
 GRAND FORKS MINING DIVISION
 GREENWOOD B. C.
 Scale 1 inch = 200 feet
 M.M. Menzies
 December 1955

Department of
 Mines and Petroleum Resources
 ASSESSMENT REPORT
 NO. 117 MAP #1

Report 117
LEGEND:
 CONTOUR INTERVAL - 100 GAMMAS
 MAGNETIC LOW -

Magnetic Intensity Varies from Approximately 2260 to 2540
 Gammas Except For Two Small Highs on Sheet No. 2
 Scale Reading 170 Is Approximately Equal To 2260 Gammas

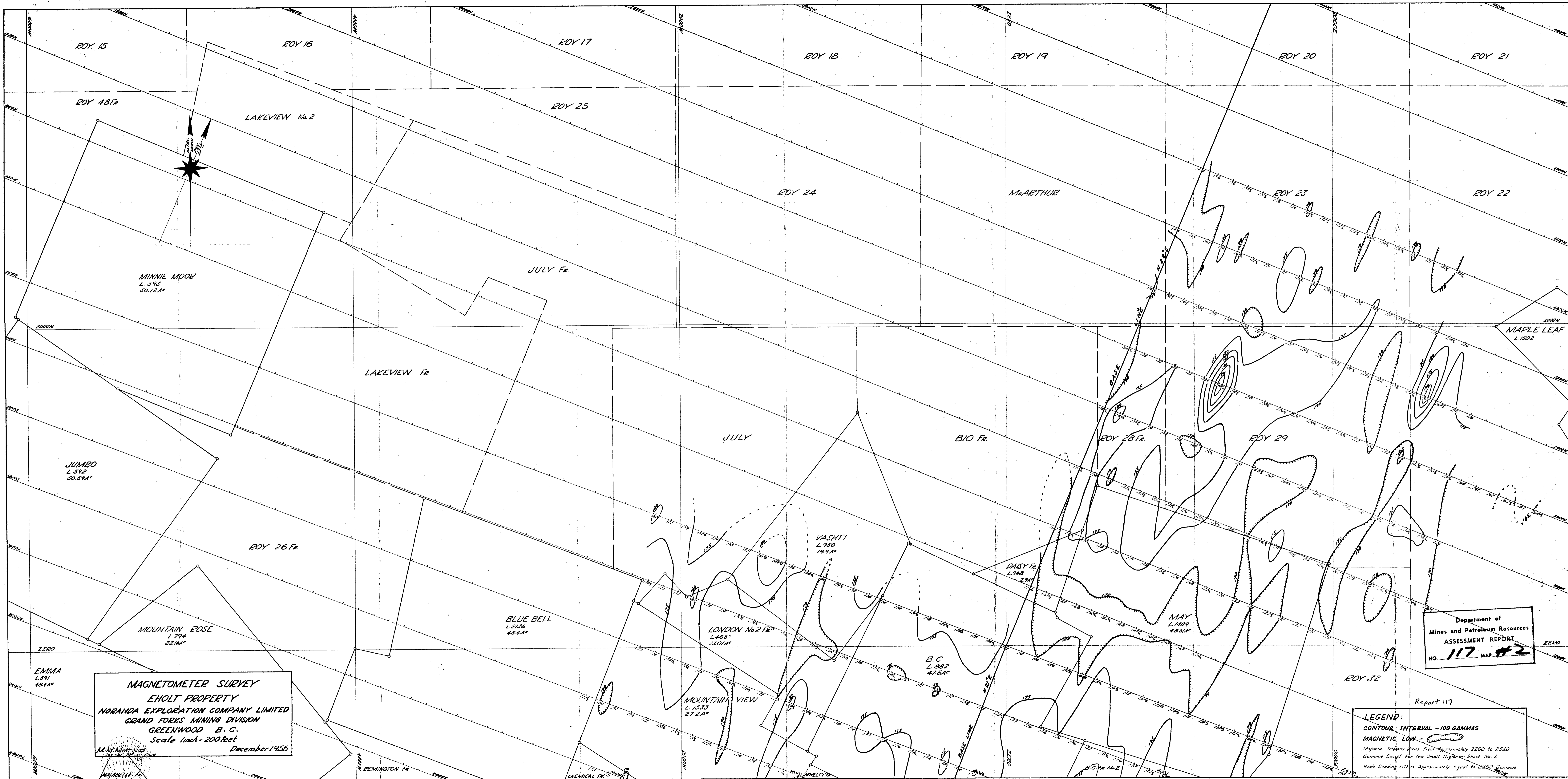

MAGNETOMETER SURVEY
EHOLT PROPERTY
 NORANDA EXPLORATION COMPANY LIMITED
 GRAND FORKS MINING DIVISION
 GREENWOOD B. C.
 Scale 1 inch = 200 feet
 December 1955

Department of
 Mines and Petroleum Resources
 ASSESSMENT REPORT
 NO. 117 MAP #2

Report 117
LEGEND:
 CONTOUR INTERVAL - 100 GAMMAS
 MAGNETIC LOW -
 Magnetic Intensity Varies From Approximately 2260 to 2540
 Gammas Except For Two Small High-up Sheet No. 2
 Scale Reading 170 is Approximately Equal to 2260 Gammas

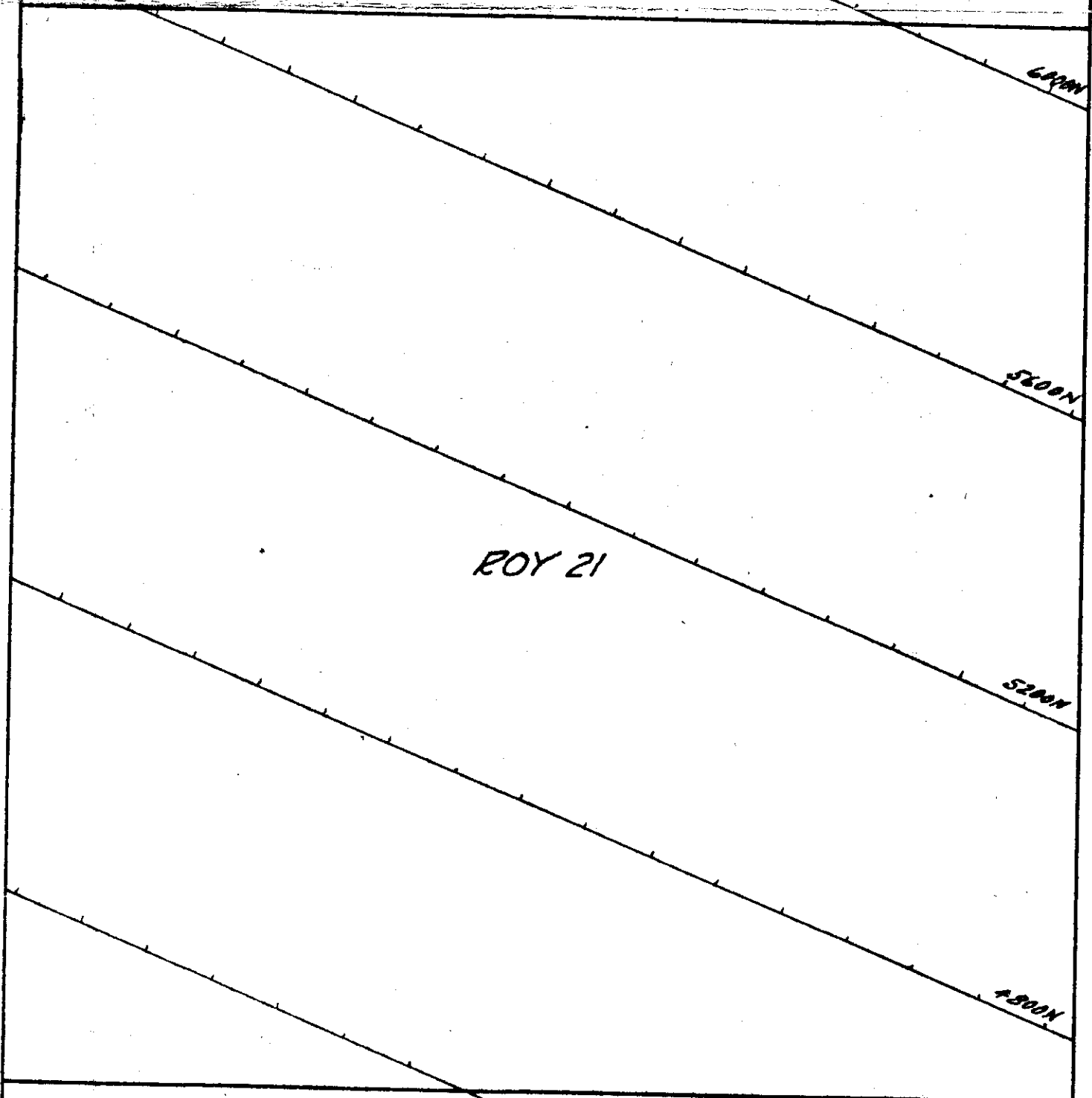
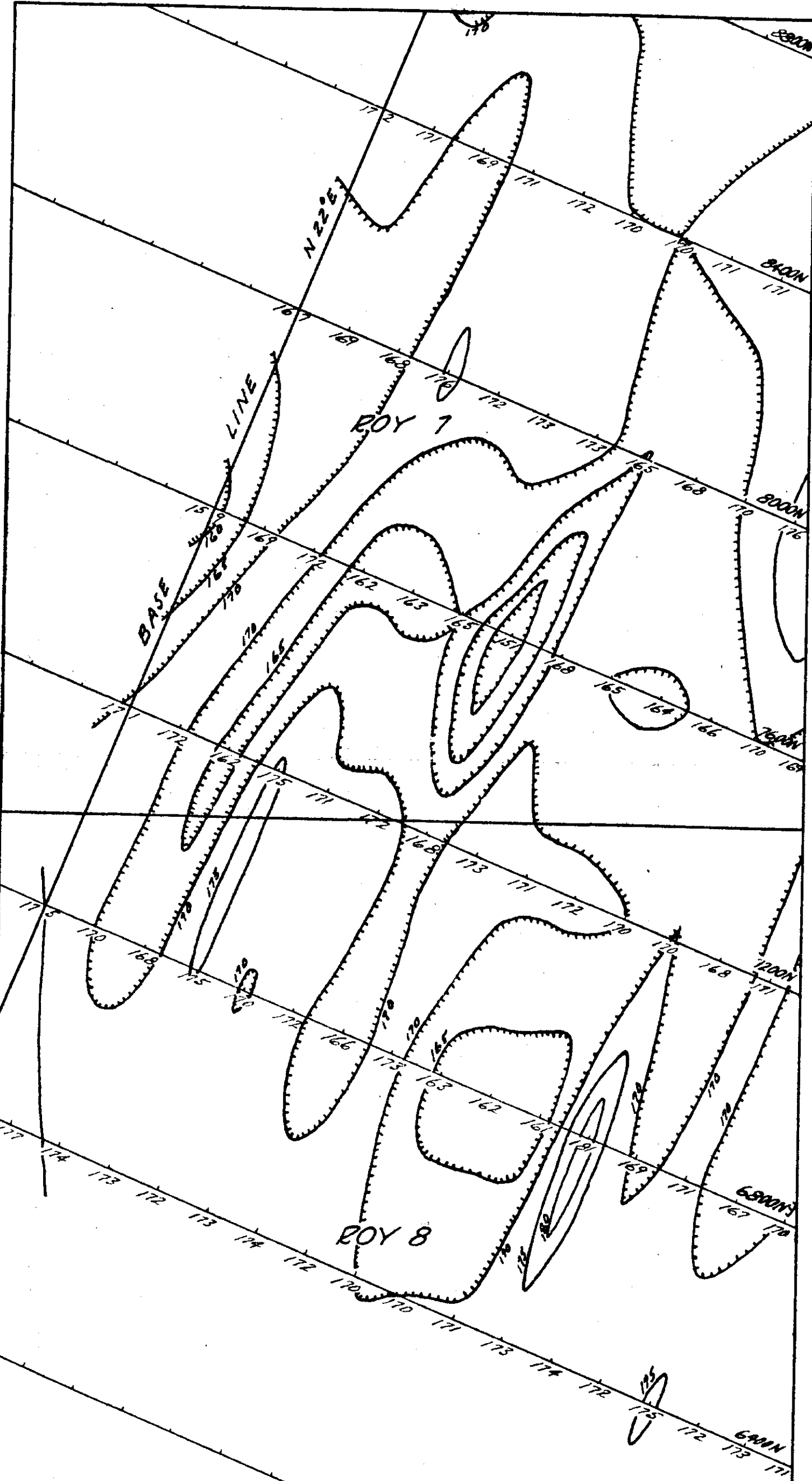

Department of
 Mines and Petroleum Resources
ASSESSMENT REPORT
 NO. **117** MAP # **3**

ROY 22 Report 117

LEGEND:
 CONTOUR INTERVAL - 100 GAMMAS
 MAGNETIC LOW -

MAGNETIC INTENSITY VARIES FROM APPROX. 2260 TO
 2540 GAMMAS - EXCEPT FOR TWO SMALL HIGHS ON SHEET 2
 SCALE READING 170 IS APPROX. EQUAL TO 2260 GAMMAS

EHOLT PROPERTY
 SHEET 3
 Scale 1" = 200'
 M.M.M.

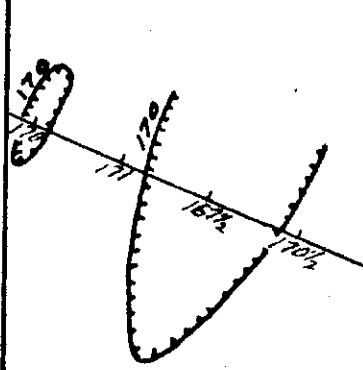

MAPLE LEAF

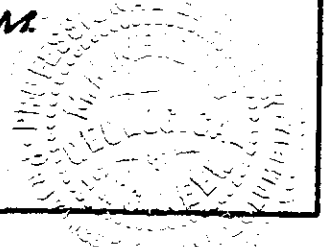

M.M. Murgio