

Geochemical Soil Analysis Survey
Skeena Silver Mines Ltd.
Highland Valley Claims
Loc. 50-1215R 92I/6E
Skeena Copper Groups.
C. Rutherford - Sept-Nov. 1956

0183

SKEENA SILVER MINES LTD.
(NON PERSONAL LIABILITY)
411-850 WEST HASTINGS STREET
VANCOUVER 1, B. C.

183

June 19, 1957

Methods used in performing Geo-chemical Soil
Tests on Skeena Silver Claims in Highland Valley
during September, October and November, 1956.

Since location lines of Divide Copper and Skeena Copper claims were close to magnetic North in bearing and strike of known mineralization was N 10° W, picket lines were cut E-W magnetic at 300' intervals. Stakes were put in at 200' intervals along these picket lines and soil samples taken. These samples were carefully recorded and analysed and location and results are plotted on the accompanying maps.

A ship's auger, extended to 4' in length by welding was used to drill into the ground as deeply as possible. Earth remaining in auger when it was pulled out was used as a soil sample.

For the chemical analysis a kit supplied by McPhar Manufacturing Company of Toronto was used.

The soil sample was carefully mixed and a small amount, as determined by a measuring device supplied, was placed in a small glass bottle. A solvent was added to the bottle, again measured against standard supplied, the bottle capped and then shaken for thirty seconds. Then a dilute solution of dithionite of proper strength and amount added and the bottle again shaken for 30 seconds. After this a drop or two of Demulsol was added to bottle. The resultant colour was checked against a chart

C.R.

June 19th.
1957

supplied and results recorded.

According to McPhar Geophysics instructions-the red colour or a count of 300 was necessary to be of importance. To be really important the dithizone was to be doubled in the analysis and if the colour again came up red you had something. In only one location was this true but on another soil sample being taken at same location and others within a fifty foot radius the original sample did not check out. There are several locations where counts of 300 were had and it was intended to check these further but lateness of season prevented. Operations have not been resumed this summer.

The writer is not a geological Engineer but has been a Member of the Professional Engineers of B.C. since 1943, as a Mining Engineer. This method is primarily a chemical method and instructions were had from McPhar Geophysics and also I worked closely with another company who were doing a large geochemical survey.

All of which is respectfully submitted.

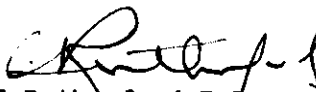
C. Rutherford, P. Engr.

AP
Geochemical survey
300

SKEENA SILVER MINES LTD.
(NON PERSONAL LIABILITY)

411-850 WEST HASTINGS STREET
VANCOUVER 1, B. C.

Expenditures re Geo-chemical Soil Tests:

SEPTEMBER 1956 -	McPhar Manufacturing Co.Ltd., supplies	197.50
	Marshall-Wells B.C. Ltd., ship's auger	6.79
	Cutting Picket Lines - labour	503.37
	Engineering - soil sampling	<u>400.00</u>
		\$ 1,107.66
		<u><u> </u></u>
OCTOBER 1956 -	McPhar Manufacturing Co.Ltd., supplies	18.00
	Cutting Picket Lines - labour	661.62
	Engineering - soil sampling	<u>150.00</u>
		\$ 829.62
		<u><u> </u></u>
NOVEMBER 1956 -	Engineering - soil samples	\$ 400.00
		<u><u> </u></u>

I hereby certify the amounts shown above are true and correct and as shown on the Company records, covering geo-chemical soil tests on the Skeena Silver Mines Ltd. claims in the Highland Valley.

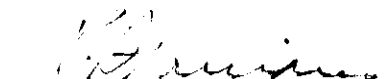
Secretary

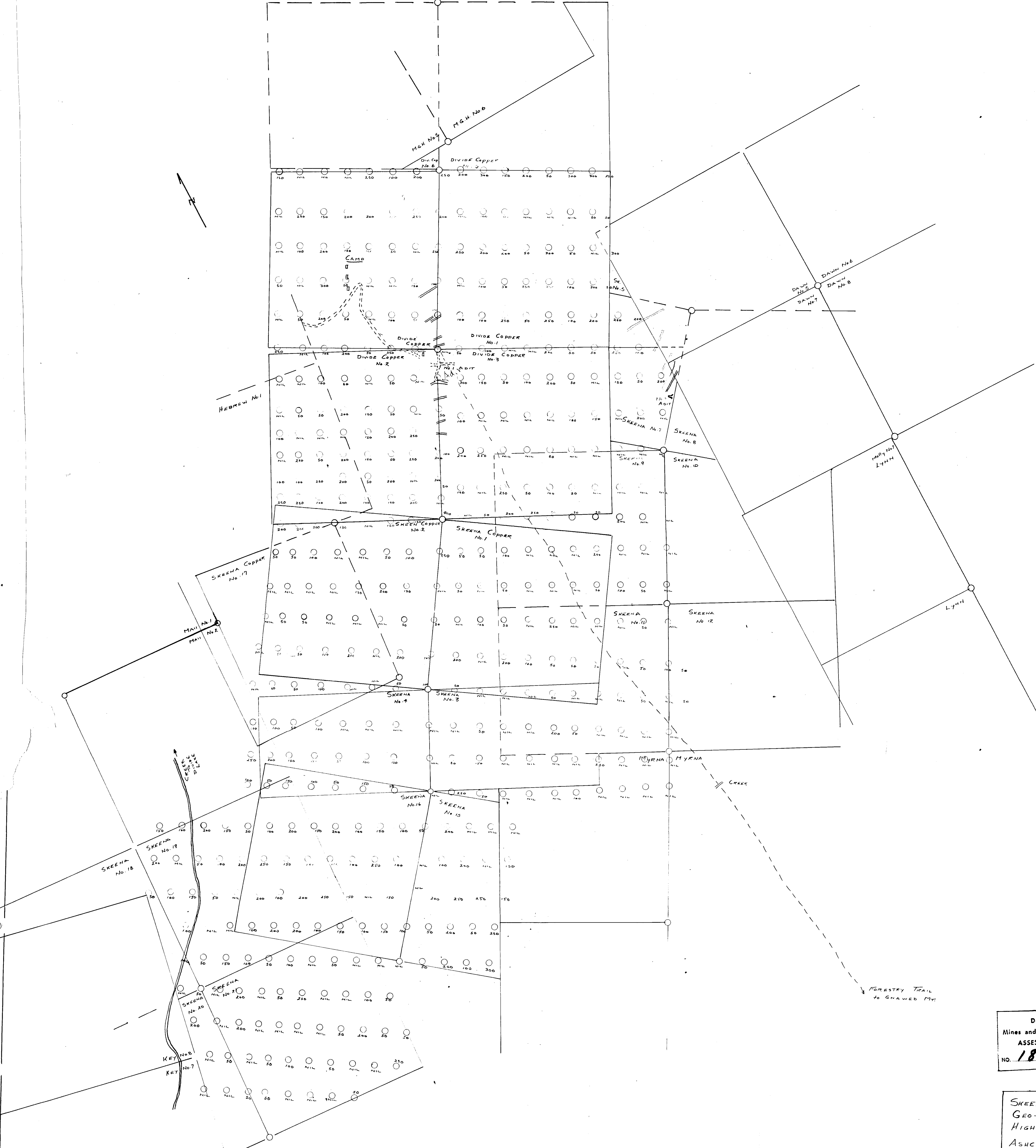

Department of
Mines and Petroleum Resources
ASSESSMENT REPORT
NO. 183 MAF #1

SKEENA SILVER MINES LTD.
GEO-CHEMICAL SURVEY
HIGHLAND VALLEY CLAIMS
ASHCROFT, B.C.
SCALE 1" = 300'
C.R.F.