

Geological, Geochemical and Geophysical
Report on the Dodo Group of Mineral
Claims (Dodo #1, #4, #6, #15, #16 and
#18) situated in the Nicola Mining Div-
ision of B. C. about 2 miles north of
Canford, B. C. at ~~500, 1200~~. Work done
between April 8, 1958 and April 8, 1959

Signed



L. B. Gatenby, P.Eng

50°12' SE

92I/3E

0262

262

I N D E X

	Page
General	1.
Geological Expenditures	2.
Geochemical Expenditures	3.
Geophysical Expenditures	4.
Geological Report and Results	5.
Geochemical Report and Results	6.
Geophysical Report and Results	7.

Enclosed Maps

- #1 1. Dodo Claim Group Map - Scale 1" = 1320'
- #2 2. Magnetometer, Self Potential and Geochemical
Soil Sampling Grids and Geological and
Geochemical Results - Scale 1" = 400'
- #3 3. Magnetometer and S. P. Profiles - Scale 1" = 400'

General:

This report deals with the expenditures and exploration results of Rio Tinto Canadian Exploration Ltd. on Dodo #1, #4, #6, #15, #16 and #18 mineral claims called Dodo Group in the Nicola Mining Division. Mineral exploration work was done under the following general headings:

- (1) Geological
- (2) Geochemical
- (3) Geophysical

Work was done between April 8, 1958 and April 8, 1959.

Geological ExpendituresPersonnel

D. Calimente, M.Sc., Field Geologist		
5 days @ \$15/day allowable		\$ 75.00
C. A. Langlois, Prospector		
3 days @ \$15/day allowable		45.00
L. B. Gatenby, P.Eng. - Supervisory capacity		
2 days @ \$35.00		70.00
Camp food costs @ \$2.40/day/man		
10 man days		24.00
Vehicle charges		<u>30.00</u>
Total		\$ 244.00

Signed

L. B. Gatenby
L. B. Gatenby, P.Eng.

Geochemical ExpendituresPersonnel

C. A. Langlois - Geochemical operator	
5 days @ \$15/day	\$ 75.00
D. Calimente - Field Geologist	
2 days @ \$15/day	30.00
Camp food costs @ \$2.40/day/man	
7 man days	16.80

Geochemical Supplies

235 samples @ 50¢ each	117.50
------------------------	--------

Vehicle charges	<u>10.00</u>
-----------------	--------------

Total	\$ 249.30
-------	-----------

Signed L. B. Gatenby
L. B. Gatenby, P. Eng.

Geophysical Expenditures

Personnel

H. Ebell - Geophysical operator		
8 days @ \$15/day		\$ 120.00
D. Calimente - Field Geologist		
4 days @ \$15/day		60.00
Camp food costs @ \$2.40/man/day		
12 man days		28.80
Vehicle charges		<u>10.00</u>
Total		\$ 218.80

Signed L. B. Gatenby
 L. B. Gatenby, P. Eng.

Geological Report

(see map no. 2)

Control for the geological mapping of this area was obtained from aerial photograph mosaics and surveyed grid lines cut and picketed on the ground.

The aerial photograph mosaics were prepared from B. C. Government 1" = $\frac{1}{2}$ Mile photographs and subsequently enlarged to a scale of 1" = 1320' approximately. These mosaics were first used for a geological interpretation of the area and later for ground control of the many reconnaissance surveys before and outside the grid surveys.

After the geological reconnaissance surveys grid lines were cut in the most promising areas at 600' spacing with 100' stations.

Results of the combined geological mapping show the main body of the claims is underlain by Nicola formation volcanics and sediments with Kingsvale Group Cretaceous volcanics in the western part of the claims.

In the Nicola formation two limestone bands (400' and 1200' thick) cut across the claims in a north easterly, south westerly direction. Two minor spots of copper mineralization filling fractures were located in the area, one in Nicola volcanics and one in Nicola sediments.

Geochemical Report

(see map no. 2)

The geochemical method used is a dithizone field technique developed by Rio Tinto Canadian Exploration Ltd. General procedure is to take soil samples on surveyed grid lines at 100 foot stations and in creeks and drainage gulleys at 250 foot intervals. Anomalous samples and every tenth background sample are sent to the company's Toronto laboratory for spectrographic analyses. Surveying of the grids is done by compass and tape.

On this claim block over 23,500 feet of grid line was soil tested at 100 foot intervals. Overburden was found to be generally thin in the ridge area in the central and eastern part of the claim block. Geochemical results are considered reliable in this area. The southerly draining creek gulley has deep clay overburden and geochemical results are not considered reliable in this area.

No pattern or trends of mineralization were shown by this survey. Detailing of two weakly anomalous areas indicated them to be very small.

Geophysical Survey

(see maps No. 2 and No. 3)

All grid lines were surveyed with a magnetometer and in addition about 5500' of additional line was surveyed with a magnetometer and self potential equipment. A Radar "60" magnetometer with a sensitivity of about 20 gammas was used for the magnetic survey.

It was found both the magnetics and the difference of potential are quite inactive in the surveyed area and no significant anomalies were discovered.

signed L. B. Gatenby
L. B. Gatenby, P. Eng.

"Self potential surveys were run with a standard potentiometer and 800 feet reel of wire. Porus ceramic contact pots were used for ground contact and stations with readings were set at 100 feet intervals. Where readings were inaccurate because of poor ground contact the contact area was moistened with water to improve the ground contact. Apart from this no difficulties were encountered in this survey.

L.B.Gatenby P.Eng."

See summary of qualification form on file 166 in connection with the "Dodo" mineral claim survey submitted by L.I. 3498 from the Mining Recorder at Merritt, B.C. on April 27th 1959.

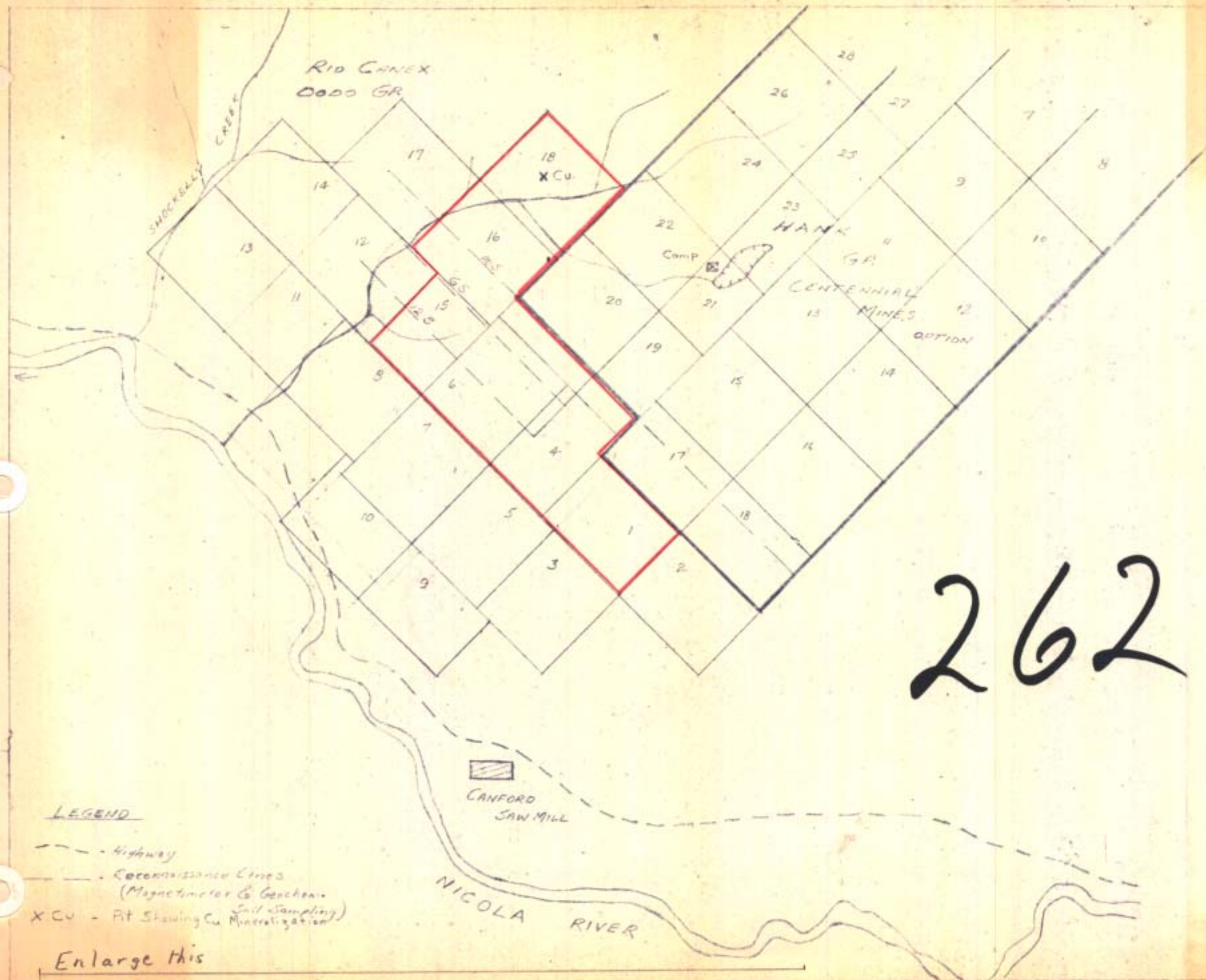

262

Department of
Mines and Petroleum Resources
ASSESSMENT REPORT
NO. 262 MAP #1

LEGEND
 - - - Highway
 --- Reconnaissance Lines
 (Magnetometer & Geochem.
 Soil Sampling)
 X Cu - Pt Showing Cu Mineralization

Enlarge this

Report 262
 RIO CANEX LTD
 DODO CLAIM GROUP
 MERRITT, B.C.
 Scale: 1" = 1500'
 Sept /58
 Topography from Aerial Mosaic
 Z. B. [Signature]
 ①

Reduce this to this

1" to 400'
reduced to 1" = 1000'

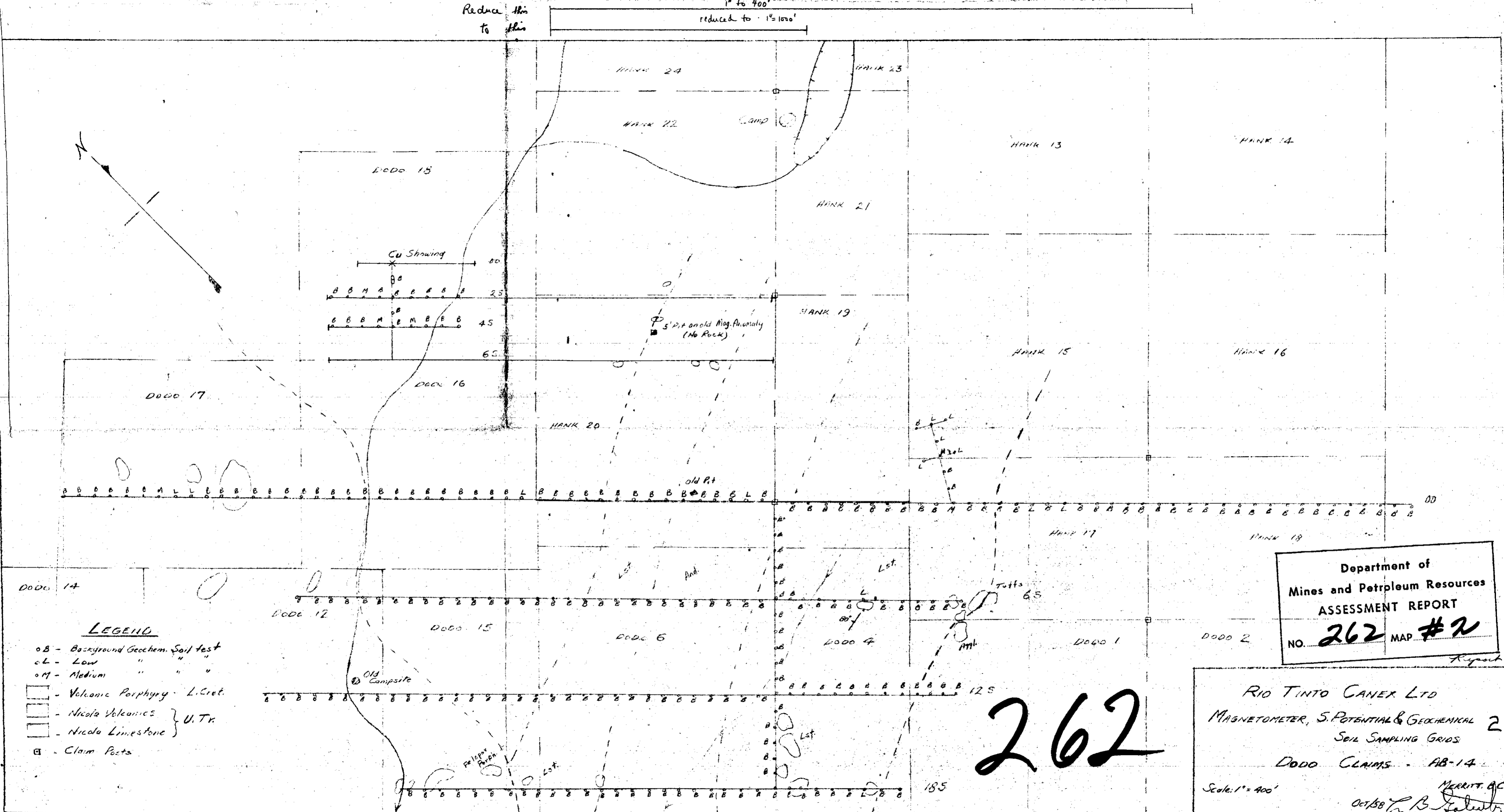
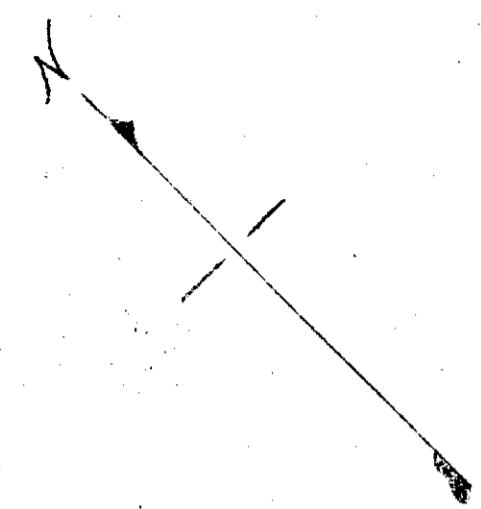

LEGEND

- oB - Background Geochem. Soil test
- oL - Low " " "
- oM - Medium " " "
- [shaded box] - Volcanic Porphyry - L. Cret.
- [unshaded box] - Nicola Volcanics } U. Tr.
- [unshaded box] - Nicola Limestone }
- - Claim Posts

Department of
Mines and Petroleum Resources
ASSESSMENT REPORT
NO. **262** MAP # **2**

RIO TINTO CANEX LTD
MAGNETOMETER, S. POTENTIAL & GEOCHEMICAL 2
SOIL SAMPLING GRIDS
DODD CLAIMS - AB-14
Scale: 1" = 400'
MERRITT, B.C.
Oct 1958 L.B. Salter

262

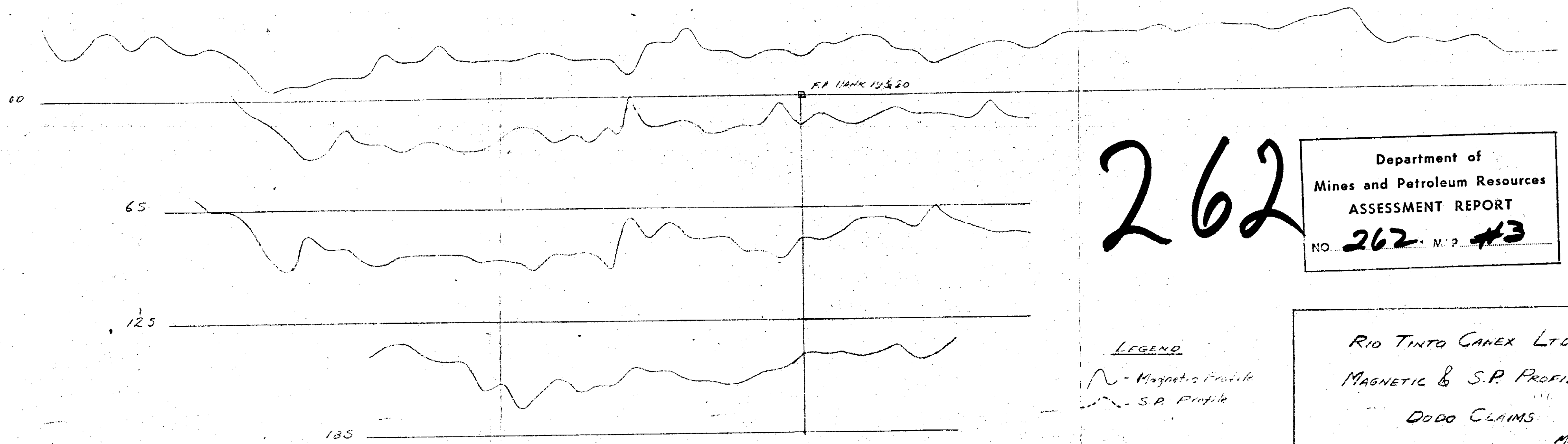
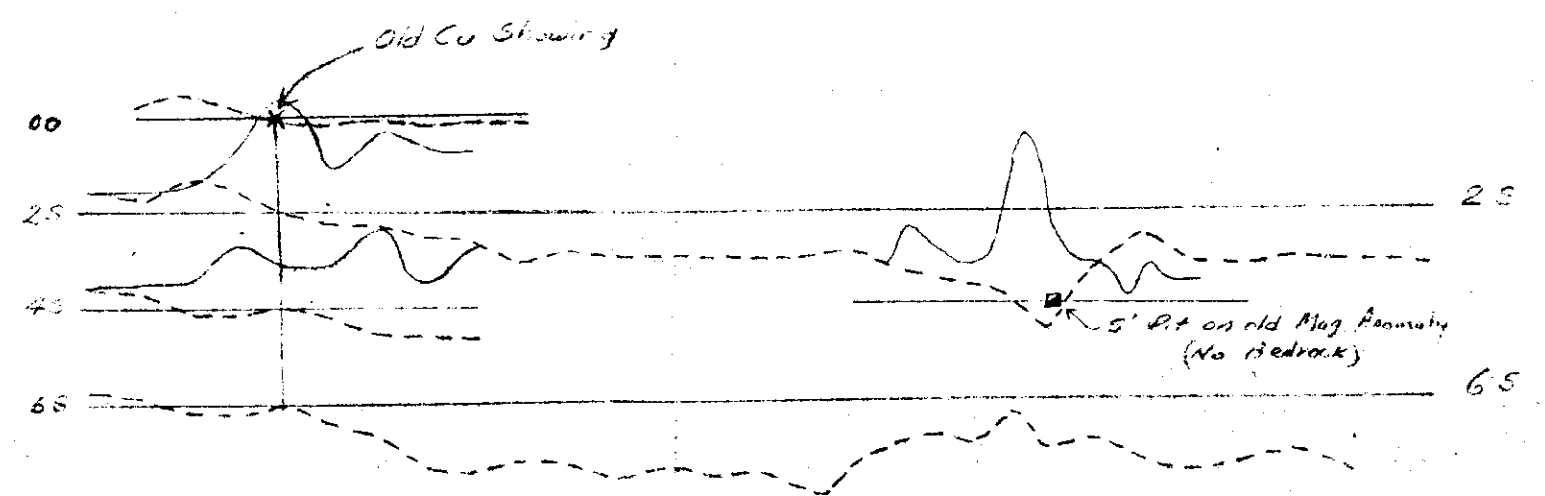
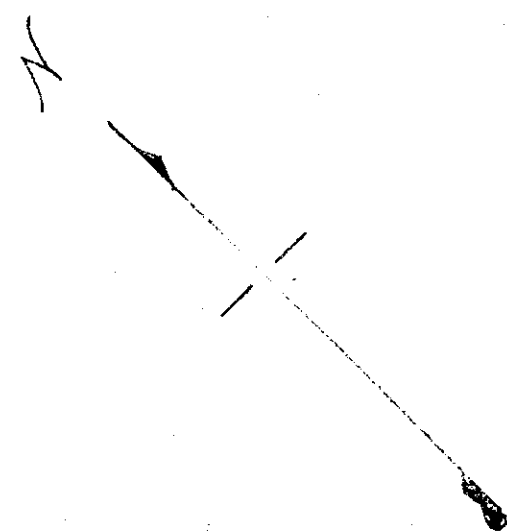

262

Department of
Mines and Petroleum Resources
ASSESSMENT REPORT
NO. 262 M.P. #3

LEGEND
— Magnetic Profile
- - - S.P. Profile

RIO TINTO CANEX LTD ^{Report} 262
MAGNETIC & S.P. PROFILES 3
DODO CLAIMS
MERRITT, B.C.
Scale: Horiz. 1" = 400'
Vert. S.P. 1" = 100 M.V.
MAG. 1" = 1000 Z. B. ^{DET 58} *Stalvey*