

INDEX - REPORT ON THE MID GROUP OF MINERAL CLAIMS

492

STATISTICAL INFORMATION Cover page

THE PROPERTY AND SURVEY Page 1

RESULTS OF SURVEY AND COSTS " 2

QUALIFICATION OF PERSONNEL " 3

Fig 1 - Magnetic Survey In Pocket

REPORT ON A MAGNETIC SURVEY ON THE MID MINERAL CLAIMS, AND
MID FRACTION.

LOCATION:

Near Merritt, B.C., in the Nicola Mining Division,
in the one degree block of which the south ~~east~~
corner is located at latitude 50 degrees and long-
itude 120 degrees - in the south west quadrant.

Supervisor: B.R. Richards, Mining Engineer.

Owner: Midwest Copper and Uranium Mines Limited, 201 - 535
Howe Street, Vancouver 2, British Columbia.

Name of Claims: Mid No. 1, Reg. no. 15152 M
" " 2, " " 15153 M
" " 3, " " 15154 M
" " 4, " " 15155 M
Mid Fr. " " 1482 G

Work performed:

June 15, 1963 to June 19, 1963, inclusive.

Department of Mines and Petroleum Resources ASSESSMENT REPORT	
NO. 492	MAP.....

REPORT ON THE MID GROUP OF MINERAL CLAIMS, by B.R. Richards

The Property, Location, etc:

The group consists of four full claims and one fraction, being Mid I to 4 inclusive and the Mid Fraction. The registration numbers of the claims are I5I52M, I5I53M, I5I54M, I5I55M and I482G. They comprise about 207 acres.

The property is located near the Craigmont Mine, about 2 miles north west of Lower Nicola, which is on the highway between Spences Bridge and Merritt. The claims are about 7 miles north west of Merritt, accessible by truck road from the highway, a distance of 2 miles. The claims are plotted on British Columbia Claims Map number 6AM4. The co-ordinates of the claims are: 50 degrees 51 minutes latitude and 120 degrees 54 minutes longitude.

Purpose of Survey:

Since there is no bedrock exposed on the property geophysics is the only method by which some knowledge of the underlying rock might be gained.

Copper mineralization in the Craigmont Mine is associated with hematite, with sufficient magnetite in places to give a magnetic anomaly. Hence any magnetic anomaly that is located in the area, within the same geological environment in which the Craigmont deposit is found, can be considered worthy of further exploration, perhaps diamond drilling.

Survey Control:

A baseline was established through the length of the property at an azimuth of 56 degrees. It was "jogged" 285 feet to the north at a point 1600 feet from the origin. Crosslines at right angles to the baseline were cut and blazed at 400 foot intervals, then chained and picketed at 100 foot intervals. Magnetic readings were taken at these 100 ft. stations.

The Survey:

The line cutting, chaining, picketing and surveying was done between June 15 and June 19, both days inclusive. The report and map were prepared in the past two days.

The magnetometer operator was Allan Swan, assisted

by Colin Swan, both of Vancouver, B.C. The work was under the supervision of the writer.

The instrument used was a Sharpe A3 Magnetometer. A chart is supplied with the instrument from which to convert the instrument readings to gammas. In the range in which the instrument was operating on this job each scale division represents 2300 gammas. The instrument is read to one hundredths of a scale division, or 23 gammas. The usual diurnal and drift corrections were made to the readings before plotting.

Results of The Survey:

Accompanying this report is a contoured map of the results of the survey. Each reading is plotted where taken on the ground. The results are contoured at 100 gamma intervals.

While readings range from 2800 to 4300 gammas no pattern emerges that could be called an anomaly, nor do the results indicate anything in the way of a structural picture. There is one pattern that shows on the two lines in the south east corner of the property. It is an area of lows, with a width of some 250 feet, and about the same in length. It undoubtedly represents a horizon of rocks with a smaller magnetite content than the enclosing rocks. Since there is no outcrop in the area one can only assume, from both the magnetic susceptibility and the shape, that it is an intrusive, possibly a granite, or other high-quartz type, into beds of intermediate flows which are common in the area.

Costs:

Wages for 2 men for 5 days @ \$20 per day per man	\$ 200.00
Supplies	45.50
Rental of Jeep. 4 days @ \$10	40.00
" " Magnetometer 4 days at \$5	20.00
Engineer's map and report	<u>300.00</u>
Total	\$605.50

Note Re Boundaries:

Claim Map 6AM4 shows the Mid Fraction plotted as a rectangle between Mid 1 and Mid 3. This present survey indicates that the fraction is as shown on the accompanying map - a "pie-cut" shaped piece in the centre of the property, with the point at the south east boundary.

Qualifications of Personnel:

I, Beresford Robert Richards, of Prince Albert, Saskatchewan, do hereby certify :

1- That I am a Mining Engineer, graduate of the University of Alberta, and am a member in good standing of the Associations of Professional Engineers of the provinces of Manitoba and Saskatchewan; and that I have practiced my profession for a period of twenty years.

2- That I have performed, supervised, and reported upon geological, geophysical and geochemical surveys for many years. Such reports have been acceptable to the Securities Commissions of Saskatchewan, Manitoba and Ontario, as well as to numerous private employers.

3- That my intentions are not to perform other professional work in the province of British Columbia this year, and so have not taken out membership in the British Columbia Association of Professional Engineers.

4- That Allan Swan is a capable operator of the Sharpe A3 magnetometer used in this survey, and I will guarantee the quality of his work.

Dated at Merritt, B.C.,
June 21, 1963.

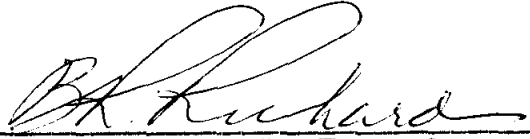
B.R. Richards, P. Eng., Man. and Sask.

Note re Allan Swan:

To my personal knowledge, the above mentioned Allan Swan has operated this type, and others types of magnetometers for at least three years, both in B.C. and Alberta.

E.R. Richards.

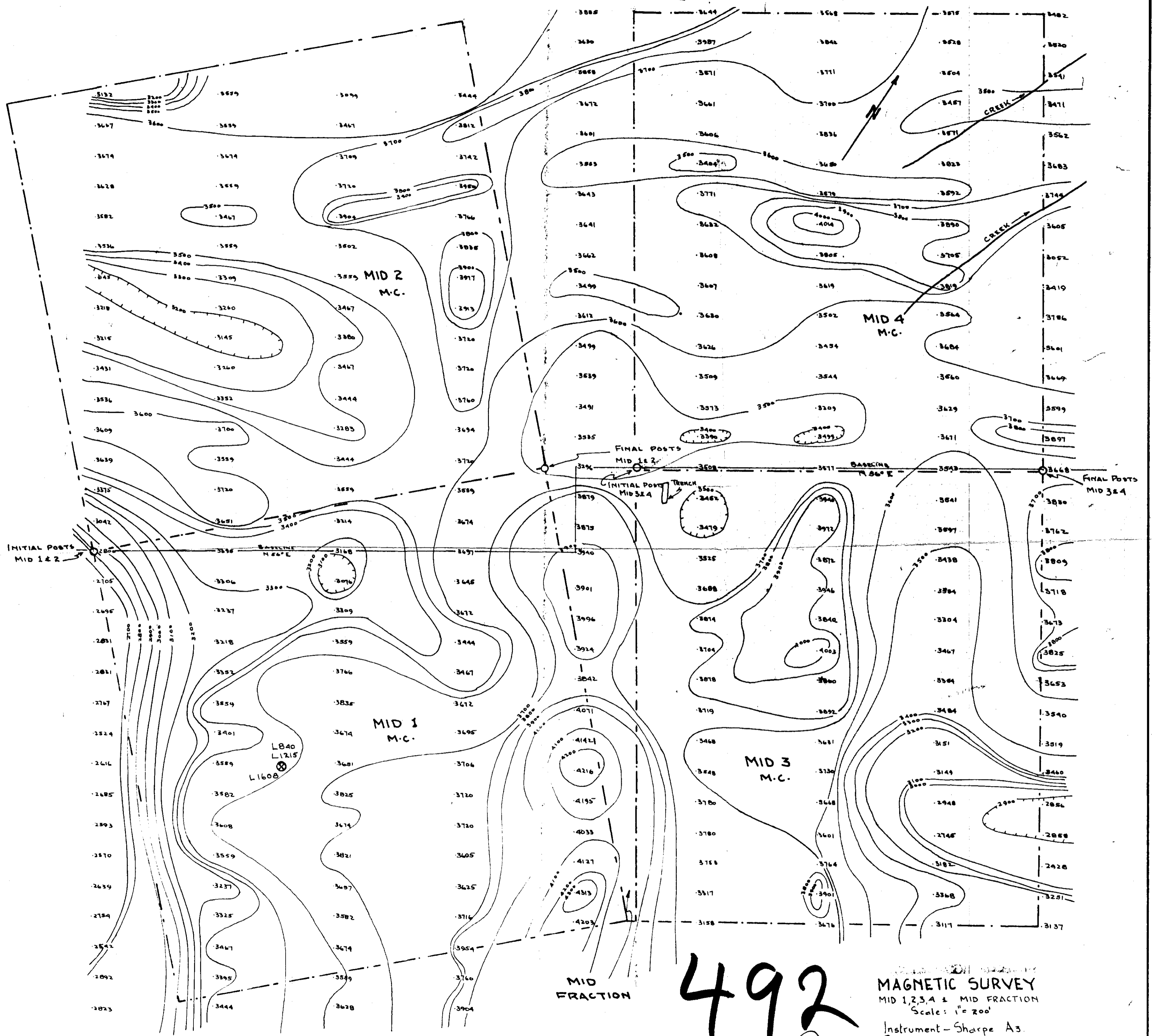

NOTE: TO ACCOMPANY MAGNETIC REPORT BY B.R. RICHARDS, MINING ENGINEER, ON THE MID GROUP OF MINERAL CLAIMS, NEAR STUMBLES CREEK, NICOLA M.D. DATED JUNE 21, 1963.

Report 492

**Department of
Mines and Petroleum Resources
ASSESSMENT REPORT**

NO. 492 N.M.P. 1

492

(MI)

MAGNETIC SURVEY
MID 1, 2, 3, 4 & MID FRACTION
Scale: 1" = 200'

Instrument - Sharpe A3.
Readings in gammas.
Contour interval - 100 gammas.
○ Magnetic depression.

○ Claim post and boundary.
⊕ L840, etc. Land survey monument.

June 21, 1963. B.