

580

GEOCHEMICAL REPORT ON  
CATFACE CLAIMS  
1964

92F/5W

Vancouver, B. C.  
November 9, 1964.

H. S. Lazenby  
Geologist

C O N T E N T S

Introduction .....	1
Method of Survey .....	1
Interpretation of Results .....	2
Statement of Work done .....	3
Statement of Qualifications .....	4
Statement of Professional Experience .....	4
Statement of Qualifications by J.J. McDougall	
Location Map .....	Fig. 1
Claim Map .....	Fig. 2
Geochem Plan .....	Fig. 3

Department of Mines and Petroleum Resources ASSESSMENT REPORT	
NO. <u>580</u>	MAP .....

## GEOCHEMICAL SURVEY OF CATFACE CLAIMS

1964

### INTRODUCTION

The Catface Mineral Claims lie on the southwest end of the Catface Peninsula, approximately 7 miles north of Tofino, B.C., in the Alberni Mining Division.

Between April 8 and August 28, 1964, a geochemical survey was run covering parts of claims Catface #53, 54, 63, 64, 65, 66, 67, 102, 103 and 104.

The work was done by a surveyor, and a specially qualified geochemical operator and their helpers. Lines trending E-W were cut through the bush and were surveyed by chain and transit. Together with the base lines, these lines total over 51,000 feet in length. Their relation to the claim boundaries is shown on Fig. 2 accompanying this report.

### METHOD OF SURVEY

Samples of the sub-humus soil layer were collected at 50-foot intervals on all E-W survey lines, marked, and put into individual polyethylene bags. At the end of the day, the rubeanic field test for copper was made and the results plotted.

Each soil sample was shaken with a strong acetate solution in a small test tube. The mud was poured into a small filter, the tip of which was resting upon a strip of reagent paper impregnated with rubeanic acid. The intensity of the spot formed on the paper was noted and plotted.

A legend on each plan (Fig. 3) shows a conversion to parts per million of copper.

INTERPRETATION OF RESULTS

Soil samples taken from different areas where copper is known to occur have been tested. The tests suggest that values of 8 and over represent anomalies of interest, i.e. areas containing 10 or greater parts per million of copper.

The three anomalies found in the area under discussion are readily discernible on Fig. 3. All are located adjacent to creek beds and judging from the surrounding results are fairly close to their source. Detailed investigation might reveal something of economic interest. The writer feels, however, that the anomalies are probably due to the presence of minor local joints containing chalcopyrite. Such joints have been observed in many instances all over the property.

In general, this area does not look very encouraging.

DOMINION OF CANADA:  
PROVINCE OF BRITISH COLUMBIA.  
To Wit:

In the Matter of

Geochemical Work of  
Catface Copper

I, H. S. Lazenby  
of Catface Copper Mines Ltd.

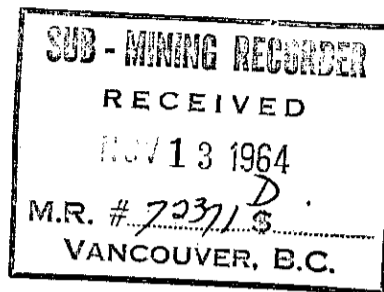

in the Province of British Columbia, do solemnly declare that the following work was done:

R. S. McBurney	- surveyor	8 Apr. to 28 Aug., 1964 - 49 days @ \$15.60	\$ 764.40
M. J. MacLeod	- surveyor's helper	8 Apr. to 28 Aug., 1964 - 14 days @ \$15.00	210.00
D. H. Randall	- geochemical operator & survey helper	8 Apr. to 28 Aug., 1964 - 57 days @ \$15.60	889.20
P. Ronnlund	- geochemical and survey helper	8 Apr. to 28 Aug., 1964 - 43 days @ \$15.00	645.00
H. S. Lazenby	- geologist	8 Apr. to 28 Aug., 1964 - 33 days @ \$25.00	825.00
			<u>825.00</u>
			\$ 3333.60

To be divided as follows:

Red group	- 67%	\$ 2233.51
Pink group	- 33%	1100.09
		<u>\$ 3333.60</u>

And I make this solemn declaration conscientiously believing it to be true, and knowing that it is of the same force and effect as if made under oath and by virtue of the "Canada Evidence Act."

Declared before me at the *city*  
of *Vancouver*, in the  
Province of British Columbia, this *13th*  
day of *November*, *1964*, A.D.

A Commissioner for taking Affidavits within British Columbia or  
A Notary Public in and for the Province of British Columbia.

★o

Sub-mining Recorder

STATEMENT OF QUALIFICATIONS

Graduated B.A. in geology from the University of B.C. in May, 1955

PROFESSIONAL EXPERIENCE

1. 1955-1956 - Geologist, Rio Canadian Exploration Ltd., engaged in mineral exploration in B.C. and Quebec.
2. 1957 - Geologist, Rio Tinto Finance & Exploration Ltd., engaged in mineral exploration in B. C.
3. 1957-1960 - Geologist, Northspan Uranium Mines Ltd., Lacnor Mine engaged in mapping, grade control, diamond drill supervision.
4. 1960-1964 - Geologist, Quebec Metallurgical Industries Ltd., Frobisher Ltd., Ventures Ltd., Falconbridge Nickel Mines Ltd. - engaged in mineral exploration in B. C.

VANCOUVER, B.C.  
November 9, 1964.

  
H. S. Lazenby,  
Geologist.

FALCONBRIDGE NICKEL MINES LIMITED

TELEPHONE  
682-3868

1112 WEST PENDER STREET  
VANCOUVER I. B. C., CANADA

November 12, 1964

The Mining Recorder,  
Vancouver,  
B. C.

Dear Sir:

This is to certify that the work and report of H. S. Lazenby covering the geochemical survey of the Catface Claims #53, 54, 63, 64, 65, 66, 67, 102, 103 and 104 was done under my supervision.

Mr. Lazenby is fully qualified as a geologist with 9 years' field and underground experience since graduation.

Mr. D. Randall has been employed by us as a prospector and geochemical operator for the past 5 years.

Yours very truly,

FALCONBRIDGE NICKEL MINES LIMITED



J. J. McDougall, P.Eng.

JJMCD:MH

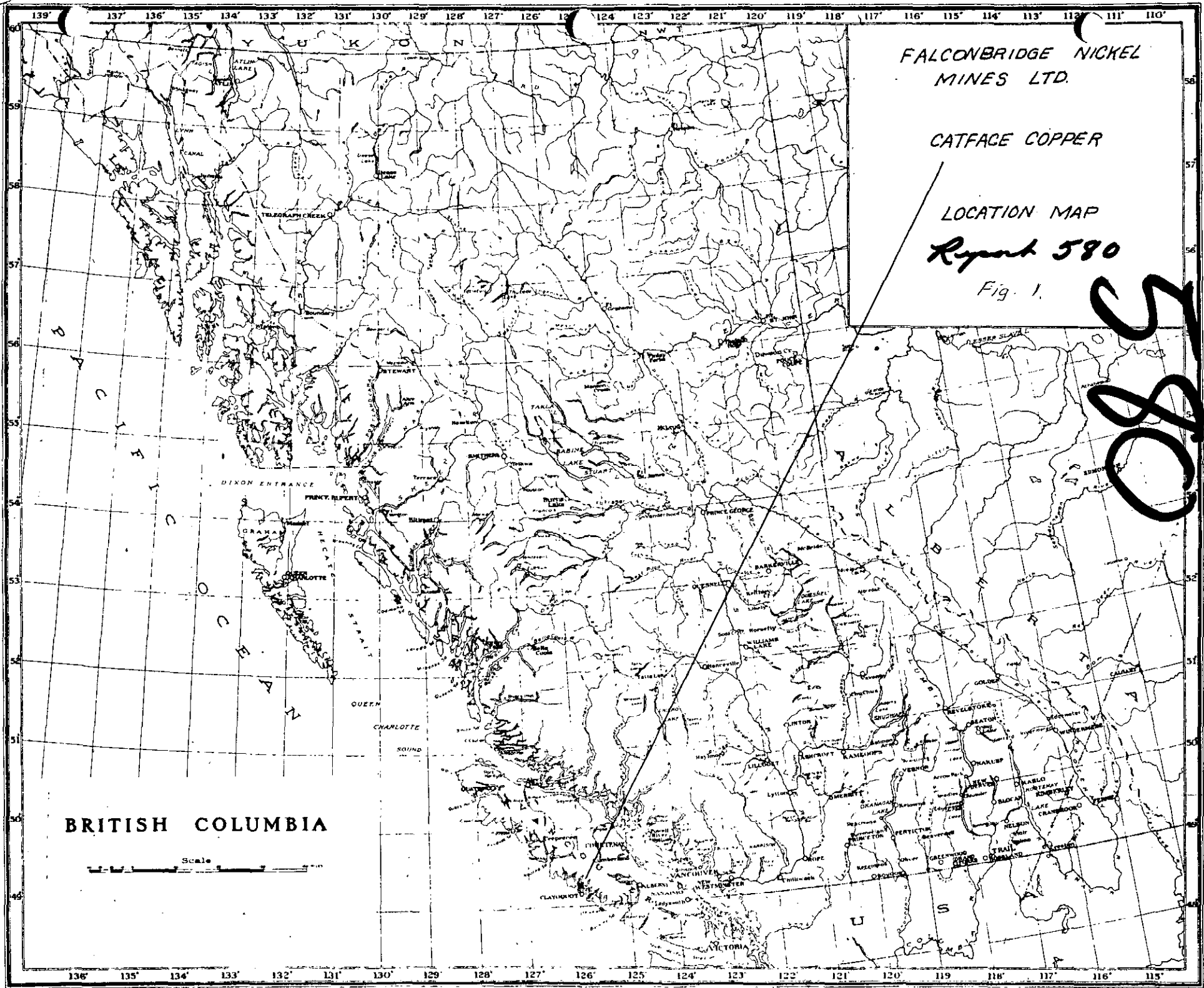

FALCONBRIDGE NICKEL  
MINES LTD.

CATFACE COPPER

LOCATION MAP

Report 580

Fig. 1.

580

BRITISH COLUMBIA

Scale



CATFACE CLAIMS  
Fig. 2

Department of  
Mines and Petroleum Resources  
ASSESSMENT REPORT  
NO. 580 MAP 2

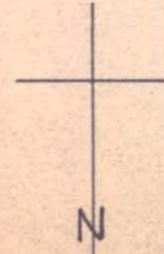

Map to accompany report by  
H.S. Lazenby on geochemical survey  
of part of 'Catface' claims, Catface  
peninsula, Alberni M.D., dated  
9 Nov, 1964.

*H.S. Lazenby*  
Report 580

SCALE: 1" = 1500'

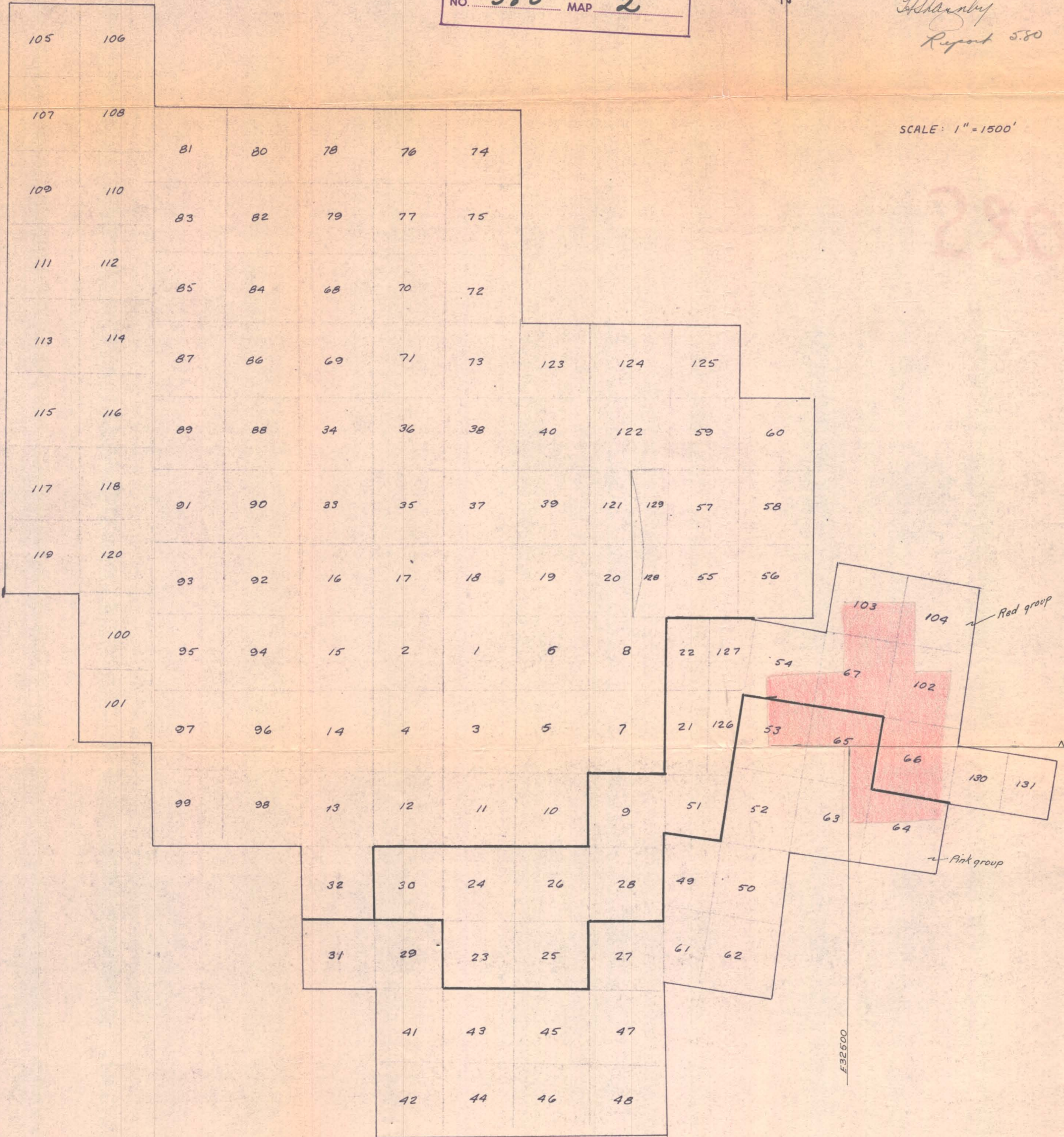

580



Department of  
 Mines and Petroleum Resources  
 ASSESSMENT REPORT  
 NO. 580 MAP 3

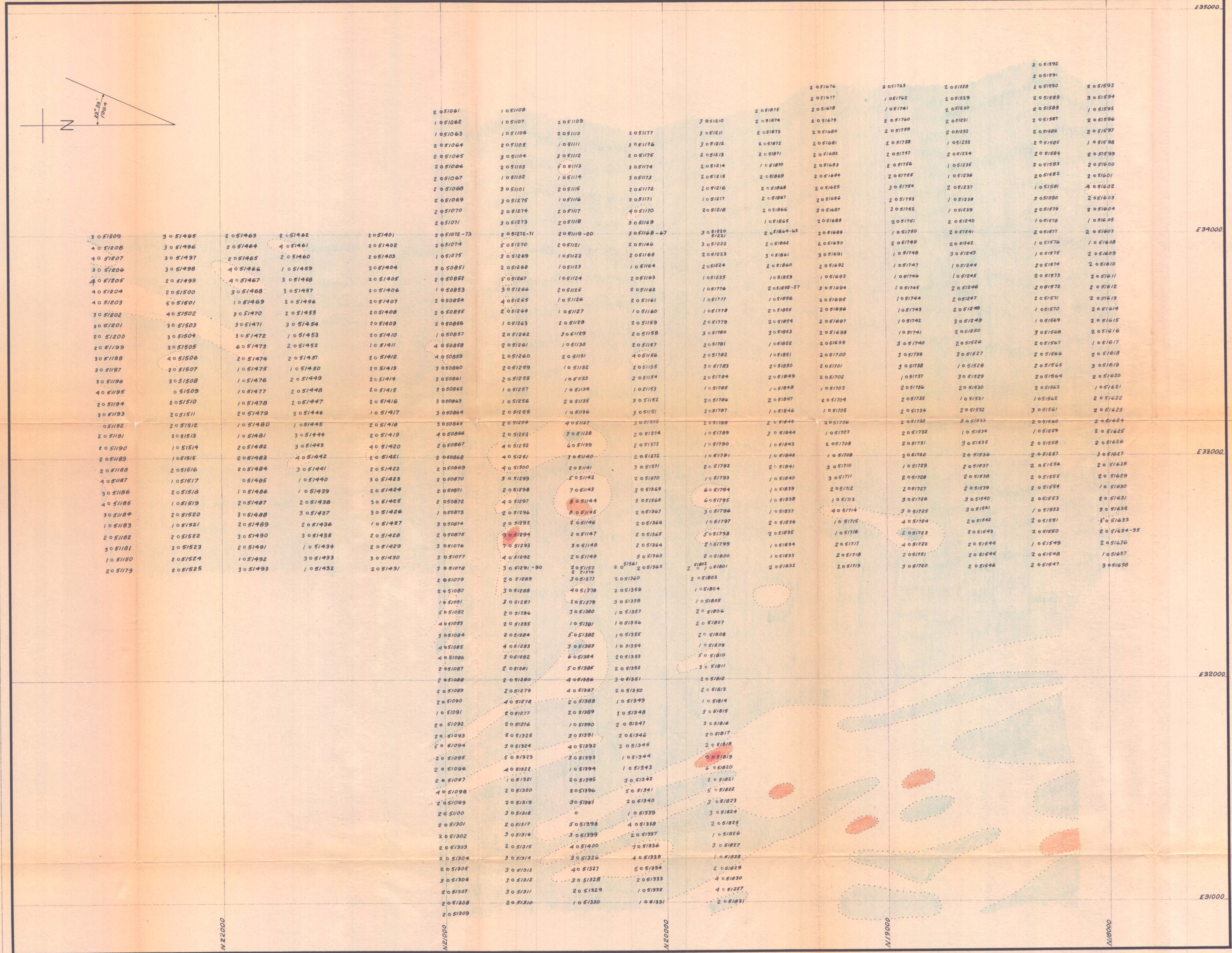
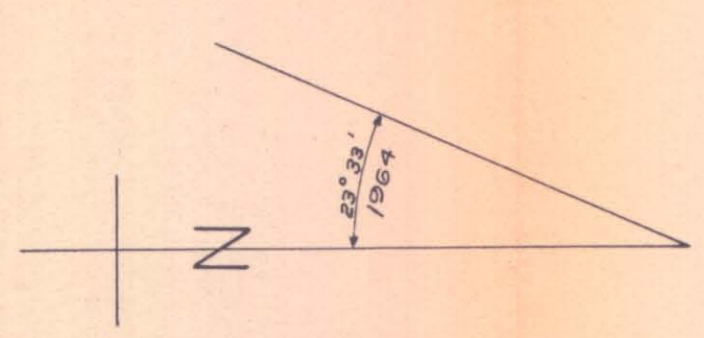

**LEGEND**

- 1 - 0 - 0.4 ppm
  - 2 - 0.4 - 0.8 ppm
  - 3 - 0.8 - 1.2 ppm
  - 4 - 1.2 - 2.0 ppm
  - 5 - 2.0 - 3.0 ppm
  - 6 - 3.0 - 5.0 ppm
  - 7 - 5.0 - 10.0 ppm
  - 8 - 10.0 - 15.0 ppm
  - 9 - 15.0 - 20.0 ppm
  - 10 - 20+ ppm
- 51631 - Sample number

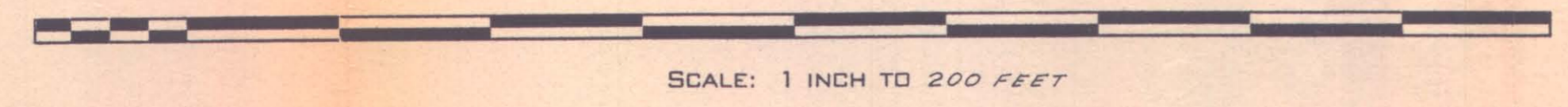

COMPANY . . . FALCONBRIDGE NICKEL MINES LTD.  
 PROPERTY . . . CATFACE COPPER  
 LOCATION . . . MAP 92-F-4, TOFINO, B.C.  
 WORKING PLACE . . . HECATE BAY AREA  
 TYPE OF MAP . . . SOIL SAMPLING PLAN  
 BASED ON . . . WORK BY R.S. McBURNEY  
 DATE . . . 28/8/64  
 DRAWN BY . . . H.S.L.  
 DATE OF WORK . . . APRIL - AUGUST - 1964

580