

D.M.

707

October 28, 1965.

Report on
Independence Property
Situated east of Coquihalla Lakes
At the confluence of New Westminster, Nicola
and Similkameen Mining Divisions.
Province of British Columbia

By: Bethex Explorations Ltd. (N.P.L.)

CONTENTS

	<u>Page</u>
Statement of Qualifications	1
Summary and Conclusions	2
Recommendations	2
Introduction	3
History	3
Exploration Program	3
Geophysical Data	4
Mineral Claims	4
Appendix #1 - Drill Data	5
Appendix #2 - Expenses	

Maps in Folder

- | | |
|---|-------------|
| # / 1. Location Map: Showing drill holes
in relation to
lines and roads | 1" = 1,000' |
| #2 2. Claim Map - includes lines & roads | 1" = 1,000' |
| #3 3. Geology Map | 1" = 1,000' |
| # 4. Geophysical Map - to follow on
receipt | |

Statement of Qualifications of persons employed during the investigation of the F.R.M., Low, and Ponoka groups of Mineral Claims and adjacent Crown Grants in the vicinity of Coquihalla Lakes

1) Diamond drill core logged by:

R.P. Chilcott B. Sc.
University of B. C.

2) Line cutters and assisting in trenching and road building

Gene Stonehocker - Prospector
Melvin DeBriske - Student

3) Supervised by:

C.J. Coveney P. Eng.

SUMMARY AND CONCLUSIONS

Bethex Explorations Ltd. (N.P.L.) owns six (6) mineral claims (Ponoka 1-6) and holds options on ninety-three (93) located claims and four (4) Crown Grants from Fort Reliance Minerals Ltd. These claims are located east of, and surrounding Coquihall Lakes, thirty-seven (37) road miles south of Merritt near the abandoned Kettle Valley line of the C.P.R.

Access is by a secondary road which follows the Coldwater River from Merritt and the Trans-Mountain Oil Pipe Line from Merritt for thirty-seven (37) miles. From here a road was constructed to the camp for three (3) miles to by-pass the old road put in by Fort Reliance, as this road proved impassible most of the summer, even for 4-wheel drive.

An exploration program costing about \$35,000.00 was conducted over these claims from July 15th, to October 31st, 1965. About seven (7) miles of road were constructed on and around the property for access to anomalies, drill sites, etc. and some 28,000 cubic yards of material were moved, including trenching.

An I.P. Survey was run by Huntec over 73,000 line feet and three (3) anomalies outlined. The results of this survey governed the locations of the first three (3) holes. The fourth hole is being drilled to test the mineralized crushed zone at depth near the adit.

As was determined before Bethex took an option on the property, a geochemical or geophysical survey was necessary to outline any more interesting areas apart from those already drilled and tested by surface geology along the contact zone.

The I.P. Survey was chosen for the detail which could be obtained, but to date, the follow-up drilling has not been encouraging.

RECOMMENDATIONS

After the fourth hole near the adit has been drilled, the information obtained will be compared with that of the first three holes and past drilling by Fort Reliance to determine whether further work is justified at this time.

It appears now, that the mineralized crushed zone at the adit is the only area of interest in a younger quartz porphyry along the Nicola-Greenstone - Eagle Granodiorite contact.

INTRODUCTION

The geology of the Independence area has been thoroughly studied before this, and because of this prior work, this report deals with diamond drilling results and the Induced Polarization Survey.

The results of the I.P. Survey have not been received, but will be forwarded to accompany this report in about two weeks.

The drill holes were located by verbal instructions from the geophysicist who conducted the survey.

HISTORY

The nucleus of this property is four (4) Crown Granted claims owned by Fort Reliance Minerals Ltd. These claims were first staked about 1900 and have had intermittent work done on them ever since then.

Numerous trenches and cuts are scattered over the Crown Grants and close to 1,000 feet of underground work was done on the Independence Crown Grant.

Ninety-three (93) located claims (plus 6 staked by Bethex) cover the contact zone for a distance of about 3 1/2 miles.

EXPLORATION PROGRAM

The last half of July and most of August was spent on road construction to various areas of the property and a main access road to Coquihalla.

The D-6 "cat" was used to construct most of the 73,000 feet of line as this proved faster and more effective than hand-cut lines.

Stripping was done over various interesting areas including clearing out the portal entrance. Stripping was also done over the anomolous areas outlined by I.P. Survey and the bulldozer was also used to extend lines where necessary to cover the anomalies completely.

GEOPHYSICAL DATA

This information in detail will be forwarded in about two weeks, as soon as it is received from Lockwood Survey in Toronto.

MINERAL CLAIMS

All mineral claims in the F.R.M. and Low groups are held by Fort Reliance Minerals Limited.

The expiry dates are as follows:

F.R.M. #1-60	October 29th, 1965
F.R.M. #1 Fr	October 21st, 1966
Low #1-32	November 4th, 1965

The following is a list of Crown Grant claims held by Fort Reliance Minerals Limited.

Bank	L1695
Butte	L1694
Independence	L1696
Homestead	L1697

All mineral claims in the Ponoka Group are held by location by Bethex Explorations Ltd. (N.P.L.)

The expiry dates are as follows:

August 12th, 1966

Signed:

R.P. Chilcott

Supervised by:

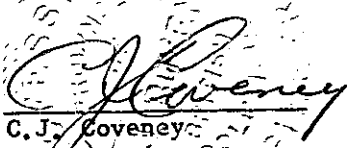
C. J. Coveney

For: Bethex Explorations Ltd. (N.P.L.)

Appendix D1

1	Drill Hole #1 - Section showing assays	1" = 40'
2	Drill Hole #1 - Plan	1" = 40'
3	Drill Hole #1 - Drill Log	
4	Drill Hole #2 - Section showing assays	1" = 40'
5	Drill Hole #2 - Plan	1" = 40'
6	Drill Hole #2 - Drill Log	
7	Drill Hole #3 - Section showing assays	1" = 40'
8	Drill Hole #3 - Plan	1" = 40'
9	Drill Hole #3 - Drill Log	

Information on Drill hole #4 to follow on completion of hole.

Independence Group

Coguihalla Area

D.D.H. # 1 L. 373' -60°

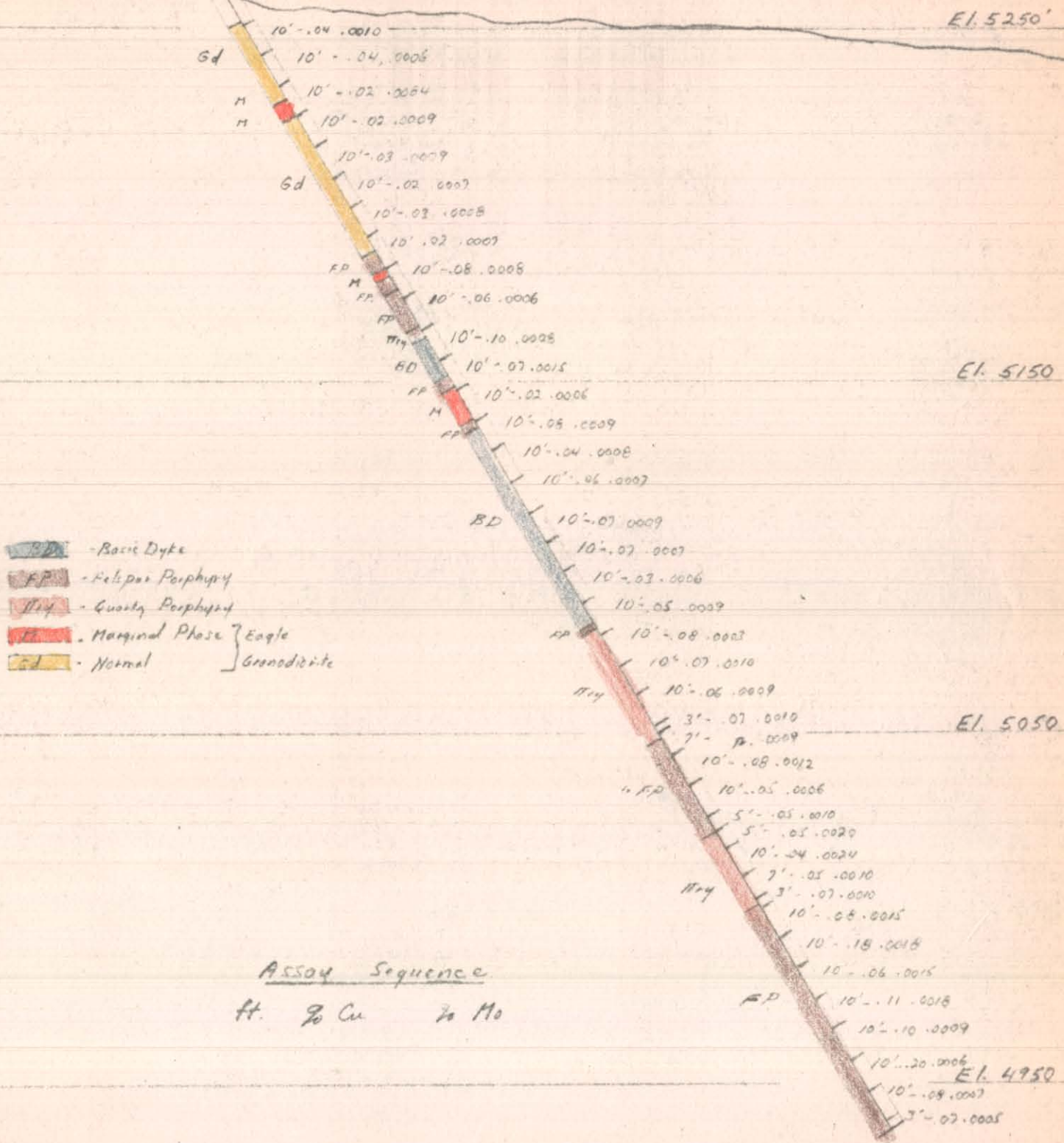

Section looking North
 Hole No. 1 No1
 Scale 1" = 40' R.P.C.

Independence Group

Coquihalla Area

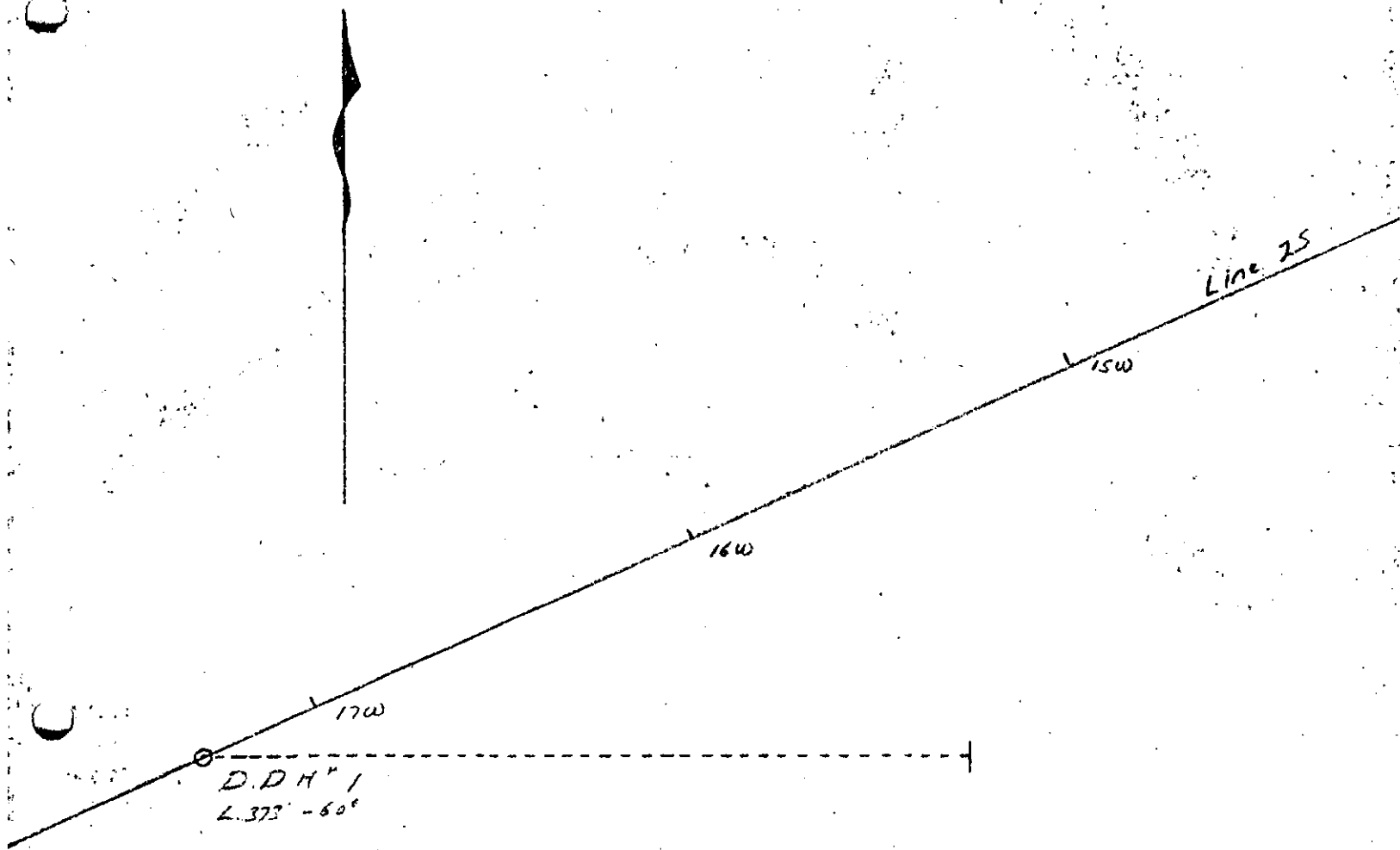

Drill Plan

Hole No. 1

Scale 1" = 40' R.P.C.

No. 2

Independence Group
Cogitalla Area

D.D.H. #2
L. 429'
-60°

- FP - Felspar Porphyry
- TP4 - Quartz Porphyry
- GSA - Greenstone-Andesite
- GS - Schistose } Nickel
- GB - Basic } Nickel

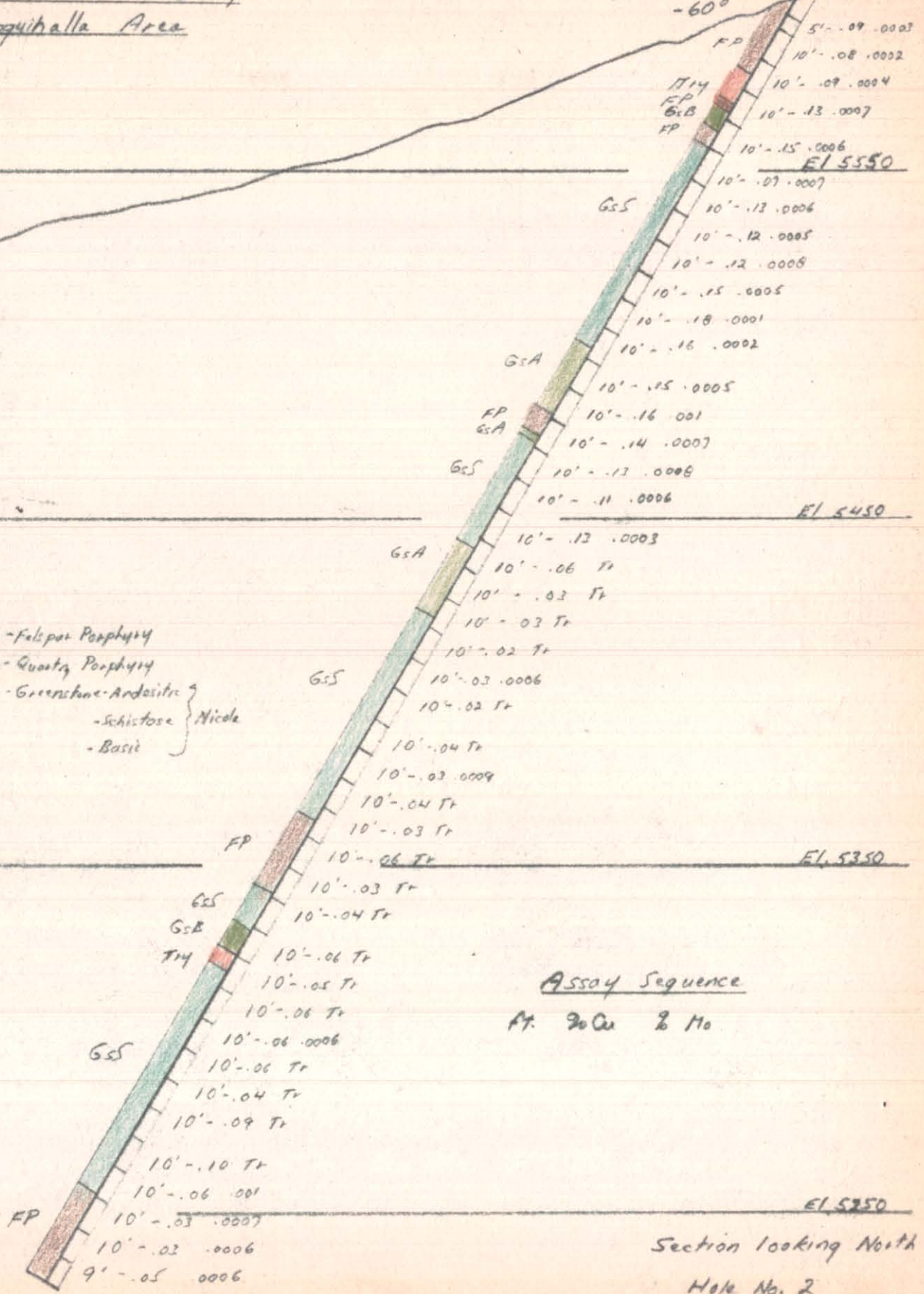

El 5550

El 5450

El 5350

El 5250

Assay Sequence

At. % Cu & Mo

Section looking North

Hole No. 2

Scale 1" = 40' R.P.C.

No. 4

DIAMOND DRILL RECORD

PROPERTY Independence HOLE NO. 1
 SHEET NUMBER 1 SECTION FROM _____ TO _____ STARTED Sept 2/65
 LATITUDE 25 DATUM _____ COMPLETED Sept 28/65
 DEPARTURE 17430' EV BEARING East ULTIMATE DEPTH 373
 ELEVATION 5260 DIP -60° PROPOSED DEPTH 750

Depth Feet	Formation	Sample No.	Width Sample	Gold \$	Sludge Gold \$
0-8 1/2	Casing - No Cor.				
8 1/2-34	Eagle Granodiorite - fresh - coarse				
34-39	" " - marginal phase - broken at 34' & 39'				
39-83	Eagle Granodiorite - 303 matrix - coarse biotite and hornblende crystals, limonite and chlorite in occasional fractures.				
83-89	Quartz-felspar-biotite porphyry. Fine pyrite flecks at 83', 85' tan coloured. (Q.F.B. Porphyry).				
89-91 1/2	Marginal (Phase) Eagle Granodiorite contains talc and chlorite - light green.				
91 1/2-96 1/2	Grey black Q.F.B. porphyry - chalc. sulfides in slips. Felspar phenocrysts.				
96 1/2-108	Grey black Q.F.B. porphyry - Calcite bands throughout. Chlorite bands 97-101 1/2' chalc. Pnct.				
108-112	Grey Q.F.B. porphyry -				
112-124 1/2	Basic porphyry - dyke? chlorite & limonite in slips. Broken at 124'				
124 1/2-128	Grey-black Q.F.B. porphyry - Key line.				
128-139	Broken marginal Eagle Granodiorite				

Drilled by Boyles Bros.

Signed R.P. [Signature]

DIAMOND DRILL RECORD

PROPERTY Independence HOLE NO. 1
 SHEET NUMBER 2 SECTION FROM _____ TO _____ STARTED Sept 23/65
 LATITUDE 25 DATUM _____ COMPLETED Sept 28/65
 DEPARTURE 17 + 30' EU BEARING East ULTIMATE DEPTH 373
 ELEVATION 5260 DIP -60° PROPOSED DEPTH 350

Depth Feet	Formation	Sample No.	Width Sample	Gold \$	Sludge Gold \$
139-141	Grey Q.F.B. porphyry - Pyrite bands @ 139				
141-206	Very coarse waste - dyke? Highly chloritized and broken - 80% recovery Fine pyrite and chalc.				
206-207 1/2	Grey feldspar porphyry.				
207 1/2-243	Black Q.F.B. porphyry.				
243-250	Pyrite @ 243' - Q.F.B. Porphyry - Grey.				
250-274	Black-brown Q.F.B. Porphyry. Calcite bands. Broken at 254' Pyrite blocks				
274-297	Quartz porphyry - chalc. & pyrite bands Fine matrix - Very coarse Quartz.				
297-373	Banded basic & black Q.F.B. Pyrite and Chalcite throughout. Hematite band @ 324' Bands 40-50' to core. Hematite bands 355-359. Broken 370-372 & chloritized.				
	90% Recovery over hole.				

Drilled by Boules Bros

Signed R.P. [Signature]

Independence Group

Coguihallo Area

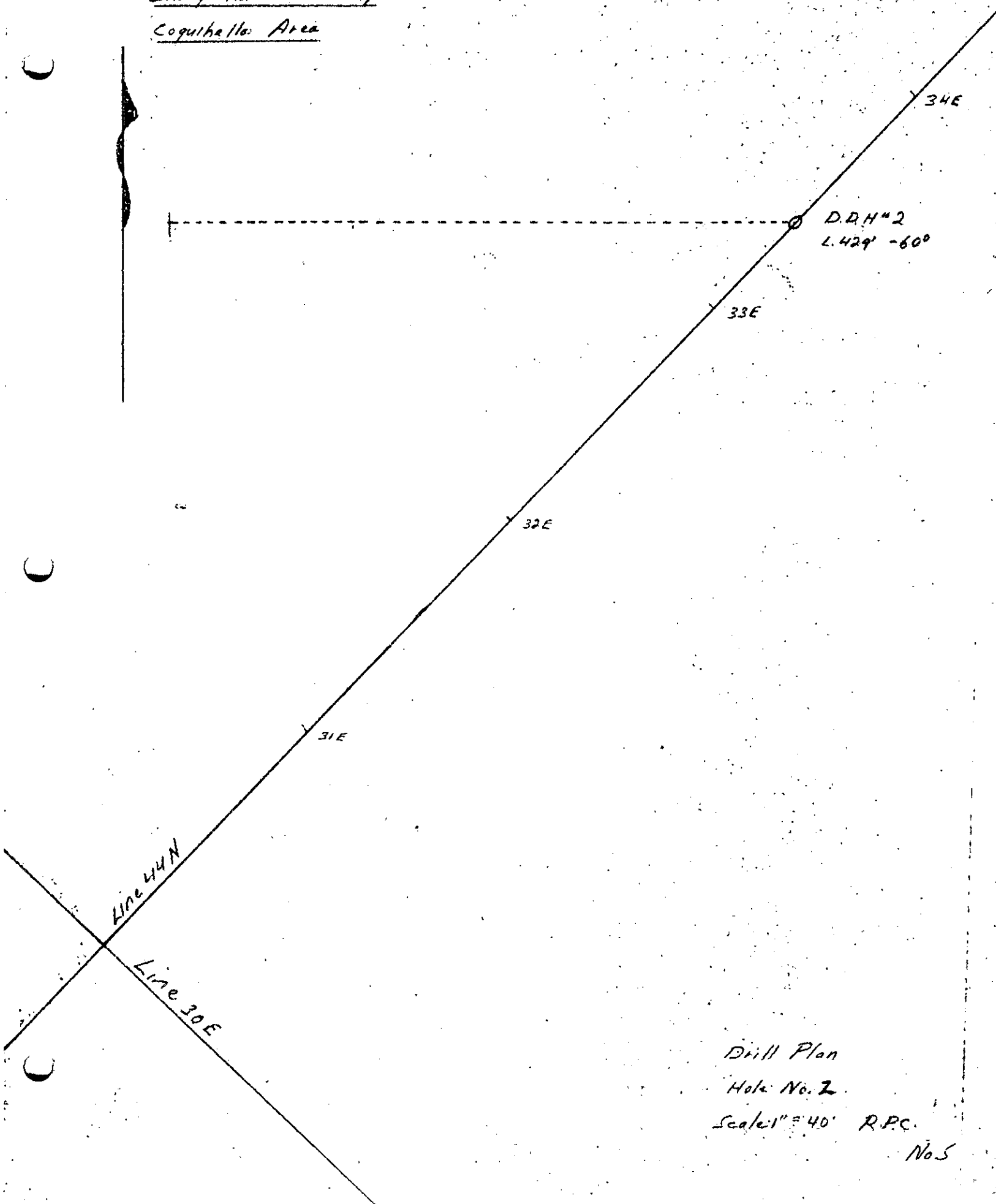

Drill Plan
Hole No. 2
Scale 1" = 40' R.P.C.
No. 5

DIAMOND DRILL RECORD

PROPERTY Independence HOLE NO. 2

SHEET NUMBER 1 SECTION FROM _____ TO _____ STARTED Oct 4/65

LATITUDE 33+40 E DATUM _____ COMPLETED Oct 14/65

DEPARTURE 44N BEARING West ULTIMATE DEPTH 429

ELEVATION 5600 DIP -60° PROPOSED DEPTH 450

Depth Feet	Formation	Sample No.	Width Sample	Gold \$	Sludge Gold \$
5-25	Light Grey Q.F.B. porphyry - 60% mafic Chlorite bands at 11', 14', 22' - 60% recovery				
25-35	Grey-black feldspar porphyry - highly silicified - 60% recovery				
35-38	End Fine grey-black feldspar (andesite) porphyry - 60% recovery				
38-44	Spinel greenstone - basaltic phase - Rusty @ 42'				
44-49	Grey-black feldspar (andesite) porphyry				
49-117	Schistose greenstone - 60% recovery Broken & blocky Rusty @ 94'. Fine pyrite @ 113'				
117-139	Cherty and blocky - 60% recovery Pyrite @ 123'				
139-146	Andesitic feldspar porphyry. Pyrite @ 150'				
146-148	Cherty and blocky				
148-183	Schistose greenstone. Pyrite along slip				
183-207	Broken @ 196 - fault? Andesitic greenstone 60% recovery @ 170-200'				
	End of bend case and span recovery @ 207'				
207-275	Pale schistose greenstones				
275-299	Feldspar (andesite) porphyry.				

Drilled by Boyles Bros. Signed R. P. [Signature]

DIAMOND DRILL RECORD

PROPERTY Independence HOLE NO. 2
 SHEET NUMBER 2 SECTION FROM _____ TO _____ STARTED October
 LATITUDE 33 140 E DATUM _____ COMPLETED Oct 14 1965
 DEPARTURE 44 N BEARING West ULTIMATE DEPTH 429
 ELEVATION 5600 DIP -60° PROPOSED DEPTH 450

Depth Feet	Formation	Sample No.	Width Sample	Gold \$	Sludge Gold \$
299-318	Finely schistose greenstone - Pyrite stringers @ 311'				
311-318	Basaltic greenstone				
318-324	Broken @ 318-319. Fed area of E.P. porphyry				
324-398	Finely schistose greenstone. Highly chloritized @ 333' and @ 340' & 346'. Pyrite bands throughout. Especially chloritized 354-398 and fractures readily at contact.				
398-429	Felcifer porphyry - coarse. Occasional fine pyrite - 10% matrix				
	429' - end of hole.				
	99% recovery 207-429'				

Drilled by Boyle Bros

Signed R. [Signature]

Independence Group

Coquihalla Area

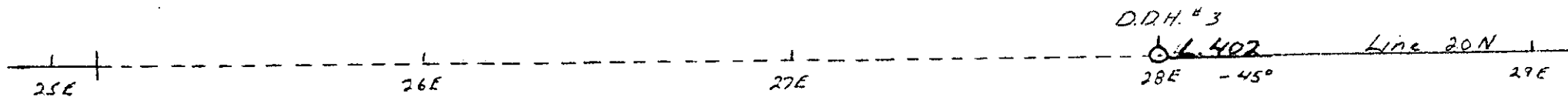

Drill Plan
Hole No. 3.
Scale 1"=40' R.P.C.

Independence Group
Coguihalla Area

D.D.H. # 3

L. 402
- 45°

- FP Felspar Porphyry
- Trq Quartz Porphyry
- GsA Greenstone - Andesitic
- GsB -schistose } Nicola
- GsC -Basaltic }

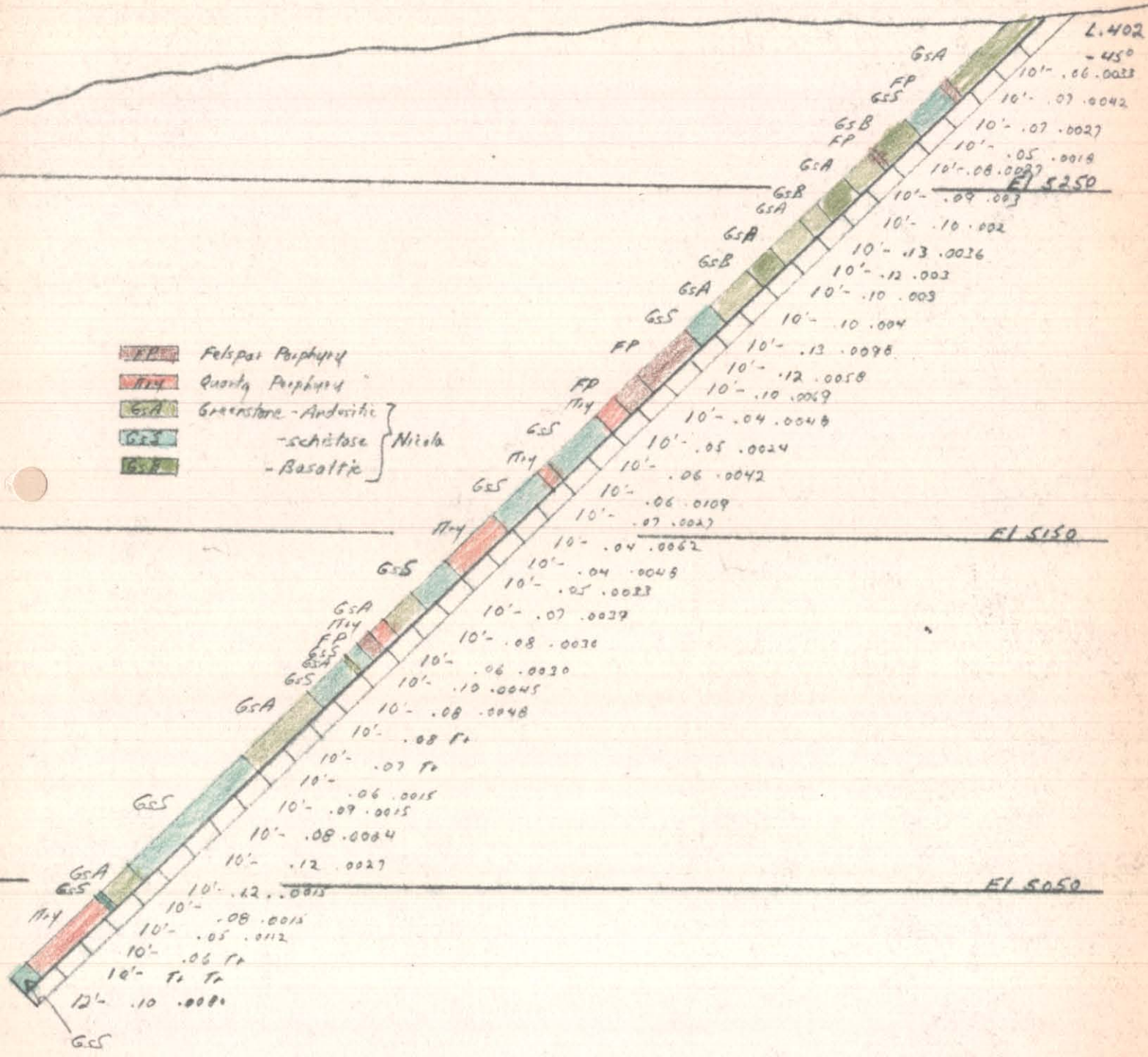

Section looking North
Hole No. 3
Scale 1" = 40' R.P.C.
No. 7

DIAMOND DRILL RECORD

PROPERTY IndependenceHOLE NO. 3SHEET NUMBER 1

SECTION FROM _____ TO _____

STARTED Oct 18/65LATITUDE 28+00E

DATUM _____

COMPLETED Oct 23/65DEPARTURE 20NBEARING WestULTIMATE DEPTH 402'ELEVATION 5300'DIP -45°PROPOSED DEPTH 400'

Depth Feet	Formation	Sample No.	Width Sample	Gold \$	Sludge Gold \$
17-33	Andesitic greenstone - very rotten and oxidized. Pyrite and some chalcopyrite. 12% recovery 17-25 - Broken to 33' and 36'				
33-36	Hard white felspar. Pyrite and some chalc. stringers.				
36-50	Coarse schistose greenstone 36-41' Fine " " 41-50' Pyrite and chalc. flecks and bands. Calcite and quartz stringers. 60% recovery 36-41'				
50-62	Basaltic greenstone and highly schistose Coarse chalcopyrite in dip.				
62-64	Pink felspar - coarse pyrite in slips.				
64-74	Pale greenstone - calcite stringers. Pyrite flecks - 50% recovery 69-71				
74-85	Dark greenstone and calcite bands Schistose - Pyrite and chalc. flecks.				
85-92	Siliceous greenstone - Pale green Pyrite and chalc. flecks.				
92-103	Dark brown greenstone. Broken @ 97' + 101'				

Drilled by Borges Bros.Signed R.P. [Signature]

No. 9

DIAMOND DRILL RECORD

PROPERTY Independence HOLE NO. 3
 SHEET NUMBER 2 SECTION FROM _____ TO _____ STARTED Oct 16/65
 LATITUDE 28°00'E DATUM _____ COMPLETED Oct 23/65
 DEPARTURE 20N BEARING West ULTIMATE DEPTH 402'
 ELEVATION 5300' DIP -45° PROPOSED DEPTH 400'

Depth Feet	Formation	Sample No.	Width Sample	Gold \$	Sludge Gold \$
105-113	Racaltic greenstone				
113-126	Pale andesitic greenstone Pyrite flecks chds				
126-136	Dark to schistose greenstone				
136-155	Pale watery green felspar porphyry				
155-164	" " " " -schistose and to 155-157 - Pyrite flecks				
164-172 1/2	Pale watery siliceous Q.F.B. porphyry				
172 1/2-192	Dark and schistose - calcite bands @ 35' to hole - pyrite flecks				
192-195	Pale Q.F.B. - grey - pyrite flecks				
195-213 1/2	Dark and schistose greenstone - Pyrite flecks and oxidized @ 196'				
213 1/2-231	Pale brown green Q.F.B. - Pyrite flecks & chcks. Darker at 225-232' Maly? @ 217 & 225'				
231-244	Finely schistose greenstone - Pyrite flecks 232-233. Hackly - Black-green				
244-255	Watery green greenstone. M.S. flecks @ 246' Pyrite bands throughout - Calcite bands				
255-260	Quartz felspar porphyry - grey green & pyritized				
260-265	Felspar porphyry - hard & grey green - pyritized				

Drilled by Borger Bros

Signed R. F. [Signature]

DIAMOND DRILL RECORD

PROPERTY IndependenceHOLE NO. 3SHEET NUMBER 3

SECTION FROM _____ TO _____

STARTED Oct 18/65LATITUDE 28°00'E

DATUM _____

COMPLETED Oct 23/65DEPARTURE 20NBEARING WestULTIMATE DEPTH 402ELEVATION 300'DIP -45°PROPOSED DEPTH 400

Depth Feet	Formation	Sample No.	Width Sample	Gold \$	Sludge Gold \$
265-270	Green-black schistose greenstone - Pyrite & calcite bands				
270-271	Calcite band - cone greenstone				
271-285	Green-black schistose greenstone - Pyritized				
285-311	Andesitic greenstone - Calcified & broken 300-311.				
311-356	Schistose greenstone - Pyritized & calcite bands Quartz vein @ 323', 325', 339'. Pyrite @ 344' Highly schistose @ 343-345.				
356-367	Andesitic greenstone - Epidote bands - Pyrite & chert blocks.				
367-369	Schistose greenstone.				
369-396	QFB porphyry - Pyritized				
396-402	Black schistose greenstone - Pyritized				
	95% recovery over hole.				

Drilled by

Boyer Bros

Signed

R. J. [Signature]

Independence Group

Coquihalla Area

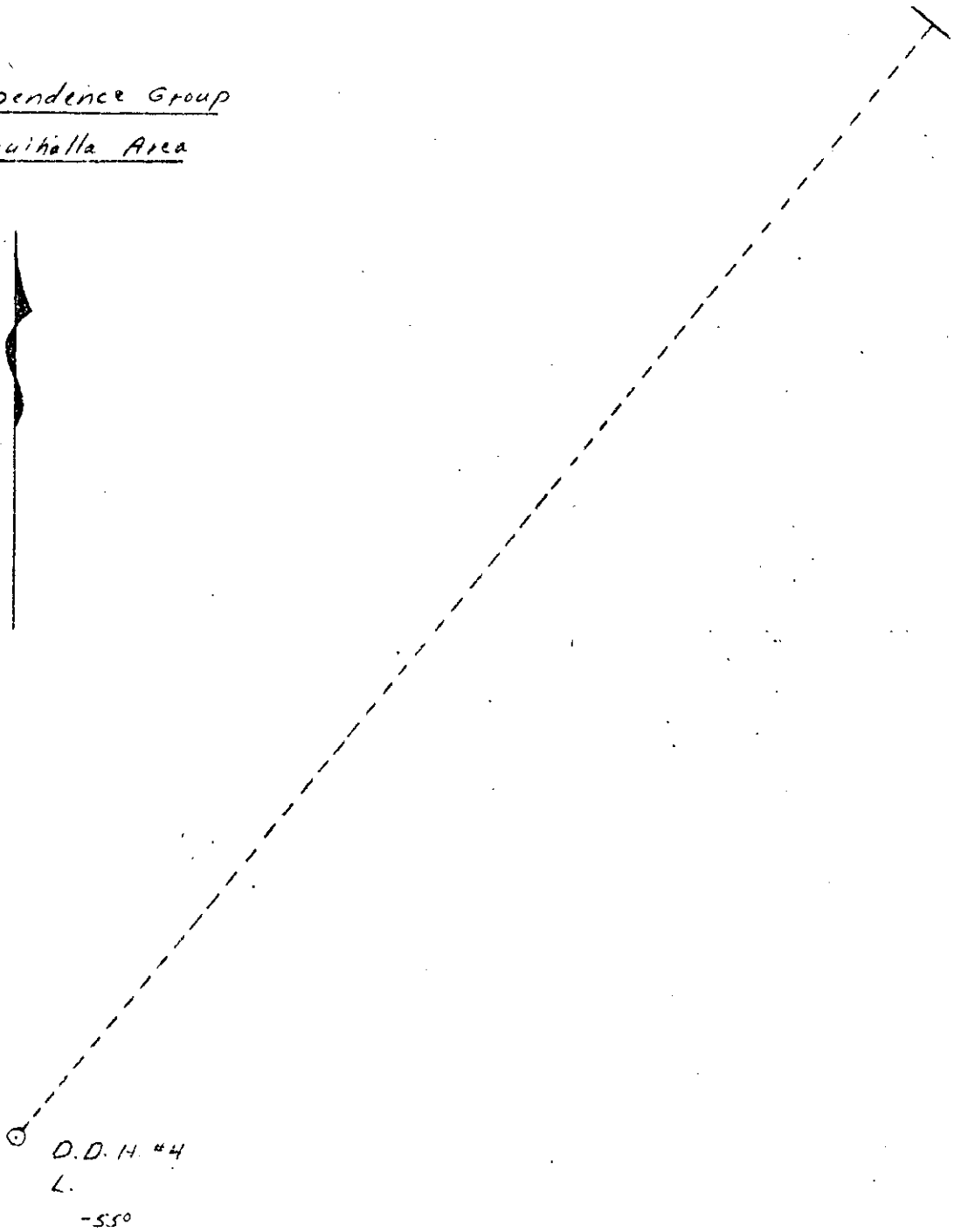

D.D.H. #4
L.
-550

Drill Plan
Hole No. 4
Scale: 1" = 40' P.P.C.

DIAMOND DRILL RECORD

PROPERTY IndependenceHOLE NO. 4SHEET NUMBER 1

SECTION FROM _____ TO _____

STARTED Oct 25/65LATITUDE 16 SE

DATUM _____

COMPLETED Nov 2/65DEPARTURE 9.5NBEARING N40EULTIMATE DEPTH 600ELEVATION 5510'DIP -55°PROPOSED DEPTH 600

Depth Feet	Formation	Sample No.	Width Sample	Gold \$	Sludge Gold \$
0-56	Quartz porphyry - chalc. flecks and brown stain with pyrite. Watery green and less free quartz with depth.				
56-106 1/2	Felspar porphyry - medium grey green.				
106 1/2 - 110	Marginal phase Eagle Granodiorite.				
110-136	Felspar porphyry - some quartz bands & pyrite bands.				
136-144	QFB porphyry - Quartz crystals.				
144-164	Felspar porphyry - some pyrite.				
164-165 1/2	- Basic dyke - 202matic - Pyrite flecks.				
165 1/2 - 220	QFB porphyry - Pyrite flecks. MoS ₂ @ 171'				
220-308 1/2	Felspar porphyry - Silicious 220'-226' MoS ₂ throughout.				
	Broken 232-261, 283 Pyrite @ 261'				
	MoS ₂ @ 233' in vugs.				
	Chalc. @ 283, 298.				
	Basic dyke 305-306, 308 1/2 - 310.				
	Gravel @ 306 1/2.				
310-574	Felspar porphyry - Pyrite & chalc. flecks 334-344. - Pyrite flecks 364-574. Chalc. flecks.				

Drilled by Boyer Bros.Signed R. P. [Signature]

No. 12

DIAMOND DRILL RECORD

PROPERTY Independence HOLE NO. 4

SHEET NUMBER 2 SECTION FROM _____ TO _____ STARTED Oct 25/65

LATITUDE 16.5E DATUM _____ COMPLETED Nov 2/65

DEPARTURE 9.5N BEARING N 40 E ULTIMATE DEPTH 600

ELEVATION 5510' DIP -55° PROPOSED DEPTH 600

Depth Feet	Formation	Sample No.	Width Sample	Gold \$	Sludge Gold \$
	Chalco in vugs @ 490' - 500'				
	Pyrite @ 516', 543' - end of hole.				
	Quartz veinlet @ 537'. Pyrite @ 537'				
	Pyrite in vugs @ 560.				
	Pyrite & Chalco diminish to end.				
	75% recovery over hole.				

Drilled by

Boyer Bros

Signed

R. P. [Signature]

No. 17

Appendix #2

Expenses incurred during the investigation of the F.R.M., Low, and Ponoka mineral claims and various Crown Grant claims on the Independence property, approximately one (1) mile east of the Coquihalla station at the confluence of the New Westminster, Nicola, and Similkameen Mining Divisions.

1) Salaries & Wages: line cutters and core splitting		
E. Stonehocker - July 15th, - October 31st, 1965		
3 1/2 months @ \$ 485.00 per month	\$ 1,697.50	
M. Debriske - July 15th, - September 15th, 1965		
2 months @ \$ 435.00 per month	<u>870.00</u>	\$ 2,567.50
2) Camp costs @ \$5.70 per man-day		
I.P. crew - 4 men for 21 days = 84 man-days	478.80	
Diamond drillers - 6 men for 48 days		
= 288 man-days	1,641.60	
E. Stonehocker = 108 man-days	615.60	
M. Debriske = 62 man-days	353.40	
Bulldozer Operator	<u>359.10</u>	3,448.50
3) Equipment rental - D-8 with rippers		
Road work on property to Coquihalla & stripping		
114 hours @ \$ 25.00 per hour	2,850.00	
D-6 - I.P. lines - 76,000 feet -		
174 hours @ \$ 13.50 per hour	2,349.00	
New access road to Coquihalla -		
200 hours	<u>2,700.00</u>	7,899.00
4) Induced Polarization Survey		7,690.00
5) Diamond drilling to September 30th, 1965		
including gas & oil		2,671.04
Projected 1,233 feet October 1st, - 31st, 1965		
@ \$ 8.00 per foot		9,864.00
6) Maps and blue prints		<u>3.22</u>
	TOTAL	\$ 34,143.26
		=====

Other expense incurred but not applicable to assessment work includes assaying, travelling, lodgings, office, administrative and capital expenses.

Appendix #2

Expenditures incurred during the investigation of the Independence #1 Group of mineral claims, which is comprised of the Low 1-18 inclusive, Low 21, 31, 32, F.R.M. 1-8 inclusive, F.R.M. 10, 11, 13, 14, 16, and Ponoka 1-6 inclusive, situated at the confluence of the New Westminster, Nicola, and Similkameen Mining Divisions.

Work consisted of:

- 1) Construction of a main access road from Coquihalla Lakes to camp and various short access roads to various parts of the property.
- 2) Line cutting and Induced Polarization Survey over the F.R.M. claims.
- 3) A diamond drill hole on the Ponoka #3 and #5 boundary.

The costs of the above investigation to be applied for one (1) years assessment work on the Independence #1 Group are as follows:

1) Wages - line cutting			\$ 1,386.68
2) Camp costs @ \$ 5.70/man-day			
I.P. crew - 43 man-days =	\$	245.10	
Diamond drillers - 144 man-days =		820.80	
E. Stonehocker - 74 man-days =		421.80	
M. Debriske - 40 man-days =		228.00	
Bulldozer operator - 22.2 man-days =		<u>126.54</u>	1,842.24
3) Equipment Rental -			
D-8 - 39.8 hours @ \$ 25.00 per hour	\$	995.00	
D-6 - 131.1 hours @ \$ 13.50 per hour		<u>1,769.65</u>	2,764.65
4) I.P. Survey			4,152.60
5) Diamond drilling			3,151.04
6) Maps and blue prints			<u>3.22</u>
			<u>13,300.43</u>
			=====
		TOTAL	\$ 13,300.43

Appendix #2

Expenditures incurred during the investigation of the Independence #2 Group of mineral claims which is comprised of the Low 19, 20, 22-30 inclusive, F.R.M. 9, 12, 15, 17, 18, 20, 21, 23-25 inclusive, 28, 29, 32, 33, 36, 37, 40, 41, 44, 45, 47, 48, 50, 51, #1 Fr., Butte Crown Grant, Bank Crown Grant, Independence Crown Grant, and Homestead Crown Grant, situated at the confluence of the New Westminster, Nicola, and Similkameen Mining Divisions.

Work consisted of:

- 1) Construction of roads to the main showings on the Crown Grants and trenching and stripping.
- 2) Line cutting and Induced Polarization Survey over the Crown Grants adjoining the F.R.M. claims
- 3) A diamond drill hole on the Bank Crown Grant

The costs of the above investigation to be applied for one (1) years assessment work on the Independence #2 Group are as follows:

1) Wages - line cutting		\$	872.78
2) Camp costs @ \$ 5.70/man-day			
I.P. crew - 37 man-days	\$	210.90	
Diamond drillers - 102 man-days		581.40	
E. Stonehocker - 26 man-days		148.20	
M. Debriske - 16 man-days		91.20	
Bulldozer Operator - 28.2 man-days		<u>160.74</u>	1,192.44
3) Equipment Rental			
D-8 - 52 hours @ \$ 25.00 per hour	\$	1,300.00	
D-6 - 172.9 hours @ \$ 13.50 per hour		<u>2,334.35</u>	3,634.35
4) Induced Polarization Survey			2,614.60
5) Diamond drilling			<u>6,400.00</u>
	TOTAL	\$	<u>14,714.17</u> =====

Appendix #2

Expenditures incurred during the investigation of the Independence #3 Group of mineral claims, which is comprised of the F.R.M. 19, 22, 26, 27, 30, 31, 34, 35, 38, 39, 42, 43, 46, 49, 52-60 inclusive, situated at the confluence of the New Westminster, Nicola, and Similkameen Mining Divisions.

Work consisted of:

- 1) Construction of a road and trenching over an anomaly.
- 2) Line cutting and Induced Polarization Survey over the F.R.M. #34 and #35 claims.
- 3) A diamond drill hole on the F.R.M. #34.

The costs of the above investigation to be applied for one

(1) years assessment work on the Independence #3 Group as follows:

1) Wages - line cutting				\$ 308.04	
2) Camp costs - @ \$ 5.70/man-day					
I.P. crew - 4 man-days	\$	22.80			
Diamond drillers - 42 man-days		239.40			
E. Stonehocker - 8 man-days		45.60			
M. Debriske - 6 man-days		34.20			
Bulldozer Operator - 12.6 man-days		<u>71.80</u>		413.80	
3) Equipment Rental					
D-8 - 22.2 hours @ \$ 25.00 per hour	\$	555.00			
D-6 - 70 hours @ \$ 13.50 per hour		<u>945.00</u>		1,500.00	
4) Induced Polarization Survey				922.80	
5) Diamond drilling				<u>2,984.00</u>	
TOTAL				\$ 6,128.64	=====

Independence Group

Coquihalla Area

D.D.H. #4 L.

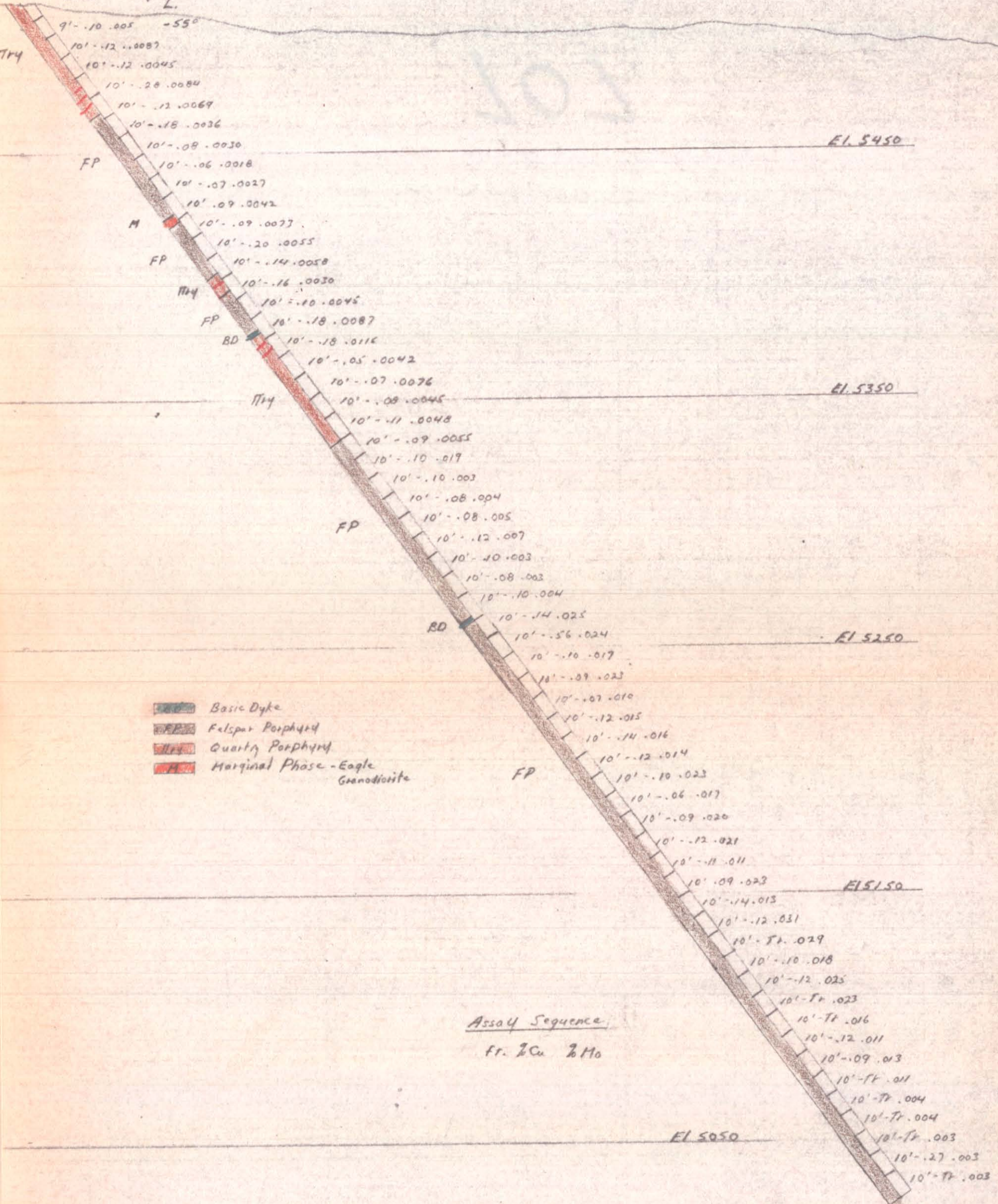

707

Section looking N40E

Hole No. 4

Scale: 1" = 40' R.P.C.

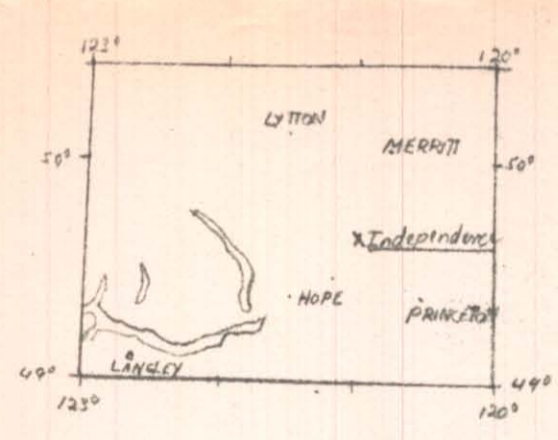

Location Key

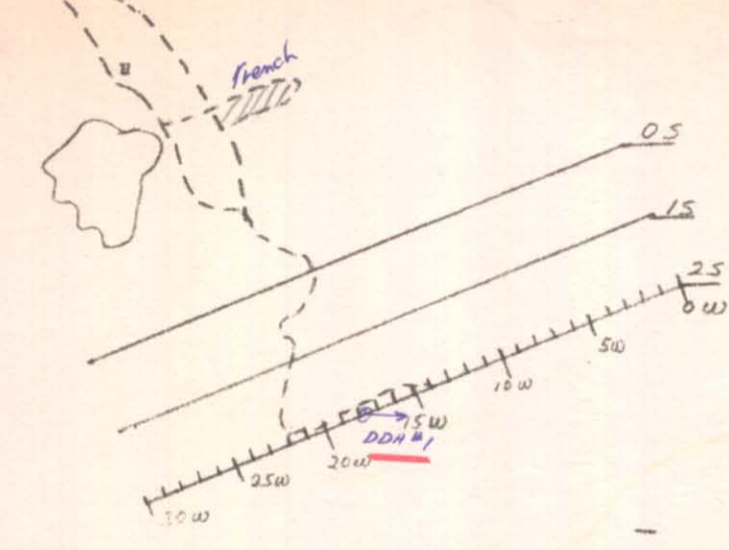

Independence Area
 Induced Polarization Grid
 Showing roads, trenches &
 Drill Hole Locations.
 Scale: 1" = 1000' Oct 28, 1965
 R.P.C.

Department of
 Mines and Petroleum Resources
 ASSESSMENT REPORT
 NO. **707** MAP #1

R.P. Chilcott
707
 No. 1 I.P. Lines

To accompany Geological and Geophysical Report by R.P. Chilcott on the low, F.R.M., Ponoka and various Crown Grants 3/4 mile east of Coquihalla Station at the confluence of Nicola, New Westminster and Similkameen Mining Divisions

Dated: October 28TH, 1965

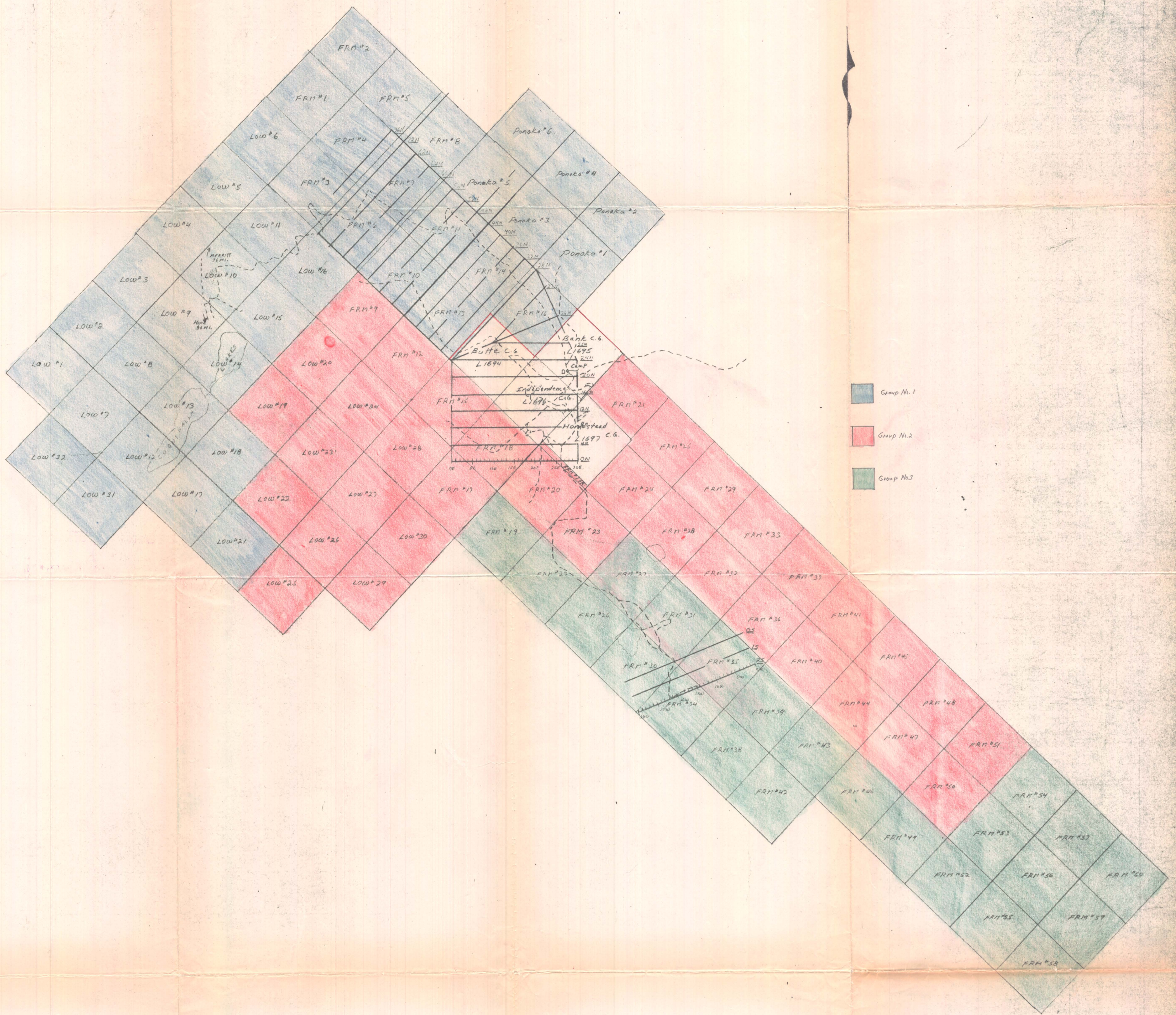

Claim Map: Includes, roads,
Trenches, and I.P. Grid
Independence Property
Cephalite, B.C.
1"=1000' Oct 6, 1965
Drawn by: R.P. Chilcote
R.P. Chilcote

To accompany Geological and Geophysical Report by
R.P. Chilcote on the Low, FRM, Ponoka and various
Crown Grants 3/4 mile east of Cephalite Station at
the confluence of Nicola, New Westminster, and
Similkameen Mining Divisions.

Dated: October 28th, 1965

No. 2 Claims

Department of
Mines and Petroleum Resources
ASSESSMENT REPORT
NO. 707 MAP #2

707

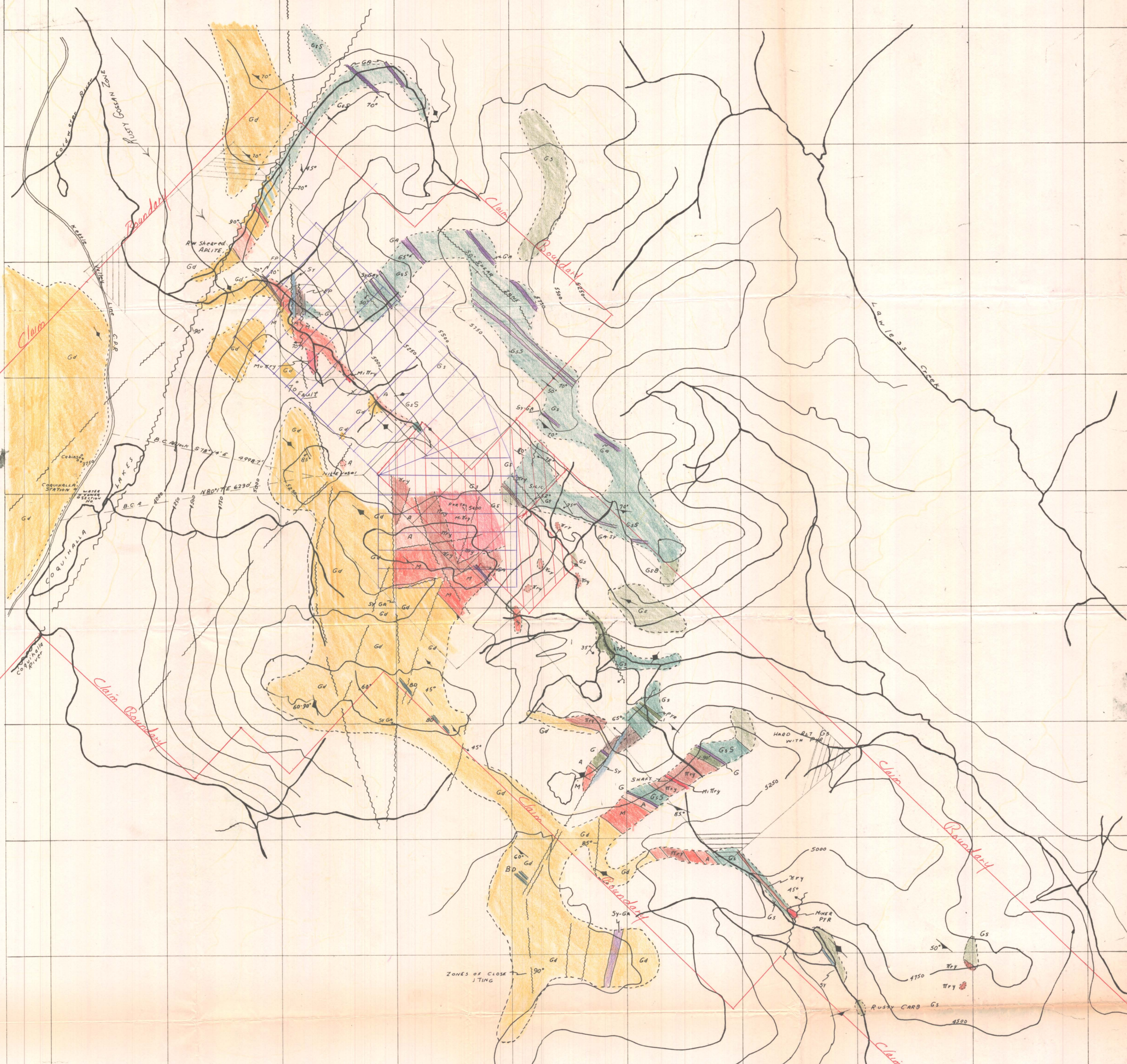

LEGEND

GLACIAL CLAY & GRAVEL	CL	
BASIC DYKES	GD	
FELSPAR PORPHYRY	FP	
QUARTZ	M. TRY	MINERALIZED
"	F. TRY	FRESH
SYENITE	SY	
GABBRO-SYENITE	SY-GA	
GABBRO	GA	
EAGLE GRANODIORITE		
MARGINAL PHASE	M	A
NORMAL	Gd	ARLITE
NICOLA GREENSTONES		
ANDESITIC	GSA	
SCHISTOSE	GSS	
BASALTIC	GSB	
Gid Lines		
MAJOR FAULTS	KNOWN	ASSUMED
FRACTURE ZONES		
GEOLOGIC CONTACTS		
FLOW LAYERS	INCLINED	VERTICAL
SCHISTOSITY		
JOINTS		
OUTCROP AREAS TRAVERSED		

To accompany Geological and Geophysical Report by R. P. Chilcote on the low, F.R.M., Penoka and various Crown Grants 3/4 mile east of Coquihalla Station at the confluence of Nicola, New Westminster, and Similkameen Mining Divisions.

Dated: October 28th, 1965

R. P. Chilcote

COMPANY ST. EUGENE WORKING PLACE SURFACE (BASED ON AIRPHOTOS BC 345.93 & 345.64 X 2 DIAM.) DATE JAN. 1951
 PROPERTY INDEPENDENCE TYPE OF MAP GEOLOGY & TOPOG. DRAWN BY AS & JAR.
 LOCATION COQUIHALLA, B.C. MAP No. 17.9

— Located Claim Boundary □ □ □ Crown Grants

Department of
Mines and Petroleum Resources
ASSESSMENT REPORT
No. 707 MAP #3

SCALE 1" = 1000'

No. 3-Geology
707