

812

INDUCED POLARIZATION SURVEY
on the
KINGFISHER, DODGE & PAR Mineral Claims
Lat. $49^{\circ} 34'$, Long. $118^{\circ} 21'$, Franklin Area
Similkameen M. D., B. C.
Survey Date-May 28-31st, 1966
Report By:S. A. Mouritsen, P. Eng., dated
August 10, 1966.

82E/9W

geofax surveys ltd.

803, 628 - 17 AVE. S.W., CALGARY, ALBERTA

TELEPHONE 264-6420

INDUCED POLARIZATION SURVEY on the FRANKLIN AREA CLAIMS

for

J. A. McDOUGALL
GRAND FORKS, B.C.

GEOFAX SURVEYS LTD.



S. A. Mouritsen

August 10, 1966.

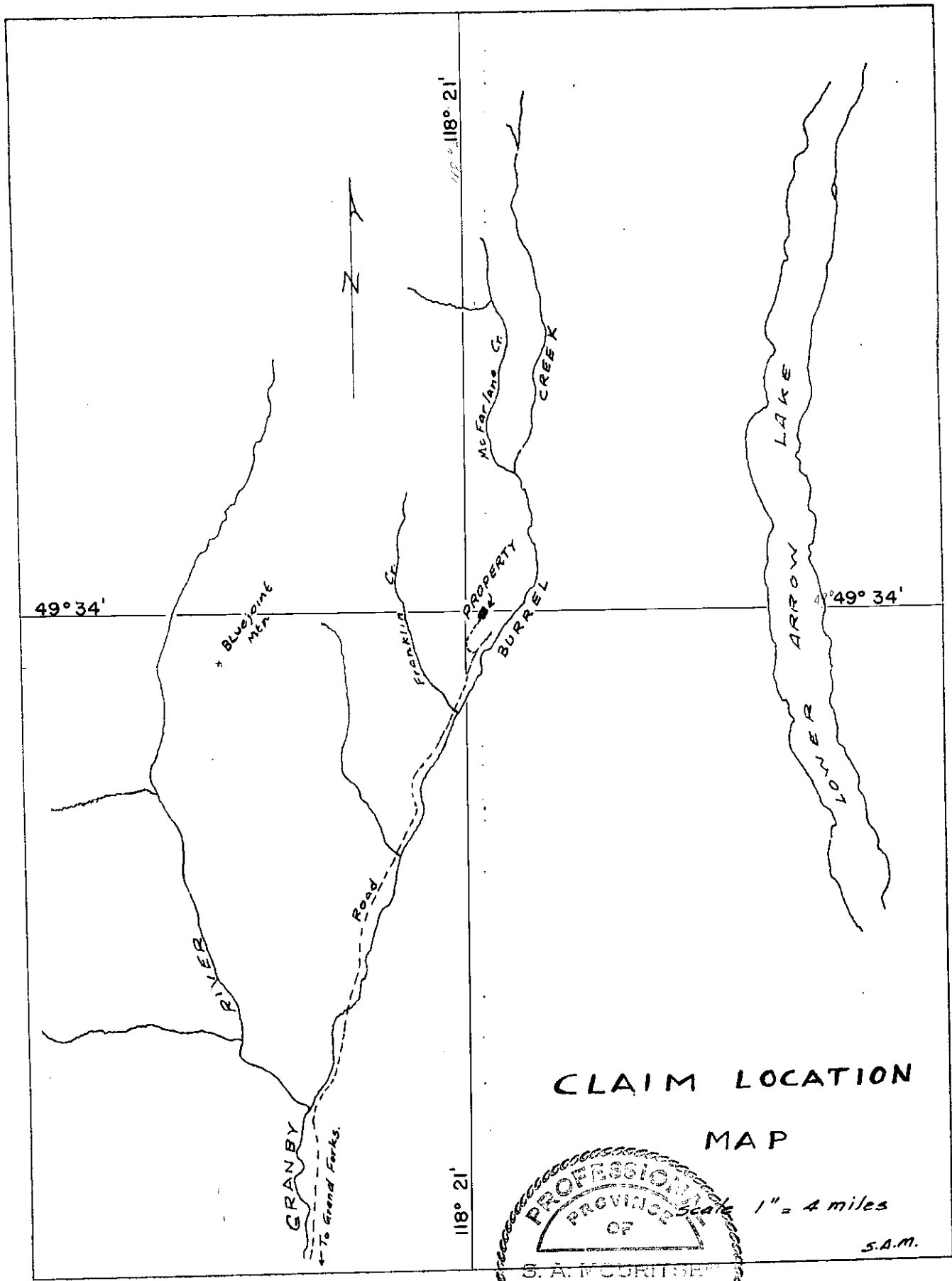

**CLAIM LOCATION
MAP**

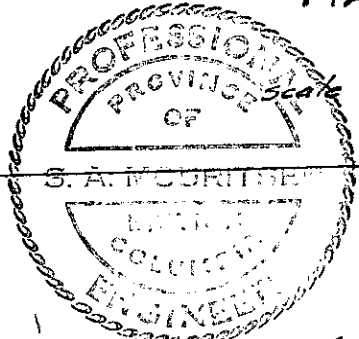

Scale 1" = 4 miles

S.A.M.

Expire Date August 3, 1996

INTRODUCTION

The Franklin claims lie above the west bank of the Burrell creek in the Franklin area and are approximately fifty-three miles north of Grand Forks along the "North Fork" road. The area has for many years been of interest to the mining industry. Activity first started around the turn of the century.

ACCESS

The area is readily accessible by a gravel road up the Grandby River and Burrell creek. A jeep can be driven right on to the property.

PROPERTY

The property consists of three claims:

Kingfisher	M. C. Record No. 13036
Dodge	M. C. Record No. 13037
Par	M. C. Record No. 13038

INSTRUMENTATION and FIELD PROCEDURE

A Huntec 2.5 Kw pulse-type Induced Polarization set was used to make the survey. The main spacing used between electrodes was 200 feet with 100 foot and 400 foot check spacings. The grid was laid out by compass and chain. The crew consisted of five men and camp was located at the old Union Mine site. Four lines were surveyed. Interpretation was done at our Calgary office.

RESULTS OF THE SURVEY

The area surveyed proved to be very anomalous. Excellent I.P. anomalies were centred at the intersection of lines X-1 and Line M

and at station 9 on Line M. These anomalies are indicative of sulphide mineralization and warrant additional exploration. The reading on station 9 Line M is extremely high and is possibly indicative of massive or near massive mineralization. This reading was checked twice by both operators and was found to be correct.

The I.P. anomalies differ in location from the main surface workings and would indicate that the exploration that pre-dated the I.P. survey was not advantageously located.

RECOMMENDATIONS

The following recommendations are a direct result of the I.P. survey.

1. Additional I.P. lines should be run to accurately determine the strike of the anomalies.
2. Drilling should be carried out to determine the size and grade of possible ore bodies underlying the I.P. anomalies.

COST ESTIMATE (Additional Work)

I.P. Survey (4 days @ \$325)	\$ 1,300.00
Drilling (2400 feet @ \$8)	19,200.00
Camp cost and board	200.00
Supervision and logging	2,500.00
Head Office	<u>500.00</u>
	\$ 23,700.00

CONCLUSIONS

1. The I.P. survey indicated good mineralization on that portion

of the claims surveyed.

2. Additional exploration is warranted.

MAPS SUBMITTED

1. Plot of I.P. profiles. *# 3*
2. Contoured map on maximum chargeability. *# 2*

Respectfully Submitted,

GEOFAX SURVEYS LTD.

S. A. Mouritsen P. Eng.

S. A. Mouritsen.

SAM/gs

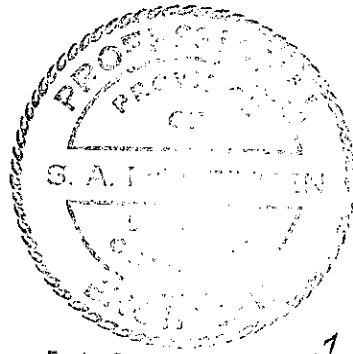

Expiry Date: August 4, 1968¹

712

geofax surveys ltd.

803, 628 - 17 AVE. S.W., CALGARY, ALBERTA
TELEPHONE 264-6420

June 15, 1966.

STATEMENT

J. A. McDougall,
Grand Forks,
B. C.

Induced Polarization Survey of the Franklin Area
Claims, May 28 - 31st.

4.25 eight hour days @ \$285 per eight hour day, survey with Huntex-type unit and two operators, property visit by qualified geophysicist during survey and final report	\$1,211.25
Casual labour, 2 men - 2 days @ \$20/day/man	80.00
Living expenses	42.74
Field supplies	1.87
	<hr/>
	\$1,335.86

*Paid
SAM*

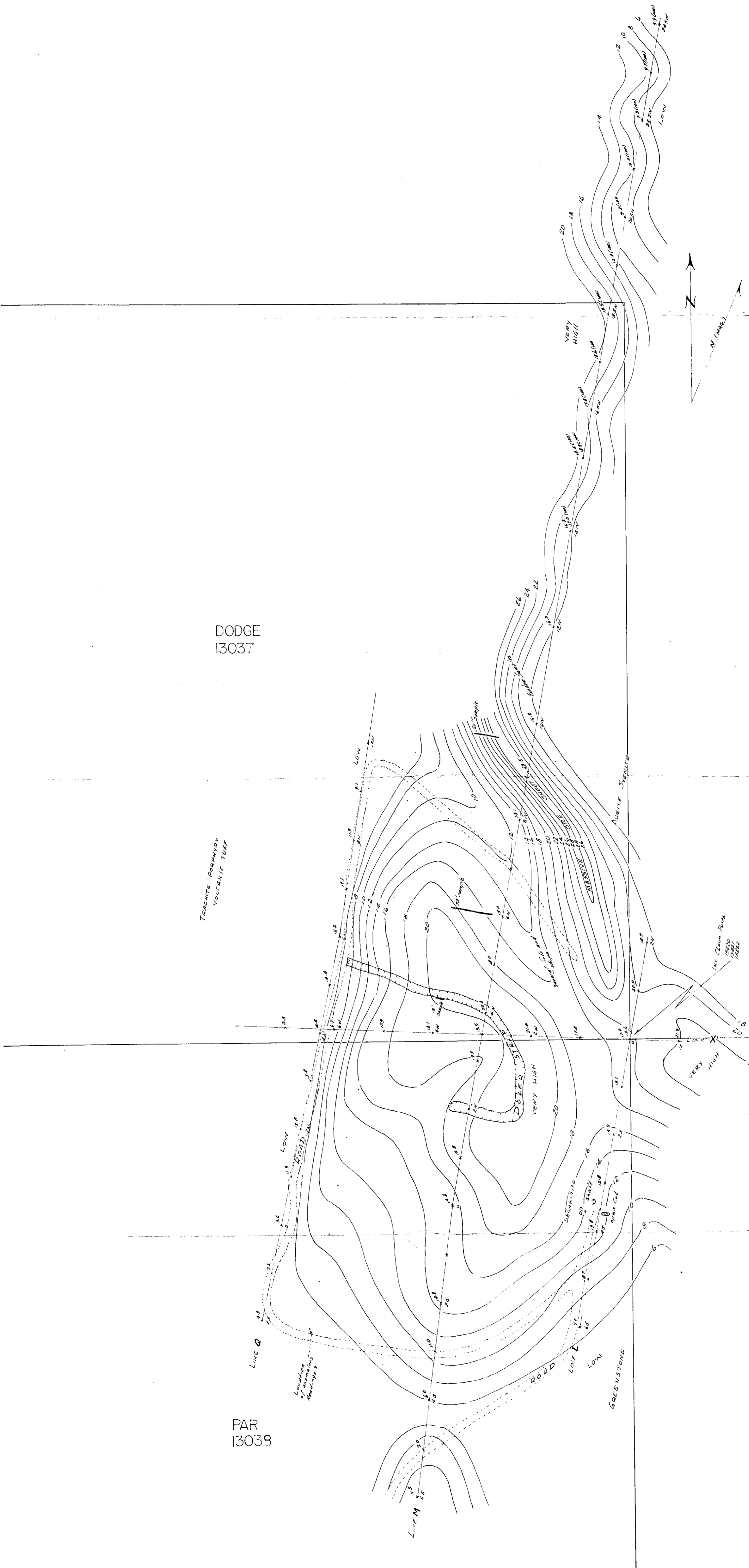

KINGFISHER
13036

Department of
Mines and Petroleum Resources
ASSESSMENT REPORT
NO. 812 MAP # 2

I.P. SURVEY
CHARGEABILITY CONTOUR MAP
KINGFISHER CLAIMS
FRANKLIN DISTRICT B.C.
CONTOUR INT - 2 MSEC.

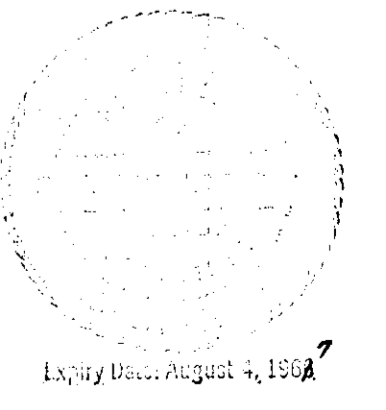

Scale 1"=1000' S.A. Mauritsen P.Eng.
To Accompany Written Report by S.A. Mauritsen, P.Eng.,
on the Kingfisher, Dodge & Par Claims, Franklin Area,
Similkameen M.D., dated August 10, 1966.



812

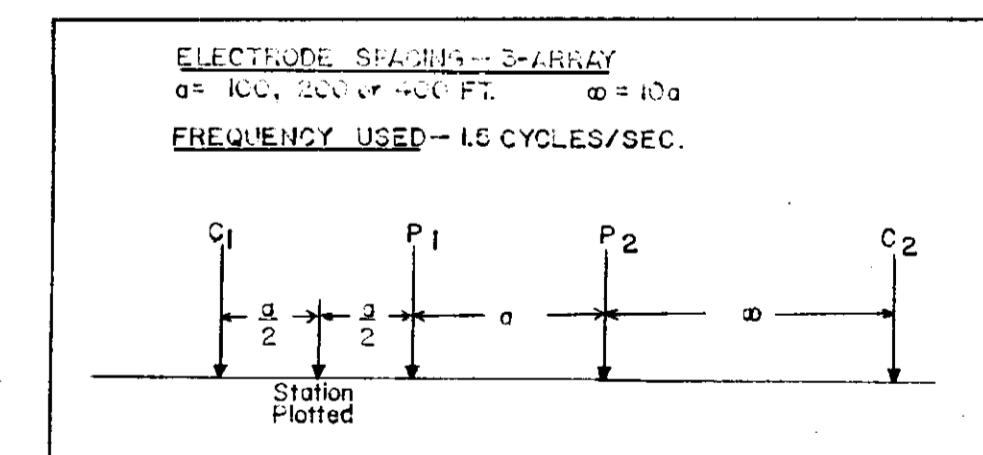
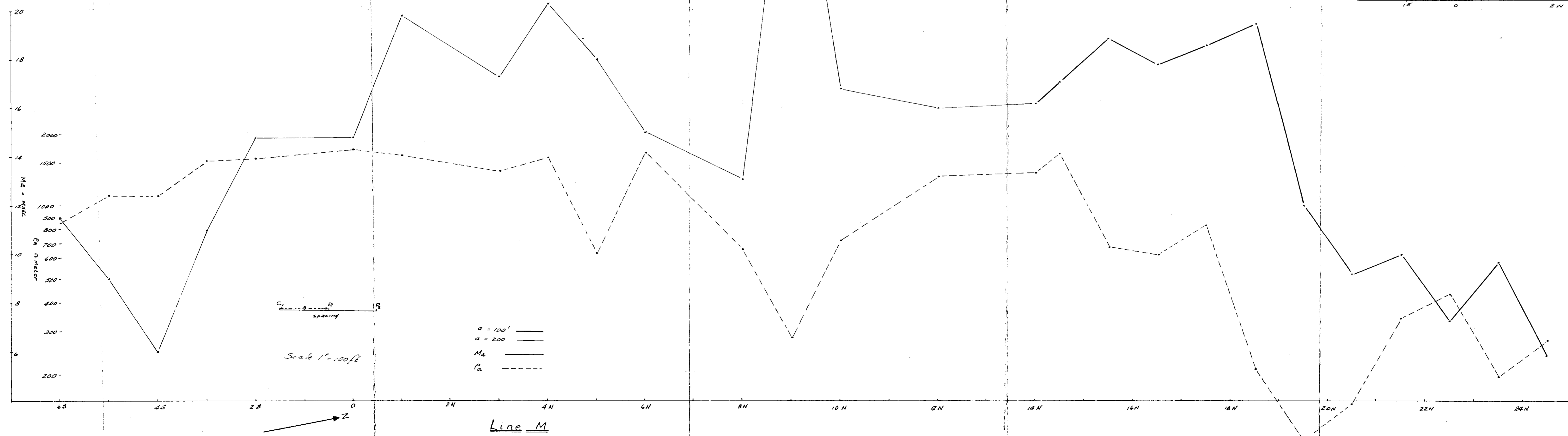
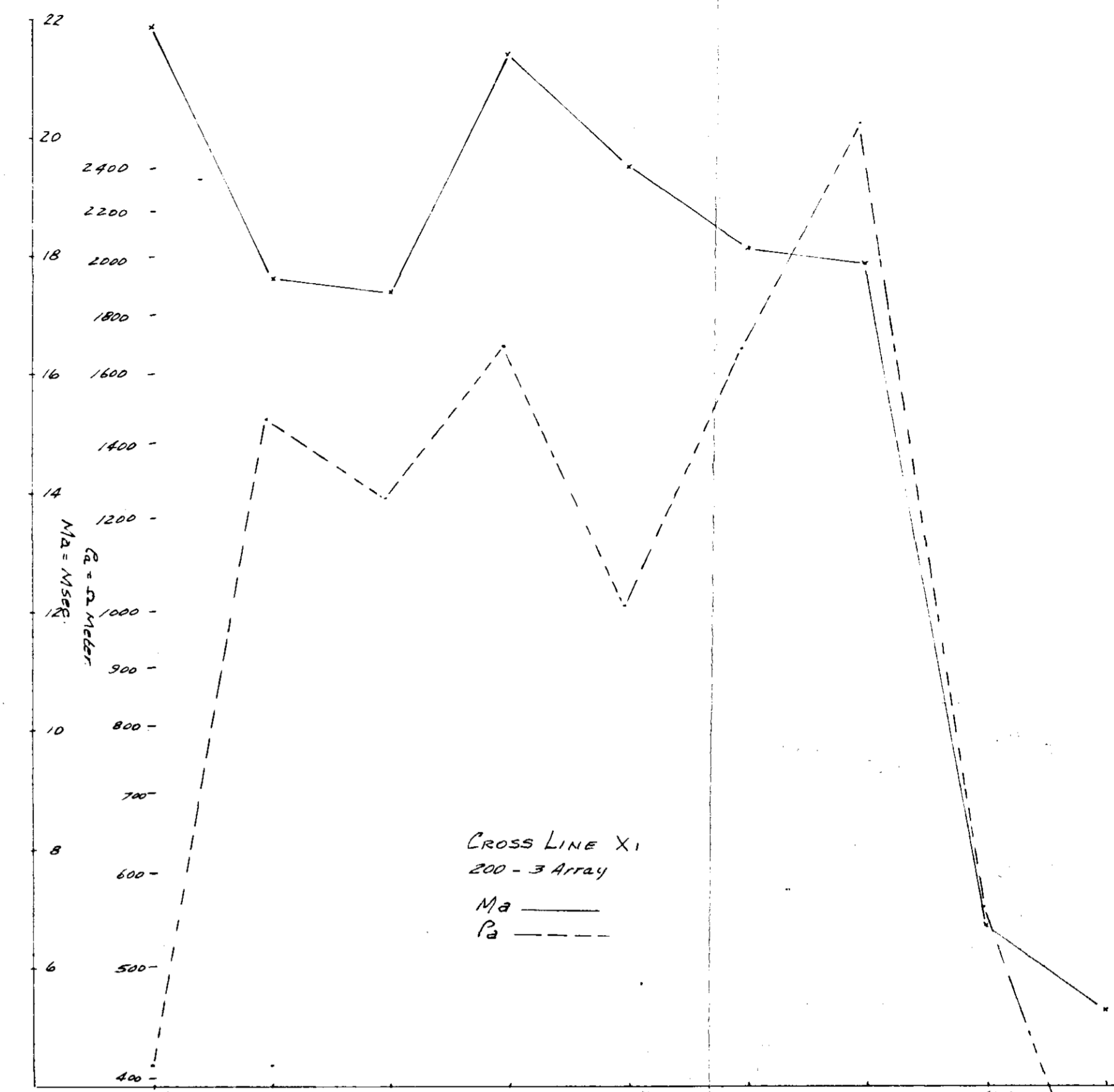
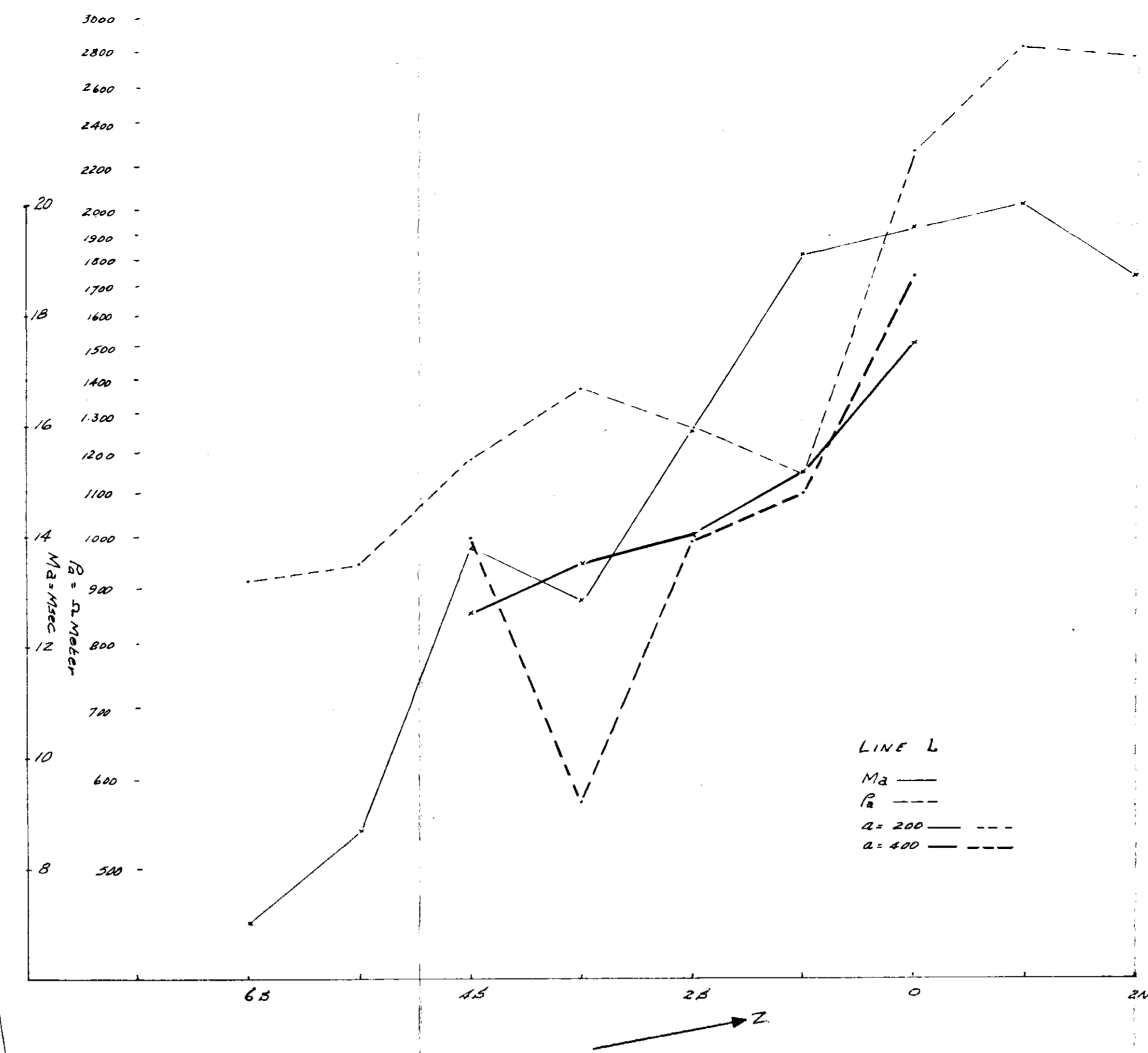
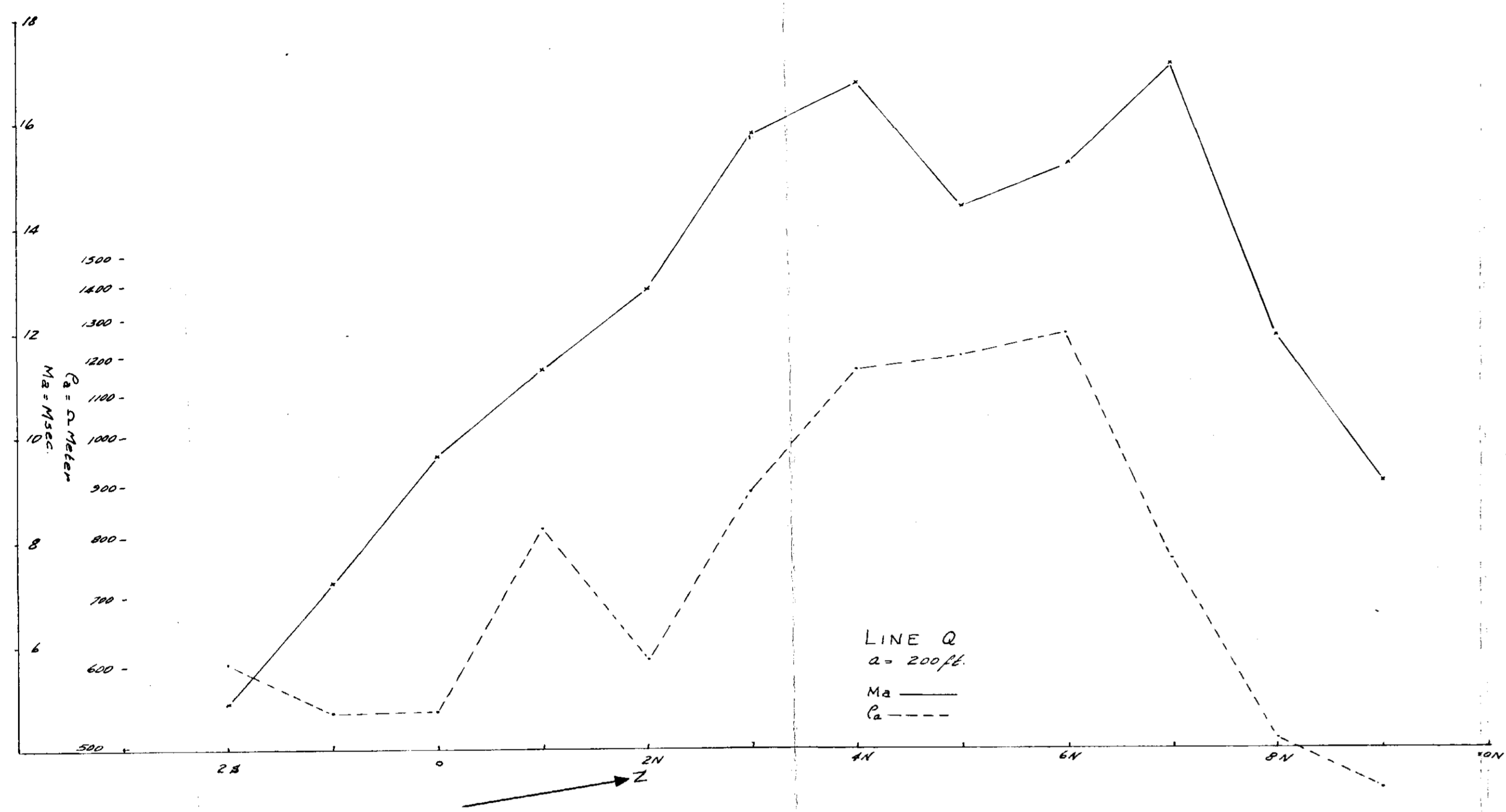

INDUCED POLARIZATION SURVEY
 CHARGEABILITY (Ma) & RESISTIVITY PROFILES
 BY: GEOFAX SURVEY LTD. SURVEY DATES - MAY 28-31 1966

To Accompany Report by S.A. Mouritsen, P. Eng.,
 on the Kingsley, Dodge, For Cluims, Franklin Area,
 Similkameen M.D., dated August 10, 1966.

Department of
 Mines and Petroleum Resources
 ASSESSMENT REPORT
 NO. 812 MAP # 3 (M2)
 I.P. PROFILES
 FRANKLIN AREA
 B.C.
 812