

LIST OF DRAWINGS

<u>DWG. No.</u>	<u>TITLE</u>	<u>SCALE</u>
5 - 150 - 3A	I.P. and Resistivity Survey (3 Electrode Array)	1"=200' → 5
- 3B	" " " " "	1"=200' → 6
- 3C	" " " " "	1"=200' → 7
- 4A	I.P. and Resistivity Survey (Pole Dipole n=2)	1"=200' → 8
- 4B	" " " " "	1"=200' → 9
- 4C	" " " " "	1"=200' → 10
- 5	I.P. and Resistivity Survey (Pole Dipole n=3)	1"=200' → 11
- 6A	Resistivity Contours (Pole Dipole n=2)	1"=200' → 12
- 6B	" " " " "	1"=200' → 13
- 6C	" " " " "	1"=200' → 14
- 7	Total Intensity Magnetics	1"=200' → 15
	PLUS CLAIM MAP & BASE LINE	→ 15A

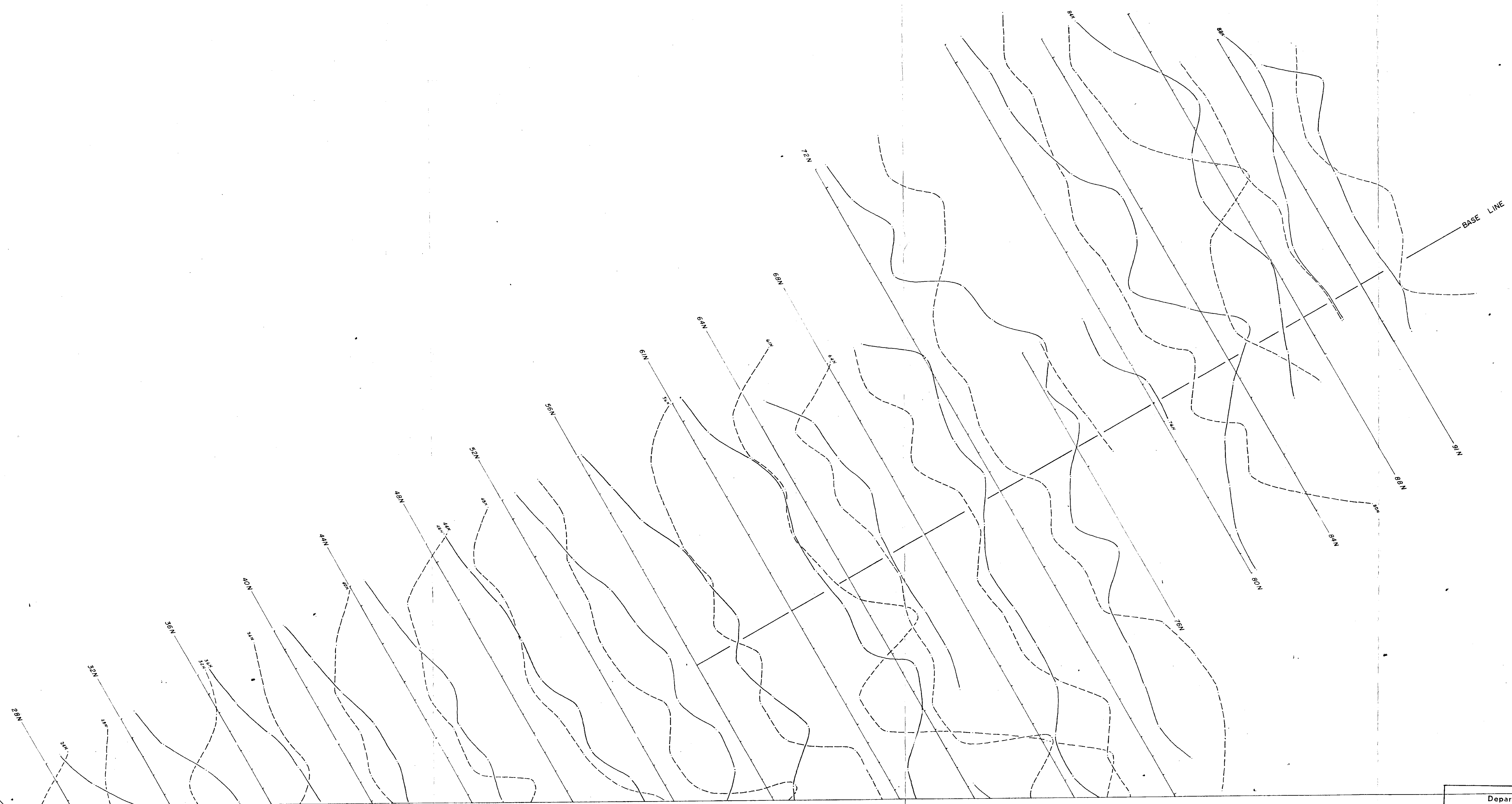

830



LEGEND

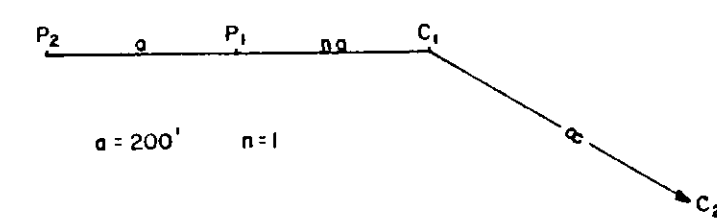

— Chargeability - Scale 1" = 10 milliseecs.
 - - - Resistivity - Scale 1" = 100 ohm metres

INDEX

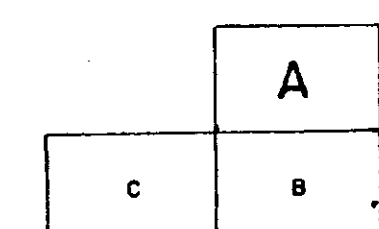

Department of
 Mines and Petroleum Resources
 ASSESSMENT REPORT
 NO. 830 MAP #5

Work undertaken by
 BARRINGER RESEARCH LTD, Toronto, Canada.

TEXAS GULF SULPHUR CO. INC.		
BIG ONION PROPERTY - SMITHERS B.C.		
INDUCED POLARIZATION & RESISTIVITY SURVEY 3 ELECTRODE ARRAY		
AUG. 1966	Scale 1" = 200'	DWG. 5-15D-3A

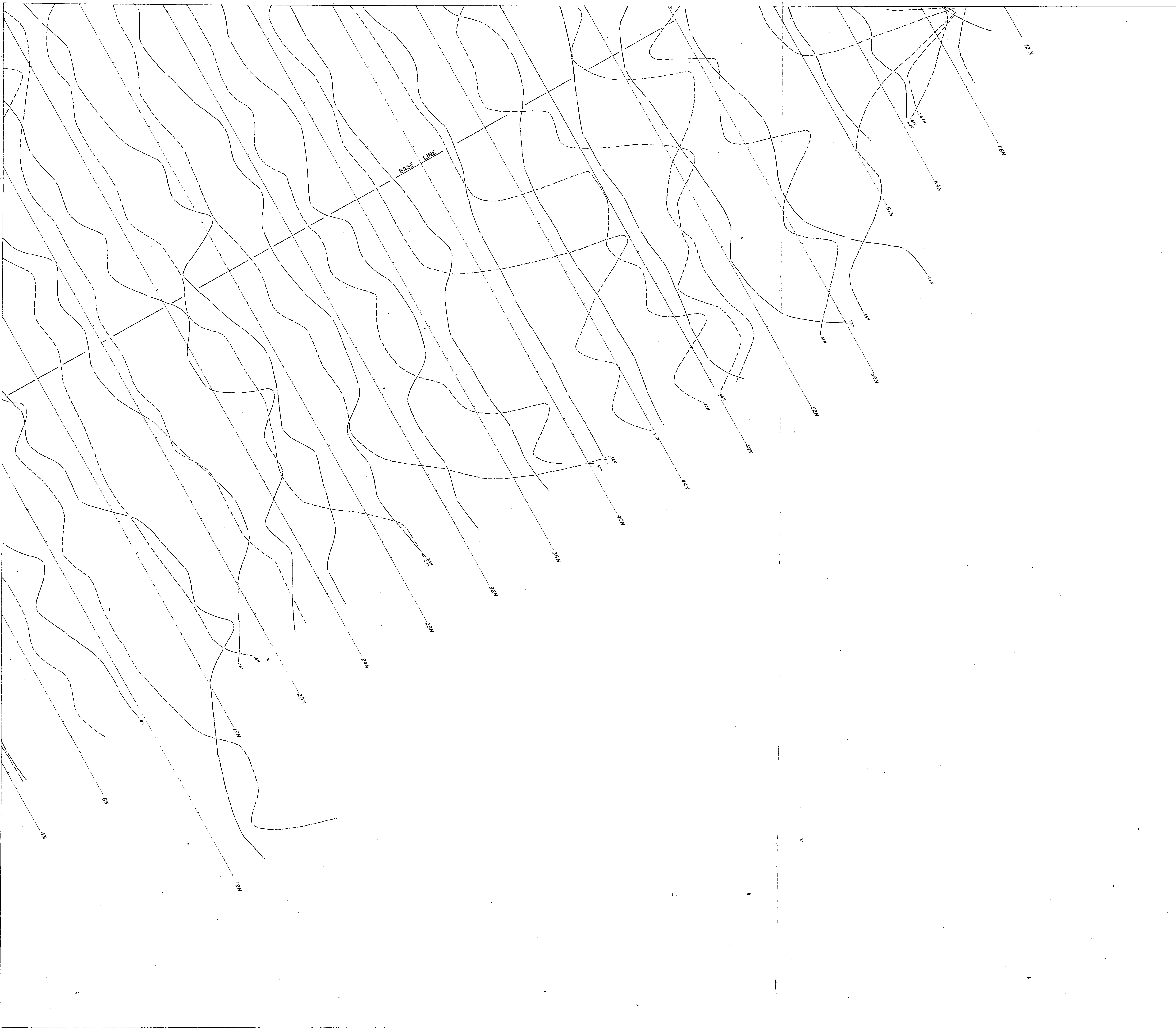

830

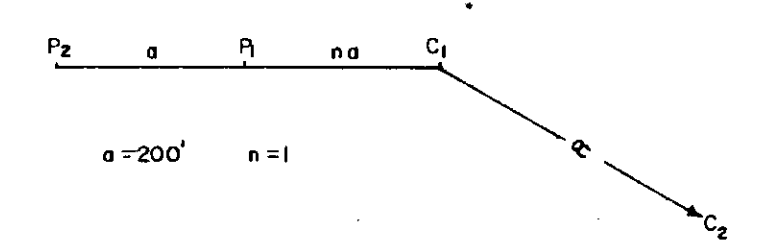
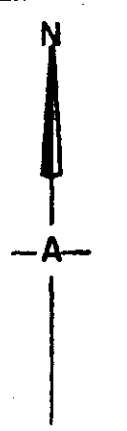

LEGEND
 — Chargeability - Scale 1" = 10 milliseconds.
 - - - - - Resistivity - Scale 1" = 100 ohm metres

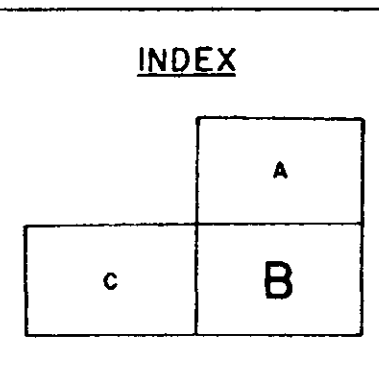

Department of
 Mines and Petroleum Resources
 ASSESSMENT REPORT
 NO. 830 MAP #6

Work undertaken by
 BARRINGER RESEARCH LTD, Toronto, Canada.

TEXAS GULF SULPHUR CO. INC.		
BIG ONION PROPERTY - SMITHERS B.C.		
INDUCED POLARIZATION & RESISTIVITY SURVEY 3 ELECTRODE ARRAY		
AUG. 1966	Scale 1" = 200'	DWG. 5-150-38

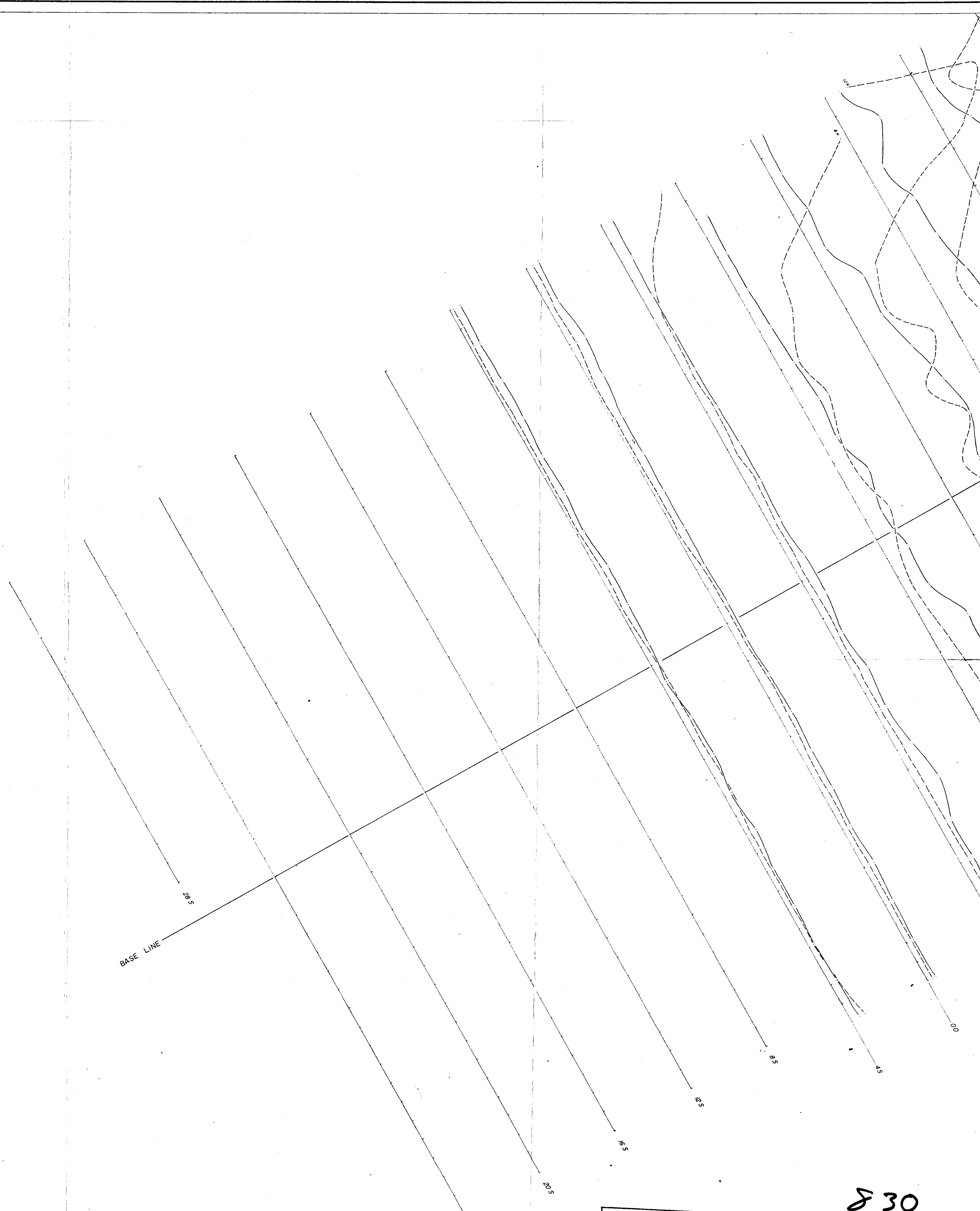

830

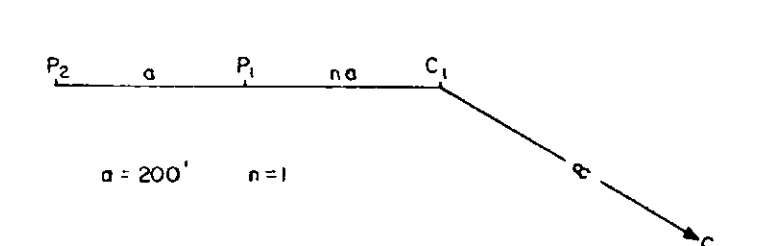

LEGEND
 ——— Chargeability - Scale 1" = 10 milliseconds
 - - - - - Resistivity - Scale 1" = 100 ohm metres

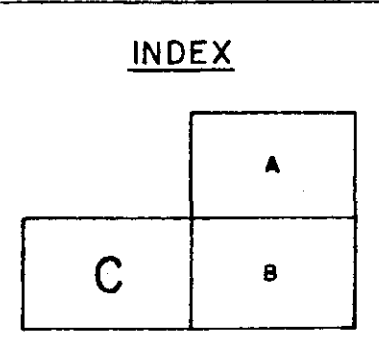

Department of
 Mines and Petroleum Resources
 ASSESSMENT REPORT
 NO. P30 MAP # 7

Work undertaken by
BARRINGER RESEARCH LTD., Toronto, Canada.

TEXAS GULF SULPHUR CO. INC.		
BIG ONION PROPERTY - SMITHERS B.C.		
INDUCED POLARIZATION & RESISTIVITY SURVEY 3 ELECTRODE ARRAY		
AUG. 1966	Scale 1" = 200'	DWG. 5-150-3C

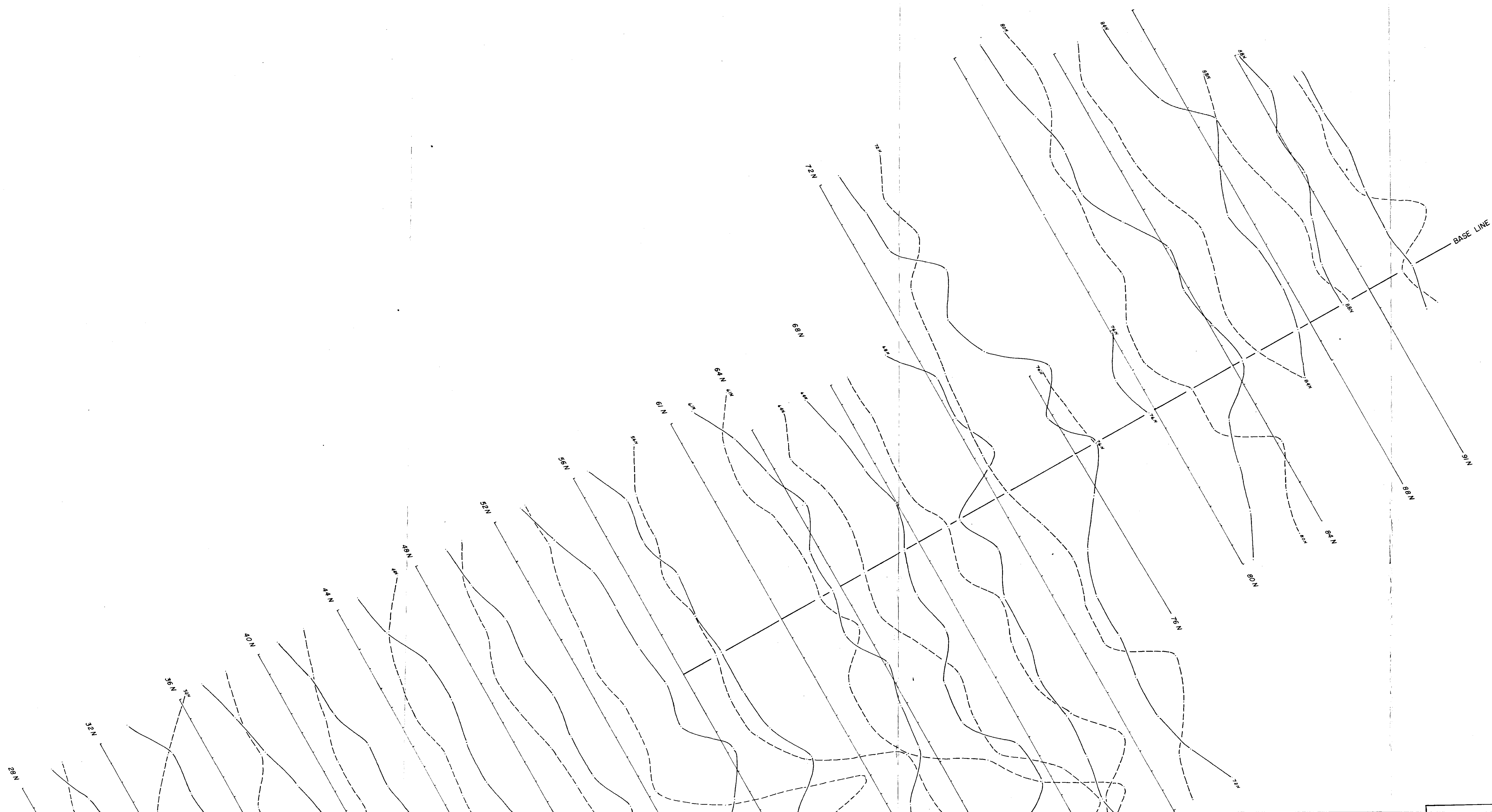

830

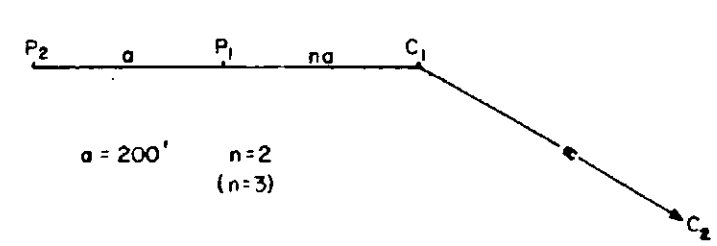
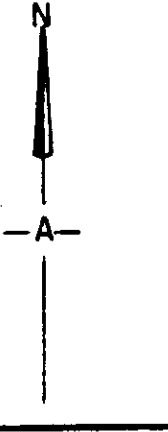

LEGEND
 ——— Chargeability — Scale $I'' = 10$ millisees.
 - - - - - Resistivity — Scale $I'' = 100$ ohm metres

INDEX

	A
C	B

Department of
 Mines and Petroleum Resources
 ASSESSMENT REPORT
 NO. 830 MAP # 8

Work undertaken by
BARRINGER RESEARCH LTD, Toronto, Canada.

TEXAS GULF SULPHUR CO. INC.		
BIG ONION PROPERTY - SMITHERS B.C.		
INDUCED POLARIZATION & RESISTIVITY SURVEY POLE - DIPOLE (n=2)		
AUG. 1966	Scale 1" = 200'	DWG. 5-150-4A

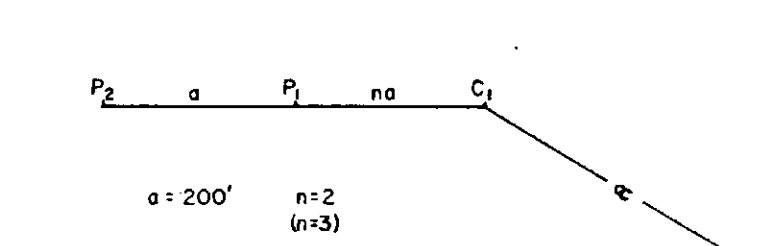
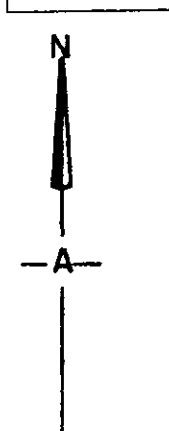
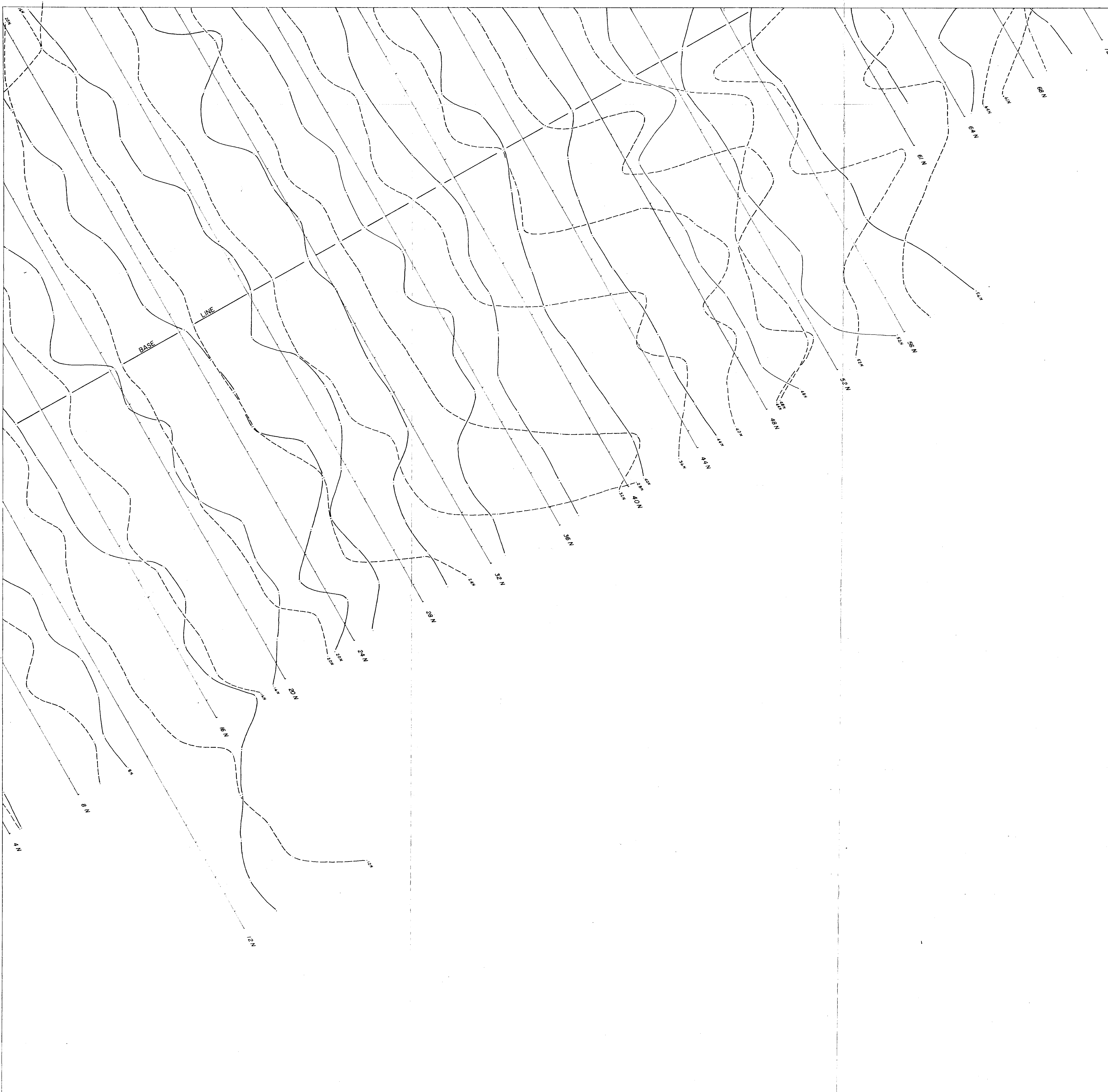

LEGEND

— Chargeability - Scale $1'' = 10$ milliseecs.

- - - Resistivity - Scale $1'' = 100$ ohm metres

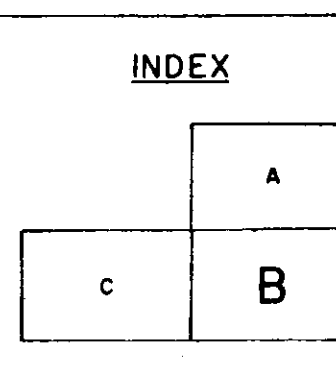

Department of
Mines and Petroleum Resources
ASSESSMENT REPORT
NO. 830 MAP # 7

Work undertaken by
BARRINGER RESEARCH LTD, Toronto, Canada.

TEXAS GULF SULPHUR CO. INC.
BIG ONION PROPERTY - SMITHERS B.C.
**INDUCED POLARIZATION
& RESISTIVITY SURVEY**
POLE - DIPOLE (n=2)

AUG. 1966 Scale $1'' = 200'$ DWG. 5-150-48

830

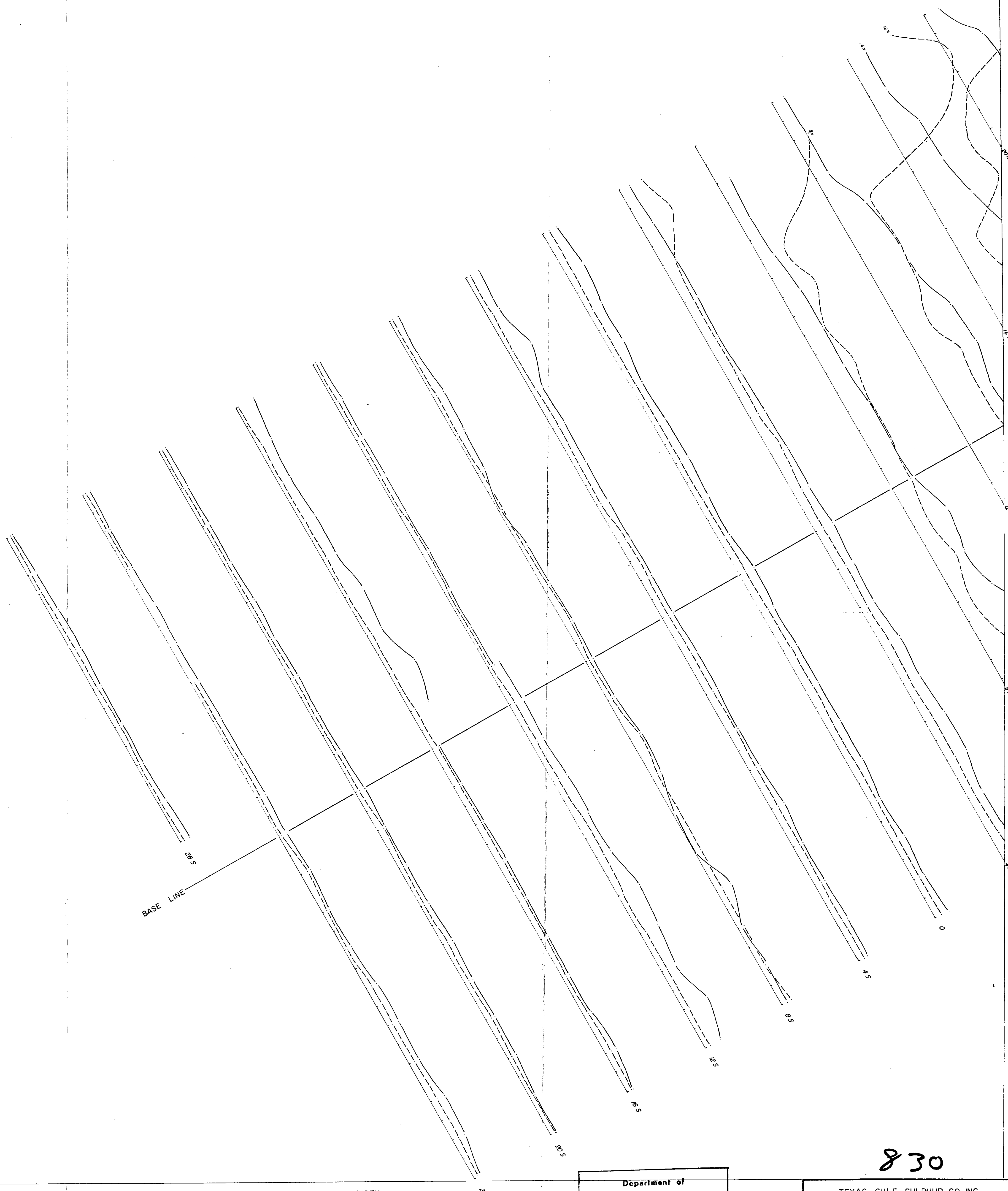

830

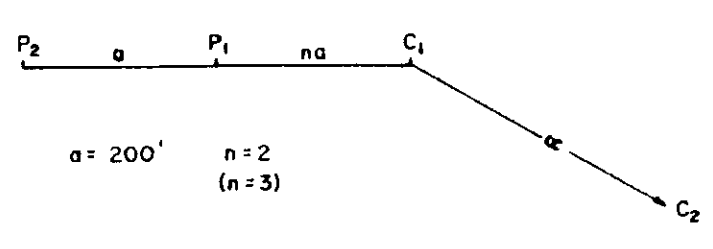

LEGEND

————— Chargeability — Scale 1" = 10 millisees.

----- Resistivity — Scale 1" = 100 ohm metres

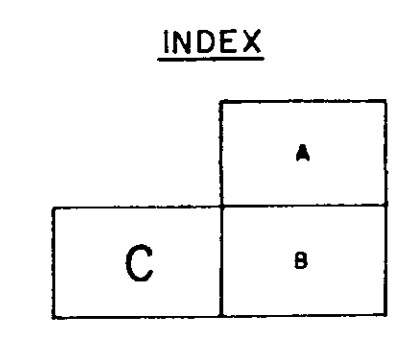

Department of
Mines and Petroleum Resources
ASSESSMENT REPORT
NO. 830 MAP # 10

Work undertaken by
BARRINGER RESEARCH LTD, Toronto, Canada.

TEXAS GULF SULPHUR CO. INC.		
BIG ONION PROPERTY - SMITHERS B.C.		
INDUCED POLARIZATION & RESISTIVITY SURVEY		
POLE - DIPOLE (n=2)		
AUG. 1966	Scale 1" = 200'	DWG. 5-150-4C

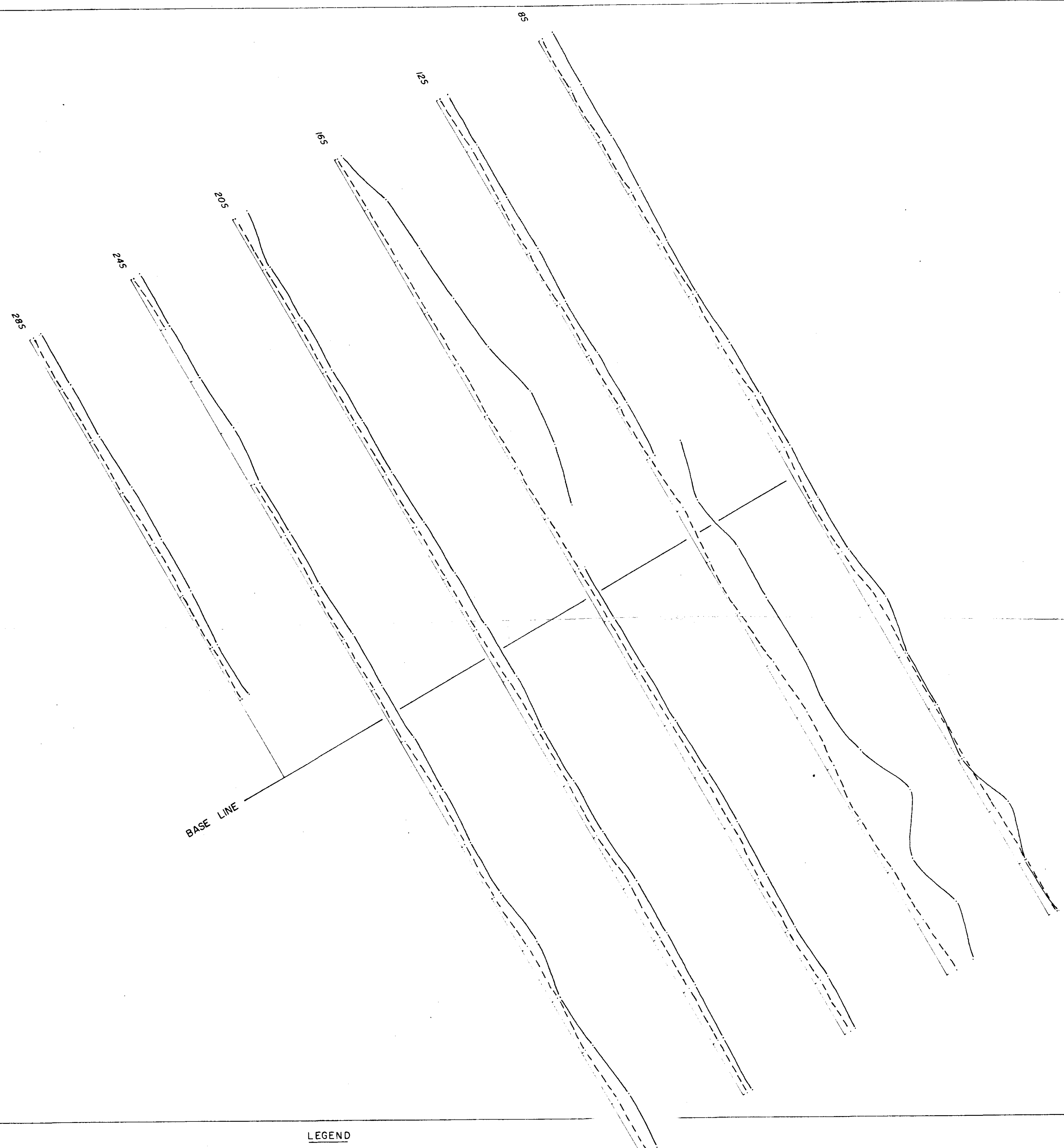

Department of
Mines and Petroleum Resources
ASSESSMENT REPORT
NO. 830 MAP # 11

830

LEGEND

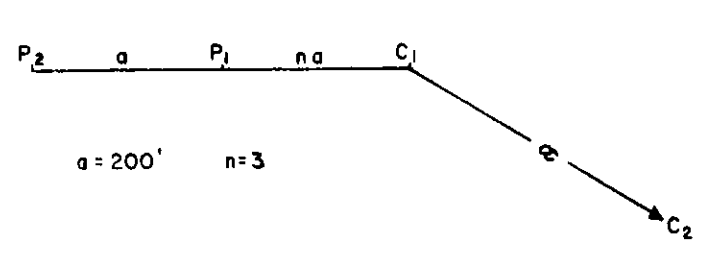

— Chargeability - Scale 1" = 10 millisecs.
- - - Resistivity - Scale 1" = 100 ohm metres

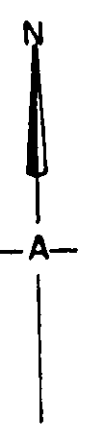

Work undertaken by
BARRINGER RESEARCH LTD, Toronto, Canada.

TEXAS GULF SULPHUR CO. INC.		
BIG ONION PROPERTY - SMITHERS B.C.		
INDUCED POLARIZATION & RESISTIVITY SURVEY POLE - DIPOLE (n=3)		
AUG. 1966	Scale 1"=200'	DWG. 5-150-5

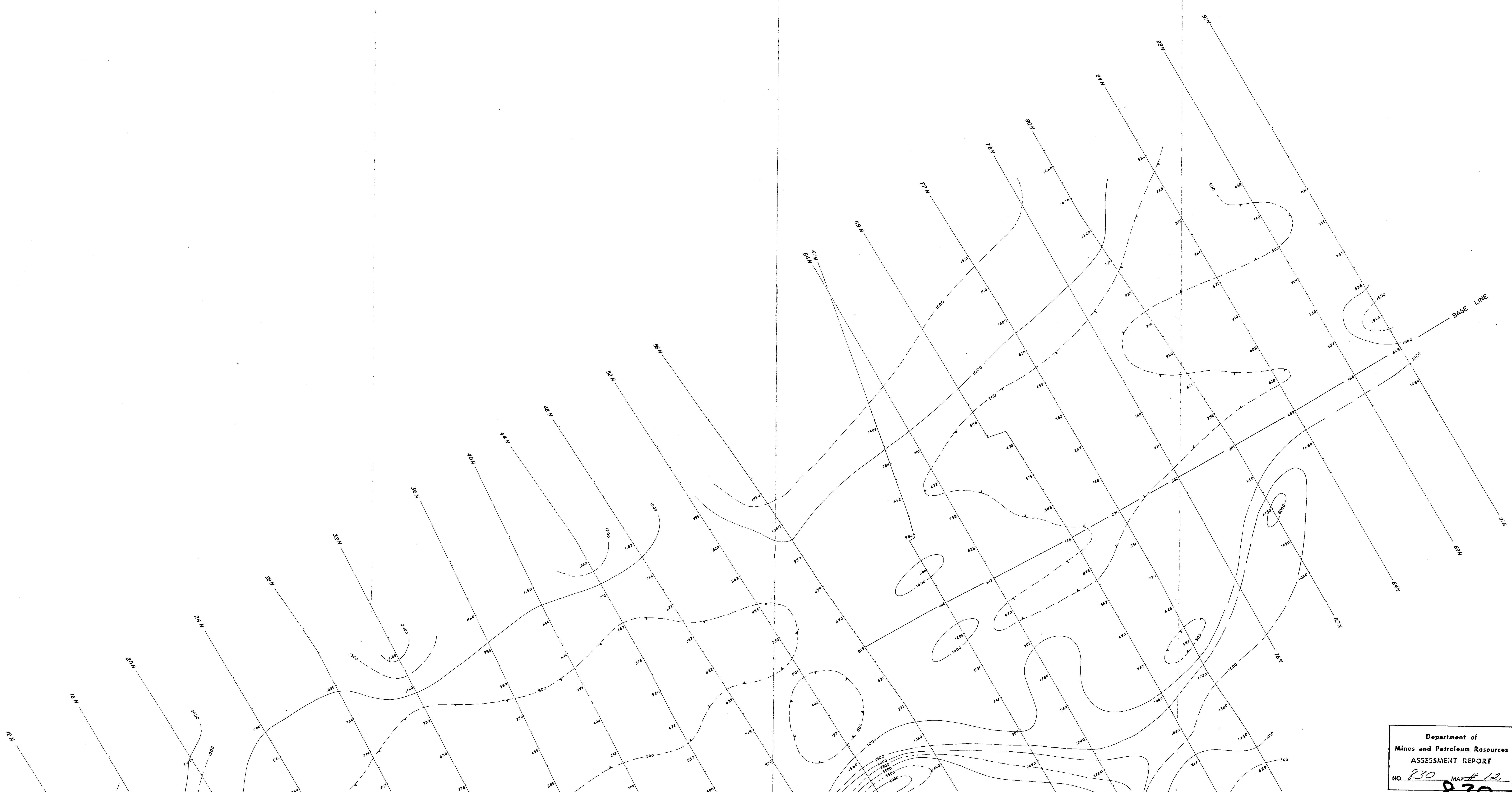

LEGEND

- Contour interval 500 ohm metres
- 5000 ohm m. interval
- - - 1000 ohm m. interval
- · · 500 ohm m. interval
- ⊖ Depression

INDEX

	A
c	b

Department of
Mines and Petroleum Resources
ASSESSMENT REPORT
NO. 830 MAP # 102

TEXAS GULF SULPHUR CO. INC.
BIG ONION PROPERTY - SMITHERS B.C.

RESISTIVITY CONTOURS

POLE - DIPOLE (n=2)
AUG 1966 Scale 1"=200' DWG. 5-150-6A

Work undertaken by
BARRINGER RESEARCH LTD., Toronto, Canada.

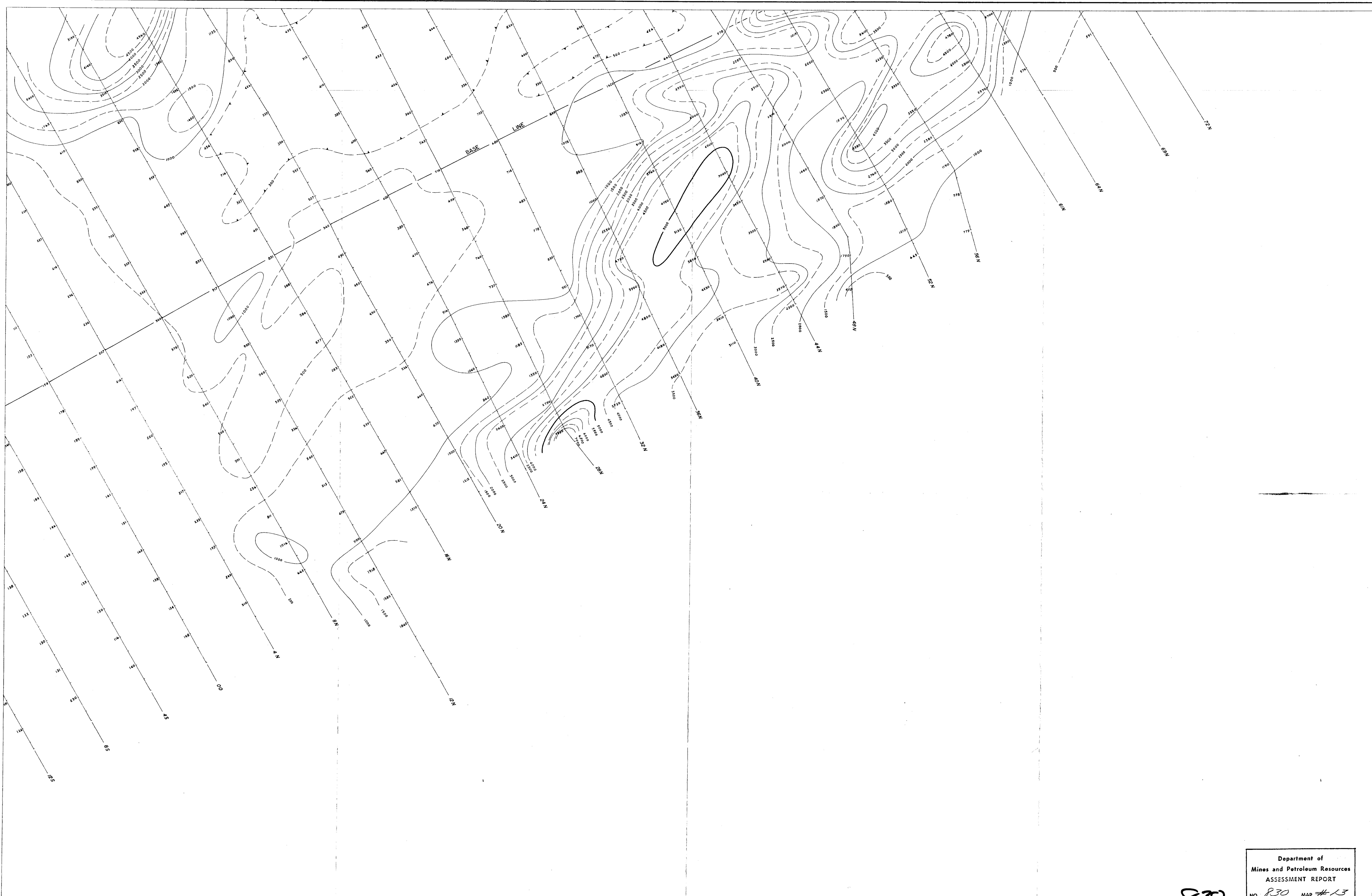

LEGEND

- Contour interval 500 ohm metres
- 5000 ohm m. interval
- 1000 ohm m. interval
- 500 ohm m. interval
- Depression

INDEX

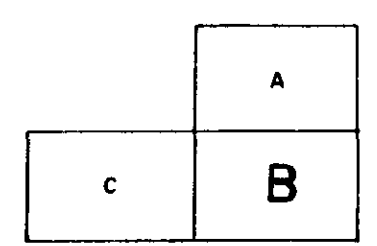

830

Department of
Mines and Petroleum Resources
ASSESSMENT REPORT
NO. 830 MAP # 13

TEXAS GULF SULPHUR CO. INC.
BIG ONION PROPERTY - SMITHERS B.C.
RESISTIVITY CONTOURS
POLE - DIPOLE (n=2)
AUG. 1966 Scale 1"=200' DWG. 5-150-6B

Work undertaken by
BARRINGER RESEARCH LTD, Toronto, Canada.

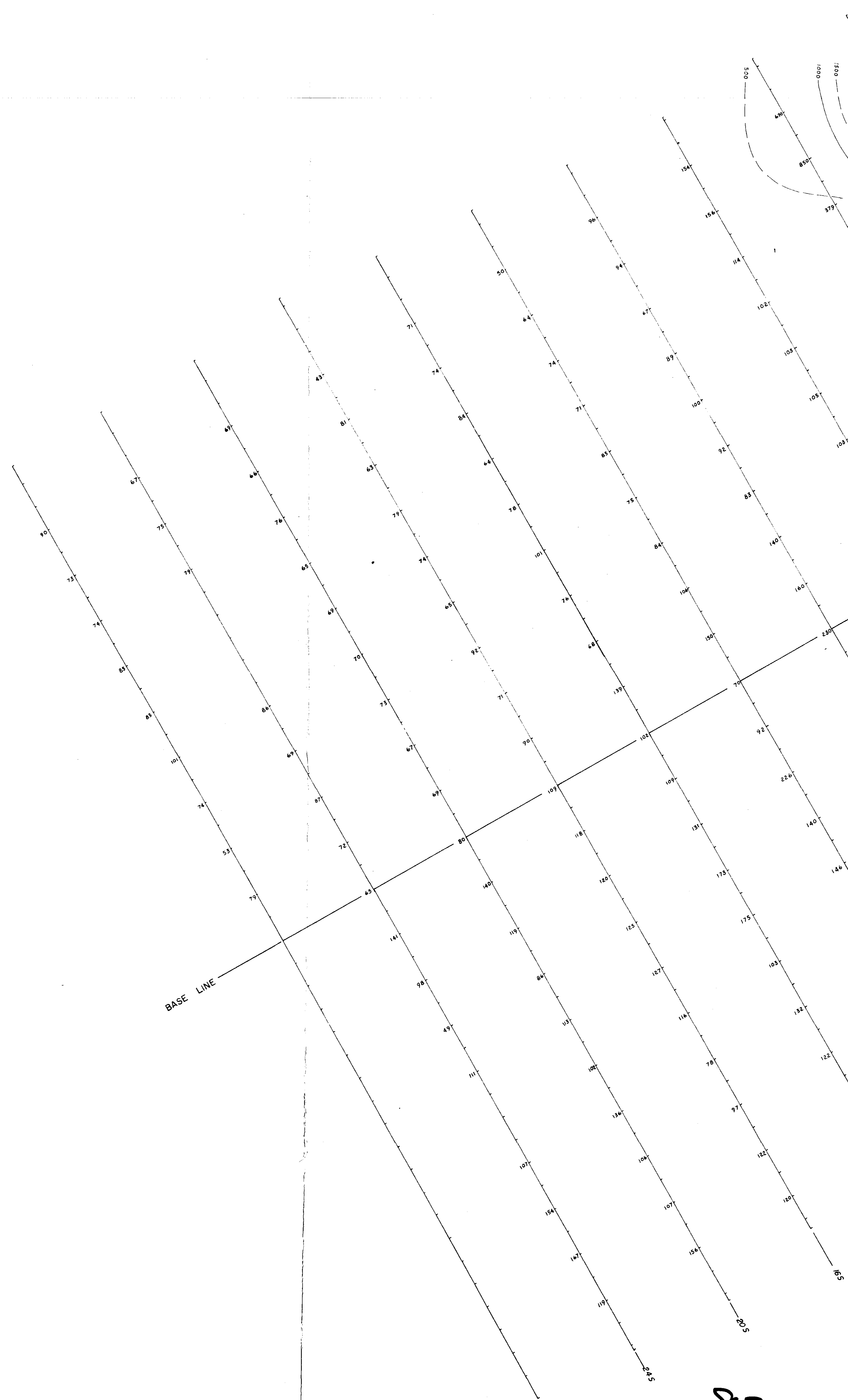

830

LEGEND
 Contour interval 500 ohm metres
 5000 ohm m. interval
 1000 ohm m. interval
 500 ohm m. interval
 Depression

INDEX

	A
C	B

Department of
 Mines and Petroleum Resources
ASSESSMENT REPORT
 NO. 830 MAP # 14

Work undertaken by
BARRINGER RESEARCH LTD., Toronto, Canada.

TEXAS GULF SULPHUR CO. INC.		
BIG ONION PROPERTY - SMITHERS B.C.		
RESISTIVITY CONTOURS		
POLE - DIPOLE (n=2)		
AUG. 1966	Scale 1"=200'	DWG. 5-150-6C

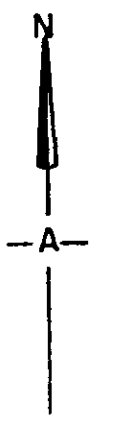
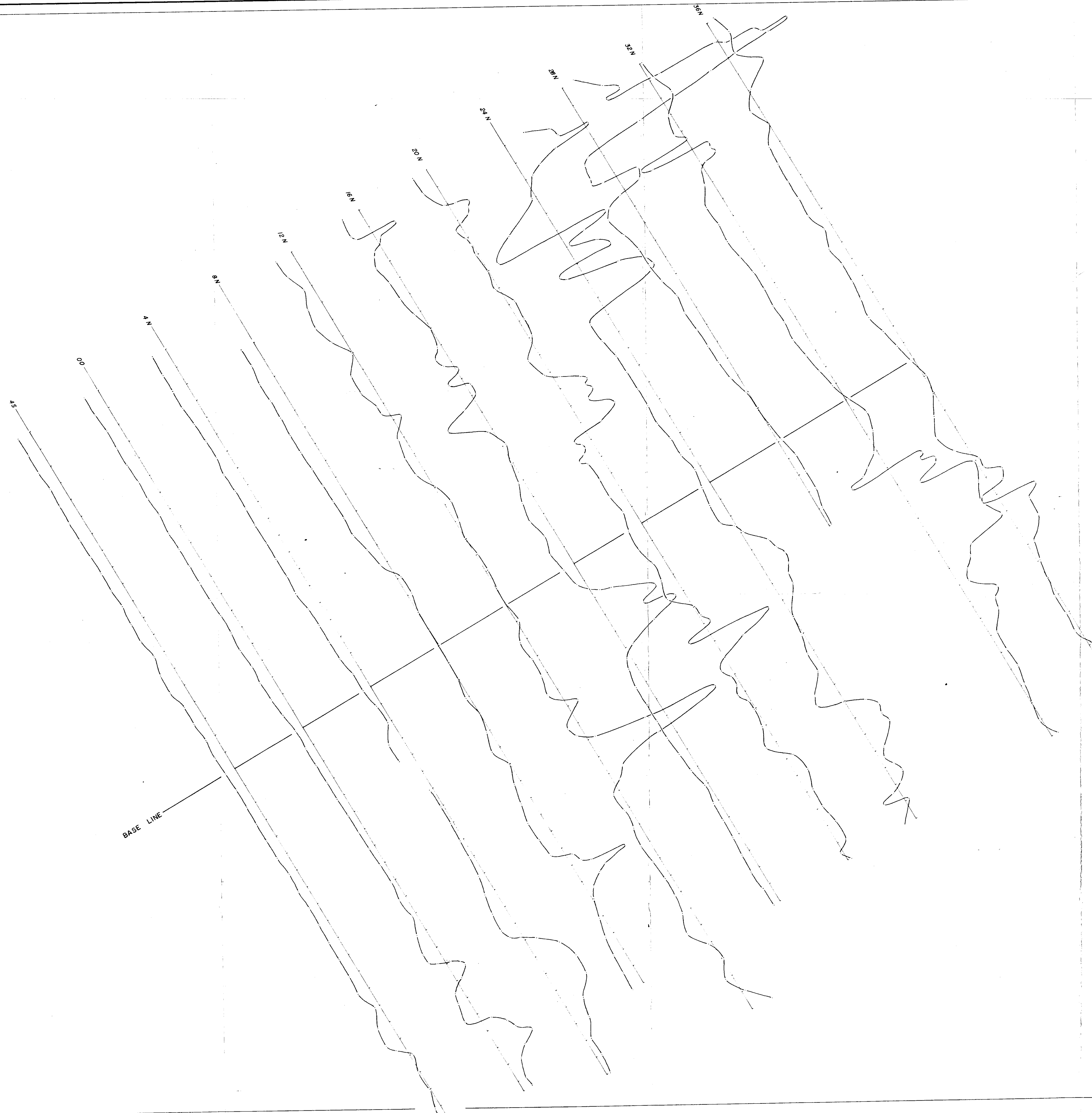

LEGEND
Profile - Scale 1" = 500'

Work undertaken by
BARRINGER RESEARCH LTD, Toronto, Canada.

830

Department of Mines and Petroleum Resources ASSESSMENT REPORT		
NO. 830	MAP # 15	
TEXAS GULF SULPHUR CO. INC.		
BIG ONION PROPERTY - SMITHERS B.C.		
TOTAL INTENSITY MAGNETICS		
AUG. 1966	Scale 1" = 200'	DWG. 5-150-7