

GEOCHEMICAL REPORT

C. A. GROUP

40 Miles North of Stewart, 56° 130° N.E.

Supervisor:	L. J. Manning, P.Eng.
Author:	L. J. Manning, P.Eng.
Claims owned by:	Silver Ridge Mining Co.
Work Done For	Silver Ridge Mining Co.
Dates of Work	July 25th to 30th, 1966

104 B' SE. #4E

836

836

S U M M A R Y

A geochemical survey of a portion of the C. A. Group north of Stewart, B. C. was made in July, 1966.

The group lies in a mountainous area about 40 miles north of Stewart at an elevation of about 5,000 feet.

77 soil samples were taken at 200 foot intervals along three E. W. lines in an attempt to cover the whole property. The lines terminated in steep bluffs at the west end of the property.

An anomalous area on the west of the property was indicated by this work.

It is recommended that because of the high cost of transporting and servicing a small crew in this area, an attempt be made to co-operate with any other crews in the area to detail the survey and prospect the anomalous area.

C O N T E N T S

	<u>Page</u>
Object	1
Location	1
Title	1
Transportation	2
Topography	2
Survey Methods and Background	2
Field Party	3
Results	3
Conclusions	4
Recommendations	4
Maps	Attached
(1) Claim Location Map # 1	
(2) Soil Samples # 2	

R E P O R T

on a

GEOCHEMICAL SURVEY

OF THE C. A. CLAIM GROUP

of

SILVER RIDGE MINING CO. LTD.

OBJECT

This report is submitted for the purpose of recording the results and subsequent conclusions of a geochemical survey carried out on the C. A. group of claims owned by Silver Ridge in the Skeena Mining Division from the 25th to the 30th July, 1966.

LOCATION

The C. A. Group is located 39 miles north of Stewart, B. C. at the headwaters of Sulphurets Creek, a tributary to the Unuk River. Elevation ranges from 4,500 to 6,000 feet at about latitude $56^{\circ}30'$ and Longitude $130^{\circ}10'$.

TITLE

The claims under consideration in this report are as follows:

<u>Claim Name</u>	<u>Record No.</u>	<u>Claim Name</u>	<u>Record No.</u>
C. A. #1	24306	C. A. #11	24316
C. A. #2	24307	C. A. #12	24317
C. A. #3	24308	C. A. #13	24318
C. A. #4	24309	C. A. #14	24319
C. A. #5	24310	C. A. #15	24320
C. A. #6	24311	C. A. #16	24321
C. A. #7	24312	C. A. #17	24322
C. A. #8	24313	C. A. #18	24323
C. A. #9	24314	C. A. #19	24324
C. A. #10	24315	C. A. #20	24325

TITLE (Continued)

<u>Claim Name</u>	<u>Record No.</u>	<u>Claim Name</u>	<u>Record No.</u>
C. A. #21	24326	C. A. #31	24336
C. A. #22	24327	C. A. #32	24337
C. A. #23	24328	C. A. #33	24338
C. A. #24	24329	C. A. #34	24339
C. A. #25	24330	C. A. #35	24340
C. A. #26	24331	C. A. #36	24341
C. A. #27	24332	C. A. #37	24342
C. A. #28	24333	C. A. #38	24343
C. A. #29	24334	C. A. #39	24344
C. A. #30	24335	C. A. #40	24345

The claims were staked on the 6th October, 1964.

TRANSPORTATION

The property is reached from Stewart by helicopter. Stewart is connected to Prince Rupert and Vancouver by daily air and weekly sea transportation services.

TOPOGRAPHY

The group is at the headwaters of Sulphurets Creek on a steep southern slope with a glacier on the northern side of the ridge and a glacier running along the foot of the valley. Vegetation is typical of that at treeline and above.

SURVEY METHODS AND BACKGROUND

In 1965 some rough reconnaissance field tests on soil samples indicated some appreciable molybdenum values and it was decided to run a more thorough survey this year, time and finances permitting.

Accordingly our field manager, Don MacLeod, took in two men, James Way and Al Manning, and selected three lines running along the side hill as near as possible to three lines laid out in the office, and which could be travelled upon between steep bluffs and on top of ridges.

Points A, B, and C were selected as starting points and samples taken at 200 foot intervals along the lines as indicated on the accompanying map. Samples were taken well below the humus level which was relatively shallow in this area. Line A was run along the base of the slope, line B on the side hill and line C on the top of the ridge.

SURVEY METHODS AND BACKGROUND (Continued)

Samples were assayed in P.P.M. and plotted revealing an area of interest on the west side of the property on both lines C and A. No explanation for the negative results obtained on line B is available except that these samples may have been taken on top of recent glacial material.

FIELD PARTY

The work was done under the direction of H. L. Hill, P. Eng. of Hill, Manning and Associates Limited, Consulting Engineers of Vancouver.

Mr. Don MacLeod, a man experienced in field work and soil sampling, took the two samplers in, showed them the required area to be sampled, and determined the practical location for the lines. He determined that Mr. James Way had taken samples previously and was a responsible individual and knew and could cope with any tendency to contaminate the samples.

Mr. James Way, with Mr. Al Manning assisting, completed the sampling, plotted the field map and returned to his residence in Likely, B. C. The samples were sent to T. S. L. in Vancouver for testing.

Direct costs are as follows:

Labor - D. MacLeod	5 days	\$ 220
- J. Way	5 days	\$ 175
- A. Manning	5 days	\$ 150
Helicopter - Stewart to Job to Stewart		\$ 522
Helicopter @ Site		\$ 96
Groceries		\$ 110
Supplies		\$ 55
Assaying		\$ 152
Supervision & Report, Hill, Manning & Associates Ltd.		\$ 150
Total Costs		\$1,730

RESULTS

The results of the survey are plotted on Map 2 to a scale of one inch equals 500 feet. Readings over ten in Molybdenum and eighty in copper are regarded as anomalous.

A zone of interest appears to be indicated on the west portion of the property by both copper and molybdenum readings in excess of background.

CONCLUSIONS

An area of possible significant mineralization occurs on the west side of the property.

RECOMMENDATIONS

Because of the lack of very high readings in the soil sampling, because of the lack of readings over background on Line B west, and because of the high cost of working in this area due to its remoteness; it is recommended that no work be done except by co-operating with other technical crews already in the area on other work. In which case, geology of bluffs on west side should be mapped to see if source of copper molybdenum increases can be located. Soil samples should be taken on the slopes below the bluffs on the west side of the property.

HILL, MANNING & ASSOCIATES LIMITED

L. J. Manning
L. J. Manning, P. Eng.

27/9/66

LJM:mjr

I, Luard J. Manning of 945 Belvedere Drive, North Vancouver, B. C. certify as follows:

1. That I am a graduate of the University of British Columbia and hold a Bachelor of Applied Science degree in Mining Engineering.
2. That I have been a member of the Association of Professional Engineers of Ontario since 1959 and a member of the Association of Professional Engineers of British Columbia since April, 1966.
3. That I have been engaged in the profession of mining engineering for over 15 years.
4. That I was a member of the engineering and supervisory staff of the Taxco Unit of the American Smelting and Refining Co. Ltd. from 1951 to 1953
5. That in 1953 I joined the staff as chief engineer at Giant Mascot Mines Ltd., Spillimacheen, B. C. and remained there until 1955.
6. That from 1955 to 1957 I was employed by Rix Athabasca Uranium Mines Ltd. as chief engineer and assistant manager.
7. That from 1957 to 1959 I was a mine captain at Pronto Uranium Mines Ltd.
8. That from 1959 to 1960 I was in charge of research and auxilliary mine services at Pronto.
9. That from 1960 to 1963 I was mine superintendent of the Pronto Division of Rio Algom Mines Ltd.
10. That from 1964 to 1965 I was General Mine Superintendent of the Pronto Division of Rio Algom Mines Ltd.
11. That from August to December 1965 I was resident manager at Orecan Mines Limited.
12. That from January 1966 I have been involved in general exploration and consulting work.
13. That I am at present a partner in the firm of Hill, Manning & Associates Limited of Vancouver, a firm of consulting mining engineers.
14. That I do not hold any financial or other interests in the properties or stock of the C. A. Claim Group of Silver Ridge Mining Co. Ltd. nor do I expect to do so in the future.

Dated at Vancouver, B. C. this 23rd day of September, 1966



L: J. Manning, P: Eng.

27/9/66

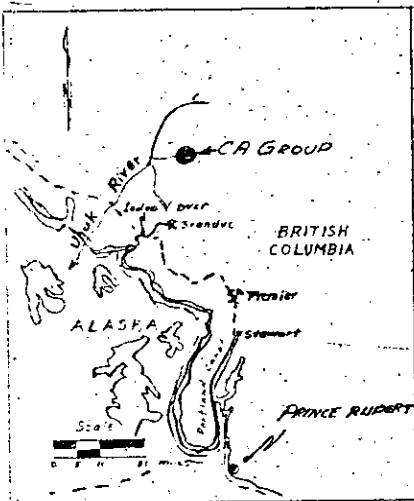

Dawson & Ross
(Ketchikan)

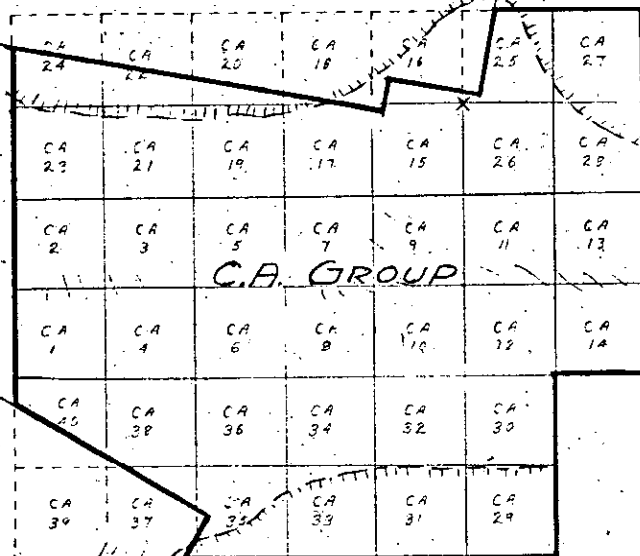

C.A. GROUP

Note
CA Group underlain
by sediments, talcemics &
intrusives which contain
2-5% pyrite thus all
surface material rusty

Granduc Mines Ltd.
Sulphurets property.

Sulphurets Cr.

Zone of Au & Ag mineralization

GLACIER

SCALE

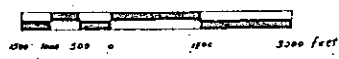

HILL, STARCK & ASSOCIATES
CONSULTING ENGINEERS
VANCOUVER BRITISH COLUMBIA

**C.A. GROUP
UNUK AREA
B.C.**

DATE Oct 1964 SCALE 1" = 1000'
 PREPARED BY JMS CHECKED BY
 DRAWN BY JMS FILE NO.
 CHECKED BY JMS CDS 700

DAWSON & ROSS
(Ketchikan)

Department of
Mines and Petroleum Resources
ASSESSMENT REPORT
NO. 836 MAP #2

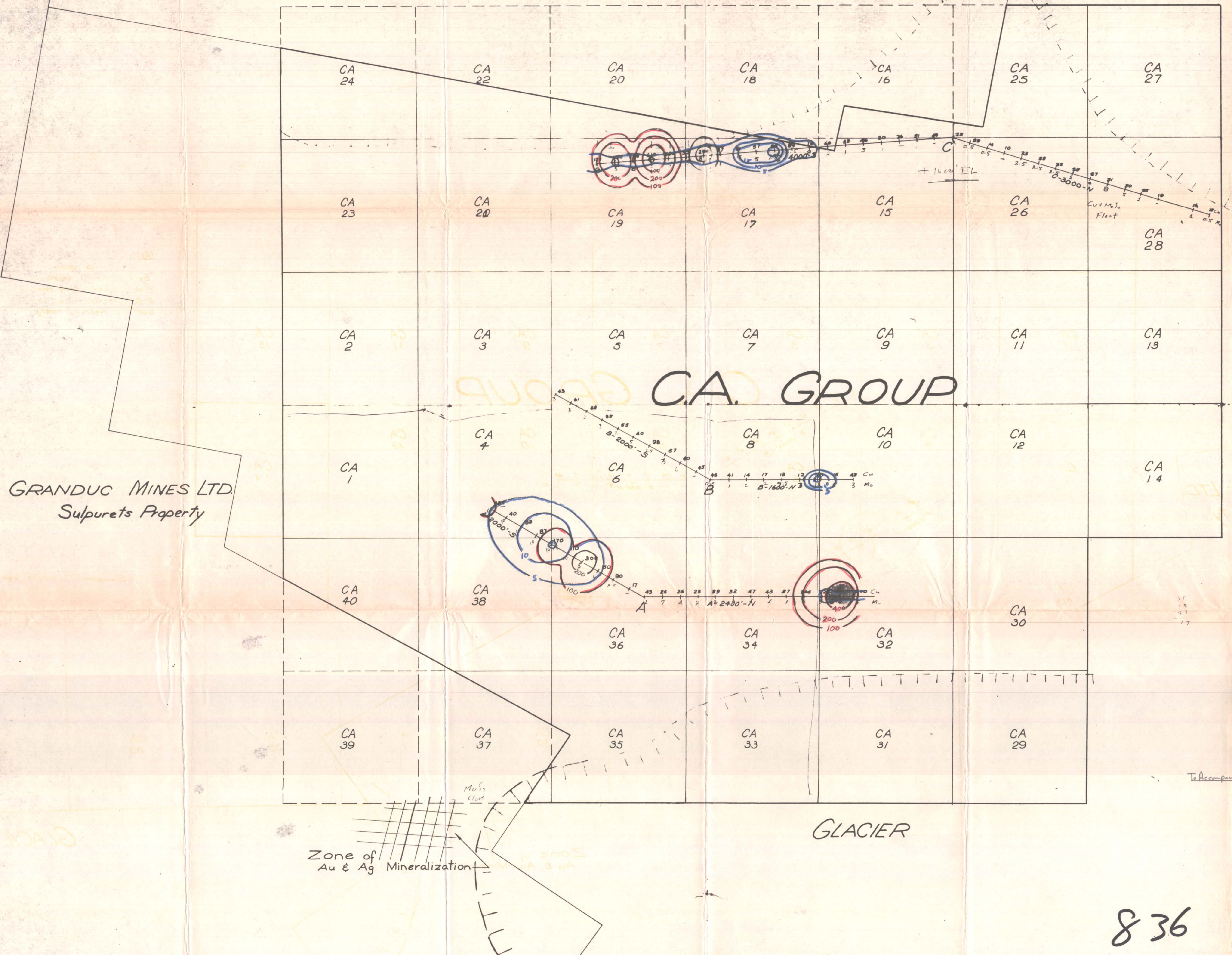

NOTE
CA Group underlain
by sediments, volcanics
& intrusives which contain
2-5% pyrite - thus all
surface material rusty

Soil Samples - in parts per million
Cu & Mo

GRANDUC MINES LTD.
Sulphurets Property

CA GROUP

GLACIER

Zone of
Au & Ag Mineralization

To Accompany Report By L.J. Manning on CA Group Shown M.D. 30th July 1966

Copper - ppm —
Molybdenum - ppm —

HILL, MANNING & ASSOCIATES LTD.

SOIL SAMPLES
CA GROUP
UNUK AREA B.C. 104B8

SCALE: 1" = 500'

DRAWN BY: D.B.C.

L.J. Manning 27/7/66

836