

WILLIAM G. STEVENSON, P. Eng.

Consulting Geologist

509 STOCK EXCHANGE BUILDING
475 HOWE STREET
VANCOUVER 1, CANADA

839

GEOCHEMICAL

REPORT ON THE

M E # 1.

MINERAL CLAIM

RECORD NUMBER 14990

NANAIMO, M.D.
BRITISH COLUMBIA

(49° 45' N - 125° 15' W)

QUALICUM MINES LTD.

MT. WASHINGTON COPPER CO. LTD.

NOVEMBER 10, 1966
VANCOUVER, B.C.

W. G. STEVENSON, P. Eng.

wog

TABLE OF CONTENTS

1. British Columbia Department of Mines and Petroleum Resources Form B. Affidavit on Application for Certificate of Work.
2. Introduction
3. Nature of Work
4. Conclusion
5. Photocopy of part of MAP 69 Scale 1" = 1 mile # 6
6. Photocopy of Part of MAN Scale 1" = 1000' showing location of geochemical samples and assay results of copper in parts per million. # 8
7. Photocopy of Part of MAN Scale 1" = 1000' showing location of geochemical samples and assay results of zinc in parts per million. # 10
8. Statement of costs with receipt from Bio Metals Ltd.
9. Certificate of W. G. Stevenson, P. Eng.

WILLIAM G. STEVENSON, P. Eng.

Consulting Geologist

509 STOCK EXCHANGE BUILDING
475 HOWE STREET
VANCOUVER 1, CANADA

INTRODUCTION

During the 1966 field season I supervised an exploration program over the property held by Mt. Washington Copper Co. This property is located on Vancouver Island, 13 miles northwest of Courtenay at an elevation in excess of 3500'. The exploration program involved prospecting, geological mapping and geochemical sampling.

This report covers the geochemical program that was conducted over part of this area which is located approximately three miles southeast of McKay Lake.

This report is being submitted in lieu of physical work to accompany an Affidavit on Application for Certificate of Work to satisfy the assessment requirements on one mineral claim, the ME #1, Record Number 14990.

NATURE OF THE WORK

Two prospectors were engaged to collect soil samples over this area. These soil samples were collected immediately below the horizon which contains humus. This horizon is generally found at depths between 6 inches and two feet below the surface.

The soil samples were submitted to Bio Metals Corporation, Ltd. (N.P.L.)

WGS

WILLIAM G. STEVENSON, P. Eng.

Consulting Geologist

509 STOCK EXCHANGE BUILDING
475 HOWE STREET
VANCOUVER 1, CANADA

204-1515 Pemberton Ave., North Vancouver, B. C. The samples were tested for copper and for zinc with an X-Ray spectroscopic instrument.

The two prospectors collected 57 samples that have a direct relationship to an area of approximately 50 acres. The location where these samples were collected is shown on the attached maps which are drawn to a scale of 1 inch = 1000 feet. The assay results are shown opposite the sample location and are indicated in parts per million. One map represents the copper values and the second map represents the zinc values.

CONCLUSION

In each instance the sample locations where the specific metal content exceeds 100 parts/million has been shaded.

The copper assays are uniformly high over this area while the zinc values are consistently lower.

Additional exploration is indicated as a result of the anomalous high copper content found in the soils in this area.

Respectfully Submitted,

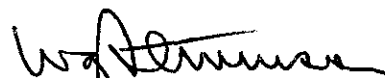

W. G. STEVENSON, P. Eng.

WILLIAM G. STEVENSON, P. Eng.

Consulting Geologist

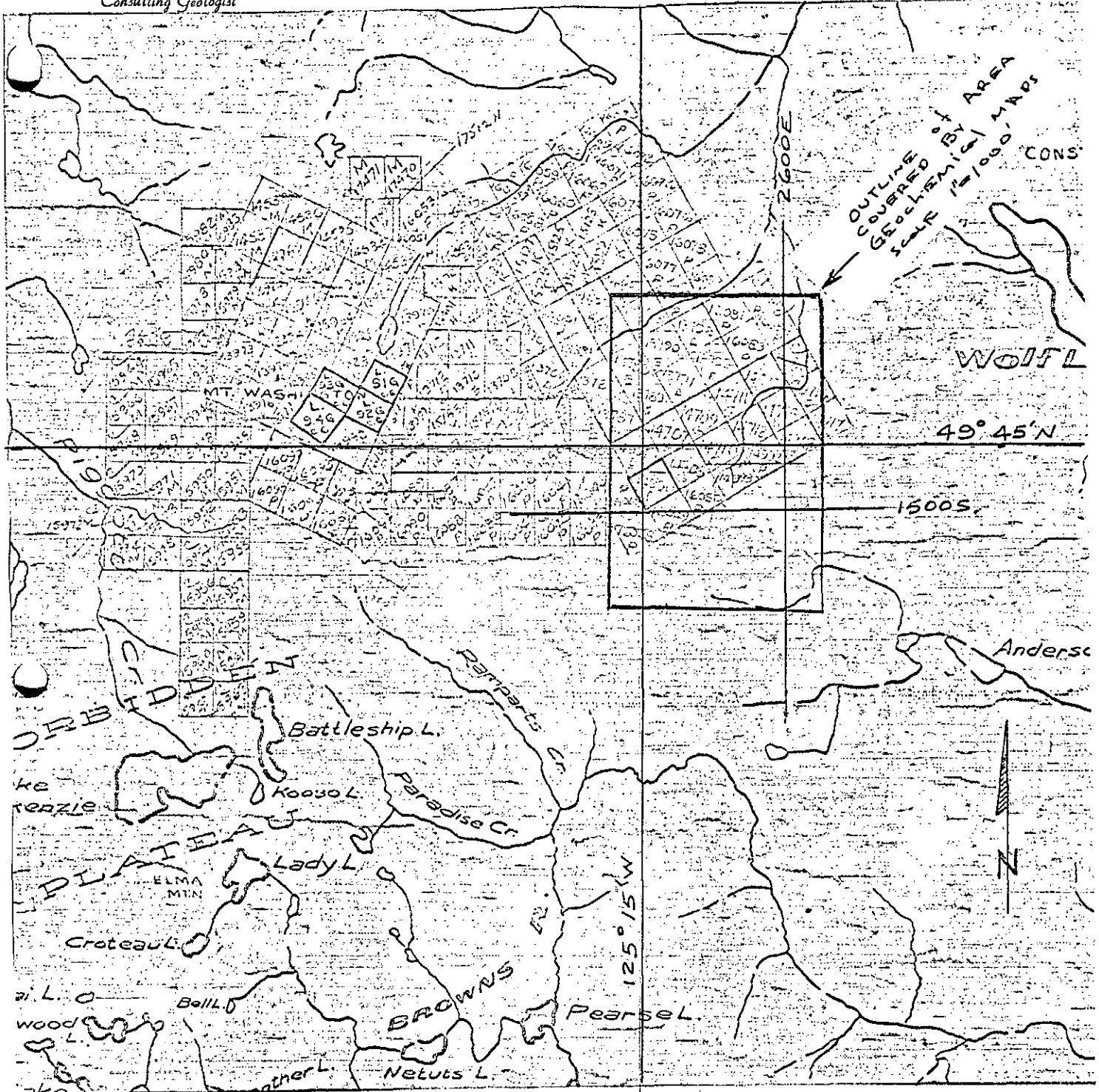

Photocopy of Part of Map 69M
B.C. Department of Mines and Petroleum
Scale 1" = 1 mile
To accompany Report by
W. G. Stevenson
November 10, 1966

N=5

REVISED Dec 7, 1966

WGP

WILLIAM G. STEVENSON, P. Eng.

Consulting Geologist

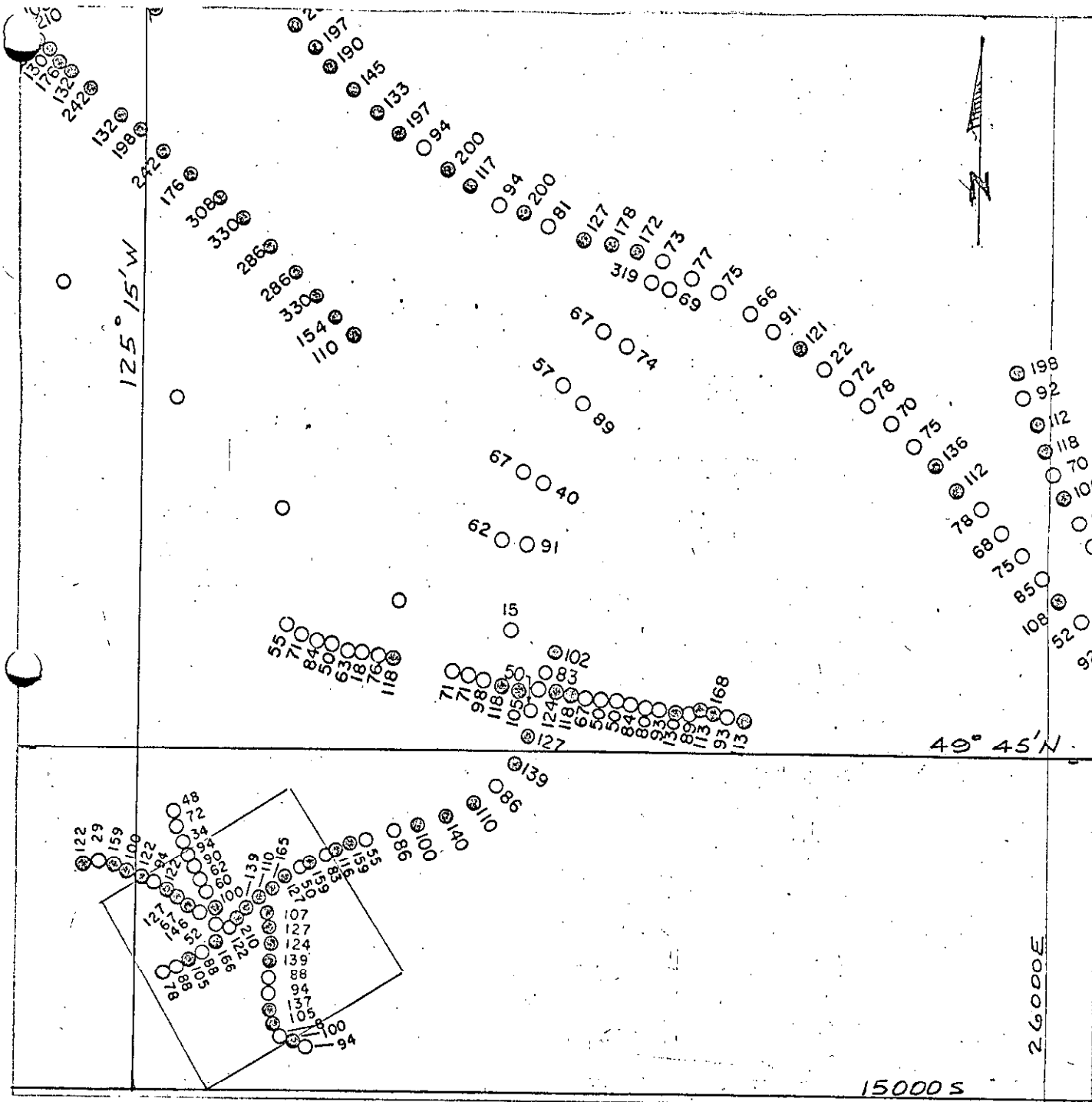

Mt. Washington Copper Mines, Ltd.

Nanaimo M.D.

British Columbia

Geochemical Plan Map

Copper Parts/Million

Scale 1" = 1000'

To accompany Report by

W. G. Stevenson

N 26

REVISED DEC 7, 1961

wyg

WILLIAM G. STEVENSON, P. Eng.

Consulting Geologist

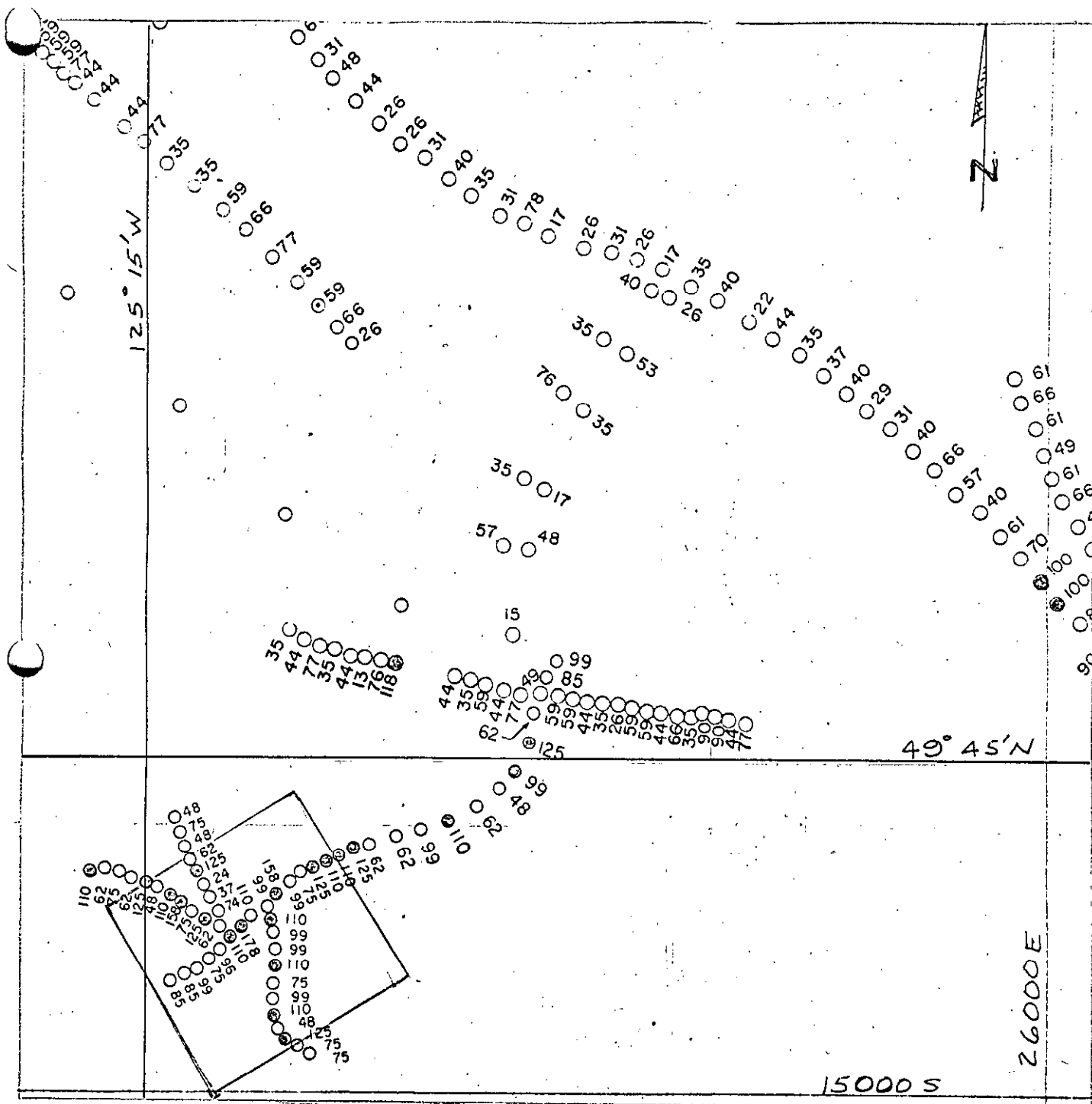

Mt. Washington Copper Mines, Ltd.
Nanaimo M.D.

British Columbia
Geochemical Plan Map
Zinc Parts/Million

Scale 1" = 1000'

To accompany Report by
W. G. Stevenson

N=7

REVISED Dec-7, 1966

wag

SUPPLEMENTAL DATA FOR
GEOCHEMICAL REPORT OF THE
ME NO. 1 MINERAL CLAIM NO. 14990
NANAIMO, B. C.
TO ACCOMPANY REPORT DATED NOVEMBER 10, 1966
BY W. G. STEVENSON, P. ENG.

During the field season 36 samples were collected from a soil horizon immediately below the zone of humus. The depth of the samples varied, though it was consistently in relation to the depth of the humus zone.

The spacial locations of certain of these pits were established from air photos and base maps in relation to specific road and stream intersections. The distance from these specific pits and the bearing to each of the other pits within the claim boundary was established with chain and Brunton compass.

W. G. Stevenson
Dec 9, 1966

WILLIAM G. STEVENSON, P. Eng.

Consulting Geologist

To accompany Report by -
W. G. Stevenson dated November 10, 1966

COSTS

Prospector, Mr. Wm. Lewis at \$750.00/month
Asst. Prospector Mr. D. Parker at \$500.00/month

\$1,250/mo. or \$41.75/day

Two days time \$ 83.50

Assaying at \$1.70/sample (56 samples) 96.90

T O T A L - - - - \$180.40

Declared before me at the *City*
of *Vancouver*, in the
Province of British Columbia, this *10*
day of *November 1966*, A.D.

W.G. Stevenson

Jill Turner

Commissioner for taking Affidavits within British Columbia or
A Notary Public in and for the Province of British Columbia.

SUB - MINING RECORDER

W.G.

TELEPHONE 988-6181
AREA CODE 604

BIO METALS
CORPORATION LTD. (N.P.L.)

ENGINEERING OFFICES
204 - 1515 PEMBERTON AVE.,
NORTH VANCOUVER, B. C.

November 9, 1966

To: W. G. Stevenson
509 - 475 Howe Street
VANCOUVER, B.C.

Project 512

Re: Geo-chemical Analysis Report
Mount Washington Copper Co.

RECEIPT

Received from Mt. Washington Copper Co. the sum of \$96.90
for Geochemical Soil Analysis Report done on 57 samples
at \$1.70 each.

Dave M. Mowbray

NO 8

ways

WILLIAM G. STEVENSON, P. Eng.

Consulting Geologist

509 STOCK EXCHANGE BUILDING
475 HOWE STREET
VANCOUVER 1, CANADA

C E R T I F I C A T E

I, William G. Stevenson, do hereby certify:

1. That I am a Consulting Geological Engineer with offices at Suite 509 Stock Exchange Building, 475 Howe Street, Vancouver, B. C.
2. That I am a graduate of University of Utah, 1946, with a Bachelor of Science degree.
3. That I am a registered Professional Engineer in the Association in British Columbia.
4. That I have practised my profession for twenty years.
5. That this report, dated November 10, 1966, is based on work that has been accomplished under my direction and that I have made periodic trips to this property during the 1966 field season.

Dated at Vancouver, British Columbia, this tenth day of November, 1966.

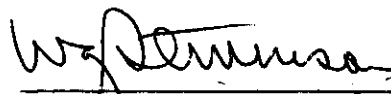

W. G. Stevenson, P. Eng.