

981

SILVER GROUP 1

This is Exhibit "A" referred to in the affidavit of WILLIAM P. WILLIAMS sworn to before me at VANCOUVER in the Province of British Columbia this 6 day of April 1967

A commissioner for taking affidavits within British Columbia

SILVER GROUP 2.

This is Exhibit "A" referred to in the affidavit of William P. Williams sworn to before me at Vancouver in the Province of British Columbia this 6 day of April 1967

A commissioner for taking affidavits within British Columbia

UNITED COPPER CORPORATION LTD.

Geochemical Soil Survey  
Silver 1 to 56 Claims  
Kamloops Mining Division

SILVER GROUP 3.

This is Exhibit "A" referred to in the affidavit of William P. Williams sworn to before me at Vancouver in the Province of British Columbia this 6 day of April 1967

A commissioner for taking affidavits within British Columbia

ALRAE EXPLORATION LTD.

February 23, 1967

TO PROTECT OUR CLIENTS, THE PUBLIC AND OURSELVES, ALL REPORTS ARE SUBMITTED AS THE CONFIDENTIAL PROPERTY OF CLIENTS AND AUTHORIZATION FOR PUBLICATION OF STATEMENTS, CONCLUSIONS AND EXTRACTS FROM OUR REPORTS MUST RECEIVE OUR WRITTEN APPROVAL.

Addendum to  
Geochemical Soil Survey Report  
Silver 1 to 56 claims  
Kamloops Mining Division  
dated February 23, 1967

ALRAE EXPLORATION LTD.

June 2, 1967

TO PROTECT OUR CLIENTS, THE PUBLIC AND OURSELVES, ALL REPORTS ARE SUBMITTED AS THE CONFIDENTIAL PROPERTY OF CLIENTS AND AUTHORIZATION FOR PUBLICATION OF STATEMENTS, CONCLUSIONS AND EXTRACTS FROM OUR REPORTS MUST RECEIVE OUR WRITTEN APPROVAL.

## TABLE OF CONTENTS

	Page
INTRODUCTION . . . . .	1
LOCATION AND ACCESS. . . . .	1
CLAIMS . . . . .	1
GEOLOGY. . . . .	2
GEOCHEMICAL SURVEY . . . . .	2
CONCLUSIONS AND RECOMMENDATIONS. . . . .	3
APPENDIX I . . . . .	5

### MAPS

### Scale

/ Claim Map	1" = 1,600 ft.
✓ Geochemical Survey Station Readings	1" = 400 ft.
✓ Geochemical Survey Grid and Topography	1" = 400 ft.

TO PROTECT OUR CLIENTS, THE PUBLIC AND OURSELVES, ALL REPORTS ARE SUBMITTED AS THE CONFIDENTIAL PROPERTY OF CLIENTS AND AUTHORIZATION FOR PUBLICATION OF STATEMENTS, CONCLUSIONS AND EXTRACTS FROM OUR REPORTS MUST RECEIVE OUR WRITTEN APPROVAL.

## INTRODUCTION

During November of 1966, Mr. D. Reinke and five men conducted a geochemical soil survey on the Silver claims, Kamloops mining division. The field crew, all employees of Alrae Exploration Ltd., were under the general supervision of the writer. During the survey two base lines were established on the claims and chained and flagged compass lines were run between the base lines. Soil samples were taken each 200 feet along these lines, which were 400 feet apart. Samples were subsequently tested at Vancouver, using two methods. Each sample was analysed for copper by the rubeanic acid method and for total heavy metals by the standard dithizone method.

Geology has been investigated briefly by Mr. D.R. Morgan, P. Eng. who prepared a report dated September 1st, 1966, describing the geology and claim locations.

## LOCATION AND ACCESS

The Silver claims are located approximately 63 miles north of Kamloops and 35 miles east of 100 Mile House, B.C. The claims are at the headwaters of Nehalliston Creek, in the vicinity of Silver and Deer Lakes. Approximate coordinates of the group is 51°32N latitude and 120°22W longitude.

The claims are accessible by four wheel drive vehicles from a point 14 miles west of Little Fort, on the road to 100 Mile House. The secondary road leads northward from this point 9-1/2 miles to the claim group.

## CLAIMS

Claims and their record numbers are as follows:

<u>Claim Name</u>	<u>Record Number</u>
Silver 1 - 6	54734 - 54739
Silver 7 - 56	54740 - 54789

All 56 claims are within the Kamloops mining division.

Mr. D.R. Morgan's report describes the apparent contradiction of some of these claims with the TC claims which were located on the same day. He describes the area of claim overlap as approximately equal to that of eight full size claims.

#### GEOLOGY

The claims are underlain by Triassic Nicola volcanics which have been intruded by fine grained grey syenite or monzonite. The map accompanying the report of Mr. D.R. Morgan, shows the distribution of these rock types.

Mr. Morgan also describes disseminated galena in sheared volcanic rocks southeast of Silver Lake. A gold prospect occurring in magnetite and pyrrhotite veins within sheared monzonite occurs immediately south of the claim group.

#### GEOCHEMICAL SURVEY

A reconnaissance geochemical soil sampling program was conducted over essentially all of the claim area by taking soil samples each 200 feet along lines 400 feet apart. The accompanying map shows the distribution and analysis value of these samples. The samples were taken at a depth of six to twelve inches and are composed of clean soil, except in swampy areas. The samples were collected by the field crew and returned to Vancouver to be analysed by a lab technician.

Each sample was subjected to two methods of analysis. First the rubenic acid test for copper was employed by using the cold acetic acid extraction. Relative concentrations of copper in the samples were described by assigning numbers from one to ten, ten representing the test for pure malachite. The second method of

GEOCHEMICAL SURVEY - Page 2

Samples of soil were collected in the field and placed in numbered plastic bags. These samples were then transported to Vancouver for analysis by a lab technician.

Soils were analysed by the rubeanic and dithizone methods which are normally field procedures. Samples were air dried but not screened. Larger pieces within the samples were excluded from the tested material.



Rae C. Jury, P. Eng.

analysis was that of dithizone addition to a buffered 200 milligram sample. The value reported in this method of analysis was the volume in millilitres of dithizone required to reach end point. Since each method is one of relative presentation, there is no obvious correlation between the number values assigned by each of the two methods. As may be seen on the map, the numbered sample values were plotted at each sample station and an interpretation of broad anomalous zones was outlined. Sections were called anomalous only if two or more consecutive samples produced relatively high values. The rubeanic test for copper produced most anomalous readings but high individual samples were encountered by the total heavy metal analysis.

As may be seen on the map, there are three general areas within the claim block of anomalous copper content in the soils. These are in the northwestern section of the claims, the south central section and the eastern portion of the claim group. There are numerous smaller and less definite anomalous areas.

The anomalies requiring first further evaluation work are the three in the south central section of the claims immediately south of Silver Lake. It is within this area that Mr. Morgan describes disseminated mineralization within the volcanic rocks. Each of the other anomalies should, however, be prospected and further tested to determine the source of the metals in the soils.

#### CONCLUSIONS AND RECOMMENDATIONS

Reconnaissance geochemical soil sampling of the Silver claims has indicated several large anomalous areas of metals, particularly copper, within the soils. Mineralization in the form of galena, pyrite and pyrrhotite has been described by Mr. Morgan occurring in volcanic rocks. Intrusive monzonite and/or syenite occurs immediately south of the strongest anomalous areas to the

south and southeast of Silver Lake. This area is recommended as the first target for further evaluation. Detailed geological mapping and induced polarization survey work are recommended as suitable methods for further evaluation.

Respectfully submitted,

*Rae G. Jury*  
Rae G. Jury, P. Eng.



APPENDIX I

Personnel record:

The following employees conducted field work on the Silver claims:

<u>Employee</u>	<u>Occupation</u>	<u>Dates Employed</u>
D. Reinke	Field Supervisor	Nov. 3 - 23, 1966
A. Groome	Sampler	Nov. 3 - 25, 1966
P. Hobbs	Sampler	Nov. 3 - 22, 1966
B. Reinke	Sampler	Nov. 3 - 22, 1966
J. Labourdais	Sampler	Nov. 3 - 23, 1966
W. Davies	Sampler	Nov. 3 - 22, 1966
H. Gerlitzki	Analyst	Dec. 2, 5, 6, 19-22/66 Jan. 1 - 9, 1967 Jan. 11 - 31, 1967 Feb. 1 - 10, 1967
J. Colongard	Analyst	Dec. 12 - 23, 1966
R. Jury	Geological Engineer Supervision	Nov. 1966 - Feb. 1967
M. Lee	Draftsman	Jan. 18, 23, 1967 Feb. 17, 20, 1967

The contract price of the above employees in soil sampling work was \$5,600.00.

And I make this solemn declaration conscientiously believing it to be true, and knowing that it is of the same force and effect as if made under oath and by virtue of the "Canada Evidence Act."

Declared before me at the City  
of Vancouver, in the  
Province of British Columbia, this 7  
day of April 1967, A.D.

*Rae B. Jury*

*[Signature]*  
A Commissioner for taking Affidavits for British Columbia or  
A Notary Public in and for the Province of British Columbia.

120°23'

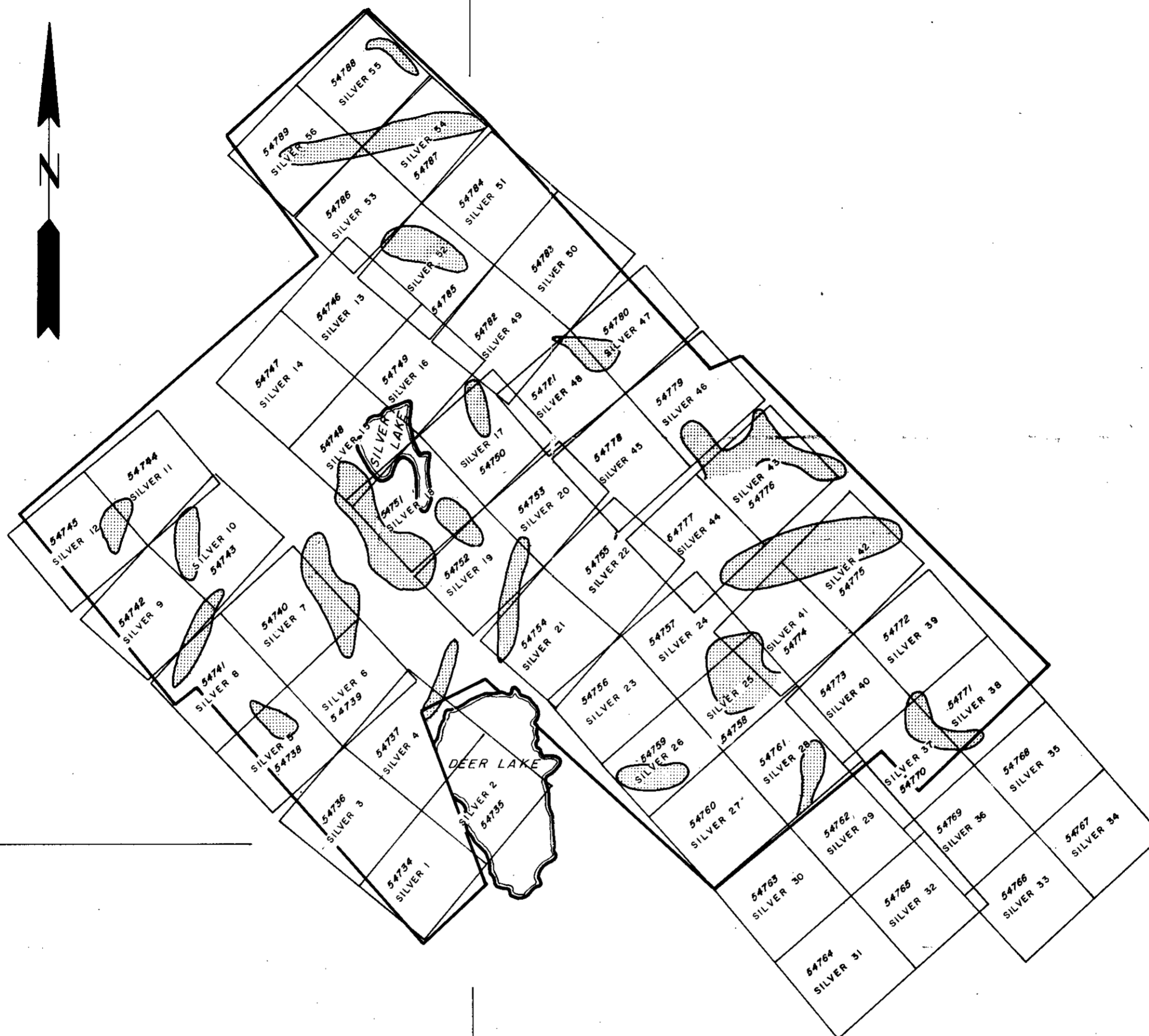

51°32'

51°32'

**LEGEND**

- AREA COVERED BY GEOCHEMICAL SURVEY
- ◻ GEOCHEMICAL ANOMALY

**Department of**  
**Mines and Petroleum Resources**  
**ASSESSMENT REPORT**  
 NO. 981 MAP 1

981

ALRAE EXPLORATION LTD.	
<b>UNITED COPPER CORPORATION LTD.</b>	
SILVER GROUP	
Claim Map	
DRAWN : H.W.C.	SCALE : 1" = 1600'
CHECKED : W.E.C.	DATE : MARCH 1967

120°23'



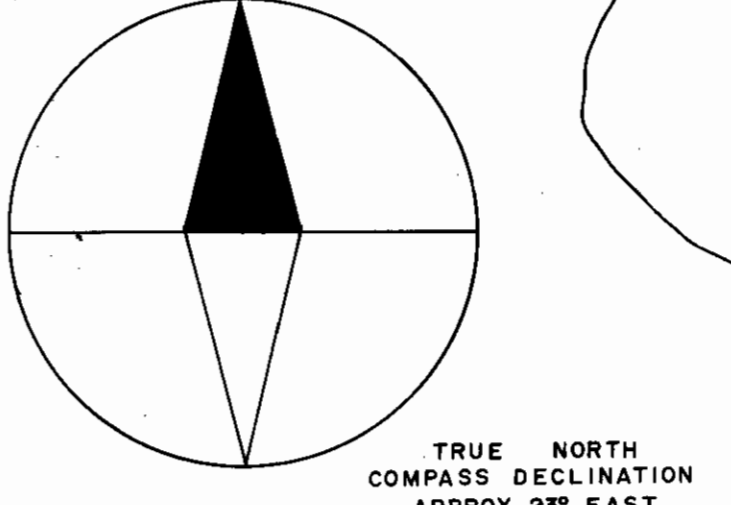
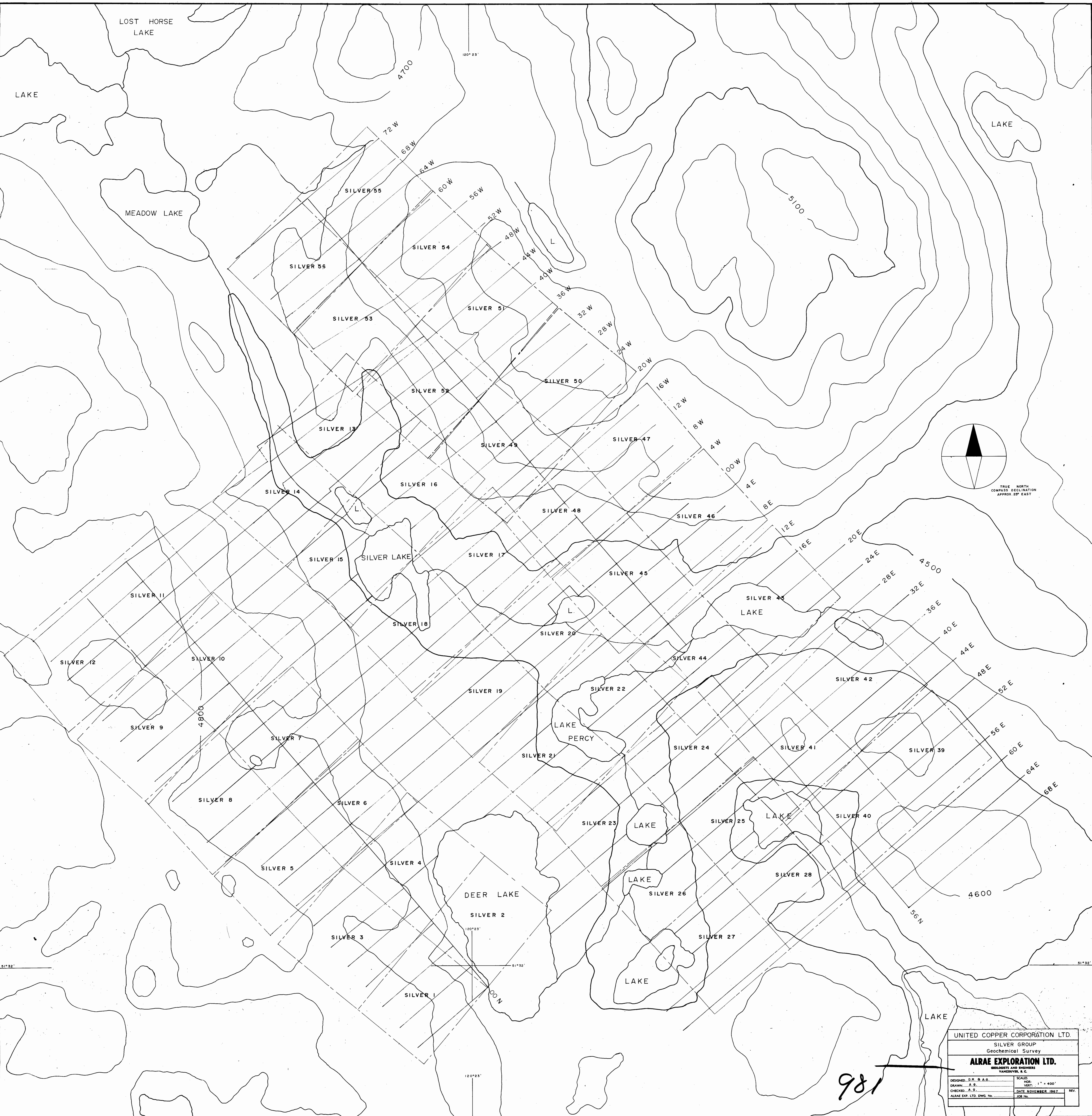

981

UNITED COPPER CORPORATION LTD.	
SILVER GROUP	
Geochemical Survey	
<b>ALRAE EXPLORATION LTD.</b>	
GEOLOGISTS AND ENGINEERS VANCOUVER, B.C.	
DESIGNED: D.R. B.A.G.	SCALE: 1" = 400'
DRAWN: A.S.	FILE: VERT.
CHECKED: A.S.	DATE: NOVEMBER 1987
ALRAE EXP. LTD. DWG. No. _____	JOB No. _____



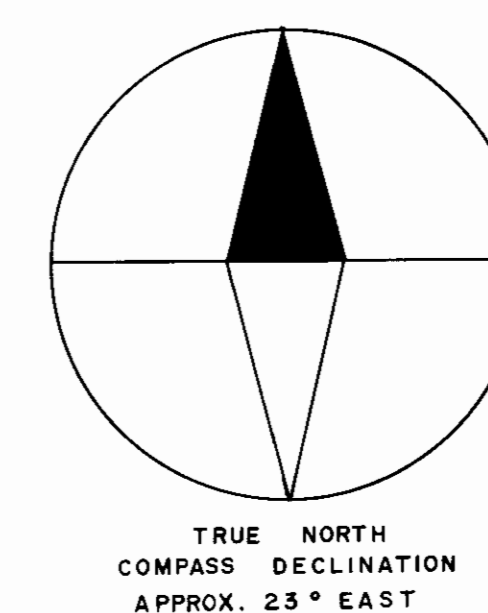
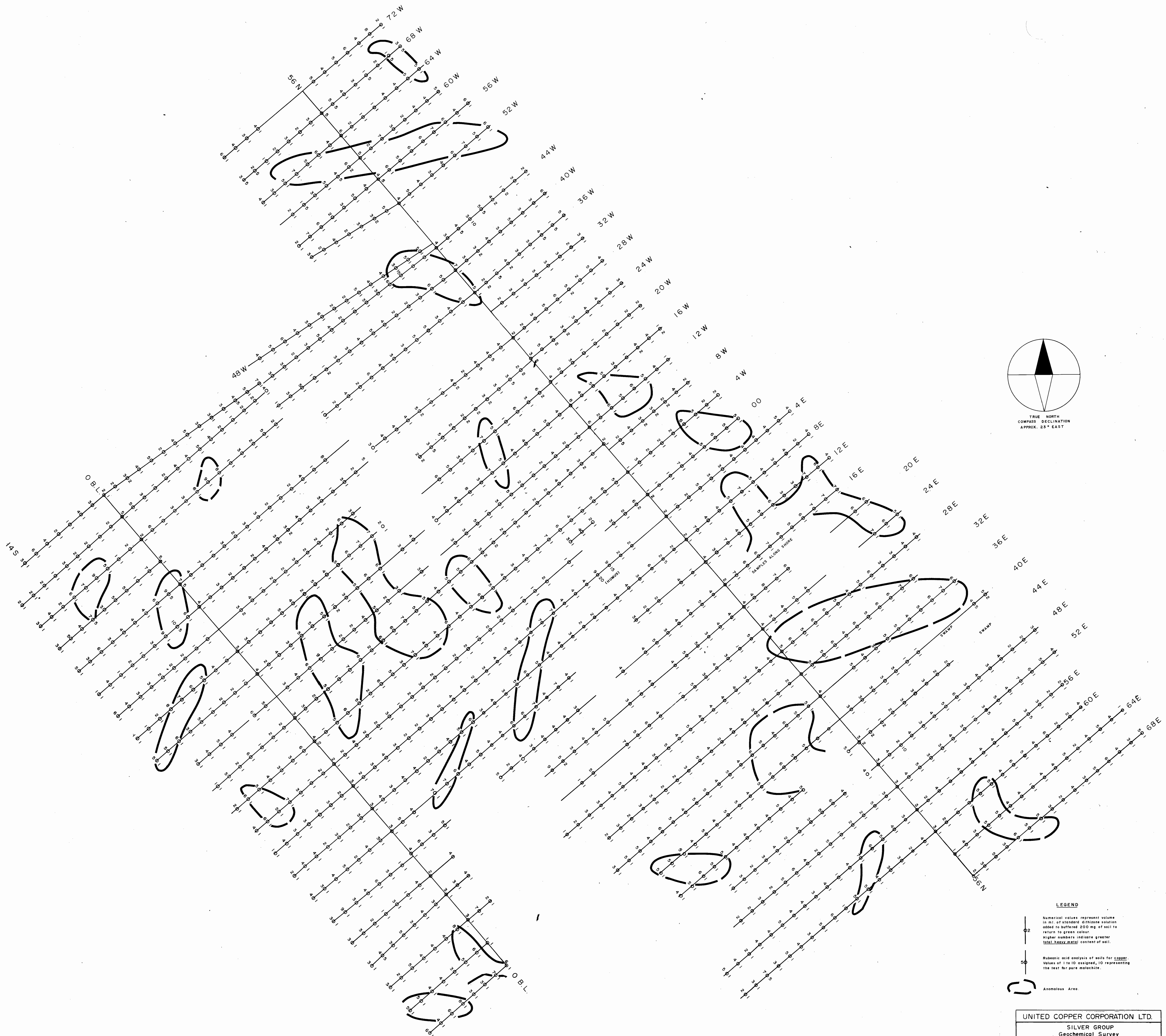

**LEGEND**

Numerical values represent volume in ml. of standard diethane solution added to buffer 200 mg. of soil to return to green colour. Higher numbers indicate greater total heavy metal content of soil.

Rubonic acid analysis of soils for copper. Values of 1 to 10 assigned, 10 representing the test for pure malachite.



Anomalous Area

UNITED COPPER CORPORATION LTD.	
SILVER GROUP	
Geochemical Survey	
<b>ALRAE EXPLORATION LTD.</b>	
GEOLOGISTS AND ENGINEERS VANCOUVER, B.C.	
DESIGNED: R.S.J.	SCALE: 1" = 400'
DRAWN: M.B.L.	CHKD: _____
CHECKED: R.S.J.	DATE: JANUARY 1987
ALRAE EXP. LTD. DWG. No. _____	JOB No. _____

981

To accompany report by R. Perry dated Feb 28, 1987  
*R. A. Perry*