

GEOCHEMICAL REPORT

CM GROUP

7 miles East of Hope, 49° 121° S.E.

92 H/6 W

Author:

G.E.A. von Rosen, P.Eng.

Claims Owned By:

Rayfield Mining Company Ltd. (N.P.L.)

Work Done For:

Rayfield Mining Company Ltd. (N.P.L.)

Work Done by:

Gellco Explorations Ltd.

Dates of Work:

October 8 to October 28, 1967

1147

1147

ABSTRACT

Rayfield Mining Company Ltd. (NPL) holds 20 mineral claims in the Coquihalla area near Hope, B.C. Gellco Explorations Ltd performed a soil sample survey for copper over the property. Results of the survey show that a few anomalous analyses of soil samples were encountered near the east end. Recommendations for further work are made.

REPORT ON
SOIL SAMPLING PROGRAM
ON THE CM MINERAL CLAIMS
COQUIHALLA AREA, HOPE, B. C.
FOR
RAYFIELD MINING COMPANY LTD. (N.P.L.)

by
G.E.A. von Rosen, P.Eng.
L. J. Manning & Associates Ltd.
November 24, 1967

CONTENTS

	<u>Page</u>
SUMMARY	1
LOCATION	1
TOPOGRAPHY & ACCESS	2
CLIMATE, WATER SUPPLY &C	2
CLAIMS	2
GEOLOGY	2
SOIL SAMPLING PROGRAM	3
Crew	3
Procedure	3
Analysis	3
RESULTS	3
COSTS	3
ASSESSMENT	3
CONCLUSIONS	4
FURTHER WORK	4
RECOMMENDATIONS	5
MAPS:	
Location map (bound) #1	APPENDIX
Soil Sample Survey (bound) #2	APPENDIX
AFFIDAVITS:	
Statement of Qualifications	APPENDIX
Certificate of Expenditures	APPENDIX
Field Report: Gelico	APPENDIX

November 24, 1967

The President and Directors,
Rayfield Mining Company Ltd. (N.P.L.),
Vancouver, B. C.

Dear Sirs:

This report summarizes the copper soil sampling survey performed on the 20 CM mineral claims by Gallico Explorations in the Coquihalla area, Hope, B. C. The work was done during September and October of 1967. The author has not visited this property but is familiar with the area in general, having visited a nearby property.

SUMMARY:

Results: Some copper geochemical readings have been encountered at the east end of the claim group.

Recommendations: Mineral claims CM 1 - 4 inclusive should be held in good standing. A program, costing about \$2,000.00 can be envisaged to adequately check out the anomalous readings on these claims. Work would consist of geological mapping where possible, further geochemical sampling, and a magnetometer survey.

LOCATION:

The claims lie on the north side of Peers Creek in the Coquihalla drainage east of Hope, B. C. The property is in the New Westminster Mining Division at about $49^{\circ}23'$, $121^{\circ}17'$, in the N.T.S. number 92 H 6.

TOPOGRAPHY AND ACCESS:

Access is by four wheel drive from the Coquihalla Road. A logging road passes through the claims. The terrain is difficult to traverse because of dense underbrush, heavy tree growth and steep mountain sides. The westernmost claims are in the valley near the mouth of Peers Creek at an altitude of 1,000 feet, whereas the easternmost claims lie near 3,500 feet.

CLIMATE, WATER SUPPLY, ETC.

Plentiful but erratic precipitation both summer and winter, support numerous streams; July and August being the driest months. Field season in this region lasts from about June to October. Good stands of timber occur in most of the region.

CLAIMS:

Mineral claims CM 1 - 20 inclusive, owned by Rayfield Mining Company Ltd. (N.P.L.) by right of purchase, expire on December 14, 1967. Their record numbers are 18392 - 18411 inclusive.

GEOLOGY:

Geological mapping as shown on Map 737A indicates that the property is underlain by rocks of the Mozameen series. Mr. E. North of Gelco Explorations observes that on the property, vegetation and shallow overburden obscure most of the bedrock except in the lower part of Peers Creek where folded argillites with minor limestone and some dioritic rock are exposed along the logging road.

Little information is available regarding the claims on the east higher up the mountain. The map in Cairnes' Memoir 139 suggests the presence of greenstones approximately where the easternmost claims would lie. Greenstones have been known to host mineralization in the area.

SOIL SAMPLING PROGRAM:

Crew: Gallico Explorations performed the survey and supplied the crew consisting of E. North and D. McLean.

Procedure: A grid was cut with baselines at 090° and 077°. The lines at 500 feet had sampling stations every 500 feet up to a total width of 3,000 feet centred by the baseline.

Samples were taken near bedrock and in most cases the profile consisted of about 6 inches of humus overlying 12 inches of soil. In a few samples vegetal matter was included in the soil sample indicating paucity of a soil cover on bedrock.

Analysis: Copper was extracted using hot nitric acid and analyzed by atomic absorption.

RESULTS:

Results are plotted on the accompanying plan. Some minor anomalies have been outlined. An overall background value of around 30 p.p.m. copper could be used on this survey. Higher values occur at the east end.

COSTS:

Gallico Explorations: Services Rendered	\$ 1,860.00
Analysis Soil Samples	295.20
Engineering and Report	<u>250.00</u>
	\$ 2,369.20

Number of Claims - 20
Number of Samples - 216

Cost per claim	\$ 118.46
Cost per sample	11.00

ASSESSMENT:

The cost of the survey should be applied for assessment on the following claims:

ASSESSMENT: (Continued)

<u>Claim Name</u>	<u>Record Number</u>	<u>New Expiry</u>
CM #1	18392	Dec. 14, 1972
CM #2	18393	Dec. 14, 1972
CM #3	18394	Dec. 14, 1972
CM #4	18395	Dec. 14, 1972

CONCLUSIONS:

The soil sampling survey performed at reasonable cost, did cover the 20 CM mineral claims. Results indicate anomalous values near the east end of the claim area approximately covered by CM 1 - 4 inclusive. Further ground work in this restricted area is necessary to check out the anomalous samples.

FURTHER WORK:

The following costs can be allocated towards a more detailed survey, (geophysical, geochemical and geologic) of the four claims:

2 man tent camp	\$ 300.00
1 geologist 2 weeks	450.00
1 helper 2 weeks	300.00
Sustenance 2 men, 2 weeks	150.00
Travel	100.00
Sample analysis	150.00
Magnetometer rental - 2 weeks	100.00
Supervision	<u>250.00</u>
	\$ 1,800.00
Contingencies	<u>200.00</u>
	<u>\$ 2,000.00</u>

RECOMMENDATIONS:

1. Let mineral claims CM 5 - 20 inclusive expire.
2. Apply assessment to CM 1 - 4 inclusive to hold until December 1972.
3. Follow-up anomalous copper soil readings by more detailed ground work mentioned above at a cost of \$2,000.00.
4. Base further work on results of this program.

Respectfully submitted,

L. J. MANNING & ASSOCIATES LTD.

G. E. A. von Rosen, P. Eng.

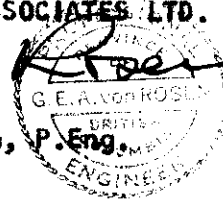

GEAvR:mjr

STATEMENT OF QUALIFICATIONS

I, G. E. A. von Rosen of the City of Vancouver, in the Province of British Columbia, hereby certify as follows:

1. That I am a Geological Engineer
2. That I am a graduate of the University of British Columbia (B.Sc. 62, M.Sc. 66)
3. That I am a registered Professional Engineer of the Province of British Columbia residing at 2149 Vanness Avenue, Vancouver 12
4. That the company, Gellco Explorations Ltd., has adequately performed this type of survey before

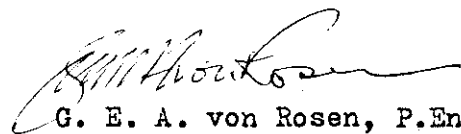
G. E. A. von Rosen, P.Eng.

December 1, 1967
Vancouver, B.C.

Gelco Explorations Ltd.

Certificate of Expenditures

Line cutting and soil survey for Rayfield Mining Co. on the C.M. claims #'s 1 - 20.

Wages

Ernest North	Oct. 8/67 to Oct. 17/67.	480.00
Box 523	8 days @ \$60 per.	
100 Mile House, B.C.		
Doug MacLean	Oct. 8/67 to Oct. 17/67.	320.00
Lac La Hache, B.C.	8 days @ \$40 per.	
Dan MacLean	Oct. 8/67 to Oct. 10/67.	150.00
Lac La Hache, B.C.	3 days @ \$50 per.	
	Sub Total	\$ 950.00

Rentals

2 Power Saws	3 days	60.00
Truck (4 by 4)	8 days	160.00
Camp Expenses		190.00
Mob. and Demob.		200.00
Management		300.00
	Total	\$1860.00

ADD

Analysis of soil samples	295.20
Engineering and report	250.00
	<u>\$2405.20</u>

[Signature]
 Secretary Treasurer
 Gelco Explorations Ltd.

Declared before me at the *City*, in the *Vancouver*, Province of British Columbia, this *1st* day of *December*, 1967, A.D.
[Signature]
 Gold Commissioner
 A Commissioner within British Columbia

GELICO EXPLORATIONS LTD.

Field Report Of Soil Sample Survey for Rayfield River Mining CO.

The survey was initiated lat in Sept. but had to be suspended because of excessive rain storms, It was started again on the 8th of Oct. 1967 and completed on the 28th of Oct.,

The samples were taken by D. Mclean, Mr. Mclean has had various experience with other companies and has been employed by Gelico Explorations Ltd. since August of 1966 in this and other types of surveys, Mr. Mclean has proven very competant and consientious in his wor k.

Mr. Norths observations of the property are that vegetation and shallow overburden obscure the most of the rock except in the lower part of Peers crk., where he encountered folded argillites with minor lime stone and some dioritic rock exposed along the logging road.

Survey completed on the CM 1 to 20 claims of the New Westminster Mining Division B.C.

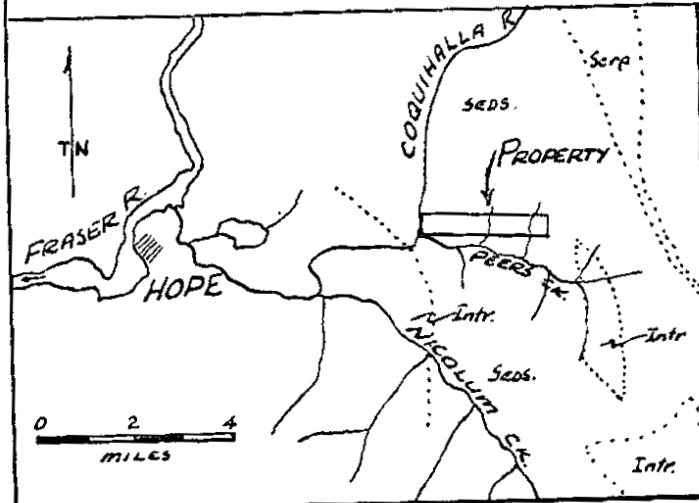
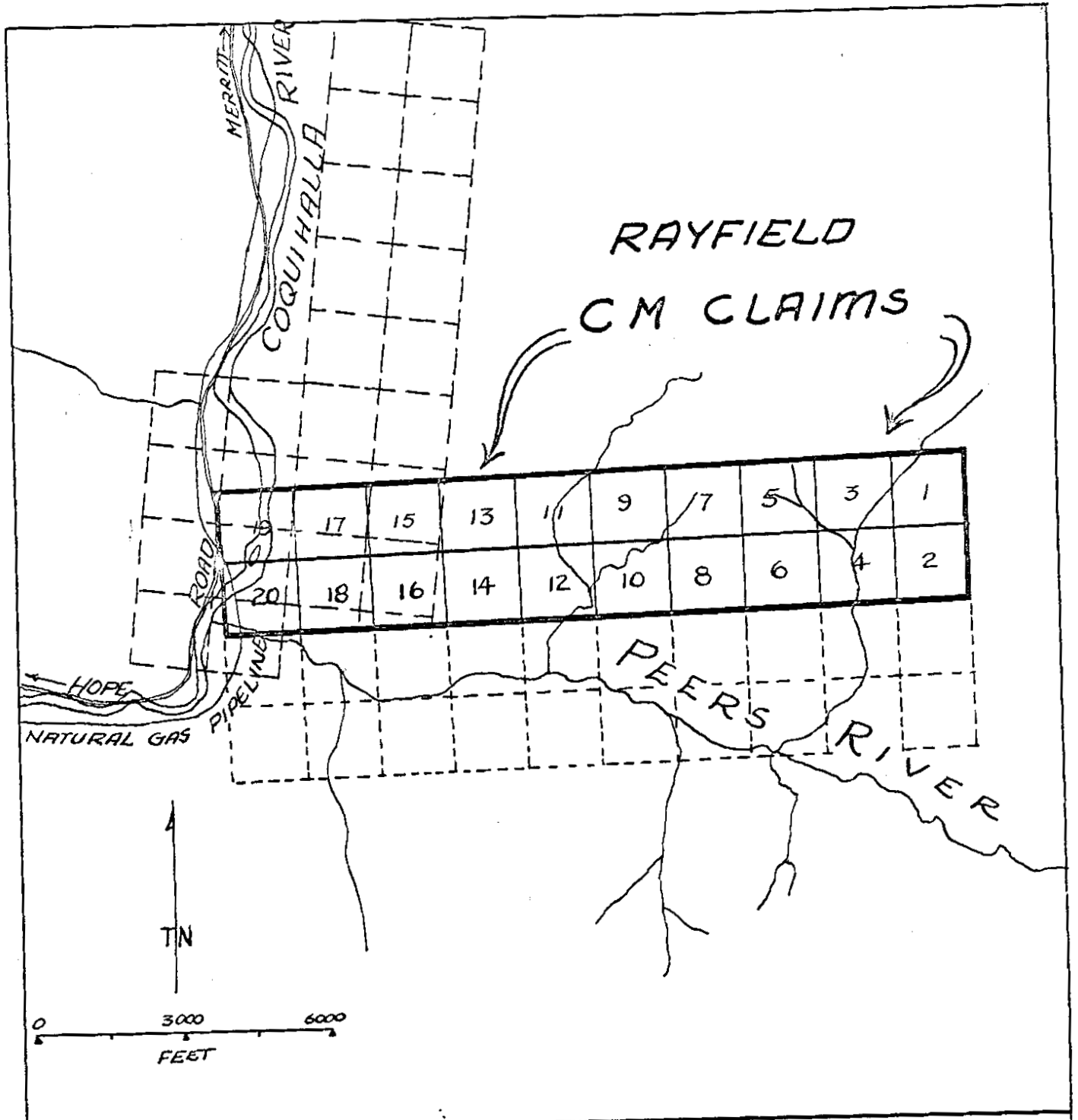

**RAYFIELD MINING
CO. LTD. NPL.
LOCATION
CM CLAIMS
COQUIHALLA R., HOPE, B.C.
L. J. MANNING & ASSOC**

22 x 1 67 GEA.V.2.

L. J. MANNING & ASSOCIATES LTD.
CONSULTING MINING ENGINEERS

610-890 WEST PENDER STREET VANCOUVER 1, B.C.

OFFICE PHONE:
683-5861

RESIDENTIAL PHONE:
L. J. MANNING - 965-5690

January 24, 1968

Rayfield Mining Co. Ltd. (N.P.L.),
650 - 890 West Pender Street,
Vancouver 1, B. C.

Dear Sirs:

In reply to the letter of the 23rd January, 1968 from
Mr. J. F. McDonald, Gold Commissioner, I offer the following:

1. All samples were bared by a mattock and scooped up with the mouth of the paper envelopes provided by T. S. L. Laboratories Ltd.
2. The samples were sealed by the folding procedure inherent in the T. S. L. envelopes and strung on a string.
3. Samples were returned in their envelopes to T. S. L. Laboratories who dried and screened them.
4. All tests were made in the T. S. L. soils laboratory in Vancouver.

I am sorry this data was not included in the original submission.

Yours truly,

L. J. MANNING & ASSOCIATES LTD.

L. J. Manning, P.Eng.

LJM:mjr

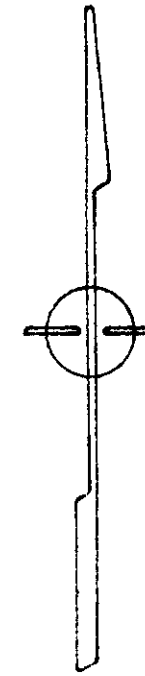

- 66 Soil Analysis pp.m. Copper (hot HNO₃) (contours 25 parts per million)
- ⊙ CLAIM POST exact location
- CLAIM POST approx

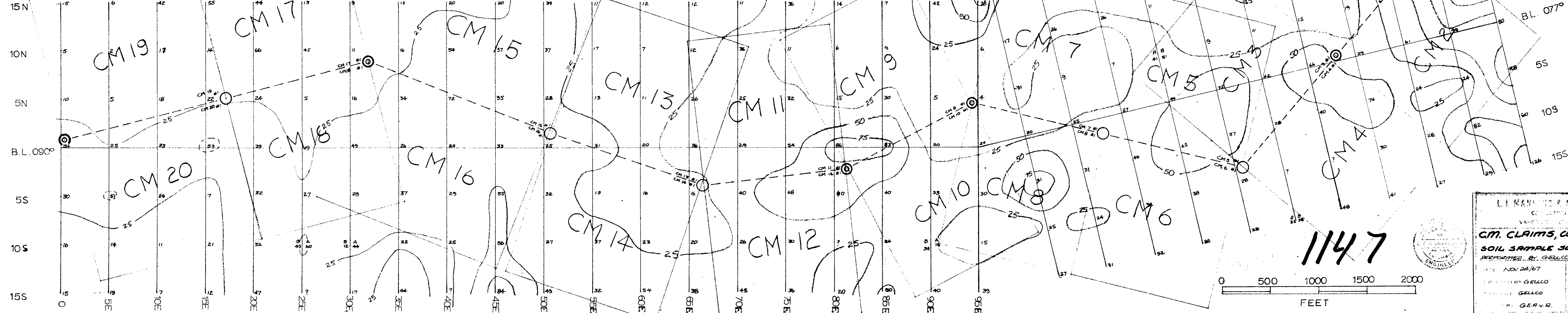
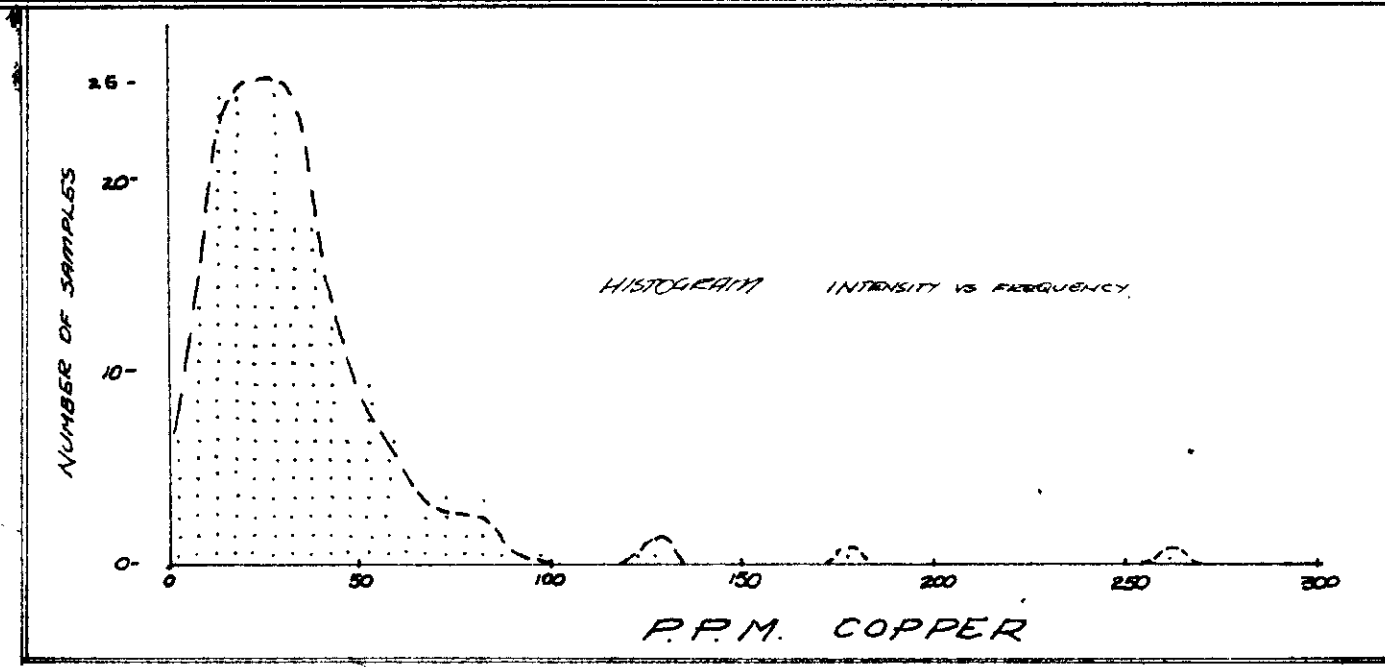

Department of
Mines and Petroleum Resources
ASSESSMENT REPORT
NO. 1147 MAP 2

L.I. MANNING & ASSOCIATES LTD.
CONSULTING ENGINEERS
VANCOUVER, BRITISH COLUMBIA
CM. CLAIMS, COQUIHALLA R.
SOIL SAMPLE SURVEY - COPPER
PREPARED BY GELICO EXPLORATION LTD.
DATE NOV 24/67
DRAWN BY GELICO
CHECKED BY GELICO
G.E.A.N.R.
MAP 2
PLN. NO. NTS
9246-1

1147

John H. ...
11/1/67