



CENTRAL MICROFILM BUREAU

File No. 1248

Not available at time of filming.

Transferred to Active Files.

No TEXT

CM-14

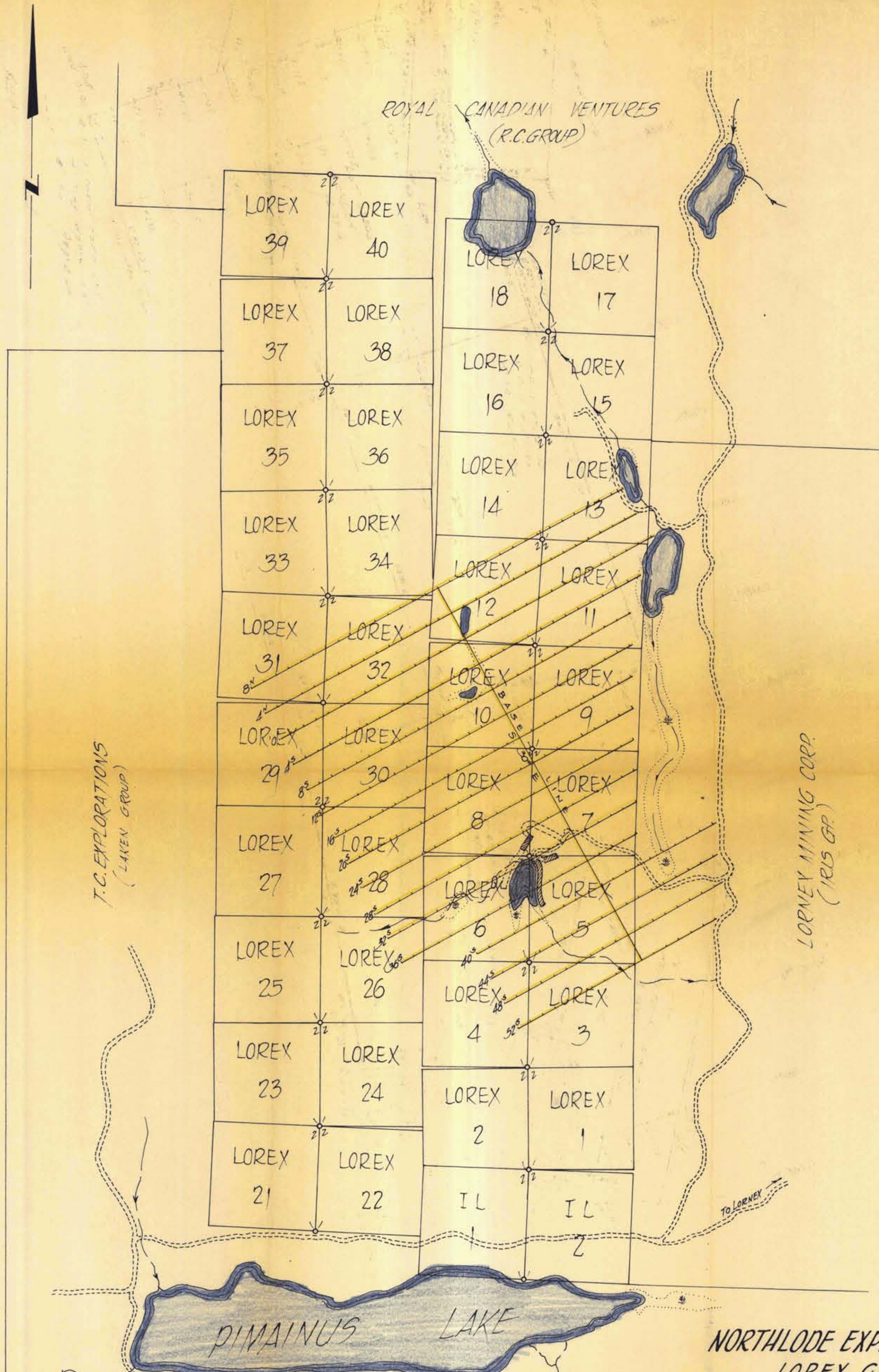

ROYAL CANADIAN VENTURES
(R.C. GROUP)

T.C. EXPLORATIONS
(LAKEV GROUP)

LORNEY MINING CORP.
(IRIS GRP.)

T.C. EXPLORATIONS (P.M. & I.L. GROUP)

NORTHLODE EXPLORATION LTD.
LOREX GROUP
HIGHLAND VALLEY, ASHCROFT, B.C.
SCALE: 1" = 1000'

GRID SYSTEM -
Base Line is on bearing N. 30° W and grid lines are
on bearing S. 60° W. All lines are chained at 100 ft.
horizontal intervals.
Magnetic declination used - 23° 30' East.

1248