

PRELIMINARY REPORT 50° 120' A100  
GEOLOGICAL - GEOCHEMICAL

Chess & Les Claims 92I/15W  
(Chess 2,5,6,7,15 - Les 1,2)  
Kamloops Mining Div.  
British Columbia

NORTH SLAVE EXPLORATION LTD. (N.P.L.)

BY: [REDACTED] PCHUK

JUNE 1962-8

1602

1602

R E P O R T

GEOLOGICAL - GEOCHEMICAL  
PRELIMINARY INVESTIGATION

of the

Chess and Les Mineral Claims  
(Chess 3,5,6,7,15 - Les 1,2.)  
Kamloops Mining Division  
British Columbia  
(N. Lat. 51, W. Long. 120 50)

for

North Slave Exploration Ltd., N.P.L.  
Calgary, Alberta

Submitted by:

*P.A. Philipchuk*

P. A. Philipchuk, P. Geol.

June 10, 1968

108 Roxboro Road, S.W.  
CALGARY, Alberta  
June 10, 1968

President and Directors  
North Slave Exploration Ltd.  
CALGARY, Alberta

Gentlemen:

Please find enclosed my report summarizing and evaluating geological and geochemical surveys conducted on seven mineral claims of the Chess property.

I hope that this compilation will be of practical assistance for planning a more intensive exploration program on the property.

Respectfully submitted,

*P.A. Philipchuk*

P. A. Philipchuk, P. Geol.  
PAP/nls

TABLE OF CONTENTS

	<u>PAGE</u>
SUMMARY AND RECOMMENDATIONS	1
INTRODUCTION	2
TRENCHING AND SAMPLING	2
GEOLOGICAL MAPPING	2
GOEHEMICAL SURVEY	3
CERTIFICATE	4
ILLUSTRATIONS:	
Figure 1 - Claim Map #1	(in pocket)
Figure 2 - Data Map #2	(in pocket)
APPENDIX:	
(a) Assays	5
(b) Soil analyses	6

SUMMARY AND RECOMMENDATIONS

Twenty-nine rock exposures along two creeks on the mineral claims were randomly sampled. Assay results indicate low grade values for lead, zinc, silver and molybdenum, with only traces of gold. See Figure 2, and Appendix (a).

These results prove that random grab sampling is impractical in evaluating vein type ore deposits. Bulk sampling should be carried out only within exposed mineralized shear zones after trenching and blasting. A considerable tonnage should be excavated to determine average grade of ore.

Twenty-five soil samples systematically taken along two traverse lines were analyzed. See Figure 2, and Appendix (b). The results indicate minor shows of copper, zinc, and molybdenum in the soil. These very low metal counts in the overburden along the two survey lines indicate that mineralized shear zones are present at depth but none are in close proximity. The geochemical survey should be continued on a closed spaced grid over the entire property in order to delineate high count anomalous zones that will reflect ore zones at depth.

## INTRODUCTION

From May 6 to 10, 1968, Mr. H. Christie, P. Geol., and Mr. J. Lutz conducted a preliminary geological and geochemical survey over the subject mineral claims under my instructions. This report summarizes and evaluates, a trenching and sampling program, an initial geochemical soil survey, and some sparse geological mapping.

## TRENCHING AND SAMPLING

Samples were picked randomly at twenty-nine locations to determine the nature of the ore mineralization. Appendix (a) contains the assay results from Laborities Limited, Vancouver. The results indicate that high grade mineralization is not widespread over the property. Good results were obtained only from exposed shear zones along Criss Creek and McGee Creek. See Geological Report by P. A. Philipchuk, P. Geol. September, 1967. All mineralized shear zones should be mapped before any additional sampling.

## GEOLOGICAL MAPPING

This program was not carried out in detail. See Figure 2. Only some observed shear zones and quartz veins were geographically located on a base map.

GEOCHEMICAL SURVEY

Twenty-five soil samples were taken over two lines across the claims. These samples, as per normal practice, were obtained from the "B" soil horizon comprising the limonitic layer immediately underlying the organic surface layers.

All soil analyses were performed at Laborities Limited, Vancouver. The determined hot-acid soluble parts Mo., Zn., and Cu. per million of dry, sieved soil are illustrated in Appendix (b).

The results of this program indicate that there are mineralized zones covered by overburden on the property. However, none are in close proximity to the two survey lines because no high anomalous readings were encountered.

CERTIFICATE

I, Peter A. Philipchuk, residing at 108 Roxboro Road, S.W., Calgary, Alberta, DO HEREBY CERTIFY that:

1. I am a consulting geologist.
2. I am a graduate of Queen's University of Kingston, Ontario, with an Honours Bachelor of Science degree in Geological Sciences (1962).
3. I am a registered Professional Geologist in the Province of Alberta.
4. I have practiced my profession since 1962 both in the mining and oil industries.
5. I have personally examined the Chess and Les claims in September 1967. However, the data compiled for this report was obtained by personnel of North Slave Exploration who acted under my supervision.
6. I have no interest, direct or indirect, in the property or securities of the company, nor do I expect to have any such interest in the future.

Respectfully submitted,

*P.A. Philipchuk*

P. A. Philipchuk, P. Geol.

Calgary, Alberta  
June 10, 1968



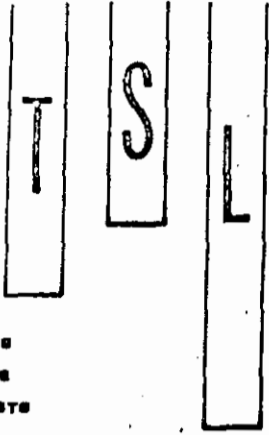

# Laboratories Limited

325 HOWE STREET - VANCOUVER 1, B.C.

TELEX: 04-50613  
CODE NAME: TSL-LABS-VCR.TELEPHONE 688-3504  
AREA CODE 604ASSAYERS  
CHEMISTS  
GEOCHEMISTS**CERTIFICATE OF ANALYSIS**

SAMPLE(S) FROM

REPORT NO.

V3593-2

SAMPLE(S) OF

SOIL (CRISS CREEK)

RESULTS IN PARTS PER MILLION

	SAMPLE No	Cu	Pb	Zn	Ag	Ni	Mo	Co
1	CS 21 TRAVERSE 13+00	15		63			1	
2	CS 22 14+00	23		53			4.5	
3	CS 23 15+00	24		68			4.5	
4	CS 24 16+00	20		75			0.5	
5	CS 25 17+00	30		63			4.5	
6								
7								
8								
9								
10								
11		Cu, Zn, Mo	BY HOT HCl—ACID EXTRACTION					
12								
13		Cu, Zn	DETERMINED BY A.A.					
14								
15		Mo DETERMINED BY Zn—DITHIOL METHOD						
16								
17								
18								
19								
20								

DATE April 26, 1968SIGNED 

DIVISION OF TECHNICAL SERVICE LABORATORIES



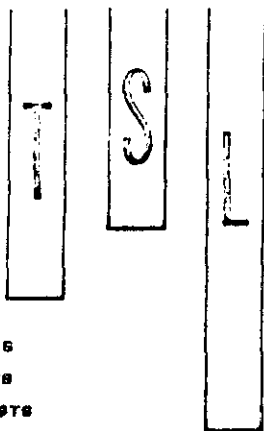

ASSAYERS  
CHEMISTS  
GEOCHEMISTS

# Laboratories Limited

325 HOWE STREET - VANCOUVER 1, B.C.

TELEX: 04-50613  
CODE NAME: TSL-LABS-VCR.

TELEPHONE 688-3504  
AREA CODE 604

## CERTIFICATE OF ANALYSIS

SAMPLE(S) FROM

REPORT NO.

✓3593

SAMPLE(S) OF SOIL (CRISS CREEK)

RESULTS IN PARTS PER MILLION

	SAMPLE No	Cu	Pb	Zn	Ag	Ni	Mo	Co
1	CS-1 TRAVERSE 1 1100	20		45			4	
2	CS-2 2100	18		65			0.5	
3	CS-3 3100	23		88			4.5	
4	CS-4 4100	40		80			<	
5	CS-5 5100	43		72			<	
6	CS-6 6100	50		110			<	
7	CS-7 7100	45		80			<	
8	CS-8 8100	33		97			4.5	
9	CS-9 TRAVERSE 2 1100	52		75			3	
10	CS-10 2100	17		64			3	
11	CS-11 TRAVERSE 2 3100	38		100			7	
12	CS-12 4100	55		125			5.5	
13	CS-13 5100	22		78			3	
14	CS-14 6100	17		100			2	
15	CS-15 7100	28		95			4.5	
16	CS-16 8100	20		90			0.5	
17	CS-17 9100	13		58			4.5	
18	CS-18 10100	28		57			<	
19	CS-19 11100	38		68			<	
20	CS-20 12100	40		58			4.5	

<.5 = less than .5 p.p.m.

DATE April 26, 1968

SIGNED 

DIVISION OF TECHNICAL SERVICE LABORATORIES



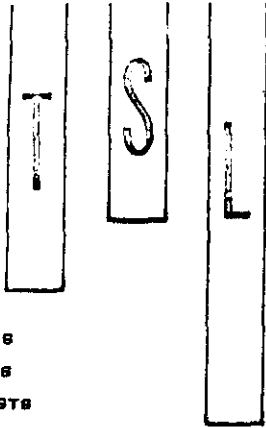

# Laboratories Limited

325 HOWE STREET - VANCOUVER 1, B.C.

TELEPHONE 688-3504

ASSAYERS  
CHEMISTS  
GEOCHEMISTS

## CERTIFICATE OF ANALYSIS

SAMPLE(S) FROM

REPORT NO.  
V-3593  
cont'd

SAMPLE(S) OF

Wt	th (type)	Sample No.	Gold (Au) oz:ton	Silver (Ag) oz:ton	Copper (Cu) %	Lead (Pb) %	Zinc (Zn) %	Molybdenum (Mo) %	Location
g	sample	91877	0.02	1.70	0.23	----	----	----	5
"	"	91879	0.02	1.06	0.08	----	0.05	----	}
"	"	91880	0.05	1.66	0.45	----	0.07	----	
"	"	91881	0.01	1.48	0.13	----	0.10	----	
	Select high grade from dump at trench	91882	0.12	16.58	1.96	4.11	3.62	0.01	}
	4' chip (face of adit)	91883	trace	1.14	0.10	----	0.55	----	
	2 1/2' chip (adit entrance)	91884	trace	1.96	0.18	----	0.40	----	
	Select grab sample	91885	0.01	3.60	0.28	----	0.12	----	}
	grab sample	91886	trace	trace	0.02	0.04	0.06	----	
	"	91887	trace	0.15	0.02	0.14	0.17	----	between 9+10
	chip over 18" shear	91888	trace	0.94	0.10	0.76	0.60	----	}
	6" chip (face of adit)	91889	trace	0.20	0.09	0.04	0.20	----	
	14" chip (adit entrance)	91890	0.015	1.10	0.15	0.31	0.15	----	
	grab	91891	trace	----	0.03	----	----	0.01	road cut near Loc. 11

oz:ton - Troy ounces per 2,000 lbs.

DATE April 26, 1960.

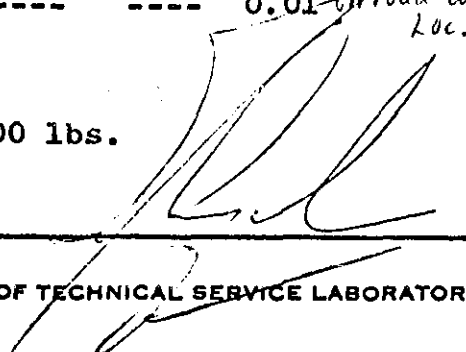
SIGNED 

PULP AND REJECTS DISCARDED AFTER 3 MONTHS

DIVISION OF TECHNICAL SERVICE LABORATORIES

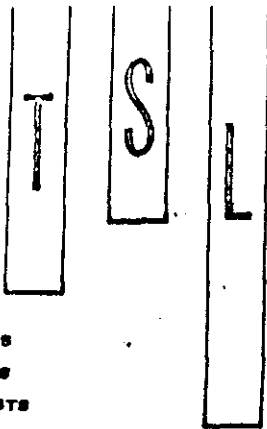

ASSAYERS  
CHEMISTS  
GEOCHEMISTS

APPENDIX (a)

# Laboratories Limited

325 HOWE STREET - VANCOUVER 1, B.C.

TELEPHONE 688-3504

## CERTIFICATE OF ANALYSIS

SAMPLE(S) FROM NORTH SLAVE EXPLORATIONS LTD.

REPORT NO.  
V-3593

SAMPLE(S) OF ROCK

Samples submitted on April 25, 1968

Width (type)	Sample No.	Gold (Au) oz:ton	Silver (Ag) oz:ton	Copper (Cu) %	Lead (Pb) %	Zinc (Zn) %	Molybdenum (Mo) %	Location
1/2" chip across vein	91861	trace	----	0.01	----	----	0.04	11
grab sample (caved acid)	91863	trace	----	----	----	----	0.05	12
1/2" chip across vein	91864	trace	----	----	----	----	0.03	13
grab sample	91865	trace	----	0.01	----	----	0.11	2
"	91866	trace	----	0.02	----	----	0.03	between 2+3 chloritic shea
"	91867	trace	----	0.02	----	----	----	
4' chip samples across best part of vein	91868	trace	----	----	----	----	0.14	} 1
	91869	trace	----	----	----	----	0.08	
grab sample	91870	trace	trace	0.02	----	----	0.02	between 1+2
6' chip across vein	91871	trace	----	0.01	----	----	0.03	4
grab samples	91872	trace	----	0.03	----	----	0.03	} 15
	91873	trace	----	0.01	----	----	----	
"	91874	trace	0.30	0.17	0.09	0.62	0.01	} 5
"	91875	trace	0.70	0.05	0.14	0.38	0.01	
"	91876	trace	0.30	0.02	----	----	----	

DATE April 26, 1968.

SIGNED

PULP AND REJECTS DISCARDED AFTER 3 MONTHS

DIVISION OF TECHNICAL SERVICE LABORATORIES



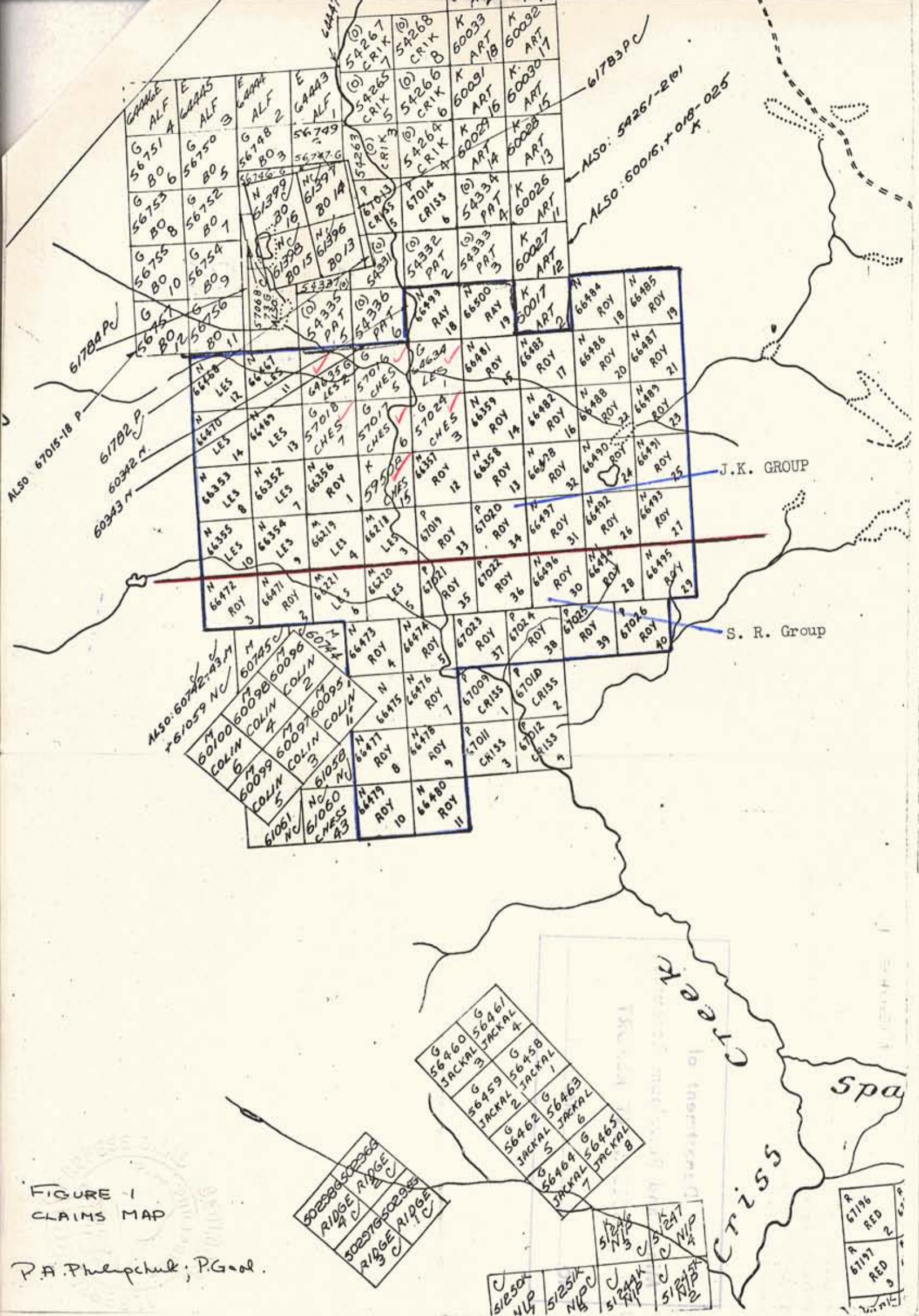



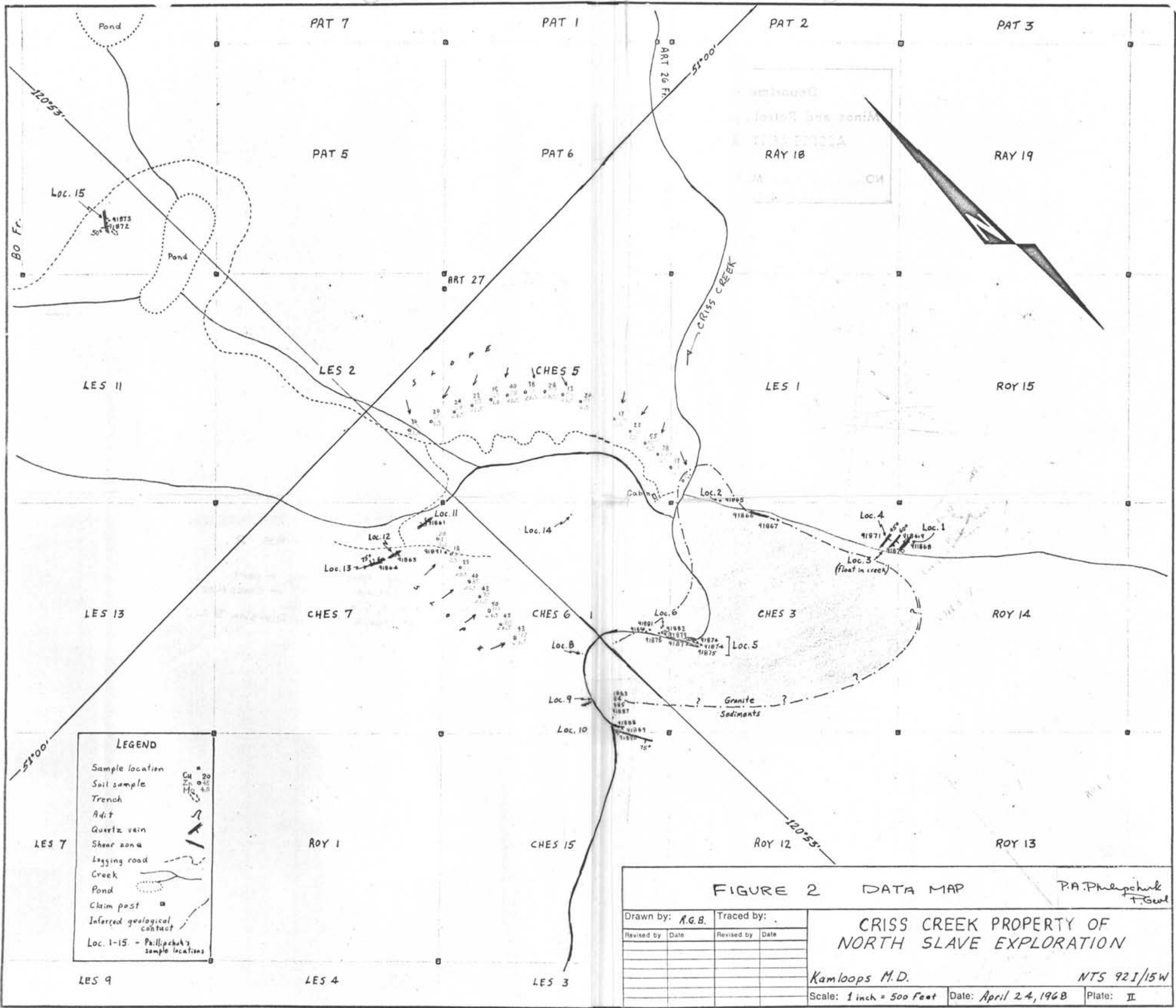

1602

**LEGEND**

Sample location	•
Soil sample	○
Trench	—
Adit	—
Quartz vein	—
Shear zone	—
Logging road	—
Creek	—
Pond	○
Claim post	□
Inferred geological contact	—
Loc. 1-15 - Phillipchuk's sample locations	

**FIGURE 2 DATA MAP**

P.A. Phillipchuk  
T. Geol

Drawn by: A.G.B.	Traced by:	<b>CRISS CREEK PROPERTY OF NORTH SLAVE EXPLORATION</b>
Revised by: _____	Revised by: _____	
		<i>Kamloops M.D.</i>
		NTS 921/15W
		Scale: 1 inch = 500 Feet
		Date: April 24, 1968
		Plate: II