

1693

GEOCHEMICAL SURVEY REPORT ON THE

BIM, TAR, KEN, BEE, CAR, EXPO AND KOL CLAIMS,

NORTHERN VANCOUVER ISLAND, B.C.

AGILIS EXPLORATION SERVICES LTD.

OCTOBER 8, 1968

TABLE OF CONTENTS

	Page
INTRODUCTION. . . . .	1
CLAIMS. . . . .	1
GEOLOGY . . . . .	2
GEOCHEMICAL SURVEYS . . . . .	3
Field Procedures . . . . .	3
Testing Procedures . . . . .	3
Results of Survey. . . . .	3
Kol Group . . . . .	3
Northeast Group . . . . .	4
CONCLUSIONS . . . . .	5
CERTIFICATE . . . . .	6

Maps

Scale

Rupert Inlet Claims (A & B Group) # 1	1 inch = 800 feet
Geo-Chem - Car Claims (B Group) # 8	1 inch = 400 feet
Geo-Chem - Magnet No. 1 Claims # 7 (A Group)	1 inch = 400 feet
Expo Claims - C Group # 6	1 inch = 800 feet
Geo-Chem - Expo Claims (C Group) # 5	1 inch = 400 feet
Geo-Chem Grid - Expo Claims (C Group) # 4	1 inch = 400 feet
Kol Claims # 3	1 inch = 800 feet
Geo-Chem - Kol Claims (B Group - North Line) # 2	1 inch = 400 feet

GEOCHEMICAL SURVEY REPORT ON THE  
BIM, TAR, KEN, BEE, CAR, EXPO AND KOL CLAIMS,  
NORTHERN VANCOUVER ISLAND, B.C.

INTRODUCTION:

The Bim, Tar, Ken, Bee, Car, Expo and Kol Claims total 129 mineral claims divided into two groups, situated north of Rupert Inlet on northern Vancouver Island. The Kol group lies south of the Bay Group of Utah Construction & Mining Co. while the others lie to the north and east.

Port Hardy lies 8 miles north of the Kol Group which is accessible by road or water. Access to the northeast group is by several logging roads.

Relief is low to moderate in the area. Timber and underbrush are heavy and overburden cover is extensive.

Personnel of Magnet Explorations Ltd. conducted geochemical surveys in four separate areas during the period October, 1967 - September, 1968.

At the request of Magnet Explorations Ltd. the writer reviewed and assessed the results of these surveys.

CLAIMS:

The following claims comprise the two groups referred to as the Kol and Northeast Groups.

Kol Group:

<u>Claim</u>	<u>Record No.</u>
Kol 1 - 47	20034 - 80

The survey was conducted on all or portions of the Kol 20, 22, 24, Kol 6 - 8 Fractions, Kol 1 - 3 Fractions, Kol 29 - 34, Kol 40 - 44.

Northeast Group:

<u>Claim</u>	<u>Record No.</u>
Bim 1 - 4	20030 - 33
Tar 1 - 10	19996 - 20005
Ken 1 - 12	20201 - 12
Bee 1 - 24	20006 - 29
Car 1, 3, 5 - 18	19980 - 95
Expo 27 - 32	19836 - 41
Expo 47 - 56	19856 - 65

For this group surveys were conducted on all or portions of Expo 27, 29 - 32, 52 - 56, Car 4 - 8, 11 - 14, Tar 2, 4, 6, Ken 1 - 10, 13 - 15, Bee 1, 2, 4, Bim 1 - 4.

GEOLOGY:

The area is underlain by a northwesterly trending series of volcanics, and to a lesser extent sediments, of Triassic Age, overlain in part by Cretaceous sediments and intruded by Jurassic and Tertiary granitic intrusives. Recent government mapping (J. E. Muller, 1967) indicates the area occupied by the Northeast Group is underlain mainly by Bonanza Formation volcanics and sediments, with possibly Karmutsen volcanics in the northwestern corner. The Bonanza rocks in this area generally consist of andesites and tuffs plus clastic sediments.

Pyrite and minor copper are common in the volcanics of both the Bonanza and Karmutsen Formations.

Government mapping indicates the Kol Group is underlain mainly by Cretaceous sediments, with units of the Bonanza Formation near the northern boundary.

## GEOCHEMICAL SURVEYS:

### Field Procedures:

In all the surveyed areas base-lines were first established then cross-lines run at 400 and 200 foot intervals or, in one area, at 500 and 250 foot intervals. Lines were established by chain and compass and marked by flagging. Samples were collected at 100 foot intervals on all cross-lines.

On the Kol Group, a 4000 foot north-south base line was established and a total of 12½ miles of cross-lines sampled at 100 foot intervals.

On the Northeast Group, 3 separate areas were sampled. In the first, the A-Group, a 6000 foot base line runs N75°W and a total of 22 miles of cross-lines spaced at either 250 or 500 foot intervals were sampled every 100 feet. On the C-Group a 5400 foot long base line trends northwest and 11 miles of cross-lines spaced at either 200 or 400 foot intervals were sampled every 100 feet. On the B-Group, a 5800 foot long north-south base line was established and a total of 5 line-miles of cross-lines spaced at either 200 or 400 foot intervals sampled every 100 feet.

Samples were collected with an auger or mattock and taken, where possible, from the soil horizon immediately underlying the humous layer. In general this consists of a reddish brown clayey sand found at an average of 10 - 20 inches below the surface, but up to 3 - 4 feet deep in swampy areas.

### Testing Procedures:

Samples were tested by Chemex Labs Ltd. of North Vancouver using the atomic absorption method.

All samples were analyzed for total copper, and several in the A-Group for lead and zinc as well. Values are reported in parts per million and have been plotted by the company at a scale of 1 inch = 200 feet.

### Results of Survey:

#### Kol Group:

Background is approximately 40 ppm (parts per

million) copper in this area. Areas greater than 2 - 3 times background might be considered anomalous. Aside from the occasional isolated reading one very weak anomalous area exists and this, occurring on lines 26N and 28N, consists of only 2 readings with a maximum of 93 ppm copper. Readings are slightly higher than background in the surrounding area, but without geologic and topographic data cannot be considered significant.

Northeast Group:

A-Group: Background for copper is taken as 30 - 40 ppm copper. Several weak to moderate intensity copper anomalies occur in the northern portion of the group. The most significant occurs on lines 52.5 - 57.5W, measures approximately 500 by 400 feet, and extends north onto the adjoining property. Anomalous zinc values are associated with the copper. Copper-lead-zinc mineralization has been exposed on the property to the northwest.

Several small anomalies occur along the northern portion of lines 30W - 40W, the largest extending from 30W to 37.5W and centered at 43N.

A copper anomaly  $3\frac{1}{2}$  - 4 times background occurs from 15W - 20W, 14N - 17N, and a narrow anomalous zone trends westerly from 25W, 18N to 35W, 18N.

C-Group: Background is taken as 30 - 40 ppm copper. Anomalous values twice background or greater occur on lines 4S - 12S between approximately 12W and 9W. Peak value is 150 ppm copper. A second, slightly weaker anomaly extends from 0, 25E to 8N, 25E measuring approximately 200 feet in width. Other anomalous areas consist of only 1 or 2 readings and are not considered significant.

B-Group: Background is 30 - 35 ppm copper. The largest and strongest anomaly occurs between lines 0 and 8S and measures approximately 1400 feet in an easterly direction by 400 - 500 feet wide. Values vary up to 440 ppm copper. Several other small anomalies consisting of 3 or 4 readings are found to the north. One of slightly larger extent, occurring near the eastern end of lines 12N and 14N, measures 600 by 300 feet, with a peak value of 200 ppm copper.

CONCLUSIONS:

Several anomalous areas warranting investigation have been located in the regions soil sampled. However, additional information regarding geology, topography, etc. is necessary before the significance of these can be determined.

The smaller ones, consisting of 2 or 3 readings and isolated high values, can probably be attributed to minor copper mineralization common in the volcanics within the area. Those anomalous for copper and zinc in the northwest portion might be caused by copper-lead-zinc mineralization associated with limestone bands similar to that found to the northwest. Aside from these, the most significant anomaly is that occurring on 4S - 8S at the northern edge of the Expo claims.

Respectfully Submitted,



R. H. D. Philp, P. Eng.

AGILIS EXPLORATION SERVICES LTD.

CERTIFICATE

I, Ronald H. D. Philp of 812 Blundell Road, Richmond, British Columbia, do hereby certify that:

1. I am a registered Professional Engineer of the Province of British Columbia.

2. I am a graduate from the University of British Columbia (B.A. Sc. 1961).

3. I have practiced my profession since 1961 while employed with Caseco Consultants Ltd., Asbestos Corporation (Explorations) Ltd., Alrae Exploration Limited, and Agilis Exploration Services Ltd.

4. My report is based on a review of the maps and field data supplied by Magnet Explorations Ltd. plus my familiarity of the conditions in the general area.

5. I have no interest, nor do I expect to receive any interest, in the property described herein or securities of Magnet Explorations Ltd.



R. H. D. Philp, P. Eng.

Vancouver, B. C.

October 8, 1968



DOMINION OF CANADA:  
PROVINCE OF BRITISH COLUMBIA.  
TO WIT:

In the Matter of THE GEO-CHEMICAL  
SURVEY OVER THE DAWN  
SAHARA GROUPS IN THE  
NANAIMO MINING DIVISION

I, WILLIAM T. A. SMITH  
of BOX 520, PORT HARDY, B.C.

in the Province of British Columbia, do solemnly declare that THE FOLLOWING PERSONNEL  
WERE EMPLOYED AND COSTS INCURRED IN CONDUCTING THE SURVEY  
PERSONNEL:

DORL PORTER, SOIL SAMPLER, OCT 27-NOV. 7, 1967, JAN 8-JAN 25, FEB 12-MAR. 3, MARCH 12-MARCH 18, MARCH 27-APRIL 10, APRIL 18-APRIL 19, MAY 8-MAY 9, MAY 12-MAY 14, JULY 16, JULY 18	82 DAYS @ \$23.75 =	1947.50
BILL SMITH, SOIL SAMPLER, OCT 27-NOV 7, 1967, JAN 8-JAN 20, FEB 12-FEB 23, MARCH 12-13, APRIL 20-APRIL 27, JULY 14-JULY 16, JULY 18	50 DAYS @ \$28.85 =	1442.50
RAY BARLEY, SOIL SAMPLER, MAY 12-MAY 14, MAY 29-JUNE 1, JUNE 3- JUNE 13, JUNE 15, JUNE 24, JULY 18	21 DAYS @ \$23.75	498.75
BOB VAN BAAREN, SOIL SAMPLER, MARCH 27-APRIL 10, APRIL 18-27, MAY 8-9, MAY 12-14, JUNE 3-6, JUNE 12-13, JUNE 24, JULY 18	38 DAYS @ \$23.75	902.50

And I make this solemn declaration conscientiously believing it to be true, and knowing that it is of  
the same force and effect as if made under oath and by virtue of the "Canada Evidence Act."

Declared before me at the CITY  
of NANAIMO, in the  
Province of British Columbia, this 28<sup>TH</sup>  
day of NOVEMBER 1968, A.D.

William T. A. Smith

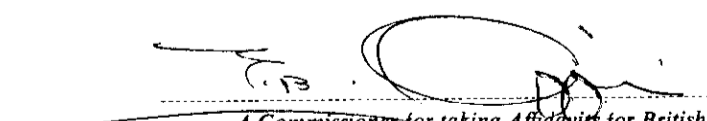
  
A Commissioner for taking Affidavits for British Columbia or  
A Notary Public in and for the Province of British Columbia.

In the Matter of

Statutory Declaration  
(CANADA EVIDENCE ACT)

JOHN ERICKSON, SOIL SAMPLER, MAY 12-14, JUNE 3-6, JUNE 12-13, 9 DAYS @ \$ 23.75	213.75
BILLY ANDERSON, SOIL SAMPLER, OCT 27-NOV 7, 1967, JAN 8-25, FEB 19-26, MARCH 12-15, MARCH 27-APRIL 10, APRIL 18-27, MAY 8-9, MAY 12-14 71 DAYS @ \$ 31.50	2236.50
DENIS MULLIGAN, SOIL SAMPLER, JAN 8-25, FEB 12, MARCH 3, MARCH 12-18, MARCH 27-APRIL 10, APRIL 18-27, MAY 8-9, MAY 12-14, MAY 29, JUNE 1, JUNE 3-13, JUNE 15, JUNE 24 94 DAYS @ \$ 23.75	2232.50
<u>DISBURSEMENTS</u>	\$ 9484.00
GEO CHEMICAL TESTING	5423.00
ENGINEERS REPORT	345.36
TOTAL COST \$	<u>15,252.36</u>

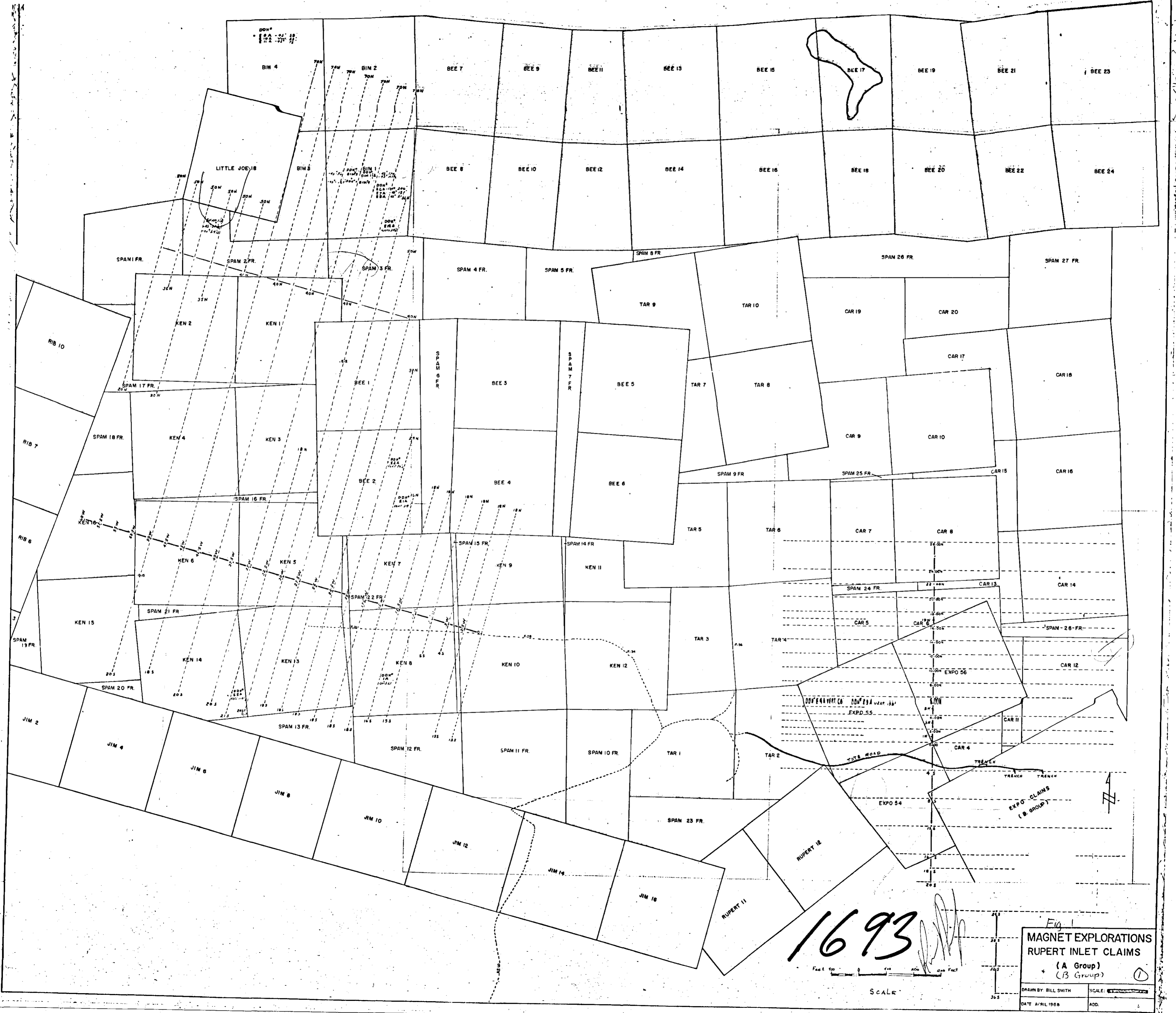

1693

Fig. 1  
**MAGNET EXPLORATIONS**  
**RUPERT INLET CLAIMS**  
 (A Group)  
 (B Group) ①

DRAWN BY BILL SMITH    SCALE: 1" = 100'  
 DATE APRIL 1968    ADD: \_\_\_\_\_

SCALE

Department of  
 Mines and Petroleum Resources  
 APPRAISAL REPORT  
 NO. 1693 Map 2

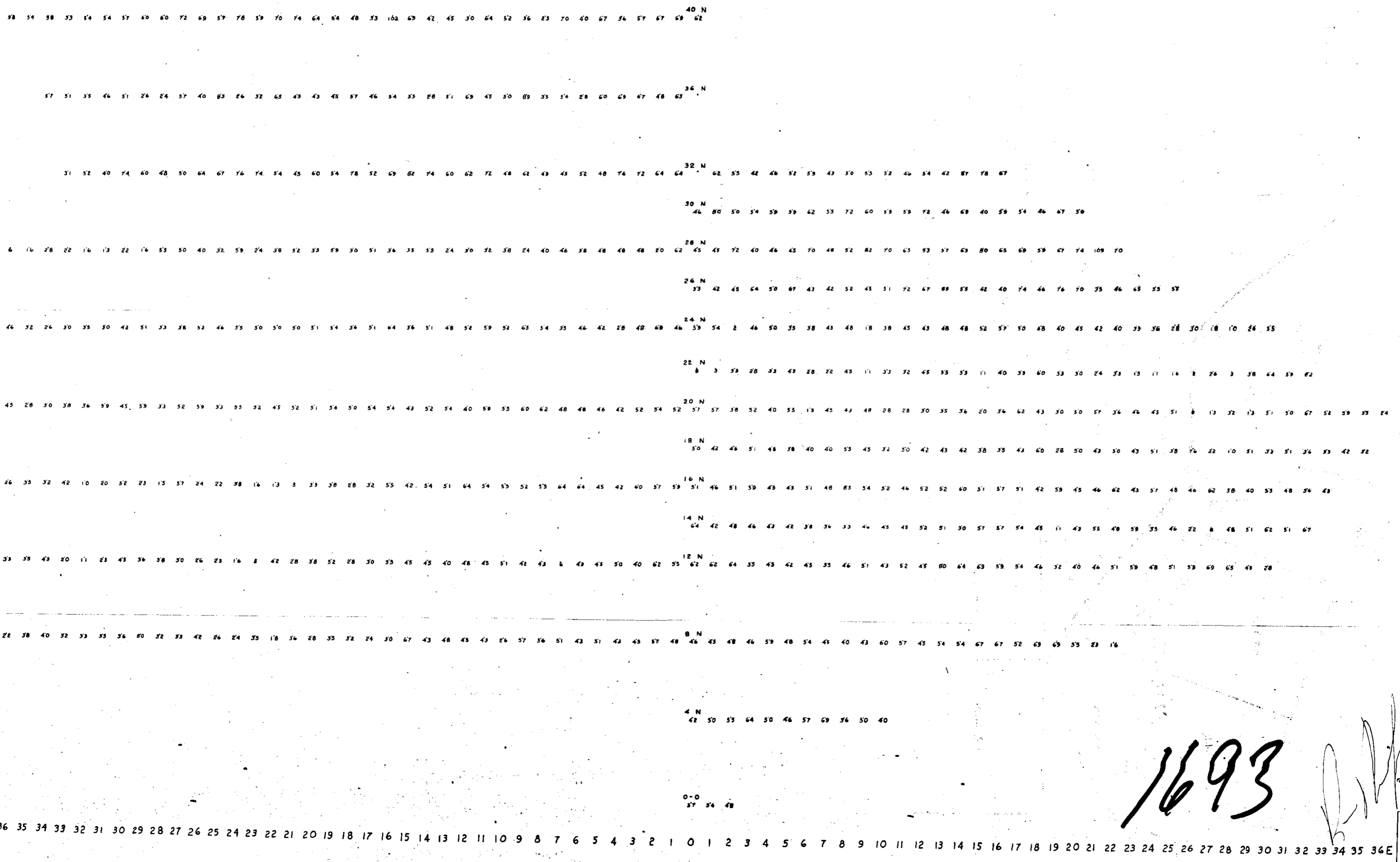

1693

*[Handwritten signature]*

Fig 8  
 KOL CLAIMS  
 GEO - CHEM  
 B GROUP  
 NORTH LINE

DRAWN BY - D. PORTER  
 DATE - JULY 1968

SCALE - 1:50,000  
 ADD -

Department of  
Mines and Petroleum Resources  
ASSESSMENT REPORT  
NO. 1693 MAP 3

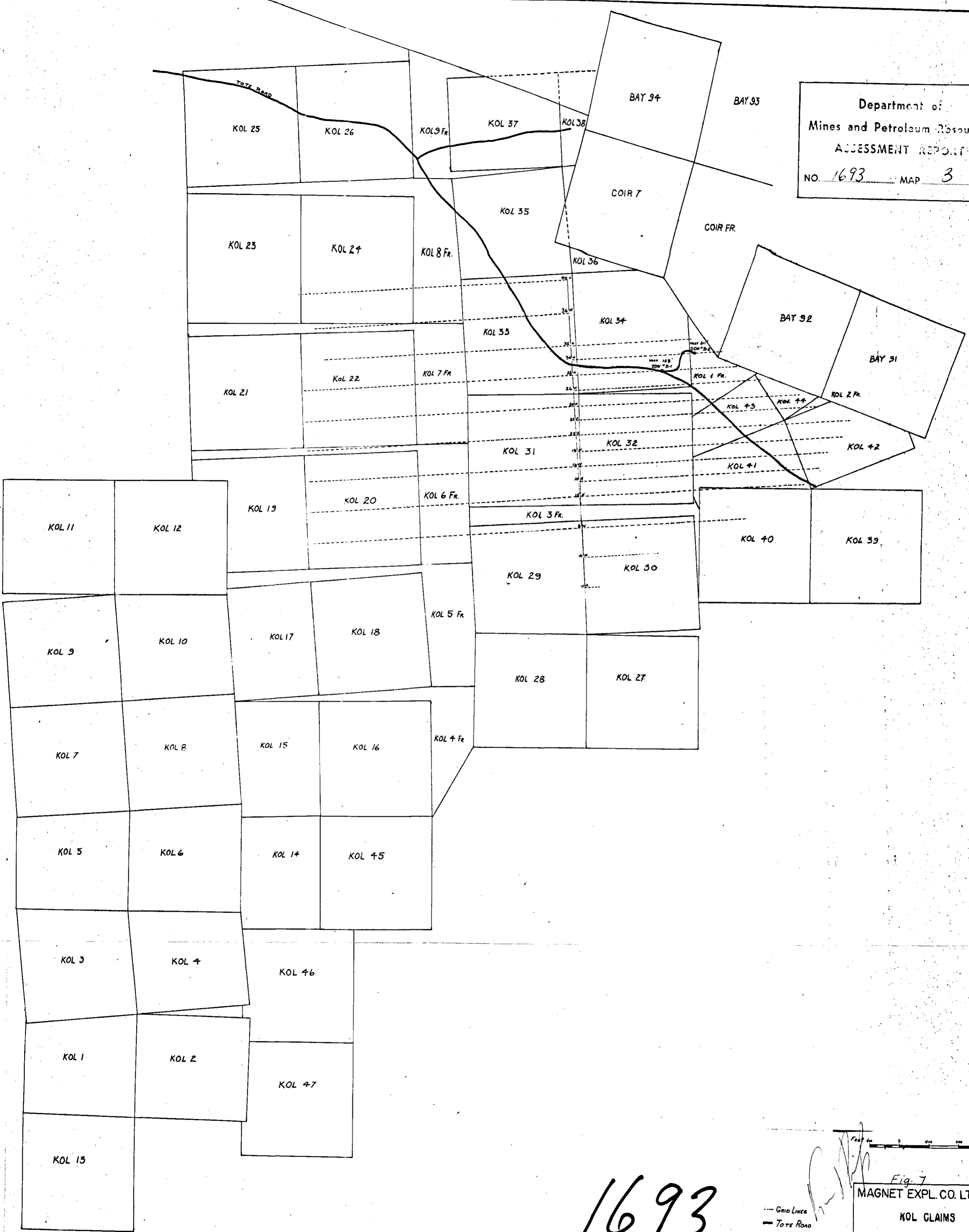

1693

--- GRID LINES  
— TOTE ROAD  
• DRILL HOLES

Fig. 7  
MAGNET EXPL. CO. LTD. (P.L.)  
KOL CLAIMS  
RUPERT INLET (3)

Scale: 0 100 200 300 Feet

DATE: 30th 1968

Department of  
 Mines and Petroleum Resources  
 ASSESSMENT REPORT  
 NO. 1693 MAP 4

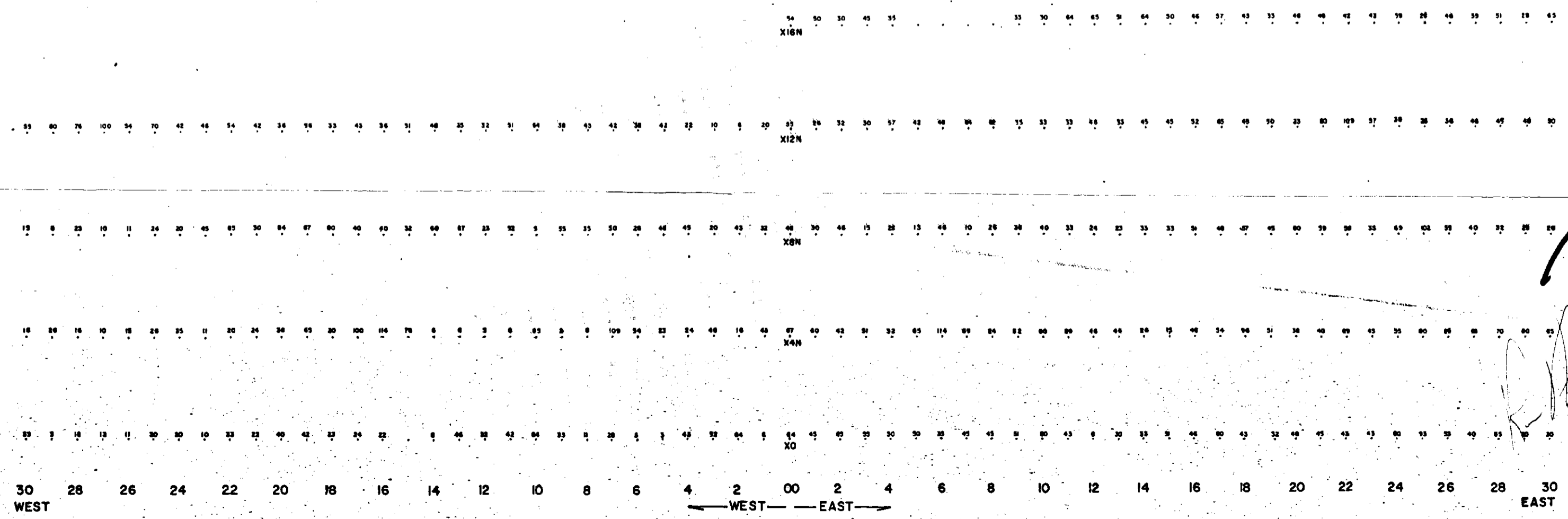

1693

Fig. 6 (4)

MAGNET EXPLORATIONS  
 GEO-CHEM GRID  
 EXPO CLAIMS (C GROUP)  
 NORTH LINE

SCALE 1:50,000

DATE - JUNE 1968

W 30 29 28 27 26 25 24 23 22 21 20 19 18 17 16 15 14 13 12 11 10 9 8 7 6 5 4 3 2 1 0 1 2 3 4 5 6 7 8 9 10 11 12 13 14 15 16 17 18 19 20 21 22 23 24 25 26 27 28 29 30 E

Department of  
Mines and Petroleum Resources  
ASSESSMENT REPORT  
NO. 1693 MAP 5

107 83 83 84 59 63 93 107 32 43 76 98 87 49 103 89 40 32 83 60 82 60 28 69 72 74 38 30 18 37 X4.5

70 80 93 83 83 42 60 57 78 111 76 69 69 48 60 64 94 83 62 64 130 91 96 60 58 48 89 83 83 96 28 X8.5

67 26 38 54 54 33 42 80 72 64 42 82 102 54 60 67 83 102 80 69 45 32 91 16 64 74 35 35 82 117 91 65 67 69 28 65 64 51 93 59 48 43 43 35 24 22 48 22 23 35 54 15 32 X12.5

53 80 74 26 18 62 67 57 76 76 65 89 62 62 65 54 59 52 59 64 46 46 22 59 74 35 30 16 70 85 65 80 28 48 51 46 64 52 69 65 54 52 43 74 54 51 53 69 52 20 57 33 43 28 30 38 50 X16.5

74 80 70 59 30 62 65 64 76 76 72 67 70 72 87 87 72 80 72 76 63 69 67 52 61 65 55 51 51 00 32 98 72 71 72 72 14 83 60 87 47 42 93 89 59 124 65 52 52 59 50 91 48 53 38 50 64 33 62 74 50 X20.5

65 54 60 53 43 43 70 64 57 20 24 137 35 52 74 59 83 46 70 64 70 85 80 60 57 51 24 70 80 42 74 57 51 69 43 50 62 52 48 64 51 54 70 42 62 83 57 89 74 36 24 80 15 X24.5

42 45 50 60 59 53 36 45 52 64 59 23 22 59 20 22 36 6 60 84 23 48 28 30 36 42 16 69 62 30 65 43 23 60 54 57 43 43 42 62 72 57 51 50 67 51 60 X28.5

59 26 38 70 28 3 16 13 22 28 33 10 89 24 55 45 47 36 48 57 70 46 45 22 23 46 50 00 53 X32.5

1693

Fig 5  
GEO-CHEM  
EXPO CLAIMS  
C GROUP  
DRAWN BY: D. PORTER  
DATE: SEPTEMBER 1968  
SCALE: 1" = 400 FEET  
ADO: 5

Department of  
 Mines and Petroleum Resources  
 ASSESSMENT REPORT  
 NO. 1693 MAP 6

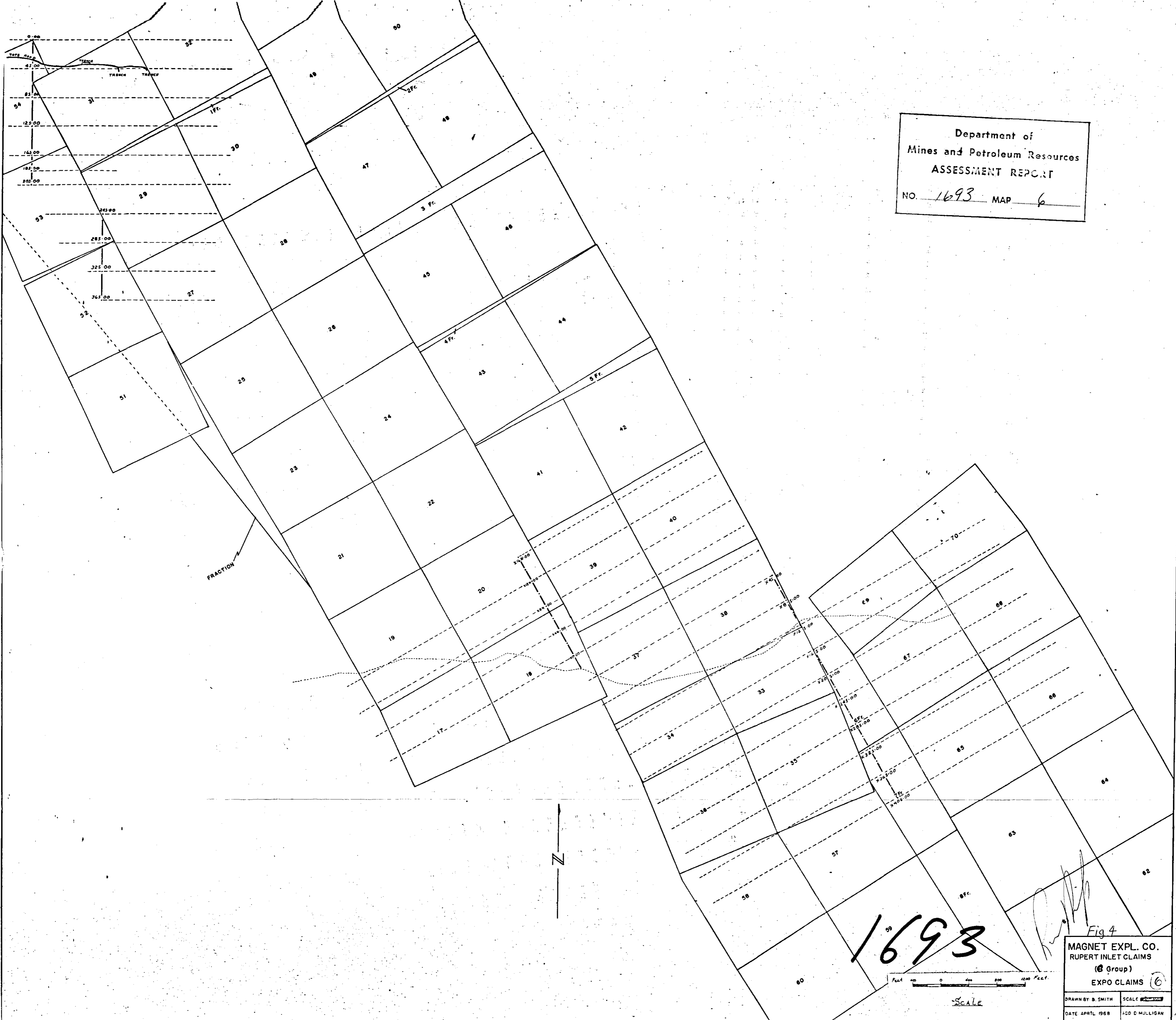

1693

*[Handwritten signature]*

Fig 4

MAGNET EXPL. CO.  
 RUPERT INLET CLAIMS  
 (B Group)  
 EXPO CLAIMS (C)

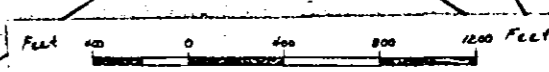

SCALE

DRAWN BY B. SMITH SCALE 1"=100'  
 DATE APRIL 1968 PDD O MULLIGAN



22 20 18 16 14 12 10 8 6 4 2 0 2 4 6 8 10 12 14 16 18 20 22 24 26 28 30 32 34 36 38 40 42 44 46 48 50 52 54 56 58 60 62 64 66 68 70  
SOUTH NORTH NORTH NORTH

Department of  
Mines and Petroleum Resources  
ASSESSMENT REPORT  
NO. 1693 MAP 7

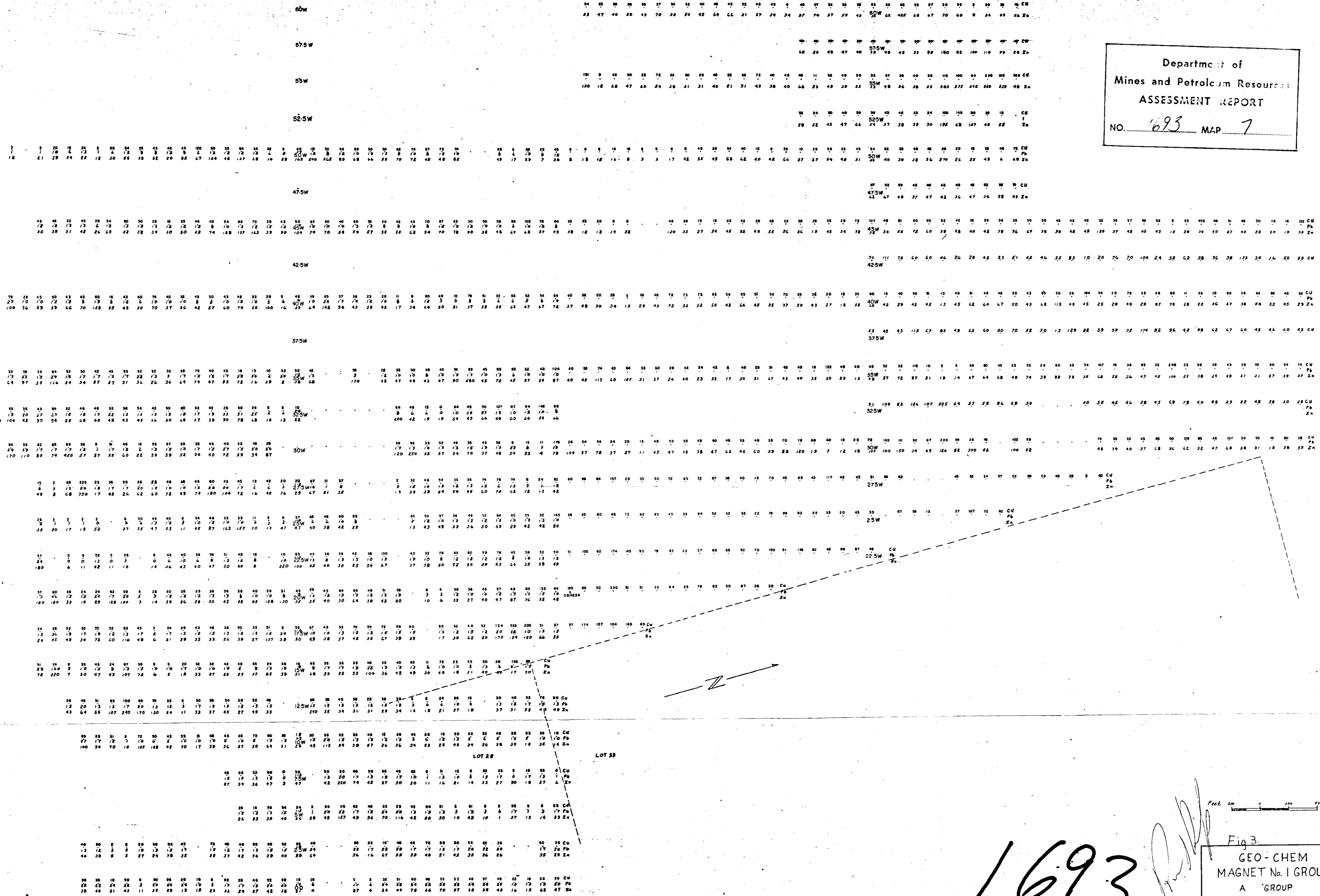

Feet 200 0 200 400 Feet

Fig. 3  
GEO-CHEM  
MAGNET No. 1 GROUP  
A GROUP  
DRAWN BY: D. MULLIGAN SCALE: 1" = 1000'  
DATE: SEPTEMBER 1946 ADD: D. PORTER

22 20 18 16 14 12 10 8 6 4 2 0 2 4 6 8 10 12 14 16 18 20 22 24 26 28 30 32 34 36 38 40  
SOUTH NORTH

