

1695

This is Report No. EM-68-1080
for Aspen Grove Mines Limited,
2 miles Northwest of Wynndel,
B.C.. September 23rd, 1968.

TABLE OF CONTENTS

	<u>PAGE</u>
Purpose	1
Location	1
Instrumentation	1
Type of Survey	2
Geological Reference	2
Presentation	2
Results	2 & 3
Conclusions	3
Recommendations	3
Statement of Costs	4

PLANS

Magnetic Contour EM-68-1080

KLYCEPTOR INTERNATIONAL AIR SURVEYS LIMITED,
250 NORTH GROSVENOR AVENUE,
BURNABY 2, B.C.
298-9619

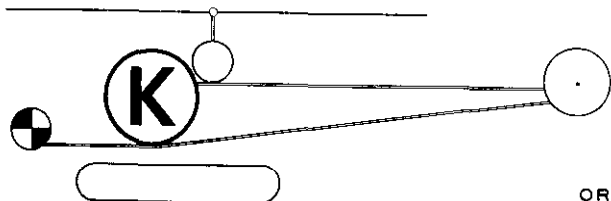

KLYCEPTOR
INTERNATIONAL AIR SURVEYS LTD.

ORIGINATORS OF GEOELECTROMAGNETIC SURVEYS BY AIR
CUSTOM GEOPHYSICAL INTERPRETATIONS

September 23rd, 1968.

KLYCEPTOR GEOPHYSICAL REPORT ON A MAGNETOMETER SURVEY OF THE
TAG, LIZ AND BID CLAIMS FOR ASPEN GROVE MINES LIMITED, LOCATED
APPROXIMATELY 2 MILES NORTHWEST OF WYNNDEL, B.C. No. EM-68-1080
SEPTEMBER 12th TO SEPTEMBER 23rd, 1968.

Purpose:

The purpose of the survey was to delineate boundaries of increased conductivity that might be significant of intrusives within the claims group.

Location:

The survey was conducted over the TAG, LIZ and BID claims approximately 2 miles Northwest of Wynndel, B.C. 116° West and 49° North. The survey was commenced on September 12th and the report compiled September 28th. The survey was conducted under the instruction of R. Reece with instrument operator Roger Williams.

Instrumentation:

The geophysical instrument utilizes signals emitted on 18.6 Kcs., from station NPG located at Arlington in the state of Washington, U.S.A.

The instrument is known as a Ronka EM 16 made by Geonics in Toronto, Ontario.

Type of Survey:

The survey was conducted on the ground with a Ronka type EM-16 electromagnetic infinite source instrument. The readings were taken at 100 foot spaced intervals over 3 northsouth control lines and 4 eastwest lines as indicated on the plan drawing No. EM-68-1080. The total distance of the lines surveyed is 11,000 feet.

Geological Reference:

Geological Survey of Canada. Memoir No. 228,
Page 50.

Presentation:

The presentation is in profile form, showing the inphase and quadrature components on the plan No. EM-68-1080.

The interpretation is based on the polarization and configuration of the anomalies with reference to the adjacent grid lines. The conductivity indicated is determined from related profile phase characteristics. The interpretation is based on the signals originating in the southwest.

Results:

The results as indicated on the plan EM-68-1080 show a linear anomalous feature A1 striking nearly north and south through 3 of the eastwest lines and nearly parallel to the 0 baseline. The linear anomaly L1 appears to be a shear or fracture strike possibly faulting the A1 zone. The L1

linear anomaly does not indicate conductive characteristics. The area within the A1 anomaly boundaries shows improved conduction over the surrounding host rock although these anomalous features are not strong.

The A1 anomaly extends from the south of the LIZ B2 claim through the LIZ B1 claim into the BID 1FR, and BID 2FR claims. The southern offset portion of the anomaly is west of the 0 Baseline extending into the TAG 2 claim.

Conclusions:

The A1 anomaly appears to be valid being independent of topographical features. The readings indicate conduction fairly consistently, to be 150 feet wide. It appears this strike may follow a contact formation. Closer spaced readings would be required for a depth and dip determination. It is understood some surface work has been conducted in the area that might justify the existence of this anomaly .

Recommendations:

If the A1 anomaly proves valid, further work is warranted with sufficient detail, to aid the geological development.

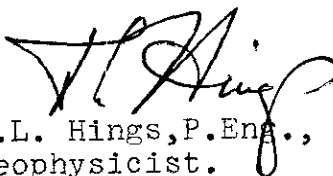
D.L. Hings, P.Eng.,
Geophysicist.

A STATEMENT OF COSTS FOR EM-68-1080 GEOPHYSICAL SURVEY COVERING THE TAG, LIZ AND BID CLAIMS NORTHWEST OF WYNNDEL, B.C. BY KLYCEPTOR INTERNATIONAL AIR SURVEYS LIMITED. SEPTEMBER 12th TO SEPTEMBER 23rd, 1968.

KLYCEPTOR CHARGES:

Survey Crew (2 men)

R. Williams	5 days @ \$25.00	\$ 125.00
R.E. Schultz	5 days @ \$25.00	125.00
		<u>\$ 250.00</u>

Plus 100 % Overhead		<u>250.00</u>
---------------------	--	---------------

\$ 500.00

Transportation:

Airlines	2 @ \$68.00	\$ 136.00
4 x 4 Jeep Rental		<u>60.00</u>

\$ 196.00

Living Costs:

6 man days @ \$12.00		\$ 72.00
----------------------	--	----------

Equipment & Rental Supplies:

Ronka EM-16	1 week @ \$60.00	\$ 60.00
Miscellaneous Supplies		<u>20.00</u>

\$ 80.00

Data Processing & Drafting:

D.A. Cramer	2 days @ \$35.00	\$ 70.00
Plus 100 % Overhead		<u>70.00</u>

\$ 140.00

Interpretation & Report:

D.L. Hings, P.Eng.	2 1/2 days @ \$60.00	\$ 90.00
--------------------	----------------------	----------

Declared before me at the

City

TOTAL

\$ 1078.00

of *Vancouver*

, in the

W. Fynndel

Province of British Columbia, this *31st*

day of *October, 1968*

J. Paul

SUB-MINING RECORDER

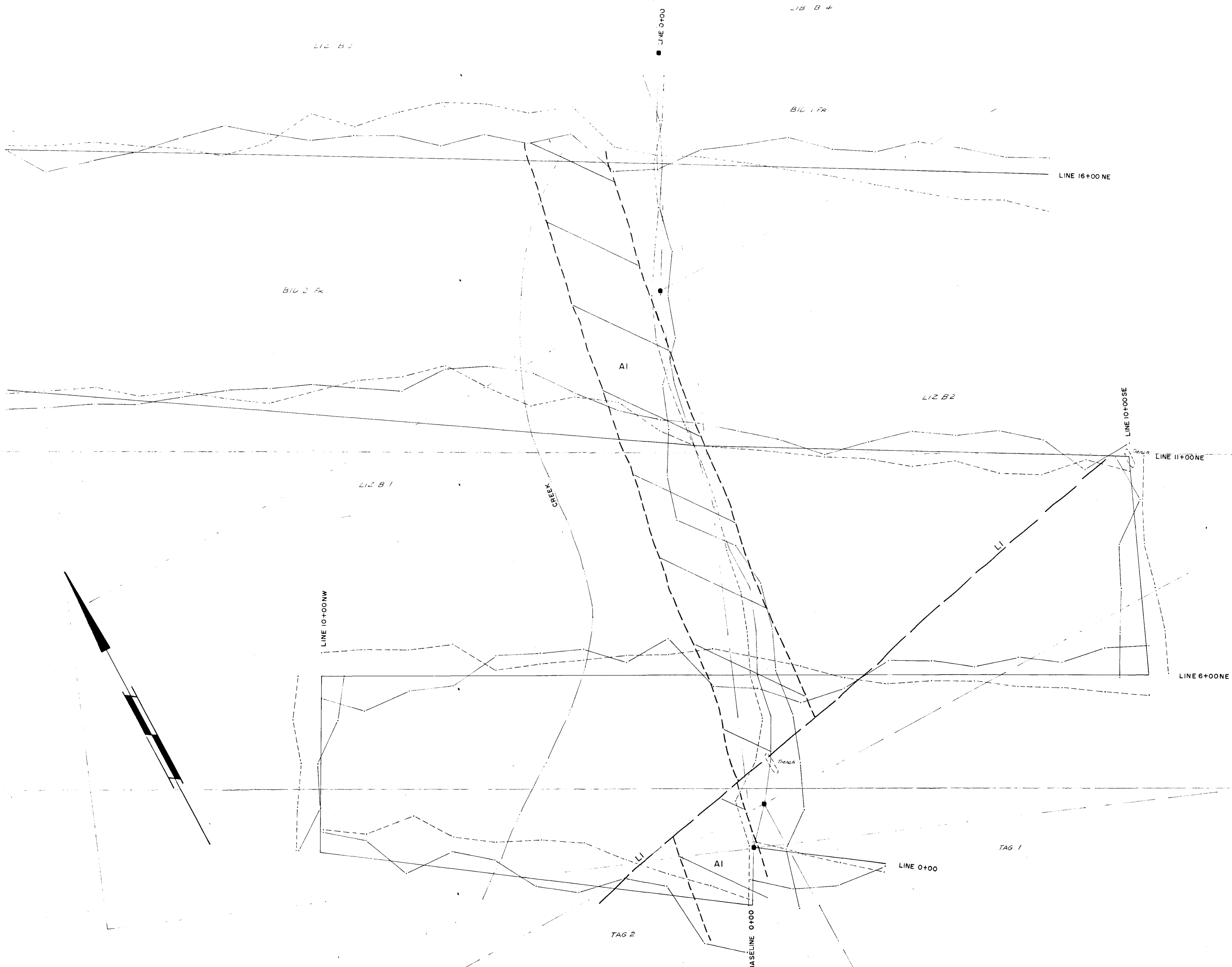

KLYCEPTOR GEOPHYSICAL SURVEY

TAG, LIZ & BID CLAIMS WYNNEL, B.C.

ASPEN GROVE MINES LTD.

SEPT. 1968. SCALE: 1" = 100' DWG. NO. EM-68-1080

EM PROFILES

APPROVED: *[Signature]*

- NOTE:-
- +|- ZERO LINE
 - IN-PHASE (1" = 30%)
 - - - QUADRATURE (1" = 30%)
 - CLAIM LINE ■ CLAIM POST
 - AREAL ANOMALY
 - LINEAR

1695 ①

To accompany geophysical
Report No. E.M.-68-1080 by
D.L. Hings, P. Eng.,
September 23, 1968.