

1722

A REPORT ON
GEO-CHEMICAL SURVEYS
OF THE
LOU CLAIM GROUP
KETTLE RIVER AREA
GREENWOOD MINING DIVISION
49° 25' - 118° 50' N.W.

By
S. J. Hunter, P. Eng.
For
RIP VAN MINING LTD. (NPL)

Vancouver, B. C.

December 19, 1968

TABLE OF CONTENTS

	<u>Page No.</u>
INTRODUCTION	1
LOCATION AND ACCESSIBILITY	2
STATUS OF THE PROPERTY	2
GENERAL GEOLOGY	3
SURVEY PROCEDURES	4
1. Location of Sample Points	
2. Method of Sampling and Assaying	
SURVEY RESULTS	5
CONCLUSIONS AND RECOMMENDATIONS	6
MAPS	
Location Plan	
Soil Sampling Plan - Lou Claims #2.	
Geology - Lou Claims #1	

A REPORT ON
GEO-CHEMICAL SURVEYS
OF THE
LOU CLAIM GROUP
KETTLE RIVER AREA
GREENWOOD MINING DIVISION
49° 25' - 118° 50' N.W.
by
S. J. Hunter, P. Eng.

INTRODUCTION

This report is on a geo-chemical survey and prospecting conducted by the author on the " Lou " Claims during the month of May 1968 for Rip Van Mining Ltd. (NPL).

A reconnaissance prospecting programme along the main Kettle River Valley established an extensive pyritic gossan on the east bank of the Kettle River approximately a mile north of the junction with Lost Horse Creek. A flight of preliminary samples yielded low values in copper and silver minerals. The " Lou " Claims were staked to cover this gossan area for Rip Van Mining Ltd. (NPL) and recorded on February 2, 1968. Since the gossan area was covered with overburden to shallow depths, it was recommended to soil sample to determine extent of mineralization

and character of sub-soil anomalies if any.

LOCATION AND ACCESSIBILITY

The " Lou " Claims are in the Greenwood Mining Division approximately 25 miles north of Rock Creek and the paved Provincial Highway # 3.

The claims can be accessed directly from Rock Creek northerly over an all-weather gravel road which follows the main Kettle River. Logging roads criss cross the claims.

A location sketch follows this page.

STATUS OF THE PROPERTY

There are 35 contiguous claims held by right of location and duly recorded in the district Recording Office at Grand Forks by:

Rip Van Mining Ltd. (NPL)
020, (40 - 7th Avenue SW
Calgary, Alberta.

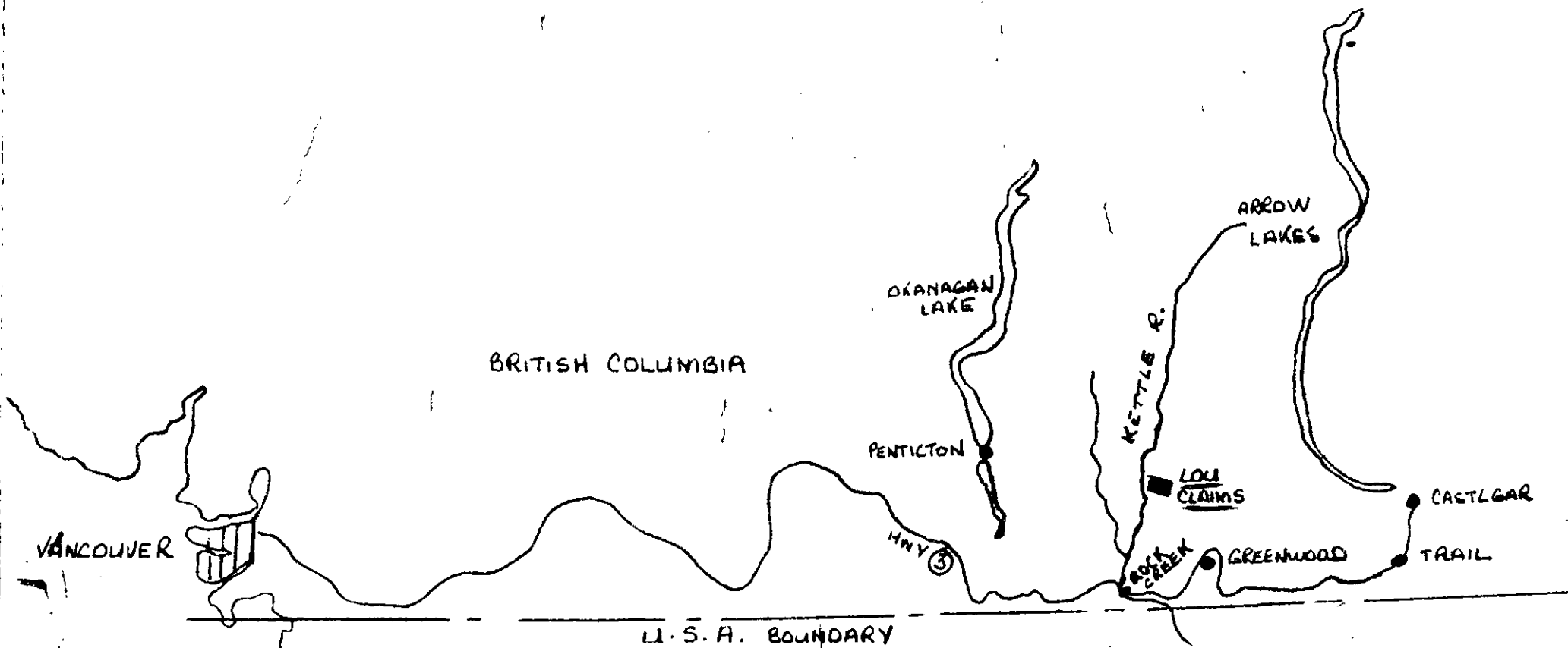

RIP VAN MINING LTD. (NPL)
LOCATION PLAN - LOU CLAIMS
GREENWOOD DISTRICT, B.C.
1" = 30 MILES MAY, 1968

GENERAL GEOLOGY

The Kettle River Valley in the area of the " Lou " Claims is occupied by a narrow segment of Palaeozoic - Permian sediments comprising greenstones, greywackes, limestones and paragneiss. On the east and west of the Kettle River are found Mesozoic Cretaceous granites and porphyritic granites which enclose the Anarchist sediments.

The " Lou " Claims are covered by a band of greenstones which strike north - south and dip at steep angles to the east. These volcanics are overlain in the north sector of the claims by a belt of younger rocks classified as Cenozoic - Paleocene tuffs and conglomerates. The easterly segment of the claims is occupied by a north striking fault to the east of which is granite.

In the area of Lou Claims 1, 3, 25 and 27, the greenstones are highly silicified and they are traversed by strong east - west shears which dip to the north. The shear planes are coated with sulfides.

SURVEY PROCEDURES

1. Location of Sample Points

The main claim location lines were run by compass and chain. 100 foot stations were marked along these lines. Parallel control lines were run at 500 foot intervals between the two main location lines.

Soil samples were chained at 200 foot intervals initially and subsequently fill-in samples were taken in several sections at 100 foot intervals. Marker flags were set at sample points and labelled with the sample number. The sample bags were accorded the number of the sample point.

2. Method of Sampling and Assaying

The surface humus and organic material was removed by shovel from each sample point until the lower clay was exposed. Approximately 3 ounces of material was taken from a 15 inch penetration of the clay horizon by hand auger, placed in a paper bag and tagged as to site location.

185 samples were taken on the " Lou " Claims for analysis.

The samples were forwarded to the Technical Services Laboratories in Vancouver for analysis for copper - lead - zinc - silver. All samples were dried in the laboratory, screened and treated by hot HNO₃ acid extraction followed by atomic adsorption for analysis.

Values are plotted on the accompanying plan.

SURVEY RESULTS

The values obtained in copper - lead - zinc - silver offered encouragement in the southern section of Lou Claims 3, 5 and 7. The large gossan area did not reveal significant metal values. The background count for the metals was:

<u>Copper</u>	<u>Lead</u>	<u>Zinc</u>	<u>Silver</u> (ppm)
15	10	45	<0.5

On Lou Claim 7 significant results over an area of 700 feet by 500 feet were as follows:

<u>Copper</u>	<u>Lead</u>	<u>Zinc</u>	<u>Silver</u> (ppm)
125	68	3200	6
61	40	2700	8
405	-	345	4.5
410	-	300	2.5
275	-	415	3.5
320	-	420	4

On Lou Claim 3 significant metal values over an area of 800 feet by 200 feet were indicated as:

<u>Copper</u>	<u>Lead</u>	<u>Zinc</u>	<u>Silver</u> (ppm)
428	28	210	6
98	-	505	1.5
165	20	175	4
123	-	138	1
43	25	775	3
23	-	345	<0.5

The above two zones were separated by a sharply rising cliff of altered greenstone.

CONCLUSIONS AND RECOMMENDATIONS

The results of the soil sampling programme yielded favourable anomalies in two sections on claims Lou 3 and Lou 7 in copper - zinc - silver values.

It was recommended to test these two zones further by bulldozer trenching in order to expose bedrock for mapping and sampling.

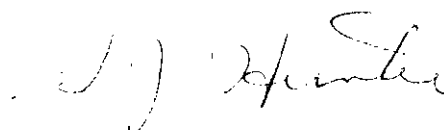

Vancouver, B. C.
December 19, 1968

S. J. Hunter, P. Eng.
Consulting Mining Engineer

STATEMENT OF EXPENSES

" Lou " Claims - 1968 Geochemical Survey

Geochemical surveying was conducted by S. J. Hunter,
P. Eng. and expenses for the work are shown below:

Wages:

<u>Personnel</u>	<u>Rate</u>	<u>Period</u> <i>may/68</i>	<u>Amount</u>
C. Drysdale	\$ 700/mo.	2 weeks <i>may/68</i>	\$ 350.00
S. J. Hunter	\$1500/mo.	1 week <i>may/68</i>	400.00
Vehicle			200.00
Assays - Technical Services Lab			300.00
Supplies			<u>200.00</u>
Total			\$1450.00

Declared before me at the *City*
of *Vancouver*, in the
Province of British Columbia, this *20*
day of *December, 1968*, A.D.

S. J. Hunter

L. J. Jernotte
A Commissioner for taking Affidavits within British Columbia or
A Notary Public in and for the Province of British Columbia.

SUB-MINING RECORDER

CERTIFICATION

I, Stanley John Hunter, of Vancouver, British Columbia do hereby certify that:

1. I am a Consulting Mining Engineer with residence at 6476 Churchill Street, Vancouver, B. C.
2. I am a Registered Professional Engineer in the Provinces of British Columbia and Ontario.
3. I am a graduate of the University of British Columbia in Mining Engineering and have practised my profession for 20 years.
4. The information contained in this report was obtained from the author's work on the claims during the month of May 1968.

Vancouver, B. C.
December 19, 1968

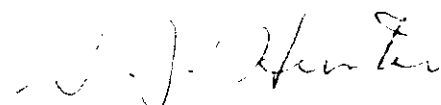
S. J. Hunter, P. Eng.
Consulting Mining Engineer

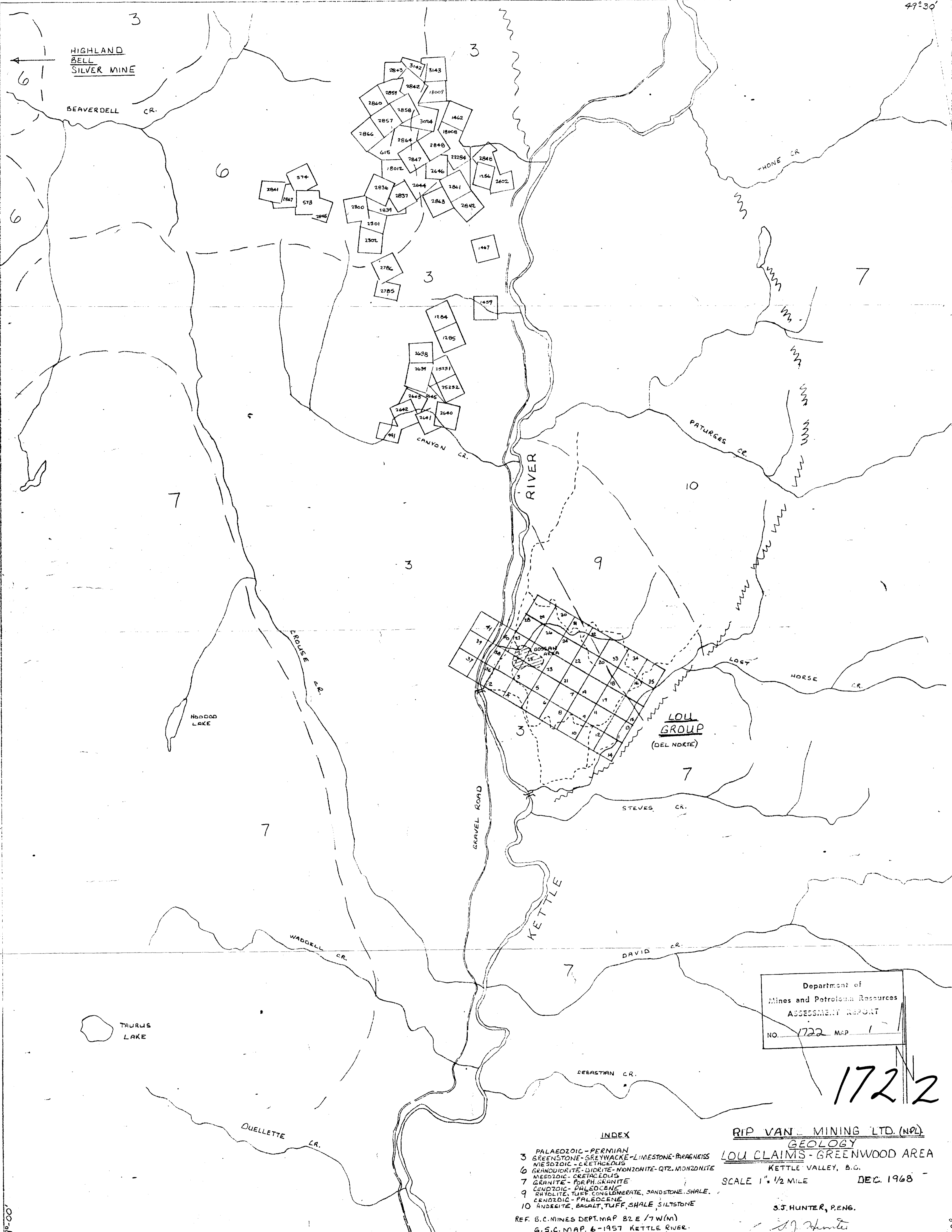

Department of
Mines and Petroleum Resources
ASSESSMENT REPORT
NO. 1722 MAP 1

1722

INDEX

- 3 PALAEOZOIC - PERMIAN GREENSTONE - GREYWACKE - LIMESTONE - PARAGNEISS
- 6 MESOZOIC - CRETACEOUS GRANODIORITE - DIORITE - MONZONITE - QTZ. MONZONITE
- 7 MESOZOIC - CRETACEOUS GRANITE - PORPH. GRANITE
- 9 CENOZOIC - PALEOCENE RHYOLITE, TUFF, CONGLOMERATE, SANDSTONE, SHALE.
- 10 CENOZOIC - PALEOCENE ANDESITE, BASALT, TUFF, SHALE, SILTSTONE

RIP VAN MINING LTD. (NPL)
GEOLOGY
LOU CLAIMS - GREENWOOD AREA
KETTLE VALLEY, B.C.
SCALE 1" = 1/2 MILE DEC. 1968
S.J. HUNTER, P. ENG.
REF. B.C. MINES DEPT. MAP 82 E / 7 W (M)
G.S.C. MAP. 6-1957 KETTLE RIVER.

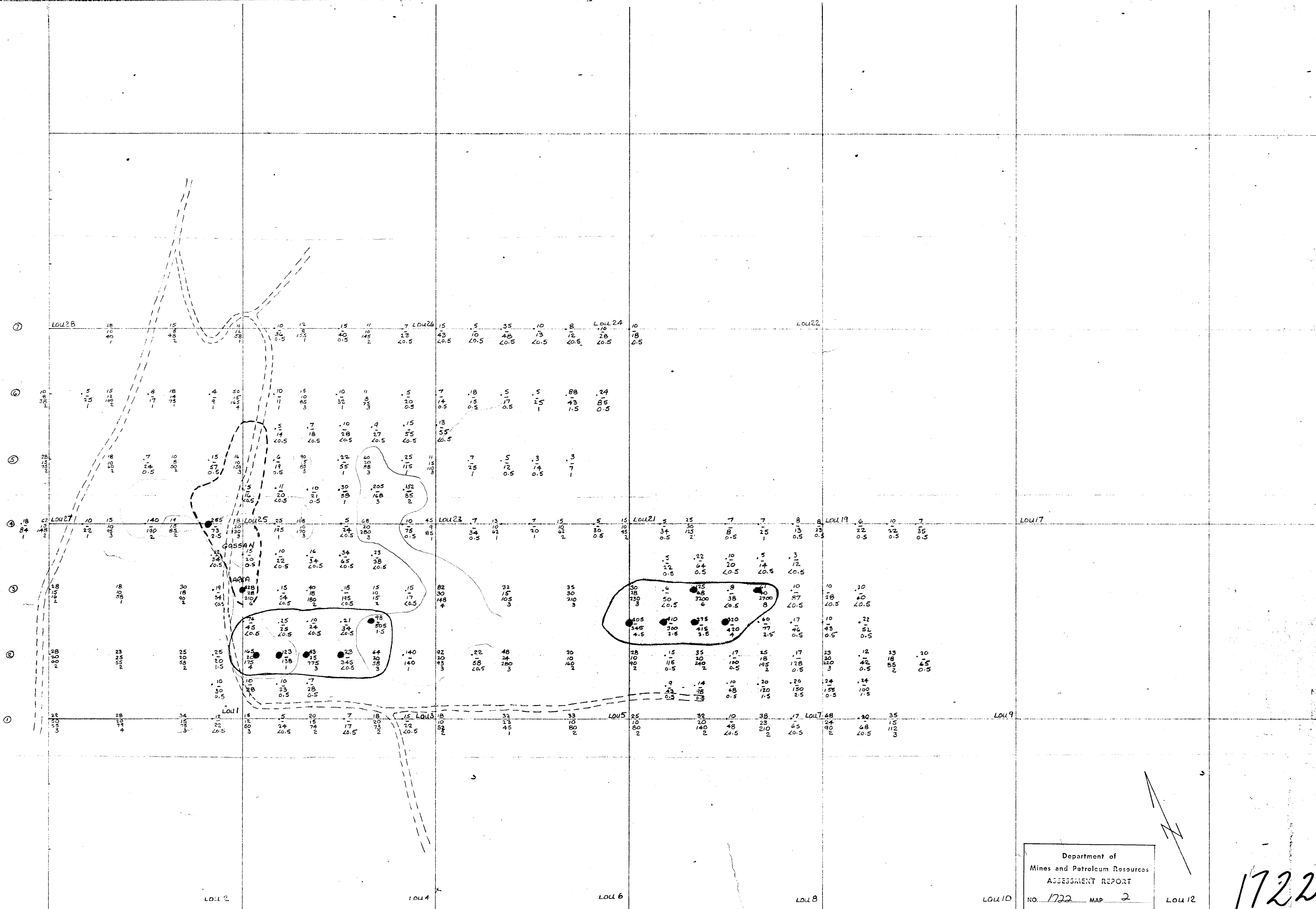

Department of
Mines and Petroleum Resources
ASSESSMENT REPORT
NO. 1722 MAP 2



1722

INDEX
Cu (PPM)
Pb
Zn
Ag

RIP VAN MINING LTD (NPL)
SOIL SAMPLING - LOU CLAIMS
GREENWOOD DISTRICT, B.C.
SCALE 1" = 300'
MAY, 1968
S.J. HUNTER, P. ENG.