

LINE CUTTING REPORT

Claim: BUD 1 and 2, GAP 1-4, GAP 1 Fr., 2 Fr., ANN 2 Fr., JAY 16, 18, 20, JAY Frs.,
NAT 1-14, NAT 16, 18-22, BOB 19, 20, SHEBA 23-26, GAP Fr. - NAT #108 Group.

Owner: GAZA MINES LTD.

Work by: MACDONALD CONSULTANTS LIMITED

Report by: G. H. McLEOD, P. ENG.

Mining Division: Kamloops

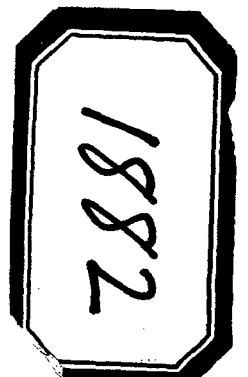

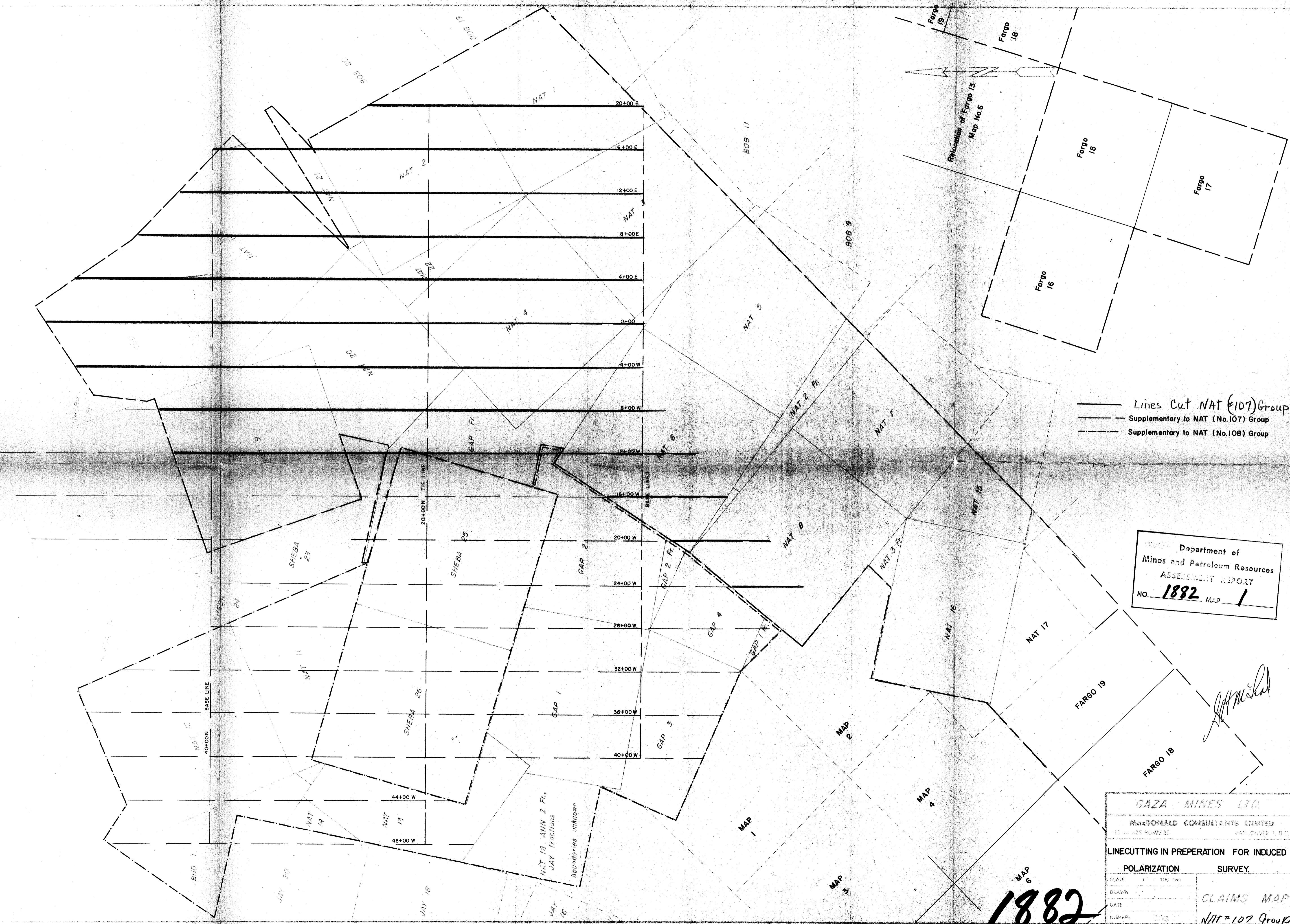

——— Lines Cut NAT (107) Group
 - - - Supplementary to NAT (No.107) Group
 - - - Supplementary to NAT (No.108) Group

Department of
 Mines and Petroleum Resources
 ASSESSMENT REPORT
 NO. **1882** MAP **1**

GAZA MINES LTD
 MACDONALD CONSULTANTS LIMITED
 11 - 425 HOWE ST. VANCOUVER 1, B.C.
 LINECUTTING IN PREPARATION FOR INDUCED
 POLARIZATION SURVEY.
 SCALE 1" = 100 Feet
 DRAWN BY _____ DATE _____ NUMBER _____
 CLAIMS MAP
 NAT = 107 Group

1882
 MAP 6

[Handwritten Signature]

LINE CUTTING REPORT

Claims: NAT 1-8, NAT 2 Fr., 3 Fr., NAT 11-17, 18-22, ANN 2 Fr., Jay Frs., 18,20;
GAP 1-4, GAP 1 and 2 Frs., MAP 1-4, 6, Fargo 15-19, Sheba 25 and 26;21-24
Bob 19 and 20 (NAT #107 Group)

Owner: Gaza Mines Ltd.

Work done by: MacDonald Consultants Limited.

P. Eng.: G. H. McLeod

Work done: May 13-26/69

Mining Division: Kamloops



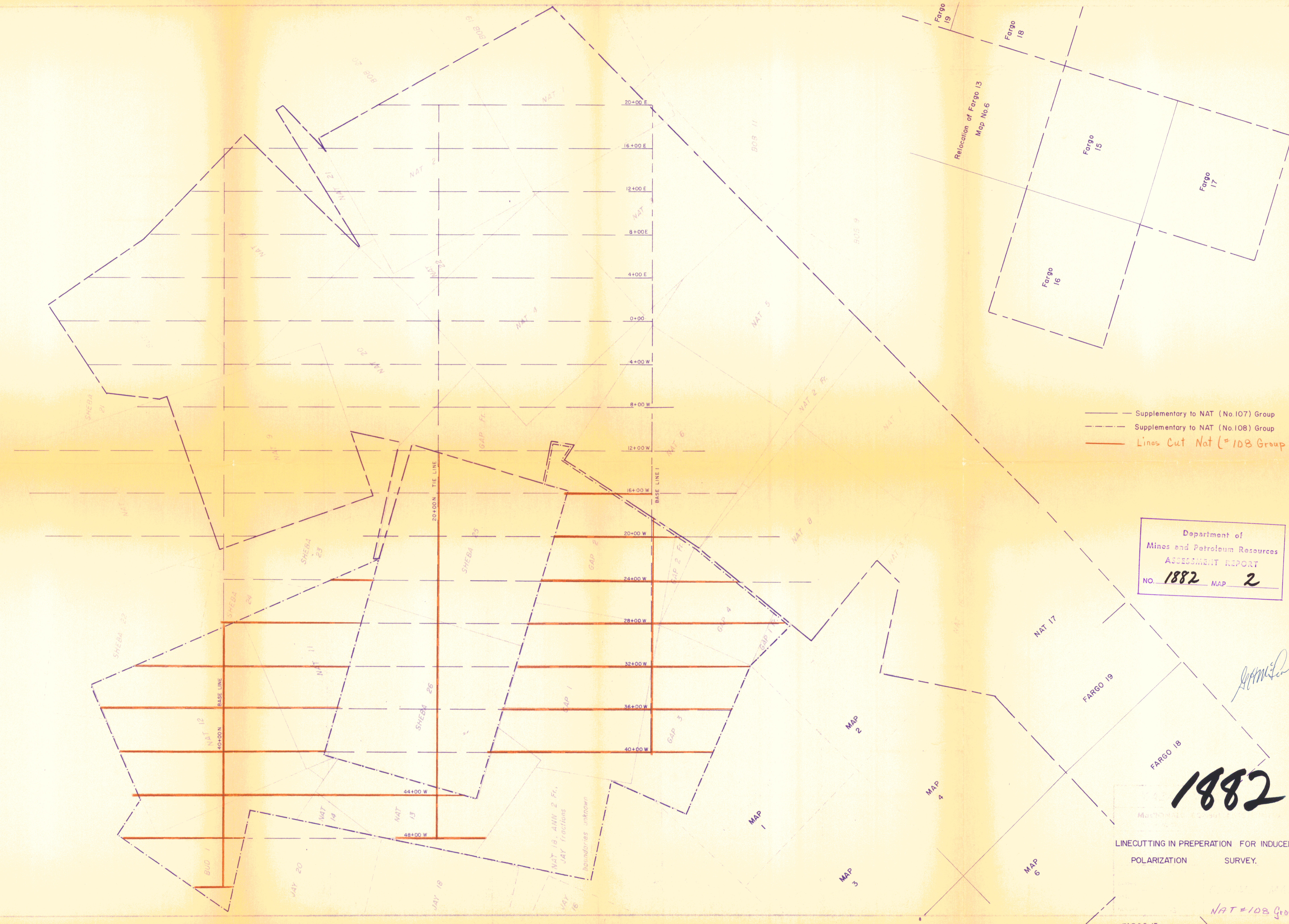

- Supplementary to NAT (No. 107) Group
- · - Supplementary to NAT (No. 108) Group
- Lines Cut Nat (#108 Group)

Department of
 Mines and Petroleum Resources
 ASSESSMENT REPORT
 NO. **1882** MAP **2**

JAM:Lead

1882

LINECUTTING IN PREPARATION FOR INDUCED
 POLARIZATION SURVEY.

NAT #108 Group

FARGO 15