

LINE CUTTING REPORT

CLAIMS: Rich 16-21, Chief 2-13

OWNER: Salem Mines Ltd.

Report by: A. R. Bullis

Date of work: April 27/69 and May 16-21/69

Mining Division: Trail Creek

49° 117° SW

LINE CUTTING REPORT

CLAIMS: Rich 16-21, Chief 2-13

OWNER: Salem Mines Ltd.

Report by: A. R. Bullis

Date of work: April 27/69 and May 16-21/69

Mining Division: Trail Creek



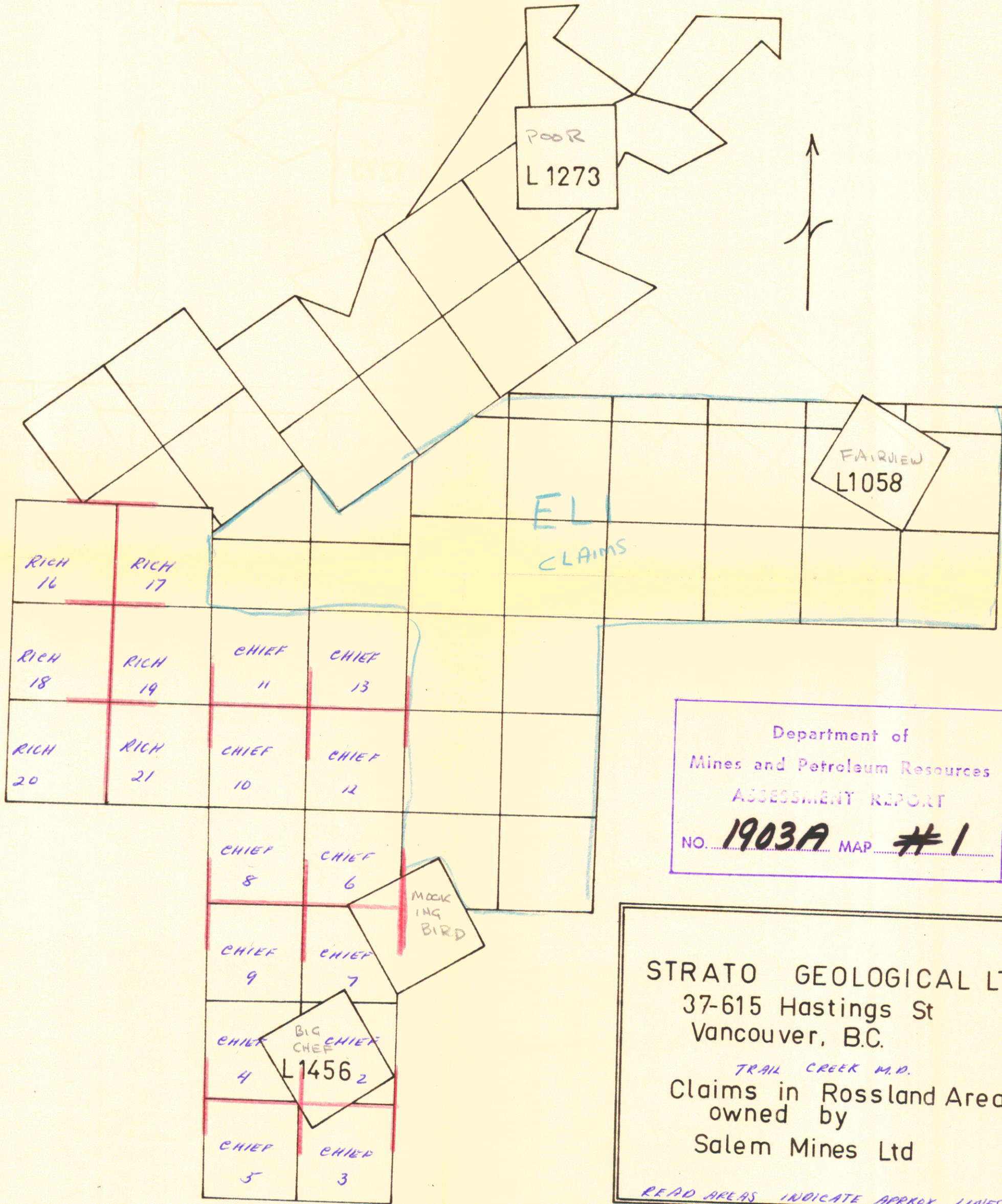

2 M. SW of Rosland

1903