

1928

A GEOCHEMICAL REPORT

on

THE ROADBLOCK CLAIMS (1-16)

SUMMERS CREEK, 20 MILES NORTH OF PRINCETON, B.C.

SIMILKAMEEN MINING DIVISION

LAT. 120°, Long. 49° (Sheet 92-H-10E)

April 11th - June 24th, 1969

by

T.L. SADLIER-BROWN

E.O. CHISHOLM, P.Eng.

HOLDER: Edward O. Chisholm
821-602 West Hastings Street
Vancouver 2, B.C.

July 25, 1969

TABLE OF CONTENTS

	<u>Page</u>
INTRODUCTION	
Location and Access	1
Topography	1
General Geology	1
GEOCHEMICAL SURVEY	
Specifications	2
Observations	3
CONCLUSIONS AND RECOMMENDATIONS	
Claim No. 6 Area	4
Claim No. 10 Area	4
Claim No. 12 Area	4
MAP	Pocket

Department of
Mines and Petroleum Resources
ASSESSMENT REPORT
NO. 1928 MAP.....

A GEOCHEMICAL REPORT ON THE ROADBLOCK CLAIMS

INTRODUCTION

Location and Access

The Roadblock Group consists of sixteen contiguous mineral claims located in the valley of Summers Creek just south of Missezula Lake and about 20 miles north of Princeton, B. C. The claims are traversed by a good gravel road leading from the Merritt-Princeton Highway to Missezula Lake and are at an elevation of 3,000 to 3,500 feet.

Topography

Much of the claim area lies on the lower slopes of the Summers Creek valley which are moderately to heavily forested. Outcrop and slide areas are common on the slopes although the valley bottom itself is level and underlain by overburden.

General Geology

The area is underlain by the Upper Triassic andesitic and basaltic rocks of the Nicola Group. In the immediate area this is represented by reddish basalt (?) and greenstone which, in places, contain disseminated pyrite and chalcopyrite. No intrusive rocks are known to occur on the claim group although granitic rocks of the Coast Intrusives have been mapped in the general area.

The Summers Creek Valley is a pronounced north/south trending topographic linear at least 25 miles long and incised about 2,000 feet into the surrounding plateau area. It could represent a fault or major fracture.

GEOCHEMICAL SURVEY.

Specification

The geochemical survey of the Roadblock Claims was carried out in two stages, a reconnaissance program during April, 1969 and a more detailed grid sampling program in June, 1969. Five men were employed.

Samples were taken from the "B" soil horizon, inasmuch as this was possible, using a mattock as a sampling tool. They were placed in paper soil sample envelopes which were then numbered and shipped to the Chisholm Prospection Laboratory, 8427 Ontario Street, Vancouver, for testing. Samples were dried in an electric drying oven, screened to -80 mesh and 1/2 gram of each was dissolved in hot perchloric nitric acid. The solution was then tested for copper using a Perkin-Elmer 290-B Atomic Absorption Spectrophotometer. Analysis was carried out by Mr. J.B. O'Donnell of Chisholm Prospection.

The reconnaissance portion of the survey was done using compass lines and the contour of the valley for control. Samples were taken along these lines at 100 foot intervals.

As a result of this survey a grid was established on the east side of the valley. An east/west base line was put in and two cross lines 4,000 feet long and 400 feet apart were turned off from

it. All lines were then sampled at 100 foot intervals. In addition the reconnaissance survey was extended to the south on the west side of the valley.

Observations

The reconnaissance program and subsequent detailed work outlined three anomalous areas. Two of these have values in the 200 to 400 p.p.m. range while one is made up predominantly of values in the 100 to 200 p.p.m. range. Background values are taken to be below about 50 p.p.m.

The most northerly of the three anomalies appears to have its source on or near the Roadblock No. 6 claim. It trends southwest down the slope and is 400 to 500 feet wide, at least 1,500 feet long and open at its uphill or northeast end.

About 1,000 feet to the south, in the vicinity of the base line, is another intense anomaly trending east/west and open uphill to the east. It is at least 800 feet long, 200 to 300 feet wide and lies mainly on Claim No. 10.

The most southerly area is less distinct and is comprised mainly of values between 100 and 200 p.p.m. It appears to trend downslope in a northwesterly direction from the west central part of Claim No. 12. Values from samples taken further up the hill were low, indicating a local source.

Other spot highs were detected on both the grid and reconnaissance survey but no follow-up work has been done on them to date.

CONCLUSIONS AND RECOMMENDATIONS

NORTHERLY ANOMALY, CLAIM NO. 6

Further prospecting and geochemical sampling is warranted in the eastern part of Claim No. 6 to establish the source of the anomaly there. Copper mineralization may be found on line 8E between 15N and 18N. If this is the case, a geophysical program to establish its extent could be warranted.

CLAIM NO. 10 ANOMALY

Copper mineralization might be expected on both lines 4E and 8E between the base line and Stn. 3N, and possibly farther up-hill to the east from the latter area. Detailed prospecting of this area should be carried out with further soil sampling, if ground conditions permit, in an effort to obtain a cut off. Geophysical methods might then be employed to establish the precise size and location of the mineralization.

CLAIM NO. 12 ANOMALY

The geochemical pattern on Claim No. 12 is not as intense as those to the north but a cut off was obtained indicating that the source area is in the general vicinity of line 4E at about 10+00 to 12+00 S, or just to the east.

Prospecting and geophysical testing of line 4E in this

area should be carried out in conjunction with the work recommended above.

Respectfully submitted,

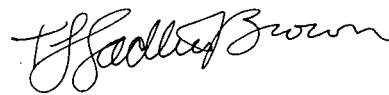

T.L. SADLIER-BROWN

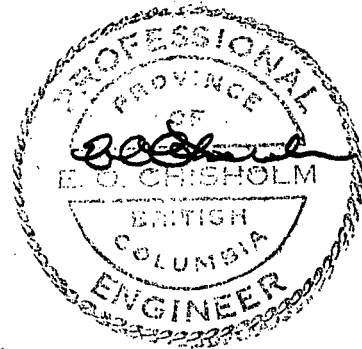

T.L. SADLIER-BROWN : STATEMENT OF QUALIFICATIONS

Education: Four years geology, Carleton University,
Ottawa, Ontario.

Experience: Summer field experience with the Geological
Survey of Canada in Northwest Territories,
Northern British Columbia and Ottawa; with
Hollinger Consolidated Gold Mines in Northern
Ontario; with McIntyre Porcupine Mines in
Northern Quebec; with Mattagami Syndicate in
Northern Quebec; with Southwest Potash Corp-
oration in Central British Columbia.

Full time field and office experience in
geology and related fields with Geological
Survey of Canada (as Technical Officer); with
Mt. Costigan Mines Ltd. in Nova Scotia; with
Atlas Explorations Ltd. in Yukon, Alaska and
British Columbia; with P.H. Sevensma Consultants
in Yukon and Northern British Columbia; and
with Chisholm Prospection Ltd. in Southern
British Columbia.



T.L. Sadlier-Brown

July 25, 1969

DOMINION OF CANADA:
PROVINCE OF BRITISH COLUMBIA.
To Wit:

In the Matter of ASSESSMENT WORK ON THE ROADBLOCK CLAIMS, SIMILKAMEEN MINING DIVISION, BRITISH COLUMBIA

I, TIMOTHY SADLIER-BROWN

of 2033 Comox Street, Vancouver

in the Province of British Columbia, do solemnly declare that

1. The work described in this report was carried out on April 11th, 12th and 13th, and June 18, 19, 20, 21, 22, 23 and 24th, 1969, a total of 10 days.
2. Four field men were employed at rates of \$750, \$750, \$400 and \$400 per month. One Supervisor was employed at a rate of \$900 per month.
3. Wages paid each man during the periods of work on the claims and directly related travel were:-

\$275	
275	
130	
130	
<u>163</u>	\$ 973

4. Other direct costs were:

Accommodation and Meals	558
Vehicle Expense	200
Geochemical Testing	<u>332</u>
TOTAL	<u>\$2,063</u>

And I make this solemn declaration conscientiously believing it to be true, and knowing that it is of the same force and effect as if made under oath and by virtue of the "Canada Evidence Act."

Declared before me at the *City*
of *Vancouver*, in the
Province of British Columbia, this *29th*
day of *July* 19*69*, A.D.

Timothy Sadlier Brown

[Signature]
A Commissioner for taking Affidavits for British Columbia or
A Notary Public in and for the Province of British Columbia.

★ 0

MINING RECORDER

In the Matter of

Statutory Declaration
(CANADA EVIDENCE ACT)

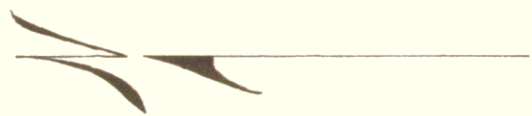

Department of
Mines and Petroleum Resources
ASSESSMENT REPORT
NO. 1928 MAP #1

COPPER GEOCHEM.
- Values in PPM

topo contour ——— 3500
road ———
claim post □
claim boundary - - -
sample point •
grid line ———
anomaly ○

**ROADBLOCK CLAIMS
PRINCETON AREA, BC**
Scale 1" to 500'

to accompany a report by
T.L. Sadlier-Brown on the Roadblock
Claims, Similkameen M.D. **JULY 8 1969**
T.L. Sadlier-Brown

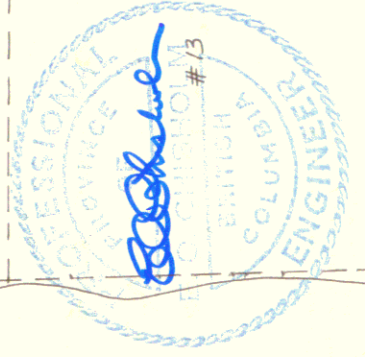
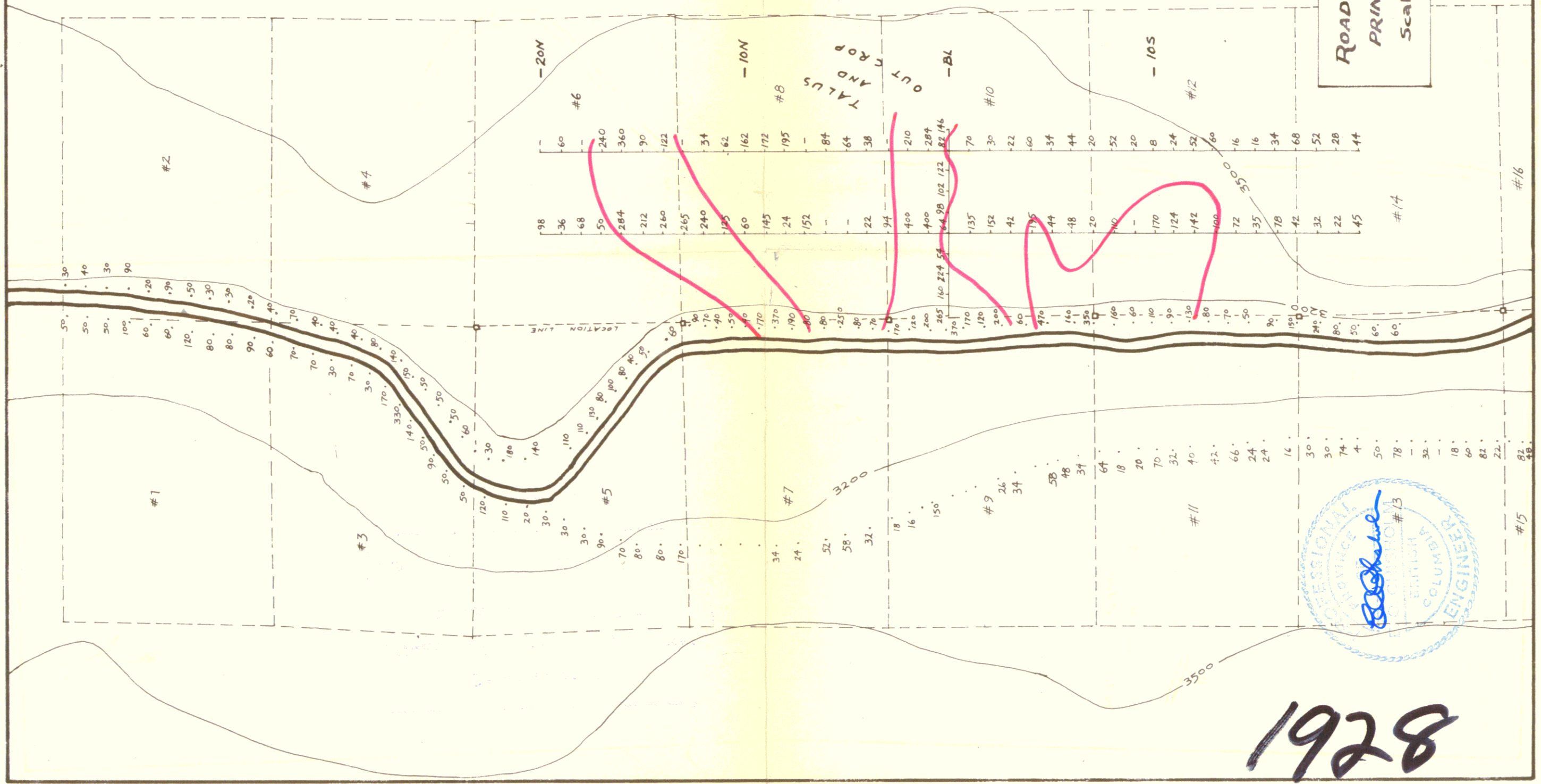

1928

TL5B