

1931

TABLE OF CONTENTS

INTRODUCTION Page 1

PROCEDURE USED Page 1

RESULTS OF SURVEY Page 1

ATTACHMENTS:

Map No. 1 Location Map

Map No. 2 Sample Results

Evidence of Expenditures Incurred

Department of
Mines and Petroleum Resources
ASSESSMENT REPORT

GOVERNMENT AGENT
REC NO. 1931 MAP

-1-

INTRODUCTION

The Tenas group of mineral claims are located in the Omineca Mining District, a distance of 11 miles southeast^{west} of Telkwa, B.C. The exact position is shown on the attached location map. A 5500-foot base line was cut, measured and marked through the centre of the 20-claim group and cross lines at 500-foot intervals were run for 3000 feet east and west of the base line to almost completely cover the claim group.

SAMPLING AND ASSAYING PROCEDURE

Soil samples from the "A" horizon were dug up at intervals of 200 feet on all the lines. The samples were placed in regular soil sampling bags and then shipped to the T.S.L. Laboratory in Smithers, B.C. Here they were dried, screened and assayed by Atomic Absorption Method for copper only.

RESULTS OF SURVEY

The results of the survey are plotted on Map No. 2. A few stream sediment samples were taken and are marked with an "X". No anomalous assays occurred in the area of the claims and leads to the conclusion that there is no copper mineralization in the area or else the depth of overburden is too great for the copper to have permeated to the surface.

Respectfully submitted,

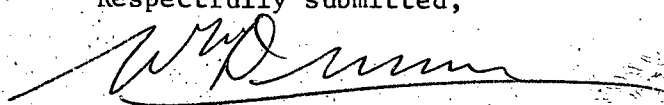
W. St. C. Dunn
Superintendent of Exploration

July 15, 1969



To accompany Report by W. ST. C. DUNN & E. G. E. on TENAS Group, ORIN ECA M.D. 15 July 1969. Scale 1:250,000



Department of
Mines and Petroleum Resources
ASSESSMENT REPORT

NO. 1931 MAP #1



EVIDENCE OF EXPENDITURES INCURREDLABOUR:

Ward	9 days @ \$450.00/mo.	\$ 150.00
Morris	9 days @ 25.00/dy.	225.00
Commers	9 days @ 25.00/dy.	225.00
Gallagher	3 days @ 500.00/mo.	50.00
Eagleston	3 days @ 400.00/mo.	40.00
Robertson	8 days @ 25.00/dy.	200.00
Burmeister	2 days @ 50.00/dy.	100.00
Kowall	10 days @ 900.00/mo.	<u>300.00</u>
		\$ 1,280.00
Assaying 390 samples @ 1.20/sample		468.00
Living Expenses - 53 man days @ 7.00/dy.		371.00
Transportation to claim group		<u>560.00</u>
		\$ 1,399.00
TOTAL COSTS -		<u><u>\$ 2,679.00</u></u>

I HEREBY CERTIFY these costs have been incurred in carrying out the geochemical survey of the Texas Group of claims.



W. St. C. Dunn - Superintendent of
Exploration

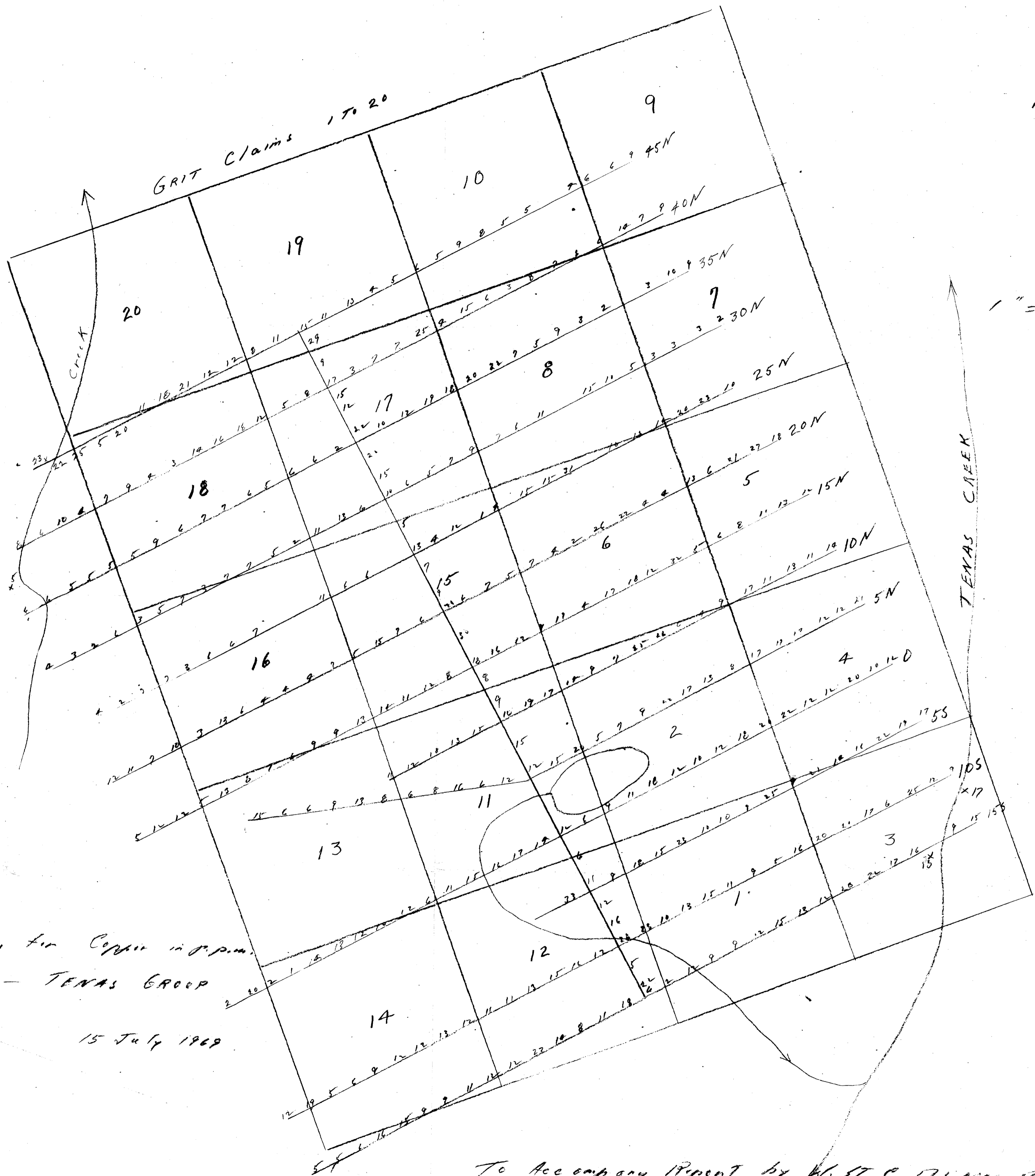

Geochemical Assays for Copper in p.p.m.
 GRIT CLAIMS - TENAS GROUP

Omnicor M.D. 15 July 1969

x Stream Sample

Department of
 Mines and Petroleum Resources
 ACCESSORY REPORT
 NO. 1931 MAP #2

To accompany Report by W. ST. C. DUNN P. Eng.
 on Texas Group, Omnicor M.D. 15 July 1969

W. St. C. Dunn
 1931
 Map No. 2