

LINE CUTTING REPORT

Owner: Consolidated Skeena Mines Ltd.

Claims: Toe, Boot, HN, Echo and Wen

Report by: J.E. White

Date of Report: March 31/69

Mining Division: Nicola



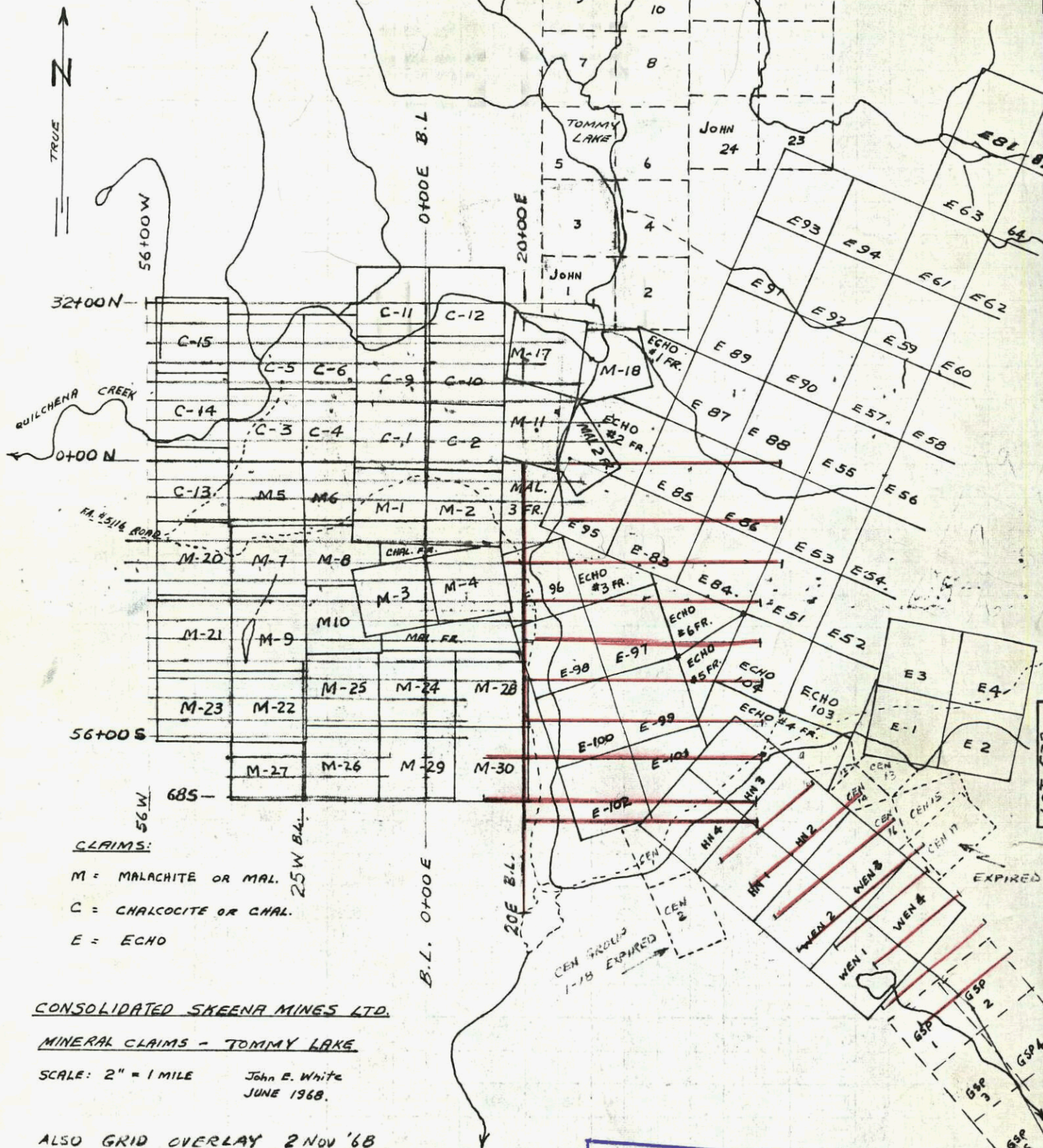

CLAIMS:
 M = MALACHITE OR MAL.
 C = CHALCOCITE OR CHAL.
 E = ECHO

CONSOLIDATED SKEENA MINES LTD.
MINERAL CLAIMS - TOMMY LAKE

SCALE: 2" = 1 MILE John E. White
 JUNE 1968.

ALSO GRID OVERLAY 2 NOV '68

— GRID LINES 1st MAY '69 to 30 JUNE '69

Department of
 Mines and Petroleum Resources
 ASSESSMENT REPORT

NO. 1953 MAP #1

1953

CONSOLIDATED SABENA MINES

TOE & BOOT CLAIMS
WITH GEOPHYSICAL GRID LINES

SC. 1" = 1/2 MILE.

JEW.
31 MARCH 1969

— Grid Lines cut 4 Oct 1968 to
15 May 1969

LAT. 49° 55'
LONG. 120° 22'

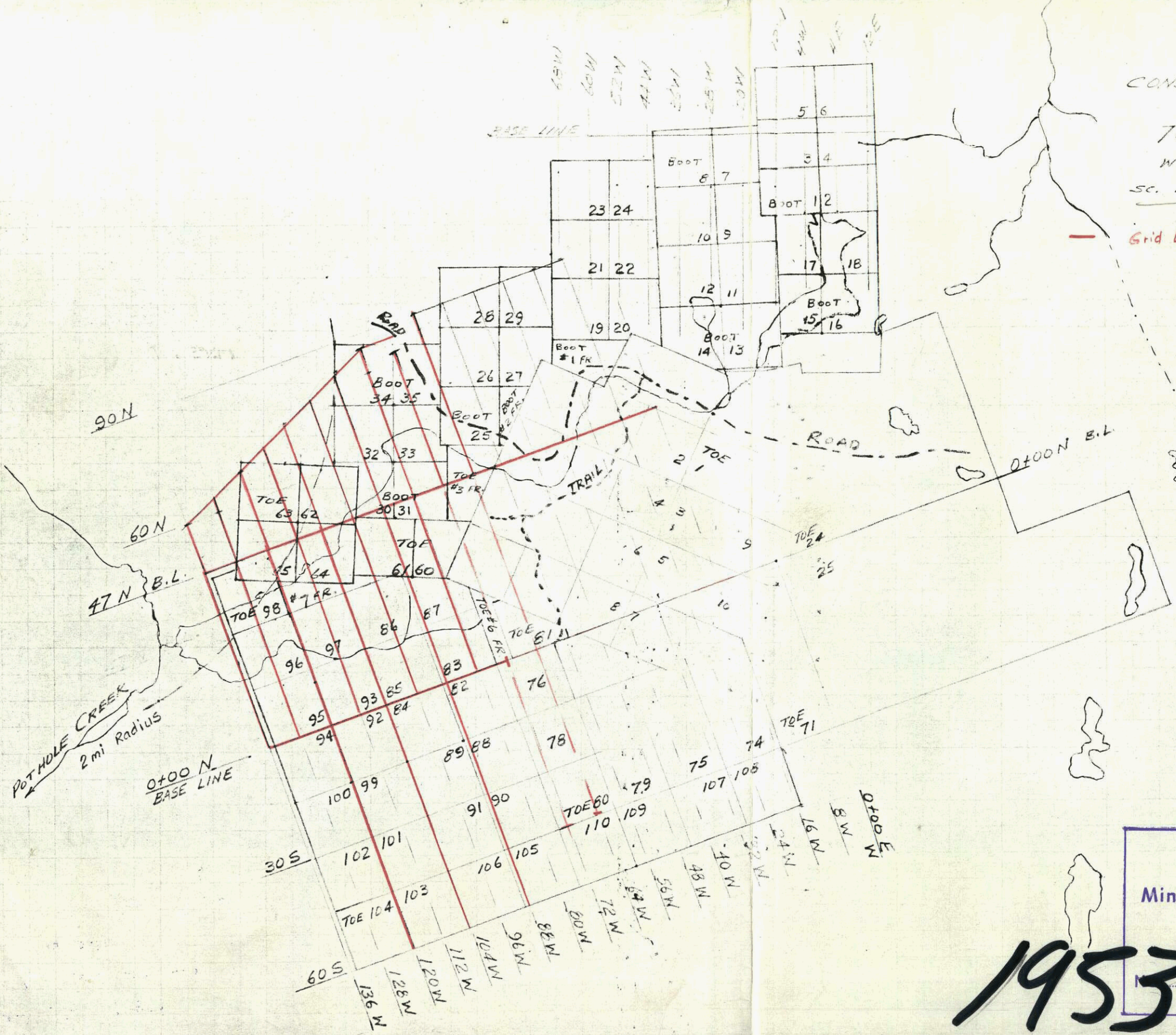
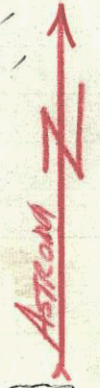

Department of
Mines and Petroleum Resources
ASSESSMENT REPORT
1953 1953 MAP #2