

1994

GEOPHYSICAL REPORT

on the

FAR CLAIM GROUP

55° 124° S.W.

OMINECA MINING DIVISION, B.C.

Department of Mines and Petroleum Resources ASSESSMENT REPORT NO. <u>1994</u> MAP .....
--

by

W.R. BACON, Ph.D, P.Eng.

for

N.B.C. SYNDICATE

Vancouver, B.C.

September 25, 1969.

124°45'

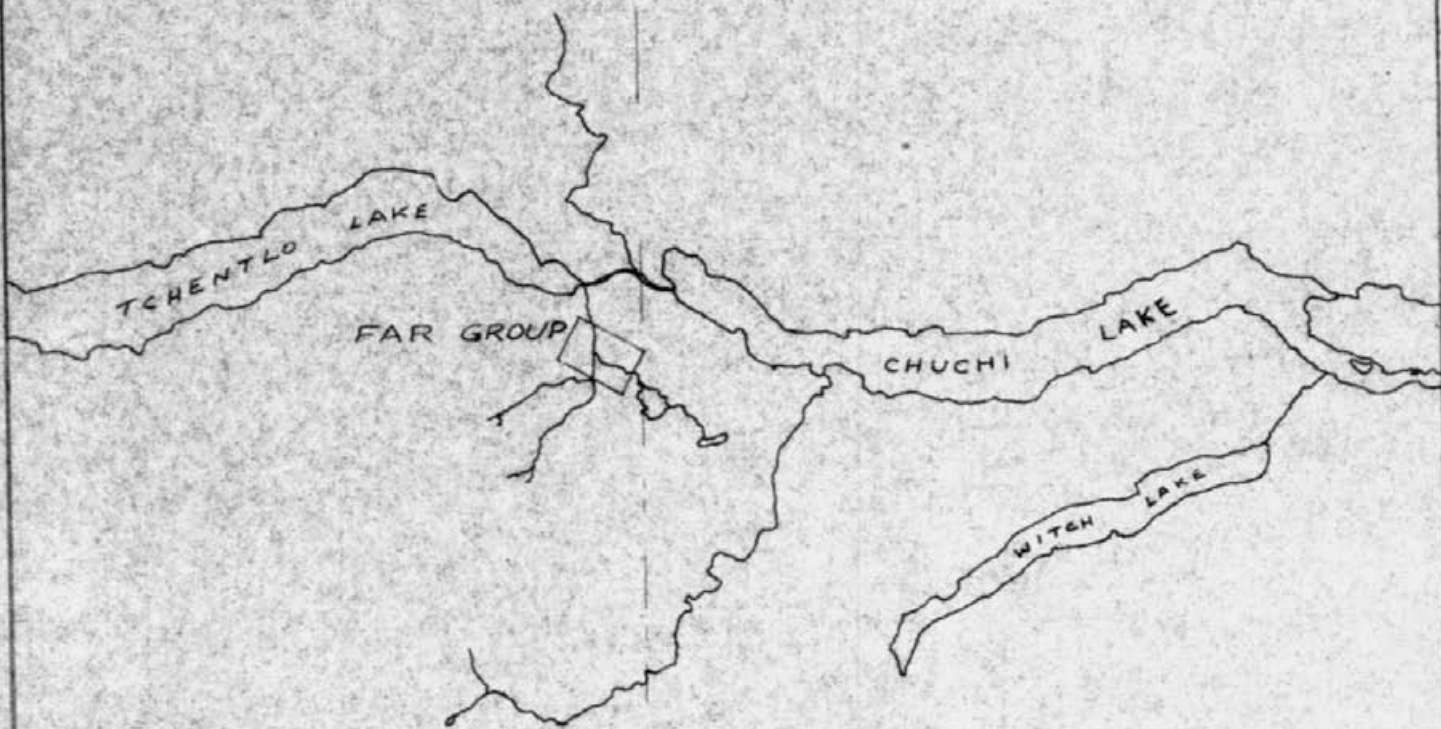

55°00'

Department of  
Mines and Petroleum Resources  
ASSESSMENT REPORT  
NO. **1994** MAP **#1**



LOCATION MAP  
FAR CLAIM GROUP  
1:250,000 1969

FIGURE 1

## TABLE OF CONTENTS

	<u>Page</u>
INTRODUCTION	1
MAGNETOMETER SURVEY	2
Purpose	2
Method	2
Results	2
Interpretation	3
CONCLUSIONS	3
TABLE OF EXPENDITURES	4

## LIST OF ILLUSTRATIONS

Figure 1.	Location Map, Far Claim Group	Frontispiece
Figure 2.	Far Claim Group, Picket Line Grid	End of Report
Plate 1.	Far Claim Group Magnetometer Survey	In envelope at back of report

INTRODUCTION

The Far Claim Group consists of 20 claims situated southwest of Chuchi Lake, approximately 53 miles north of Fort St. James. (See location map, Figure I) Access to the claim group is normally by fixed wing aircraft from Fort St. James.

The claims cover the greater part of two aeromagnetic anomalies indicated on map 93N/2, Chuchi Lake. They are as follows:

<u>Name</u>	<u>Record Numbers</u>	<u>Date Staked</u>	<u>Date Recorded</u>
Far 1-10	63811 - 820	Sept. 21, 1968	Oct. 11, 1968
11-20	63821 - 830	Sept. 22, 1968	Oct. 11, 1968

The area is characterized by low easterly trending ridges of glacial drift. Most of the area has been burned and is covered by small pine. There is considerable windfall.

No rock outcrop has been found on the property.

A picket line grid was cut with the base line approximately along the location line of Far 11-20. Picket lines were cut at 400 foot intervals. All lines were chained with chainage pickets at 100 foot intervals. The extent of the picket line grid is shown on Figure II.

## MAGNETOMETER SURVEY

### Purpose

A magnetometer survey was carried out to detail the aeromagnetic anomaly on the south portion of the claim group where interesting copper analyses had been obtained in silt sampling.

### Method

Magnetic readings were taken at 100 foot intervals on the picket lines and at 200 foot intervals on the base line using a Minimag instrument. This is a small, hand-held instrument made by the Norwegian Geological Survey and sold by Craelius. Accuracy is  $\pm 50$  gammas when hand held. This level of accuracy was deemed adequate considering the strong magnetic variations indicated on the published aeromagnetic maps.

Base line stations were repeated a number of times as the instrument operator traversed the picket lines. Corrections were made when necessary to reduce all readings to those established along the base line.

### Results

Plate I shows the magnetometer results obtained. These results are contoured at 1000 gamma intervals for 7500 gammas and above.

A relatively narrow, highly magnetic body is indicated along and north of the base line from about 16E to 56E.

The survey does not delimit this body to the west.

High readings are indicated to the north along line 60E. This is approaching the area of the second aeromagnetic anomaly covered by the claims. The second anomaly, however, was not investigated by this survey.

#### Interpretation

A fairly tabular magnetic body 300 to 500 feet in width and at least 4000 feet long is indicated by the magnetic survey.

Drill core left by former explorers of the property indicates this body to be a basic intrusive, highly fractured with considerable chloritization. Magnetite content appears fairly high in this rock and, in addition, magnetite fills many fractures. There is some associated pyrite mineralization.

#### CONCLUSIONS

The magnetometer survey has outlined a basic intrusive which appears to have been tested with two drill holes by previous explorers.

The survey has not shown any feature which appears to correlate with the relatively high copper content in silt samples upstream from the drill hole sites.

TABLE OF EXPENDITURES  
(1969)

R. Warren	Linecutter	June 8 - June 21	
R.I. Warren	"	" "	
T. Oly	"	" "	
		(Contract)	\$1452.40
J.C. Stephen,	Exploration Supt.	June 7, 8	70.00
C. Harivel	Geologist	Aug. 23-30 incl. Sept. 5, 6	\$750/mo. 250.00
N. Orr	Field Assistant	Aug. 23-30 incl.	\$475/mo. 127.00
	Food, supplies & equipment rental		<u>455.00</u>
		Total	\$2354.40

Declared before me at the *City*  
of *Skowmish*, in the  
Province of British Columbia, this *26*  
day of *Sept.* *1969*, A.D.

*W.R. Bacon, Ph.D., P.Eng.*  
W.R. Bacon, Ph.D., P.Eng.

*Jill Suran*  
A Commissioner for taking Affidavits within British Columbia  
A Notary Public in and for the Province of British Columbia.  
SUB - MINING RECORDER

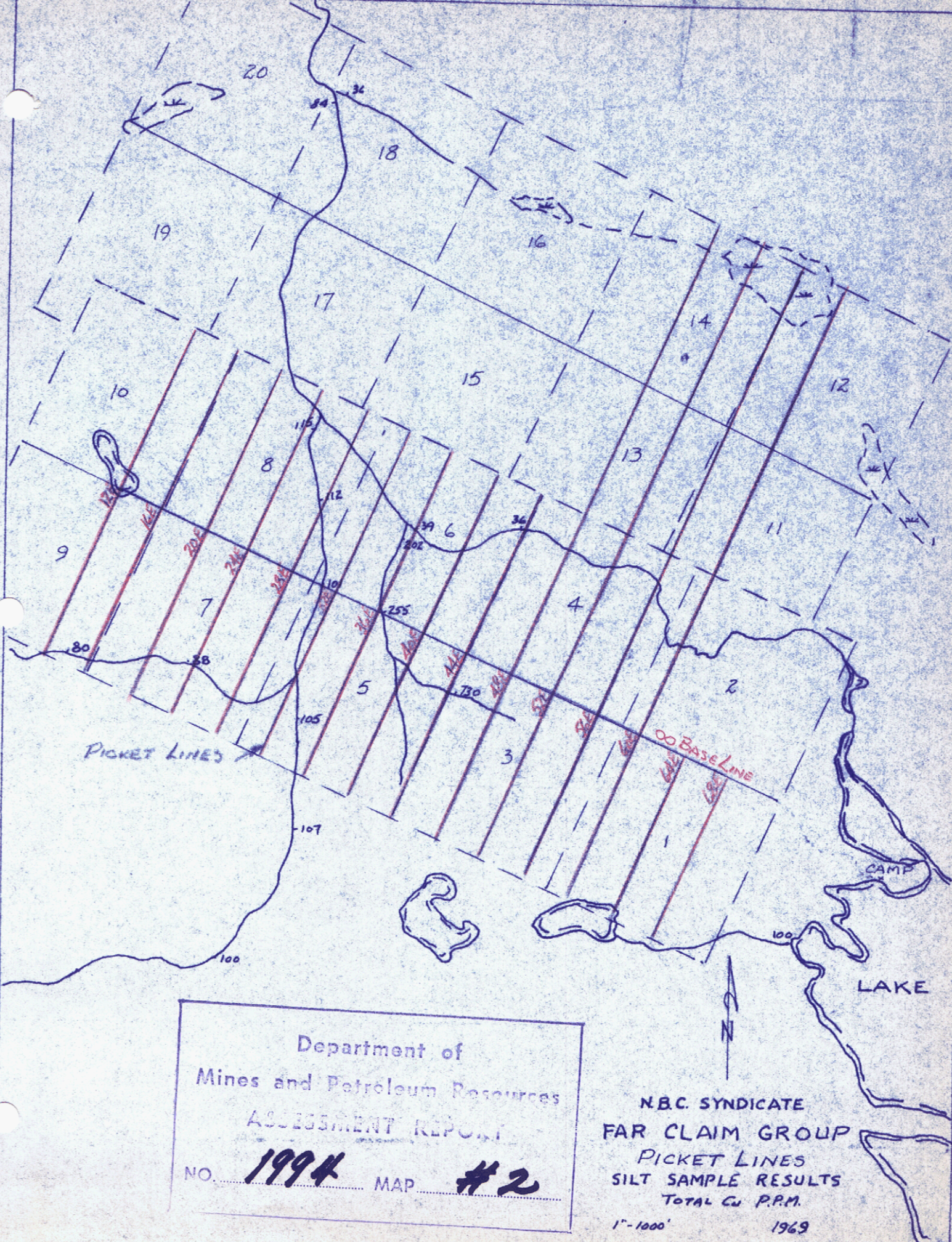

Department of  
 Mines and Petroleum Resources  
 ASSESSMENT REPORT  
 NO. **1994** MAP **#2**

NBC SYNDICATE  
 FAR CLAIM GROUP  
 PICKET LINES  
 SILT SAMPLE RESULTS  
 TOTAL CU P.P.M.  
 1"-1000' 1969

FIGURE 11



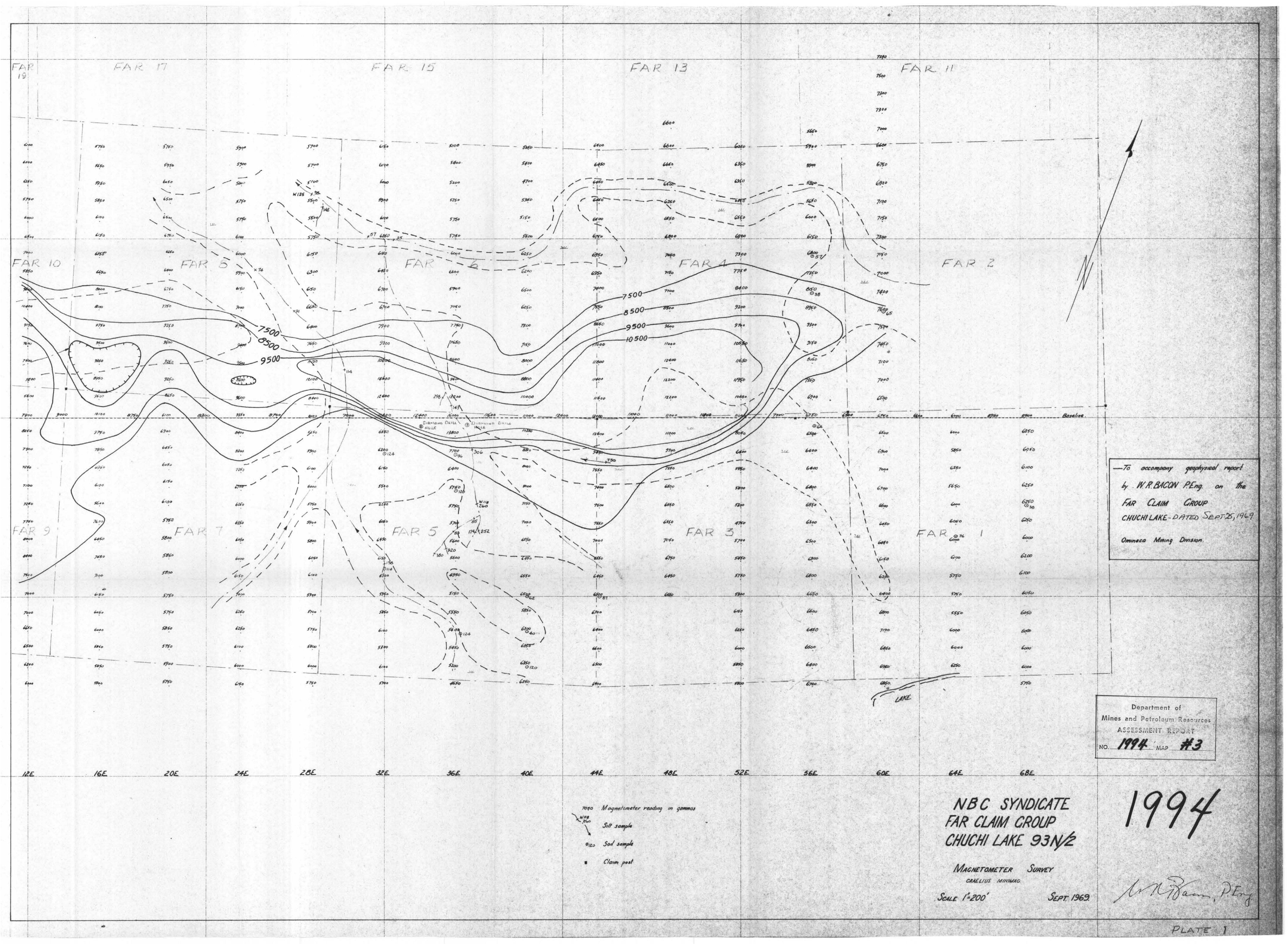

To accompany geophysical report  
 by W.R. BACON P.Eng. on the  
 FAR CLAIM GROUP  
 CHUCHI LAKE - DATED SEPT. 25, 1969  
 Omineca Mining Division.

Department of  
 Mines and Petroleum Resources  
 ASSESSMENT REPORT  
 NO. 1994 MAP #3

- 7000 Magnetometer reading in gammas
- N 1/8 S 1/2 Silt sample
- 0120 Soil sample
- Claim post

NBC SYNDICATE  
 FAR CLAIM GROUP  
 CHUCHI LAKE 93N 1/2

MAGNETOMETER SURVEY  
 CAELIUS MINING  
 SCALE 1"=200' SEPT. 1969

1994  
 W.R. Bacon P.Eng.