

2058

GEOCHEMICAL REPORT  
T.N. CLAIMS, SKUHUN CREEK  
4 MILES N.E. OF DOT, B. C.  
50°121°  
FOR 92106E  
CROYDON MINES LTD. (N.P.L.)  
SEPTEMBER 1 - OCTOBER 27, 1969

J. W. Hogan, P.Eng.  
L. J. Manning & Associates Ltd.,  
610 - 890 West Pender Street,  
Vancouver 1, B. C.

November 18, 1969

TABLE OF CONTENTS

Introduction	Page 1
General Geology and Topography	Page 1
Sampled Soil Horizon	Page 1
Sampling Procedure	Page 1
Sample Preparation and Laboratory Analysis	Page 2
Summary and Conclusions	Page 2
#1 Geochemical Plan - Scale 1" = 600'	In Pocket
#2 Location of Lines with Respect to Claim Boundaries - Scale 1" = 600'	In pocket

Department of  
Mines and Petroleum Resources  
ASSESSMENT REPORT  
NO. 2058 MAP .....

# L. J. MANNING & ASSOCIATES LTD.

CONSULTING MINING ENGINEERS

610-890 WEST PENDER STREET VANCOUVER 1, B.C.

OFFICE PHONE:  
683-8861

RESIDENTIAL PHONE:  
L. J. MANNING - 985-8690

## INTRODUCTION

The following report is on a Geochemical Soil Survey over the T.N. Group of claims, Skuhun Creek area, Highland Valley, B. C.

## GENERAL GEOLOGY AND TOPOGRAPHY

The west half of the property is underlain by the Hybrid Quartz Diorite phase of the Guichon Batholith. The east half of the property is underlain by the Chataway Granodiorite Phase of the Guichon.

Topography is generally flat except for lines 32 - 72N which are on the steep north facing slope of Skuhun Creek Valley.

## SAMPLED SOIL HORIZON

Soils were taken from the "B" Horizon. In general, "A<sub>1</sub>" leached horizon was 1" - 4" thick.

## SAMPLING PROCEDURE

Samples were taken on a line grid basis. This grid was at a 400' line interval on 200' stations. A shovel or mattock was used to reach the "B" Horizon where a 30-40 gram samples was placed in standard 4" x 9" soil sample envelopes. Drainage slope, swamp, etc. were marked on the envelope with the corresponding grid location.

Samples were partially air dried, and all information on the envelopes was transferred to record sheets. Samples were then shipped to Bondar-Clegg, North Vancouver.

SAMPLE PREPARATION AND LABORATORY ANALYSIS

Bondar-Clegg treated the samples in the following manner:

- Drying
- Visual determination of soil horizon, colour texture and organic content.
- Sieve to -80 mesh fraction.
- Hot extraction by  $\text{HNO}_3$  - HCL
- Atomic absorption analysis for copper parts per million.

SUMMARY AND CONCLUSIONS

The laboratory determination of organic content of samples eliminated the spurious anomalies resulting from incorrect sampling of the "A" horizon. The results of these organic samples are shown on the enclosed plan but the analysis were not used for determining threshold values. Threshold values were taken as double the median.

Several zones anomalous in copper were determined on the property. They are centered between lines 16N and 28N at 42W - 56W; between lines 44N and 48N at 48W - 62W and between 56N and 60N at 50W - 56W.

Respectfully submitted,

L. J. MANNING & ASSOCIATES LTD.

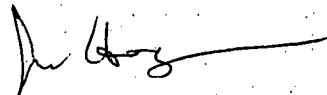

John W. Hogan, P.Eng.

JWH:mjb

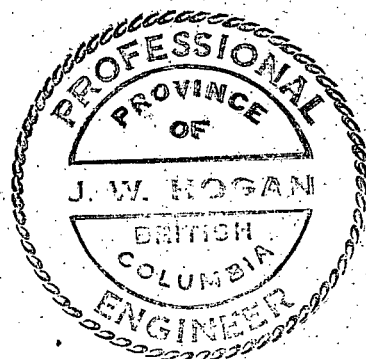

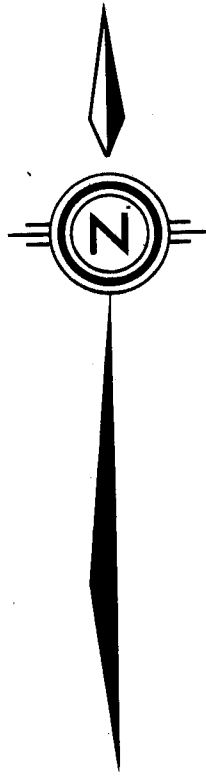

Department of  
Mines and Petroleum Resources  
ASSESSMENT REPORT  
NO. 2058 MAP 02

CROYDON MINES LIMITED (NPL)  
"TN" GROUP GRID SYSTEM  
SKUHUN CREEK AREA, HIGHLAND VALLEY, BRITISH COLUMBIA.  
SCALE: 1" = 600' REF. MAP 921/6E.

2058

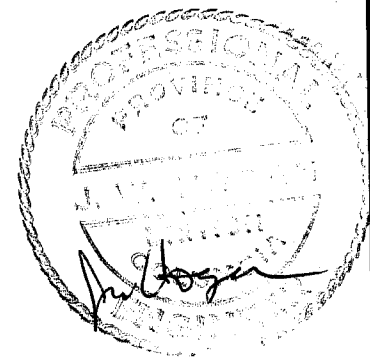

TO ACCOMPANY GEOCHEMICAL REPORT BY J. HOGAN, P. ENG. ON  
THE TN GROUP, SKUHUN CREEK, KAMLOOPS MINING DIVISION  
DATED: NOV 18, 1969

AMEX EX. SERVICES LTD., KAMLOOPS, B.C. OCTOBER, 1969.

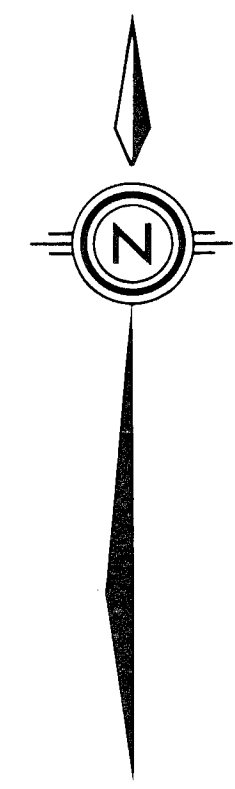
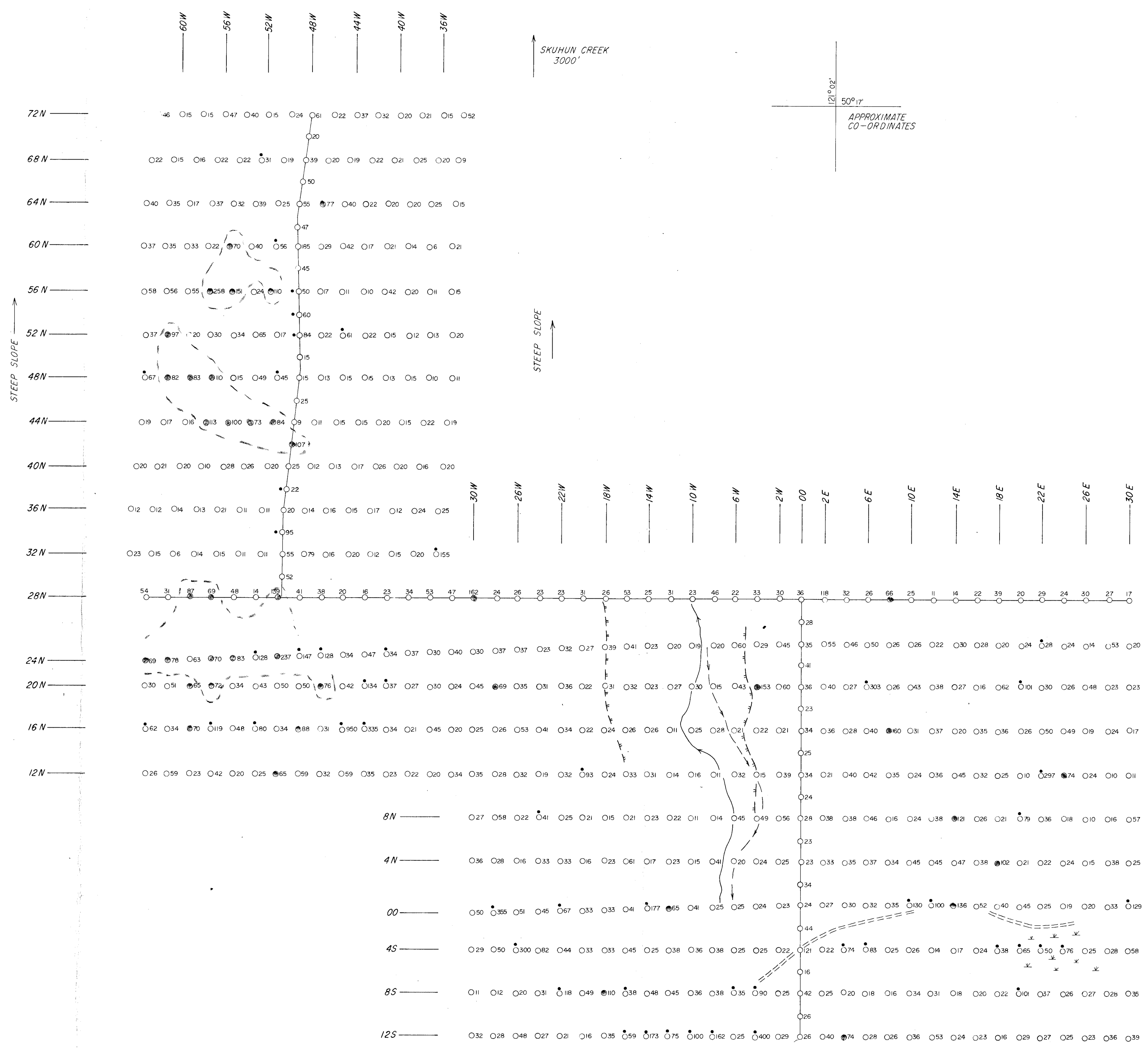

- SYMBOLS**
- Dirt road
  - Swamp
  - Top of slope—hitches point down slopes
- GEOCHEM SYMBOLS**
- O Geochemical sample location and Cos per value in p.p.m.
  - Threshold value 65 p.p.m.
  - Anomalous value +65 p.p.m.
  - Higher than normal organics in soil sample

Department of  
Mines and Petroleum Resources  
ASSESSMENT REPORT  
NO. **2058** MAP **91**

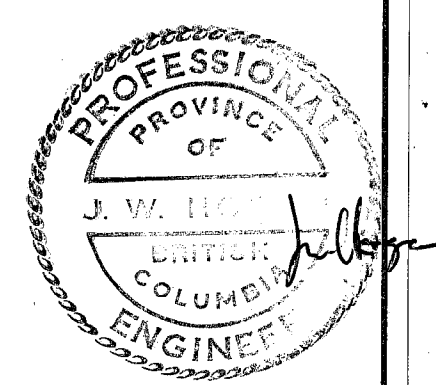

L. J. MANNING & ASSOCIATES LTD.  
VANCOUVER, B. C.  
CROYDON MINES LTD.  
**GEOCHEMICAL PLAN**  
T. N. CLAIM GROUP  
HIGHLAND VALLEY, B. C.

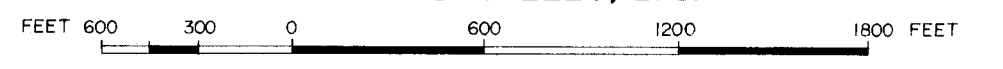

**2058**

To accompany geochemical report by J. Hagan, P. Eng. on the T. N. group, Skuhun Creek, Kamloops Mining Division—dated Nov. 1969