

2111

GEOCHEMICAL REPORT
CHALCO CLAIMS, PUKAIST CREEK
2 MILES S.E. OF TOKETIC, B.C.
50°121' N. E.
FOR
TROY SILVER MINES LTD. (N.P.L.)
OCTOBER 1969

J. W. Hogan, P.Eng.
L. J. Manning & Associates Limited,
610 - 890 West Pender Street,
Vancouver 1, B. C.

December 2, 1969

L. J. MANNING & ASSOCIATES LTD.
CONSULTING MINING ENGINEERS

610-890 WEST PENDER STREET VANCOUVER 1. B.C.

OFFICE PHONE:
683-5861

RESIDENTIAL PHONE:
L. J. MANNING - 985-5690

December 2, 1969

Chief Gold Commissioner,
Victoria, B. C.

Dear Sir:

I was not the supervisor of the
geochemical work performed on the Chalco
Group of Claims, Pukaist Creek, B. C.
However, I have been in charge of, and present
on other geochemical surveys where Mr. Leo Halton who
took the geochemical samples on the Chalco Group was
involved.

To the best of my knowledge he is competent
for the task involved.

Respectfully submitted,

L. J. MANNING & ASSOCIATES LTD.



John W. Hogan, P.Eng.

JWH:mjb



TABLE OF CONTENTS

Introduction	Page 1
General Geology and topography	Page 1
Sampled Soil Horizon	Page 1
Sampling Procedure	Page 1
Sample Preparation and Laboratory Analysis	Page 2
Summary and Conclusions	Page 2

#1 Geochemical Plan - 1" = 400'	In Pocket
#2 Location of Lines with Respect to Claim Boundaries - 1" = 800'	In Pocket

Department of
Mines and Petroleum Resources
ASSESSMENT REPORT
NO. 2111 MAP

L. J. MANNING & ASSOCIATES LTD.

CONSULTING MINING ENGINEERS

610-890 WEST PENDER STREET

VANCOUVER 1, B.C.

OFFICE PHONE:
683-5861

RESIDENTIAL PHONE:
L. J. MANNING - 985-5690

INTRODUCTION

The following report is on a geochemical soil survey over a west portion of the Chalco Group of claims, Pukaist Creek area, Highland Valley, B. C.

GENERAL GEOLOGY AND TOPOGRAPHY

The property is underlain by the Hybrid Quartz Diorite phase of the Guichon Batholith. Older Cache Creek rocks outcrop in the southwest corner of the property. Topography is moderate to steep, with Pukaist Creek following a precipitous canyon for most of its course through the south portion of the property.

SAMPLED SOIL HORIZON

Soils were taken from the "B" Horizon. In general "A₂" leached horizon was 1" - 4" thick.

SAMPLING PROCEDURE

Samples were taken on a line grid basis. This grid was at a 500' line interval on 200' stations, with fill in sampling as indicated on the enclosed plan. A shovel was used to reach the "B" Horizon where a 30-40 gram sample was placed in standard 4" x 9" soil sample envelopes. Drainage slope, swamp, etc. were marked on the envelope with corresponding grid location.

Samples were air dried and shipped to Crest Laboratories, Vancouver, B. C.

SAMPLE PREPARATION AND LABORATORY ANALYSIS

Crest Laboratories treated the samples in the following manner:

- Drying
- Sieve to -80 mesh fraction
- Hot extraction - $\text{HClO}_4\text{-HNO}_3$
- Atomic absorption analysis for copper parts per million

SUMMARY AND CONCLUSIONS

Threshold values were taken as roughly double the median. Above threshold (anomalous) values are shown in red on the enclosed plan.

An anomalous copper zone of near threshold, threshold values and above threshold values is located at approximately baseline No. 3 - 22 + 50S - 35S - 1 5E. Overburden cover will be 20' to 30' over parts of the anomaly.

Respectfully submitted,

L. J. MANNING & ASSOCIATES LTD.

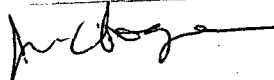

John W. Hogan, P.Eng.

JWH:mjb

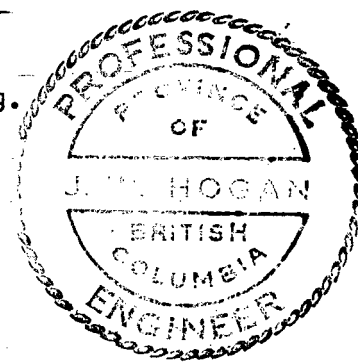

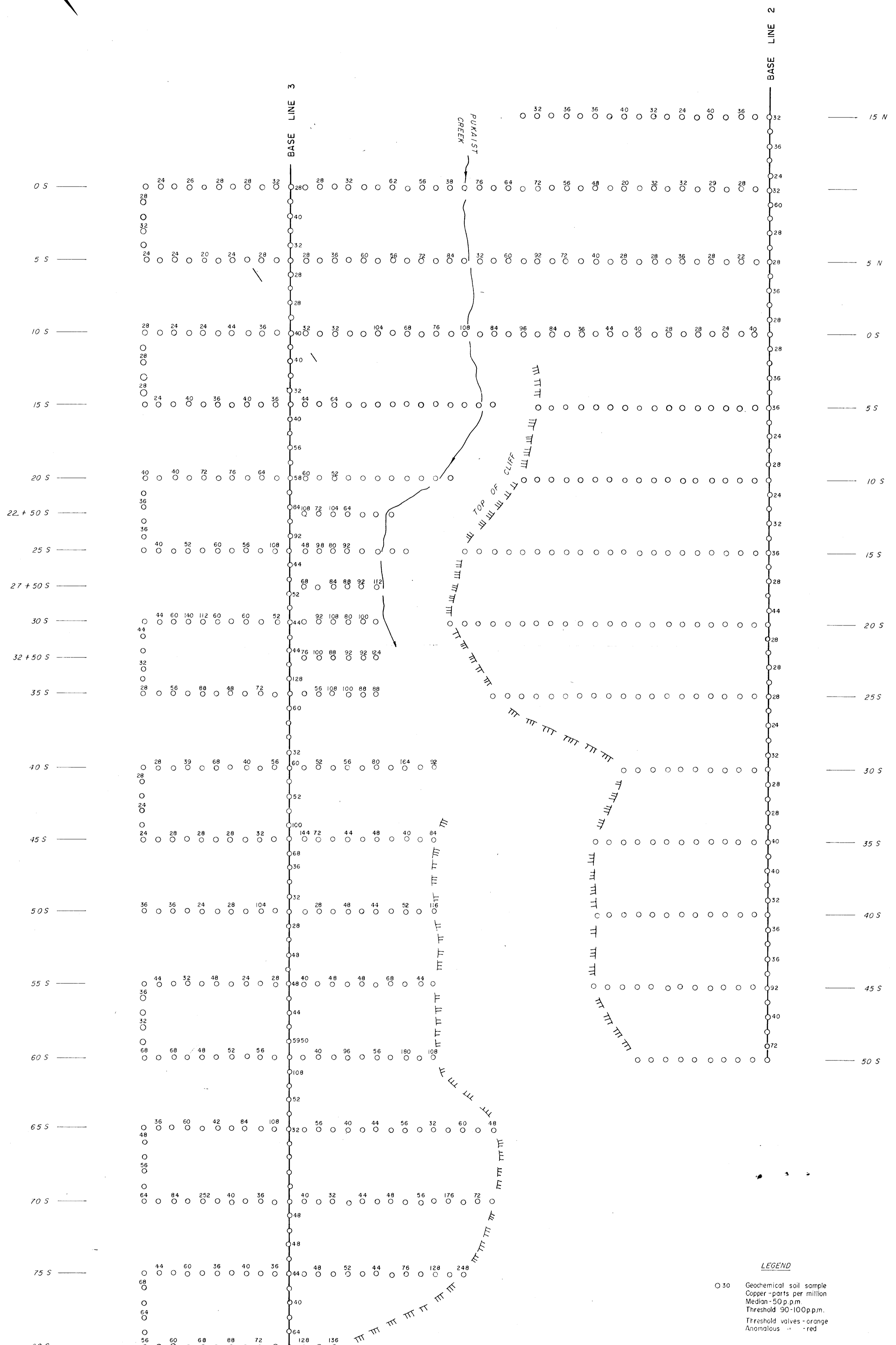
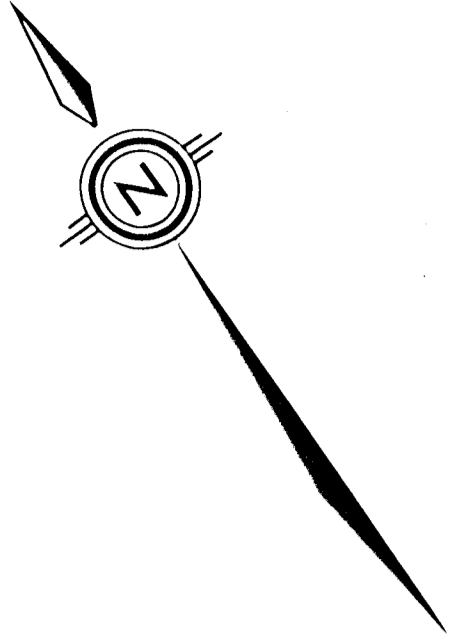

Department of
 Mines and Petroleum Resources
 ASSESSMENT REPORT
 NO. 2111 MAP #1

TROY SILVER MINES LTD.
 GEOCHEMICAL SURVEY
 WEST PORTION-CHALCO GROUP-PUKAIST CREEK
 KAMLOOPS M.D. B.C.

LEGEND
 0.30 Geochemical soil sample
 Copper - parts per million
 Median - 50 p.p.m.
 Threshold - 90-100 p.p.m.
 Threshold values - orange
 Anomalous - red

NOTE:
 TO ACCOMPANY GEOCHEMICAL REPORT BY JOHN W. HOGAN, P.E.M.
 ON THE CHALCO GROUP ON PUKAIST CREEK, KAMLOOPS M.D.
 DATED DECEMBER 4, 1969

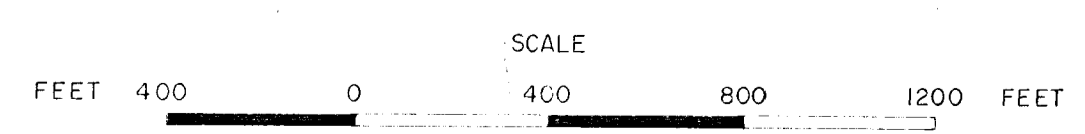

J. J. Channing

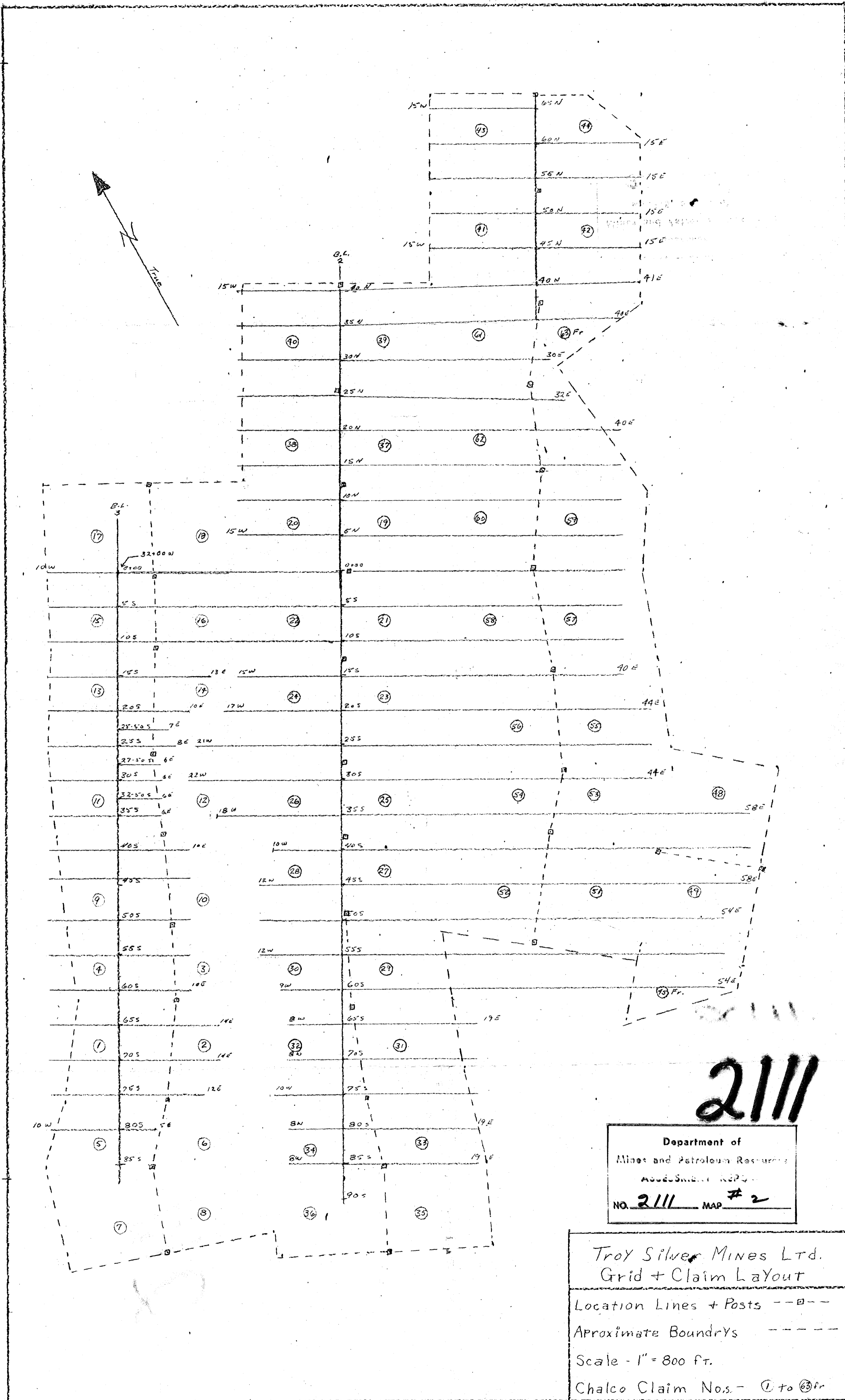

Department of
 Mines and Petroleum Resources
 ASSESSMENT REPORT
 NO. 2111 MAP # 2

Troy Silver Mines Ltd.
 Grid + Claim Layout
 Location Lines + Posts --□--
 Approximate Boundrys - - - -
 Scale - 1" = 800 ft.
 Chalco Claim Nos. - ① to ③4