

Geophysical Report 92013W
on Cannoo - Taseko Project
Taseko River Area, B.C.
Lat: 51°00' Long: 122°00' May-Dec., 1969
By: D. R. Doal, S.R.O.

Part
B

92013W

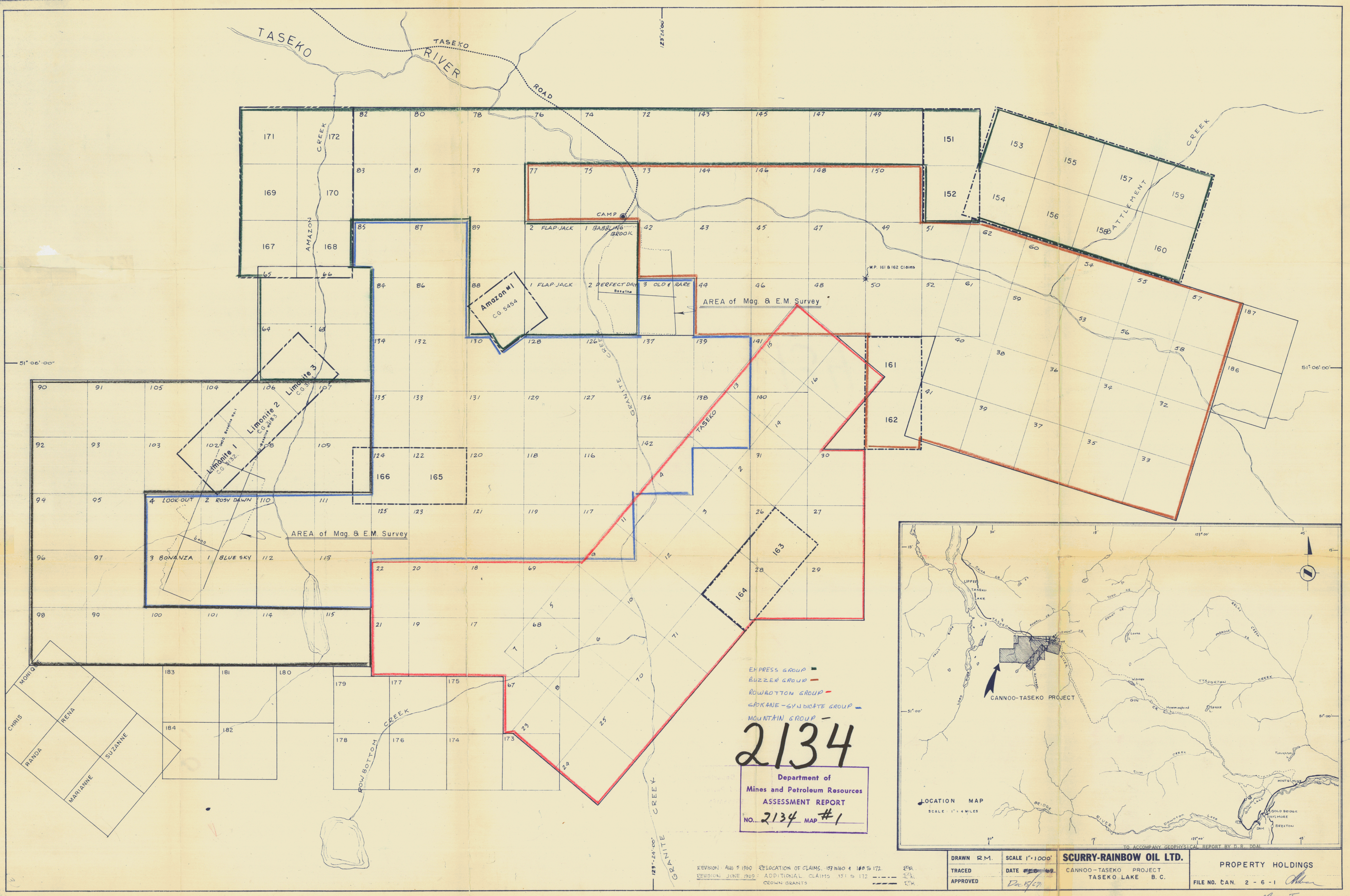

2134
 Department of
 Mines and Petroleum Resources
 ASSESSMENT REPORT
 NO. 2134 MAP #1

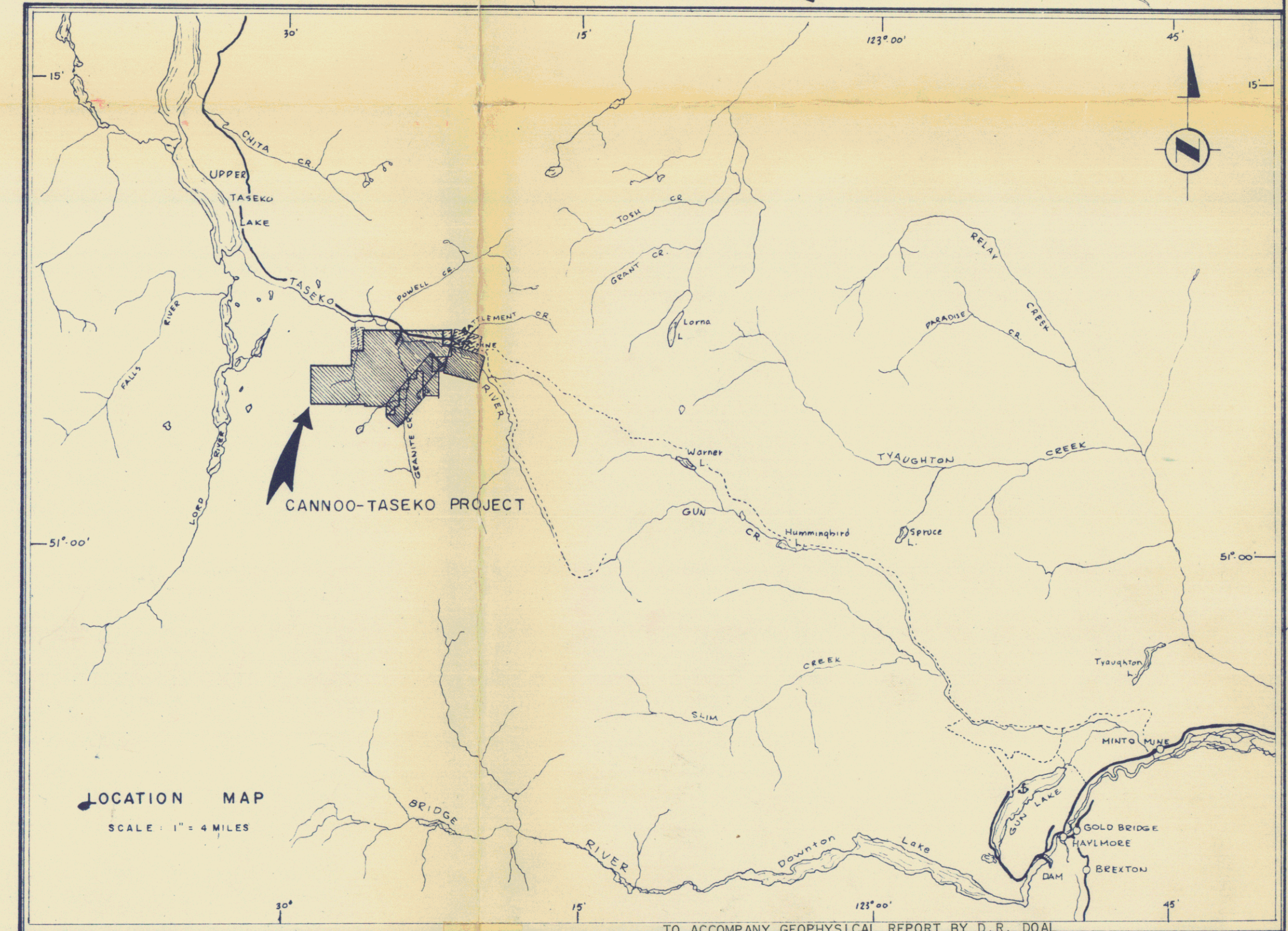

DRAWN R.M.	SCALE 1" = 1000'	SCURRY-RAINBOW OIL LTD.	PROPERTY HOLDINGS
TRACED	DATE 1969	CANNOO-TASEKO PROJECT	
APPROVED	DATE 1969	TASEKO LAKE B.C.	FILE NO. CAN. 2-6-1

REVISION AUG 9 1960 RELOCATION OF CLAIMS 157 TO 160 & 168 TO 172
 REVISION JUNE 1969 ADDITIONAL CLAIMS 151 TO 172
 CROWN GRANTS

Map I



2134

Department of
Mines and Petroleum Resources
ASSESSMENT REPORT
NO. 2134 MAP #7

DRAWN		SCALE 1" = 200'	SCURRY-RAINBOW OIL LTD.		MAGNETOMETER SURVEY
TRACED R M		DATE NOV 1969	CANNOO TASEKO	SPOKANE GROUP	
APPROVED			BLOCK AA-KK	PLAN	FILE NO. CAN 4-1-8 Map VII

TO ACCOMPANY GEOPHYSICAL REPORT BY D.R. DOAL

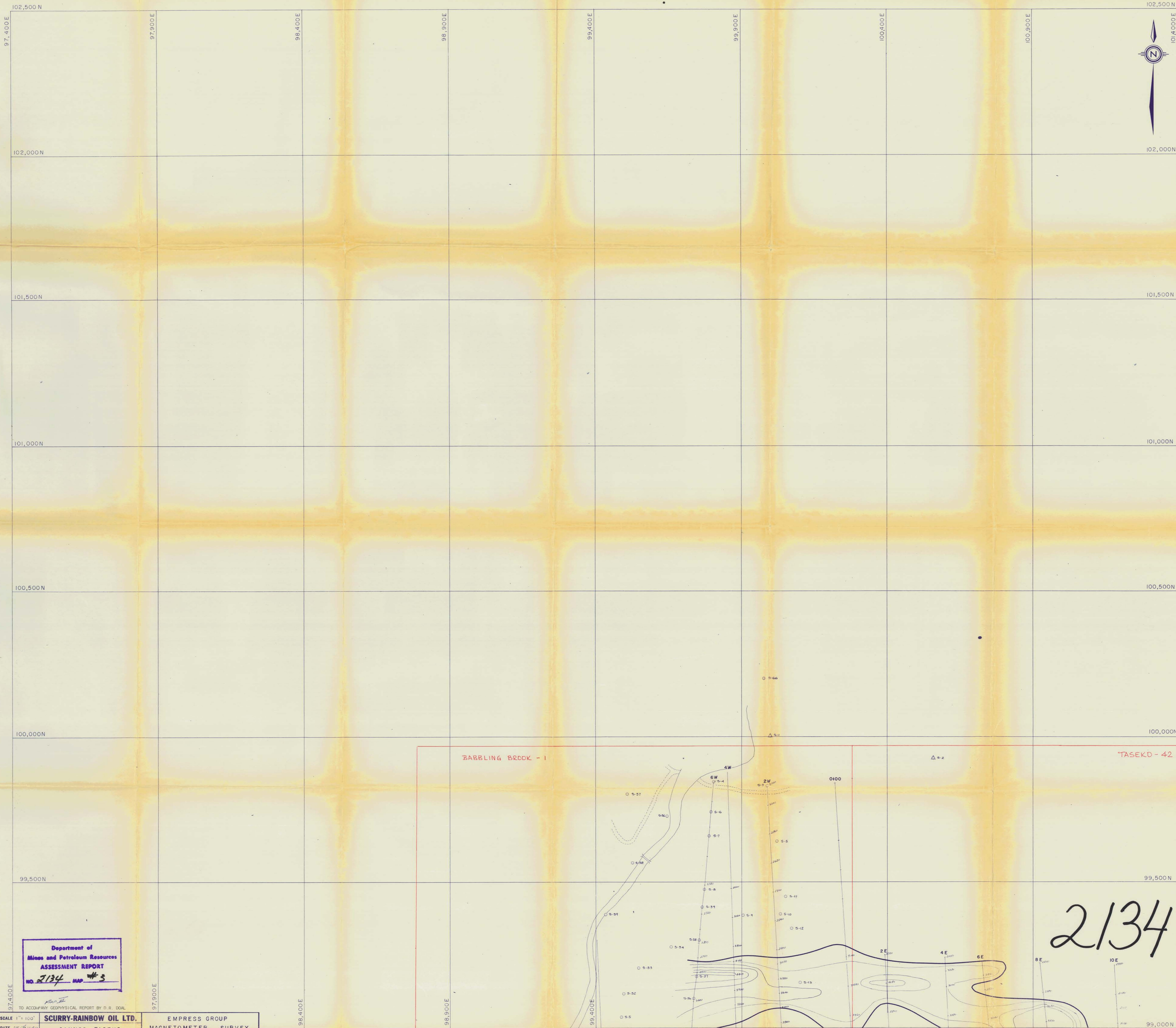

BABBLING BROOK - 1

TASEKD - 42

2134

Department of
Mines and Petroleum Resources
ASSESSMENT REPORT
NO. 2134 MAP # 3

DRAWN	SCALE 1" = 100'	SCURRY-RAINBOW OIL LTD.	EMPRESS GROUP
TRACED R.M.	DATE DEC 1969	CANNOO TASEKO	MAGNETOMETER SURVEY
APPROVED		BLOCK M PLAN	FILE NO.

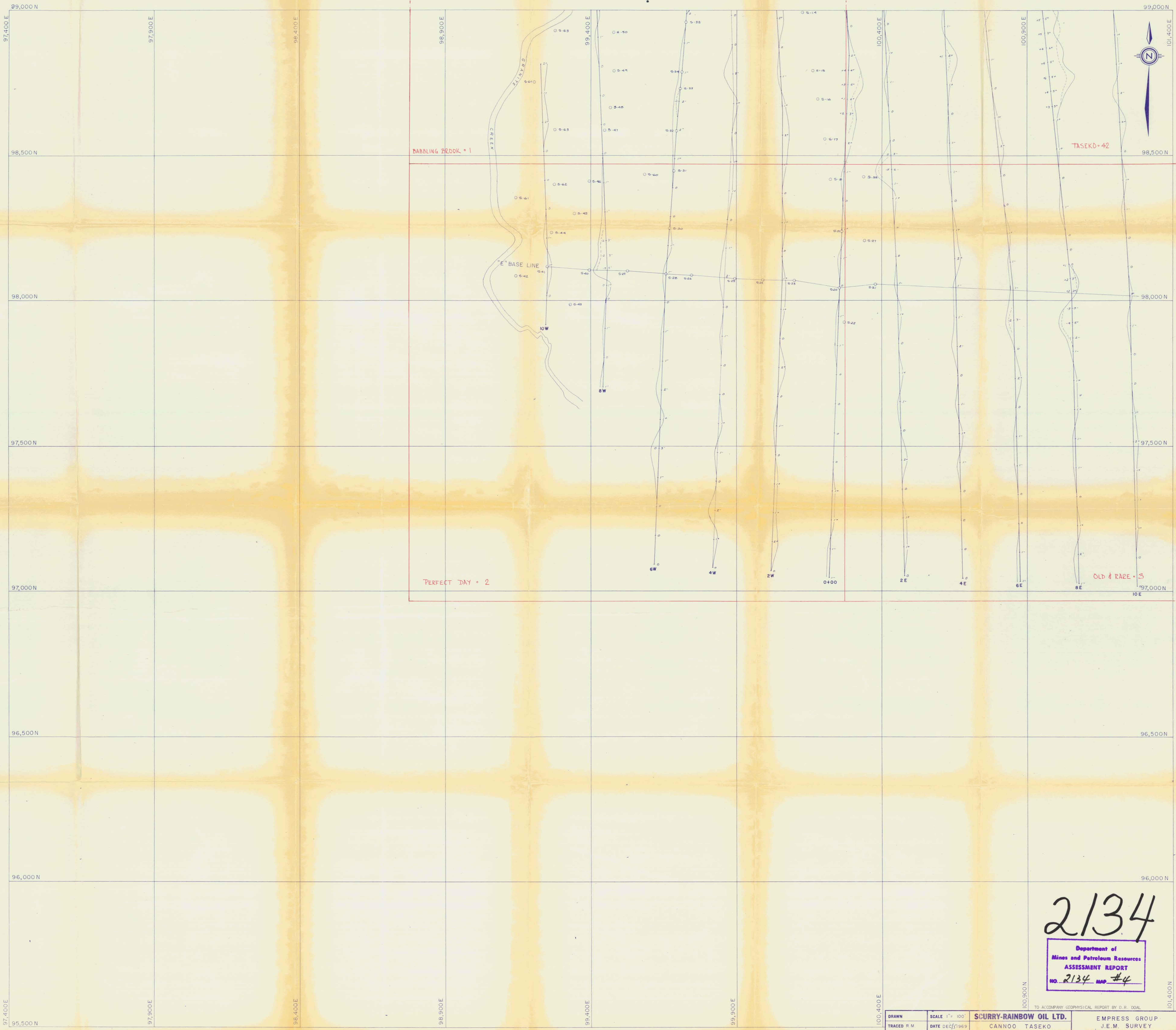

2134

Department of
Mines and Petroleum Resources
ASSESSMENT REPORT
NO. 2134 MAP #4

DRAWN	SCALE 1" = 100'	SCURRY-RAINBOW OIL LTD.	TO ACCOMPANY GEOPHYSICAL REPORT BY D.R. DOAL
TRACED R.M.	DATE DEC/1969	CANNOO TASEKO	EMPRESS GROUP
APPROVED	<i>[Signature]</i>	BLOCK V PLAN	J.E.M. SURVEY
			FILE NO. <i>[Signature]</i>

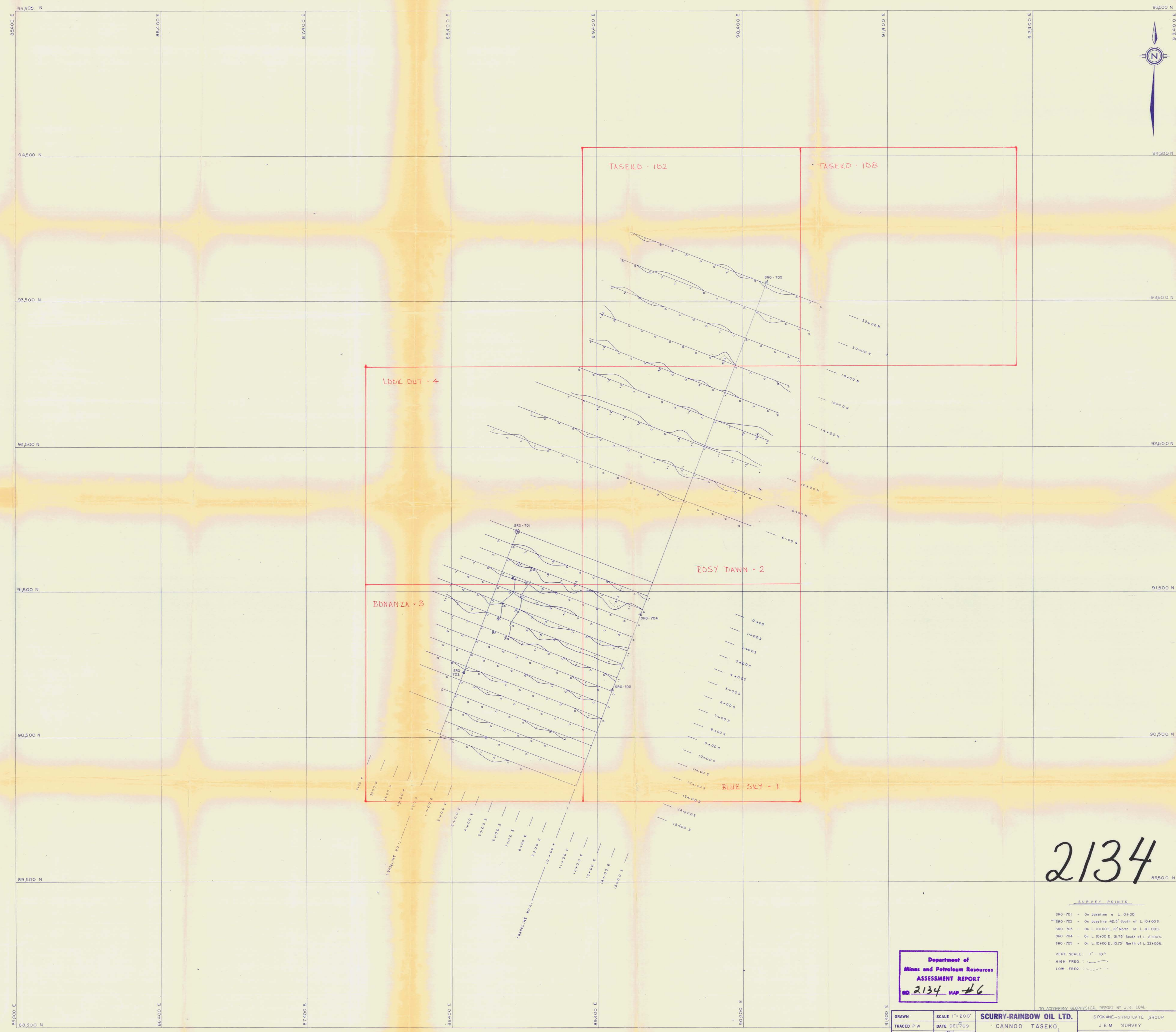

2134

SURVEY POINTS
SR0-701 - On baseline @ L 0+00
SR0-702 - On baseline 42.5' South of L 10+00S
SR0-703 - On L 10+00 E, 12' North of L 8+00S
SR0-704 - On L 10+00 E, 31.75' South of L 2+00S
SR0-705 - On L 10+00 E, 10.75' North of L 22+00N

VERT SCALE: 1" = 10'
HIGH FREQ:
LOW FREQ:

Department of
Mines and Petroleum Resources
ASSESSMENT REPORT
NO. 2134 MAP #6

TO ACCOMPANY GEOPHYSICAL REPORT BY W.R. DOAL

DRAWN	SCALE 1" = 200'	SCURRY-RAINBOW OIL LTD.	SPOKANE-SYNDICATE GROUP
TRACED P.W.	DATE DEC 1969	CANNOO TASEKO	J.E.M. SURVEY
APPROVED		BLOCK AA-KK	PLAN
		FILE NO.	Map V1

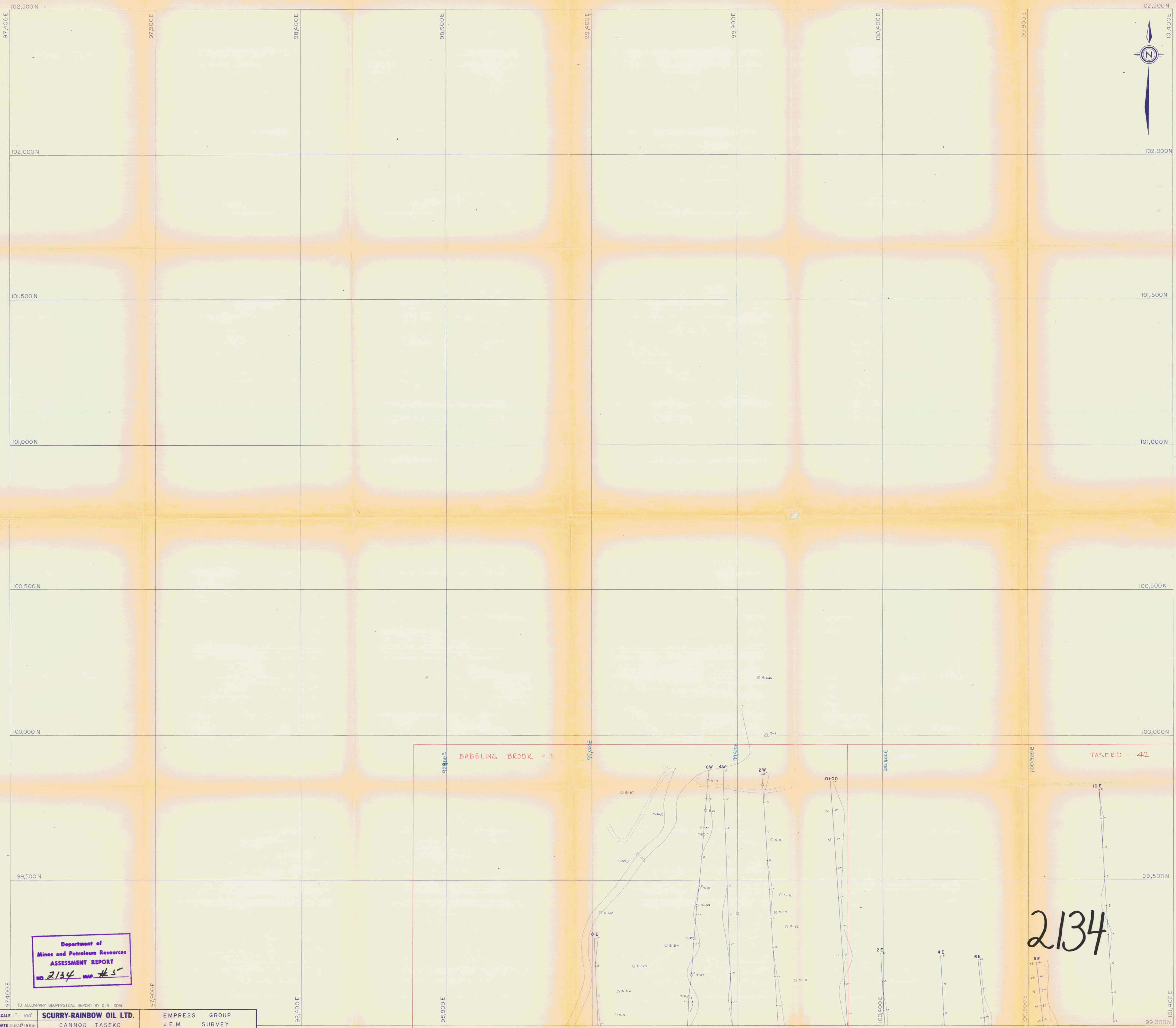

2134

Department of
Mines and Petroleum Resources
ASSESSMENT REPORT
NO. 2134 MAP # 5

DRAWN	SCALE 1" = 100'	SCURRY-RAINBOW OIL LTD.	EMPRESS GROUP
TRACED R.M.	DATE DEC 15 1969	CANNOO TASEKO	J.E.M. SURVEY
APPROVED		BLOCK: M PLAN	FILE NO.

TO ACCOMPANY GEOPHYSICAL REPORT BY D.R. DOAL