

LINECUTTING REPORT

CLAIMS: PH AND CT
OWNER: G. L. OATES
BY: A.A. ABLETT
MINING DIVISION: KAMLOOPS & NICOLA
WORK DONE: FEB. 14 - MARCH 15, 1970

PH and CT GROUPS

NO DEPOSIT ?
9:1 / 6E in point

50° 13 1/2' - 16 1/2'
121° 00.3' - 02.7'





SCALE: 1" = 1/2 MILE.

PH 13	PH 14	PH 16	PH 15	PH 21	PH 22		
PH 11	PH 12	PH 18	PH 17	PH 39	PH 20	PH 28	PH 23
PH 9	PH 10	PH 20	PH 19	PH 37	PH 38	PH 46	PH 45
PH 7	PH 8	PH 22	PH 21	PH 35	PH 36	PH 48	PH 47
PH 5	PH 6	PH 24	PH 23	PH 33	PH 34	PH 50	PH 49
PH 3	PH 4	PH 26	PH 25	PH 31	PH 32	PH 52	PH 51
PH 1	PH 2	PH 28	PH 27	PH 29	PH 30	PH 54	PH 53
CT 2	CT 1	CT 31	CT 32	CT 34	CT 33	CT 59	CT 60
CT 4	CT 3	CT 29	CT 30	CT 36	CT 35	CT 57	CT 58
CT 6	CT 5	CT 27	CT 28	CT 38	CT 37	CT 55	CT 56
CT 8	CT 7	CT 25	CT 26	CT 40	CT 39	CT 53	CT 54
CT 10	CT 9	CT 23	CT 24	CT 42	CT 41	CT 51	CT 52
CT 12	CT 11	CT 21	CT 22	CT 44	CT 43	CT 49	CT 50
CT 14	CT 13	CT 19	CT 20	CT 46	CT 45		
CT 16	CT 15	CT 17	CT 18	CT 48	CT 47		

Abbott L.

Gordon L.

Gordon Cr.

55.1 mile grid

KAMLOOPS M.D.
MERRITT M.D.

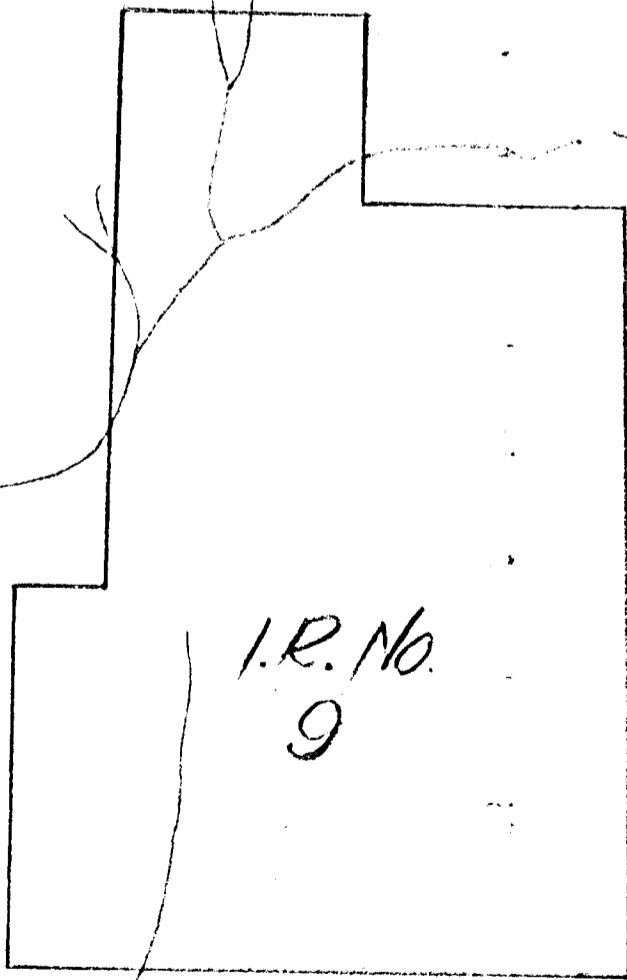

I.R. No.
9

2270

Department of
Mines and Petroleum Resources
ASSESSMENT REPORT
NO. 2270 MAP #1

REF. MAPS 921/3E and 6E.

"PH" and "CT" GROUPS
GORDON CR. AREA
Kamloops and Merritt Mining Divisions.