

PROPRIETE

ZYMOETZ

SITUATION DES TRAVAUX.
UPPER SHOWING.

Echelle 1:50'

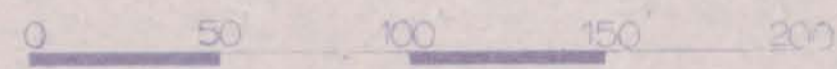

Date 12 3 1970

Auteur B HUSSON
To accompany geological report, by J.P. Nicolet, on Pany, Kom and Natan Groups of claims, on Zymoetz River, Ontario M.D.

LEGENDE

- Chemin carrossable Road
- Projection horizontale des sondages de NATIVE MINES
Horizontal projection of drills
- Travaux miniers realises
Underground works
- Tracé du projet de travaux miniers
Projected adds
- Stations sondage au niveau des travaux miniers
Drilling station in underground works.

Department of
Mines and Petroleum Resources
ASSESSMENT REPORT
NO. **2394** MAP # **22**

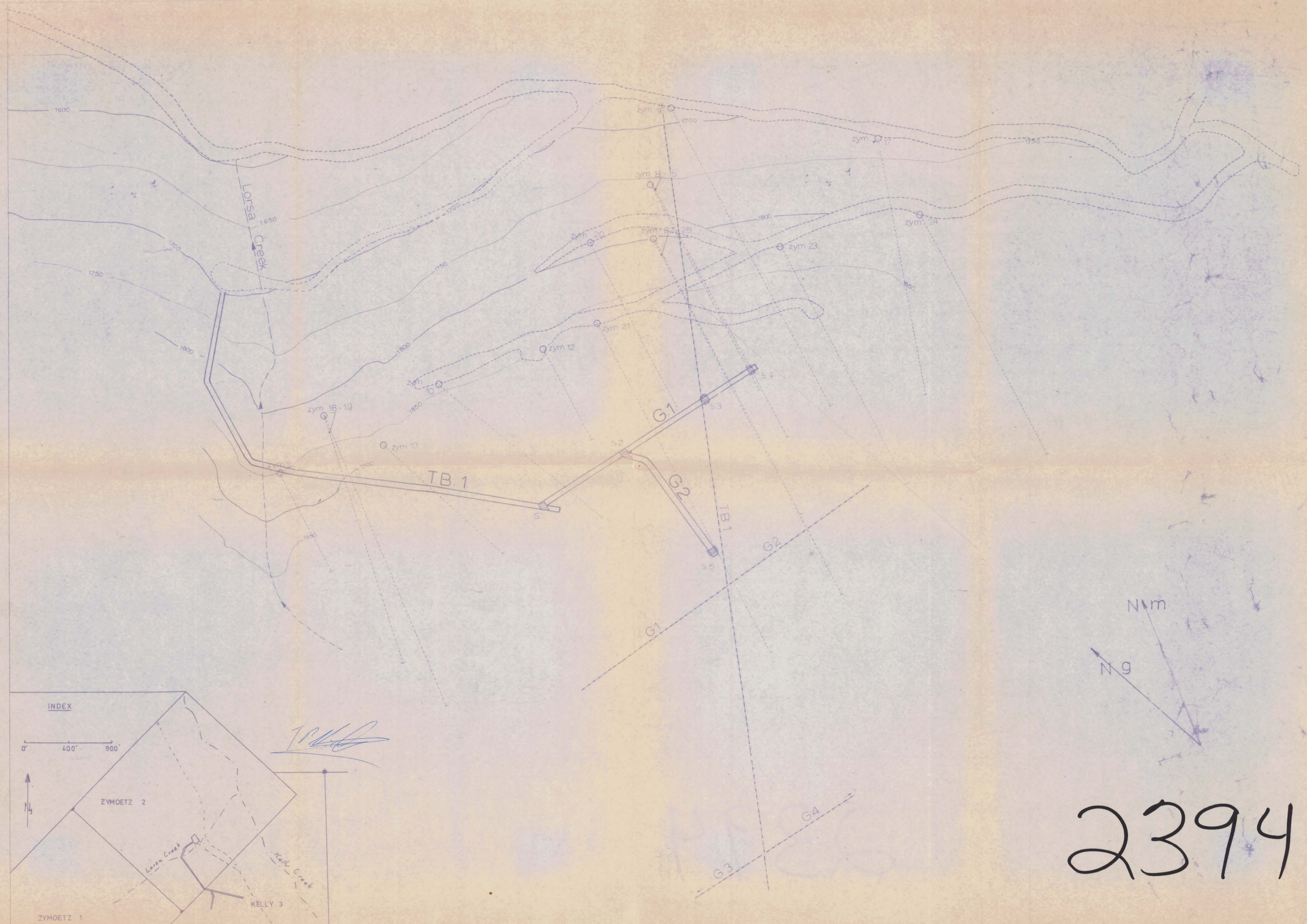

INDEX

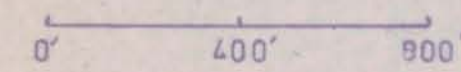

2394

PROPRIETE

ZYMOETZ

TRAVAUX MINERS - UPPER SHOWING

PLAN GEOLOGIQUE COTE 1670

Echelle 1:50'

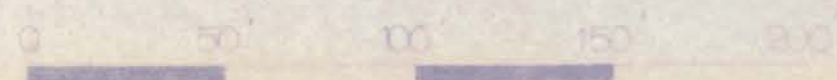

To accompany geological report by J.P. Nicolet on Panny, Kom and Naton groups of claims on Zymoetz river - Ontario M.D.

B. HUSSON

LEGENDE

- Granodiorite
- Porphyre andesitique
- Diorite
- Roches volcaniques
Volcanics
- Faille observee
Observed fault
- Faille interpretee
Assumed fault
- Impact sondage dans le plan de coupe
Intersection drill in cross-section
- Passee mineralisee dans sondages
Mineralized section in drill
- Formations mineralisables
Assumed mineralized formation
- Stations de sondages dans travaux miniers
Drilling station in adits
- Projecteurs des sondages = projections des sondages

Department of
Mines and Petroleum Resources
ASSESSMENT REPORT
NO. **2394** MAP # **25**

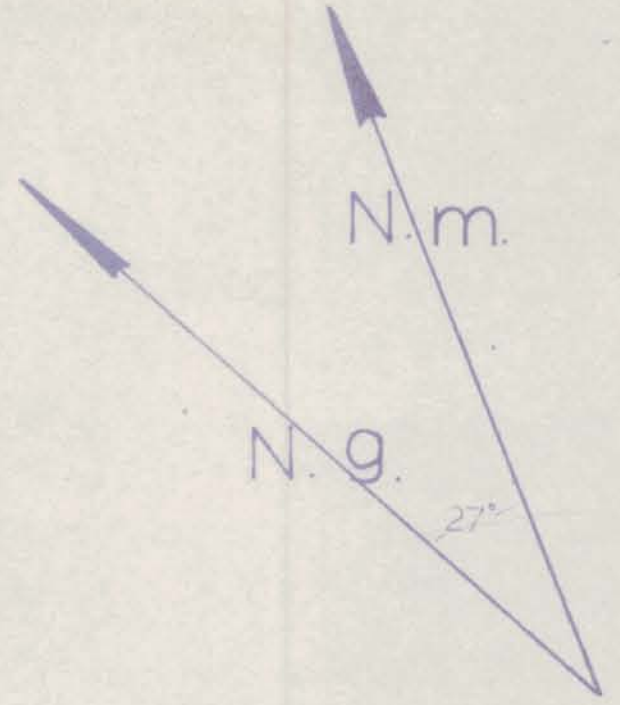
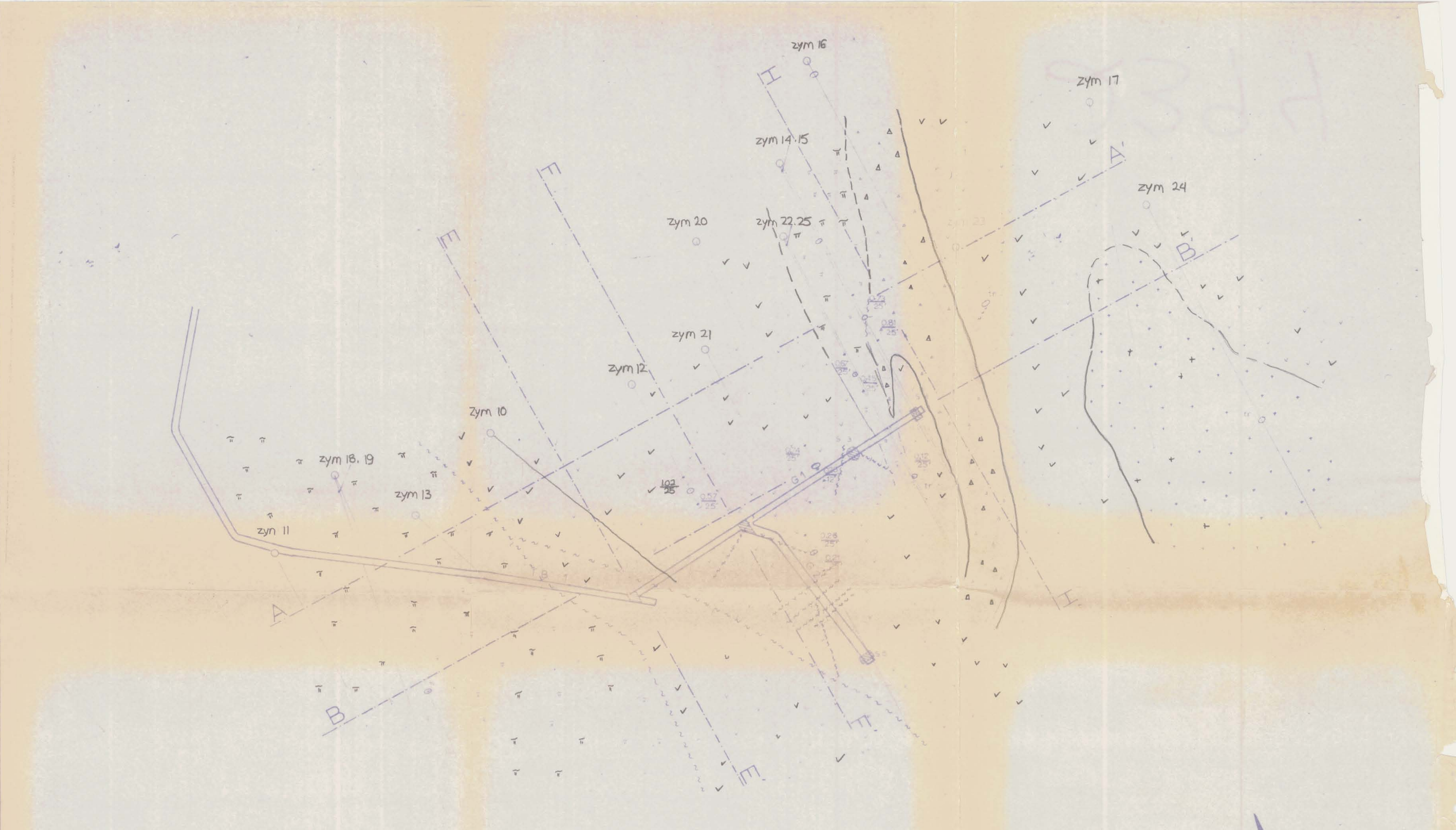
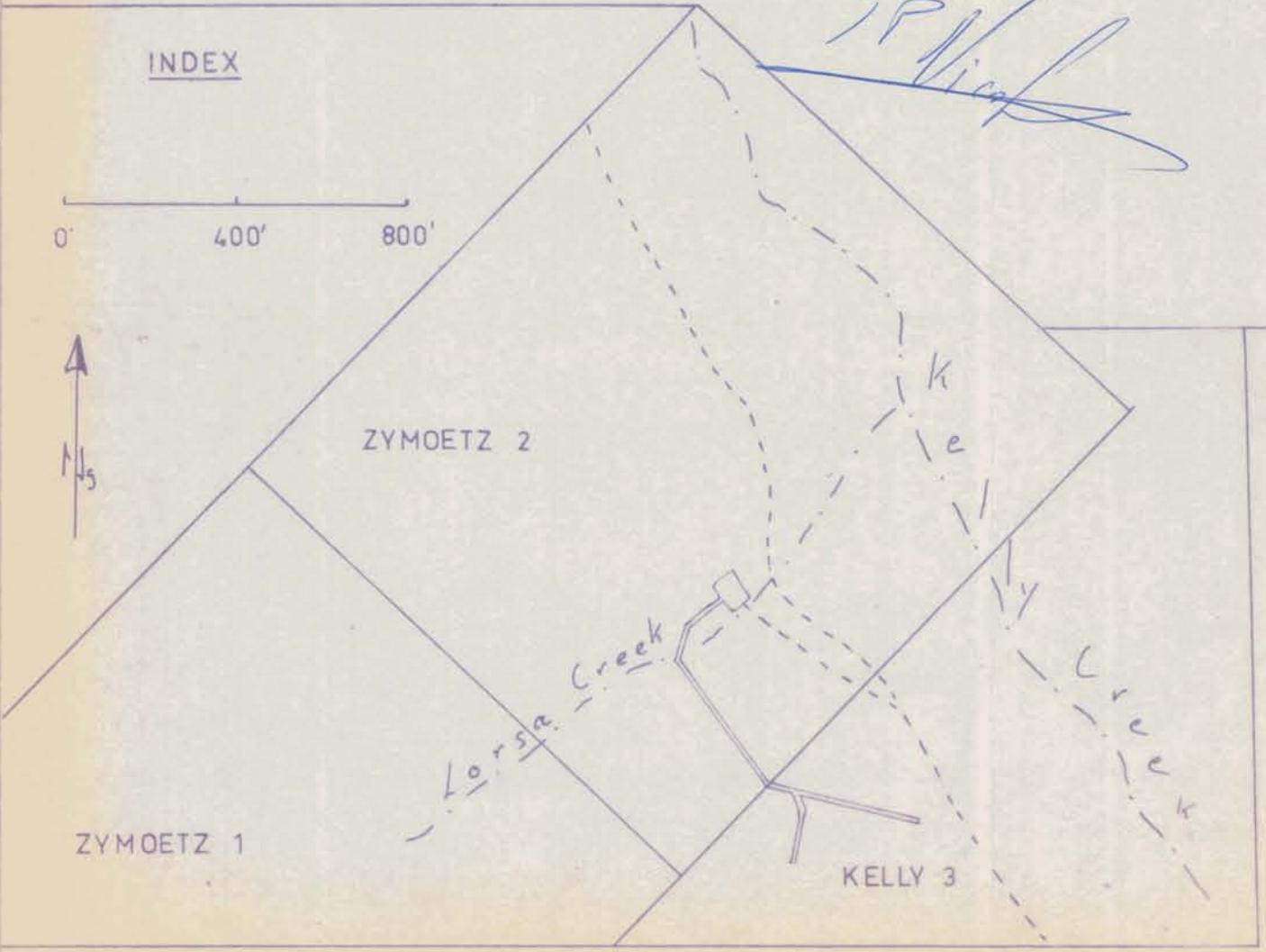

2394

GALERIE G1 200-281

Department of
 Mines and Petroleum Resources
 ASSESSMENT REPORT
 NO. **2394** MAP **#29**

Date	
Avancement	
Front	N°
	AVANCEMENT
de	LEVÉ
Taille	
Parement gauche	RAINURAGE
	LEVÉ
Couronne	LEVÉ
Parement droit	LEVÉ
	RAINURAGE
Boues de foration	
Orientation de la galerie	

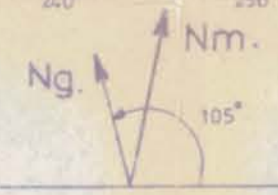
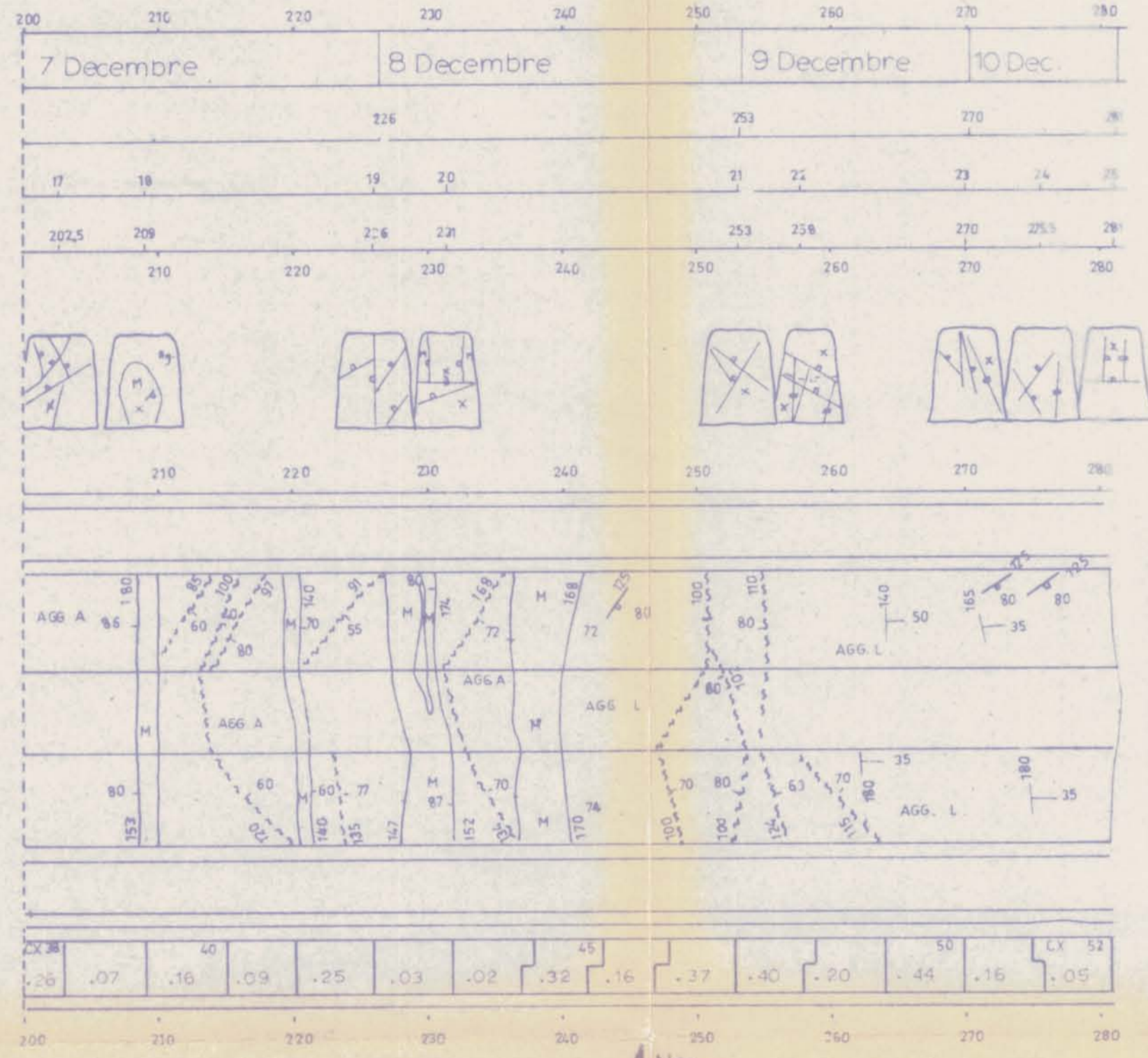

JP Nicolet



TRAVERS-BANCS TB.1 205-400.

Date	
Avancement	
Front de Taille	N ^o
	AVANCEMENT
Parement gauche	LEVÉ
	RAINURAGE
Couronne	LEVÉ
Parement droit	LEVÉ
	RAINURAGE
Boues de foration	
Orientation du Travers-Bancs	

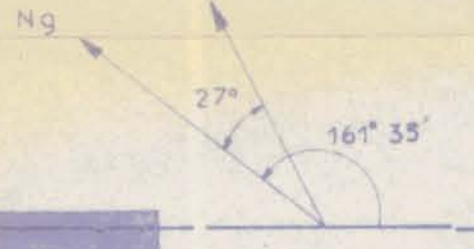
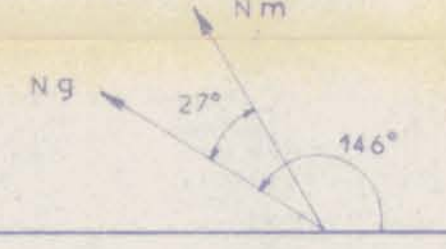
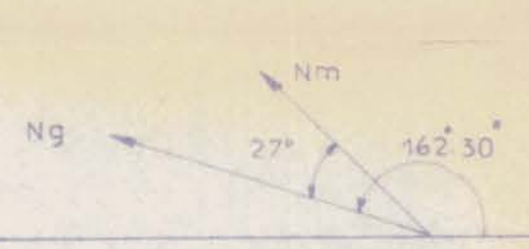
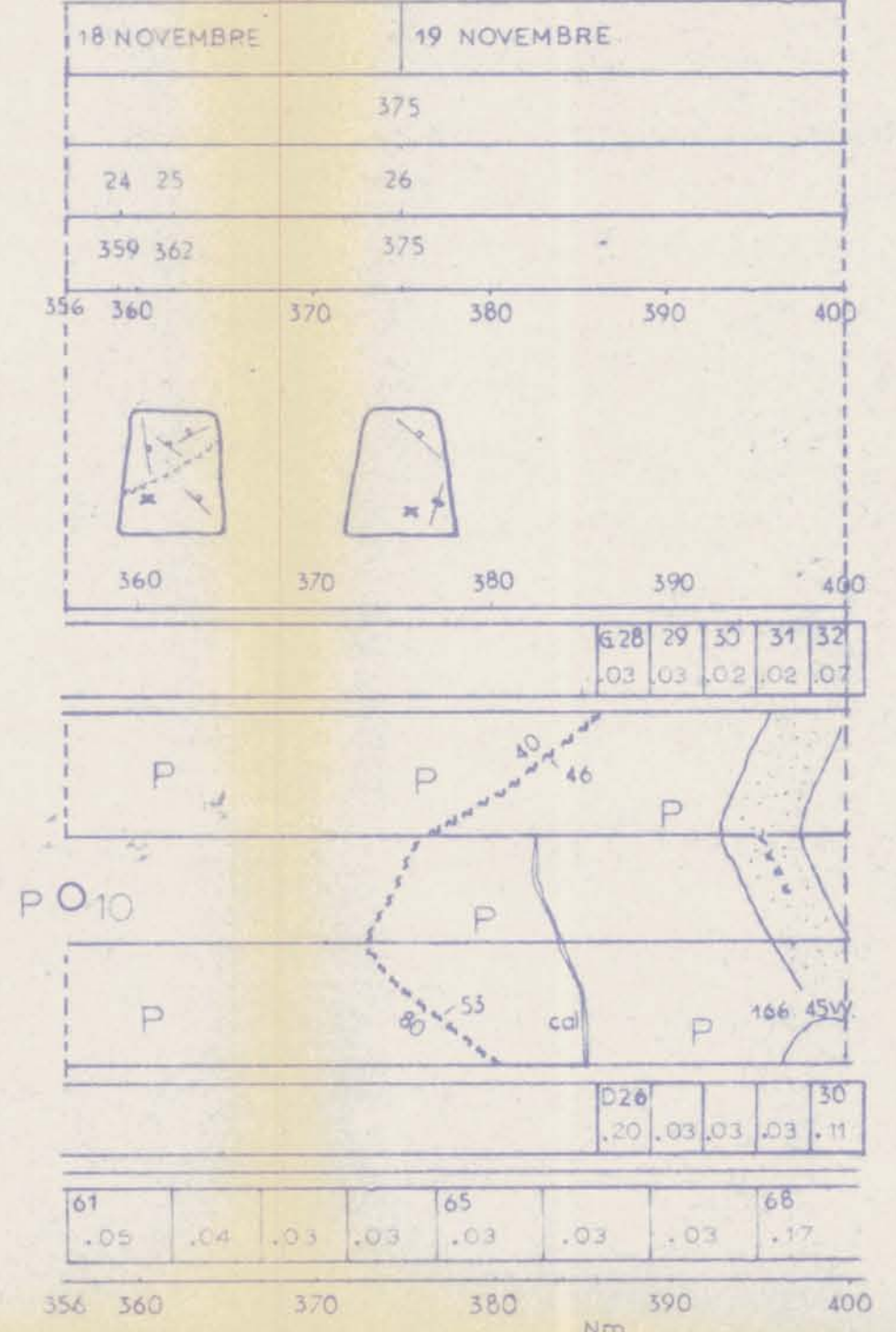
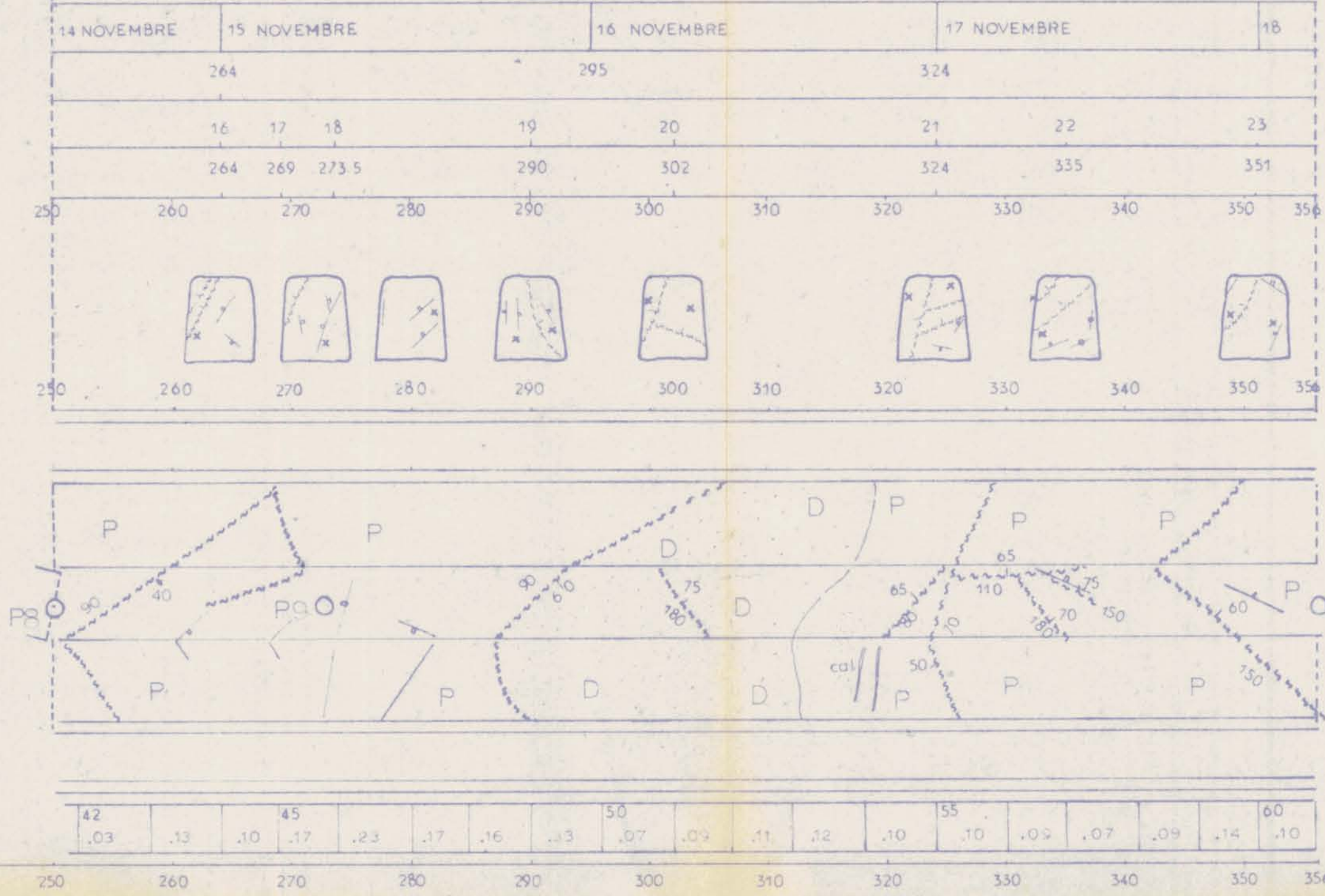
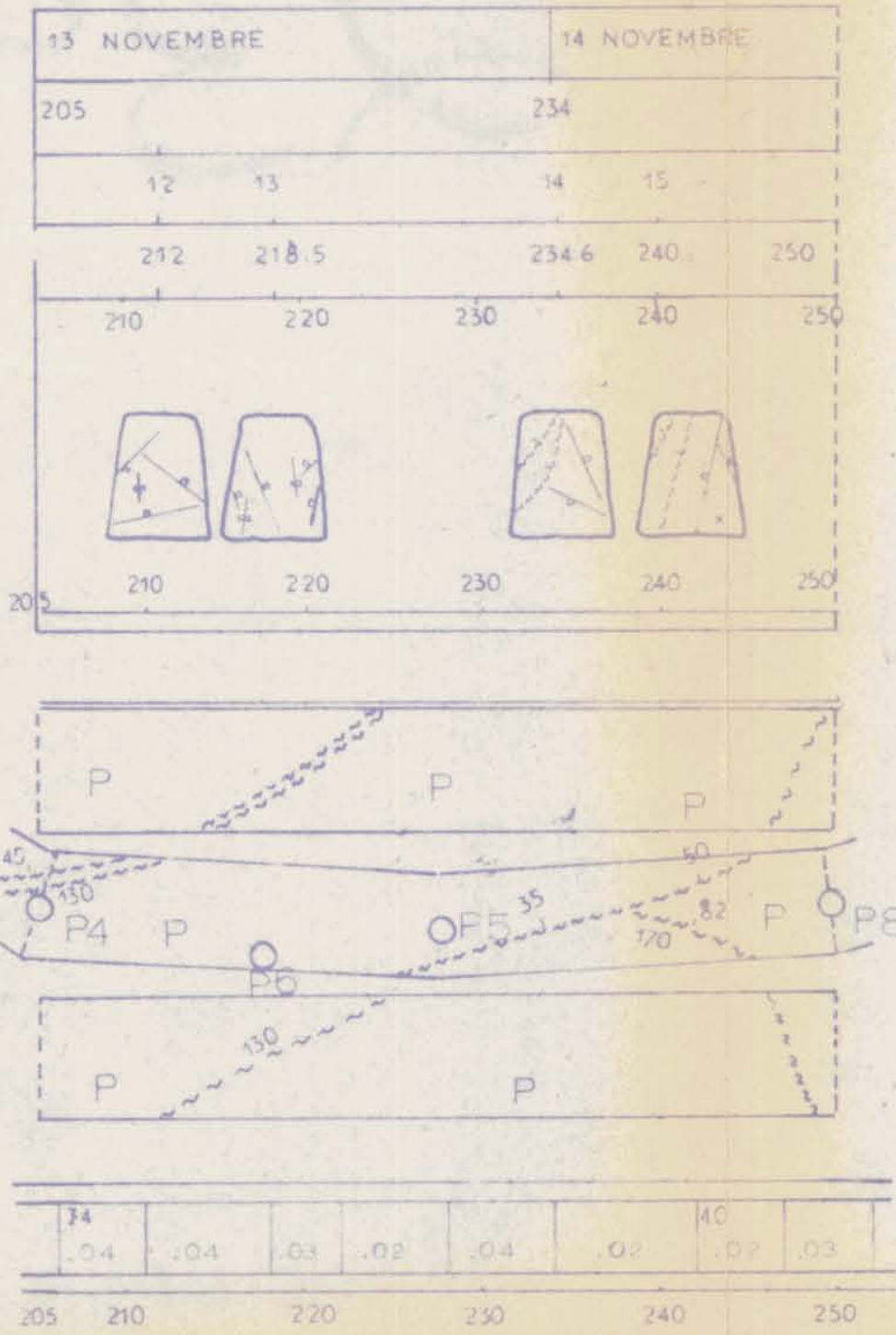

Department of
 Mines and Petroleum Resources
 ASSESSMENT REPORT
 NO. **2394** MAP. **#30**



Department of
Mines and Petroleum Resources
ASSESSMENT REPORT
NO. **2394** MAP **#32**

GALERIE G.1. 0-200'

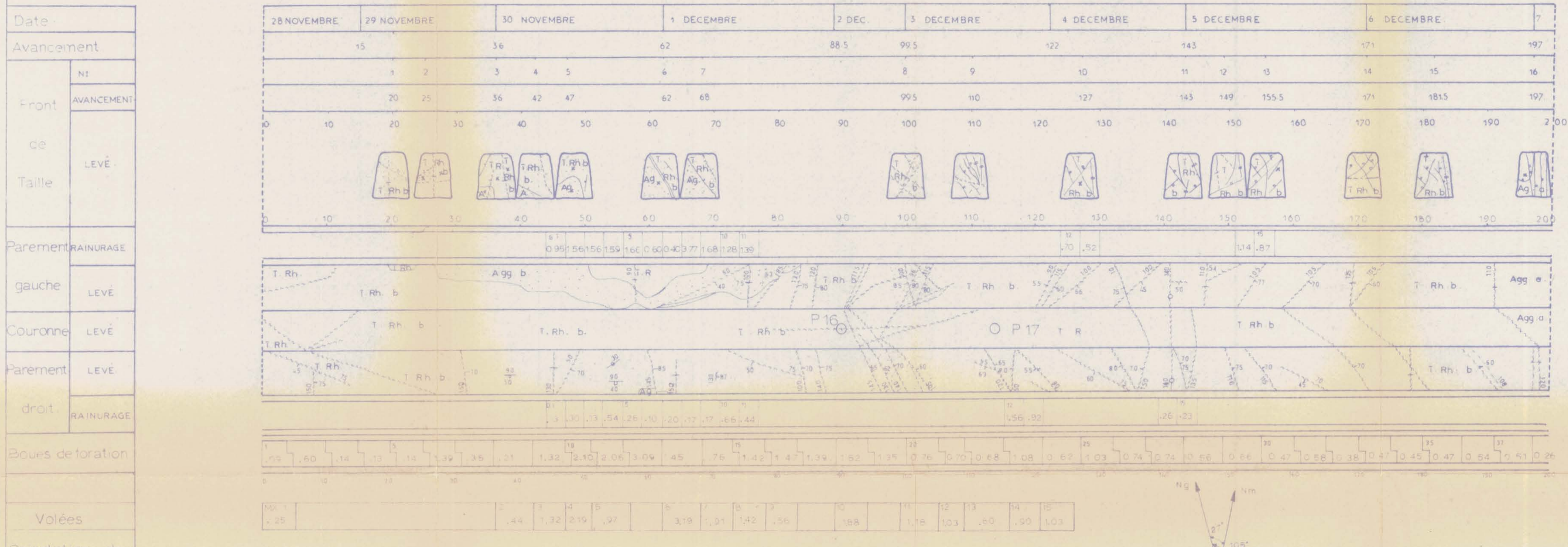

[Handwritten signature]

[Faint text in a box, possibly a legend or note]

Department of
Mines and Petroleum Resources

ASSESSMENT REPORT

NO. **2394** MAP **#33**

TRAVERS-BANCS T.B.1 400-569.5

Date
Avancement:
Front
de
Taille
Parement
gauche
Couronne
Parement
droit
Boues de foration
Volées
Orientation du Travers - Bancs

20 NOVEMBRE		
401		
27	28	
401	406	
400	410	420

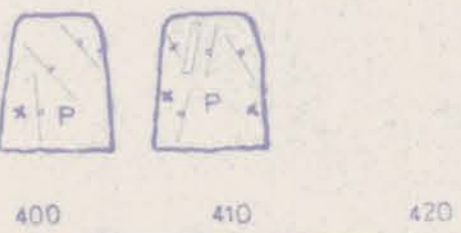

RAINURAGE				
633	35			
0.4	0.3	0.5	1.8	.31
LEVÉ				
P Rh P1				
P P P11				
P Rh P				
RAINURAGE				
1051				35
.13	.40	.21	.17	.20
LEVÉ				
P Rh P				
P P P11				
P Rh P				
RAINURAGE				
68	70			
.17	.09	.23	.16	
400	410	420		



T. Nicolet

20 NOVEMBRE												21 NOVEMBRE			22 NOVEMBRE			23 NOVEMBRE		24 NOV		25 NOV		26 NOV		27 NOVEMBRE		
												429	459	481	510	522	534	546			570							
												29	30	31	32	33	34	35	36	37	38	39	40	41	42	43	44	45
												429	436	442	459	463.5	469.5	487	492.5	510	515.5	524	528	540	546	552	558	569.5
												420	430	440	450	460	470	480	490	500	510	520	530	540	550	560	570	

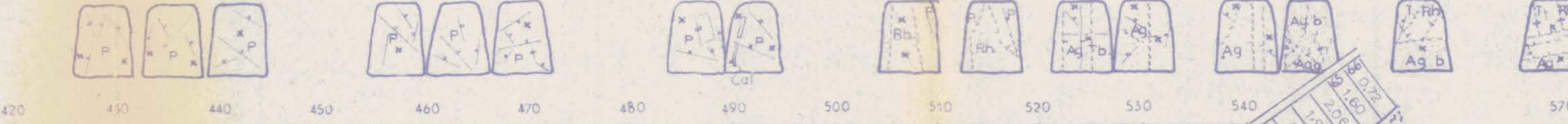

RAINURAGE												RAINURAGE			RAINURAGE		RAINURAGE		RAINURAGE		RAINURAGE		RAINURAGE					
58	59											40	45	50	55	60	65	70	75	80	85	90	95	100	105	110	115	120
0.7	0.7	0.6	0.3	.31	.05	.03	.49	.74	1.52	2.17	54	.28	.18	.26	.39	.42	.74	.95	.40	.56	.70							
LEVÉ												LEVÉ			LEVÉ		LEVÉ		LEVÉ		LEVÉ							
P1												P P P12			P P		P Rh		P Ag b		P Ag a		P P13 P14 P15					
P P P11												P P P12			P P		P Rh		P Ag b		P Ag a		P P13 P14 P15					
P P P11												P P P12			P P		P Rh		P Ag b		P Ag a		P P13 P14 P15					
RAINURAGE												RAINURAGE			RAINURAGE		RAINURAGE		RAINURAGE		RAINURAGE							
56	57	40	45	50	55	60	65	70	75	80	85	90	95	100	105	110	115	120	125	130	135	140	145	150	155	160	165	170
1.16	.05	.03	.02	tr	tr	tr	.08	.08	.02	.02	.05	.02	.54	.2	.60	.38	.68	.25	.55	.44	2.0	1.7	.74	.85	.0	.7	.12	.14
1.72	.04	.04	.75	.03	.03	.03	.02	.02	.80	.03	.06	.06	.04	.85	.03	.49	.49	1.32	1.52	.95	.85	.56	.60	.23	.95	.33		
420	430	440	450	460	470	480	490	500	510	520	530	540	550	560	570													

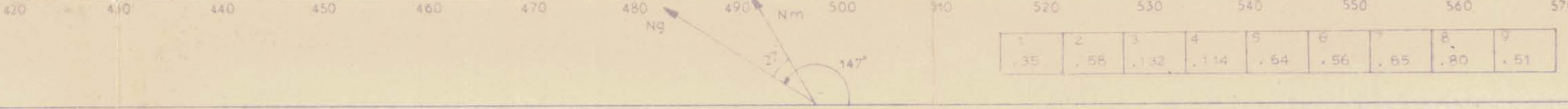

1	2	3	4	5	6	7	8	9
.35	.58	.132	.114	.64	.56	.65	.20	.51

... ..

Department of
Mines and Petroleum Resources
ASSESSMENT REPORT
NO. **2394** MAP # **34**

TRAVERS BANCS 1 0 205'

Date :	5 NOVEMBRE	6 NOVEMBRE	7 NOVEMBRE	8 NOVEMBRE	9	9 NOVEMBRE	10	10 NOVEMBRE	11 NOVEMBRE	12 NOVEMBRE	13	
Avancement	20					74		132		204		
Front de Taille	1 2 3 4 5 6					7 8		9 10 11				
	22.5 34 70.3 76 85					109 132		159 182 188				
LEVÉ												
Parement gauche												
Couronne												
Parement droit												
Boues de foration	.03 .02 .02 5 .02 .02 .00 .03 .04 10 .07 .07 .03 .05 .08 18 .09					17 .10 .08 .10 20 .12 21 .14		22 .21 .07 .08 25 .11 .09 .11 .82 .27 .45 .17 .25 33 .18				

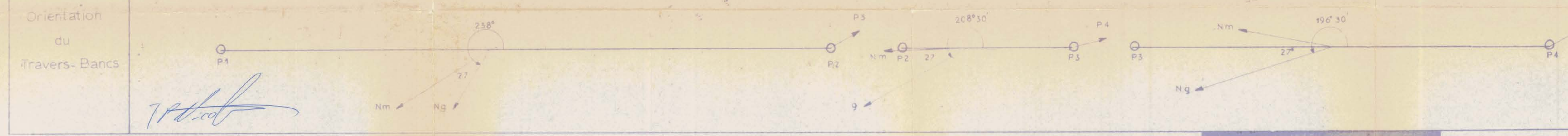

J.P. Nicolet

PROPRIETE
ZYMOETZ

Department of
Mines and Petroleum Resources
ASSESSMENT REPORT
NO. **2394** MAP # **28**

TRAVAUX MINIERS UPPER SHOWING

COUPE LONGITUDINALE B B'

Echelle 1:50



Date 12 3 1970

B HUSSON

Geological report by JP Nicolet on Panny, Kom and Natan groups
located on Zymetz river, Drenthe, M.D.

LEGENDE

- Granodiorite
- Porphyre andesitique
- Diarite
- Roches volcaniques
- Sondage 1970
Drill hole 1970
- Faille observee
observed fault
- Faille interpretee
Assumed fault
- Impact sondage with
intersection drill with
cross section
- Passes mineralises
Mineralized section
in drills
- Formations mineralises
Assumed mineralized formation
- Station sondage in
miniers
Drilling station in adits

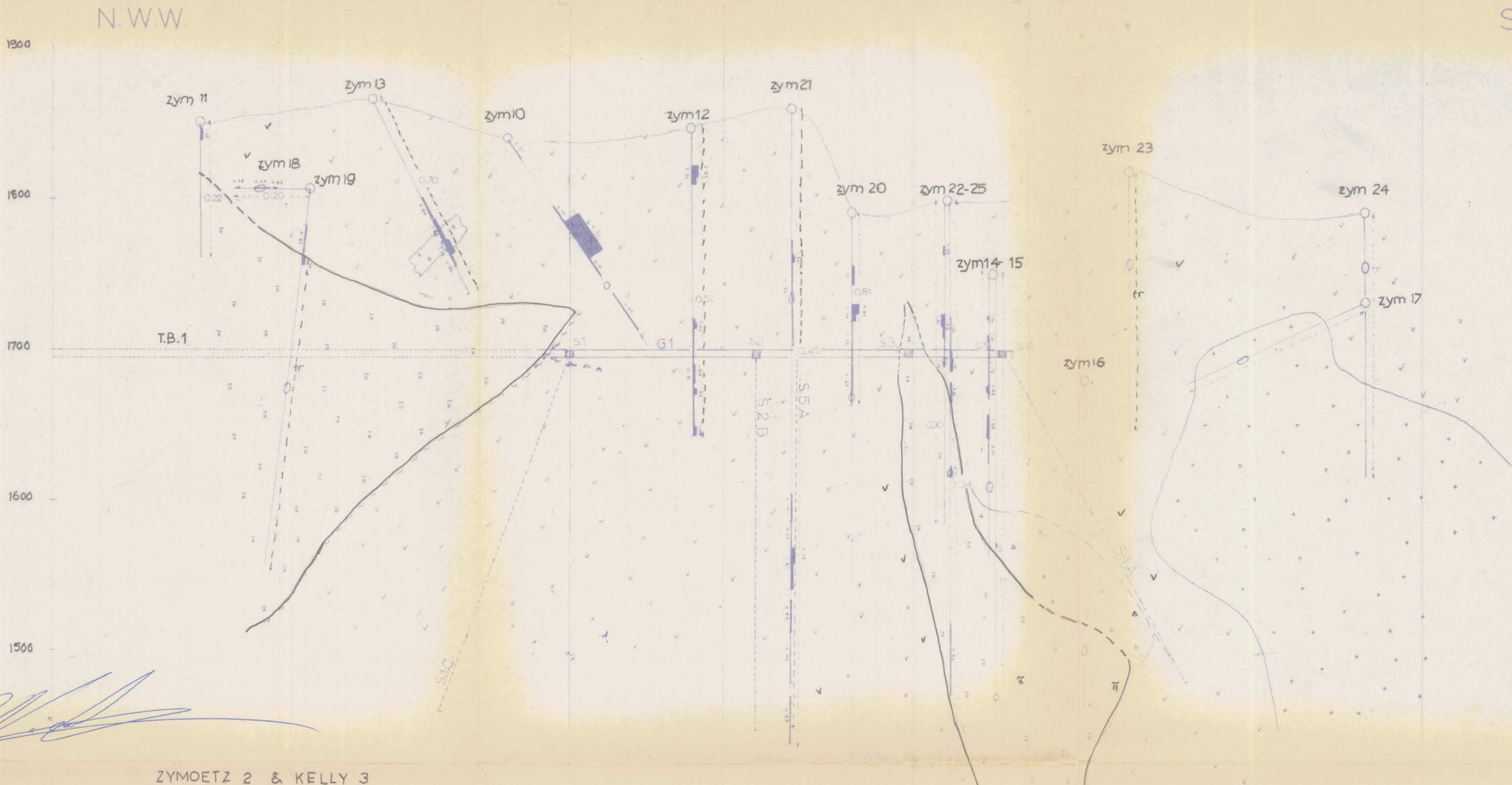

ZYMOETZ 2 & KELLY 3

2394

PROPRIETE
ZYMOETZ

Department of
Mines and Petroleum Resources
ASSESSMENT REPORT
NO. **2394** MAP **# 27**

TRAVAUX MINIERS UPPER SHOWING

COUPE LONGITUDINALE A A'

Echelle 1:50



Date 12 3 1970

B HUSSON

To accompany geological report by J.P. Nicolet on Panny, Kom and Naton groups of claims on Zymoetz river, District N.D.

LEGENDE

- | | | | |
|-------|----------------------|-------|------------------------------------|
| +++ | Granodiorite | --- | Observed fault |
| R | Porphyre andesitique | ~ ~ ~ | Assumed fault |
| • • • | Diorite | ○ | Investigation drill or core series |
| v v | Roches volcaniques | — | Minevalize section in drill |
| | | ■ s | Assumed mineralize formation |
| | | | Stations sondage tri-traités |
| | | | Drilling station in adits |
- Projections des sondages projection des profils

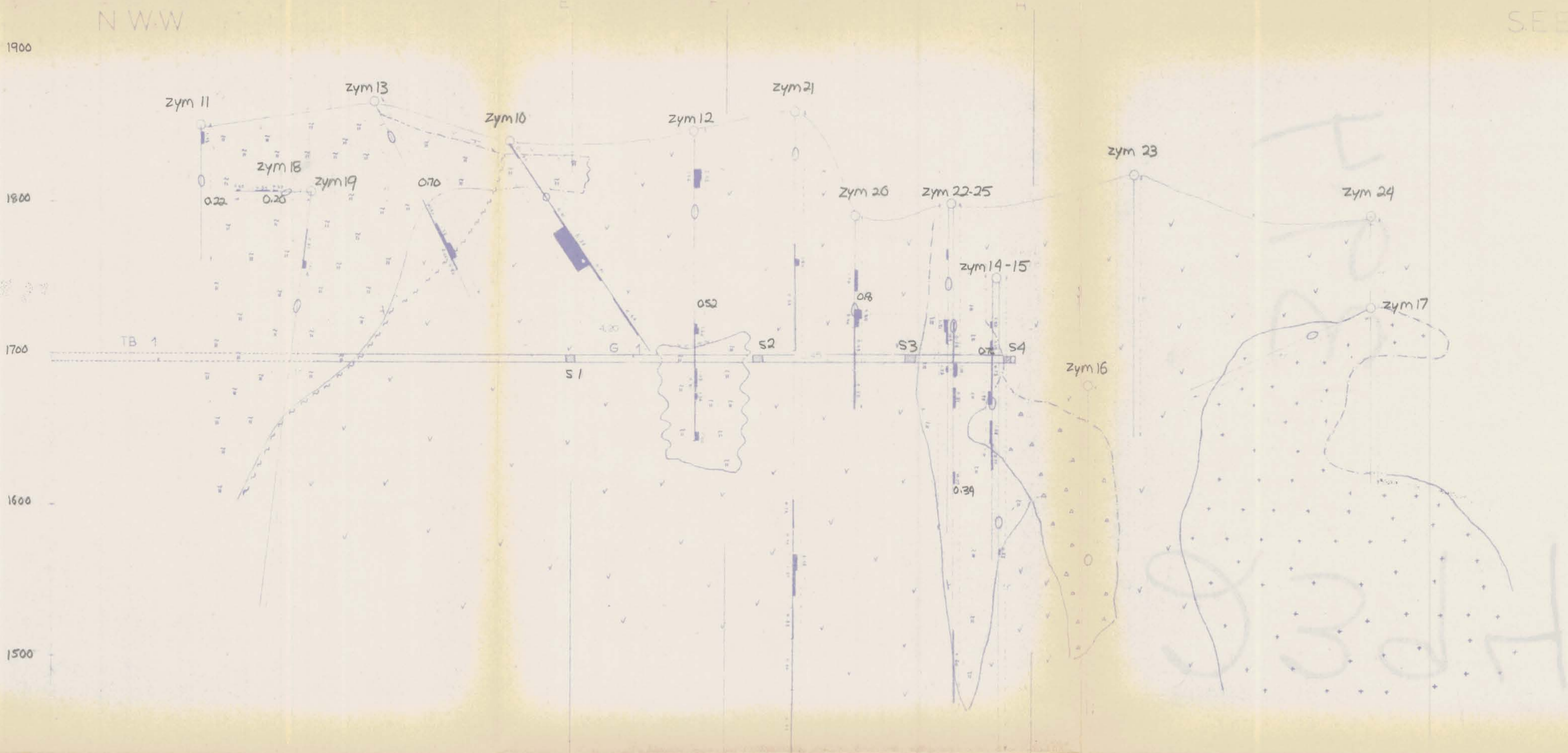

ZYMOETZ 2 & KELLY 3

[Handwritten signature]

2394

PROPRIETE

ZYMOETZ

TRAVAUX MINIERS : UPPER SHOWING

PLAN GEOLOGIQUE COTE 1725

Echelle 1:50

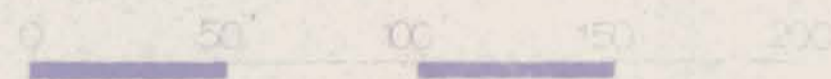

To accompany geological report by J.P. Nicolet on Panny, Ken and Nathan ... of claims on Zymoetz river District M.G.

B. HUSSON

LEGENDE

- Granodiorite
- Porphyre andes tique
- Diorite
- Roches volcaniques
Volcanics
- Faute observée
Observed fault
- Faute inferieure
Assumed fault
- Impact sondage dans coupe coupe
Intersection drill on cross section
- Partie mineralisee dans sondage
Mineralized section in drill
- Formations mineralisees
Assumed mineralized formation
- Stations de sondages dans travaux miniers
Drilling station in adits
- Projections des sondages = projection des profils
theoriques

Department of
Mines and Petroleum Resources
ASSESSMENT REPORT
NO. **2394** MAP #26

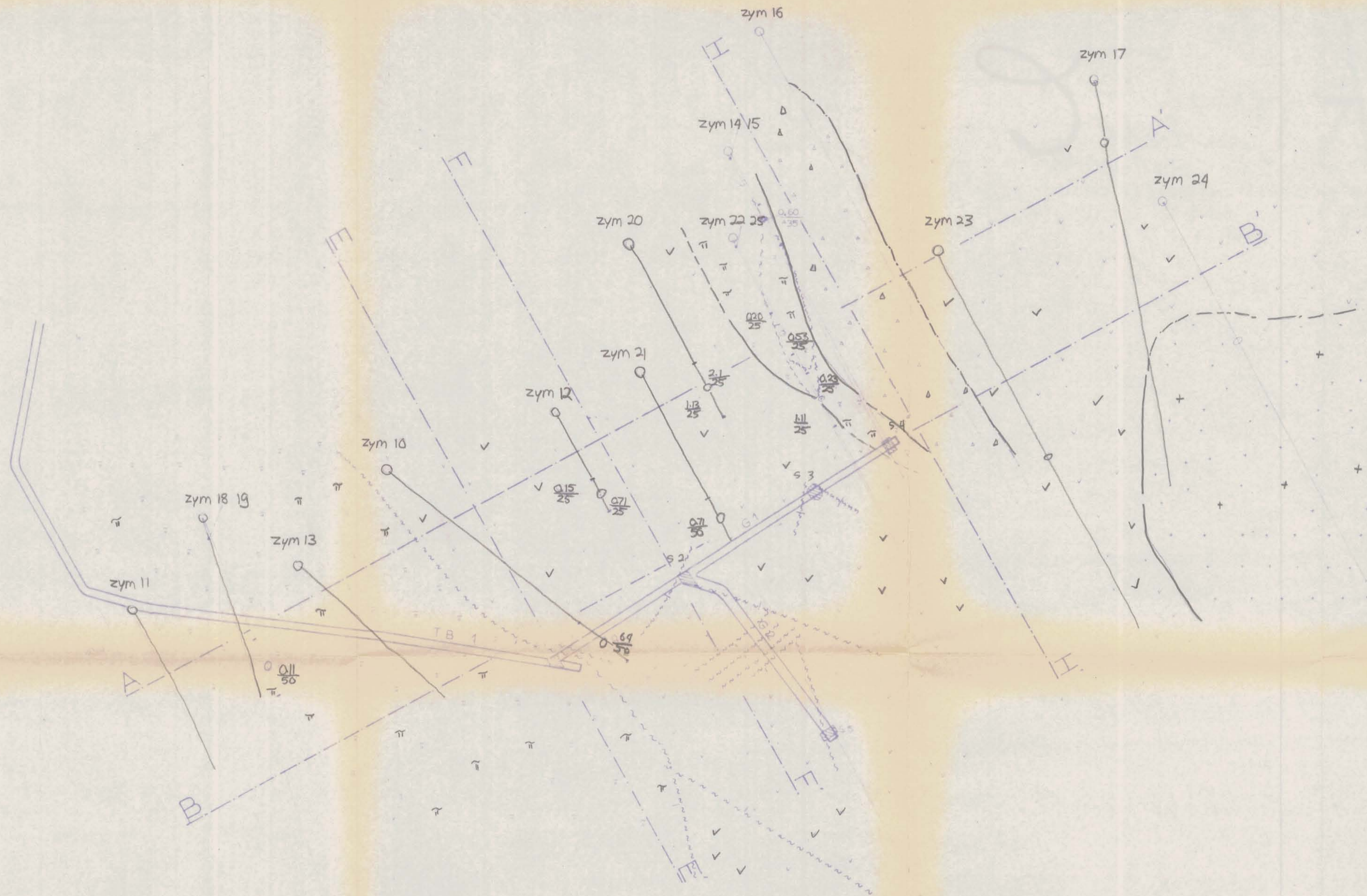
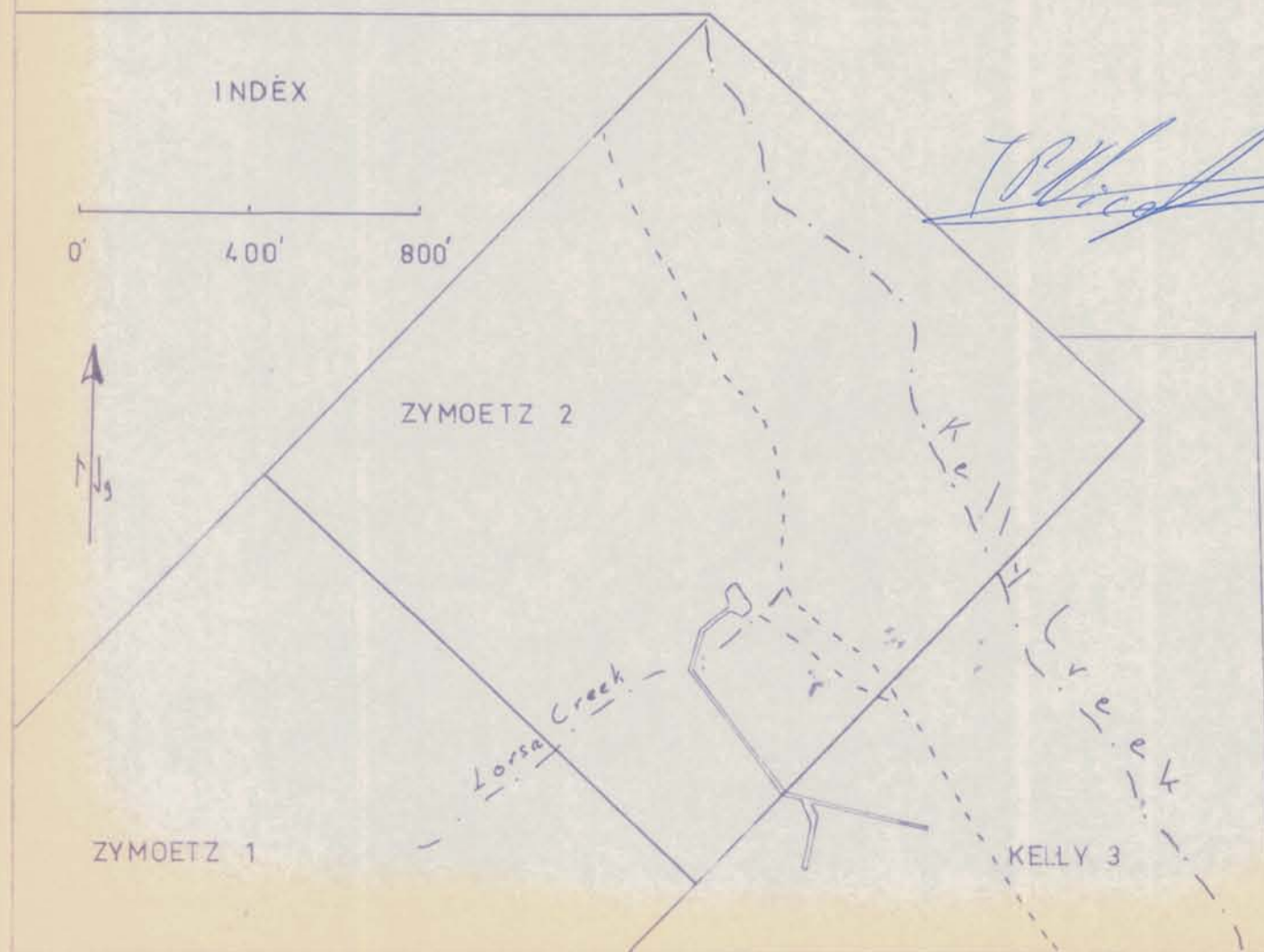

2394