

2490

92 I/11E
GEOCHEMICAL REPORT
M. B. CLAIMS, WOODS CREEK
14 MILES S.E. OF ASHCROFT, B.C.
50°121'
FOR
CROYDON MINES LTD. (N.P.L.)
APRIL 1-JULY 15, 1970

plotted
no deposit
50°34'
121°06 1/2'

J. W. Hogan, P.Eng.
L. J. Manning & Associates Ltd.
610 - 890 West Pender Street
Vancouver, B. C.

August 3, 1970

TABLE OF CONTENTS

Introduction	Page 1
General Geology and Topography	Page 1
Sampled Soil Horizon	Page 1
Sampling Procedure	Page 1
Sample Preparation and Laboratory Analysis	Page 2
Summary and Conclusions	Page 2

#1 Geochemical Plan - Scale 1" = 600'

In Pocket (See)

#2 Location of Lines with Respect to
Claim Boundaries - Scale 1" = 1,000'

In Pocket (See)

Department of
Mines and Petroleum Resources
ASSESSMENT REPORT
NO. 2490 MAP.....

L. J. MANNING & ASSOCIATES LTD.

CONSULTING MINING ENGINEERS

610-890 WEST PENDER STREET

VANCOUVER 1, B.C.

OFFICE PHONE:
683-5861

RESIDENTIAL PHONE:
L. J. MANNING - 985-5690

INTRODUCTION

The following report is on a geochemical soil survey over the M.B. Group of claims, Woods Creek area, Highland Valley, B. C.

GENERAL GEOLOGY AND TOPOGRAPHY

The north half of the property is underlain by granodiorite of the Highland Valley Phase of the Guichon Batholith. The south half of the property is underlain by post-intrusive volcanics of the Kamloops Group.

Topography consists of gentle to moderate slopes.

SAMPLED SOIL HORIZON

Soils were taken from the "B" Horizon at depths of from 6" to 10" below surface.

SAMPLING PROCEDURE

Samples were taken on a line grid basis. This grid was at 400' line interval on 200' stations. A shovel was used to reach the "B" Horizon where a 30-40 gram sample was placed in standard 4" x 9" soil sample envelopes. Drainage slope, swamp; etc. were noted. Samples were not taken where swampy ground was located arising in excessive depth of the "B" horizon.

Samples were partially air dried and then shipped to Bondar-Clegg, North Vancouver.

SAMPLE PREPARATION AND LABORATORY ANALYSIS

Bondar-Clegg treated the samples in the following manner:

- Drying
- Visual determination of soil horizon, colour, texture and organic content.
- Sieve to -80 mesh fraction
- Hot extraction by HNO_3 -HCl
- Atomic absorption analysis for copper parts per million.

SUMMARY AND CONCLUSIONS

The laboratory determination of organic content of samples eliminated the spurious anomalies resulting from incorrect sampling of "A" Horizon. The results of these organic samples are shown on the enclosed plan but the analysis were not used for determining threshold values. Threshold values were taken as double the median.

General outcrop locations and background soil values in copper indicate a granodiorite and volcanic terrain. Therefore, threshold values were calculated for each terrain.

Several zones anomalous in copper were determined on the property. A north-south zone centered at 4N-46W is a probable drainage anomaly as it is coincident along a stream direction. A south-west-north east zone centered at 52S-46W, although over a projected younger volcanic capping, may represent an eroded exposure of granodiorite.

Respectfully Submitted,

L. J. MANNING & ASSOCIATES LTD.

John W. Hogan, P.Eng.

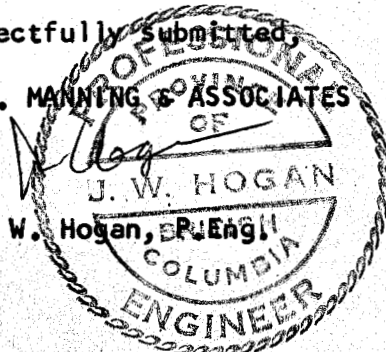

JWH:mjb

August 3, 1970

Department of
Mines and Petroleum Resources
ASSESSMENT REPORT

NO. 2490 MAP #2

2490

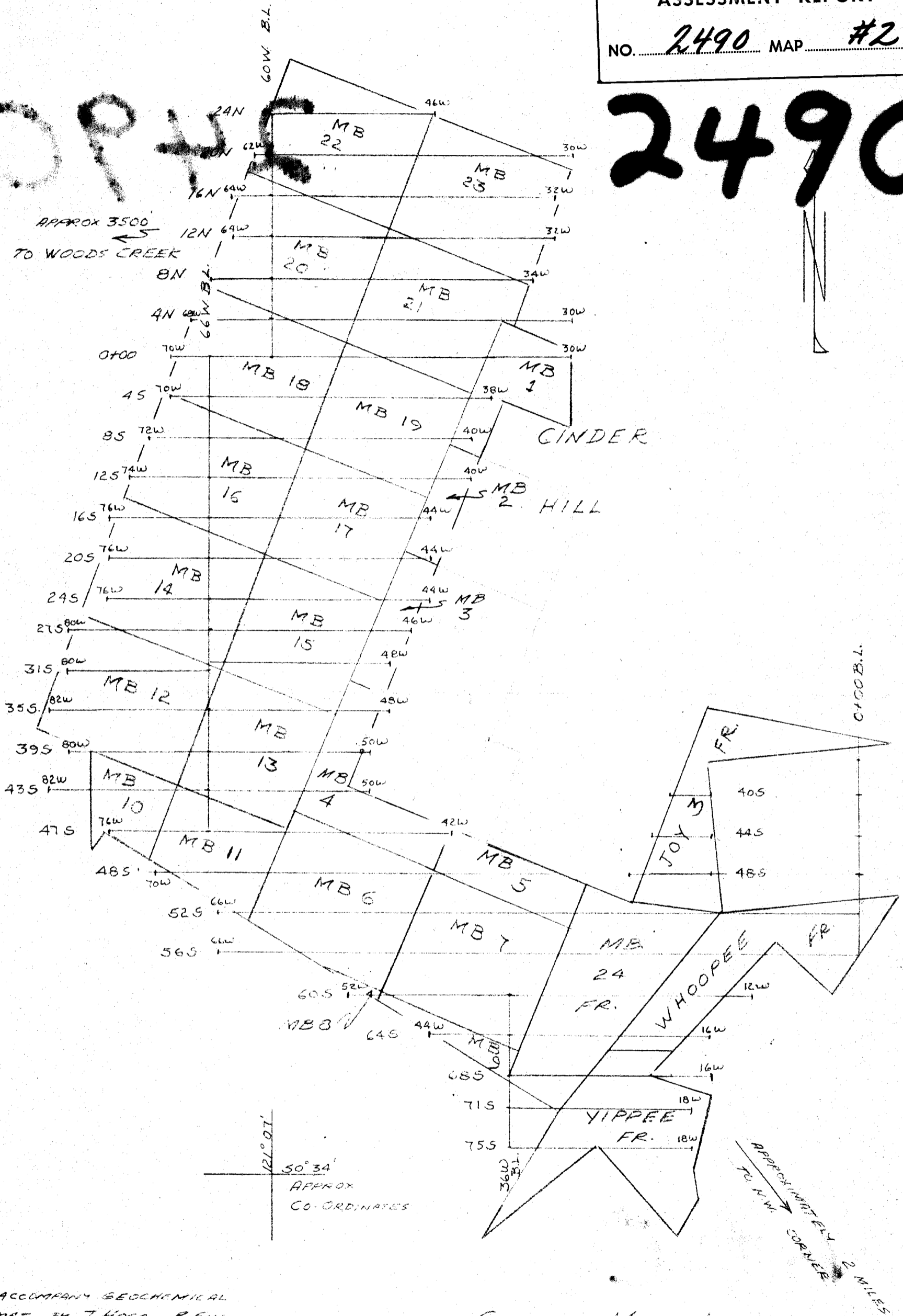

TO ACCOMPANY GEOCHEMICAL
REPORT BY J. HOGAN, P. ENG.
ON THE M.B. GROUP, WOODS
CREEK, KAMLOUSAN DIVISION

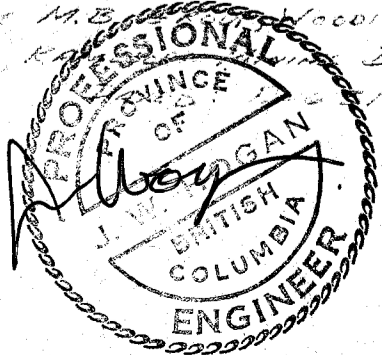

CROYDON MINES LTD.
M.B. GROUP GRID SYSTEM
WOODS CREEK, HIGHLAND VALLEY, B.C.
SCALE: 1" = 1000' JMB AVE/70

L.J. MANNING & ASSOC.

LEGEND
GR - GRANODIORITE
V - VOLCANICS
SYMBOLS
→ STREAM
≡ SWAMP
OTL - OUTCROP AREA

GEOCHEMICAL SYMBOLS
30 - GEOCHEMICAL SOIL SAMPLE
COPPER IN PARTS PER MILLION
(O) - HIGHER THAN NORMAL COPPER IN SOIL SAMPLE
GRANODIORITE TERRAIN
63-68 - THRESHOLD VALUE
68+ - ANOMALOUS
VOLCANIC TERRAIN
45-50 - THRESHOLD VALUE
50+ - ANOMALOUS

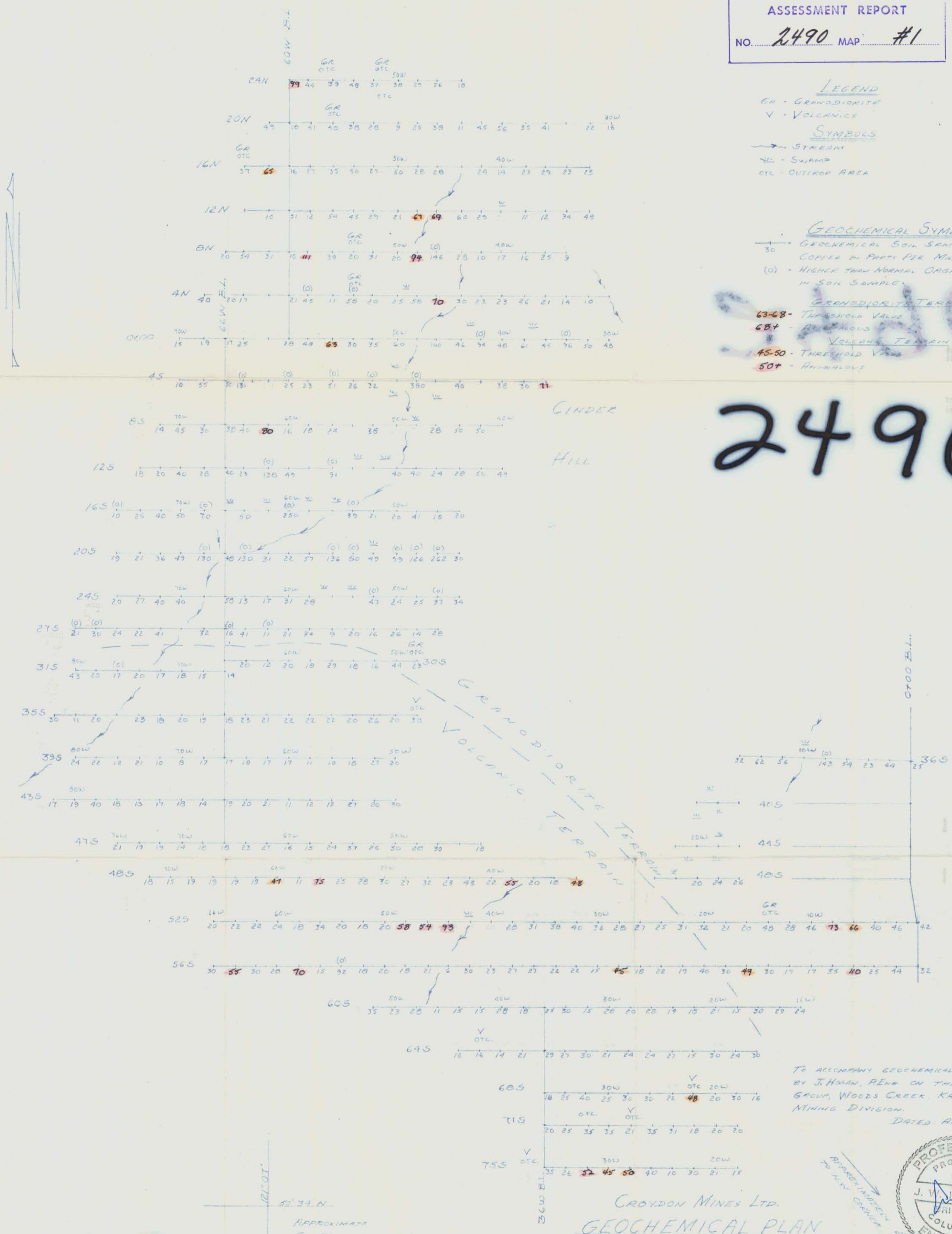

2490

TO ACCOMPANY GEOCHEMICAL REPORT
BY J. HOGAN, P.E. ON THE M.B.
GROUP, WOODS CREEK, KANLOOPS
MINING DIVISION.
DATED AUG 3/1970



CROYDON MINES LTD.
GEOCHEMICAL PLAN
M.B. CLAIM GROUP
WOODS CREEK, HIGHLAND VALLEY, B.C.
SCALE: 1" = 600' J.M. AUG 1970
L.J. MANNING & ASSOC.

N.T.S. - 92-T-11-E 2