

RUPERT INLET

SEC 16

SEC 15

UTAH CONSTRUCTION & MINING CO.

Mag. var. 25° E.

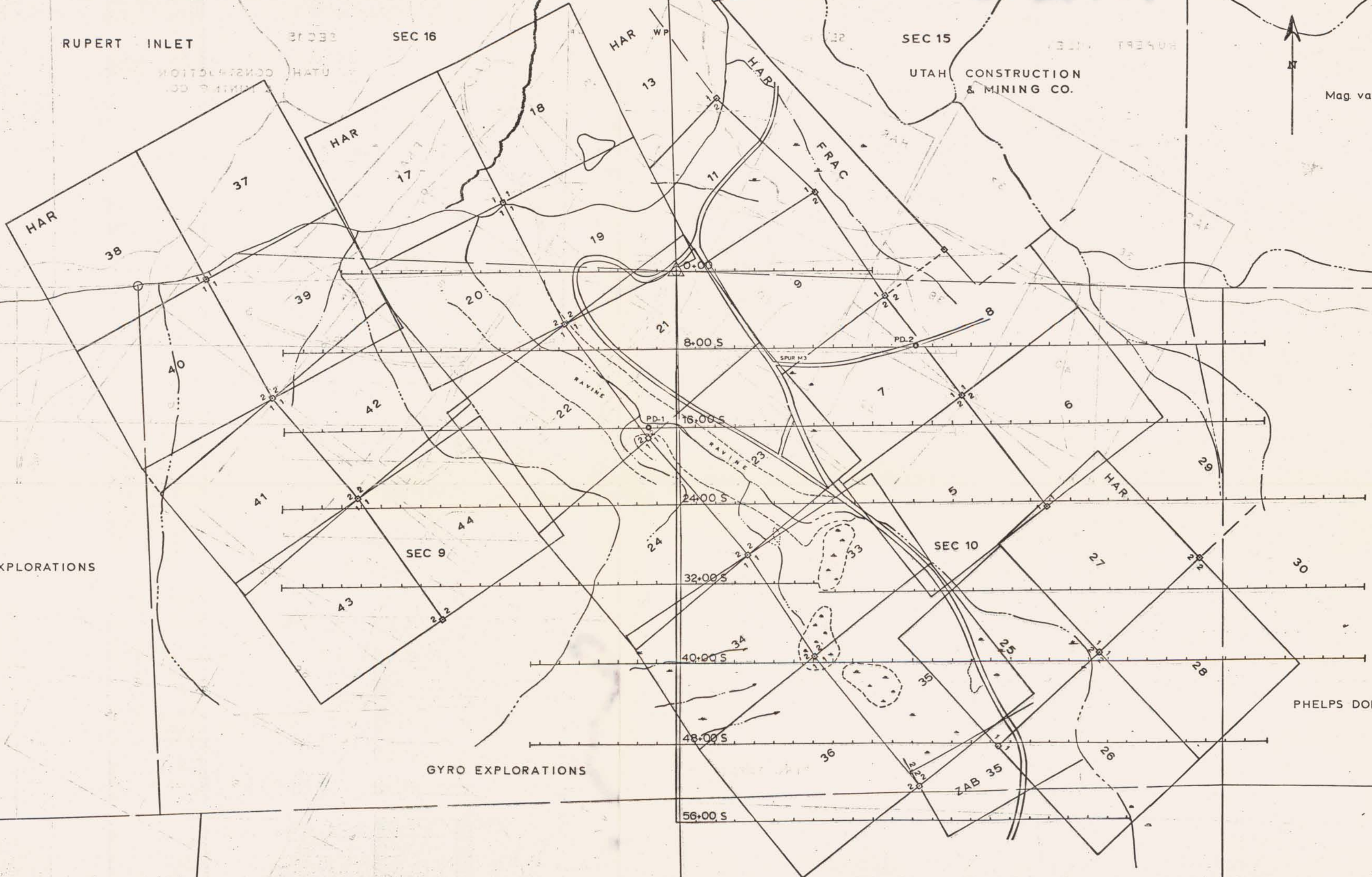

GYRO EXPLORATIONS

GYRO EXPLORATIONS

PHELPS DODGE

PINE LAKE MINING

Department of  
Mines and Petroleum Resources  
ASSESSMENT REPORT  
NO. 2514 MAP #1

2514

PHELPS DODGE CORPORATION OF CANADA, LIMITED  
VANCOUVER OFFICE  
PROJECT 83 RIVIERA OPTION  
PD GRID  
AND MINERAL CLAIMS  
SCALE: 1 INCH = 400 FT. DATE: FEBRUARY 1970 SURVEYED BY: J.S. DL. DRAWN BY: J.S. DL. MAY 1970