

2561

GEOLOGICAL & GEOCHEMICAL REPORT

H CLAIM GROUP

5 Miles southeast of Holberg, B. C.

51° 128° S. E.

NANAIMO MINING DIVISION

by

B. A. NEKRASOV, P. ENG.

Dated September 10,  
1970.

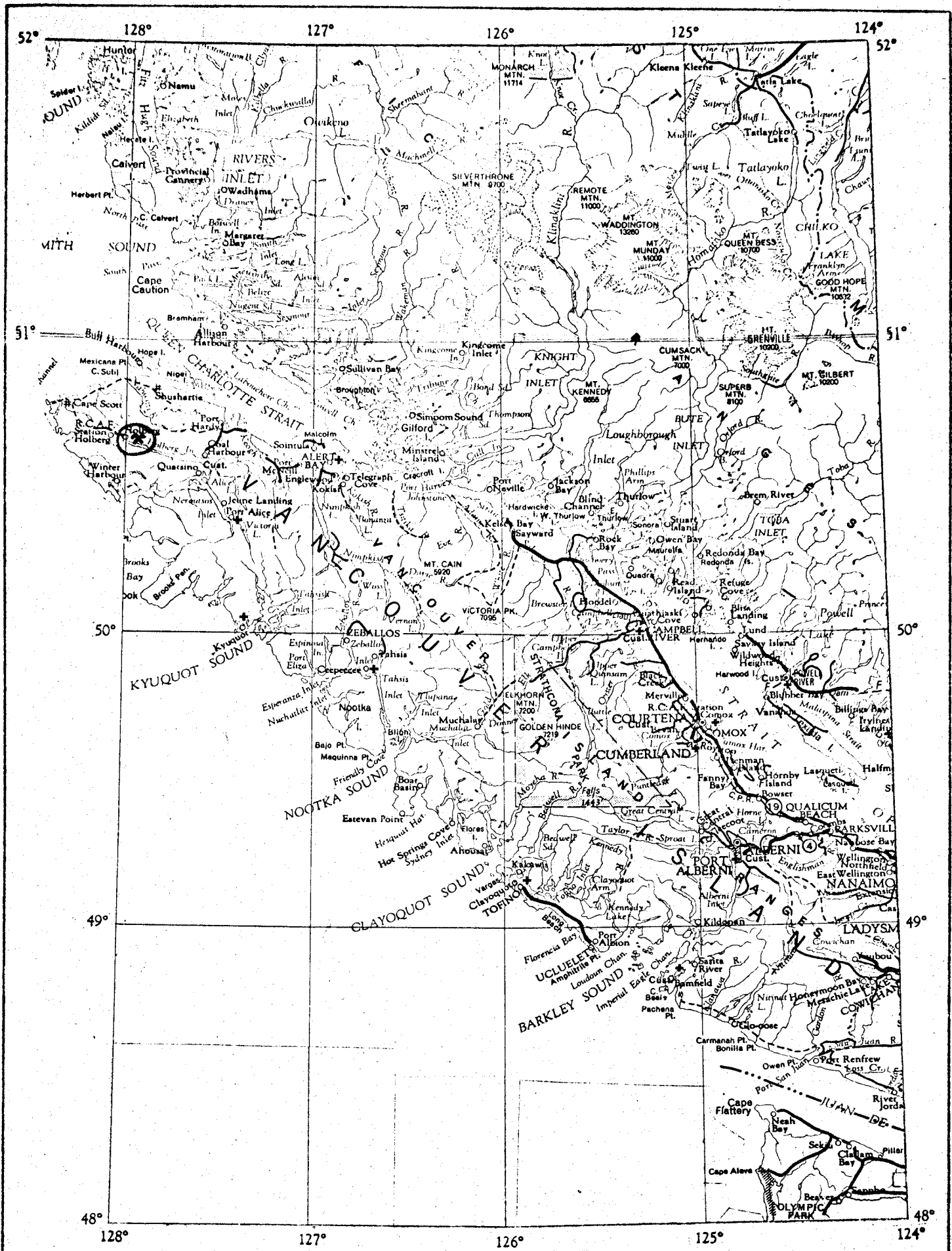

SCALE: 1 INCH = 30 MILES

INDEX MAP

**X** KW GROUPS  
 HOLBERG INLET  
 VANCOUVER ISLAND, B.C.

TABLE OF CONTENTS

	<u>Page</u>
#1 Index Map	1
Introduction	2
Field Work	3
General Geology	4
Local Geology	4 - 5
Geochemical Results	5
Conclusions	6
Appendix	7
Statement of Qualifications	8
Statement of Costs	9
Certificate of Qualification	10
Certificates of Analysis	13

ILLUSTRATIONS

Histograms, Zn., Cu., Mo.	11
Example of Soil Sample Data Sheet	12
#2 Claim Map	<del>In pocket</del> Real
#3 Geological Map	" Pocket
#4 Geochemistry Soil Survey (Cu., ppm)	"
#5 Geochemistry Soil Survey (Mo., ppm)	"
#6 Geochemistry Soil Survey (Zn., ppm)	"

Department of  
Mines and Petroleum Resources  
ASSESSMENT REPORT  
NO. 2561 MAP

## INTRODUCTION

The H #1 to #32 claims were staked between the 11th and 24th of July, 1969 by D. K. Bragg as agent for Victoria Bragg. They were recorded in Vancouver on August 11, 1969. Notice to group H #1 to #32 was filed in Vancouver on August 10, 1970.

Victoria Bragg of 3567, West 27th Avenue, Vancouver 8, B. C. is the recorded owner of the H claims.

The claim group is located on the north shore of Holberg Inlet. The centre of the group is about five miles east-south of Holberg, B.C. Access is by boat from Coal Harbour, B. C. and Holberg, B. C. or by helicopter or float plane from Port Hardy, B.C. airport.

Elevations on the group range from sea level to 1900 feet above sea level near the centre of the group. Streams occupy sharp topographic depressions and canyons make crossing them difficult. The claim group lies within the Rayonier Forest Management Area. About half the area is covered by mature hemlock, balsam, cedar and spruce trees. The other half of the area covered by the H claims has been logged during at least two periods. Along the north shore of Holberg Inlet, for approximately 2000 ft. inland, the forest was logged between 50 and 60 years ago. Travel through the new growth is relatively easy except for dense patches of salal bush immediately along the shore of the inlet. The rest of the logged area was harvested between 10 and 20 years ago. Travel in this area of young forest regeneration is most difficult through the thick hemlock growth and dense briar thickets.

From July 8 to August 8, 1970, geological mapping and geochemical soil survey was carried out on a portion of the block. During this period work was done on H 1 to 9, H 12, 14, 17, 19, 21, 23 and 25 claims.

## FIELD WORK

Field work on the H claim group was done by the following personnel during July and August, 1970.

D. K. Bragg	Field Geologist	July 8 to August 8
V. Bragg	Cook & Field Assistant	July 8 to August 8
D. Kupferschmid	Field Assistant	July 8 to July 16
J. Schmiesing	Field Assistant	July 8 to July 16
E. Warner	Field Assistant	July 20 to August 7
W. Boyd	Field Assistant	July 20 to July 23

D. K. Bragg, field geologist, supervised the field assistants and participated in the surveying and soil sampling. He also mapped the physical features and geology of the area covered.

Traverse lines were surveyed with Ranger compass and nylon chain. The lines were run north-south at about 400 ft. intervals with stations every 200 ft. along the lines. Control of the lines were put in at 66S, 100S and 132S. The north-south geochem lines are numbered from west to east and the stations from north to south in a continuation of the south-east quadrant grid system started on the adjoining KW claims. The lines are marked with orange and the stations with red plastic flagging.

Soil samples were taken using a 3 foot auger. Wherever possible the reddish brown B horizon underlying the organic layer and leached zone was sampled. Soil sample data sheets were utilized and data on vegetation, soil type, texture, colour, sample depth, topography, and depth of overburden were recorded in the field. The soils were collected and placed in 'high wet strength Kraft  $3\frac{1}{2}$  x 6  $\frac{1}{8}$  O.E. waterproof bags' in the field. The samples were then partially dried in the sun and air in preparation for shipment to a custom laboratory.

A total of 11.11 miles of traverse line was surveyed on the H claims and 355 samples were collected. The samples were analysed for copper, molybdenum and zinc by Chemex Labs Ltd., 212 Brooksbank Avenue, North Vancouver, B. C.

## GENERAL GEOLOGY

The Port Hardy area is underlain by Upper Triassic sediments and volcanic rocks intruded by several small stocks of assumed Jurassic age. The Upper Triassic rocks include, from youngest to oldest, Bonanza group, Quatsino formation and Karmutsen group. The Bonanza group consists of sediments and volcanic rocks. The Quatsino is largely represented by limestones, the Karmutsen is dominantly of volcanic origin.

Along the north shore of Holberg Inlet, sedimentary rocks are probably Cretaceous in age, locally overlie the Upper Triassic rocks.

## LOCAL GEOLOGY

The Bonanza volcanic rocks are predominant on the area of the H claims that has been mapped to date. These include interbedded andesitic flows, tuffs, agglomerates, lapilli tuffs, ~~and other volcanics~~ *BH*

Bonanza sediments: black fossiliferous shales and some limestone interbedded with tuffs and andesite sills occur on most of H9 and 10. These sediments lie south of a subsidiary fault striking N 80° W across the northern portion of H9 and 10 and the south of H8. South of this fault some of the volcanic assemblage that may in effect be part of the lower Bonanza sediments interbedded with volcanic sequence, was typed as upper Bonanza volcanics. Due to the lack of continuous outcrop, it was difficult to determine the continuity of the sequences and the actual fault zone itself.

Another fault striking N 40° W cuts across the N.E. corner of H2 and 3, and the south west half of H 1. Associated with this fault is parallel shearing. Considerable pyrite was observed in the area.

Just east of line 192E between 116S and 120 are an assemblage of rocks that may be Cretaceous siltstone and sandstones. However, at times these are hard to distinguish from some of the Bonanza tuffs. The only other occurrence of Cretaceous rocks found is just off the map sheet along the north shore of the inlet south of 216E, 154 S.

### LOCAL GEOLOGY - continued

Pyrite and minor chalcopyrite occur randomly throughout the map area. Two zones of strong pyritization were observed. Along the N 40 W fault across H 1, 2 and 3, pyritization seems to be associated with the shearing. Pyrite is also disseminated in the volcanics. As much as 5% sulphides by volume was noted in the gouge zones. Between lines 212E and 216E and stations 126S and 130S, considerable pyrite occurs, disseminated in Bonanza andesites (flow) and in a thin bed of agglomerate volcanics. The observed thickness of these beds was about 50 ft. striking N 70°W dipping S.W., dipping with the slope of the hill. This zone appeared to extend over about 400 ft. by 600 ft. As much as 20% pyrite by volume was observed. Lower down the creek and below these beds, a silicified tuff was found, containing considerable pyrite and minor chalcopyrite.

### GEOCHEMICAL RESULTS

The samples collected were further dried in a thermostatically controlled oven at a temperature not greater than 130° F, at Chemex Labs Ltd. The samples were then screened to -80 mesh under exhausted hoods.

The samples were analysed for total copper, total molybdenum and total zinc, using a perchloric acid digestion. The atomic absorption method was employed for analysis. The results are given in parts per million (ppm) and plotted on separate maps included in this report.

Histograms are made for copper, zinc and molybdenum suggesting a background of 30 to 40 ppm for copper; 50 to 60 ppm for zinc, and 0 ppm for molybdenum.

★

CONCLUSIONS

The results of the geochemical sampling and analysis are presented in the accompanying maps. A coincident anomalous area for Cu., Mo. and Zn occurs along the 132S base line between 184E and 206E within the lower Bonanza sediments interbedded with volcanic sequences. Other small coincidences above background do occur along the afore described faults. No significance is given to this anomalies, which probably refer only to changes in rock types under the soil.

There is no evidence of sulphide mineralization of economic value on the claims surveyed and no favourable geological structure was observed.



*B. A. Nekrasov*  
.....

B. A. NEKRASOV, P. Eng. (V.T.)  
B. C. Consultant Geologist



A P P E N D I X

## STATEMENT OF QUALIFICATIONS

D. K. Bragg supervised and participated in the soil sampling and survey control. He mapped the physical features and the geology of the area surveyed.

His qualifications are as follows:

Graduated Armstrong High School, B. C. in 1951.

Attended U.B.C. from 1958 to 1962 in the faculty of Arts and Science, in honors geology.

Worked for Kennco Explorations during the summers of 1956, 1957 and 1959 in the Yukon and northern British Columbia as an assistant prospector and geochem sampler under the direction of Dr. R. Campbell and R. Woodcock.

Worked as chief prospector for the Nahanni 60 Syndicate in the Northwest Territories in 1960 under the direction of Doug Wilmont.

Worked as chief prospector in the Yukon for Dualco in 1961 under supervision of E. Wozniak.

Worked as chief prospector for Mining Corp. of Canada in southeast B. C. in 1962 under J.S. Scott and Dr. K. Northcote.

Worked as chief prospector during the summer of 1963, for the Francis River Syndicate, in the Central Yukon, under the direction of Dr. A. Aho.

Worked as a field geologist in the Greenwood area of B.C. for Scurry Rainbow Oil in 1965 under the direction of Bill Quinn.

Worked as a field project supervisor for Alrae Explorations Ltd., from September 1965 to April 1, 1967 under the direction of Rae Jury.

Has received B. C. Provincial Grubstakes for the years 1964, 1968, 1969 and 1970.

Has worked in the Port Hardy-Holberg Inlet for three years.

STATEMENT OF COSTS

(Salaries plus field expenses at \$6.00/day)

D. Kupferschmid	8 days	@ \$26.00	\$ 208.00
J. Schmiesing	8 days	@ \$24.00	192.00
W. Boyd	3 days	@ \$24.00	72.00
E. Warner	14 days	@ \$28.00	392.00
V. Bragg	28 days	@ \$26.00	728.00
D.K. Bragg	28 days	@ \$41.00	1,148.00
Employee Benefits (UIC, CPP, WCB)			<u>83.25</u>
			\$2,823.25
Cost of Analysis, 350 samples, Cu., Mo., Zn., @ \$2.00/sample			700.00
Vehicle Rental 28 days @ \$11.00/day			308.00
Boat & Motor rental, 28 days @ \$5.00/day			140.00
Report & map preparation			<u>400.00</u>
T O T A L			<u><u>\$4,371.25</u></u>

Declared before me at the City

*Vancouver*

in the

Province of British Columbia, this 14

day of September 1970, A.D.

*Juli Turner*

Commissioner for taking Affidavits within British Columbia or  
Notary Public in and for the Province of British Columbia.

SUBSTITUTION RECORDER

C E R T I F I C A T E

---

I, Boris A. Nekrasov, of the City of Vancouver, in the Province of British Columbia, hereby certify:

1. THAT I am a consulting Geological Engineer and my present address is P.O. Box 491, Stn. A., Vancouver 1, B.C.
2. THAT I am a registered Professional Engineer in Mining and Geological Section in Yukon Territory and also a corporate member of the Engineering Institute of Canada, a member of B.C. & Yukon Chamber of Mines, the Canadian Institute of Mining and Metallurgy as well as other Learned Societies.
3. THAT I have practiced my profession as an exploration geologist in B.C. and Yukon Territory for 15 years.
4. THAT I examined the property concerned in this report.
5. THAT I have no direct or indirect interest whatsoever in the mining claims referred to in the accompanying report, nor do I expect to receive any such interest.
6. THAT I have no direct or indirect interest in any Company acquiring control or intending to acquire control of H and/or KW Group mineral claims.

DATED this September 10, 1970



*Boris A. Nekrasov*  
.....

B. A. NEKRASOV, P. Eng. (Y.T.)  
Consulting Geological Engineer





# CHEMEX LABS LTD.

212 BROOKSBANK AVE.  
NORTH VANCOUVER, B.C.  
CANADA  
TELEPHONE: 985-0648

• CHEMISTS • GEOCHEMISTS • ANALYSTS • ASSAYERS

## CERTIFICATE OF ANALYSIS

CERTIFICATE NO. 11041 B

TO: Mr. D.K. Bragg  
3567 W. 27th Ave.  
Vancouver, B.C.

K.W. CLAIMS

INVOICE NO. 3700  
DATE RECEIVED Aug. 15, 1970  
DATE ANALYSED Aug. 21, 1970

ATTN:

SAMPLE NO.:	ppm Copper	ppm Molybdenum	ppm Zinc
184E 86S	48	0	67
88	26	0	66
90	42	0	43
92	30	0	55
94	26	0	48
96	33	0	57
98	34	0	57
100	40	0	68
102	31	0	45
104	31	0	40
106	38	0	62
108	38	0	54
110	56	1	68
112	30	0	47
114	51	0	57
116	36	0	43
118	48	0	68
120	65	1	80
122	76	1	157
124	36	0	57
126	40	0	50
128	41	0	90
130	51	1	85
184E 132S	50	4	62
188S 66+00E	33	0	120
188E 68S	33	1	43
70S	34	1	57
72S	33	0	60
74S	36	1	45
76S	33	0	47
78S	42	0	72
80S	41	1	72
82S	50	0	74
84S	10	0	27
86S	41	0	57
88S	31	0	45
90S	41	0	54
92S	41	2	55
94S	21	1	52
188E 96S	33	1	64
Std #22	52	17	72

Certified by

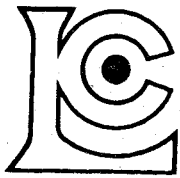

# CHEMEX LABS LTD.

212 BROOKSBANK AVE.  
NORTH VANCOUVER, B.C.  
CANADA  
TELEPHONE: 985-0648

\* CHEMISTS \* GEOCHEMISTS \* ANALYSTS \* ASSAYERS

## CERTIFICATE OF ANALYSIS

TO: Mr. D.K. Bragg  
3567 W. 27th Ave.,  
Vancouver, B.C.

K.W. CLAIMS

CERTIFICATE NO. 11041 A  
INVOICE NO. 3700  
DATE RECEIVED Aug. 15, 1970  
DATE ANALYSED Aug. 21, 1970

ATTN:

SAMPLE NO.:	ppm Copper	ppm Molybdenum	ppm Zinc
66S 182E	42	0	60
184	40	0	55
186	48	0	74
190	44	0	59
194	48	0	70
196	40	1	85
198	42	0	82
202	44	0	85
206	40	0	55
208	34	2	48
210	24	0	54
212	36	0	70
66S 214E	28	1	60
100S 202E	36	0	45
204E	46	2	94
206	52	0	54
208	30	0	33
210	30	0	50
212	24	0	48
214	24	0	49
100S 216	33	0	57
132S 186E	96	4	200
190E	56	3	74
192	60	4	90
194	48	18	220
198	48	13	200
202	80	7	220
206	41	1	49
210	56	2	52
212	63	0	68
132S 214E	46	0	47
184E 68S	34	0	66
70S	22	0	40
72S	50	1	55
74S	44	0	40
76S	21	0	70
78S	38	1	68
80S	54	0	45
82S	42	0	80
184E 84S	41	0	50
Std #22	52	18	74

Certified by

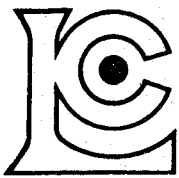

# CHEMEX LABS LTD.

212 BROOKSBANK AVE.  
NORTH VANCOUVER, B.C.  
CANADA  
TELEPHONE: 985-0648

\* CHEMISTS \* GEOCHEMISTS \* ANALYSTS \* ASSAYERS

## CERTIFICATE OF ANALYSIS

TO: Mr. D. K. Bragg  
3567 W. 27th Ave.,  
Vancouver, B. C.

CERTIFICATE NO. 11043  
INVOICE NO. 3706  
DATE RECEIVED August 15/70  
DATE ANALYSED August 21/70

ATTN: K. W. Claims

SAMPLE NO.:	PPM Copper	PPM Molybdenum	PPM Zinc	
216E 124S	74	0	48	
126	44	0	48	
128	31	1	66	
130	24	2	52	
132	33	0	80	
134	40	2	94	
136	70	0	80	
138	36	0	38	
140	36	0	43	
142	33	10	57	
144	40	0	66	
146	28	13	52	
148	31	7	55	
150	41	1	54	
152	31	0	64	
216E 154S	24	4	50	
192E 72-1-50S	51	1	74	Rock
216E 126+50S	26	0	42	Rock
Std. #22	52	16	72	

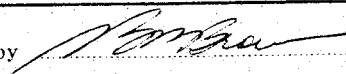
Certified by 



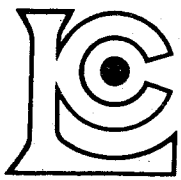

# CHEMEX LABS LTD.

212 BROOKSBANK AVE.  
NORTH VANCOUVER, B.C.  
CANADA  
TELEPHONE: 985-0648

• CHEMISTS • GEOCHEMISTS • ANALYSTS • ASSAYERS

## CERTIFICATE OF ANALYSIS

CERTIFICATE NO. 11042  
INVOICE NO. 3706  
DATE RECEIVED August 15/70  
DATE ANALYSED August 21/70

TO: Mr. D. K. Bragg,  
3567 W 27th Ave.,  
Vancouver, B. C.

ATTN:

K. W. Claims

SAMPLE NO.:	PPM Copper	PPM Molybdenum	PPM Zinc
212E 118S	22	0	36
120	30	0	50
122	21	0	37
124	24	0	42
126	34	0	36
128	46	1	64
130	34	1	130
132	14	0	17
134	30	0	43
136	46	0	50
138	31	1	45
212E 140S	36	0	34
216E 66S	24	0	50
68	26	0	66
70	21	0	52
72	34	0	55
74	34	0	55
76	34	0	42
78	28	2	49
80	28	2	60
82	42	0	85
84	41	0	74
86	42	0	42
88	38	0	74
90	26	0	50
92	26	0	57
94	22	0	45
96	21	2	87
98	16	0	43
102	24	0	48
104	16	0	40
106	18	0	48
108	26	2	43
110	21	1	60
112	12	0	66
114	22	0	47
116	20	0	39
118	22	0	45
120	21	0	42
216E 122S	24	0	33
Std. #22	54	17	74

Certified by

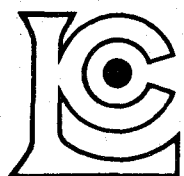

# CHEMEX LABS LTD.

212 BROOKSBANK AVE.  
NORTH VANCOUVER, B.C.  
CANADA  
TELEPHONE: 985-0648

• CHEMISTS • GEOCHEMISTS • ANALYSTS • ASSAYERS

## CERTIFICATE OF ANALYSIS

TO: Mr. D. K. Bragg,  
3567 W. 27th. Ave.,  
Vancouver, B. C.

CERTIFICATE NO. 11041  
INVOICE NO. 3706  
DATE RECEIVED August 15/70  
DATE ANALYSED August 21/70

ATTN:

K. W. Claims

SAMPLE NO.:	PPM Copper	PPM Molybdenum	PPM Zinc
208E 110S	22	0	43
112	24	0	55
114	22	1	50
116	18	3	31
118	21	1	45
120	22	0	59
122	18	0	54
124	30	1	57
126	54	0	67
128	42	3	142
130	42	2	107
132	44	1	110
134	33	0	52
136	44	0	70
138	44	0	90
208E 140S	42	0	68
212E 68S	41	0	70
70	36	0	62
72	18	0	57
74	31	0	59
76	33	0	62
78	20	1	49
80	51	0	57
82	44	0	64
84	38	0	70
86	56	0	110
88	38	0	68
90	34	0	66
92	28	0	67
94	34	0	66
96	46	0	60
98	21	0	37
102	18	0	42
104	8	0	45
106	18	0	49
108	24	2	45
110	13	0	50
112	18	0	36
114	20	0	64
212E 116S	16	0	57
Std. #22	52	16	74

Certified by

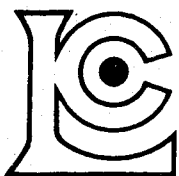

# CHEMEX LABS LTD.

212 BROOKSBANK AVE.  
NORTH VANCOUVER, B.C.  
CANADA  
TELEPHONE: 985-0648

• CHEMISTS • GEOCHEMISTS • ANALYSTS • ASSAYERS

## CERTIFICATE OF ANALYSIS

TO: Mr. D. K. Bragg  
3567 W. 27th Ave.,  
Vancouver, B. C.

CERTIFICATE NO. 11040  
INVOICE NO. 3706  
DATE RECEIVED August 15/70  
DATE ANALYSED August 21/70

ATTN: K. W. Claims

SAMPLE NO.:	PPM C opper	PPM Molybdenum	PPM Zinc
204E 98S	50	1	50
104	18	0	50
106	30	0	49
108	21	0	40
110	38	0	54
112	24	0	43
114	16	0	59
116	20	0	43
118	20	0	55
120	21	0	52
122	20	0	33
124	46	0	72
126	21	0	87
128	18	1	74
130	21	0	47
132	36	3	76
134	100	16	525
204E 136S	42	7	200
208E 66S	21	2	54
68	22	0	55
70	30	0	66
72	30	0	74
74	42	2	62
76	40	0	50
78	30	0	78
80	30	0	59
82	31	0	60
84	33	0	74
86	40	0	66
88	26	0	64
90	34	0	57
92	18	0	55
94	30	0	87
96	31	0	55
98	24	0	62
104	24	0	40
106	13	0	42
208E 108S	16	0	47
Std. #22	52	16	72

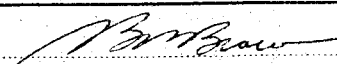
Certified by 



# CHEMEX LABS LTD.

212 BROOKSBANK AVE.  
NORTH VANCOUVER, B.C.  
CANADA  
TELEPHONE: 985-0648

• CHEMISTS    • GEOCHEMISTS    • ANALYSTS    • ASSAYERS

## CERTIFICATE OF ANALYSIS

TO: **D. K. Bragg**  
**3567 W. 27th Ave.,**  
**Vancouver, B. C.**

CERTIFICATE NO. **11039**  
INVOICE NO. **3706**  
DATE RECEIVED **August 15/70**  
DATE ANALYSED **August 21/70**

ATTN: **K. W. Claims**

SAMPLE NO.:	PPM Copper	PPM Molybdenum	PPM Zinc
200E 88S	33	0	40
90	30	0	39
92	24	0	52
94	30	0	64
96	36	0	82
98	13	0	42
100	26	0	45
102	16	0	42
104	12	0	64
106	13	0	48
108	22	1	54
110	20	0	39
112	14	0	66
114	22	0	52
116	34	0	60
118	60	0	74
120	31	0	68
122	34	0	90
124	33	0	60
126	34	1	66
128	28	2	68
130	42	8	340
132	78	20	200
200E 134S	52	15	320
204E 66S	33	0	62
68	22	0	57
70	41	0	68
204E 72S	74	0	48
74	44	0	54
76	58	1	67
78	58	0	68
80	18	0	59
82	36	1	87
84	41	2	55
86	42	0	50
88	51	1	55
90	20	0	124
92	30	1	60
94	18	0	66
204E 96S	16	0	55
Std. #22	52	16	72

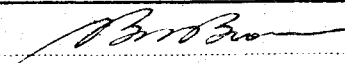
Certified by 

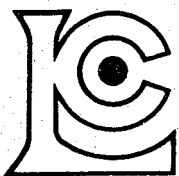

# CHEMEX LABS LTD.

212 BROOKSBANK AVE.  
NORTH VANCOUVER, B.C.  
CANADA  
TELEPHONE: 985-0648

• CHEMISTS • GEOCHEMISTS • ANALYSTS • ASSAYERS

## CERTIFICATE OF ANALYSIS

TO: Mr. D. K. Bragg  
3567 W. 27th Ave.,  
Vancouver, B. C.

CERTIFICATE NO. 11038  
INVOICE NO. 3706  
DATE RECEIVED August 15/70  
DATE ANALYSED August 21/70

ATTN: K. W. Claims

SAMPLE NO.:	PPM Copper	PPM Molybdenum	PPM Zinc
196E 76S	40	0	48
78	31	0	48
80	28	0	90
82	22	0	52
84	66	0	68
86	33	0	38
88	48	0	57
90	33	0	76
92	24	0	48
94	26	1	67
96	20	0	42
98	41	0	43
100	24	1	45
102	21	1	66
104	28	0	68
106	22	0	70
108	26	1	59
110	31	0	52
112	31	0	55
114	28	0	50
116	36	0	76
118	44	0	70
120	42	0	90
122	38	0	82
124	31	0	52
126	20	0	52
128	41	0	68
130	56	12	170
196E 132S	51	10	200
200E 66S	36	0	62
68	41	0	78
70	40	1	76
72	46	0	66
74	52	0	68
76	42	0	70
78	54	1	60
80	34	0	39
82	44	0	67
84	41	0	43
200E 86S	36	0	67
Std. #22	54	17	72

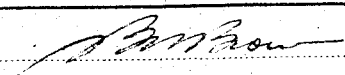
Certified by 



# CHEMEX LABS LTD.

212 BROOKSBANK AVE.  
NORTH VANCOUVER, B.C.  
CANADA  
TELEPHONE: 985-0648

• CHEMISTS • GEOCHEMISTS • ANALYSTS • ASSAYERS

## CERTIFICATE OF ANALYSIS

CERTIFICATE NO. 11037  
INVOICE NO. 3706  
DATE RECEIVED August 15/70  
DATE ANALYSED August 21/70

TO: Mr. D. K. Bragg  
3567 W. 27th Ave.,  
Vancouver, B. C.

ATTN:

K. W. Claims

SAMPLE NO.:	PPM Copper	PPM Molybdenum	PPM Zinc
192E 66S	44	1	72
68	40	1	82
69	34	1	66
70	30	0	60
72	40	1	78
74	40	1	52
76	34	0	128
78	40	1	87
80	38	2	80
82	40	0	68
84	41	1	49
86	48	1	48
88	38	0	68
90	20	0	45
92	20	0	66
94	46	0	74
96	51	0	74
98	6	0	19
100	46	2	64
102	34	0	36
104	28	1	35
106	21	2	45
108	52	0	49
110	52	0	67
112	48	0	66
114	26	1	55
116	34	0	52
118	30	0	70
120	13	0	27
122	42	2	124
124	33	0	68
126	38	0	47
128	38	0	57
130	41	5	124
192E 132S	41	4	200
196E 66S	44	0	76
68	48	0	90
70	51	0	76
72	51	0	66
196E 74S	48	0	68
Std. #22	54	17	72

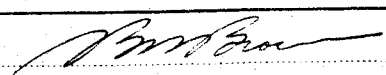
Certified by 

# HISTOGRAMS Zn, Cu, Mo, Geochemical Data 355 samples

To accompany 'Geological & Geochemical Report' by B.A. Nekrasov, P. Eng.  
H Claims, Holberg Inlet Vancouver Island B.C. Nanaimo Mining Division  
dated. Sept. 1970

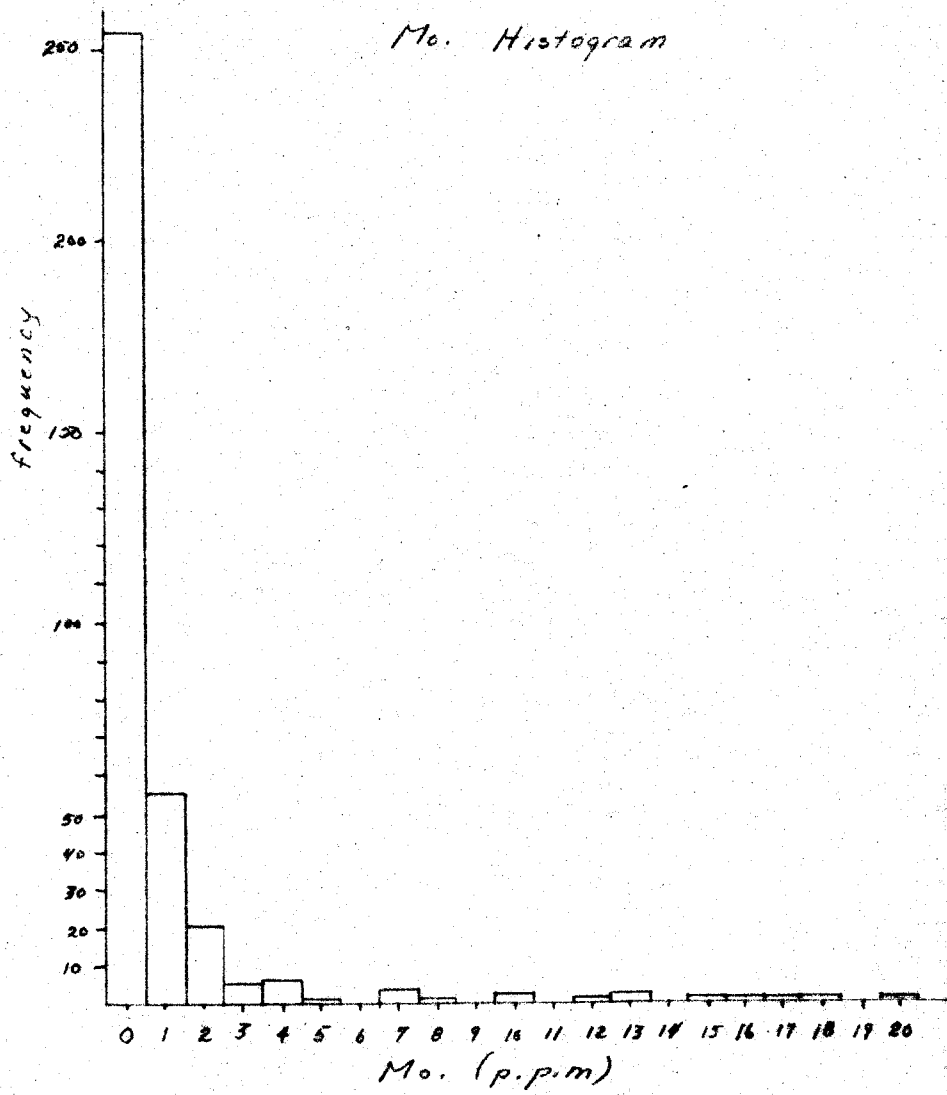
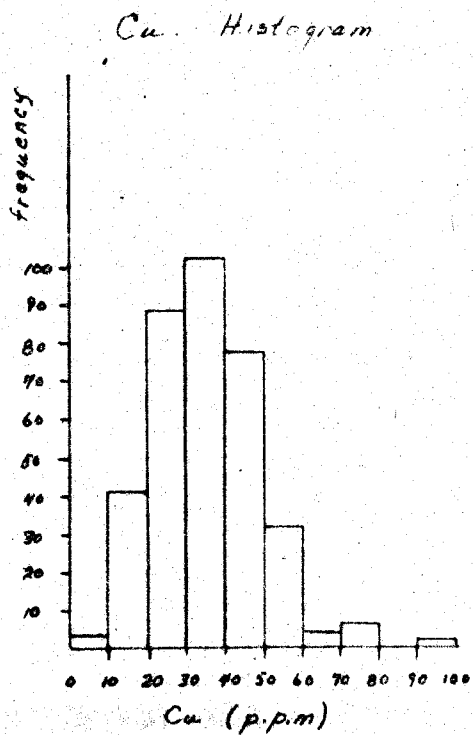
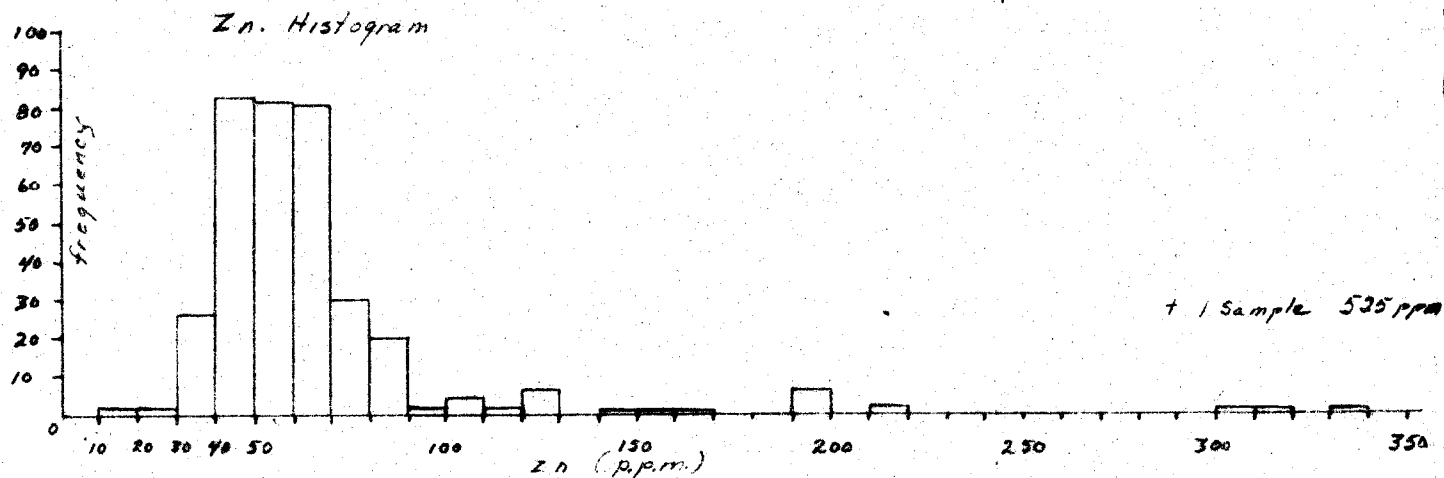

Drawn by DK Bragg

Sept 1970

D. BRAGG  
SOIL SAMPLING DATA SHEET

C-Cedar  
B Balsam GCL

PROJECT

"H" CLAIMS

SAMPLERS:

DK BRAGG

DATE:

AUGUST 3 1970

SAMPLE NO.	STATION	COMMENTS	FOREST COVER VEGETATION, ETC.	DESCRIPTION OF SOIL - TYPE, TEXTURE, COLOR ETC.	SAMPLE DEPTH	ESTIMATED OVERBURDEN DEPTH	TOPOGRAPHY
196E	86S	TOP of HILL. EDGE of LOSS.	IMMAT. B. HEM	LIGHT BROWN GCL Moist	2'	2' ±	5° N
	88S	TBR	IMAT. HEM	" GCL "	2½'	4' ±	25° S
	90S		" " C	" GCL ORG "	3'	5' ±	35° S
	92S		" " C	RED " GCL " "	3'	5' ±	25° S
	94S		" " C	" " GCL " "	2½'	3' ±	40° SW
	96S	Hossback No Soil	" " C	GRAY " " " "	1½'	1½'	40° SW
	98S		" " C	RED " " "	3'	4' ±	30° W
	100S		" " CB	" " " "	2½'	5' ±	30° SW
	102S		" " C	" " " "	3'	5' ±	30° SW
	104S		" C HEM	LIGHT " " "	3'	5' ±	35° SW
	106S		" C " B	RED " GCL "	3'	5' ±	30° SW
	108S		" " "	DARK " GCL ORG "	2½'	3' ±	25° SW
	110S		" HEM B	RED " GCL "	2½'	4' ±	15° SW
	112S		" " "	" " " "	2'	2' ±	30° W
	114S	Logg	YNG	" " " "	2½'	5' ±	20° S
	116S	"	" " "	" " " "	3'	10' ±	20° SW
	118S	"	" " "	" " " "	2'	5' ±	20° SW
	120S	"	" " "	RED " SCL "	2½'	10' ±	20° SW
	122S	"	" " "	BUFF SCL "	3'	10' ±	10° SW
	124S	"	" " ALDER	RED BROWN GCL "	2½'	10' ±	20° SW
	126S	"	" " "	" " GCL "	3'	10' ±	2° W
	128S	"	" " "	DARK " SCL "	3'	15' ±	5° S
	130S	"	" " "	DARK RED GCL "	2½'	5' ±	25° S
	132S	"	" " C ALDER	DARK BROWN GCL	2½'	5' ±	15° SW
		C-Cedar B-Balsam GCL	Gravel clay, loam				



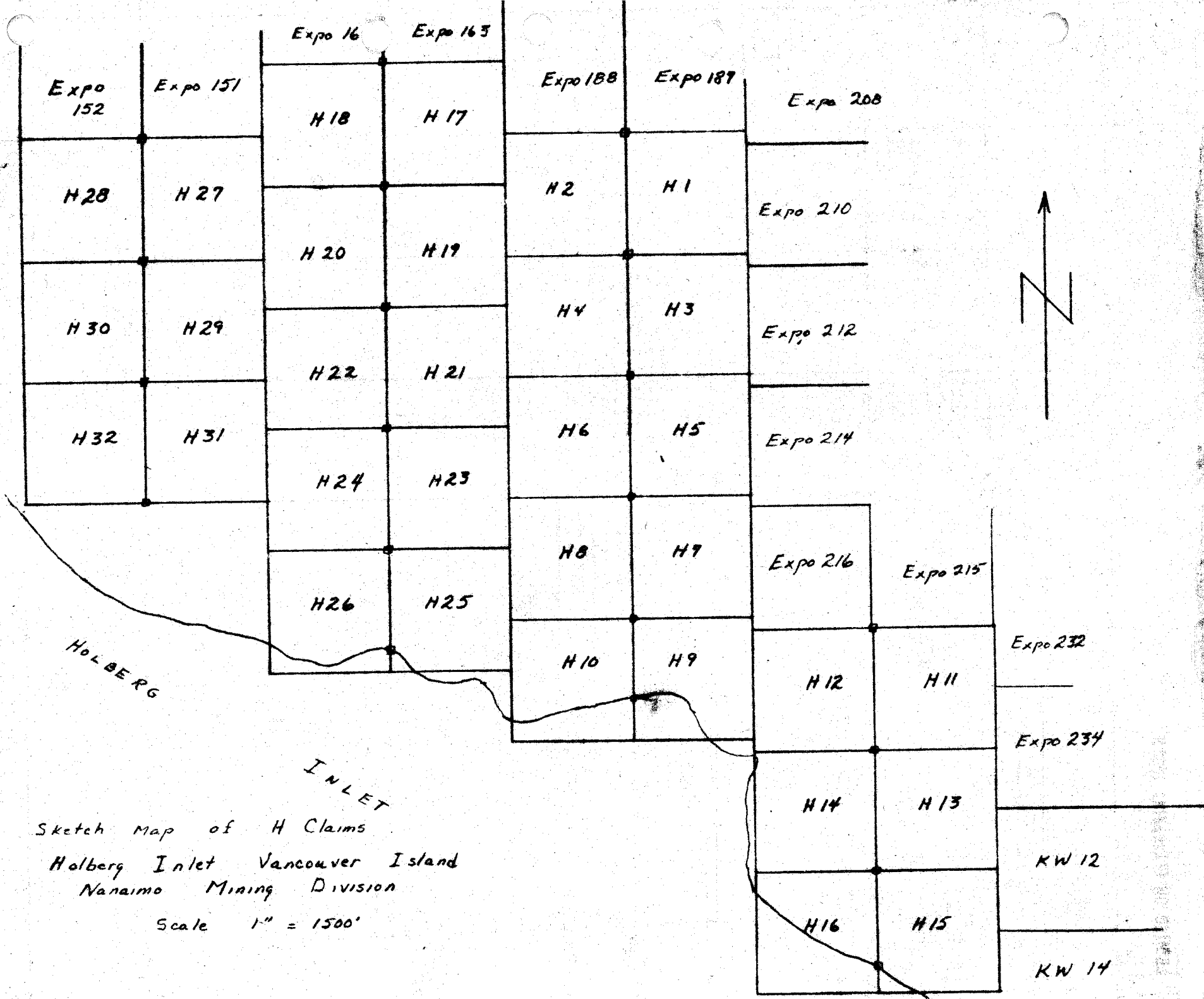

Sketch Map of H Claims  
 Holberg Inlet Vancouver Island  
 Nanaimo Mining Division  
 Scale 1" = 1500'





**SYMBOLS**

- Lake
- Outline of outcrop
- Open swamp
- Traverse & base lines
- Slash - edge of logging
- Trail
- Stream
- Intermittent streams
- Claim post, location line
- Claim boundaries showing claim overlap
- Claim names
- Geological contacts defined
- Geological contacts inferred
- Roads, skid ways
- Other flagged lines

**LEGEND**

- CRETACEOUS**
  - Siltstone, pebbly conglomerates, coal beds
- LOWER JURASSIC OR LATER**
  - Granite
  - Bonanza Volcanics
  - Bonanza Sediments, black fossiliferous shales with interbedded Andesite, tuffs
- UPPER TRIASSIC**
  - Owatsino limestone
  - Karmutsen Volcanics amygdaloidal Andesites
  - Limestone
  - Fault, inferred / defined
  - Bedding showing strike & dip
  - Sulphide mineralization: disseminated / massive (Py) pyrite (Cup) Chalcoo pyrite
  - Altered volcanics; chlorite, epidote
  - Shearing

Department of  
Mines and Petroleum Resources  
ASSESSMENT REPORT  
NO. 2561 MAP #3

1 inch = 400 FT  
**2561**  
*Actual*

**3 GEOLOGY MAP**  
**H CLAIMS**  
HOLBERG INLET VANCOUVER ISLAND B.C.  
SCALE 1" = 400'  
To accompany 'Geological & Geochemical Report' by B. A. Nekrasov P. Eng. on the H Claims, Holberg Inlet Nanaimo Mining Division, dated Sept. 1970  
Geology by: D.K. Bragg Date: Sept 1970  
Drawn by: D.K. Bragg



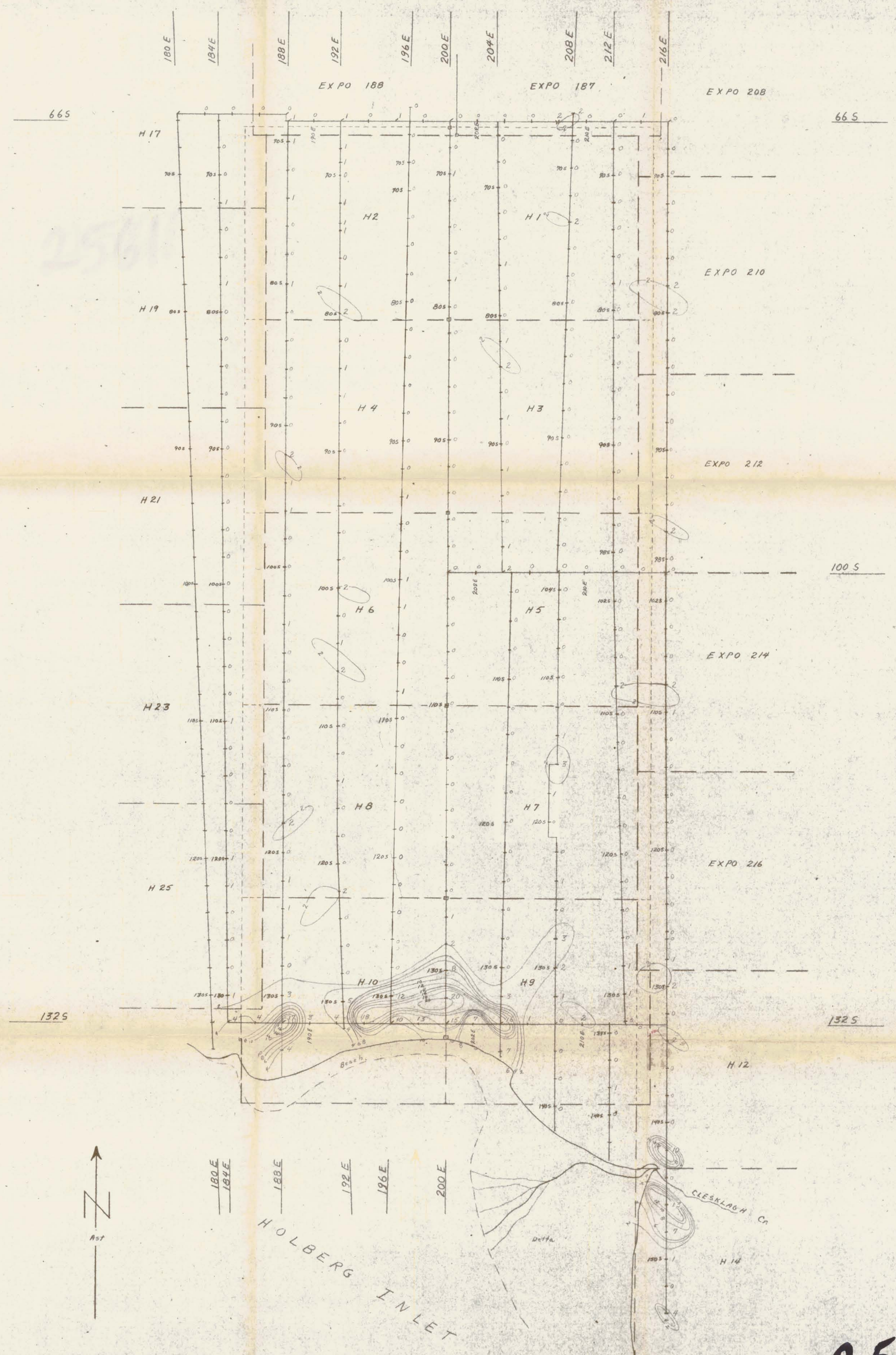

2561

2561  
*McLennan*

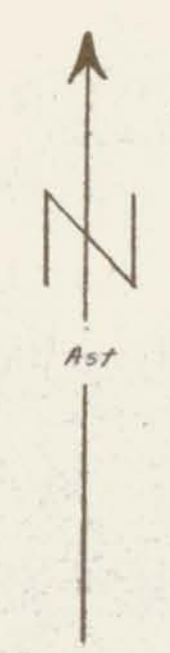

**LEGEND**  
 Location line showing position of posts,  
 claim boundary & claim name  
 Traverse lines showing station numbers,  
 soil sample sites & Mo. analysis in ppm.  
 Contour showing Mo. in ppm.  
 Interval 2 ppm.

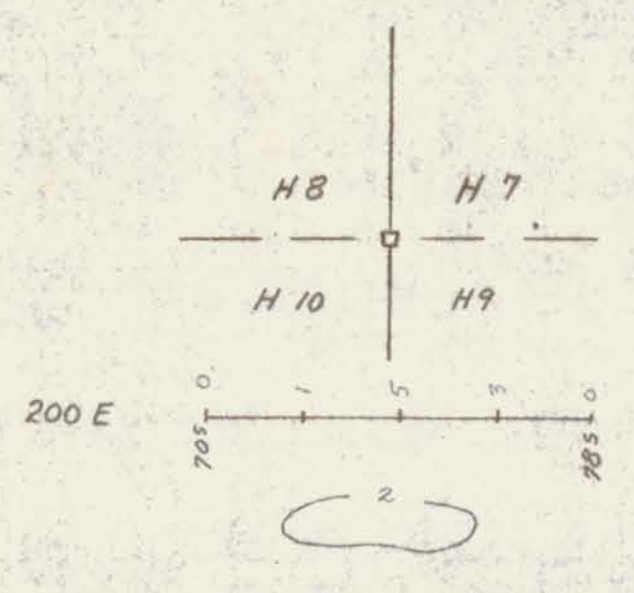

Department of  
 Mines and Petroleum Resources  
**ASSESSMENT REPORT**  
 NO. 2561 MAP #5

GEOCHEMICAL SOIL SURVEY (Mo. ppm.)	
<b>H CLAIMS</b>	
HOLBERG INLET VANCOUVER ISLAND B.C.	
SCALE 1" = 400'	
To accompany 'Geological & Geochemical Report' by B. A. Nekrasov P.Eng. on the H Claims, Holberg Inlet Nanaimo Mining Division, dated Sept. 1970	
Work by: DK. Bragg	Date: Sept. 1970
Drawn by: DK. Bragg	



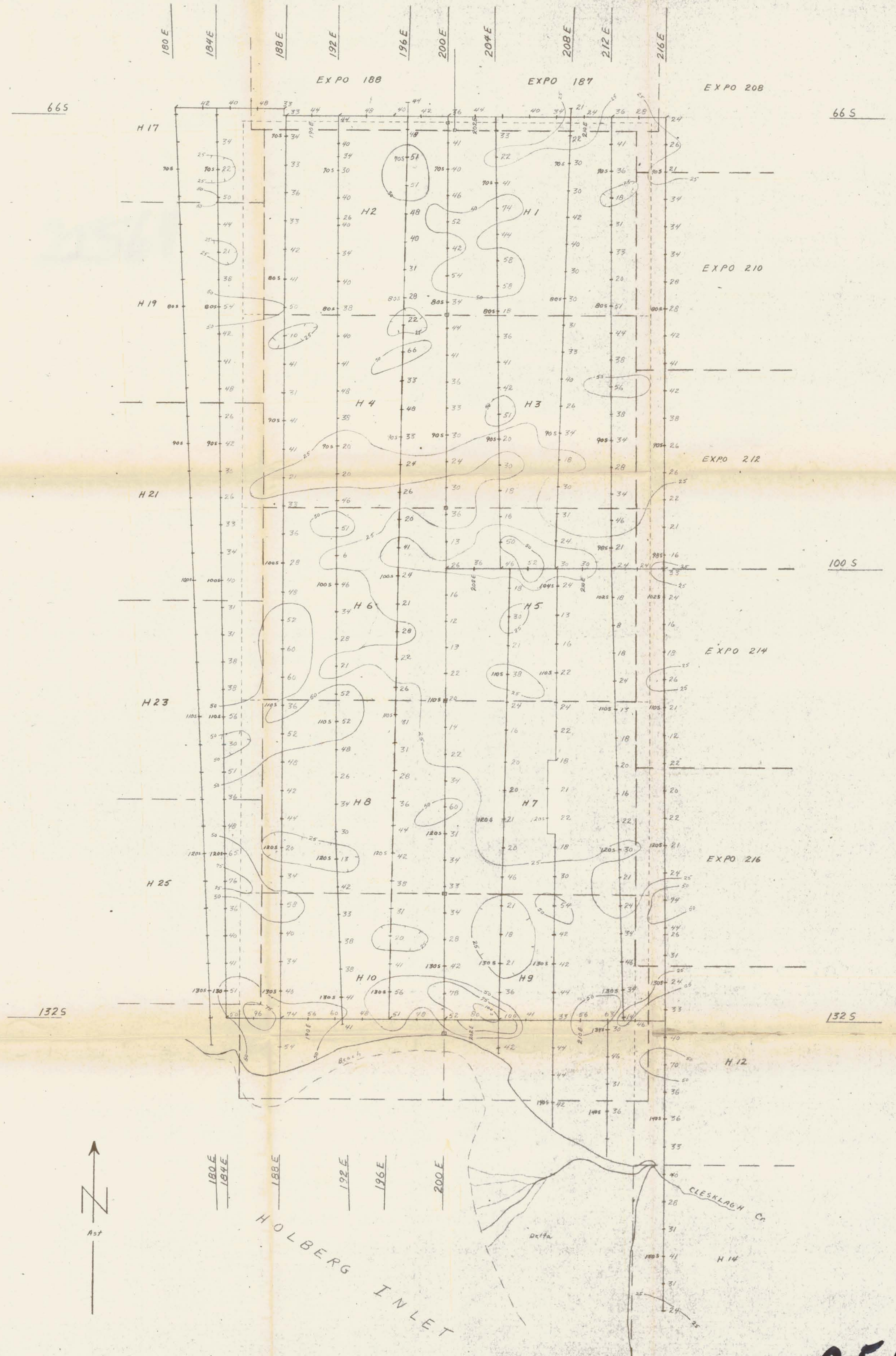

**2561**  
*Brugg*

**LEGEND**

Location line showing position of posts, claim boundary & claim name

Traverse lines showing station numbers, soil sample sites & Cu. analysis in ppm.

Contour showing Cu. in ppm. Interval 25 ppm.

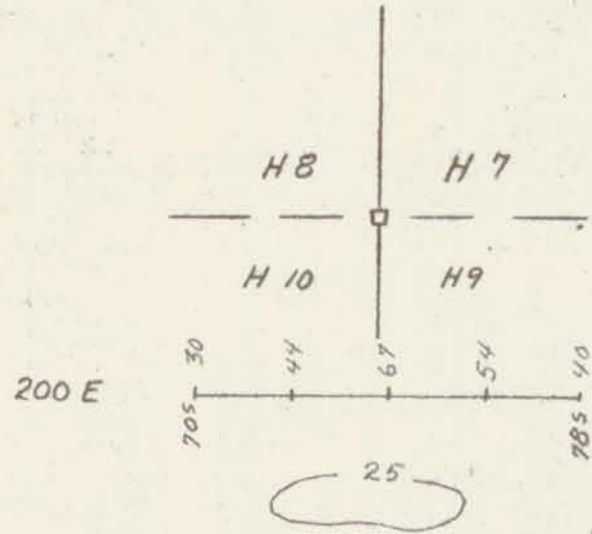

Department of  
 Mines and Petroleum Resources  
 ASSESSMENT REPORT  
 NO. **2561** MAP #4

GEOCHEMICAL SOIL SURVEY (C.u. ppm.)

**H CLAIMS**  
 HOLBERG INLET VANCOUVER ISLAND B.C.  
 SCALE 1" = 400'

To accompany Geological & Geochemical Report by B. A. Nekrasov P. Eng. on the H Claims, Holberg Inlet Nanaimo Mining Division, dated Sept 1970

Work by: DK. Bragg Date: Sept 1970  
 Drawn by: DK Bragg



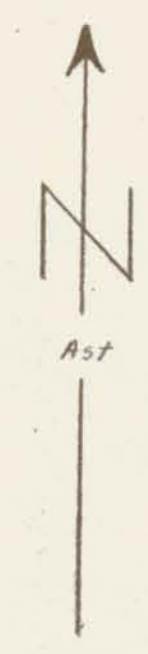
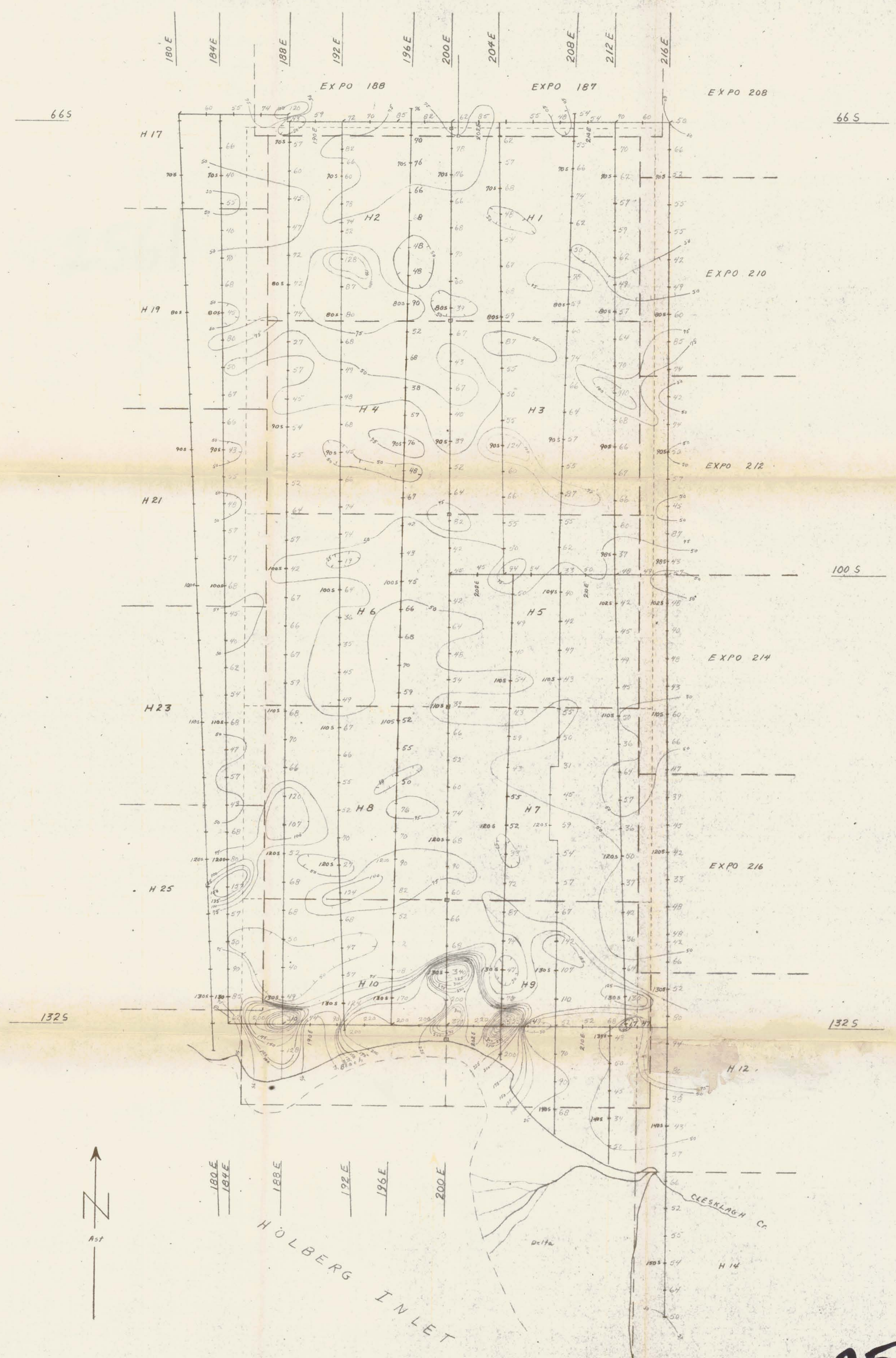

**2561**

**LEGEND**  
 Location line showing position of posts, claim boundary & claim name  
 Traverse lines showing station numbers, soil sample sites & Zn analysis in ppm.  
 Contour showing Zn in ppm. Interval 25 ppm.

Department of  
 Mines and Petroleum Resources  
 ASSESSMENT REPORT  
 NO. **2561** MAP #6

GEOCHEMICAL SOIL SURVEY (Zn ppm.)  
**H CLAIMS**  
 HOLBERG INLET VANCOUVER ISLAND B.C.  
 SCALE 1" = 400'  
 To accompany 'GEOLOGICAL & GEOCHEMICAL REPORT' by B. A. Nekrasov P.Eng. on the H Claims, Holberg Inlet Nanaimo Mining Division, dated Sept 1970  
 Work by: DK Bragg Date: Sept 1970  
 Drawn by: DK Bragg