

2672

Department of
Mines and Petroleum Resources
ASSESSMENT REPORT

NO. 2672 MAP.....

COIN CANYON MINES LTD.

GEOLOGICAL AND GEOCHEMICAL REPORT

BUB CLAIM GROUP

ATLIN MINING DIVISION
59°40'N 133°25'W

By: Gordon C. Gutrath, P. Eng.

Date: October 1, 1970

TABLE OF CONTENTS

INTRODUCTION	Page 1
PERSONNEL.....	Page 2
GEOGRAPHY.....	Page 2
Location.....	Page 2
Access.....	Page 2
Topography.....	Page 2
Vegetation.....	Page 2
Climate.....	Page 3
HISTORY AND DEVELOPMENT.....	Page 3
GEOLOGY.....	Page 4
General.....	Page 4
Property Geology.....	Page 4
Mineralization.....	Page 5
Sampling.....	Page 5
Economics.....	Page 6
GEOCHEMICAL SURVEY.....	Page 6
Survey Equipment and Analysis.....	Page 6
Survey Performed.....	Page 6
Results.....	Page 7
CONCLUSION.....	Page 8

ILLUSTRATIONS:

#1 Location Map	1" = 4 miles
#2 General Geology	1" = 1 mile
Geochemical Survey	
#3 Copper	1" = 500 feet
#4 Lead	1" = 500 feet
#5 Silver	1" = 500 feet
#6 Molybdenum	1" = 500 feet
Claim Map & Outcrop	
#7 Geology	1" = 500 feet

COIN CANYON MINES LTD.

GEOCHEMICAL AND GEOLOGICAL REPORT

BUB CLAIM GROUP
Atlin Mining Division

59°40'N 133°25'W

I N T R O D U C T I O N

The property was visited for the first time on the 4th of August, 1969 with R. L. McKamey. A camp was located and accessibility to the claim group was investigated.

Between August 9th and September 1st, 1969, under the field supervision of R. L. McKamey, 33,000 feet of control grid line was cut and surveyed on the Bub Claim Group, at a cost of \$2,790.00. The line-cutting was applied as assessment work in order to keep the 20 Bub Claims in good standing until October 9, 1970.

Between June 20th and July 3rd, 1970, an additional 44,600 feet of control grid line was cut and surveyed, under the field supervision of C. B. Rouleau. Soil samples were collected and sent to Vancouver Geochemical Laboratories Ltd. for geochemical analysis.

PERSONNEL (1970)

Supervision:

G. Gutrath, P. Eng. - overall supervision on the Bub Group exploration program for Coin Canyon Mines Ltd.

PERSONNEL (1970)
(cont'd)

Line Cutters and Soil Sampling:

C.B. Rouleau - responsible for line cutting & soil sampling.
C. Gardiner - line cutter.

GEOGRAPHY

Location:

The Bub Claim Group is located in northwestern British Columbia, 12 miles to the northeast of Atlin, B.C. The claims are on the west side of Boulder Creek, approximately three miles to the southwest of the molybdenum property that is presently being drilled by Adanac Mines Ltd. Coordinates of the Bub Claim Group are 59°40'W and 133°25'W.

Access:

Access to the property is by 14 miles of good, all-weather gravel road from Atlin. Atlin is 50 miles from the Alaska Highway and 100 miles from Whitehorse, Yukon.

Topography:

The claim group is located on a gentle easterly facing slope, starting at an elevation of 3500 feet and extending to the ridge at 5000 feet. The topography would not hinder any future road building on the property.

Vegetation:

The lower slopes, below an elevation of 4000 feet, is covered by dense willows and alders with scattered patches of scrub balsam. The upper slope is covered by open, grassy, alpine meadows.

GEOGRAPHY (cont'd)

Climate:

The average yearly precipitation would be in the range of 20 inches. Winter snowfall would average four feet. The average temperature for the month of June is 51°F and for January 20°F.

HISTORY AND DEVELOPMENT

Boulder Creek was worked for placer gold intermittently from 1899 to 1953. The wolframite in the pay gravels was considered a nuisance and was not saved until 1950 when two shipments were made that assayed: 46.88% and 49.01% WO₃ and 7.42% and 10.75% tin.

In 1963, Newmont Mining Corporation of Canada Ltd. optioned 78 claims from Alan Matson, that included the present Bub Claim Group, of Atlin, B.C. Twelve trenches, totalling 3,360 feet in length, averaging 16'0 wide and 6'0 deep, were bulldozed in the vicinity of the original showings. A very limited area was surveyed with an Askania magnetometer. Newmont dropped their option on the property in 1963.

Cominco in 1964 optioned the property from Alan Matson and packsack-core drilled the mineralized zones in the trenches.

Five holes were drilled for a total length of 114.2 feet. One hole was 50 feet long and the other four were all under 20 feet in length

HISTORY AND DEVELOPMENT (cont'd)

The most interesting development in this area is on Adanac's Ruby Creek property, located three miles to the northeast of the Bub Group.

Drilling has geologically indicated 82,329,000 tons grading 0.145% MoS₂. Kerr Addison Mines Ltd. has optioned the Adanac property and has committed themselves to carrying out a feasibility study costing \$2,500,000.00. This program is now underway.

GEOLOGY

General:

(J.P. Aitkens, 1959, Geological Survey of Canada, Atlin Map Area (104N) Memoir 307).

The east side of Atlin Lake is underlain by Cache Creek sediments and related volcanics of Pennsylvannian age. This series has been intruded by small ultrabasic stocks during Pennsylvannian time and by undifferentiated granite rocks (Coast Intrusions) and alaskite and quartz monzonite intrusives during Jurrassic and Cretaceous times.

Property Geology:

The claim group is underlain by Cache Creek Group greenstone interbedded with small sections of limestone and quartzite. On the west side of the claim group there are three small stocks of peridotite and meta-diorite. The northeasterly 1/3 of the claim group is underlain by a large stock of alaskite composition.

GEOLOGY (Cont'd)Mineralization:

Disseminations and irregular massive lenses of pyrrhotite-pyrite with minor amounts of chalcopyrite, tetrahedrite, galena, sphalerite, fluorite, cassiterite and scheelite occur in altered talcose basic volcanics and peridotite. Minor molybdenite mineralization has been located in the northerly trench on the Bub Claim #15.

Sampling:

Mr. L.G. White, P. Eng. in 1962 had a sample from the property spectrographically analyzed. The most interesting values in the samples were for tin (Sn) 2.5%, and tungsten (W) 1.0%.

Newmont Mining, in 1963, did some detailed sampling of the mineralization in the trenches. They assayed for zinc, tin, copper and silver, and did not appear to consider the tungsten values worth checking. Their assay values were from: trace to .42% in tin, nil to .25% in copper, nil to 5.3% in zinc, and trace to 11.4 oz. in silver.

Cominco, in 1964, drilled five packsack-drill holes in the area of the trenches that had been sampled by Newmont. The drilling indicated very short mineralized sections that assayed: up to .35% copper, 1.2% zinc, 0.69% tin, and .41% tungsten.

GEOLOGY (cont'd)

Economics:

There has not been enough exploration work done on the property to determine the economic potential. The property is favourably located with regards to water, timber, and transportation. There is no electric power available and no local labour force.

GEOCHEMICAL SURVEY

Survey Equipment and Analysis:

The geochemical analysis was done by Vancouver Geochemical Laboratories Ltd. using the following equipment and procedure:-

Weight of samples used:	0.5 gm.
Samples sifted or ground to:	-80 mesh
Extraction:	Hot HNO ₃ and HCO ₄
Method of Analyses:	Atomic Absorption Spectrometer
Volume of Dilution:	10 ml.
Instrument used:	Tetron AA4 and AA5
Analyst:	C. Chung & L. Nicol
Analyzed for:	* the first 130 samples collected in 1969 were analyzed for Cu, Mo, Pb & Ag. * the 403 samples collected in 1970 were analyzed for Cu.

Survey Performed:

The soil samples were collected with a stainless steel trowel from the "A" soil horizon at a depth varying from six inches to one foot. A total of 176 soil samples were collected at 200-foot intervals on a grid with crosslines at 800-foot intervals. This was basically a reconnaissance survey to locate the best mineralized zone area on

GEOCHEMICAL SURVEY (cont'd)Survey Performed: (cont'd)

claim groups. These samples were analyzed for Cu, Mo, Pb and Ag. A total of 403 fill-in soil samples were collected later from the northeast portion of the claim group. These samples were collected at 100-foot intervals in crosslines at 400-foot intervals and analyzed for Cu.

Results:

Lead: - the lead background is in the range of 20 to 30 ppm.

There are only three anomalous lead samples and they were collected from the northeast corner of the claim group.

Silver: - the silver background is in the range of 1 to 1.5 ppm. Anomalous values are in the range of 2.5 ppm. to 7 ppm. The most significant anomalous zone is in the northeast corner of the claim group.

Molybdenum: - the molybdenum background is in the range of 1 to 2 ppm. Anomalous values range from 4 to 11 ppm. The higher values are concentrated in the northeast corner of the claim group.

Copper: - the copper background is in the range of 20 to 40 ppm. Values over 70 ppm. Cu. are significantly anomalous and range as high as 380 ppm. The copper anomalous values are the most uniformly distributed of the various elements analyzed and best demonstrate the trend of the mineralized zone.

CONCLUSION

The geochemical survey outlined a zone with anomalous lead, silver, molybdenum and copper values in the northeast corner of the claim group. The most significant values are for copper and molybdenum. The anomaly is in part coincidental with the northeasterly-trending mineralized zone that is exposed in the trenches. However, the northeasterly-trending anomalous zone centered at station 4+00N-14+00W is directly related to the mineralized zone in the trenched area and the copper anomaly at station 4+00N 0+00W may be related to a sub-parallel mineralized zone. The anomaly has not been investigated and is in an area completely covered with overburden.

Respectfully submitted,

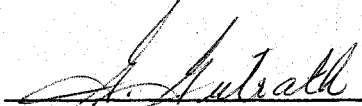

Gordon C. Gutrath, P. Eng.

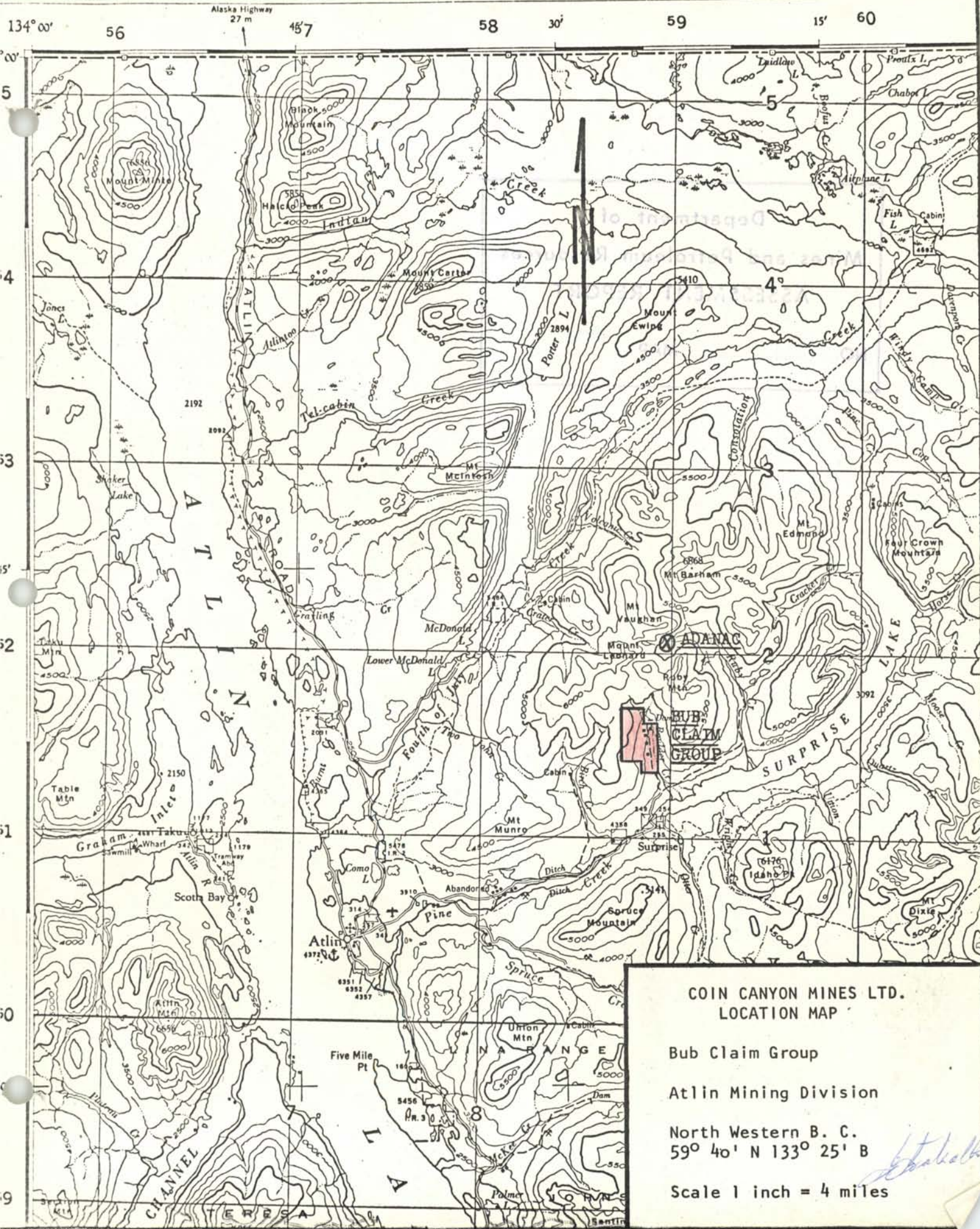

COIN CANYON MINES LTD.
LOCATION MAP

Bub Claim Group
 Atlin Mining Division
 North Western B. C.
 59° 40' N 133° 25' B
 Scale 1 inch = 4 miles

Spalding

Department of
Mines and Petroleum Resources
ASSESSMENT REPORT

NO. 2672 MAP #1

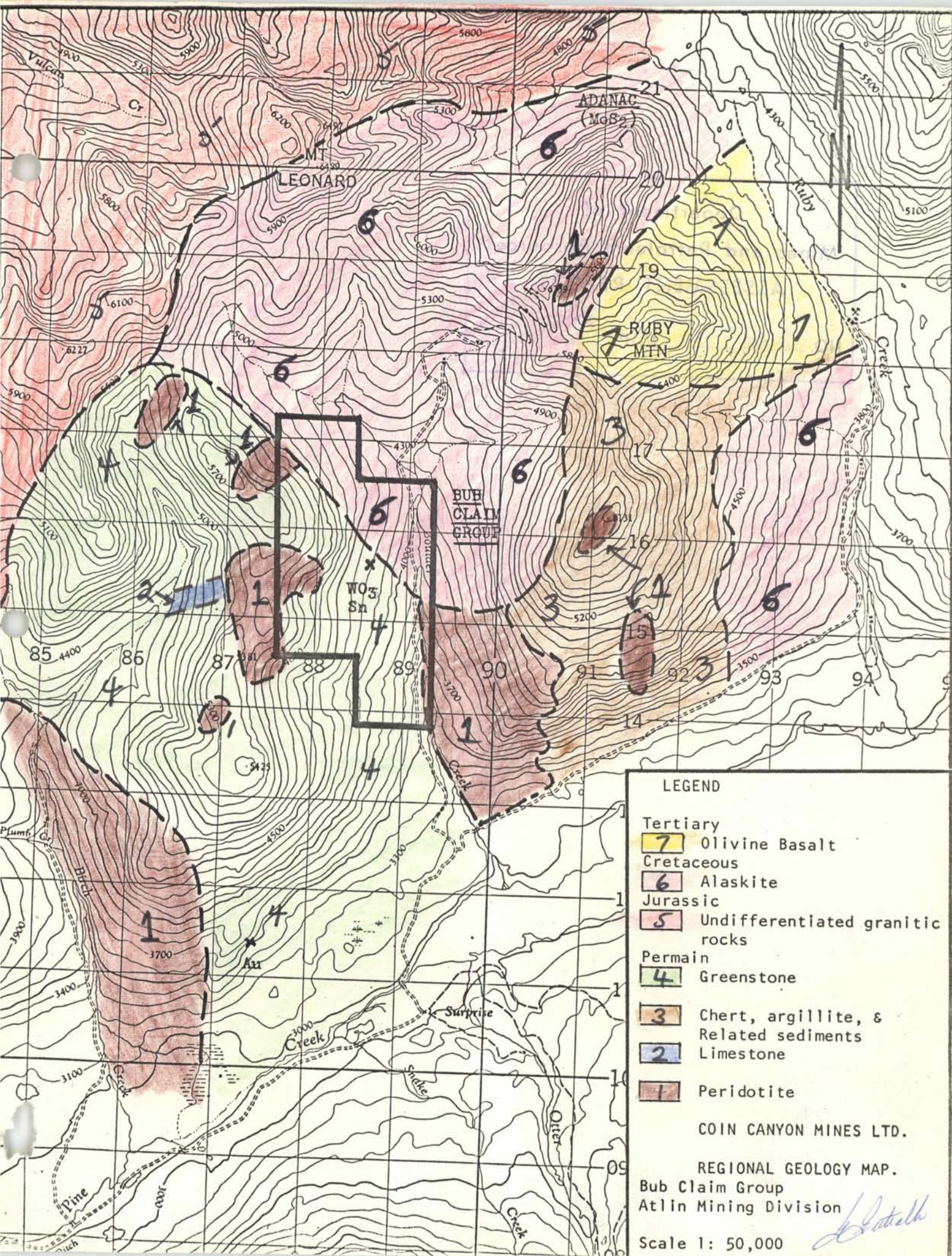

LEGEND

- Tertiary
 - 7 Olivine Basalt
- Cretaceous
 - 6 Alaskite
- Jurassic
 - 5 Undifferentiated granitic rocks
- Permian
 - 4 Greenstone
 - 3 Chert, argillite, & Related sediments
 - 2 Limestone
 - 1 Peridotite

COIN CANYON MINES LTD.

REGIONAL GEOLOGY MAP.
 Bub Claim Group
 Atlin Mining Division

Scale 1: 50,000

L. G. Gathel

Department of
Mines and Petroleum Resources
ASSESSMENT REPORT

NO. 2672 MAP #2

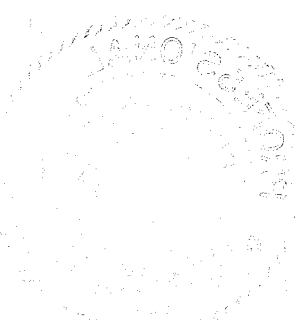



L-40+00N

L-32+00N

L-24+00N

L-16+00N

L-8+00N

L-0+00

L-8+00S

L-16+00S

L-24+00S

L-32+00S

L-40+00S

L-24+00N

L-16+00N

L-8+00N

L-0+00

L-8+00S

L-16+00S

L-24+00S

L-32+00S

L-40+00S

L-48+00S

L-56+00S

BASE LINE — B

BASE LINE — A

CREEK
BOULDER

SAT TRAIL

CAMP

Department of
Mines and Petroleum Resources
ASSESSMENT REPORT
NO. 2672 MAP #3

COPPER (P.P.M.)
COIN CANYON MINES LTD.

2672 GEOCHEMICAL SURVEY
BUB CLAIM GROUP
ATLIN MINING DIVISION
NORTH WESTERN B.C.
59° 40' N 133° 25' W

LEGEND

	+ 120 ppm
	80 - 120 ppm
	40 - 80 ppm

FIELD WORK BY R.L. MCKAMEY
SUPERVISED BY G. GUTRATH P. ENG.

FEET 500 250 0 250 500 1000 1500 FEET
ALTAIR SEPT 10-1969

J. Smith



Department of
Mines and Petroleum Resources
ASSESSMENT REPORT
NO. 2672 MAP #4

LEGEND

	+ 100 ppm
	60 - 100 ppm
	30 - 60 ppm

2672

LEAD (PPM)
COIN CANYON MINES LTD.
GEOCHEMICAL SURVEY
BUB CLAIM GROUP
ATLIN MINING DIVISION
NORTH WESTERN B.C.
59° 40' N 133° 25' W

FIELD WORK BY R.L. MCKAMEY
SUPERVISED BY G. GUTRATH P. ENG.

FEET 0 200 400 600 800 1000 1500

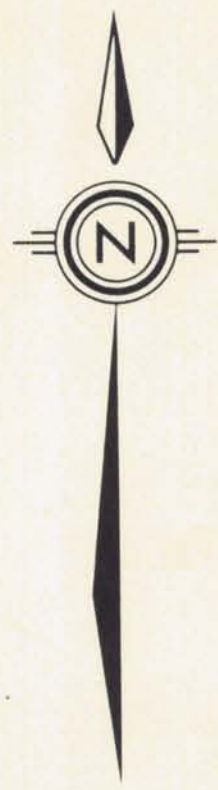

L-40+00 N
 L-32+00 N
 L-24+00 N
 L-16+00 N
 L-8+00 N
 L-0+00
 L-8+00 S
 L-16+00 S
 L-24+00 S
 L-32+00 S
 L-40+00 S

L-24+00 N
 L-16+00 N
 L-8+00 N
 L-0+00
 L-8+00 S
 L-16+00 S
 L-24+00 S
 L-32+00 S
 L-40+00 S
 L-48+00 S
 L-56+00 S

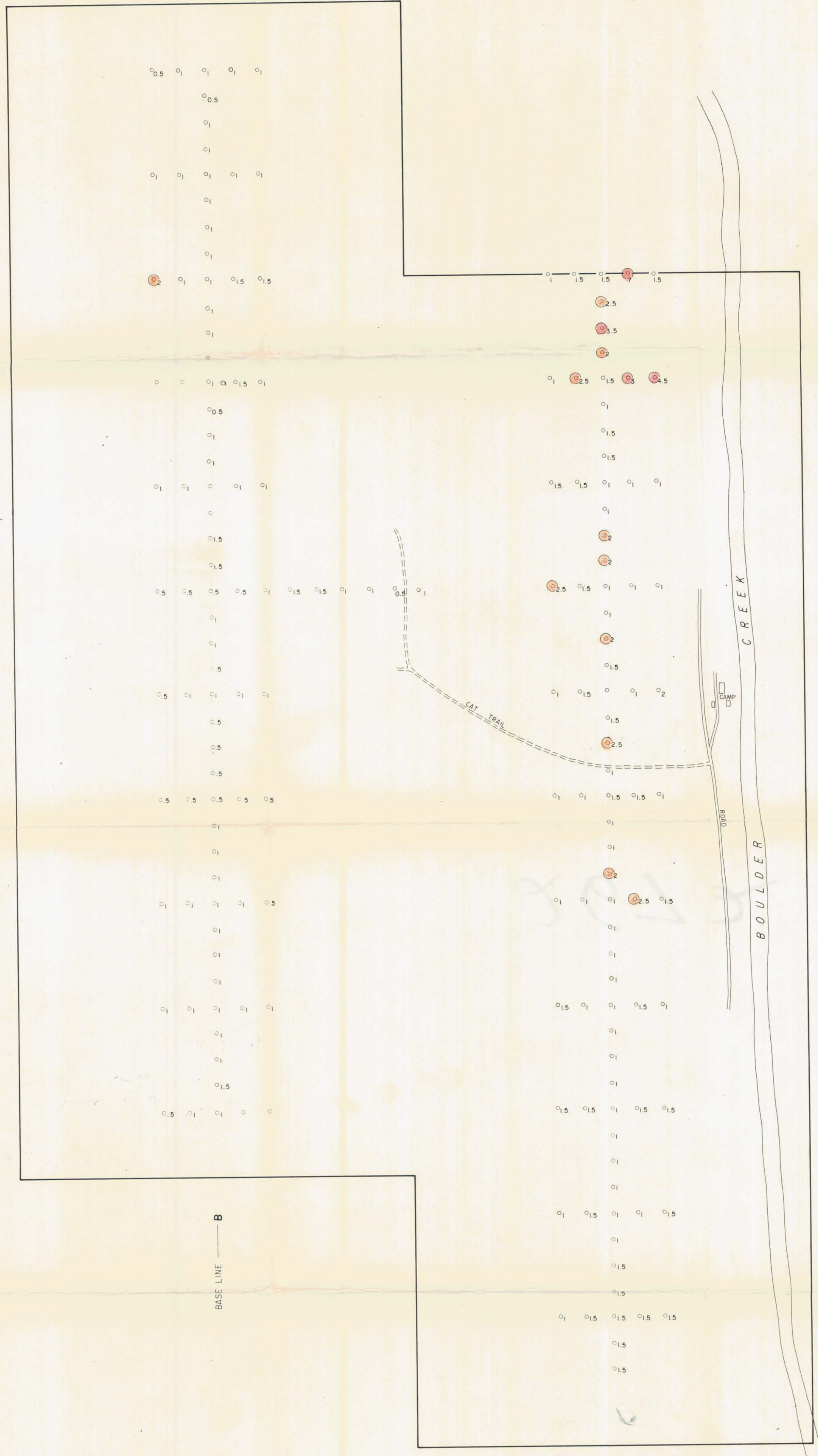

Department of
 Mines and Petroleum Resources
 ASSESSMENT REPORT
 NO. 2672 MAP #5

SILVER (P.P.M.)
 COIN CANYON MINES LTD.

GEOCHEMICAL SURVEY
BUB CLAIM GROUP

ATLIN MINING DIVISION
 NORTH WESTERN B.C.

59° 40' N 133° 25' W

LEGEND
 [Red Circle] + 3 ppm
 [White Circle] 2 - 3 ppm

2672

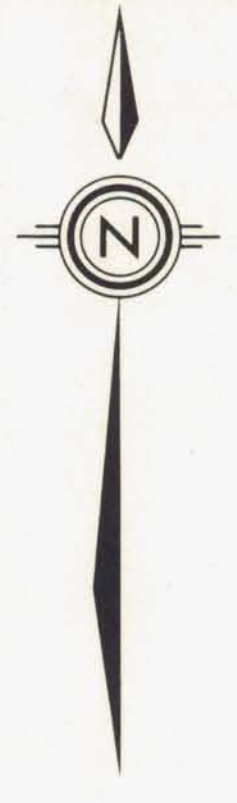

L-40+00 N
L-32+00 N
L-24+00 N
L-16+00 N
L-8+00 N
L-0+00
L-8+00 S
L-16+00 S
L-24+00 S
L-32+00 S
L-40+00 S

L-24+00 N
L-16+00 N
L-8+00 N
L-0+00
L-8+00 S
L-16+00 S
L-24+00 S
L-32+00 S
L-40+00 S
L-48+00 S
L-56+00 S

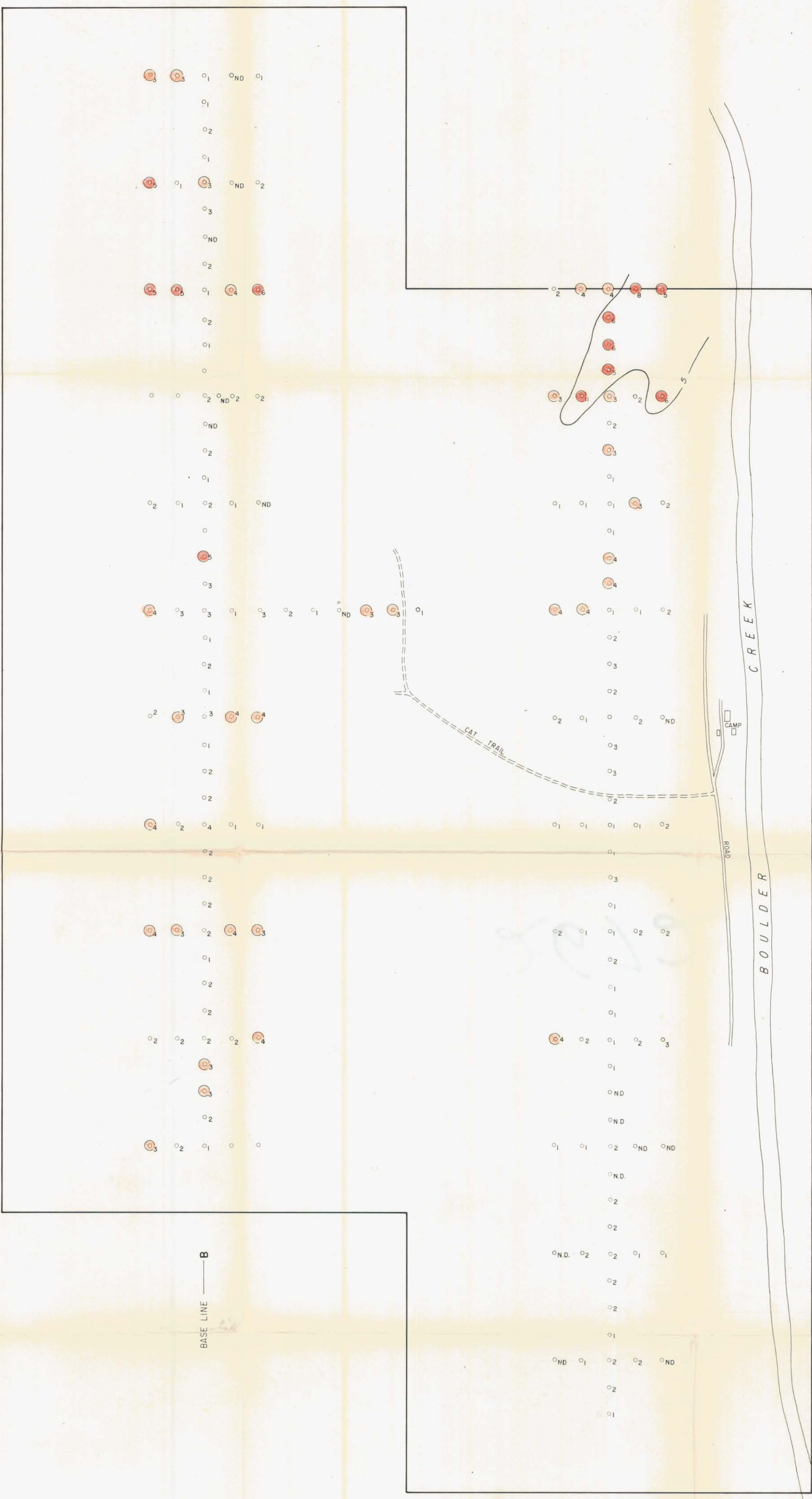

BASE LINE B

BASE LINE A

Department of
Mines and Petroleum Resources
ASSESSMENT REPORT
NO. 2672 MAP #6

LEGEND
+ 5 ppm
3 - 5 ppm

2672











MOLYBDENUM (PPM)
COIN CANYON MINES LTD.
GEOCHEMICAL SURVEY
BUB CLAIM GROUP
ATLIN MINING DIVISION
NORTH WESTERN B.C.
59° 40' N 133° 25' W

FIELD WORK BY R.L. MCKAMEY
SUPERVISED BY G. GUTRATH P. ENG.

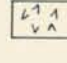
FEET 0 200 400 600 800 1000 1200 1400 1600
ALTAIR SEPT 10-1969

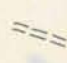

LEGEND

-  Peridotite, Meta-diorite
-  Alaskite
-  Quartzite
-  Limestone
-  Gabbro
-  Observed contact
-  Assumed contact
-  Road
-  Bulldozer trail
-  Outline of outcrop
-  Trench

Department of
Mines and Petroleum Resources
ASSESSMENT REPORT
NO. 2672 MAP #7

2672

COIN CANYON MINES LTD.
GEOLOGICAL MAP
BUB CLAIM GROUP
ATLIN MINING DIVISION
NORTH WESTERN B.C.

59° 40' N, 133° 25' W
Feet 500 250 0 500 1000 1500 Feet