

2822

KENNCO EXPLORATIONS, (WESTERN) LIMITED

REPORT

ON

SOIL GEOCHEMICAL SURVEY

LAWYERS NO. 1 & 2 GROUPS
(Lawyers Mineral Claims 1 to 54)

Situated 20 miles northwest of Thutade Lake,
Omineca Mining Division,
British Columbia

57° 127° SE

Department of
Mines and Petroleum Resources
ASSESSMENT REPORT

NO. 2822 MAP

By

R. W. Stevenson, P. Eng.

Work done August 14 to 22, 1970

January 8, 1971

TABLE OF CONTENTS

	<u>Page</u>
LIST OF CLAIMS AND DISTRIBUTION OF WORK	1
STATEMENT OF COSTS INCURRED	3
Soil Geochemical Survey	3
INTRODUCTION	4
LOCATION AND ACCESS	5
SOIL GEOCHEMICAL SURVEY	6
Soil Survey Field Work	6
Control Survey Lines	6
Soil Sample Collection	6
Packaging	7
Sample Preparation	7
Analysis	7
Interpretation	7

LIST OF ILLUSTRATIONS

1 Location Map	1 : 250,000
2 Plate No. 1 Copper in Soil	1" = 400'
3 Plate No. 2 Molybdenum in Soil	1" = 400'
4 Plate No. 3 Zinc in Soil	1" = 400'
5 Plate No. 4 Lead in Soil	1" = 400'
6 Plate No. 5 Cobalt in Soil	1" = 400'
7 Plate No. 6 Nickel in Soil	1" = 400'
8 Plate No. 7 Soil Sample Locations	1" = 400'



Kennco Explorations, (Western) Limited

LAWYERS CLAIMS

Situated 20 miles northwest of Thutade Lake

Omineca Mining Division
British Columbia

57° 127° SE

LOCATION MAP

Scale:
1 : 250,000

R. H. Stevenson

LIST OF CLAIMS AND DISTRIBUTION OF WORK

Lawyers No. 1 Group

<u>Claim No.</u>	<u>Record No.</u>	<u>Record Date</u>	<u>\$ Soil Geochem Work Each Claim</u>	<u>Years Applied</u>
1	84334	February 11	180	1
3	84336	"	180	1
4	84337	"	290	1
5	84338	"	125	1
6	84339	"	100	1
11	84344	"	290	2
12	84345	"	395	2
13	84346	"	265	1
14	84347	"	340	1
15	84348	"	200	1
16	84349	"	290	1
17	84350	"	-	1
18	84351	"	40	1
21	84354	"	391	2
22	84355	"	205	1
23	84356	"	100	1
24	84357	"	175	1
25	84358	"	15	1
26	84359	"	-	1
27	84360	"	-	1
28	84361	"	-	1
29	84362	"	-	1
30	84363	"	-	1
45	89966	August 7	25	1
46	89967	"	-	1
47	89968	"	-	1
48	89969	"	-	1
49	89970	"	-	1
50	89971	"	-	1
51	89972	"	-	1
52	89973	"	-	1
53	89974	"	-	1
54	89975	"	-	1
Total for Group No. 1			= \$3606	36

List of Claims & Distribution of Work - cont'd

Lawyers No. 2 Group

<u>Claim No.</u>	<u>Record No.</u>	<u>Record Date</u>	<u>\$ Soil Geochem Work Each Claim</u>	<u>Years Applied</u>
2	84335	February 11	360	1
7	84340	"	445	2
8	84341	"	40	2
9	84342	"	360	2
10	84343	"	605	2
19	84352	"	490	2
20	84353	"	80	1
31	84364	"	15	1
32	84365	"	195	1
33	84366	"	185	1
34	84366A	"	95	1
35	89956	August 7	-	2
36	89957	"	-	2
37	89958	"	-	1
38	89959	"	-	1
39	89960	"	-	1
40	89961	"	-	1
41	89962	"	-	1
42	89663	"	-	1
43	89964	"	-	1
44	89965	"	-	1
Total for Group No. 2 =			<u>\$2870</u>	<u>28</u>

TOTAL FOR GROUPS 1 & 2 = \$6476

64

STATEMENT OF COSTS INCURRED

Soil Geochemical Survey

A detailed explanation of how the soil geochemical survey expenditures were incurred is given under the section entitled 'Soil Survey Field Work'.

The total cost of the soil geochemical survey on Lawyers No. 1 and 2 groups is as follows:

Chemical analysis of 1004 samples for Cu, Mo, Zn, Pb, Co, Ni
... \$4,518.00

Wages & Board:			
S.C. Gower	Aug 14-22	\$30.00 + \$10	360.00
J.B. Cordonier	Aug 14-18	\$18.00 + \$10	140.00
E.A. Black	Aug 14-22	\$18.00 + \$10	252.00
A.B. Flower	Aug 14-17,19-22	\$17.00 + \$10	216.00
R.J. Beaty	Aug 14,16-22	\$16.00 + \$10	208.00
R.S. Lopaschuk	Aug 14-21	\$14.00 + \$10	192.00
Laths for station markers			30.00
Helicopter set-outs on the property:			
3:30 hrs @ \$160/hr			560.00
			<hr/>
			\$6,476.00

The amount expended on each claim is shown on the list of claims.

Total on Group No. 1 = \$3606
Total on Group No. 2 = \$2870

INTRODUCTION

The mineral property discussed in this report is situated about 20 miles northwest of Thutade Lake, British Columbia. The exploration work on these claims consisted of a soil geochemical survey.

The work was done under the supervision of R. W. Stevenson, P. Eng.

LOCATION AND ACCESS

The property is situated at Latitude 57°19'N, Longitude 127°13'W, about 290 miles northwest of Prince George. This is about 20 miles northwest of Thutade Lake. The survey area is about 5000' to 6000' above sea level. Most of the area is above tree-line, and is grass-covered; but alpine fir grows in the lower part of the valley adjacent to the west end of the baseline.

Access to the property is by fixed-wing aircraft from Smithers to Thutade Lake, a distance of about 165 miles, and by helicopter from there. Local travel on the Lawyers property is fairly easy, except for the difference in elevation between the stream valley along the baseline, and the north and south ends of the sample lines. Helicopter set-outs were used so as to minimize the travel time from the camp to the higher parts of the survey area.

SOIL GEOCHEMICAL SURVEY

Soil Survey Field Work

Control Survey Lines

A control grid was established by chain and compass survey. Laths were used to mark the stations because most of the survey area is above tree-line. This gave good control of sample sites, with minimum expenditure.

The baseline direction is east-west. The sample lines are north-south. Line 8+00W was continued southward so as to establish the position of two other lines. These lines were run at 300° azimuth, just south of the main grid. They are designated Line 56+00SE and Line 60+00SE. This grid layout was chosen so as to give efficient coverage of the upland area that was to be sampled, as well as conforming to the claim boundaries. A base map with scale 1" = 400' was compiled for use in plotting the sample results.

Soil Sample Collection

The samples were taken at 100-foot intervals along the grid lines. The location of the sample sites is shown on Plate No. 7. They were taken from the top of the "B" (rusty) horizon. Exceptions to this occurred in rocky places where sufficient soil could not be found to take a sample.

The samples were collected by digging a small hole with a trenching tool type of spade. By this means it was possible to see where the top of the "B" horizon was. The soil sample was then taken from the top of the "B" horizon, either with the tip of the spade, or with a small trowel.

A note was then made of the grid line location, the sample number, the depth to the top of the "B" horizon, the direction of drainage, the type of vegetation (i.e. - grass, wooded, or bare soil), and the soil type.

Packaging

The samples were placed in 3" x 4 1/2" brown paper envelopes on which the sample numbers had been marked. These were closed with a triangular triple fold. (The bags are not anomalous in trace metals).

Sample Preparation

The samples were shipped to our laboratory in North Vancouver, where they were oven-dried at 80°C and sieved through an 80-mesh size stainless steel screen. (These sieves do not show noticeable wear even after several thousand samples have been sifted). The minus 80 mesh fraction was collected for all the analyses involved.

Analysis

The samples were analysed in the North Vancouver laboratory of Kennco Explorations, (Western) Limited, under the supervision of H. Goddard, laboratory manager, and G. Henriouille, chemist.

A one gram - 80 mesh sample is placed in a 25 x 200 mm test tube. Two ml of concentrated nitric acid is added. The sample is allowed to digest 15 minutes, and 5 ml of 70% perchloric acid is added. The sample is digested on a medium heat hot plate for four hours. After cooling the sample is diluted to 55 ml with distilled water, agitated, and after settling, the solution is used for the determination of Mo, Cu, Zn, Pb, Ni, and Co by an Atomic Absorption Spectrophotometer (Techtron AA5).

Interpretation

Overburden is fairly continuous over most of the area sampled, and varies from a few inches to probably about 20' or 30'. A good sample of "B" horizon was obtained at most sample

sites; however, the vegetation is generally grass, and the lack of coniferous forest may inhibit metal concentration in the "B" horizon. Certainly the metal levels for Cu, Mo, Zn, Pb, Co, and Ni are very low compared to other soil surveys below tree-line in the Thutade area. The results for these metals are plotted on Plates No. 1 to 6.

Copper values are generally in the 15 to 35 ppm range. Relative to this background, 50 ppm has been designated weakly anomalous. But even at these levels there is no well defined group of anomalous samples. For molybdenum, 4 ppm has been designated weakly anomalous. For zinc, 100 ppm is considered to be weakly anomalous, and 200 ppm anomalous. For lead, 20 ppm is considered to be weakly anomalous, and 50 ppm anomalous. Sample No. S8468 is strongly anomalous in lead (133 ppm). For cobalt, 20 ppm is weakly anomalous. Only one sample is strongly anomalous at 245 ppm Co (No. S8613). For nickel, 60 ppm is weakly anomalous.

No significant anomalies have been outlined. There is no variation in background level that might indicate changes in lithology. The few sample sites that are anomalous in various elements should be checked in the field in an attempt to ascertain whether they are derived from narrow zones of mineralization.

Vancouver, B. C.

January 8, 1971

R. W. Stevenson, P.Eng.

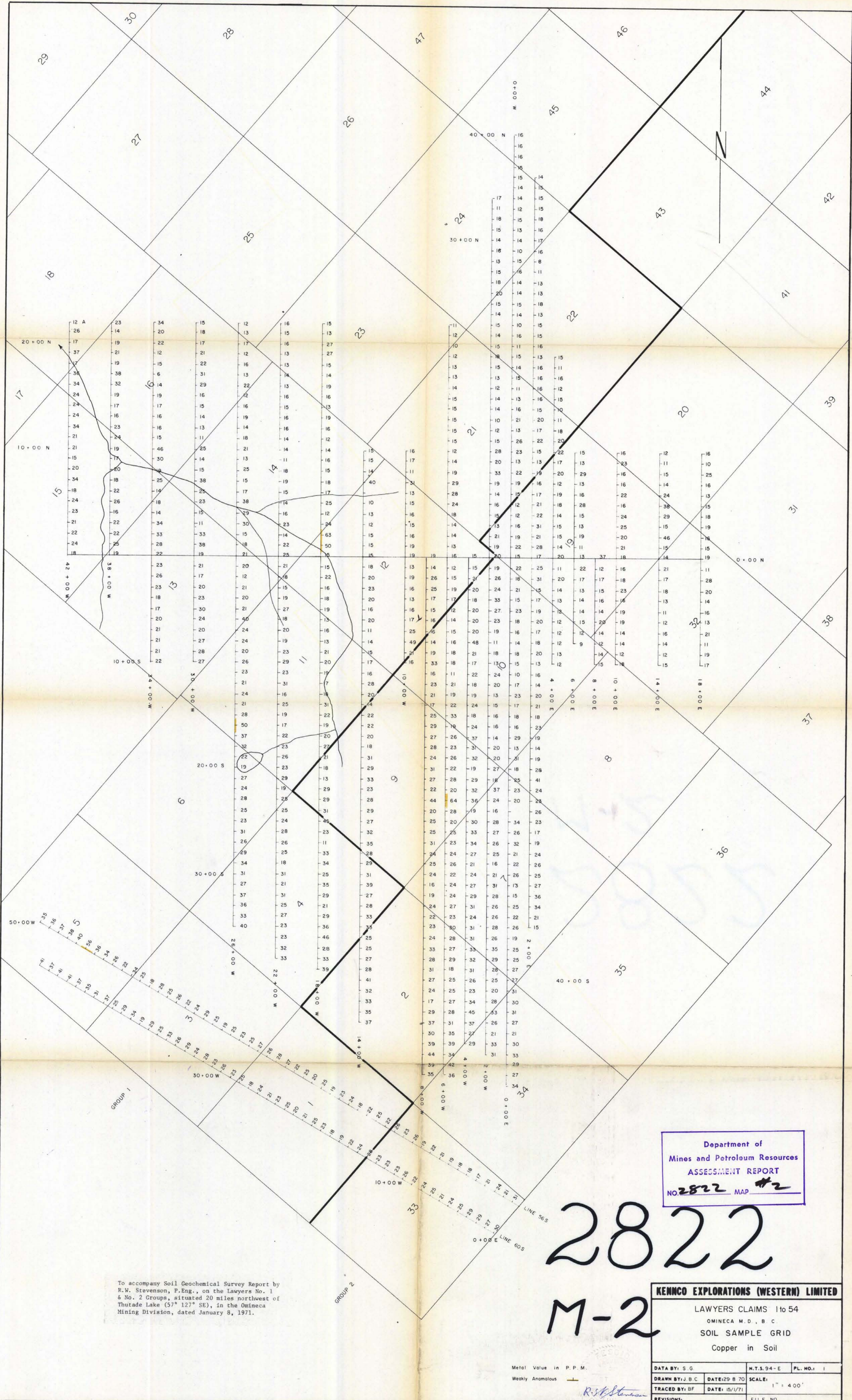

Department of
 Mines and Petroleum Resources
 ASSESSMENT REPORT
 NO. 2822 MAP #2

2822
 M-2

To accompany Soil Geochemical Survey Report by
 R.M. Stevenson, P.Eng., on the Lawyers No. 1
 & No. 2 Groups, situated 20 miles northwest of
 Thutade Lake (57° 127° SE), in the Omineca
 Mining Division, dated January 8, 1971.

KENNCO EXPLORATIONS (WESTERN) LIMITED			
LAWYERS CLAIMS 11 to 54			
OMINECA M.D., B.C.			
SOIL SAMPLE GRID			
Copper in Soil			
DATA BY: S.G.	N.T.S. 94-E	PL. NO. 1	1
DRAWN BY: J.B.C.	DATE: 29 B 70	SCALE:	1" = 400'
TRACED BY: BF	DATE: 15/1/71	REVISIONS:	FILE NO.

Metal Value in P.P.M.
 Weekly Anomalous

R.M. Stevenson

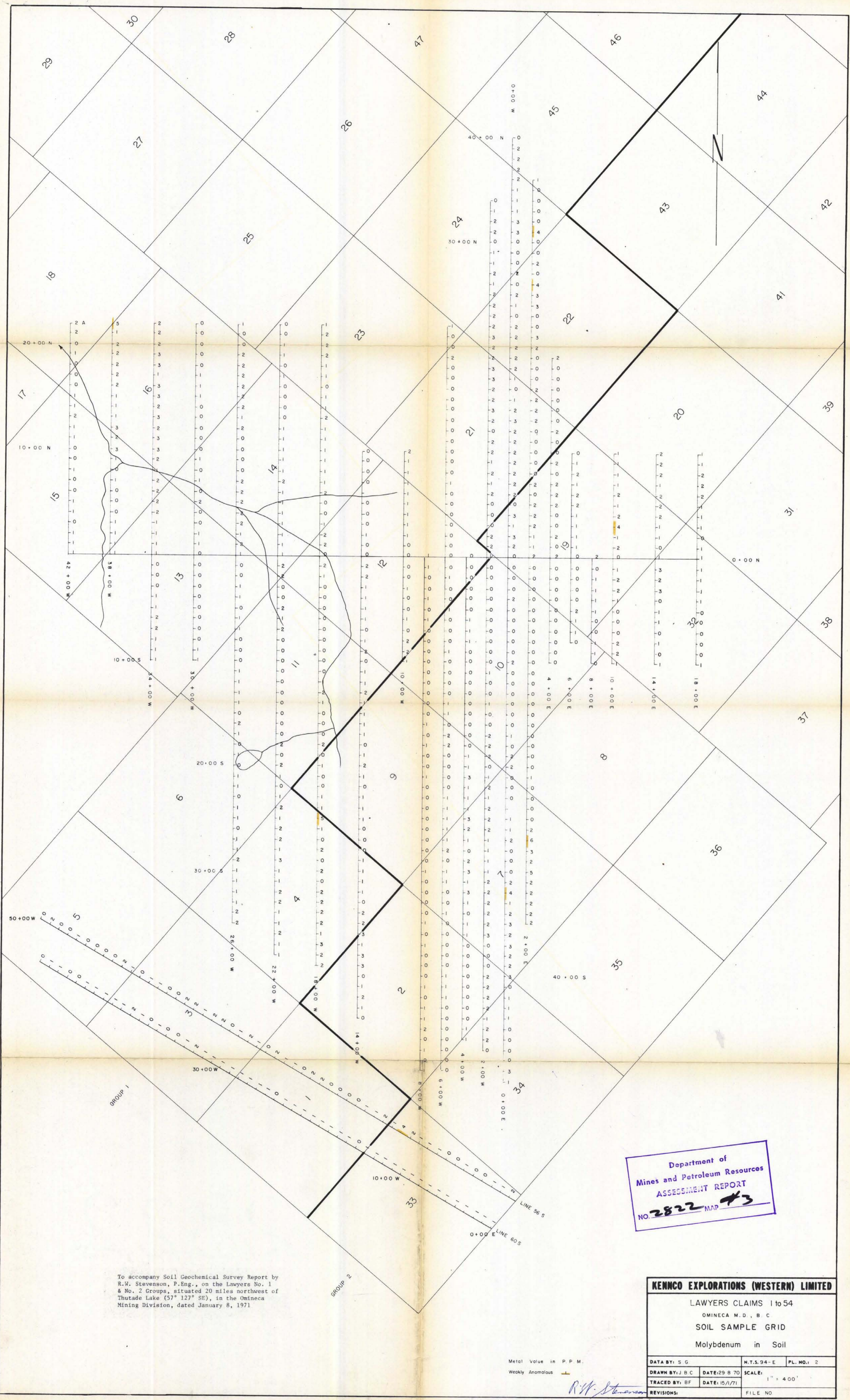

To accompany Soil Geochemical Survey Report by R.W. Stevenson, P.Eng., on the Lawyers No. 1 & No. 2 Groups, situated 20 miles northwest of Thutade Lake (57° 127' SE), in the Omineca Mining Division, dated January 8, 1971

Department of
Mines and Petroleum Resources
ASSESSMENT REPORT
NO. 2822 MAP #3

KENCO EXPLORATIONS (WESTERN) LIMITED		
LAWYERS CLAIMS 1 to 54		
OMINECA M.D., B.C.		
SOIL SAMPLE GRID		
Molybdenum in Soil		
DATA BY: S.G.	N.T.S. 94-E	PL. NO.: 2
DRAWN BY: J.B.C.	DATE: 29.8.70	SCALE: 1" = 400'
TRACED BY: B.F.	DATE: 15/1/71	
REVISIONS:		FILE NO.

Metal Value in P.P.M.
Weekly Anomalous

R.W. Stevenson

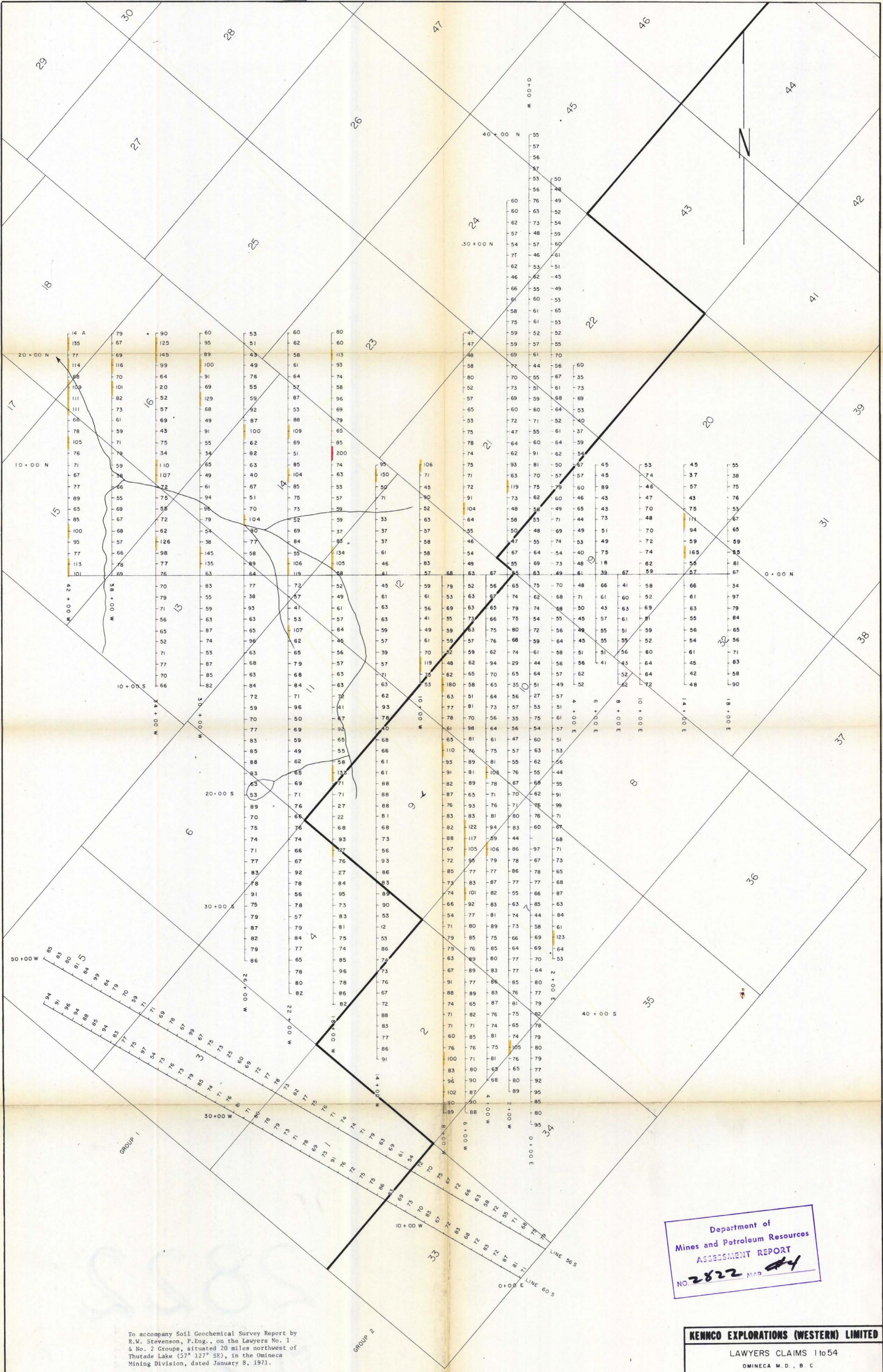

To accompany Soil Geochemical Survey Report by R.W. Stevenson, P.Eng., on the Lawyers No. 1 & No. 2 Groups, situated 20 miles northwest of Thutade Lake (57° 127° SE), in the Omineca Mining Division, dated January 8, 1971.

Department of
Mines and Petroleum Resources
ASSESSMENT REPORT
NO. 2822 MAP #4

KENNCO EXPLORATIONS (WESTERN) LIMITED			
LAWYERS CLAIMS 11054			
OMINECA M.D., B.C.			
SOIL SAMPLE GRID			
Zinc in Soil			
DATA BY: S.G.	N.T.S. 94-E	PL. NO. 3	
DRAWN BY: J.B.C.	DATE: 29.8.70	SCALE: 1" = 400'	
TRACED BY: B.F.	DATE: 15/71	REVISIONS:	
FILE NO.			

Metal Value in P.P.M.
Weakly Anomalous \perp
Anomalous \perp
R.W. Stevenson

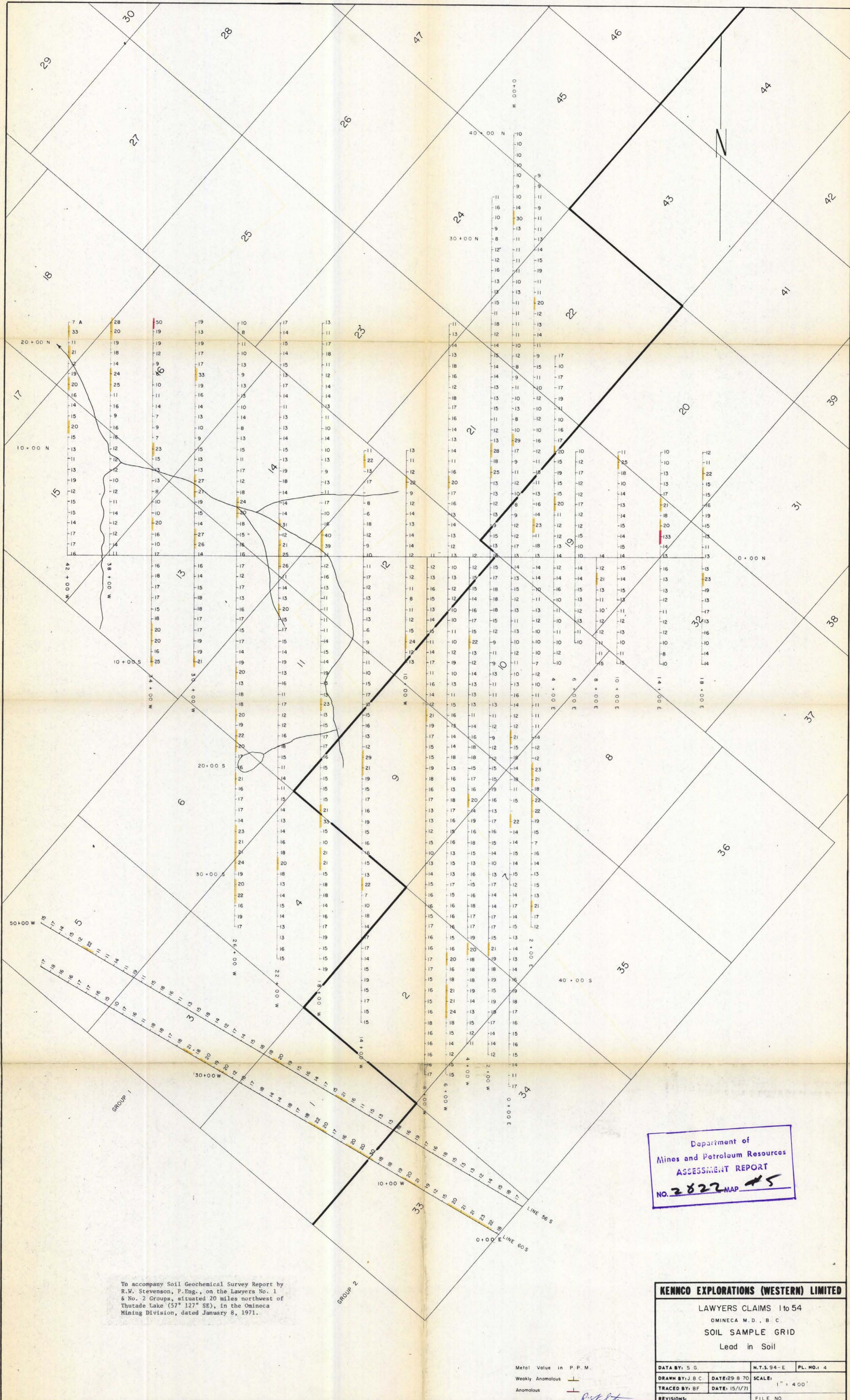

To accompany Soil Geochemical Survey Report by R.W. Stevenson, P.Eng., on the Lawyers No. 1 & No. 2 Groups, situated 20 miles northwest of Thutade Lake (57° 12' SE), in the Omineca Mining Division, dated January 8, 1971.

Department of
Mines and Petroleum Resources
ASSESSMENT REPORT
NO. 2822-MAP #5

KENCO EXPLORATIONS (WESTERN) LIMITED			
LAWYERS CLAIMS 1 to 54			
OMINECA M.D., B.C.			
SOIL SAMPLE GRID			
Lead in Soil			
DATA BY: S.G.	N.T.S. 94-E	PL. NO.: 4	
DRAWN BY: J.B.C.	DATE: 29-8-70	SCALE: 1" = 400'	
TRACED BY: BF	DATE: 15/1/71		
REVISIONS:		FILE NO.	

Metal Value in P.P.M.
Weekly Anomalous —
Anomalous —

R. Stevenson

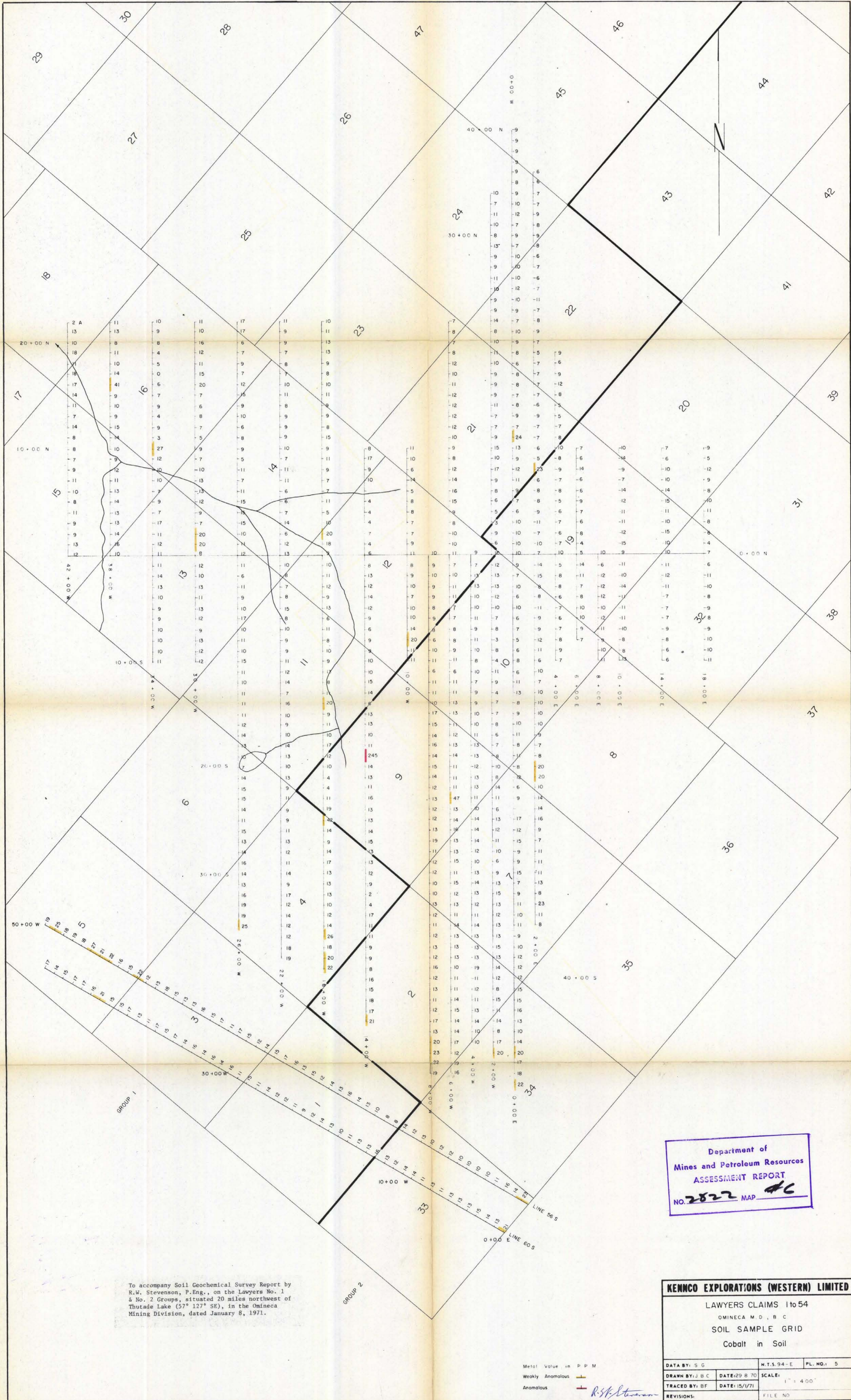

To accompany Soil Geochemical Survey Report by R.W. Stevenson, P.Eng., on the Lawyers No. 1 & No. 2 Groups, situated 20 miles northwest of Thutade Lake (57° 127' SE), in the Omineca Mining Division, dated January 8, 1971.

Department of
Mines and Petroleum Resources
ASSESSMENT REPORT
NO. 2822 MAP 46

KENNCO EXPLORATIONS (WESTERN) LIMITED			
LAWYERS CLAIMS 1 to 54			
OMINECA M.D. B.C.			
SOIL SAMPLE GRID			
Cobalt in Soil			
DATA BY: S.G.	M.T.S. 94-E	PL. NO. 1	5
DRAWN BY: J.B.C.	DATE: 29.8.70	SCALE:	1" = 400'
TRACED BY: B.F.	DATE: 15/1/71	REVISIONS:	FILE NO.

Metal Value in P.P.M.
Weakly Anomalous █
Anomalous █
R.W. Stevenson

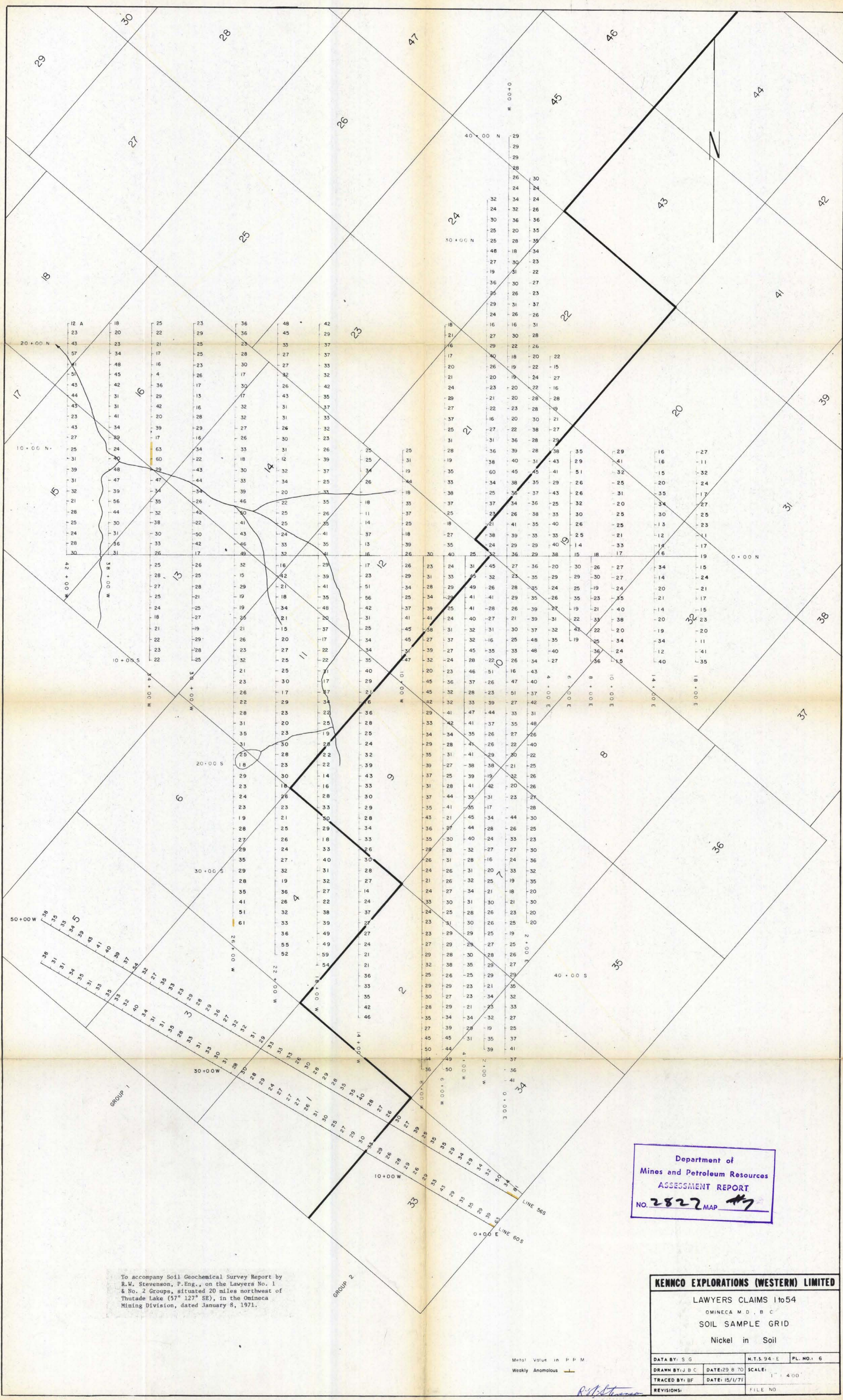

Department of
 Mines and Petroleum Resources
 ASSESSMENT REPORT
 NO. 2827 MAP #7

To accompany Soil Geochemical Survey Report by
 R.W. Stevenson, P.Eng., on the Layers No. 1
 & No. 2 Groups, situated 20 miles northwest of
 Thutade Lake (57° 127° SE), in the Omineca
 Mining Division, dated January 8, 1971.

KENNCO EXPLORATIONS (WESTERN) LIMITED			
LAWYERS CLAIMS 1 to 54			
OMINECA M. D. B. C.			
SOIL SAMPLE GRID			
Nickel in Soil			
DATA BY: S G	N.T.S. 94° E	PL. NO. 6	
DRAWN BY: J.B.C.	DATE: 29/8/70	SCALE: 1" = 400'	
TRACED BY: BF	DATE: 15/1/71	REVISIONS:	
FILE NO.			

Metal Value in P.P.M.
 Weakly Anomalous ---

R. Stevenson

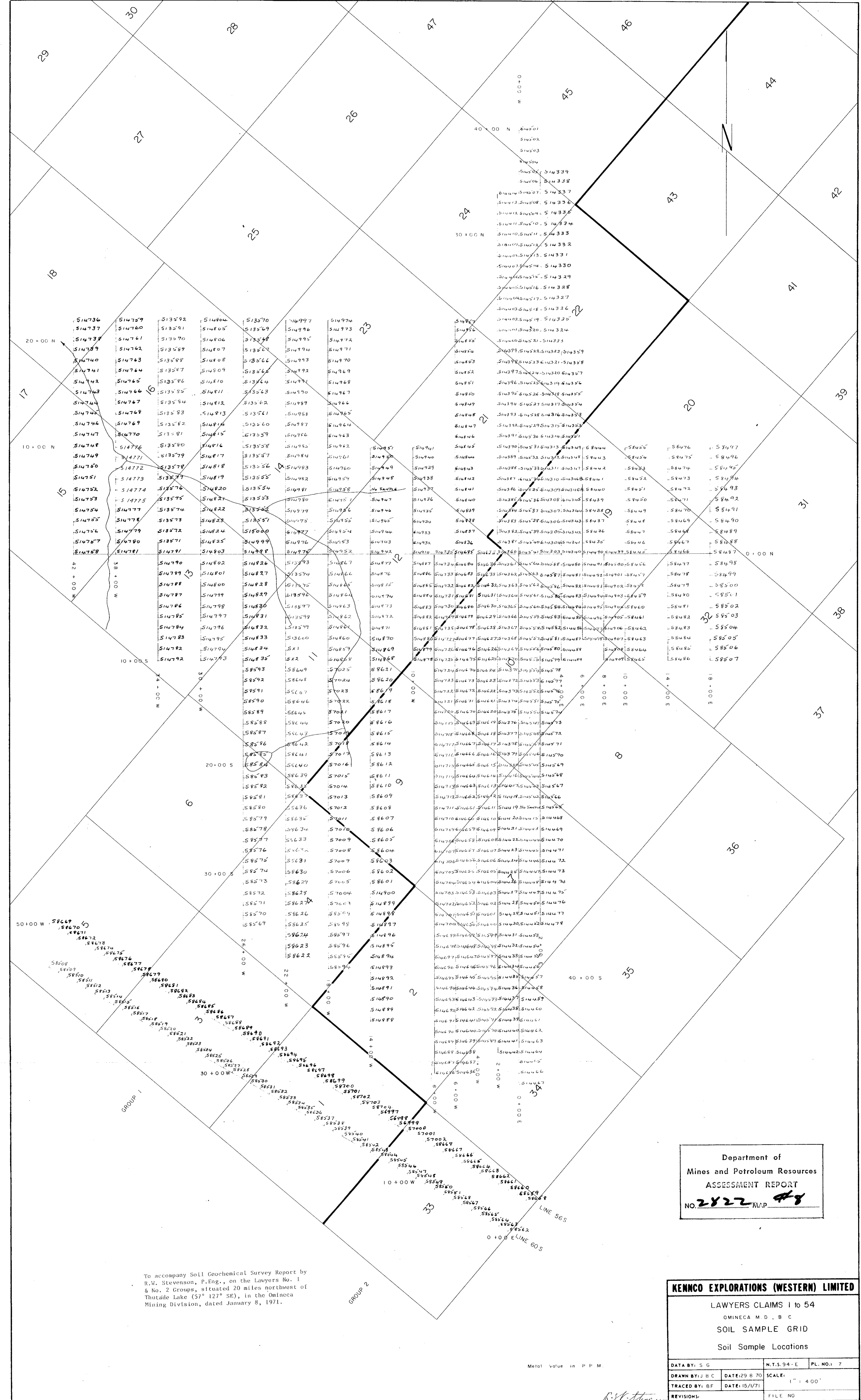

To accompany Soil Geochemical Survey Report by R.M. Stevenson, P.Eng., on the Lawyers No. 1 & No. 2 Groups, situated 20 miles northwest of Thutade Lake (57° 127' SE), in the Omneca Mining Division, dated January 8, 1971.

Department of
Mines and Petroleum Resources
ASSESSMENT REPORT
NO. 2822 MAP. #8

KENNCO EXPLORATIONS (WESTERN) LIMITED			
LAWYERS CLAIMS 1 to 54			
OMNECA M.D., B.C.			
SOIL SAMPLE GRID			
Soil Sample Locations			
DATA BY: SG	N.T.S. 94-E	PL. NO. 17	
DRAWN BY: JBC	DATE: 29 B 70	SCALE: 1" = 400'	
TRACED BY: BF	DATE: 15/1/71		
REVISIONS:		FILE NO.	

Metal value in PPM.

R.M. Stevenson