

LINE CUTTING REPORT

CLAIMS: DAWN

OWNER: MT. SICKER MINES LTD. (N.P.L.)

MINING DIVISION: VICTORIA

BY: J. E. BROOKS

WORK DONE: May 1-10, 1970

92B/13W

47167

PRESIDENT  
C. B. FIELD  
SEC.-TREAS.  
JOHN F. WOOD

DIRECTORS  
H. G. GRANT  
H. G. SOMMERS  
EARL HASTINGS  
A. W. WHITTINGHAM



# MOUNT SICKER

## MINES LTD. N.P.L.



P. O. BOX 576

VICTORIA, B.C.

TELEPHONE 382-4204

March 23, 1971.

The Mining Recorder,  
The Department of Mines And Petroleum Resources,  
The Douglas Building,  
Victoria, British Columbia.

Dear Sir:

The following is a statement of expences accrued during  
the line cutting carried out over the Dawn 1 & 2 mineral claims.

<u>Date</u>	<u>Name</u>	<u>Address</u>	<u>Rate per day</u>	<u>Total</u>
May 1, 1970	Jack E. Brooks	Duncan B. C.	\$25.00	\$25.00
May 2, 1970	" "	" "	" "	" "
May 3, 1970	" "	" "	" "	" "
May 4, 1970	" "	" "	" "	" "
May 5, 1970	" "	" "	" "	" "
May 6, 1970	" "	" "	" "	" "
May 7, 1970	" "	" "	" "	" "
May 8, 1970	" "	" "	" "	" "
May 10, 1970	" "	" "	" "	" "
				<u>Total \$225.00</u>

2914

*Jack E Brooks*  
Jack E. Brooks,  
Mine Superintendent,  
Mt. Sicker Mines Ltd., (npl)

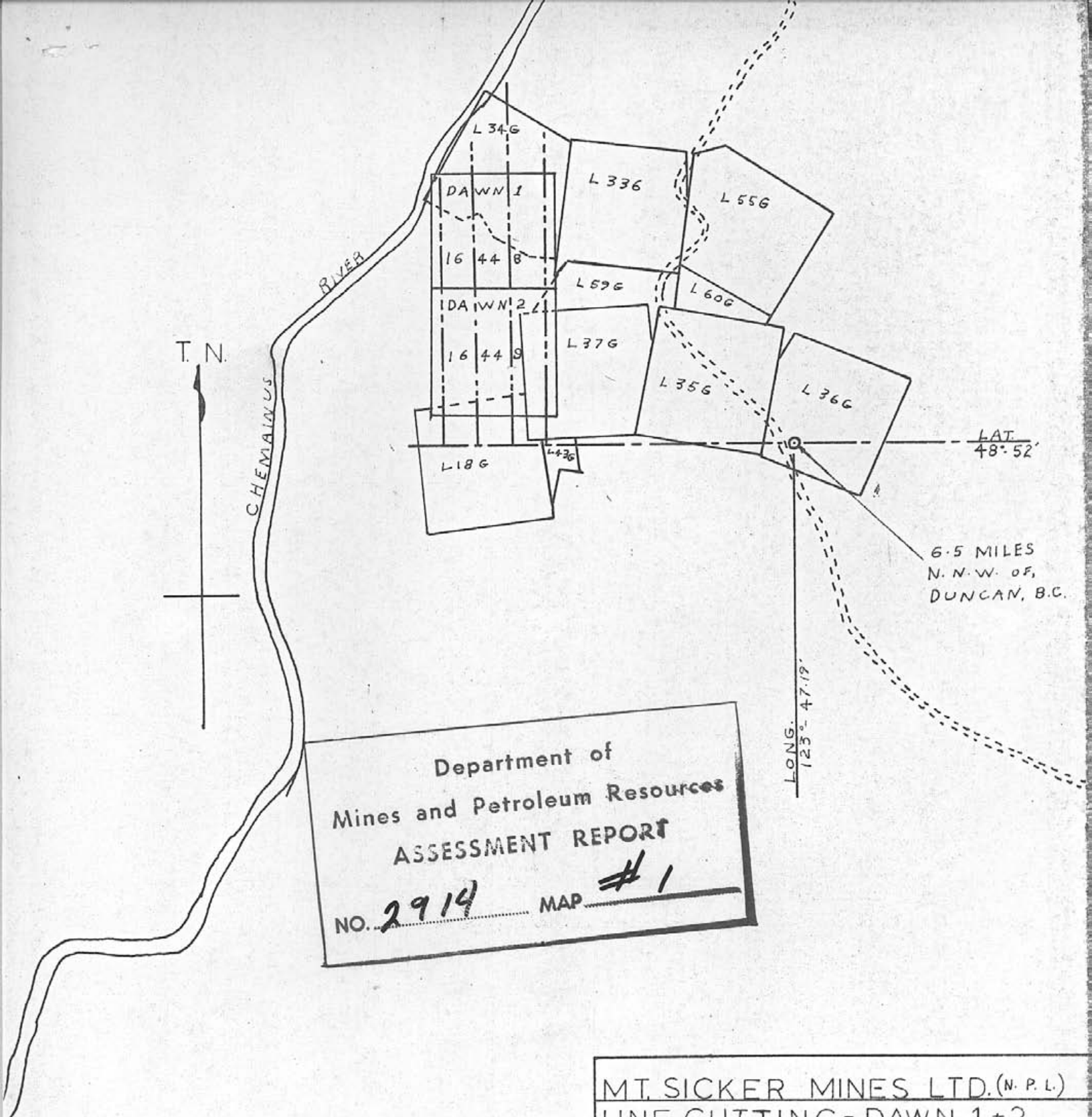

Department of  
Mines and Petroleum Resources  
ASSESSMENT REPORT  
NO. 2914 MAP #1

M.D - VICTORIA  
BY - J.E. BROOKS  
WORK DONE - MAY 1-10, 1970

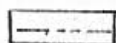
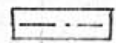
MT. SICKER MINES LTD. (N.P.L.)		
LINE CUTTING - DAWN 1 + 2		
For Geo-chem. 14,100'		
Legend.		
	Line cut	
	Base line	
Scale 1" = 1500'	20 MAR 1971	J & Brooks