

Line Cutting Report

Claims: BB

Owner : Vallex Mines Ltd.

M.D. : Cariboo

Work Done : Feb 12 - March 15/71

988/9E

3046

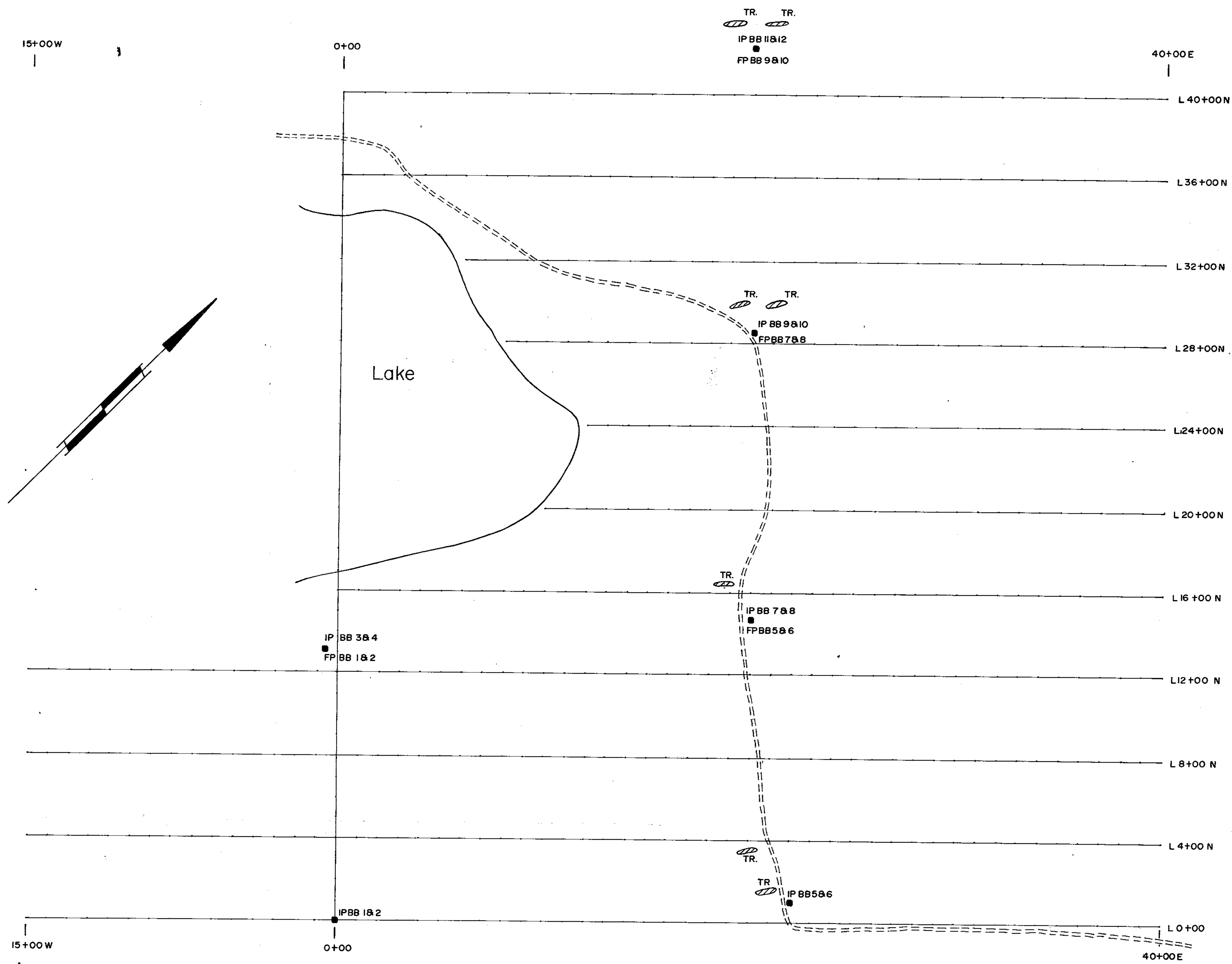

3046 M-1

Department of
Mines and Petroleum Resources
ASSESSMENT REPORT
NO. 3046 MAP #1

NOTE:-
● CLAIM POST --- ROAD
▨ TRENCH ○ LAKE
— CUT LINES & PICKET STATIONS

VALLEX MINES LTD (NPL)		
Line Cutting Plan		
BB Claims McLeese Lake Area Quesnel MD.		
Field Data Supplied by :- Tundra Holding Company		
MAY 1971	SCALE 1" = 300'	Dwg-dac