

LINE CUTTING REPORT

CLAIMS: ALAMO

OWNER: SAN JACINTO EXPLORATIONS LTD.

AUTHOR: D.A. CHAPMAN

WORK DONE: NOV. 1-14, 1970

MINING DIVISION: KAMLOOPS

92I/6E67W

3076

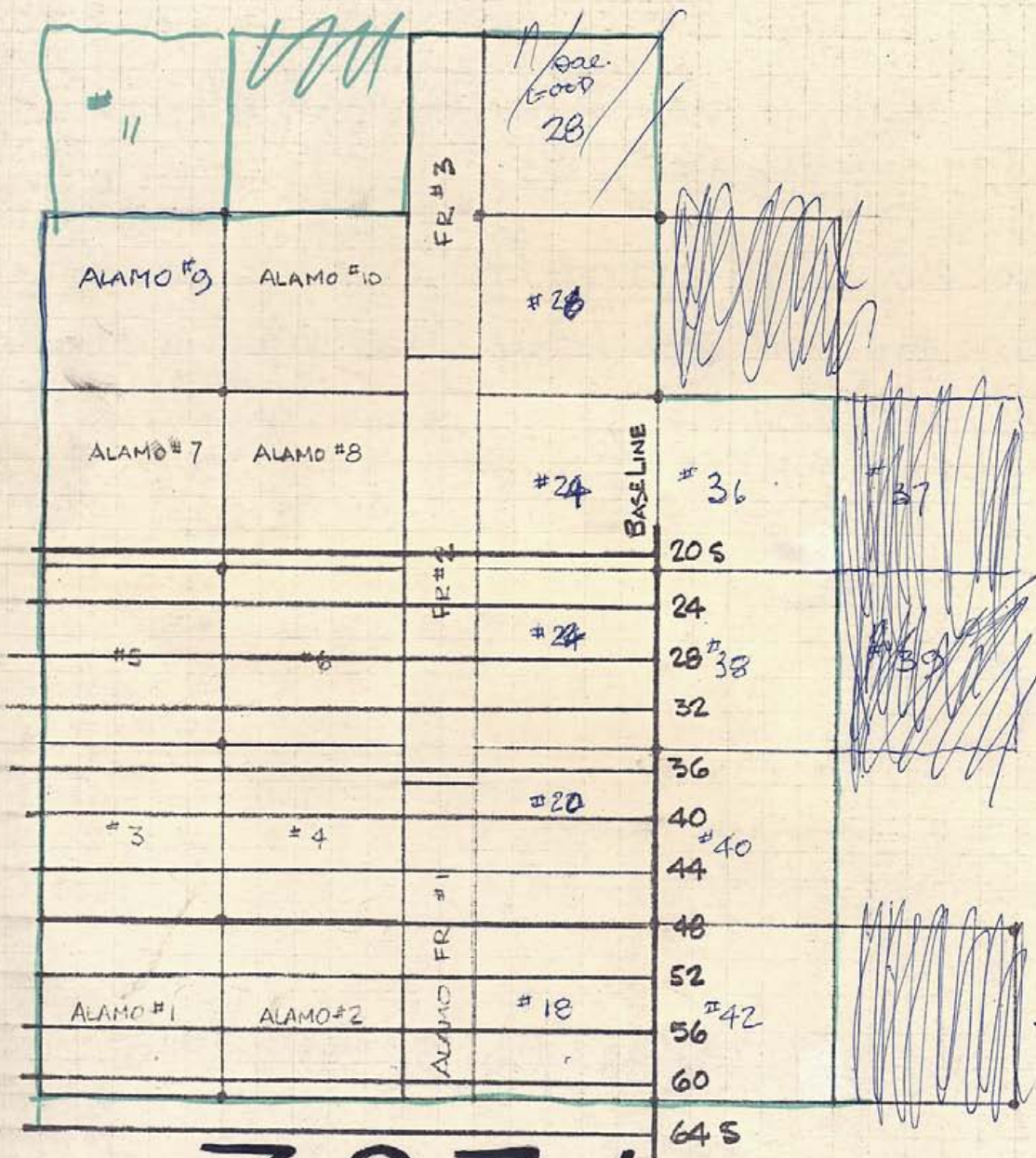

SKETCH OF IP GRID LINES CUT.

SAN JACINTO EXPLORATIONS LTD.
 ALAMO GROUP, KAMLOOPS MD.
 HIGHLAND VALLEY, B.C.
 SKUHUN CREEK AREA.

Type 3 linecutting
 All thick growth
 Lines cut 13' wide and to ground

R.A. Chapman

Department of
 Mines and Petroleum Resources
 ASSESSMENT REPORT
 MAP # 3076
 NO. 3076

3076 M-1

SKETCH SHOWING
LINE CUTTING LOCATION
STA 205 TO STA 645
ALAMO CLAIM GROUP
SAN JACINTO EXPLORATIONS LTD.
HIGHLAND VALLEY, KAMLOOPS B.C.

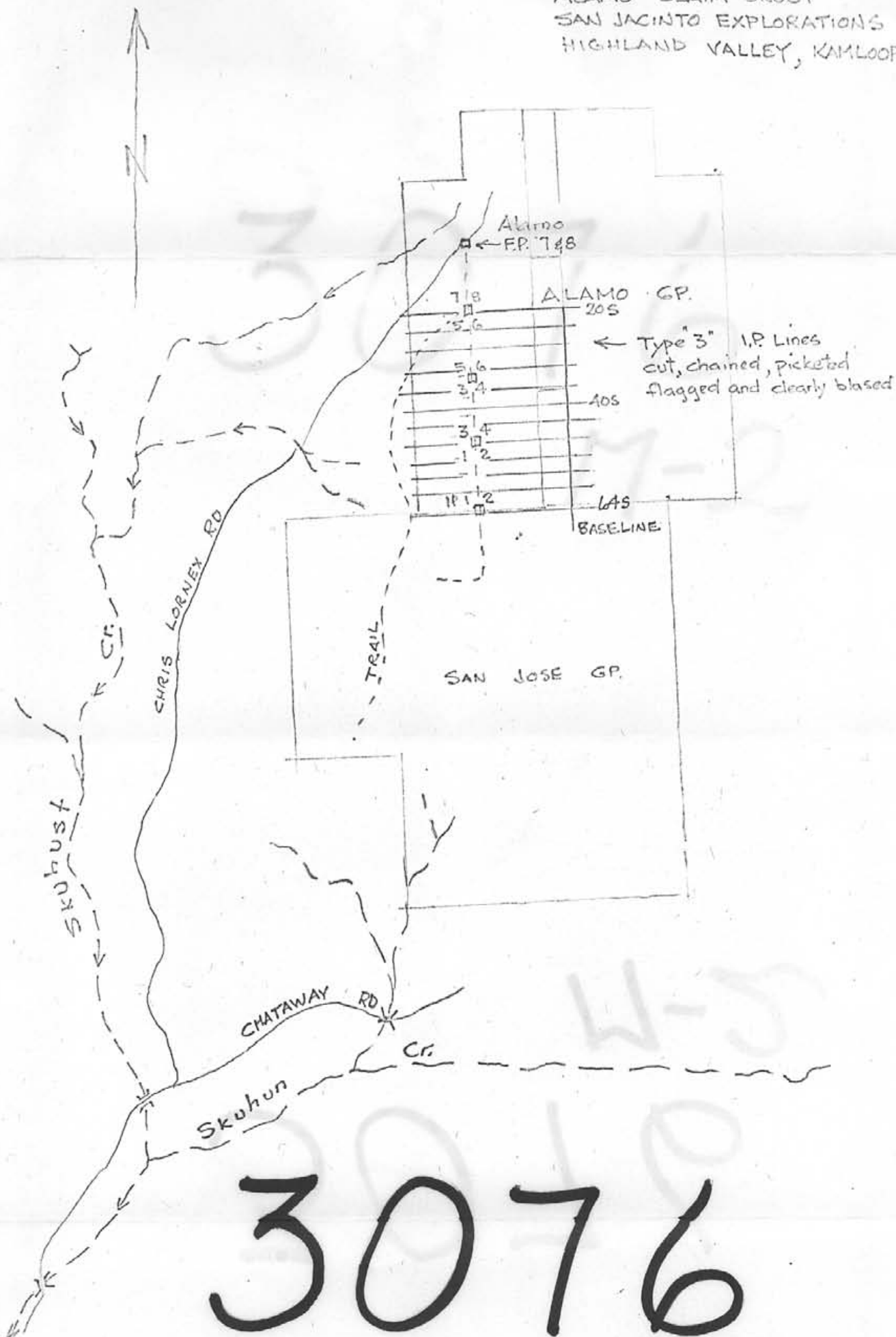

3076

M-2

Department of
Mines and Petroleum Resources
ASSESSMENT REPORT
No. 3076. MAP #2

D.A. CHAPMAN & ASSOCIATES LTD
3513 W 31ST VAN 8, B.C.
June 16, 1971

D.A. Chapman