

3285

COMINCO LTD.

EXPLORATION

N.T.S. 92 I/2

WESTERN DISTRICT

October 5, 1971

GEOCHEMICAL SURVEY ON THE S.B. GROUP

MERRITT AREA, NICOLA MINING DISTRICT

BRITISH COLUMBIA

Nicholas L. Szabo

Department of
Mines and Petroleum Resources
ASSESSMENT REPORT

NO. 3285 MAP.....

I N D E X

SUMMARY 1

INTRODUCTION 1

GEOCHEMICAL SURVEY 1

ATTACHMENTS following 2

C O M I N C O L T D.

EXPLORATION
N.T.S. 92 I/2

WESTERN DISTRICT
October 5, 1971

GEOCHEMICAL SURVEY ON THE S.B. GROUP

MERRITT AREA, NICOLA MINING DISTRICT

BRITISH COLUMBIA

SUMMARY

A total of 111 soil samples were collected on the four S.B. claims. Two anomalies were outlined by both the cxCu and hxCu content of soils. In view of the shallowness of overburden in the area and the size and magnitude of the anomalies the existence of significant sub-cropping mineralization seems unlikely.

INTRODUCTION

The S.B. Group consists of four claims staked during October of 1970 to cover a portion of a mineralized breccia in a stock in the Merritt area of British Columbia.

GEOLOGY

The S.B. Group is underlain by the Jesse Creek Stock believed to be of Jurassic age. The stock intrudes the volcanic rocks of the Upper Triassic Nicola Group, and is believed to be differentiated, varying inward from marginal quartz diorite to granodiorite.

GEOCHEMICAL SURVEY

The survey was performed by the writer and D.R. Bourne. Data on procedures is as follows.

SOIL SURVEY

A total of 111 samples were collected. Three of these samples were collected from the same pit at different depths to determine metal content variation versus depth. The variation was found to be non-significant. All other samples were collected from the Bh horizon at a depth between 6 and 8 inches. Lines were run east-west at 400' intervals with samples collected at 100 to 200' spacing along the lines. All lines were run with the aid of a Brunton compass and chain.

SAMPLE PREPARATION & ANALYSIS

All samples were first air dried and then sieved to -80 mesh. Analysis for hxCu and cxCu was done by atomic absorption, using a hot nitric acid attack for hxCu and an ammonium citrate - hydroxylamine hydrochloride buffer for cxCu analysis. The mean hxCu value was found to be 45 ppm with a standard deviation of 34.1, and for cxCu the mean was 0.54 with the standard deviation of 0.75. The data, however, was found to be log-normally distributed and a graphic solution gave the hxCu threshold as 72 ppm and cxCu threshold as 2 ppm.

DATA PRESENTATION

- Plate 1 Location Map 1" = 4 Miles
- Plate 2 Claim Map Showing S.B. Claims 1" = $\frac{1}{2}$ Mile
- Plate 3 hxCu Content of Soils 1" = 400'
- Plate 4 cxCu Content of Soils 1" = 400'

...continued...

Two anomalous areas were outlined by the soil survey. The hxCu anomalies are approximately 1200' by 200' and 1600' by 300' in their dimensions. Two single sample cxCu anomalies are coincident with the hxCu anomalies. The cxCu content of soils is between 0.8 and 2.5% of the total copper content. In view of the organic content of the Bh horizon sampled and in the generally shallow thickness of overburden in the area the adsorbed copper content of soils would be expected to be much higher if significant sub-cropping copper mineralization existed on the claims. The hxCu anomalies are small in magnitude as well as in dimensions and again in view of the shallow overburden conditions the size and magnitude of the anomalies makes the existence of sub-cropping mineralization unlikely.

Submitted by: N. L. Szabo
N.L. Szabo,
Geochemist

Endorsed for
release by: W.T. Irvine
W.T. Irvine, P. Eng.
Manager Exploration

DISTRIBUTION

Chief Geologist, Exploration (1)
Mining Recorder, Merritt (2)
Western District (2)
Geochemical File (1)
NLS

NLS/mjb

ATTACHMENT

- 1 Plate 1 Location Map 1" = 4 miles
 - 2 Plate 2 Claim Map Showing S.B. Claims. 1" = $\frac{1}{2}$ mile
 - 3 Plate 3 hxCu Content of Soils 1" = 400'
 - 4 Plate 4 cxCu Content of Soils 1" = 400'
- Exhibit A

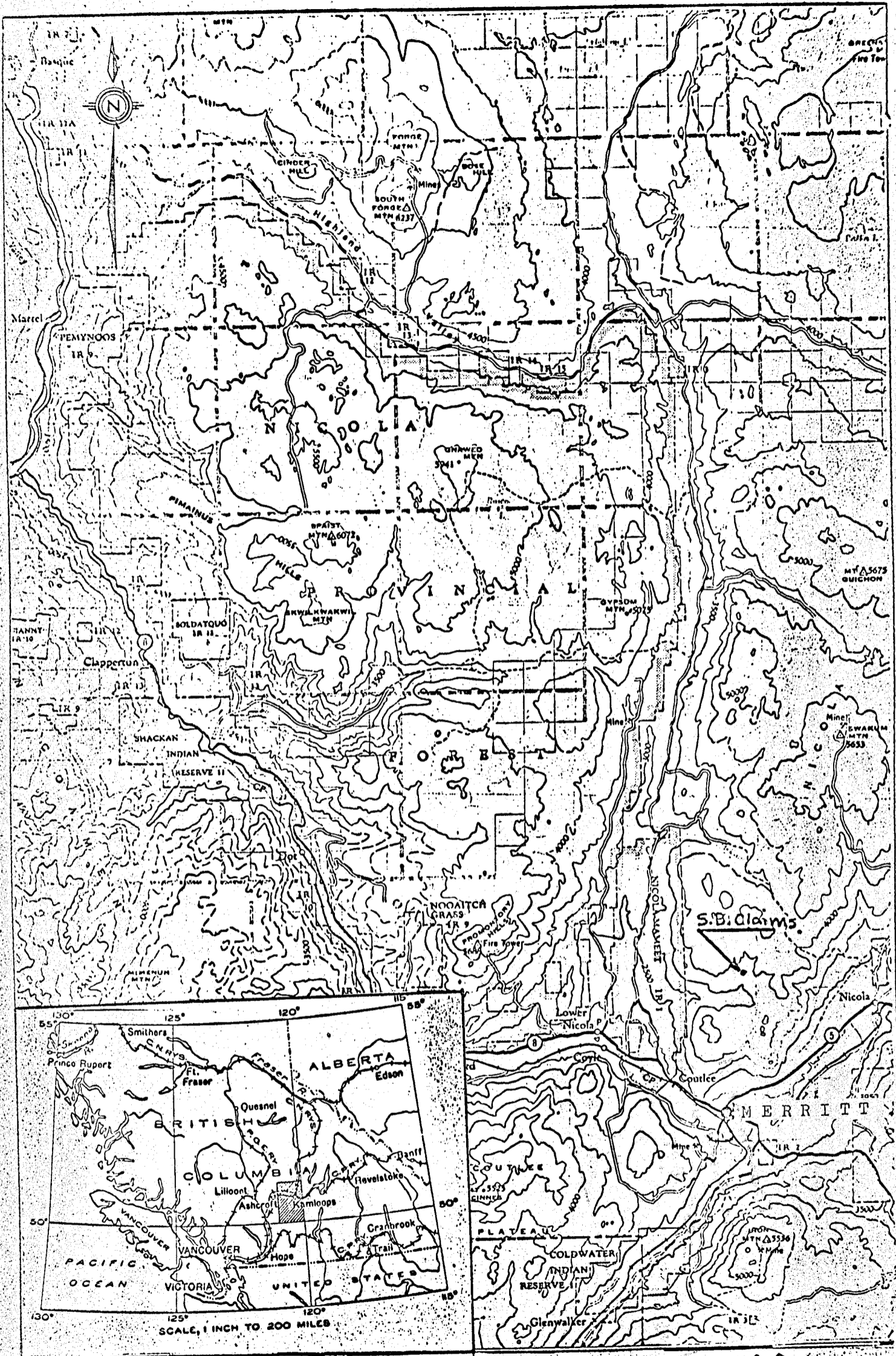

To Accompany a Report to be Submitted by N.L. Szabo

N.L. Szabo Comingo

Drawn by:	Traced by:
Revised by: _____ Date: _____	Revised by: _____ Date: _____

LOCATION MAP

Scale: 1" = 4 miles Date: Oct. 6, 1971 Plate: 1

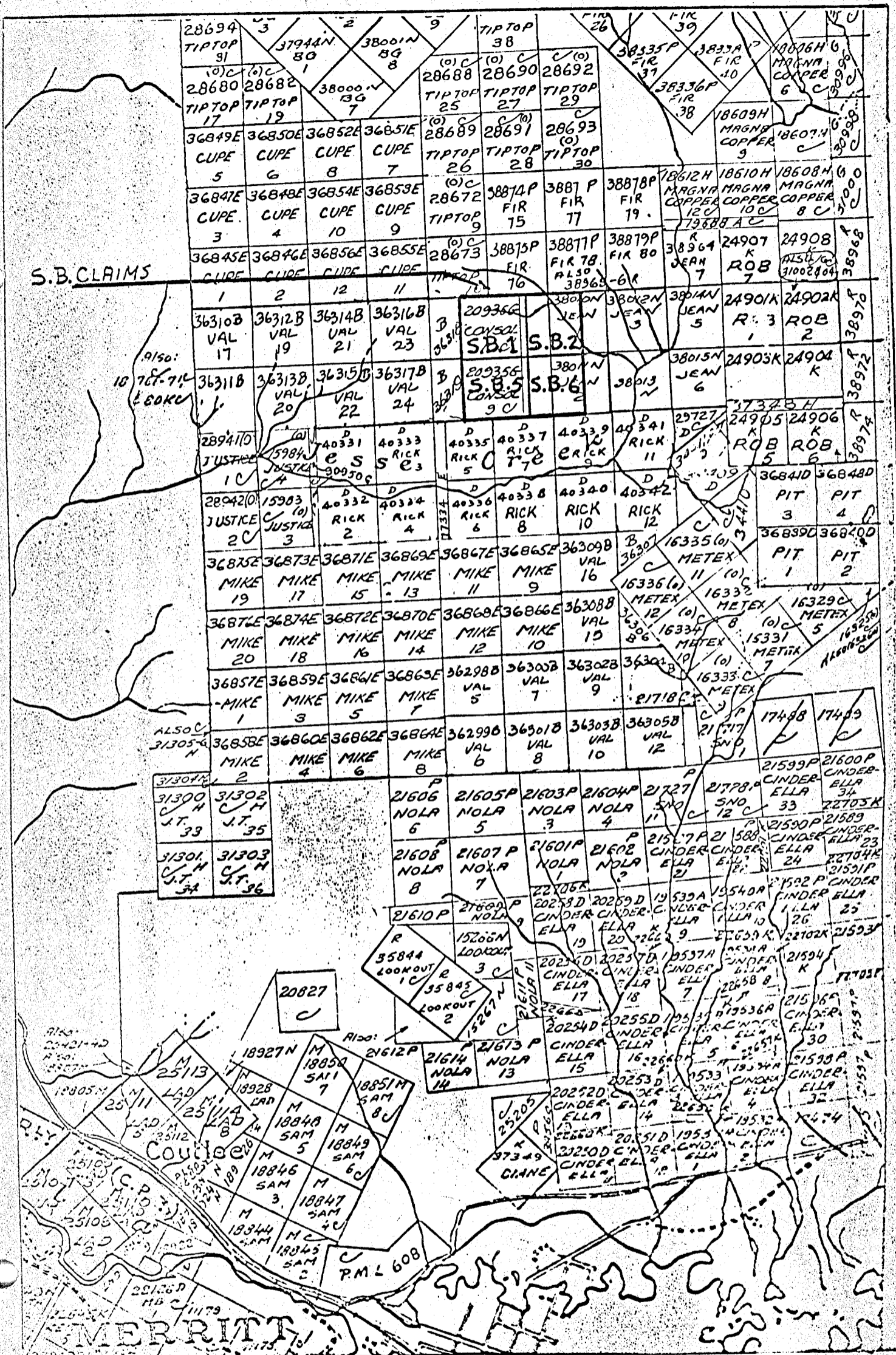

S.B. CLAIMS

CLAIM MAP
S.B. CLAIMS

To Accompany a Report to be Submitted by N.L. Szabo *N & Szabo*



Drawn by:	Financed by:
Revised by:	Date:
Revised by:	Date:
Revised by:	Date:
Revised by:	Date:

Scale: 1" = 1/2 mile Date: Oct. 6, 1971 Plate: 2

DOMINION OF CANADA:

PROVINCE OF BRITISH COLUMBIA.

To Wit:

In the Matter of

Statutory Declaration Relating
To Expenditures on the Geochemical
Survey on the S.G. Group, Nicola
Mining Division.

I, NICHOLAS LOUIS SZABO

of City of VANCOUVER

in the Province of British Columbia, do solemnly declare that

1. Copies of a report regarding a geochemical survey on certain mineral claims situated in the Nicola Mining Division are being filed with the Mining Recorder in Vancouver.
2. Attached hereto, and marked with the letter "A" upon which I have signed my name at the time of declaring hereof, is a Statement of Expenditures incurred in connection with the geochemical survey of the said claims showing in addition the period during which those making the said survey performed their work.

And I make this solemn declaration conscientiously believing it to be true, and knowing that it is of the same force and effect as if made under oath and by virtue of the "Canada Evidence Act."

Declared before me at the City
of Vancouver, in the
Province of British Columbia, this 12
day of October, 1971, A.D.

Nicholas L Szabo

Jill Turner
A Commissioner for taking Affidavits within British Columbia or
A Notary Public in and for the Province of British Columbia.
Sub-mining Recorder

C O M I N C O L T D.

EXPLORATION
N.T.S. 92 1/2

WESTERN DISTRICT
October 5, 1971

EXHIBIT "A"

COST OF GEOCHEMICAL SURVEY

S.B. CLAIMS, MERRITT AREA, NICOLA

MINING DISTRICT, BRITISH COLUMBIA

Wages (6 man days)	\$180.00
Food	\$ 50.00
Motel	\$ 24.00
Analyses	\$181.00
Truck Rental	\$ 69.16
Report	\$ 42.00
Drafting	\$ 15.00
	<hr/>
	\$561.16
	<hr/>

Sampling and sample analyses were done in the months of August and September, 1971.

Signed: Nicholas L Szabo
Nicholas L. Szabo

This is Exhibit "A" to the Statutory Declaration of Nicholas L. Szabo declared before me this 12 day of October 1971.

Jim Turner
A Commissioner for taking Affi-
savits for British Columbia
Sub-mining Recorder

COMINCO LTD.

EXPLORATION

WESTERN DISTRICT

STATEMENT OF QUALIFICATIONS

N. L. Szabo was responsible for conducting the geochemical survey described herein. Mr. Szabo has received his M.Sc. from the University of Connecticut and expects to receive his Ph.D. in the coming academic year from the University of New Brunswick. He has worked with the New Brunswick Mines Branch and the Geological Survey of Canada, and I consider him a competent and experienced geochemist.

Signed:

J. Richardson.
J. Richardson, P. Eng.

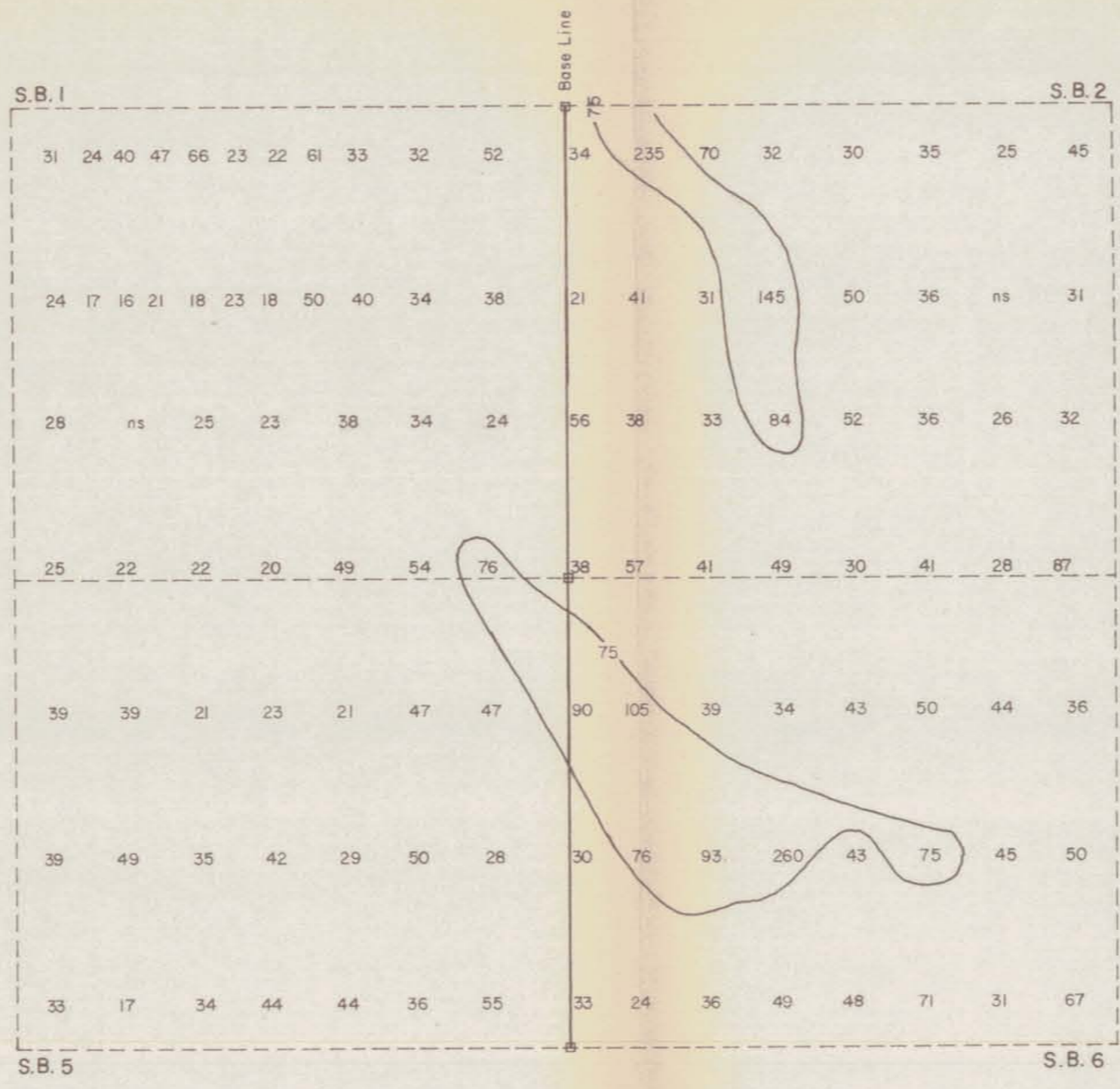

Department of
 Mines and Petroleum Resources
 ASSESSMENT REPORT
 NO. **3285** MAP # **3**

To Accompany a Report to be Submitted by N.L. Szabo *N.L. Szabo*



Drawn by:	Traced by: T.G.B.
Revised by: _____ Date: _____	Revised by: _____ Date: _____

S.B. GROUP
h x Cu content of soils

Scale: 1" = 400' Date: Sept 13, 1971 Plate: 3

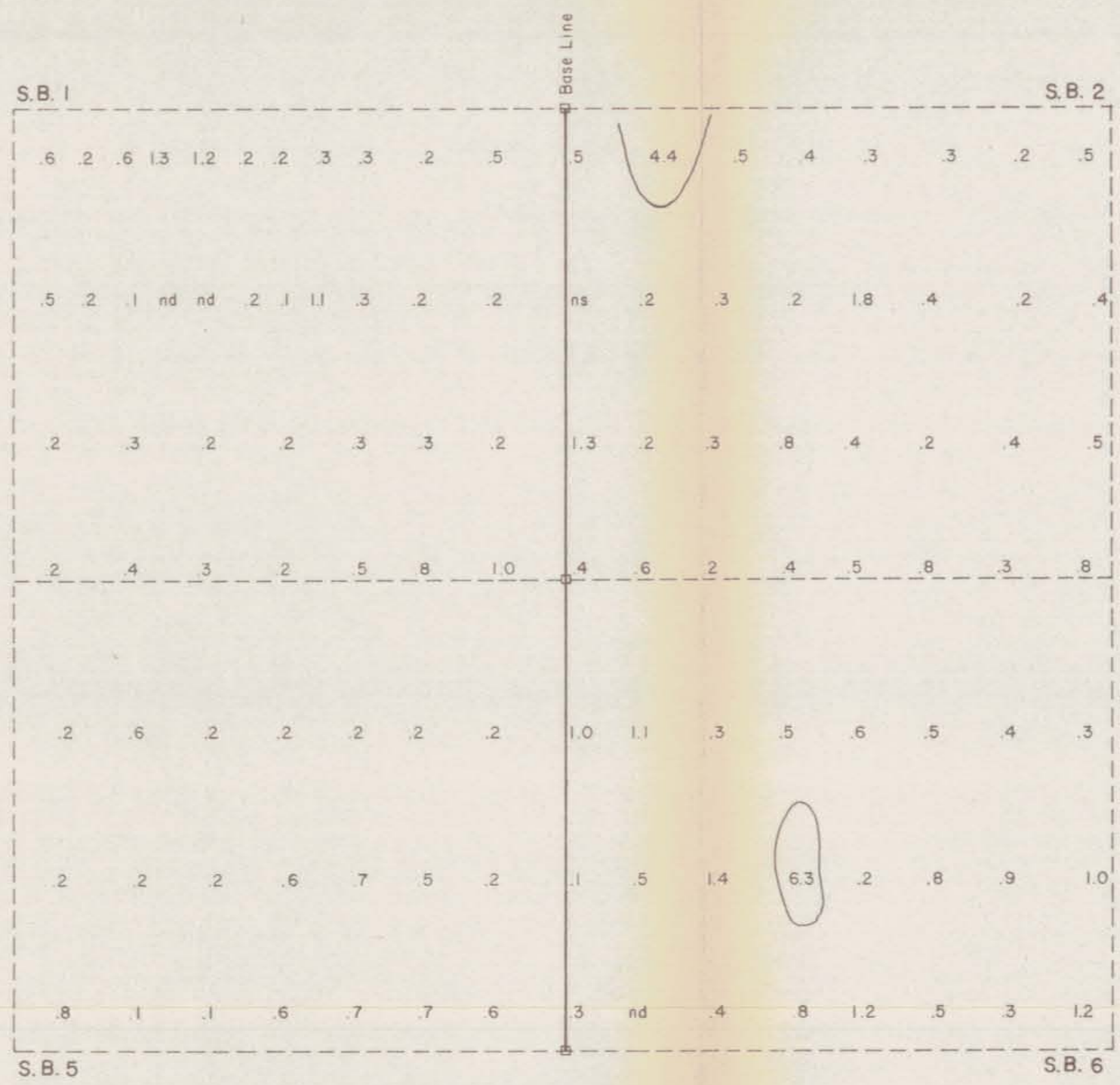

Department of
 Mines and Petroleum Resources
ASSESSMENT REPORT
 NO. 3285 MAP #4

To Accompany a Report to be Submitted by N.L. Szabo *N.L. Szabo*

Drawn by:		Traced by: T.G.B.		S.B. GROUP c x Cu content of soils
Revised by	Date	Revised by	Date	
Scale: 1" = 400'		Date: September 13, 1971		Plate: 4

