

3364

A GEOCHEMICAL REPORT

on the

KOR GROUP OF MINERAL CLAIMS

Princeton Area, British Columbia

Similkameen Mining Division

Latitude 49°31' North

Longitude 120°25' West

92 H / 9W

Including:

KOR 1-12 - Record Nos. 29182-93

KOR 13-20 - Record Nos. 29672-79

by

E. O. CHISHOLM, M.A., P.ENG.

November 15, 1971

Registered Owner of Claims:

NICANEX MINES LTD. (N.P.L.)

Work Performed By:

J. Todd, 642 Clark Drive, Vancouver, B.C.

P. Egan, 607-475 Howe St., Vancouver, B.C.

Department of
Mines and Petroleum Resources
ASSESSMENT REPORT

NO. _____ MAP _____

Department of
 Mines and Petroleum Resources
 ASSESSMENT REPORT
 NO. 3364 MAP #1

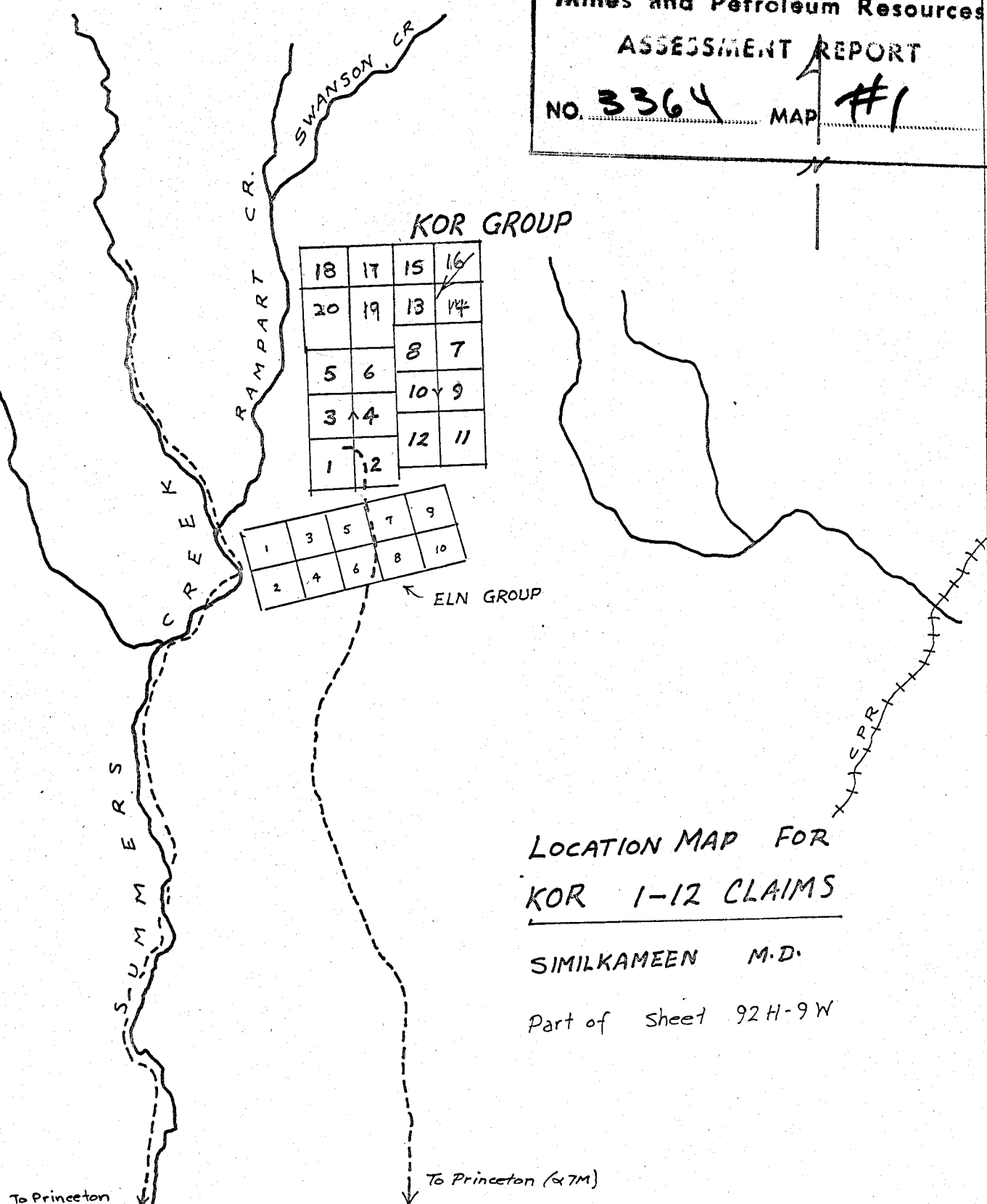

KOR GROUP

18	17	15	16
20	19	13	14
5	6	8	7
3	4	10	9
1	12	12	11

ELN GROUP

1	3	5	7	9
2	4	6	8	10

LOCATION MAP FOR
 KOR 1-12 CLAIMS

SIMILKAMEEN M.D.

Part of Sheet 92H-9W

To Princeton

To Princeton (x7M)

TABLE OF CONTENTS

	<u>Page No.</u>
SUMMARY.....	1
LIST OF CLAIMS.....	1
LOCATION AND ACCESS.....	2
TOPOGRAPHY.....	2
GEOLOGY.....	2
GEOCHEMICAL SURVEY.....	3
DISCUSSION OF RESULTS.....	4
SUMMARY OF COSTS.....	5
SUPPORTING AFFIDAVIT.....	6
LIST OF PERSONNEL.....	7

MAPS

1	Location Map	Front
2	Geochemical Survey (Fig. 1)	Pocket
3	(Fig. 4)	"

S U M M A R Y

During September 1971 a geochemical survey was carried out by Nippon Mining of Canada Ltd. on the Kor Group of claims near Princeton on behalf of Nicanex Mines Ltd., the registered owners of the claim group. A grid consisting of 18 miles of picket lines was sampled at 200 foot intervals on lines spaced 400 feet apart. Claims covered by the survey were Kor 1 to 20, as shown on the attached plans. Samples were assayed for copper by Crest Laboratories (B.C.) Ltd., a commercial assay laboratory located at 1068 Homer Street, Vancouver, B.C., using the atomic absorption method. No significant geochemical anomalies were found.

L I S T O F C L A I M S

<u>Claim Name</u>	<u>Record Number</u>
Kor 1 - 12	29182 - 29193
Kor 13 - 20	29672 - 29 79

R E F E R E N C E M A P S

1. G.S.C. Map 888A, Princeton, B.C. - 4 Mile Geology
2. N.T.S. Sheet 92H; Hope, B.C. - 4 Mile Topography

LOCATION AND ACCESS

The mining claims under discussion are located 8 miles northeast of Princeton, British Columbia, at approximate Latitude $49^{\circ}31'$ North, Longitude $120^{\circ}25'$ West. Access may be obtained to the group by motor car from the main road connecting Princeton to Jura, B.C.

TOPOGRAPHY

The topography is moderate with vegetation covered slopes and open swampy valleys. Most of the area can be traversed by foot. There is sufficient talus to facilitate road building. A dense forest cover is present and less than 5% of rock is exposed. The overburden in most cases appears to be light and can be removed by shallow trenching generally. The elevation and topography will allow year-round exploration to be carried out.

GEOLOGY

The claims are underlain by Tertiary intrusives of pink and grey granite and granodiorite of the Otter Lake group and mixed border phase andesites of the Triassic Nicola Group. A contact between the two rock types is exposed on the northeast corner of the claim group. The group itself appears to lie on the contact of these two rock types. This is inferred from float boulders and almost 100% of the group is covered by glacial boulder clays.

Glacial Deposits:

Glacial deposits cover the entire claim group. They form eskers on outwash ridges with pebble to cobble sized gravels. Swamp and bog occupies the river and stream valleys between the ridges.

Structural Features:

A broad linear feature follows northward valleys of Rampart and Christian Creeks that may represent parallel lineaments to the Albian Creek fault structure to the northwest.

Mineralization:

Disseminated pyrite is found in flood boulders of Nicola conglomerate and granitized equivalents throughout the group. Sparse chalcopyrite and bornite were noted in narrow quartz veins in one such boulder located on the southwest corner of Kor No.2 Claim.

G E O C H E M I C A L S U R V E Y

A geochemical survey was carried out on a 400 foot grid across the claim group totalling approximately 18 line miles of work (Fig. 1). Samples were taken at 200 foot intervals at 6 inches below surface on east/west flagged

lines off a main north/south base line. In some areas the "B" horizon was not present and the "A" horizon was sampled. Samples were placed in heavy Kraft envelopes and shipped to Crést Laboratories (B.C.) Ltd., a Vancouver commercial laboratory where they were assayed by atomic absorption techniques. This process includes drying the samples, screening to -80 mesh, digesting in perchloric acid and analysing for copper content by atomic absorption spectrometry. The results are shown in Figure 1.

DISCUSSION OF RESULTS

The background value for copper in the surveyed area is 10 to 20 parts per million. Threshold values were taken to be 40 to 50 parts per million and anomalous values above 100 parts per million. Only 4 samples of the 500 taken reported in the anomalous range and do not appear to be related to any significant adjacent assay values. These probably represent erratics from glacial material.

It is concluded that the soil survey does not represent any significant concentrations of copper values on the claim group.

Respectfully submitted,



E. O. Chisholm, P.Eng.

APPENDIX I

SUMMARY OF COSTS

Linecutting and Sampling	\$ 1,600.00
Geochemical analyses	683.00
Equipment Rental	209.52
Geologist	280.00
Report and Drafting	180.00
	<hr/>
TOTAL	\$ 2,952.52
	<hr/> <hr/>

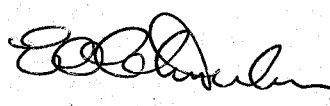
Declared before me at the *City*
of *Nanaimo*, in the
Province of British Columbia, this *22nd*
day of *Nov* *1971*, A.D. 

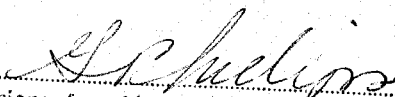
A Commissioner for taking Affidavits within British Columbia or
A Notary Public in and for the Province of British Columbia.

Sub-mining Recorder

APPENDIX II

AFFIDAVIT SUPPORTING SUMMARY OF COSTS

I, Edward O. Chisholm, Consulting Geologist
of 821-602 West Hastings Street, Vancouver 2, B. C.,
do hereby state that to the best of my knowledge and
belief, the statement of costs presented in Appendix I
of this report is both true and correct.

DATED AT VANCOUVER THIS 15th DAY OF NOVEMBER, 1971

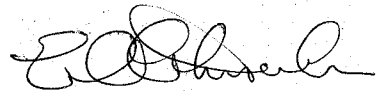

Edward O. Chisholm, P.Eng.



Witness

APPENDIX III

PERSONNEL

James Todd	Party Chief	642 Clark Drive, Vancouver, B.C.
Pat Egan	Sampler	607-475 Howe Street, Vancouver, B.C.
K. Shuto	Geologist	607-475 Howe Street, Vancouver, B.C.



Department of
 Mines and Petroleum Resources
 ASSESSMENT REPORT
 NO. 5369 MAP 43

KOR GROUP

Similkameen Mining Division
 Nicanex Mining
 (EICA)

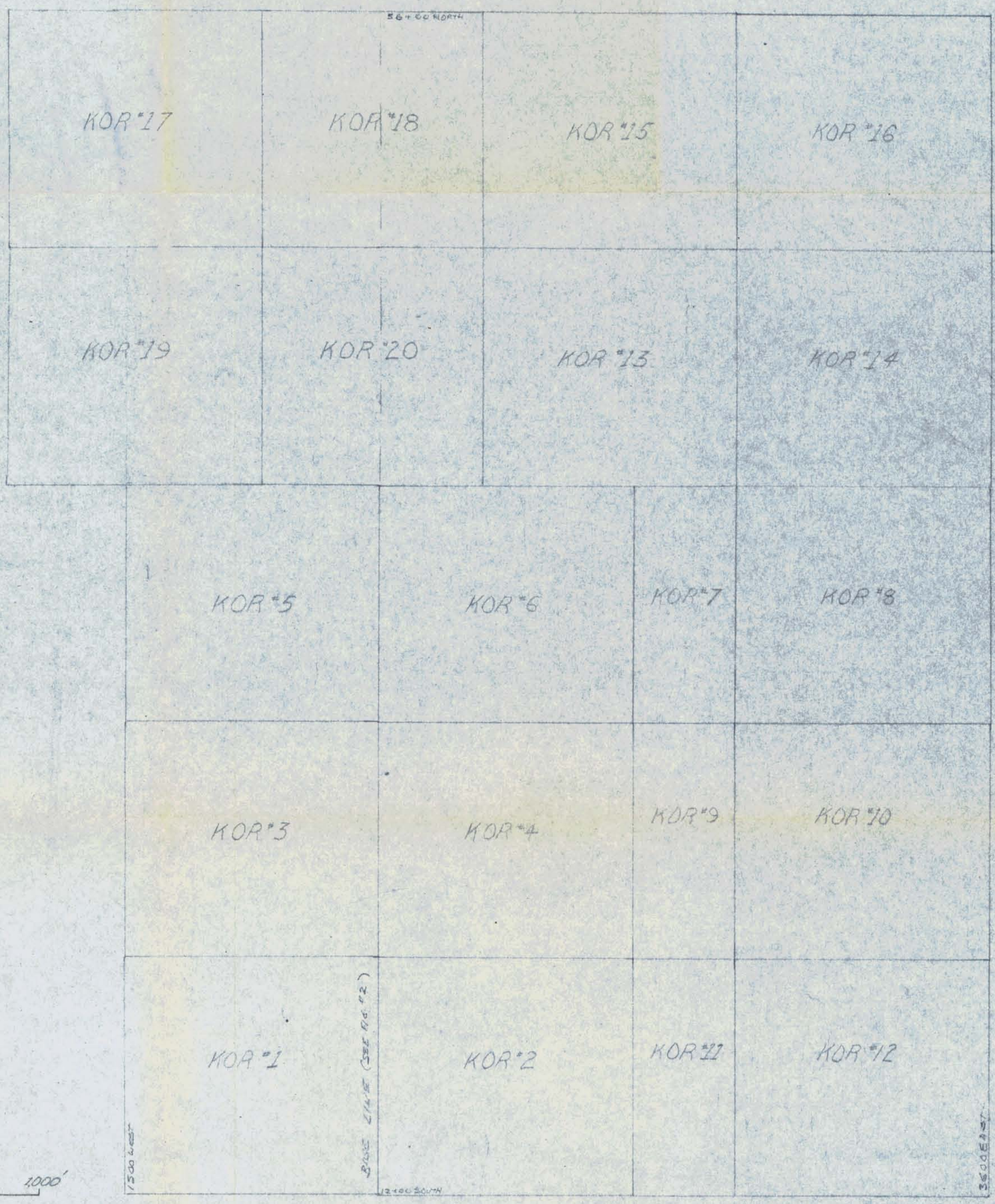

[Handwritten signature]

Department of
Mines and Petroleum Resources
ASSESSMENT REPORT
NO. 3364 MAP #2

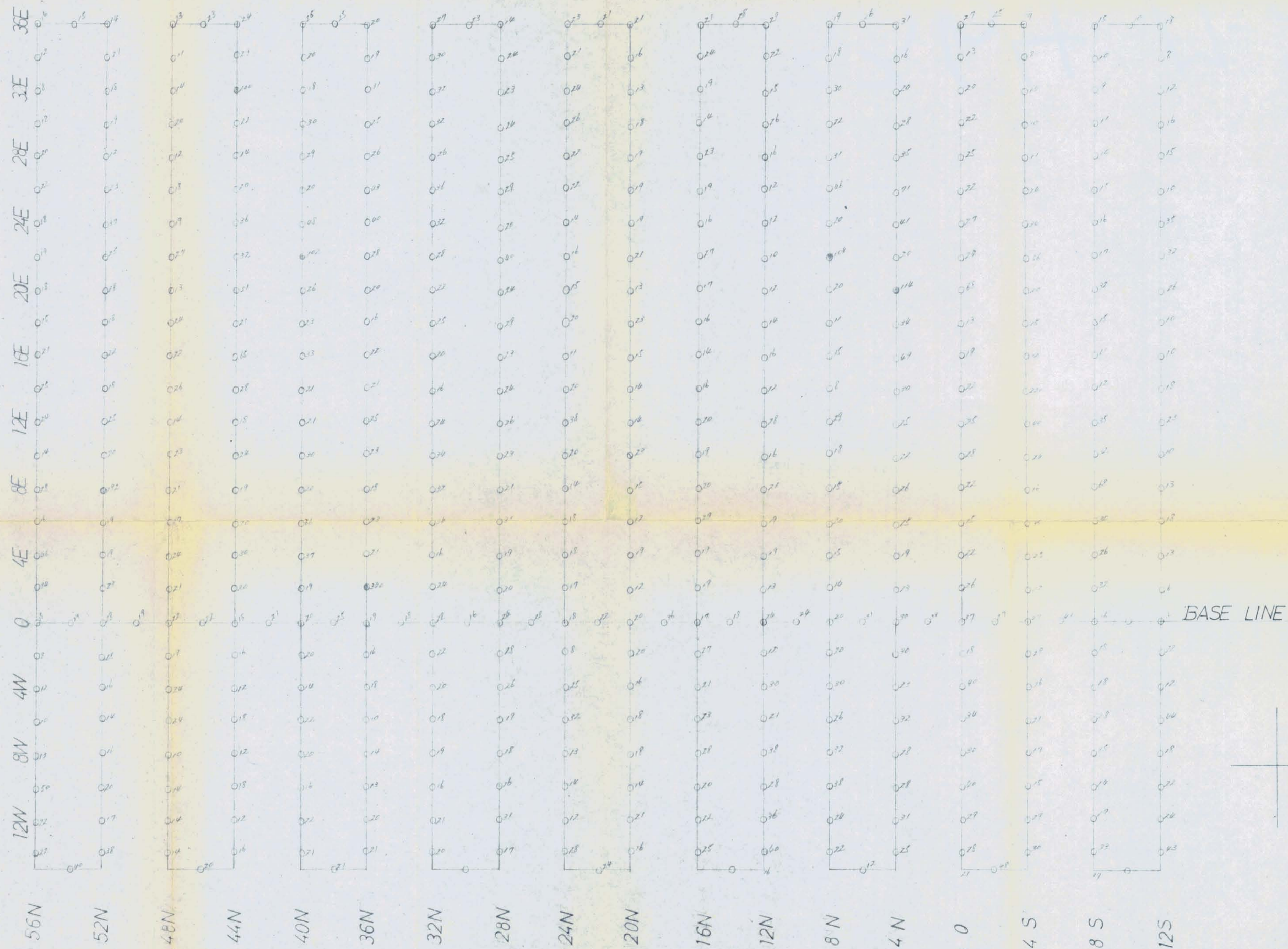

3364 M-2

Date Oct. 20. 1971

GEOCHEMICAL SURVEY (TOTAL COPPER P.P.M.)

KOR GROUP
Similkameen Mining Division

Scale: 1 inch = 400 feet (FIG 1)