

S. RADVAK ENGINEERING LTD.
PROFESSIONAL MINING ENGINEERS

216-470 GRANVILLE ST.
VANCOUVER 1, B.C.
TELEPHONE 681-4020

GEOCHEMICAL SURVEY REPORT

ON

THE HK, NB AND BM GROUP OF CLAIMS

NB 1 - 30 Record Nos. 67031-67060

HK 11 - 16 Record Nos. 73800-73803

HIGHLAND VALLEY

50°, 121°

Owner: Highland Star Mines Ltd. [NPL]

Work by: Radvak Engineering Ltd.

Work Dates: October 12 - 25, 1971

3377

November 12, 1971

Vancouver, B. C.

Department of
Mines and Petroleum Resources
ASSESSMENT REPORT

NO. 3377 MAP

S. RADVAK ENGINEERING LTD.
PROFESSIONAL MINING ENGINEERS

216-470 GRANVILLE ST.
VANCOUVER 1, B.C.
TELEPHONE 681-4020

TABLE OF CONTENTS

	<u>Page</u>
INTRODUCTION	1
LOCATION	2
WORK PROGRAMME	2
GEOLOGY	3
COSTS	3
DISCUSSION OF RESULTS	4
RECOMMENDED PROGRAMME	4
CONCLUSIONS	5

GEOCHEMICAL SURVEY MAPS

Copper Molybdenum

- 1 Claim Map
- 2 Copper in ppm
- 3 Molybdenum in ppm

S. RADVAK ENGINEERING LTD.
PROFESSIONAL MINING ENGINEERS

216-470 GRANVILLE ST.
VANCOUVER 1, B.C.
TELEPHONE 681-4020

GEOCHEMICAL SURVEY REPORT

ON

THE HK [HK 11-16 & NB 17-30] GROUP,
THE MB [NB 1-12] AND THE BM [NB 13-16]
GROUP OF CLAIMS

INTRODUCTION:

Highland Star Mines Ltd. [NPL], formerly known as "Little Pine Tex Mining Corp. Ltd. [NPL]" owns 36 claims in the Highland Valley of British Columbia.

Radvak Engineering was requested by Mr. M. Campbell to initiate the first phase of the exploration programme as recommended by MacDonald Consultants.

PROPERTY:

The property consists of 36 claims which are separated into three different groups due to lack of continuity. Six additional claims were staked to make the group contiguous.

NB Group	NB 1 - 12	12 claims
HK Group	HK 11 - 16] NB 17 - 30]	20 claims
BM Group	NB 13 - 16	4 claims

S. RADVAK ENGINEERING LTD.
PROFESSIONAL MINING ENGINEERS

216-470 GRANVILLE ST.
VANCOUVER 1, B.C.
TELEPHONE 681-4020

LOCATION:

The property is located in the Skwilkwakwil Mountain area approximately eleven miles southeast of Spences Bridge, B. C., Kamloops Mining Division.

Access to the southerly group is along Skuk^{hun} Creek, while access to the northern group is by Pimainus Lake.

WORK PROGRAMME:

The work consisted of flagging lines by pacing the distances using a brunton. Samples were taken every four to five hundred feet along the lines. The three base lines were measured out.

The claim location lines were used as base lines. Some of the claims were short so that soil sample lines were put at 400-foot centres rather than at 500-foot centres.

The work programme was carried out from October 12th to October 25th, 1971.

Mr. H. H. Shear, P. Eng., of Greenwood, B. C., supervised the programme in the field, assisted by Messrs. George F. Cressy and Gary McPherson of Merritt, B. C.

S. RADVAK ENGINEERING LTD.
PROFESSIONAL MINING ENGINEERS

216-470 GRANVILLE ST.
VANCOUVER 1, B.C.
TELEPHONE 681-4020

The samples were taken using an auger and the samples were sent to T.S.L. Laboratory in Vancouver for assaying for copper and molybdenum.

A total of 346 samples were taken on the 36 claims involved.

GEOLOGY:

A high percentage of rock outcrops occur on the NB 9-12, NB 23-30 and NB 35-36 claims. These rocks have been mapped by Mr. K.S. Northcote in his recent and comprehensive study of the Highland Valley as the Chataway variety. Granodiorite is the principal rock type and was the only type noted during the sampling programme.

Costs: [October 15 - 25, 1971]

H.H. Shear, P. Eng. - 10 days @ \$100/day	\$1,000.00
Gary McPherson - 9 days @ 60/day	540.00
George F. Cressy - 8 days @ 60/day	480.00
Room and Meals	200.00
Truck Rental 10 x \$35.00	350.00
Assaying	636.40
Drafting	120.00
Engineering - S. Radvak [Oct. 12,13,25,26,27]	500.00
	<hr/>
	\$3,826.40
	<hr/>

S. RADVAK ENGINEERING LTD.
PROFESSIONAL MINING ENGINEERS

216-470 GRANVILLE ST.
VANCOUVER 1, B.C.
TELEPHONE 681-4020

DISCUSSION OF RESULTS:

The geochemical survey outlined several interesting anomalies.

The soil background for copper is approximately 33 parts per million so that any readings over 100 have to be considered anomalous.

Group HK [NB 17 - NB 30] + [HK 11 - HK - 16]

anomalies outlined:

Claims NB 26-28	800 feet by 1,300 feet
Claims NB 20, 21 & 22	700 feet by 1,400 feet

Group NB [NB 1-12]:

Claims NB 2 & NB 4	400 feet by 2,000 feet
Claims NB 9 & NB 10	1,000 feet by 1,600 feet

No anomalous area was outlined in Group BN [NB 13 - NB 16]. The molybdenum results were almost negative through the whole property.

RECOMMENDED PROGRAMME:

The main area of interest is NB 9 and 10 where a good anomaly has been outlined.

S. RADVAK ENGINEERING LTD.
PROFESSIONAL MINING ENGINEERS

216-470 GRANVILLE ST.
VANCOUVER 1, B.C.
TELEPHONE 681-4020

The second area of interest has to be NB 20 and
22.

As soon as the snow is off the ground, a percussion
drilling programme at 500 foot centres should be initiated.

Costs:

Phase I:

Mapping	\$ 4,000.00
3,000 feet @ 4¢/foot	12,000.00
Assaying - 300 x \$4.00	1,200.00
Engineering and Supervision for two months	<u>3,000.00</u>
	<u>\$20,200.00</u>

Phase II:

This phase should consist of percussion drilling
and diamond drilling depending on the results of Phase I.

CONCLUSIONS:

The initial geochemical soil survey is encouraging.
A percussion drilling programme should be initiated as soon
as the weather permits.

Respectfully submitted,

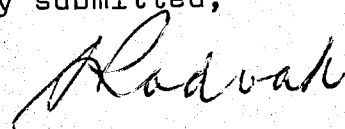
S. Radvak, P. Eng.

ASSAYERS
CHEMISTS
GEOCHEMISTS



CORE LABORATORIES - CANADA LTD.

325 Howe Street Vancouver 1, B.C. Phone 688-3504

CHARGE TO

HIGHALND STAR MINES
470 Vienna Cres.
North Vancouver, B.C.

INVOICE NUMBER

C 785

SHIPPED TO:

DATE:	REFERENCE NO.:		YOUR ORDER NO.:	
Oct. 29, 1971.	SHIPPED:	V10743 VIA:	TERMS: NET 30 DAYS	UNIT PRICE
				TOTAL
	347 3 No Samples 344 Soil Samples for Cu and Mo + Sample prep.			\$1.85
				\$636.40

INVOICE

ASSAYERS
CHEMISTS
GEOCHEMISTS



CORE LABORATORIES - CANADA LTD.

325 Howe Street Vancouver 1, B.C. Phone 688-3504

SAMPLE(S) FROM
HIGHLAND STAR MINES

Certificate of Analysis

REPORT NO.

V 10743

SAMPLE(S) OF SOILS

Sample No.	Cu ppm	Mo ppm
115N 10W	32	<1
15	N.S.	N.S.
115N OE	N.S.	N.S.
5	79	<1
10	33	<1
15	N.S.	N.S.
120N 5W	60	<1
10	43	<1
15	28	<1
120N OE	60	<1
5	64	<1
10	76	<1
15	47	<1
125N 5W	44	<1
10	38	<1
15	22	<1
125N OE	52	<1
5	22	<1
10	23	<1
15	31	<1
130N 5W	21	<1
10	127	<1
15	18	<1
130N OE	39	<1
5	62	<1
10	35	<1
15	37	<1

HOT PERCHLORIC ACID EXTRACTION
DETERMINED BY A.A.

DATE Oct. 29, 1971.

SIGNED

PULP AND REJECTS DISCARDED AFTER 3 MONTHS

ASSAYERS
CHEMISTS
GEOCHEMISTS



CORE LABORATORIES - CANADA LTD.

325 Howe Street Vancouver 1, B.C. Phone 688-3504

SAMPLE(S) FROM
HIGHLAND STAR MINES

Certificate of Analysis

REPORT NO.

V 10743

SAMPLE(S) OF SOILS

Sample No.	Cu ppm	Mo ppm
75N OE	65	<1
5	48	<1
10	39	<1
15	45	<1
80N 5W	44	<1
10	31	<1
15	50	<1
80N OE	54	<1
5	51	<1
10	37	<1
15	57	<1
85N 5W	43	<1
10	28	<1
15	70	<1
85N OE	57	<1
5	53	<1
10	120	<1
15	64	<1
90N 5W	90	<1
10	49	<1
15	44	<1
90N OE	33	<1
5	70	<1
10	124	<1
15	58	<1
105N 5W	84	<1
10	60	<1
15	39	<1
105N OE	27	<1
5	44	<1
10	44	<1
15	41	<1
110N 5W	39	<1
10	22	<1
15	13	<1
110N OE	56	<1
5	32	<1
10	32	<1
15	13	<1
115N 5W	31	<1

DATE Oct. 29, 1971.

SIGNED R. A. Stollart

PULP AND REJECTS DISCARDED AFTER 3 MONTHS

ASSAYERS
CHEMISTS
GEOCHEMISTS



CORE LABORATORIES - CANADA LTD.

325 Howe Street Vancouver 1, B.C. Phone 688-3504

SAMPLE(S) FROM
HIGHLAND STAR MINES

Certificate of Analysis

REPORT NO.

V 10743

SAMPLE(S) OF SOILS

Sample No.	Cu ppm	Mo ppm
45N 35E	43	<1
50N 5W	42	<1
10	108	<1
15	47	<1
50N OE	63	<1
5	56	<1
10	35	<1
15	32	<1
55N 5W	48	<1
10	105	<1
15	42	<1
55N OE	83	<1
5	57	<1
10	46	<1
15	10	<1
60N 5W	52	<1
10	95	<1
15	43	<1
60N OE	130	<1
5	200	<1
10	184	<1
15	38	<1
20	55	<1
65N 5W	65	<1
10	79	<1
15	58	<1
65N OE	110	<1
5	107	<1
10	35	<1
15	61	<1
70N 5W	35	<1
10	120	<1
15	61	<1
70N OE	134	<1
5	26	<1
10	16	<1
15	44	<1
75N 5W	149	<1
10	36	<1
15	43	<1

DATE Oct. 29, 1971.

SIGNED

PULP AND REJECTS DISCARDED AFTER 3 MONTHS

ASSAYERS
CHEMISTS
GEOCHEMISTS



CORE LABORATORIES - CANADA LTD.

325 Howe Street Vancouver 1, B.C. Phone 688-3504

SAMPLE(S) FROM
HIGHLAND STAR MINES

Certificate of Analysis

REPORT NO.

V 10743

SAMPLE(S) OF SOILS

Sample No.	Cu ppm	Mo ppm
L2ON 10W	50	<1
15	48	<1
2ON OE	62	<1
5	46	<1
10	78	<1
15	99	<1
L25N 5W	41	<1
10	64	<1
15	98	<1
25N OE	66	<1
5	47	<1
10	55	<1
15	16	1
L3ON 5W	48	<1
10	42	<1
15	89	<1
3ON OE	140	<1
5	47	<1
10	66	<1
15	35	<1
L35N 5W	94	<1
10	60	<1
15	59	<1
35N OE	108	<1
5	26	<1
10	71	<1
15	50	<1
L4ON 5W	102	<1
10	105	<1
15	58	<1
4ON OE	64	<1
5	39	<1
10	46	<1
15	70	<1
45N 5W	55	<1
10	81	<1
15	64	<1
45N OE	58	<1
5	60	<1
10	31	<1

DATE Oct. 29, 1971.

SIGNED

PULP AND REJECTS DISCARDED AFTER 3 MONTHS

ASSAYERS
CHEMISTS
GEOCHEMISTS



CORE LABORATORIES - CANADA LTD.

325 Howe Street Vancouver 1, B.C. Phone 688-3504

SAMPLE(S) FROM
HIGHLAND STAR MINES

Certificate of Analysis

REPORT NO.

V 10743

SAMPLE(S) OF SOILS

Sample No.	Cu ppm	Mo ppm
65E 45S	12	<1
50	11	<1
55	29	<1
60	59	<1
70E 30S	67	1
35	36	<1
40	29	1
45	46	<1
50	19	<1
55	33	<1
60	25	<1
ON OE	59	1
5	67	<1
10	238	<1
15	58	<1
ON 5W	81	1
10	55	<1
15	55	<1
5N 5W	55	<1
10	126	<1
15	55	<1
5N OE	82	<1
5	47	<1
10	289	<1
15	83	<1
10N 5W	46	<1
10	38	<1
15	31	<1
10N OE	58	<1
5	39	<1
10	42	<1
15	276	1
15N 5W	49	<1
10	49	<1
15	49	<1
15N OE	49	<1
5	48	<1
10	65	<1
15	71	1
12ON 5W	71	<1

DATE

Oct. 29, 1971.

SIGNED

PULP AND REJECTS DISCARDED AFTER 3 MONTHS

ASSAYERS
CHEMISTS
GEOCHEMISTS



CORE LABORATORIES - CANADA LTD.

325 Howe Street Vancouver 1, B.C. Phone 688-3504

SAMPLE(S) FROM
HIGHLAND STAR MINES

Certificate of Analysis

REPORT NO.

V 10743

SAMPLE(S) OF SOILS

Sample No.	Cu ppm	Mo ppm
L4OE 20S	27	1
25	14	1
30	71	<1
35	29	<1
40	96	1
45	22	1
50	19	1
55	21	<1
60	17	<1
L45E 30S	22	1
35	48	1
40	22	<1
45	55	1
50	25	1
55	37	<1
60	18	<1
50E 30S	47	<1
35	73	<1
40	55	<1
45	45	1
50	21	<1
55	18	1
60	29	1
55E 30S	45	1
35	53	<1
40	37	<1
45	44	1
50	19	1
55	24	<1
60	24	1
60E 30S	200	<1
35	39	<1
40	65	1
45	42	1
50	54	<1
55	45	<1
60	120	<1
65E 30S	47	1
35	41	1
40	49	<1

DATE Oct. 29, 1971.

SIGNED

PULP AND REJECTS DISCARDED AFTER 3 MONTHS

ASSAYERS
CHEMISTS
GEOCHEMISTS



CORE LABORATORIES - CANADA LTD.

325 Howe Street Vancouver 1, B.C. Phone 688-3504

SAMPLE(S) FROM
HIGHLAND STAR MINES

Certificate of Analysis

REPORT NO.

V 10743

SAMPLE(S) OF SOILS

Sample No.	Cu ppm	Mo ppm
L25E 15S	77	<1
20	22	<1
25	31	<1
30	51	<1
35	59	<1
40	41	<1
45	38	<1
50	30	<1
55	22	<1
60	33	<1
L3OE OS	30	<1
5	49	1
10	34	<1
15	52	<1
20	28	<1
25	36	<1
30	31	1
35	49	<1
40	41	<1
45	25	<1
50	400	<1
55	35	<1
60	31	<1
L35E OS	38	<1
5	33	<1
10	51	1
15	30	<1
20	23	<1
25	42	<1
30	48	<1
35	39	<1
40	52	<1
45	52	<1
50	31	<1
55	29	<1
60	18	<1
L4OE OS	71	<1
5	56	<1
10	48	<1
15	118	<1

DATE Oct. 29, 1971.

SIGNED

PULP AND REJECTS DISCARDED AFTER 3 MONTHS

ASSAYERS
CHEMISTS
GEOCHEMISTS



CORE LABORATORIES - CANADA LTD.

325 Howe Street Vancouver 1, B.C. Phone 688-3504

SAMPLE(S) FROM
HIGHLAND STAR MINES

Certificate of Analysis

REPORT NO.

V 10743

SAMPLE(S) OF SOILS

Sample No.	Cu ppm	Mo ppm
30W 25S	19	<1
30	39	<1
LOE OS	38	<1
5	103	1
10	75	<1
15	66	<1
20	41	1
25	30	<1
30	54	<1
L 5E OS	53	<1
5	87	<1
10	50	<1
15	43	<1
20	38	<1
25	48	<1
30	16	<1
L10E OS	64	<1
5	36	<1
10	138	<1
15	123	1
20	43	<1
25	40	<1
30	35	<1
L15E OS	37	<1
5	81	<1
10	60	<1
15	179	<1
20	42	<1
25	84	<1
30	34	<1
L20E OS	55	<1
5	60	1
10	138	<1
15	38	<1
20	18	<1
25	39	<1
30	42	<1
L25E OS	48	<1
5	75	<1
10	70	<1

DATE Oct. 29, 1971.

SIGNED

PULP AND REJECTS DISCARDED AFTER 3 MONTHS

ASSAYERS
CHEMISTS
GEOCHEMISTS



CORE LABORATORIES - CANADA LTD.

325 Howe Street Vancouver 1, B.C. Phone 688-3504

SAMPLE(S) FROM
HIGHLAND STAR MINES
cc/S. RADVAK

Certificate of Analysis

REPORT NO.

V 10743

SAMPLE(S) OF SOILS

Sample No.	Cu ppm	Mo ppm
L5W OS	13	<1
5	51	1
10	70	<1
15	68	<1
20	55	1
25	120	<1
30	71	<1
L10W OS	60	<1
5	108	<1
10	81	1
15	56	<1
20	27	<1
25	55	<1
30	54	1
L15W 0	64	<1
5	52	<1
10	52	<1
15	66	<1
20	62	<1
25	27	<1
30	34	1
L 20W OS	38	<1
5	190	1
10	79	<1
15	80	<1
20	62	1
25	100	<1
30	29	1
25W OS	64	1
5	130	<1
10	183	<1
15	63	<1
20	119	<1
25	35	<1
30	44	<1
30W OS	44	<1
5	60	<1
10	31	<1
15	67	<1
20	59	1

DATE Oct. 29, 1971.

SIGNED

PULP AND REJECTS DISCARDED AFTER 3 MONTHS

NO. 3377

MAP

#1

Department of
Mines and Petroleum Resources
ASSESSMENT REPORT

N.B. 1-36

O.C. area

H.K. 11-16

3377 M-1



SURVEYED AREA

FEET 1000

SCALE
0

4,400

FEET

PIMAINUS L.

Skuhun

Creek

Skuhost Creek

SKWILKWAKWIL
MT.

RADVAK ENGINEERING LTD.

LITTLE PINE TEX MINING CORP LTD. (N.P.L.)

(HIGHLAND CHIEF)

INDEX MAP

S. RADVAK ENGINEERING LTD.
PROFESSIONAL MINING ENGINEERS

216-470 GRANVILLE ST.
VANCOUVER 1, B.C.
TELEPHONE 681-4020

November 29, 1971

Gold Commissioner,
Victoria, B. C.

Dear Sir:

Re: Highland Star Property

The soil samples were taken from the gray
["C"] zone.

The location map requested is included.

Yours truly,

S. Radvak

13340

SR/LA

S. Radvak

FILE 166 - Kamloops

NOV 30 '71 AM

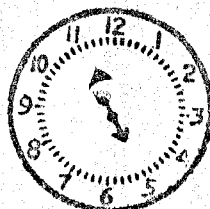

DEPT. OF MINES
AND PETROLEUM RESOURCES

REFERRED TO	DATE	INITIAL
D.M.		
C.G.C.		
C.C.		
D.C.G.C.		
D.C.C.		
ACCTS.		
C.M.B.		
C.I.		
C.A.		
R. T.		
C.P.E.		
FILING CLERK		

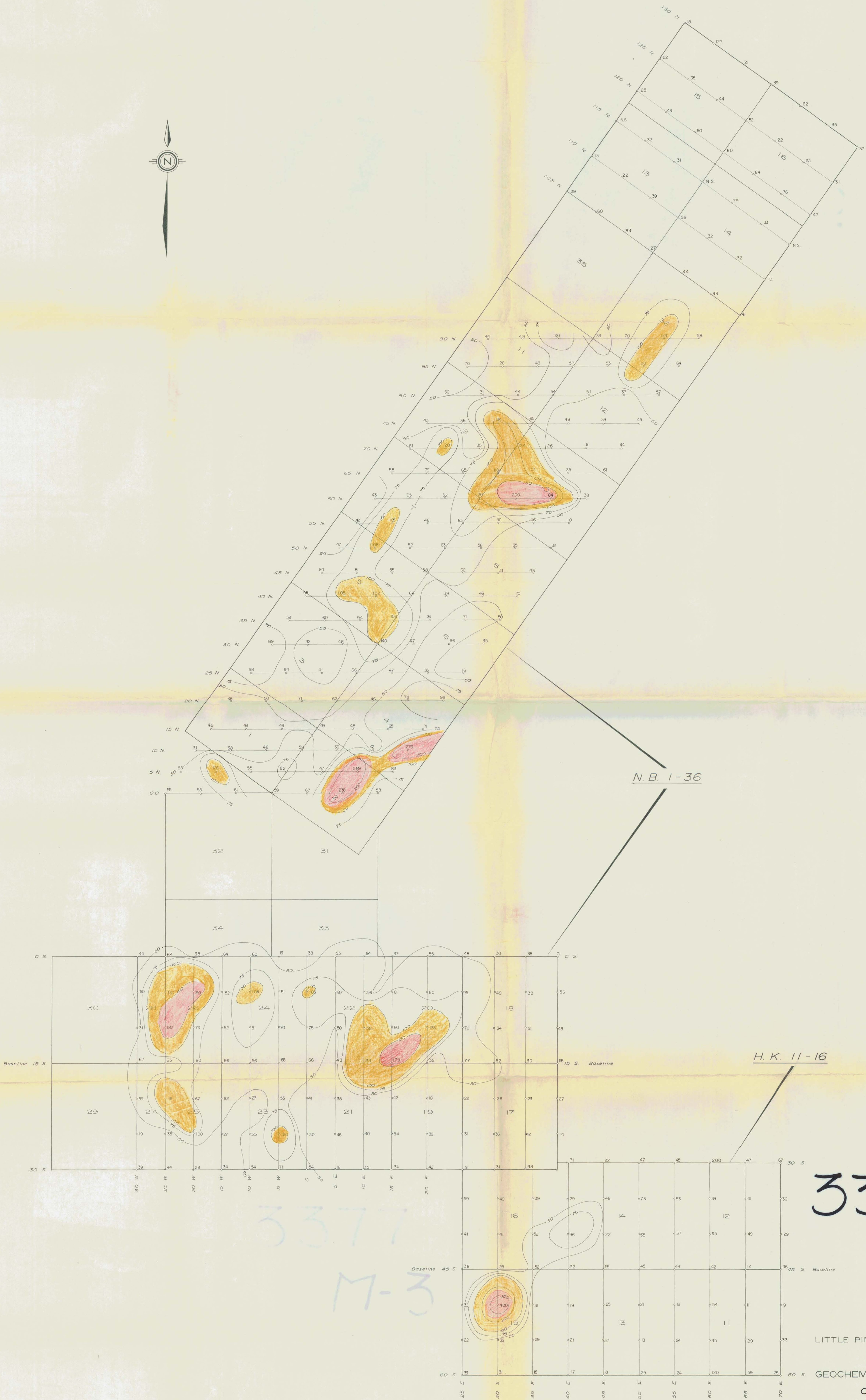
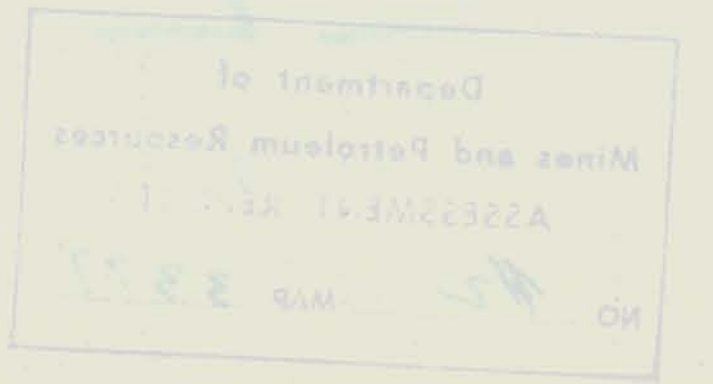

N.B. 1-36

H.K. 11-16

M-2

3377

3377

M-3

Cu + 150 p.p.m.
Cu + 100 p.p.m.

RADVAK ENGINEERING LTD.
LITTLE PINE TEX MINING CORP LTD (NPL)
(HIGHLAND STAR)
GEOCHEMICAL SURVEY & CLAIM MAP
COPPER IN P.P.M.

SCALE
0 500 1000 1500 FEET



W-3
3377

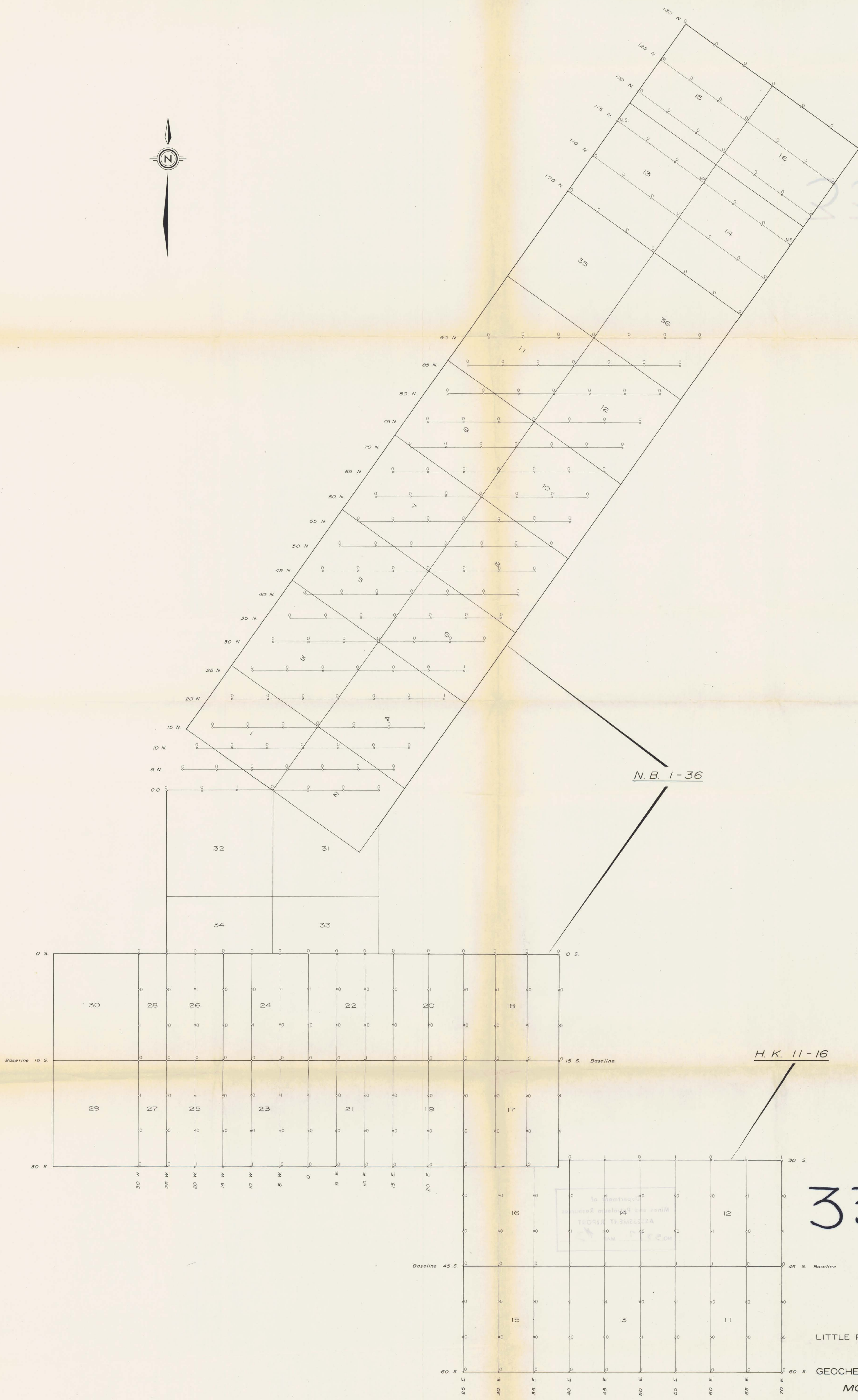

N.B. 1-36

H.K. 11-16

3377
M-3

RADVAK ENGINEERING LTD.
LITTLE PINE TEX MINING CORP. LTD. (NPL.)
(HIGHLAND STAR)
GEOCHEMICAL SURVEY & CLAIM MAP
MOLYBDENUM IN P.P.M.

