

D. I. T. HOLDINGS LTD.

SUITE 102 - 2222 BELLEVUE AVENUE
WEST VANCOUVER, B. C.

3395

Report
On The

KAT 527-540, ELAINE 513-526 AND JOYCE 501-510
MINERAL CLAIMS

SIMILKAMEEN MINING DIVISION
PRINCETON AREA
BRITISH COLUMBIA
49-30 N.L. 120-20 W.L.

For

ABELLA RESOURCES LTD (N.P.L.)
534-789 WEST PENDER STREET
VANCOUVER, B.C.

By

DONALD W. TULLY, P.ENG.



DECEMBER 10, 1971

WEST VANCOUVER, B.C.

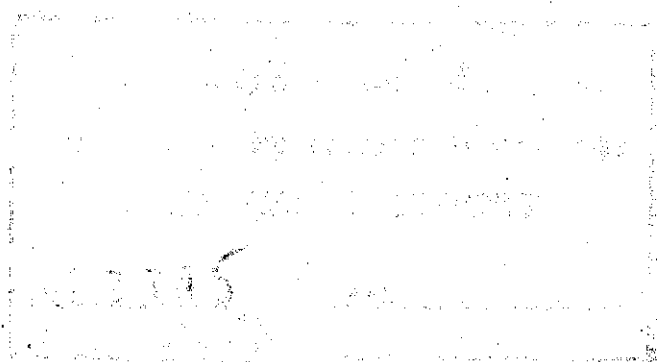

D. I. T. HOLDINGS LTD.

SUITE 102 - 2222 BELLEVUE AVENUE
WEST VANCOUVER, B. C.

TABLE OF CONTENTS

	<u>Page</u>
SUMMARY AND CONCLUSIONS.....	1
INTRODUCTION.....	1
PROPERTIES - LOCATION, ACCESS, TOPOGRAPHY.....	1
REFERENCES - PREVIOUS DEVELOPMENT.....	3
GEOLOGY - REGIONAL.....	4
MINERALIZATION - ASSAYS.....	4
GEOLOGICAL SURVEY (STRATO GEOLOGICAL LTD).....	5
GEOCHEMICAL SURVEY (" " ").....	5
RECOMMENDED WORK PROGRAM.....	7
ESTIMATED COSTS.....	8
CERTIFICATE.....	9

APPENDIX

REPORT BY STRATO GEOLOGICAL LTD.....(End of Report)	
COST DISTRIBUTION.....(" " ")	
ASSAY CERTIFICATES.....(" " ")	

MAPS

1) LOCATION MAP.....	Following Page 1
2) CLAIM MAPS - KAT GROUP.....	" " 2
3 - JOYCE AND ELAINE GROUPS.....	" " 2
G.S.C. MAP #888A - PRINCETON GEOLOGY.....	(In Pocket)
G.S.C. MAP #889A - PRINCETON MINERAL.....	(" ")
G.S.C. MAP #569A - WOLFE CREEK - GEOLOGY....	(" ")
4) TOPOGRAPHY MAP 92 H/8.....	(" ")
5) KAT - GEOLOGY AND GEOCHEMICAL PLAN.....	(" ")
6) 7) JOYCE & ELAINE - GEOLOGY AND GEOCHEMICAL PLAN	(" ")

} removed
- 4/8/82

D. I. T. HOLDINGS LTD.

SUITE 102 · 2222 BELLEVUE AVENUE
WEST VANCOUVER, B.C.

SUMMARY AND CONCLUSIONS

A work program costing \$38,000.00 is recommended for the Elaine Claim Group. More ground should be acquired and a magnetometer survey is proposed. Should the results of this work warrant further testing a follow-up program of bulldozer trenching and 2500 feet of diamond drilling is planned.

No further work is recommended for the Kat and Joyce Claim Groups.

INTRODUCTION

Mr. S. Belzberg, President of ABELLA RESOURCES LTD (N.P.L.) requested the writer to examine the Joyce, Elaine and Kat Claim Groups held in the Princeton area of southern British Columbia. The claims were examined in the field while exploration work was in progress on October 11,12,13 and 14, 1971 with Mr. Uno Leis of Strato Geological Ltd, Vancouver, B.C. Strato Geological Ltd supervised and conducted the geological mapping and geochemical soil sampling under the writers direction.

PROPERTY - LOCATION, ACCESS, TOPOGRAPHY

The properties are in the Similkameen Mining Division and comprise a total of 38 mineral claims in three

121° 30'



KAT CLAIMS

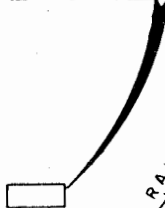

KETTLE VALLEY RAILROAD

ELAINE CLAIMS



JOYCE CLAIMS



49° 30'

PRINCETON

MILKAMEN RIVER

HEDLEY

Department of
 Mines and Petroleum Resources
 ASSESSMENT REPORT
 NO. 3395 MAP #1

ABELLA RESOURCES LTD. (N.P.L.)

CLAIM LOCATION MAP

SCALE: 1" = 4 MILES

D. I. T. HOLDINGS LTD.

SUITE 102 - 2222 BELLEVUE AVENUE
WEST VANCOUVER, B.C.

groups, namely the;

Joyce

Elaine

Kat

The Joyce and Elaine Claim Groups are located 5 miles east of Princeton, B.C. on the north side of the Similkameen River near the mouth of Hayes Creek at elevation 2000-3000 feet a.s.l.

The Kat claims are located 25 miles north of Princeton near Swanson Creek at elevation 4700-5000 a.s.l.

The following information was obtained in a check of the claim posts on the ground and the Mining Recorder's Office, Princeton, British Columbia.

Joyce and Elaine Claim Group

<u>NAME</u>	<u>RECORD #</u>	<u>EXPIRY DATE</u>
Joyce 501-510	29648-57P Incl.	Assessment work filed before Nov. 13, 1971
Elaine 513-526	29634-47P Incl.	Assessment work filed before Nov. 13, 1971

These claims are underlain by Placer Mining Leases #1982,1996,1997 and 1998 in the valley floor of the Similkameen River not in the name of Abella Resources Ltd, some of which date back to the year 1885.

Kat Claim Group

<u>NAME</u>	<u>RECORD #</u>	<u>EXPIRY DATE</u>
Kat 527-540	29658-71P Incl.	Assessment work filed before Nov. 13, 1971

KAT CLAIMS
B.C.D. MINES
MAP 92-H-9W

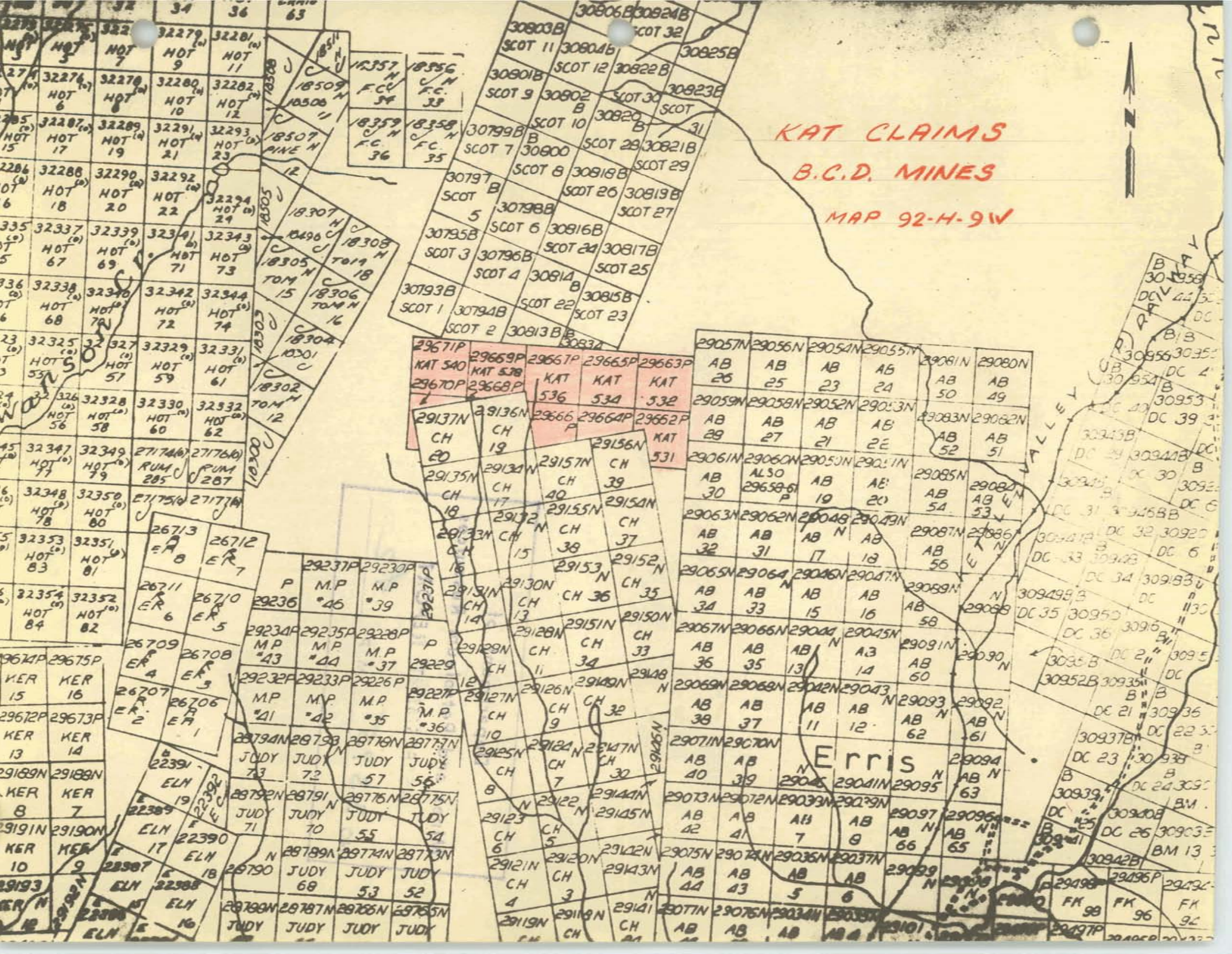

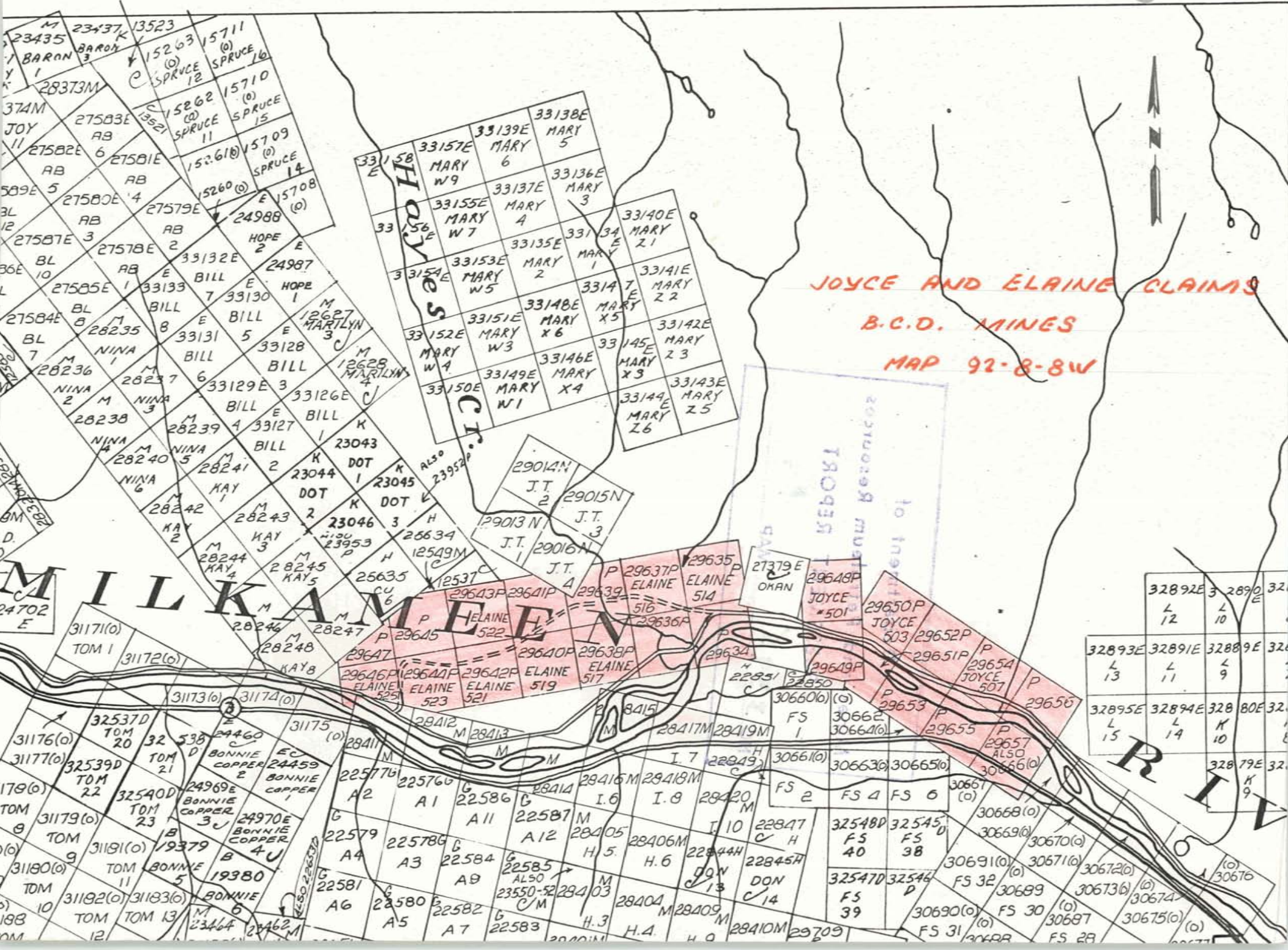

JOYCE AND ELAINE CLAIMS
 B.C.D. MINES
 MAP 92-8-8W

IRON ORE



32892E	32890E	32891E	32892E
L 12	L 10	L 11	L 9
32893E	32891E	32889E	32890E
L 13	L 11	L 9	L 10
32895E	32894E	32880E	32891E
L 15	L 14	K 10	L 9
			32879E 32880E
			K 9

D. I. T. HOLDINGS LTD.

SUITE 102 2222 BELLEVUE AVENUE
WEST VANCOUVER, B. C.

Although B.C. Department of Mines Claim Map 92 H/5 shows an apparent contravention of Kat claims 527-531, 533, 535, 537 and 539, no evidence of this was found on the ground.

Access to the Joyce and Elaine claims is by car. A four-wheel drive vehicle is necessary to reach the Kat Claim Group to a point 5000 feet west of Swanson Creek thence a distance of 8000 feet on foot by compass through dense bush. Relief over the Kat claims is undulating and moderate. The topography over the Joyce and Elaine groups is steep along the north side of the Similkameen River and flat in the river valley. A gas-pipeline is currently being built over the Joyce-Elaine claims parallel to the Similkameen River.

REFERENCES - PREVIOUS DEVELOPMENT

1. Geological Survey of Canada Memoir 243, p-91.
2. G.S.C. Maps 888A and 889A.
3. B.C.D.M. Annual Report 1915, pp 241-243.
4. B.C.D.M. Annual Report 1919, p-171.
5. Report by Stokes Exploration Management (SEMCO) dated August 1, 1971.

Copper is noted on G.S.C. Map 889A on the north side of the Similkameen River about 2 miles west of the mouth of Hayes Creek. This is the former Shamrock (Blue Ridge) Group. Several adits and tunnels as well as test-pits (now covered) are reported by local resident Mr. Tom Coyne. (Personal communication reported to Mr. Leis.)

D. I. T. HOLDINGS LTD.

SUITE 102 · 2222 BELLEVUE AVENUE
WEST VANCOUVER, B. C.

GEOLOGY - REGIONAL

The Kat, Joyce and Elaine Claim Groups occupy the western contact of the Pennask Batholith. (G.S.C. Map #888A)

The Pennask Batholith extends southward from the area west of Summerland in the Brenda Mine area some fifty miles. It is a complex intrusive of probably Jurrassic age.

Rocks contacting this batholith are mostly Nicola lavas, pyroclastics and sediments of earlier Triassic age.

MINERALIZATION - ASSAYS

1. Joyce and Elaine Claim Groups

According to the B.C. Department of Mines Annual Reports for 1915 and 1919, ten tons of copper ore from breccia and vein structures, up to 3 feet wide and 20 feet long and grading 15 per cent copper, was shipped from the pits in this locale which are now caved in.

A chalcopyrite-pyrite zone was located northwest of the property on a newly acquired claim Elaine #6 adjoining Elaine #526. Grab Sample No. 2 assayed over 5% copper. This zone needs more trenching and sampling to assess the potential value.

D. I. T. HOLDINGS LTD.

SUITE 102 - 2222 BELLEVUE AVENUE
WEST VANCOUVER, B.C.

2. Kat Claim Group

No significant mineralization was noted other than fine grains of magnetite in granodiorite on the Kat Claim Group.

GEOLOGICAL SURVEY

Mr. Uno Leis, B.Sc., Manager of Strato Geological Ltd, mapped the geological features of the Kat, Joyce and Elaine Claim Groups. His report is appended herewith. The results of the survey are shown on the maps accompanying this report.

GEOCHEMICAL SURVEY

Strato Geological Ltd carried out the geochemical soil sampling program. A total of 1024 soil samples were taken from the "B" soil horizon at intervals of two hundred feet along control lines 400 feet apart on the three claim groups. Mr. Uno Leis supervised the work. His report is appended herewith. The results are summarized as follows:

KAT GROUP

447 soil samples were taken and analyzed using the hot perchloric acid and atomic absorption method. The results showed:

<u>% Samples</u>		<u>Cu</u>	<u>Mo</u>
50%	Assayed	0-20 ppm	less than 1 ppm (Aver.)
37.5%	"	21-40 "	" " 1 " "
6%	"	41-60 "	" " 1 " "
2%	"	61-80 "	" " 1 " "
2%	"	81-100 "	" " 1 " "
2%	"	100 + "	" " 1 " "

D. I. T. HOLDINGS LTD.

SUITE 102 - 2222 BELLEVUE AVENUE
WEST VANCOUVER, B.C.

Background is considered to be 40 parts per million copper.

No anomalous areas of significance were located.

The results are shown on the accompanying map on scale 1" = 400'.

JOYCE GROUP

188 soil samples were taken and analyzed using the hot perchloric acid and atomic absorption method. The results showed:

<u>% Samples</u>	<u>Cu</u>	<u>Mo</u>
35% Assayed	0-20 ppm	less than 1 ppm
48% "	21-60 "	" " 1 "
6% "	61-80 "	" " 1 "
11% "	81 + "	" " 1 "

Background is considered to be 60 parts per million copper.

Two anomalous areas for copper were located near the banks of the Similkameen River but are not considered significant.

The results are shown on the accompanying map on scale 1" = 200'.

ELAINE GROUP

389 soil samples were taken and analyzed. The results showed:

<u>% Samples</u>	<u>Cu</u>	<u>Mo</u>
29% Assayed	0-20 ppm	less than 1 ppm (Aver.)
37% "	21-40 "	" " 1 " "
18% "	41-60 "	" " 1 " "
5% "	61-80 "	" " 1 " "

D. I. T. HOLDINGS LTD.

SUITE 102 - 2222 BELLEVUE AVENUE
WEST VANCOUVER, B. C.

<u>% Samples</u>	<u>Cu</u>	<u>Mo</u>
4% Assayed	81-100 ppm	less than 1 ppm (Aver.)
7% "	100 + "	" " 1 "

Background is considered to be 60 parts per million copper.

Three weakly anomalous copper areas were located on claims 520 and 522.

The results are shown on the accompanying map on scale 1" = 200'.

RECOMMENDED WORK PROGRAM

STAGE I

More ground should be acquired around Elaine claim #6 and north of Elaine #520, 522 and 524.

STAGE II

A magnetometer survey is proposed on Elaine claims #520, 522, 524, 526 (6 and 7 newly acquired) to outline the general area of copper mineralization indicated in sample No. 2 taken on Elaine claim #6 (newly acquired).

STAGE III

Bulldozer trenching should be done to open up the indicated copper mineralization preparatory to a diamond drill test.

STAGE IV

Should the results of Stages I, II and III above warrant further work, a program of diamond drilling is recommended.

APPENDIX

D. I. T. HOLDINGS LTD.

SUITE 102 - 2222 BELLEVUE AVENUE
WEST VANCOUVER, B.C.

ESTIMATED COSTS

Phase 1. Magnetometer Survey		
9 line miles @ \$180/mi.....	\$ 1,620	
 Buldozer trenching		
160 hrs @ \$40/hr.....	<u>6,400</u>	
		\$ 8,020
 Phase 2. 2500 feet of Bx diamond drilling at an overall cost of \$12.50 per foot.....		<u>30,000</u>
	TOTAL.....	\$38,020

Respectfully submitted

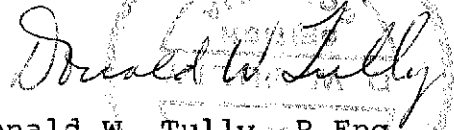

Donald W. Tully, P.Eng.

December 12, 1971

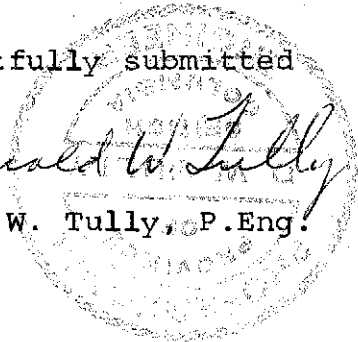

D. I. T. HOLDINGS LTD.

SUITE 102 - 2222 BELLEVUE AVENUE
WEST VANCOUVER, B.C.

CERTIFICATE

I, Donald William Tully, do hereby certify:

1. I am a Consulting Geological Engineer with offices at Suite 102-2222 Bellevue Avenue, West Vancouver, British Columbia.
2. I am a graduate of McGill University, 1943, with the Degree of Bachelor of Science.
3. I am a Registered Professional Engineer in the Provinces of British Columbia and Ontario.
4. I have practised my profession for twenty-six years.
5. I have no direct, indirect or contingent interest in the securities of ABELLA RESOURCES LTD (N.P.L.) or the properties thereof nor do I intend to receive any interest.
6. This report is based on a personal study of the rocks and soil in the field and the data in public and private files during October, November and December, 1971.

DATED at West Vancouver, British Columbia, this 10th day
of December, 1971.

Donald W. Tully

Donald W. Tully, P.Eng.
Consulting Geologist

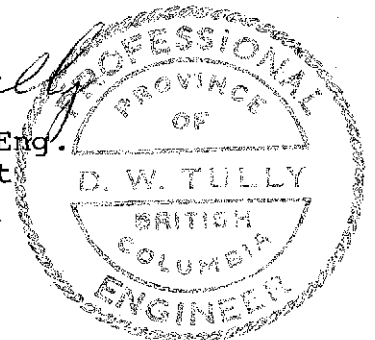

Report On The

KAT, JOYCE AND ELAINE
MINERAL CLAIM GROUPS

SIMILKAMEEN MINING DIVISION
PRINCETON, B.C.

For

ABELLA RESOURCES LTD
534-789 West Pender Street
Vancouver, B.C.



TABLE OF CONTENTS

1. Summary and Conclusions
2. Introduction
3. Claim Description
4. Work Performed
5. Geology - Regional
6. Geology - Property
7. Assay Results - Geochemical Survey
8. Certification
9. Program Costs

1. Summary and Conclusions

A program consisting of line-cutting, soil sampling, stream sediment sampling, geological mapping, and prospecting was conducted on the Joyce, Elaine and Kat mineral claim groups.

Grids were cut on each group, consisting of a base-line with parallel crosslines at 400 foot intervals. The lines were blazed and ribboned, with stations marked at 200 foot intervals. At each station soil samples were taken from the "B" horizon. These samples were analyzed by Core Laboratories in Vancouver for copper and molybdenum in parts per million.

Stream sediment samples were taken at the junctions of creeks, and at 400 foot intervals along the creeks.

Geological mapping was carried out using the grids established on the property. The granites of the Coast Intrusions appeared to be the main lithological unit on all three properties.

2. Introduction

Strato Geological Ltd was requested by Abella Resources Ltd (N.P.L.) to conduct a reconnaissance exploration program on the Joyce, Elaine and Kat mineral claim groups situated in the Princeton area of the Similkameen Mining Division. These claims lie mainly over the Coast Intrusions, with some rocks of the Nicola group also being noted. These properties are copper and molybdenum prospects.

The project consisted of a geological and geo-chemical survey, the results of which are included on the map at the end of this report.

During the project, Uno Leis (Operations Manager), David Coyne, Lamont Burke, Rolland Richardson, Cran Campbell, James Kay, Ron Kiponyas, Marko Motkalok, Clayton Matheson, William Montgomery (samplers) participated in the field work from October 1, 1971 to November 12, 1971. The duration of the program on the Elaine 513 to 526 mineral claims was from October 1, 1971 to October 13, 1971. The program lasted from October 10th to October 24th, 1971 on the Kat 527 to 540 mineral claims. The program on the Joyce 501 to 510 mineral claims extended from October 19th to November 12th, 1971.

This report is based upon personal examination of the claims, examination of the final results of the surveys, and the Geological Survey of Canada publication, Memoir 243.

3. Claim Description

10 claims comprise the Joyce Claim Group, as follows:

<u>Claims</u>	<u>Record Numbers</u>
Joyce 501 to 510	29648 to 29657

14 claims comprise the Elaine Claim Group, as follows:

<u>Claims</u>	<u>Record Numbers</u>
Elaine 513 to 526	29634 to 29647

14 claims comprise the Kat Claim Group, as follows:

<u>Claims</u>	<u>Record Numbers</u>
Kat 527 to 540	29658 to 29671

The Joyce and Elaine mineral Claim Groups are situate approximately seven miles east of Princeton, along the old Princeton-Hedley Highway. The road runs through the property, making access very easy. The claims extend north and south of the road, covering a significant portion of the valley floor and extending to the cliffs on the northern side of the valley.

The Kat mineral Claim Group is situate approximately 15 miles north east of Princeton. These claims can be best reached by turning off the Princeton-Merritt Highway toward Missezula Lake and proceeding along the Summers Creek Road for approximately seven miles. A road turns off at this point and carries on to Rampart Creek. From here it is necessary to hike in for a distance of approximately two miles due east.

The local topographic relief ranges from 4500 to 5000 feet above sea level.

4. Work Performed

The field work consisted of 1) line-cutting and ribboning, 2) soil sampling and stream sediment sampling, and 3) geological mapping and prospecting. The lines were surveyed by compass, blazed and ribboned. Stations were marked with ribboning at two hundred foot intervals at which points soil samples were taken from the "B" horizon. Stream sediment samples were taken from silt deposits in the stream beds at main junctions and at 400 foot intervals along the streams to the approximate boundary of the claims.

The geological mapping and prospecting was conducted simultaneously along the grid lines and the information from notes and field sketches was integrated for the final map. A granitic phase of the Coast Range intrusions was observed to be the most predominant lithological unit present.

The old Shamrock Group showing (G.S.C. Map 889A) to the immediate north of the Elaine Claim Group was examined. A cliff face was noted to be mineralized and stained by malachite, for a width of approximately 15 feet. A sample was obtained and analyzed. (Sample No. 2) The area appeared to be open so that the Elaine 6 and Elaine 7 mineral claims were located, tying in with the Elaine claim group covered in this report.

5. Geology - Regional

The Coast Range intrusions are of pre-upper Lower Cretaceous Age. They are a major rock-type present in the area and have been subdivided into the grey, red, and white granodiorites in sequence from the oldest to youngest.

The 'grey' granodiorite is uniform in texture, composition, and appearance. A light grey rock, it is distinctly foliated, and ranges in composition from quartz diorite to granodiorite. The principal mineral constituents are plagioclase quartz, orthoclase (with either large crystals or interstitial), biotite and amphibolite, with minor magnetite, apatite, titanite and zircon. This rock appears to have resulted primarily from intense metamorphism of intruded rocks.

The 'red' granodiorite appears to have derived from a magma more plentifully supplied with mineralizers. It is characteristically coarser grained, with more variable texture and grain size. Apatite and pegmatite dykes are more common. The normal pink phase normally grades into the darker porphyritic phase, though at places dykes cut into it. The rock is generally light in colour, composed mainly of quartz, plagioclase, and pink orthoclase or microcline. The porphyritic phase has a groundmass of dark foliated granodiorite with euhedral crystals of orthoclase and zircon being common. The orthoclase crystals are metamorphic in origin and thus porphyroblasts rather than true phenocrysts. The 'red' granodiorite ranges from granite to quartz diorite, with a larger percentage of K-spar and quartz than is present in the 'grey' granodiorites. Plagioclase, biotite and amphibole are also main constituents with magnetite, titanite, and zircon present as accessory minerals. cod Fry

'White' granodiorite, light to greenish grey in colour, has a characteristically glomeroporphyritic texture with clusters of needles of amphibole. It is coarse grained, rarely foliated, and derived in part by granitization of volcanic rocks. The 'white' granodiorites are more calcic and less siliceous than the red or grey granodiorites, grading from a basic granodiorite to a diorite. The principal constituents are quartz, orthoclase, plagioclase, biotite, and amphibole, with magnetite, apatite, titanite, and zircon as accessory minerals. This subdivision exhibits a chilled border with the red granodiorite subdivision, with dykes extending into the latter. Thus it appears to be somewhat younger in origin.

The Nicola group consists of lavas with lenses

of tuffaceous and argillaceous rocks, and occasional limestone beds. The volcanics are mainly massive andesite porphyry with a groundmass of medium sodic plagioclase, pyroxene, chlorite, epidote, actinolite, and some magnetite. Pyroxene and plagioclase phenocrysts are present. The rocks are commonly deep green, grey green, or blue green in colour. The composition ranges from fairly acid andesite to a basalt. Plagioclase, pyroxene, and amphibole are common with lesser amounts of quartz. Magnetite, pyrite, and some chalcopyrite have been observed. Secondary minerals are chlorite, calcite, epidote, and limonite.

The sedimentary rocks are much less widespread than the volcanics and are present as lenticular formations of varying sizes. The largest belt of sedimentary rock is located at Hedley.

6. Geology - Property

Kat Group:

The outcrops on the Kat claims are all Coast Range Intrusives. Granitic phases of 'red' granodiorite and 'grey' granodiorite were predominant. The outcrops toward the northern boundaries of the western claims, consisting of Kat 533-540 appeared to be grey granitic rock with very little evidence of K-spar. The southwestern portion of the claim group was mainly red granite with a trend of increased K-spar constituents toward the south. The granites in this region were frequently pegmatitic. Iron staining and discrete grains of magnetite were observed.

The eastern portion of the claim group was

primarily covered by swamp and outcrops were less abundant. These outcrops were granitic with orthoclase crystals visible in many of them. There was much less K-spar present in the rocks of this portion of the claims.

Elaine Group:

The southern portion of the Elaine Group rests entirely within the valley of the Similkameen River.

The northern claims extend over the talus slopes and include the cliffs and outcrops, composed mainly of the granitic phase of the Coast Range Intrusives. Elaine 524 and 526 include outcrops of the Nicola Volcanics. The Nicola Group is limited to these claims on this property.

Hydrothermal alteration was evident with extensively chloritized mafics observed in the outcrops and the outcrops and the boulders of the talus slopes. K-spar was observed to be a constituent of the intrusive rocks.

Joyce Group:

The southern claims of the Joyce group lie extensively in the Similkameen River Valley. The southern boundary of Joyce 510, however, encompasses the southern talus slopes and the cliffs of grey granitic intrusive rock.

The northern claims extend over the talus slopes of the northern wall of the valley and include extensive cliffs for the whole length of the claims. All outcrops are a granitic phase of the Coast Range Intrusives. The granites are primarily grey and toward the eastern end

of the group on Kat 509, they are chloritized to varying degrees, with K-spar evident in the same regions.

7. Assay Results - Geochemical Survey

The soil samples were processed as follows:

1. Dried at approximately 125°F
2. Crushed and sieved to -80 mesh
3. Weighed into test tubes
4. Digested with perchloric-nitric acid
5. Analyzed by atomic absorption spectrophotometer

The assay results from Core Laboratories

indicate:

	<u>Background (Cu)</u>	<u>Background (Mo)</u>
Kat Group.....	40 ppm less than 1 ppm
Elaine Group...	60 ppm less than 1 ppm
Joyce Group....	60 ppm less than 1 ppm

CERTIFICATE

I, Uno Leis, do hereby certify:

1. I am Operations Manager of Strato Geological Ltd., with offices at 37-615 West Hastings Street, Vancouver 2, British Columbia.
2. I am a graduate of Carleton University, 1969, with the degree of Bachelor of Science.
3. I am not a registered Engineer in the province of British Columbia or of any province.
4. I have been engaged in geological exploration for two and one half years throughout British Columbia, parts of Yukon Territory, and parts of Saskatchewan.
5. I have no direct, indirect, or contingent interest in the securities of Abella Resources Ltd (N.P.L.) or the properties thereof nor do I intend to receive any interests.
6. This report is based on personal field examination, and of the data obtained as a result of the survey.

DATED at Vancouver, British Columbia, this 7th day of December, 1971.

Uno Leis, B.Sc.

Signed: U. Leis



Cost Distribution

Elaine 513 to 526

Silt Sampling, Soil Sampling & Line-cutting	\$ 1900.00
Laboratory Analysis	756.00
Geological Mapping & Examination	1400.00
Engineering Report	175.00
	<hr/>
TOTAL ASSESSMENT WORK	\$ 4231.00

Kat 527 to 540

Silt Sampling, Soil Sampling & Line-cutting	\$ 1900.00
Laboratory Analysis	756.00
Geological Mapping & Examination	1400.00
Engineering Report	175.00
	<hr/>
TOTAL ASSESSMENT WORK	\$ 4231.00

Joyce 501 to 510

Silt Sampling, Soil Sampling & Line-cutting	\$ 1300.00
Laboratory Analysis	548.00
Geological Mapping & Examination	1000.00
Engineering Report	175.00
	<hr/>
TOTAL ASSESSMENT WORK	\$ 3031.00

4231
4231

11,493

ASSAYERS
CHEMISTS
GEOCHEMISTS

KAT



CORE LABORATORIES - CANADA LTD.

325 Howe Street Vancouver 1, B.C. Phone 688-3504

SAMPLE(S) FROM
STRATO GEOLOGICAL

Certificate of Analysis

REPORT NO.

V 10750

SAMPLE(S) OF SOILS

Sample No.	Cu ppm	Mo ppm
BEL 0 16M	27	2
20	29	1
BEL 0 25	25	<1
4	72	2
6	17	<1
8	24	1
10	22	<1
12	13	1
14	18	<1
15	24	<1
2N	27	<1
4	26	<1
6	15	1
8	21	<1
10	19	<1
12	15	<1
14	18	<1
15	25	<1
BEL 4 05	33	2
2	35	2
4	91	4
6	25	<1
8	21	<1
10	29	<1
12	24	<1
14	69	5
15	22	<1
2N	25	1
4	103	14
6	100	2
8	40	<1
10	13	<1
12	29	<1
14	17	<1
15	22	<1
BEL 8 8N	28	<1
BEL 12 2S	87	5
4	41	<1
8	18	<1
12	17	<1
14	17	<1

DATE Nov 19, 1971.

SIGNED [Signature]

PULP AND REJECTS DISCARDED AFTER 3 MONTHS

ASSAYERS
CHEMISTS
GEOCHEMISTS



CORE LABORATORIES - CANADA LTD.

325 Howe Street Vancouver 1, B.C. Phone 688-3504

SAMPLE(S) FROM
STRATO GEOLOGICAL

Certificate of Analysis

REPORT NO.
V 10753

SAMPLE(S) OF SOILS

Sample No.	Cu ppm	Mn ppm
BEL 8 OS	26	<1
2	27	<1
4	31	<1
6	21	1
8	38	1
10	45	2
12	46	<1
14	16	<1
15	17	<1
2N	20	<1
4	25	1
6	15	1
10	19	1
12	23	1
15	52	<1
BEL 52 2S	37	<1
4	25	<1
6	11	1
8	19	<1
10	17	<1
12	10	<1
14	17	<1
15	20	1
BEL 88 2S	50	<1
4	23	1
6	21	<1
8	19	<1
10	15	<1
12	16	<1
14	20	<1
15	26	<1
BEL 104 0	12	<1
2N	16	1
4	15	<1
6	16	<1
8	14	1
10	32	<1
12	21	<1
14	14	<1
15	14	<1

DATE Nov 24, 1971 HOT PERCHLORIC ACID DIGESTION DETERMINED BY A.A.
SIGNED [Signature]

PULP AND REJECTS DISCARDED AFTER 3 MONTHS

ASSAYERS
CHEMISTS
GEOCHEMISTS



CORE LABORATORIES - CANADA LTD.

325 Howe Street Vancouver 1, B.C. Phone 688-3504

Certificate of Analysis

REPORT NO.

V 10750

SAMPLE(S) FROM
STRATO GEOLOGICAL

SAMPLE(S) OF SOILS

Sample No.	Cu ppm	Mo ppm
BEL 12 1	16	<1
ON	48	<1
2	59	1
4	43	<1
6	54	36
8	37	1
10	25	<1
12	50	<1
14	47	<1
15	57	<1
BEL 16 23	24	2
4	25	<1
6	15	<1
8	38	<1
8	35	<1
10	30	<1
12	36	<1
14	42	<1
15	17	1
2N	24	1
4	28	<1
6	30	<1
10	38	1
12	20	1
14	17	1
15	21	2
BEL 20 23	13	1
4	16	2
6	18	1
8	21	<1
10	13	<1
12	12	<1
14	N.S.	N.S.
15	19	<1
0	19	<1
2N	26	<1
4	34	2
6	21	1
8	22	1
10	15	<1

DATE Nov 17, 1971.

SIGNED [Signature]

ASSAYERS
CHEMISTS
GEOCHEMISTS



CORE LABORATORIES - CANADA LTD.

325 Howe Street Vancouver 1, B.C. Phone 688-3504

SAMPLE(S) FROM
STRATO GEOLOGICAL

Certificate of Analysis

REPORT NO.

V-10750

SAMPLE(S) OF
SOILS

Sample No.	Cu ppm	Mo ppm
BBL 20 12N	19	<1
14	18	<1
15	21	<1
BBL 24 0	59	8
23	21	<1
4	N.S.	N.S.
6	17	<1
8	18	<1
10	15	1
12	15	<1
14	15	<1
15	28	<1
2N	69	<1
4	18	1
6	19	<1
8	29	11
10	13	<1
12	15	<1
14	21	1
15	19	<1
BBL 28 23	14	1
4	15	<1
6	18	<1
8	14	<1
10	N.S.	N.S.
12	77	7
14	32	2
15	74	3
ON	18	<1
2	20	<1
4	13	<1
6	22	<1
8	17	<1
10	21	<1
12	40	<1
14	13	<1
15	16	<1
BBL 32 23	30	1
4	20	<1
6	32	<1

DATE Nov 12, 1971

SIGNED [Signature]

PULP AND REJECTS DISCARDED AFTER 3 MONTHS

ASSAYERS
CHEMISTS
GEOCHEMISTS



CORE LABORATORIES - CANADA LTD.

325 Howe Street Vancouver 1, B.C. Phone 688-3504

SAMPLE(S) FROM
STRATO GEOLOGICAL

Certificate of Analysis

REPORT NO.
V 10750

SAMPLE(S) OF SOILS

Sample No.	Cu ppm	Mo ppm
BBL 32 8S	17	1
10	12	1
12	13	<1
14	22	1
15	14	1
0	16	1
2N	23	<1
4	27	<1
6	17	<1
8	17	<1
10	14	<1>
12	17	<1
14	18	<1
15	35	<1
BBL 36 2S	18	<1
4	19	<1
6	108	1
8	21	1
10	19	1
12	N.S.	N.S.
14	N.S.	N.S.
15	45	1
0	15	<1
2N	15	<1
4	17	<1
6	19	1
8	27	1
10	16	<1
12	14	<1
14	27	<1
15	50	<1
BBL 40 2S	28	<1
4	23	<1
6	57	<1
8	38	<1
10	18	<1
12	22	<1
14	20	<1
15	N.S.	N.S.
ON	20	<1
2	19	<1

DATE Nov 19, 1971

SIGNED [Signature]

ASSAYERS
CHEMISTS
GEOCHEMISTS



CORE LABORATORIES - CANADA LTD.

325 Howe Street Vancouver 1, B.C. Phone 688-3504

Certificate of Analysis

REPORT NO.
V 10750

SAMPLE(S) FROM
STRATO GEOLOGICAL

SAMPLE(S) OF SOILS

Sample No.	Cu ppm	Mo ppm
BBL 40 4N	18	<1
6	84	<1
8	156	2
10	17	<1
12	59	2
14	13	<1
15	12	<1
BBL 44 2S	19	<1
4	21	<1
6	27	<1
8	30	<1
10	15	<1
12	29	<1
14	23	4
15	23	<1
2N	13	<1
4	21	<1
6	17	<1
8	18	<1
10	15	<1
12	25	<1
14	46	<1
15	21	<1
BBL 48 2S	30	<1
4	20	<1
6	17	<1
8	15	<1
10	21	<1
12	20	<1
14	21	<1
15	12	<1
ON	10	<1
2	9	<1
4	35	<1
6	19	<1
8	19	1
10	25	<1
12	10	<1
14	22	1
15	24	<1

DATE Nov 19, 1971.

SIGNED [Signature]

ASSAYERS
CHEMISTS
GEOCHEMISTS



CORE LABORATORIES - CANADA LTD.

325 Howe Street Vancouver 1, B.C. Phone 688-3504

SAMPLE(S) FROM
STRATO GEOLOGICAL

Certificate of Analysis

REPORT NO.
V 10750

SAMPLE(S) OF SOILS

Sample No.	Cu ppm	Mo ppm
BBL 52 ON	22	<1
2	20	<1
4	13	<1
6	6	<1
8	25	<1
10	14	<1
12	12	<1
14	15	<1
15	15	<1
BBL 56 2S	29	<1
4	21	<1
6	18	<1
8	34	<1
10	18	<1
12	27	<1
14	39	<1
15	23	<1
2N	7	<1
4	10	<1
6	6	<1
8	15	<1
10	32	<1
12	15	<1
14	16	<1
15	14	<1
BBL 60 2S	18	<1
4	21	<1
6	35	1
8	12	<1
10	75	<1
12	20	1
14	14	<1
15	61	<1
N	N.S.	N.S.
2	62	<1
4	38	1
6	22	<1
8	15	<1
10	12	1
12	13	<1

DATE Nov 12, 1971

SIGNED [Signature]

PULP AND REJECTS DISCARDED AFTER 3 MONTHS

ASSAYERS
CHEMISTS
GEOCHEMISTS



CORE LABORATORIES - CANADA LTD.

325 Howe Street Vancouver 1, B.C. Phone 688-3504

SAMPLE(S) FROM
STRATO GEOLOGICAL

Certificate of Analysis

REPORT NO.

V 10750

SAMPLE(S) OF SOILS

Sample No.	Cu ppm	Mo ppm
BBL 60 14	13	<1
	17	2
BBL 64 15	25	<1
	24	<1
	24	<1
	17	1
	22	<1
	21	<1
	22	<1
	23	<1
	25	<1
	28	<1
	14	<1
	20	1
	23	<1
	22	<1
	20	1
BBL 68 12	27	<1
	29	<1
	29	<1
	30	<1
	17	<1
	17	<1
	22	<1
	16	<1
	18	<1
	16	<1
	20	<1
	11	<1
	19	<1
	17	<1
	16	1
	30	<1
	26	<1
	13	<1
	14	<1
	22	<1
BBL 72 15	27	<1
	21	<1
	15	<1

DATE Nov 19, 1971.

SIGNED *[Signature]*

PULP AND REJECTS DISCARDED AFTER 3 MONTHS

ASSAYERS
CHEMISTS
GEOCHEMISTS



CORE LABORATORIES - CANADA LTD.

325 Howe Street Vancouver 1, B.C. Phone 688-3504

SAMPLE(S) FROM
STRATO GEOLOGICAL

Certificate of Analysis

REPORT NO.

V 10750

SAMPLE(S) OF SOILS

Sample No.	Cu ppm	Mo ppm
BEL 72 83	28	<1
10	28	<1
12	20	<1
14	29	1
15	17	<1
ON	18	<1
2	27	<1>
4	24	<1
6	18	<1
8	20	<1
10	18	1
12	14	<1
14	17	<1
15	25	1
BEL 76 23	23	<1
4	19	<1
6	49	<1
8	20	<1
10	18	<1
12	16	<1
14	32	<1
15	20	<1
0	19	<1
2N	25	<1
4	22	<1
6	14	<1
8	40	<1
10	31	<1
12	16	<1
14	49	1
15	44	<1
BEL 80 OS	19	<1
2	13	1
4	19	<1
6	12	1
8	26	<1
10	14	<1
12	19	<1
14	14	<1
15	13	<1

DATE Nov 19, 1971.

SIGNED *A. D. Sullivan*

PULP AND REJECTS DISCARDED AFTER 3 MONTHS

ASSAYERS
 CHEMISTS
 GEOCHEMISTS



CORE LABORATORIES - CANADA LTD.

325 Howe Street Vancouver 1, B.C. Phone 688-3504

SAMPLE(S) FROM
 STRATO GEOLOGICAL

Certificate of Analysis

REPORT NO.
 V 10750

SAMPLE(S) OF SOILS

Sample no.	Cu ppm	Mo ppm
BBL 80 ON	20	<1
2	24	<1
4	47	<1
6	28	1
8	17	1
10	17	<1
12	16	1
14	13	<1
15	14	<1
BBL 84 2S	27	<1
4	18	<1
6	17	<1
8	16	<1
10	12	<1
12	16	<1
14	16	<1
15	16	<1
0	29	<1
2N	22	<1
4	12	<1
6	16	1
8	17	1
10	15	<1
12	15	<1
14	17	<1
15	12	<1
BBL 88 0	16	<1
2S	12	<1
4N	14	<1
6	65	<1
8	104	<1
10	24	<1
12	10	<1
15	14	<1
BBL 92 2S	45	2
4	46	<1
6	23	<1
8	25	<1
10	19	<1
12	15	1

DATE Nov 17, 1971.

SIGNED [Signature]

ASSAYERS
CHEMISTS
GEOCHEMISTS



CORE LABORATORIES - CANADA LTD.

325 Howe Street Vancouver 1, B.C. Phone 688-3504

Certificate of Analysis

REPORT NO.

V 10750

SAMPLE(S) FROM
STRATO GEOLOGICAL

SAMPLE(S) OF SOILS

Sample No.	Cu ppm	Mo ppm
BEL 92 14.3	20	<1
15	20	<1
ON	93	<1
2	29	<1
4	27	<1
6	14	<1
8	13	<1
10	13	<1
12	20	<1
14	28	1
15	13	<1
BEL 96 03	16	<1
2	14	<1
4	15	<1
6	17	1
8	40	<1
10	14	<1
12	15	<1
14	21	<1
15	18	<1
2N	41	<1
4	55	1
6	25	1
8	24	<1
10	22	<1
12	27	<1
15	11	<1
BEL 100 2S	19	<1
4	18	<1
6	17	1
8	23	<1
10	25	<1
12	21	<1
14	22	<1
15	21	<1
ON	41	<1
2	25	<1
4	30	<1
6	18	<1

DATE Nov 17, 1971.

SIGNED *[Signature]*

PULP AND REJECTS DISCARDED AFTER 3 MONTHS

ASSAYERS
CHEMISTS
GEOCHEMISTS



CORE LABORATORIES - CANADA LTD.

325 Howe Street Vancouver 1, B.C. Phone 688-3504

SAMPLE(S) FROM
STRATO GEOLOGICAL

Certificate of Analysis

REPORT NO.
V 10750

SAMPLE(S) OF
SOILS

Sample No.	Cu ppm	Mo ppm
BEL 1008N	39	<1
10	29	1
12	86	1
14	220	<1
15	224	<1
BEL 10426	18	1
4	15	1
6	22	1
8	14	<1
10	120	<1
12	44	2
14	118	<1
15	78	<1

HOT PERCHLORIC ACID DIGESTION
DETERMINED BY A.A.

DATE Nov 19, 1971.

SIGNED *[Signature]*

ASSAYERS
CHEMISTS
GEOCHEMISTS

Joyce



CORE LABORATORIES - CANADA LTD.

325 Howe Street Vancouver 1, B.C. Phone 688-3504

SAMPLE(S) FROM
STRATO GEOLOGICAL

Certificate of Analysis

REPORT NO.
V 10746

SAMPLE(S) OF SOILS

Sample No.	Cu ppm	Mo ppm
CBL 0 ON	27	<1
200	N.S.	N.S.
400	27	<1
600	44	<1
800	14	<1
1000	16	<1
1200	37	<1
1400	11	<1
1600	25	<1
CBL 0 2S	150	<1
400	163	<1
8	36	<1
10 ROAD	N.S.	N.S.
1200	16	<1
14	Slide N.S.	N.S.
15 SLIDE	N.S.	N.S.
CBL 4 2S	81	<1
8 River Bed	N.S.	N.S.
10 Gravel	N.S.	N.S.
12 Gravel	N.S.	N.S.
14 SLIDE	N.S.	N.S.
15 SLIDE	N.S.	N.S.
CBL 8 8S RIVER	N.S.	N.S.
10 Hiway	N.S.	N.S.
1 2	36	<1
14 SLIDE	N.S.	N.S.
15 SLIDE	N.S.	N.S.
CBL 12 10S	172	<1
12	26	<1
14	9	<1
15	13	<1
CBL 160	20	<1
10N	14	<1
12	23	<1
14	25	<1
15	18	<1
CBL 168S	30	<1
10	44	<1
12	33	<1
14	68	<1

DATE Nov 12, 1971.

SIGNED [Signature]

PULP AND REJECTS DISCARDED AFTER 3 MONTHS

ASSAYERS
CHEMISTS
GEOCHEMISTS



CORE LABORATORIES - CANADA LTD.

325 Howe Street Vancouver 1, B.C. Phone 688-3504

SAMPLE(S) FROM
STRATO GEOLOGICAL

Certificate of Analysis

REPORT NO.
V 10746

SAMPLE(S) OF SOILS

Sample No.	Cu ppm	Mo ppm
CBL 16 15S	13	<1
CBL 20 0	29	1
2N	N.S.	N.S.
4	N.S.	N.S.
6	17	<1
8	14	<1
12	11	1
14	15	<1
15	13	<1
CBL 20 6S	39	<1
8	47	1
10	74	<1
12 Hiway	N.S.	N.S.
14	69	<1
15 SLIDE	N.S.	N.S.
CBL 24 ON	28	<1
4	N.S.	N.S.
600 SLIDE	N.S.	N.S.
800	17	<1
CBL 24 4S	37	<1
6	39	<1
8	60	<1
10	43	<1
12	119	<1
14	108	<1
15	39	<1
CBL 28 0	26	<1
2N	7	<1
8	18	<1
10	12	<1
12	20	1
14	30	<1
16	21	<1
CBL 28 8S	35	1
10	50	<1
12	121	<1
14	47	<1
15	28	<1
CBL 32 0	30	1
2N	N.S.	N.S.

DATE Nov 12, 1971.

SIGNED *[Signature]*

PULP AND REJECTS DISCARDED AFTER 3 MONTHS

ASSAYERS
CHEMISTS
GEOCHEMISTS



CORE LABORATORIES - CANADA LTD.

325 Howe Street Vancouver 1, B.C. Phone 688-3504

SAMPLE(S) FROM
STRATO GEOLOGICAL

Certificate of Analysis

REPORT NO.

V 10746

SAMPLE(S) OF SOILS

Sample No.	Cu ppm	Mo ppm
CBL 32 4N	11	<1
6	N.S.	N.S.
CBL 32 2S	185	<1
8	47	<1
10	37	<1
12	48	<1
14	66	<1
CBL 36 2S	100	<1
10	38	<1
12	36	<1
14	58	<1
15	74	<1
CBL 40 2S	78	<1
10	45	<1
12	76	<1
14	58	<1
15	56	<1
CBL 44 0	69	<1
4N SLIDE	N.S.	N.S.
6 SLIDE	N.S.	N.S.
8 SLIDE	N.S.	N.S.
10	21	<1
12 SLIDE	N.S.	N.S.
14	18	<1
15	14	<1
CBL 44 2S	101	<1
12	137	<1
14	63	<1
15	59	<1
CBL 48 0	56	<1
2N	11	<1
CBL 48 12S	83	<1
14	51	<1
15	51	<1
CBL 52 0	14	<1
6N	12	<1
10	28	<1
12	21	<1
12	16	<1
14	12	<1

DATE Nov 12, 1971.

SIGNED [Signature]

ASSAYERS
CHEMISTS
GEOCHEMISTS



CORE LABORATORIES - CANADA LTD.

325 Howe Street Vancouver 1, B.C. Phone 688-3504

SAMPLE(S) FROM
STRATO GEOLOGICAL

Certificate of Analysis

REPORT NO.

V 10746

SAMPLE(S) OF SOILS

Sample No.	Cu ppm	Mo ppm
CBL 52 15N	14	<1
CBL 52 2S	11	<1
10	41	<1
12	43	<1
14	51	<1
15	46	<1
CBL 56 2N	15	<1
4	12	<1
6	14	<1
8	57	<1
14	12	<1
15	109	<1
CBL 56 10S	111	<1
12	48	<1
14	51	<1
15	48	<1
CNL 60 ON	35	<1
2	12	<1
4	10	<1
6	17	<1
8	12	<1
10	17	<1
15	17	<1
CBL 60 6S	144	<1
8	143	<1
10	87	<1
12	55	<1
14	57	<1
15	54	<1
CBL 64 0	45	<1
2N	111	<1
8	10	<1
10	14	<1
CBL 64 6S	55	<1
8	43	<1
10	94	<1
12	57	<1
14	49	<1
15	45	<1
CBL 68 2N	8	<1

Nov 12, 1971.

DATE _____

SIGNED *[Signature]*

PULP AND REJECTS DISCARDED AFTER 3 MONTHS

ASSAYERS
CHEMISTS
GEOCHEMISTS



CORE LABORATORIES - CANADA LTD.

325 Howe Street Vancouver 1, B.C. Phone 688-3504

SAMPLE(S) FROM
STRATO GEOLOGICAL

Certificate of Analysis

REPORT NO.
V 10746

SAMPLE(S) OF SOILS

Sample No.		Cu ppm	Mo ppm
CBL 68	10N	9	<1
	12	21	<1
	14	20	<1
	15	43	<1
CBL 68	6S	41	<1
	8	40	<1
	10	133	<1
	12	45	<1
	14	39	<1
	15	34	<1
CBL 70	0	20	<1
	2N	23	<1
	4	14	<1
	6	7	<1
	8	10	<1
	10 SLIDE	N.S.	N.S.
	12 SLIDE	N.S.	N.S.
	14 SLIDE	N.S.	N.S.
	15	5	<1
	6S	39	<1
CBL 72	8	47	<1
	10	43	<1
	12	53	<1
	14	50	<1
	15	41	<1
	0	30	<1
CBL 76	2N	12	<1
	4	7	<1
	6	9	<1
	8	9	<1
	10 SLIDE	N.S.	N.S.
	12	5	<1
CBL 76	15 SLIDE	N.S.	N.S.
	6S	42	<1
	8	153	<1
	10	146	<1
	12	56	<1
	14	43	<1
	14 SLIDE	N.S.	N.S.
	15	44	<1
CBL 0'N	4000	38	<1
	Nov 12, 1971.		

DATE _____

SIGNED 

ASSAYERS
CHEMISTS
GEOCHEMISTS



CORE LABORATORIES - CANADA LTD.

325 Howe Street Vancouver 1, B.C. Phone 688-3504

Certificate of Analysis

REPORT NO.
V 10746

SAMPLE(S) FROM
STRATO GEOLOGICAL

SAMPLE(S) OF SOILS

Sample No.	Cu ppm	Mo ppm
CBL 200N 4000 SLIDE	N.S.	N.S.
400 ON	13	<1
200	N.S.	N.S.
400	16	<1
600	26	<1
800	27	<1
1000	15	<1
1200	20	<1
1400	11	<1
1600	32	<1
CBL 600N 4000SLIDE	N.S.	N.S.
CBL 800 ON	12	<1
200N (O.C.)	12	<1
400 (O.C.)	14	<1
600	11	<1
800	25	<1
4000 SLIDE	N.S.	N.S.
CBL 1000N-4000 SLIDE	N.S.	N.S.
CBL 1200 TL 1200 ON	62	<1
CBL 1200N 4000	18	<1
TL 1200 200N SLIDE	N.S.	N.S.
400	20	<1
600	22	<1
800	65	<1
CBL 1400N 4000 CLIFF	N.S.	N.S.

HOT PERCHLORIC ACID EXTRACTION
DETERMINED BY A.A.

DATE Nov 12, 1971.

SIGNED *A. A. [Signature]*

PULP AND REJECTS DISCARDED AFTER 3 MONTHS

ASSAYERS
CHEMISTS
GEOCHEMISTS



CORE LABORATORIES - CANADA LTD.

325 Howe Street Vancouver 1, B.C. Phone 688-3504

SAMPLE(S) FROM
STRATO GEOLOGICAL

Certificate of Analysis

REPORT NO.

V 10754

SAMPLE(S) OF SILT

Sample No.	Cu ppm	Mo ppm
1	25	<1
2	48	<1
3	35	<1
4	46	<1
5	23	<1
6	20	<1

HOT PERCHLORIC ACID DIGESTION
DETERMINED BY A.A.

DATE Nov 30, 1971.

SIGNED *M. Lerner*

PULP AND REJECTS DISCARDED AFTER 3 MONTHS

ASSAYERS
CHEMISTS
GEOCHEMISTS

ELAINE



CORE LABORATORIES - CANADA LTD.

325 Howe Street Vancouver 1, B.C. Phone 688-3504

SAMPLE(S) FROM
STRATO GEOLOGICAL

Certificate of Analysis

REPORT NO.
V 10737

SAMPLE(S) OF SOILS

Sample No.	Ca ppm	Mo ppm
ABL-ON	76	1
2	13	<1
4	12	1
6	9	<1
8	10	<1
10	12	1
12	10	<1
14	7	1
15	7	1
ABL 4	8	<1
4	13	1
6	10	1
8	7	<1
10	9	<1
12	11	1
14	11	2
15	9	1
ABL 5 - 0	45	<1
ABL 8 - ON	26	<1
2	18	<1
4	8	<1
6	17	<1
8	8	1
10	7	<1
12	9	<1
14	9	<1
15	5	1
ABL12- ON	80	1
2	12	<1
4	13	<1
6	9	<1
8	10	<1
10	15	<1
12	7	1
14	7	1
15	8	1
ABL 16- ON	23	1
2	12	1
4	5	1
6	7	1

DATE Oct. 26, 1971.

SIGNED [Signature]

PULP AND REJECTS DISCARDED AFTER 3 MONTHS

ASSAYERS
CHEMISTS
GEOCHEMISTS



CORE LABORATORIES - CANADA LTD.

325 Howe Street Vancouver 1, B.C. Phone 688-3504

SAMPLE(S) FROM
TRATO GEOLOGICAL

Certificate of Analysis

REPORT NO.
V 10737

SAMPLE(S) OF SOILS

Sample No.	Cu ppm	Mo ppm
ABL 16-8	22	1
10	10	<1
12	8	<1
14	7	<1
15	6	<1
ABL 20-CN	14	<1
2	11	<1
4	100	<1
6	15	<1
8	13	<1
10	12	<1
12	9	<1
15	6	<1
ABL - 2 4-CN	11	<1
2	8	<1
4	7	<1
6	16	<1
8	10	<1
10	10	<1
12	9	<1
14	N.S.	NS.
15	N.S.	N.S.
ABL -28-CN	7	<1
2	9	<1
4	15	<1
6	11	<1
8	10	<1
10	10	<1
12	11	1
14	7	<1
15	5	<1
abl-32-CN	9	<1
2	13	1
4	15	<1
6	12	<1
8	14	<1
10	11	<1
12	8	1
14	8	1
15	9	<1

DATE Oct. 26, 1971.

SIGNED *[Signature]*

ASSAYERS
CHEMISTS
GEOCHEMISTS



CORE LABORATORIES - CANADA LTD.

325 Howe Street Vancouver 1, B.C. Phone 688-3504

Certificate of Analysis

REPORT NO.

V 10737

SAMPLE(S) FROM
STRATO GEOLOGICAL

SAMPLE(S) OF SOILS

Sample No.	Cu ppm	Mo ppm
ABL 36- ON	N.S.	N.S.
2	33	<1
4	14	1
6	18	<1
8	11	1
10	8	1
12	9	<1
14	9	<1
15	12	<1
ABL 40- ON	N.S.	N.S.
2	27	1
4	123	1
6	65	1
8	18	1
10	11	<1
12	33	<1
14	11	1
15	8	<1
ABL 44- ON HOUSE	N.S.	N.S.
2 HOUSE	N.S.	N.S.
4	20	<1
6	35	<1
10	9	<1
12	26	<1
14	20	1
15	11	<1
ABL 48- ON	29	1
4	22	<1
8	13	<1
10	21	1
15	18	<1
ABL 52- ON	35	<1
8	35	<1
10	106	1
14	3	<1
15	24	1
ABL 56- ON	19	2
2 HOUSE	N.S.	N.S.
4	87	1
6	76	<1

DATE Oct. 26, 1971.

SIGNED [Signature]

ASSAYERS
CHEMISTS
GEOCHEMISTS



CORE LABORATORIES - CANADA LTD.

325 Howe Street Vancouver 1, B.C. Phone 688-3504

SAMPLE(S) FROM
STRATO GEOLOGICAL

Certificate of Analysis

REPORT NO.

V 10737

SAMPLE(S) OF SOILS

Sample No.	Cu ppm	Mo ppm
ABL-56-8	66	<1
10	30	<1
12	35	1
14	22	<1
15	30	<1
ABL-60-ON	25	<1
2	153	<1
4	234	<1
6	140	<1
8	52	<1
10	62	<1
12	47	<1
14	25	<1
15	21	<1
16	N.S.	N.S.
ABL-64-ON	30	<1
2	68	<1
4	110	<1
6	79	<1
8	100	1
10	66	1
12	101	2
14	45	<1
15	32	<1
ABL-68-ON	43	<1
2	42	<1
4	150	1
6	90	1
8	85	1
10	32	<1
12	50	<1
14	74	1
15	61	1
ABL-72-2H	38	1
4	54	1
6	119	1
8	38	3
10	16	1
12	34	1
14	44	1

DATE Oct. 26, 1971.

SIGNED *[Signature]*

ASSAYERS
CHEMISTS
GEOCHEMISTS



CORE LABORATORIES - CANADA LTD.

325 Howe Street Vancouver 1, B.C. Phone 688-3504

SAMPLE(S) FROM
RATO GEOLOGICAL

Certificate of Analysis

REPORT NO.
V 10737

SAMPLE(S) OF SOILS

Sample No.	Cu ppm	Mo ppm
ABL 72-15	37	<1
ABL 76-ON	20	<1
2	23	<1
4	100	1
6	22	3
8	32	4
10	45	2
12	19	<1
14	60	7
15	66	1
ABL 80ON	16	<1
2	18	<1
4	33	1
6	79	<1
8	20	1
10	32	<1
12	24	2
14	16	2
15	38	<1
ABL 84ON	27	<1
2	19	<1
4	32	2
10	98	2
12	26	1
14	28	1
15	39	1
ABL 88ON	29	<1
2 ROCK	N.S.	N.S.
4	22	1
6	39	1
8	30	<1
10	31	<1
12	38	1
14	59	<1
15	50	<1
ABL 92- ON	33	1
2	39	<1
4	32	<1
6	38	1
8	25	1

DATE Oct. 28, 1971.

SIGNED [Signature]

ASSAYERS
 CHEMISTS
 GEOCHEMISTS



CORE LABORATORIES - CANADA LTD.

325 Howe Street Vancouver 1, B.C. Phone 688-3504

SAMPLE(S) FROM
 STRATO GEOLOGICAL

Certificate of Analysis

REPORT NO.
 V 10737

SAMPLE(S) OF SOILS

Sample No.	Cu ppm	Mo ppm
ABL 92 10	57	2
12	62	1
ABL 96-CN	71	6
2	37	8
4	35	22
6	40	18
8	16	3
ABL 100-CN	50	4
2	48	3
4 ROCK	N.S.	N.S.
5 ROCK	N.S.	N.S.
ABL 104-N	52	<1
2	50	1
ABL 0- 2S	127	1
8	35	1
10	157	<1
12	161	<1
14	76	1
15	151	<1
ABL 4- 2S	40	1
8	102	<1
10	100	1
12	58	1
14	134	<1
15	77	2
ABL 8- 2S	N.S.	N.S.
8	128	2
10	37	1
12	131	1
14	43	<1
15	84	<1
ABL 12-4S	146	1
8	202	1
10	44	<1
12	110	<1
14	208	1
15	101	1
ABL 162S	24	1
8	79	<1
10	88	<1

DATE Oct. 26, 1971.

SIGNED *L. H. [Signature]*

ASSAYERS
CHEMISTS
GEOCHEMISTS



CORE LABORATORIES - CANADA LTD.

325 Howe Street Vancouver 1, B.C. Phone 688-3504

SAMPLE(S) FROM
STRATO GEOLOGICAL

Certificate of Analysis

REPORT NO.
V 10737

SAMPLE(S) OF Soils

Sample No.	Cu ppm	Mo ppm
ABL 44-23	50	<1
14	48	<1
15	45	<1
ABL 48-23	27	<1
4	28	1
6	31	1
8	38	<1
10	45	<1
12	45	<1
14	35	<1
15	38	<1
ABL 52-23	27	<1
4	24	<1
6	30	<1
8	24	1
10	45	<1
14A	44	<1
14B	46	<1
15	40	<1
ABL 56-23	27	1
4	23	4
6	40	<1
8	38	<1
10	42	1
12	43	<1
14	41	1
15	44	1
ABL 60-23	22	1
4	26	1
6	27	<1
8	35	1
10	34	<1
12	36	1
14	34	1
15	40	1
ABL 64-23	32	1
4	50	1
6	52	<1
8	38	<1
10	41	<1

DATE Oct. 26, 1971.

SIGNED [Signature]

PULP AND REJECTS DISCARDED AFTER 3 MONTHS

ASSAYERS
CHEMISTS
GEOCHEMISTS



CORE LABORATORIES - CANADA LTD.

325 Howe Street Vancouver 1, B.C. Phone 688-3504

SAMPLE(S) FROM
STRATO GEOLOGICAL

Certificate of Analysis

REPORT NO.
V 10737

SAMPLE(S) OF SOILS

Sample No.	Cu ppm	Mo ppm
ABL 12-12S	76	1
14	228	<1
15	117	<1
ABL 20-2S	29	1
4	19	<1
ABL 24-2S	18	<1
4	18	<1
ABL 28-2S	13	<1
4	18	<1
6	18	<1
10	29	1
12	22	1
14	36	<1
15	73	<1
ABL 32-2S	15	<1
6	20	1
8	19	<1
10	15	<1
12	14	1
14	19	1
15	25	<1
ABL 36-2S	15	1
6	24	1
8	23	1
10	25	<1
12	18	<1
14	25	<1
15	39	<1
ABL 40-2S	21	1
4	21	1
8	59	1
10	25	1
12	41	1
14	45	1
15	44	<1
ABL 44-2S	21	1
4	21	<1
6	25	1
8	27	1
10	31	<1

DATE Oct. 27, 1971.

SIGNED *[Signature]*

PULP AND REJECTS DISCARDED AFTER 3 MONTHS

ASSAYERS
CHEMISTS
GEOCHEMISTS



CORE LABORATORIES - CANADA LTD.

325 Howe Street Vancouver 1, B.C. Phone 688-3504

SAMPLE(S) FROM
STRATO GEOLOGICAL

Certificate of Analysis

REPORT NO.

V 10737

SAMPLE(S) OF SOILS

Sample No.	Ca ppm	Mo ppm
ABL 64- 12S	39	<1
14	40	<1
15	35	<1
ABL 68- 2S	47	<1
4	27	<1
6	27	<1
8	22	1
10	40	<1
12	70	1
14	46	<1
15	35	<1
ABL 72- 2S	29	1
4	34	<1
6	36	<1
8	39	1
10	49	1
12	41	<1
14	47	1
15	44	1
ABL 76- 2S	17	1
4	26	1
6	36	<1
8	36	<1
10	33	<1
12	40	<1
14	87	1
15	46	<1
ABL 80- 2S	26	1
4	30	<1
6	29	1
8	45	<1
10	36	1
12	44	1
14	49	1
15	47	1
ABL 84- 2S	29	<1
4	35	<1
6	45	1
8	40	1
10	46	1

DATE Oct. 26, 1971.

SIGNED *R. D. Stoll*

ASSAYERS
CHEMISTS
GEOCHEMISTS



CORE LABORATORIES - CANADA LTD.

325 Howe Street Vancouver 1, B.C. Phone 688-3504

SAMPLE(S) FROM
STRATO GEOLOGICAL

Certificate of Analysis

REPORT NO.
V 10737

SAMPLE(S) OF SOILS

Sample No.	Cu ppm	Pb ppm
ABL 84 - 12S	45	<1
14	39	<1
15	41	<1
ABL 88 - 2S	40	1
4	39	<1
6	34	<1
8	37	<1
10	39	<1
12	37	<1
14	44	<1
15	90	<1
ABL 92 - 2S	38	1
4	43	1
6	41	<1
8	40	<1
10	45	1
12	42	<1
14	32	1
15	305	<1
ABL 96 - 2S	42	<1
4	37	<1
6	39	<1
8	38	<1
10	35	<1
12	38	1
14	370	1
15	N.S.	N.S.
ABL 100 - 2S	45	1
4	44	<1
6	42	<1
8	40	1
10	39	1
12	39	1
14	41	1
15	77	<1
ABL 104 - 2S	43	1
4	42	1
6	45	3
8	50	1
10	58	<1

DATE Oct. 26, 1971.

SIGNED [Signature]

ASSAYERS
CHEMISTS
GEOCHEMISTS



CORE LABORATORIES - CANADA LTD.

325 Howe Street Vancouver 1, B.C. Phone 688-3504

SAMPLE(S) FROM
STRATO GEOLOGICAL

Certificate of Analysis

REPORT NO.
V 10737

SAMPLE(S) OF SOILS

Sample No.	Cu ppm	Mo ppm
ABL 104-123	38	<1
14	45	<1
15	50	<1
U.P.-C.R. 100	78	<1
500	53	1
900	32	1
1300	25	1
1700	34	1
2100	23	<1
2500	22	<1
2900	23	<1
3300	26	2
3700	20	<1
4100	19	1
4500	23	<1

Handwritten: 1149-5 OK
SITE
SAMPLES

HOT PERCHLORIC ACID EXTRACTION
DETERMINED BY A.A.

ppm - Parts Per Million.

DATE Oct. 26, 1971.

SIGNED [Signature]

PULP AND REJECTS DISCARDED AFTER 3 MONTHS

ASSAYERS
CHEMISTS
GEOCHEMISTS



CORE LABORATORIES - CANADA LTD.

325 Howe Street Vancouver 1, B.C. Phone 688-3504

Certificate of Analysis

SEMIQUANTITATIVE SPECTROGRAPHIC

REPORT NO.

V 10908

Sample(s) From **STRATO GEOLOGICAL**

Sample(s) Of **ROCK**

Semiquantitative Spectrographic Analysis:

	Sample 1	Sample 2		Sample 1	Sample 2	Sample
Antimony	ND	ND	Lithium (Li ₂ O)	-	-	
Arsenic	TRACE	ND	Manganese	.002%	.08%	
Barium	.01%	.01%	Mercury	-	-	
Beryllium (BeO)	ND	ND	Molybdenum	.001%	.01%	
Bismuth	ND	ND	Nickel	TRACE	.002%	
Cadmium	ND	ND	Silver	TRACE	TRACE	
Cerium (CeO ₂)	-	-	Tantalum (Ta ₂ O ₅)	-	-	
Chromium	TRACE	TRACE	Thorium (ThO ₂)	-	-	
Cobalt	ND	.01%	Tin	ND	TRACE	
Columbium (Cb ₂ O ₅)	-	-	Titanium	.02%	.15%	
Copper	.06%	MAJOR	Tungsten	ND	.05%	
Gallium	ND	TRACE	Uranium (U ₃ O ₈)	-	-	
Germanium	-	-	Vanadium	TRACE	.003%	
Indium	-	-	Zinc	TRACE	.08%	
Iron	.5%	MATRIX	Zirconium (ZrO ₂)	-	-	
Lead	ND	ND				
Aluminum	.1%	.2%	Potassium	TRACE	.5%	
Boron	TRACE	TRACE	Magnesium	.05%	1.0%	
Calcium	.1%	5.0%	Sodium	TRACE	.2%	
Silicon	MATRIX	MAJOR				

Figures are approximate:

H - High - 10 - 100% approx.
MH - Medium High - 5 - 50% approx.
M - Medium - 1 - 10% approx.
LM - Low Medium - .5 - 5% approx.
L - Low - .1 - 1% approx.

CODE

TL - Trace Low - .05 - .5% approx.
T - Trace - .01 - .1% approx.
FT - Faint Trace - approx. less than .01%.
PT - Possible Trace - Presence not certain.
- - Not Detected - Elements looked for but not found.

Matrix - Major Constituent
Major - Above normal spectrographic range.

DATE Nov 25, 1971.

SIGNED L. D. Fuller

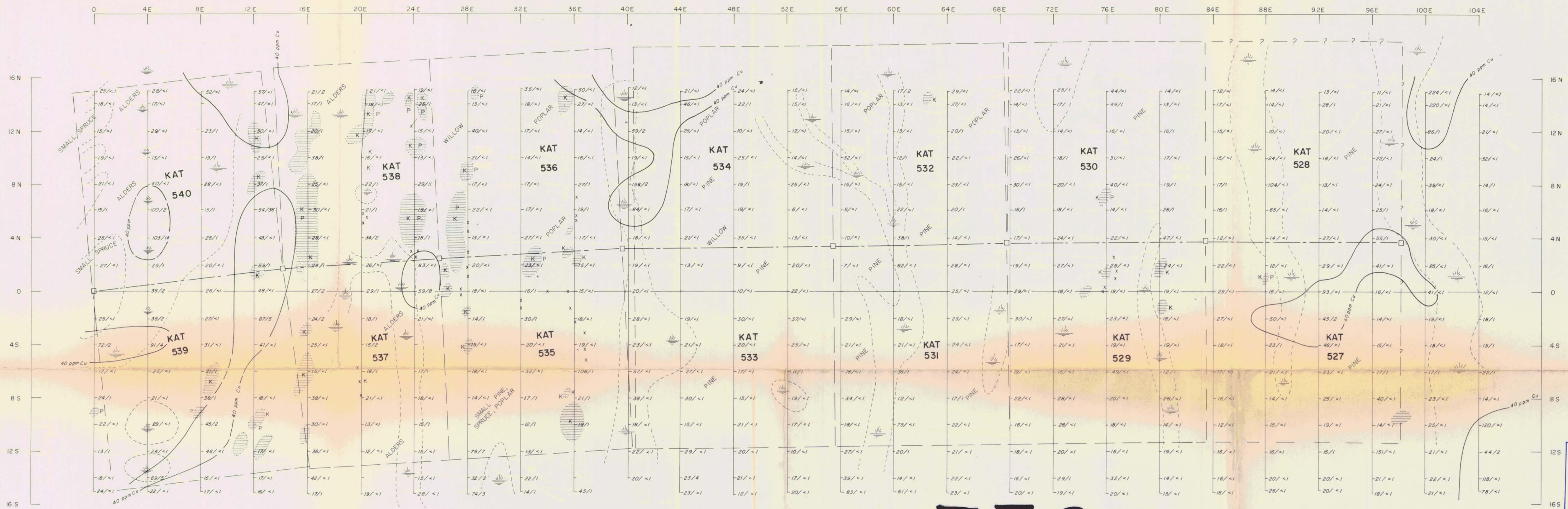

3395
M-5

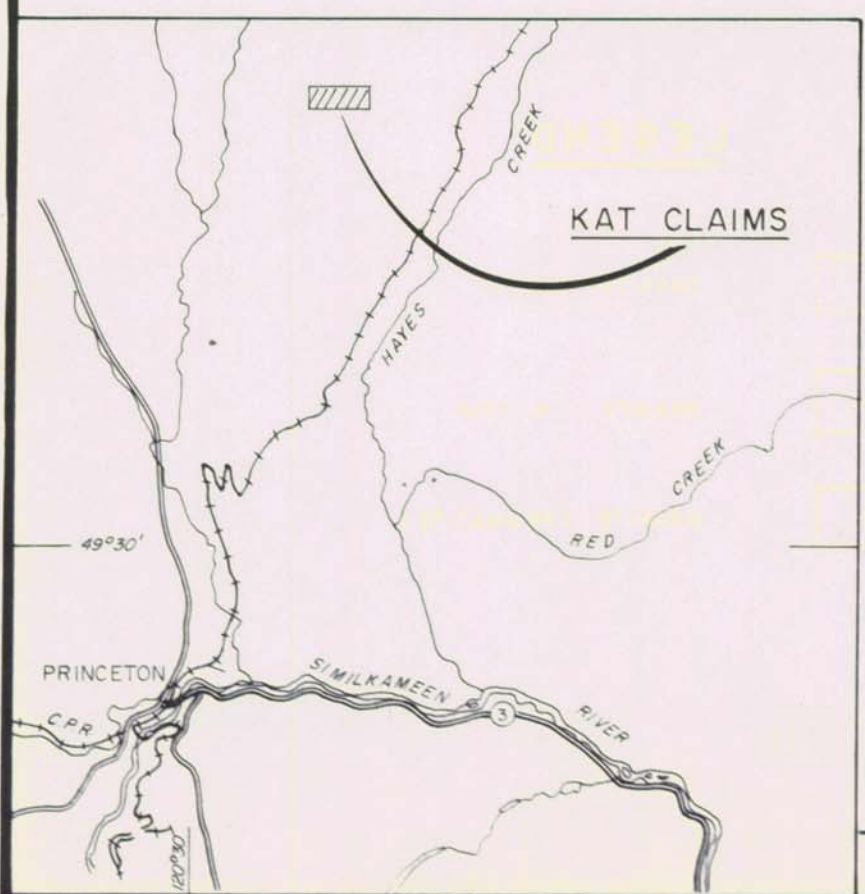

KEY PLAN, SHOWING LOCATION OF CLAIMS

LEGEND

- GRANITE (GREY)
- GRANITE (K-SPAR)
- GRANITE (PEGMATITE)

SYMBOLS

- ROCK OUTCROPS
- BOULDERS
- CREEK
- STRIKE & DIP
- FAULT (Inferred)
- GEOCHEMICAL SOIL SAMPLE LOCATION
- Cu/Mo IN ppm
- SWAMP
- CLAIM POST

ABELLA RESOURCES LTD. (N.P.L.)
KAT CLAIM GROUP
SIMILKAMEEN MINING DIVISION
GEOLOGY AND GEOCHEMICAL PLAN

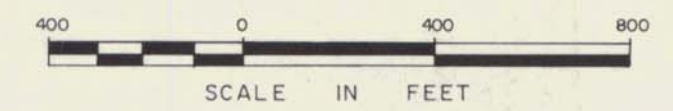

DECEMBER 1, 1971



GEOLOGY AND GEOCHEMICAL SOIL SAMPLING BY:
STRATO GEOLOGICAL LTD.
615 W. HASTINGS ST. VANCOUVER, B.C.

U. Feis



Donald W. Tully

Department of
Mines and Petroleum Resources
ASSESSMENT REPORT
NO. 3375 MAP #5



Department of
Mines and Petroleum Resources
ASSESSMENT REPORT
NO 3375 MAP #6

ABELLA RESOURCES LTD. (N.P.L.)
ELAINE CLAIM GROUP
SIMILKAMEEN MINING DIVISION
GEOLOGY AND GEOCHEMICAL PLAN

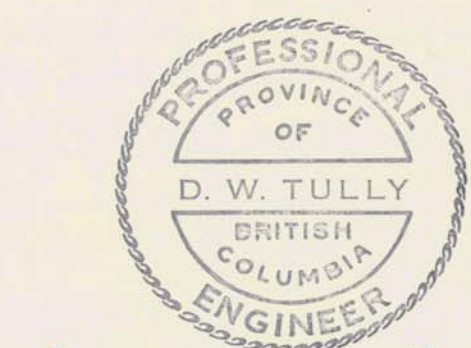

Donald W. Tully

SCALE IN FEET
0 100 200 300 400

DECEMBER 1, 1971

GEOLOGY AND GEOCHEMICAL SOIL SAMPLING BY:
STRATO GEOLOGICAL LTD.
615 W. HASTINGS ST. VANCOUVER, B.C.

LEGEND

- GRANITE (GREY)
- GRANITE (K-SPARK)
- GRANITE (CHLORITIZED)
- NICOLA VOLCANICS

SYMBOLS

- ROCK OUTCROPS
- BULLDENERS
- CREEK
- STRIKE & DIP
- GEOCHEMICAL SILT SAMPLE LOCATION
- GEOCHEMICAL SOIL SAMPLE LOCATION
- Cu/Mo IN ppm
- SWAMP
- CLAIM POST
- SITE OF OLD WORKINGS
- FAULT (Inferred)
- PIPELINE

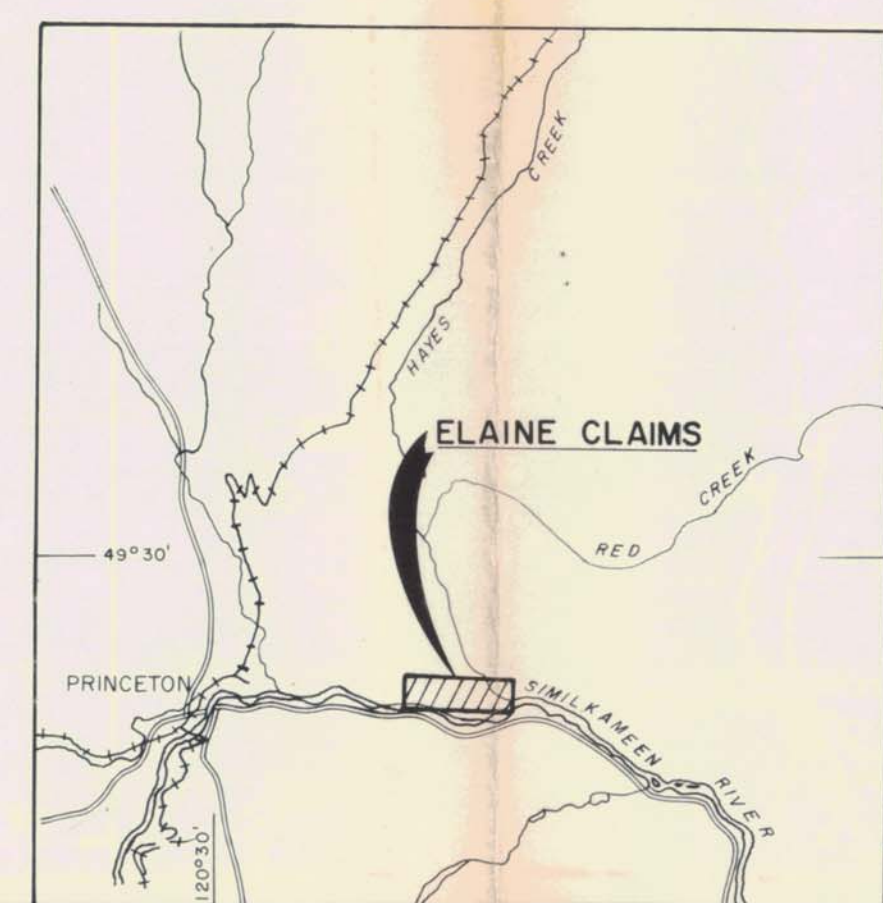

KEY PLAN, SHOWING LOCATION OF CLAIMS

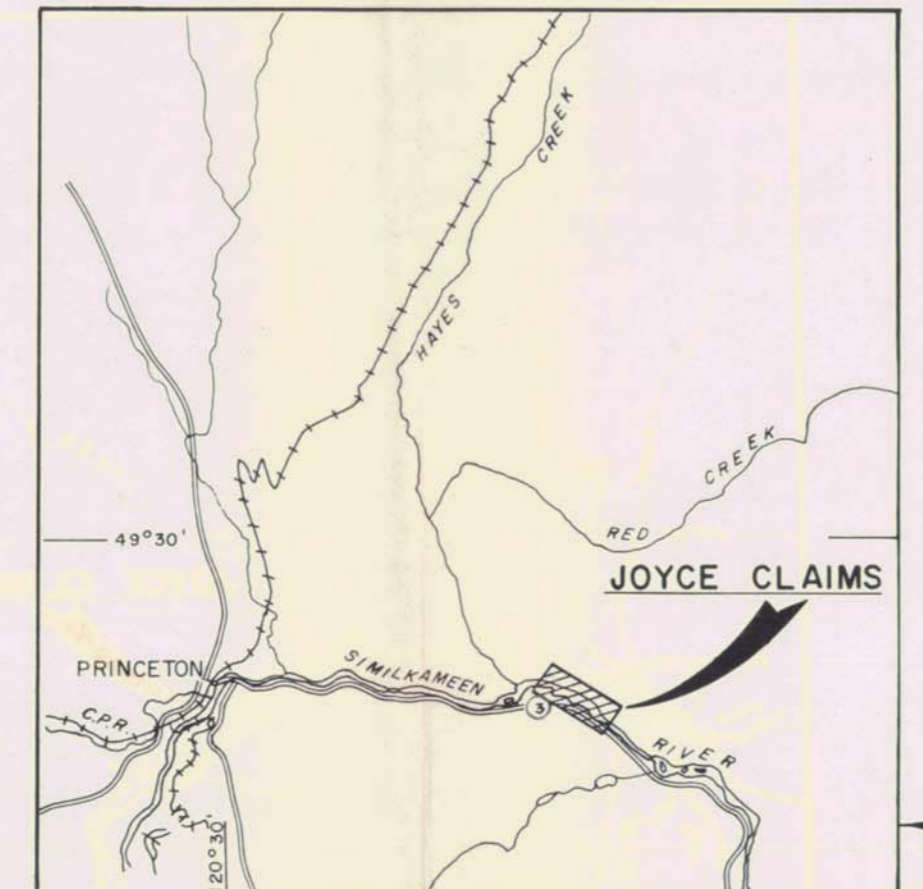
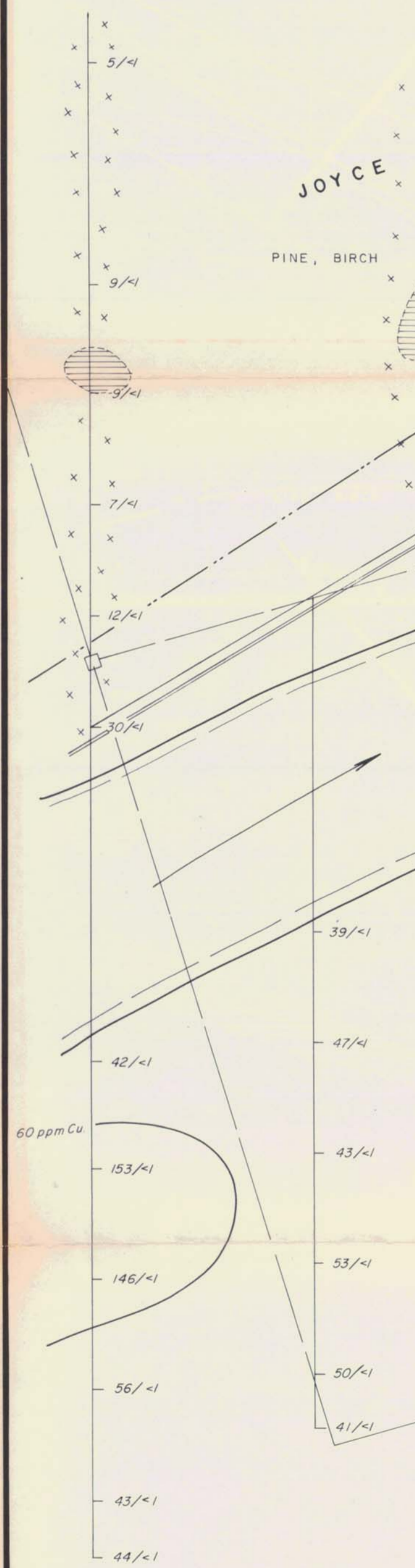
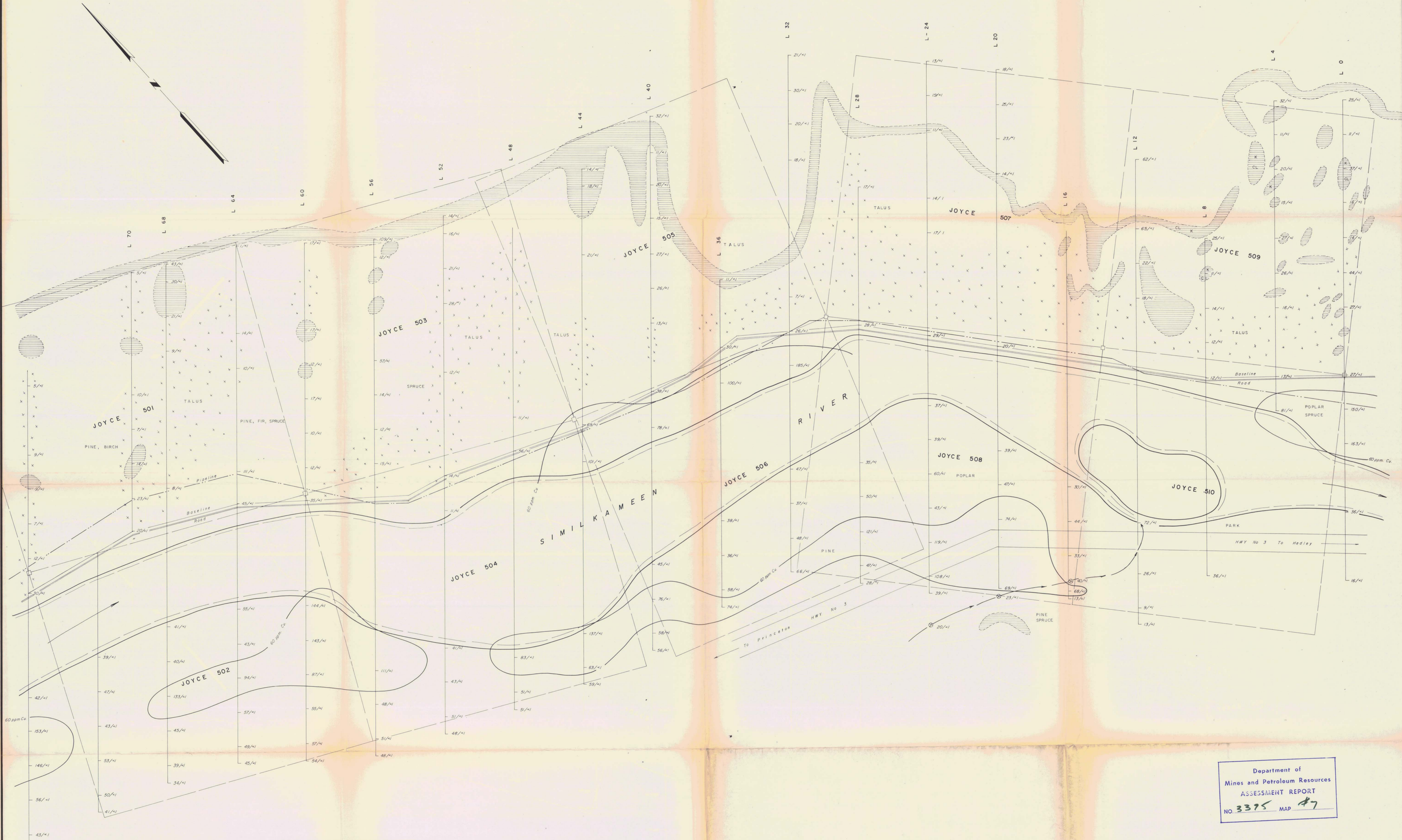
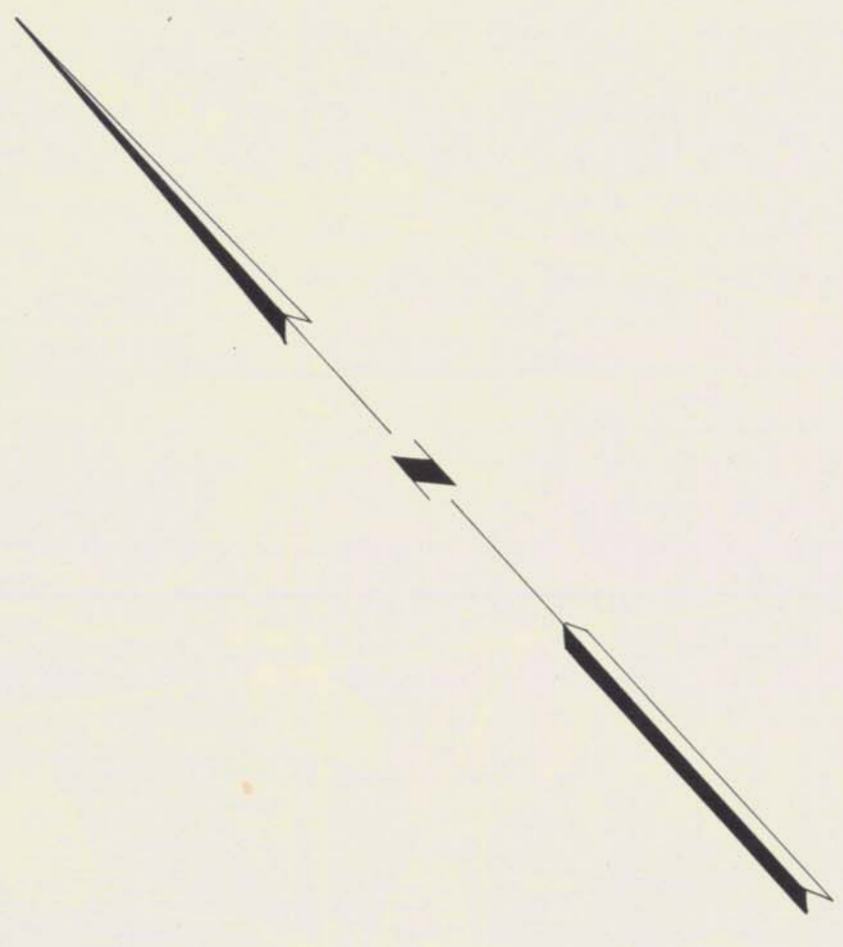

KEY PLAN, SHOWING LOCATION OF CLAIMS

LEGEND

- GRANITE (GREY)
- GRANITE (K-SPAR)
- GRANITE (CHLORITIZED)

SYMBOLS

- ROCK OUTCROPS
- BOULDERS
- CREEK
- STRIKE & DIP
- GEOCHEMICAL SOIL SAMPLE LOCATION
- GEOCHEMICAL SOIL SAMPLE LOCATION
- Cu/Mo IN ppm
- SWAMP
- CLAIM POST
- FAULT (Inferred)
- PIPELINE

Department of
Mines and Petroleum Resources
ASSESSMENT REPORT
NO. 3375 MAP #7

ABELLA RESOURCES LTD. (N.P.L.)
JOYCE CLAIM GROUP
SIMILKAMEEN MINING DIVISION
GEOLOGY AND GEOCHEMICAL PLAN

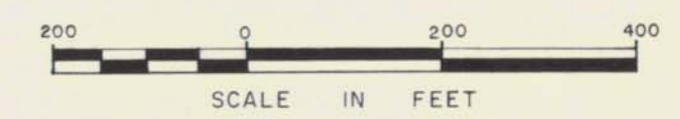

DECEMBER 1, 1971

GEOLOGY AND GEOCHEMICAL SOIL SAMPLING BY:
STRATO GEOLOGICAL LTD.
615 W. HASTINGS ST. VANCOUVER, B.C.



Donald W. Tully