

ELC GEOPHYSICAL REPORT NO. GC-M-131B-71
FOR MAMIT LAKE MINES LTD.
ED AND DUDE CLAIMS GROUPS
HIGHLAND VALLEY AREA, B.C. 50° N - 120° W
NOVEMBER 5th 1971 to JANUARY 31, 1972.

92 I / 7W

TABLE OF CONTENTS

	<u>PAGE</u>
Purpose	1
Presentation	1
Instrumentation	2
Geochem Sampling Method	2
Geological Reference	3
Location	3
Personnel	4
Results	4
Geochemical Results	5
Correlation Conclusions	6
Statement of Costs	8

3526

PLANS

✓ Magnetometer Contour Plan	M-131B-71-PC
3 Geochem Contour Plan	GC-131B-71-C
✓ Location Plan	GC-M-131B-71-L

ELC GEOPHYSICS LTD.
250 N. Grosvenor Ave.
Burnaby 2, B.C.

298-9619

Department of
Mines and Petroleum Resources
ASSESSMENT REPORT

NO. 3526 MAP _____

elc geophysics ltd.

250 NORTH GROSVENOR, VANCOUVER, CANADA TELEPHONE: (604) 298-9619

ELC GEOPHYSICAL REPORT NO. GC-M-131B-71 FOR MAMIT LAKE MINES LTD. OVER THE ED AND DUDE CLAIMS GROUPS IN THE HIGHLAND VALLEY AREA, B. C. NOVEMBER 5th, 1971 to D JANUARY 31, 1972.

Purpose:

The purpose of this combined geochem and magnetometer survey was to determine possible extension of anomalous features to the south of previous MLM surveys. This work constitutes a step in the extension to the south utilizing a common base line, for co-ordinate and geophysical continuity.

Presentation:

The plan M-131B-71-PC shows the results of the magnetometer survey in both profile and contour form, to thereby delineate linear strikes and areas having magnetic low and high anomalous features.

The GC-131B-71-C indicates the values of the geochemical determinations in ppm of CU and the contours encompass the areas of values in excess of 75 ppm.

...con't...

There were 172 soil samples taken at 200 foot intervals along the grid lines.

The summation and conclusions of the results presented herein will be presented in a subsequent report covering the many surveys conducted in this area of the Mamit Lake property and will include control maps.

Instrumentation:

The magnetometer survey was conducted with a Sabre M100 direct reading vertical field self-leveling fluxgate magnetometer made by Sabre Electronics Ltd. Vancouver, B.C.

Geochemical Sampling Method:

The samples were taken from the "B" horizon first by removal of any overlying debris, then digging a hole, using a round mouthed spade, approximately 15 inches below the surface. A sample from the hole was

...con't...

packaged using a standard kraft soil bag obtained from Acme Analytical Laboratories Ltd.

The soil depth samples were taken from the "B" horizon every three inches to a depth of 2 feet. The sample determinations were made by Acme Analytical Laboratories Ltd. 6455 Laurel Street, Burnaby, B.C.

Geological Reference:

B.C. Department of Mines and Petroleum Resources, Bulletin No. 56, Geology of the Guichon Creek Batholith, by K.E. Northcote.

A summary report on a geological investigation of the MLM and GCM claims groups by W.M. Sharp, P. Eng. June 1968.

Location:

The areas shown on our plan GC-M-131B-71-L cover a block of claims immediately west of Mamit Lake, B.C. located on the highway between Merritt and Kamloops, B.C. Latitude 50° N longitude 120° W.

...con't...

Personnel:

The survey was conducted by W. Mather, assisted by E. Wiggins, J. Wells and K. Pettersen. The magnetometer survey included 36,200 feet of line, with station spacing at 100 foot intervals, reduced to 50 foot intervals in anomalous areas. A total of 172 geochem samplings were recorded.

Results:

The magnetometer results are shown on plan M-131B-71-PC, The linear anomaly L1 crossing the southern portion of the base line is closely associated with the magnetic low ML1. The magnetic high linear MH2 is closely associated with the magnetic high contour MH2A. The prominent magnetic high Mh2B forms a curve similar to ML1 through a very anomalous area.

The long linear L4 extending nearly north and south seems to be associated with the magnetic low contour ML4. The prominent magnetic low indicated by the bedding strike B1 is directly associated with the magnetic low contour MLB1 and seems to form a semi-circular pattern peculiar to the area. The linear anomalies L3 and L5 involve magnetic highs shown by

...con't...

the contour MH5. The linear L6 in the southwest cuts through the anomalies L4 and the bedding anomaly B1 and apparently westerly through the linear anomaly L3, although there is insufficient control to substantiate this. East of the base line, (with the exception of the linear anomaly L7) there is a marked reduction of the anomalous features indicating an increase in overburden.

Geochemical Results:

Referring to the plan GC-131B-71-C the northern anomalous feature GC1C crossing the baseline corresponds with the anomalous feature crossing line 42 S of the 131A survey. This substantiates the strike of the GC1 anomalies, extending through three survey plans.

The grid anomalies to the south within the contours exceeding 75 PPM of CU coincide with the more magnetic anomalous features. The relatively high background readings between the contours of GC11 and GC13 suggest some association exists between these two anomalies. The geochem anomaly GC11 falls closely to the magnetic linear anomaly L1 and terminates on MH2.

...con't...

The GC10 anomaly coincides with the general northwest southeast strike trend, and is apparently associated with the magnetic anomalies L6 and B1. The GC12 geochem contour anomaly follows closely with the magnetic linear L5 and the magnetic high MH5. The curvature of the bedding indicated at B1 of the magnetic survey suggests that GC12 and GC14 may be associated.

Correlation Conclusions:

The strong magnetic anomalies in the vicinity of L1 and MH2 make the area between MH2, and the base line, to the southern edge of the survey a zone of major interest. The associated geochem anomaly GC11, exists over an area of considerable fracturing and little overburden. The trenching indicated on the geochem plan is mostly north and east of the GC11 anomaly but does exist between GC11 and GC13. The results from this surface work should aid considerably in assessing the value of the GC11 anomaly. GC10 follows the area trend north west, southeast and probably warrants extension to the west.

The anomalous zone including GC11 and GC13

...con't...

warrants further work to the south in the vicinity of the base line, in the general strike of GCl1.

The source validity of all the geochem anomalies will be reported in the accumulated assessment report to follow.

cb

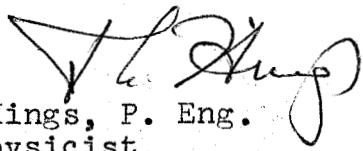
D.L.Hings, P. Eng.
Geophysicist.

A statement of costs for Geophysical Survey No. GC-M-131B-71
Covering the ED and DUDE Claims Groups
Highland Valley Area, B.C.
50° N - 120° W.
For Mamit Lake Mines Ltd.
November 5th, 1971 to JAN. 31, 1972.

Field Crew

W. Mather	9 days @ 45.00	405.00	
B. Wells	8 dyas @ 40.00	320.00	
K. Pettersen	4 days @ 40.00	160.00	
E. Wiggins	8 days @ 30.00	<u>240.00</u>	
			1125.00

Transportation

4 x 4 truck	8 days @ 12.00	96.00	
370 miles @ 12¢		<u>44.40</u>	
			140.40

Instruments & Equipment

1 magnetometer	8 days @ 10.00	80.00	
misc. supplies	8 dyas @ 5.00	<u>40.00</u>	
			120.00

Food & Lodging

28 mandays @ 12.00			336.00
--------------------	--	--	--------

Data Processing & Drafting

R.L.Reece	5 days @ 60.00	300.00	
D. A. Cramer	3 days @ 60.00	<u>180.00</u>	
			480.00

Interpretation & Report

D.L.Hings, P. Eng.			
2 1/2 days @ 120.00			300.00

Acme Analytical Labs. Ltd.

172 soil sample determinations			200.00
--------------------------------	--	--	--------

TOTAL			\$ 2701.40
-------	--	--	------------

LOCATION MAP

SCALE:- 1:50,000

DWG. NO. GC-M-131B-71-L

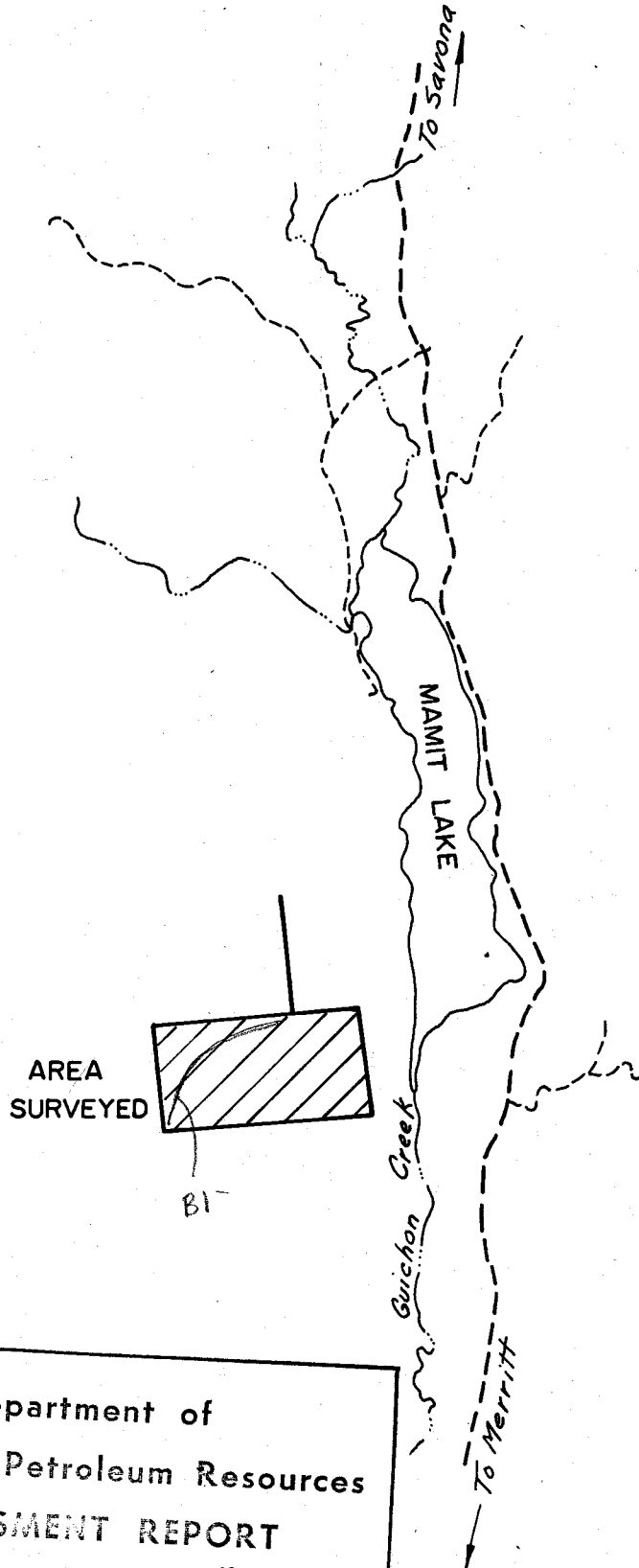

Department of
Mines and Petroleum Resources
ASSESSMENT REPORT
NO. 3526 MAP #1

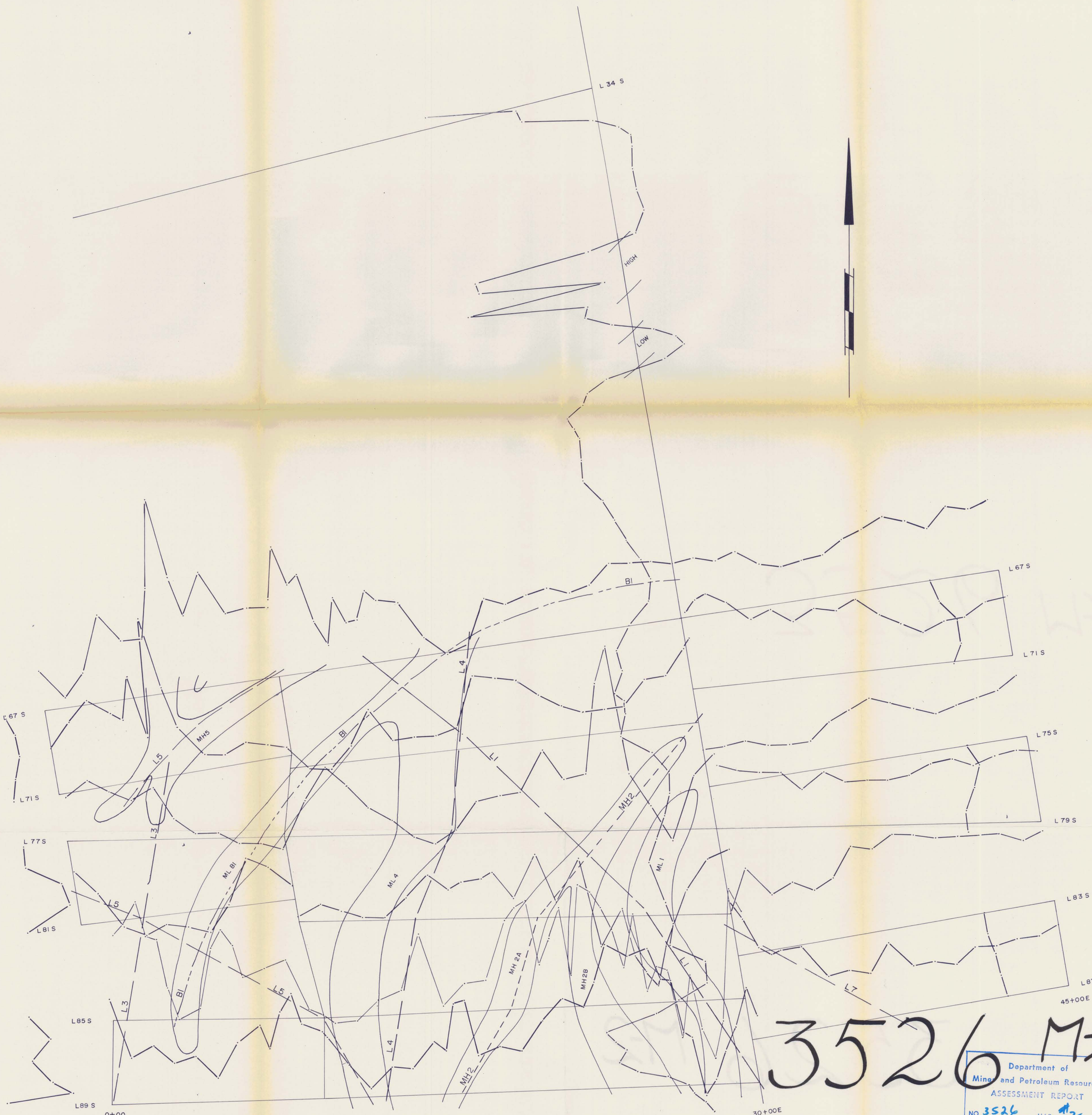

3526 M-2

Department of
 Mines and Petroleum Resources
 ASSESSMENT REPORT
 NO. 3526 MAP #2

ELC GEOPHYSICS LTD.
 ED, DUDE & MLM CLAIMS MAMIT LAKE AREA, B.C.
 MAMIT LAKE MINES LTD.
 JAN. 1972 SCALE: 1"=200' DWG. NO.:- M-131 B-71-PC
 MAG. PROFILES
 APPROVED *[Signature]*

NOTE:-
 SURVEY LINES
 ZERO LINE 55,000 GAMMAS (1"=1000 GAMMAS)
 LINEAR ANOMALY
 BEDDING STRIKE
 MAG HIGH AREA (MH)
 MAG HIGH LINEAR ANOMALY
 MAG LOW AREA (ML)



ELC GEOPHYSICS LTD.
 ED, DUDE & MLM CLAIMS MAMIT LAKE AREA, B.C.
 MAMIT LAKE MINES LTD.
 JAN. 1972 SCALE: 1"=200' DWG. NO.: GC-131B-71-C
 GEOCHEM PLAN
 APPROVED *[Signature]*

NOTE:-
 — SURVEY LINES & STATIONS
 ■ CLAIM POST
 — CLAIM LINES
 ○ 70 PPM CU CONTOUR
 3/3 PPM CU
 3 PPM MO

Department of
 Mines and Petroleum Resources
 ASSESSMENT REPORT
 NO. 3526 MAP #3