

92I/11E

GEOLOGICAL REPORT ON THE

Property of GRANDORA EXPLORATIONS

LTD. (N.P.L.), HIGHLAND VALLEY, B.C.

NED 1-4 Fr., DEN 9, 11, 13, 15, 17,
19 - 37, 47 - 62, 78 - 80, 84, 85,
FC 1 - 4 Fr., LEM Fr., ELKE 1 - 2 Fr.,
DN 1 - 5 Fr.,

Situated on SW slope of South Forge
Mountain, Kamloops Mining Division.

50° 32'N, 121° 03'W.

Submitted by: D.P. Taylor, Geologist
Endorsed by: R.H.D. Philp, P. Eng.

Owner: GRANDORA EXPLORATIONS LTD. (NPL)
Adara Mining Ltd.

Work conducted by: Agilis Exploration
Services Ltd.

3660

GEOLOGICAL REPORT
ON THE PROPERTY OF
GRANDORA EXPLORATIONS LTD. (N.P.L.)
HIGHLAND VALLEY,
KAMLOOPS MINING DISTRICT, B.C.

Department of
Mines and Petroleum Resources
ASSESSMENT REPORT
NO. 3660 MAP.....

March 9, 1972

Kamloops, B.C.

TABLE OF CONTENTS

	Page
INTRODUCTION.....	1
REGIONAL GEOLOGY.....	1
WORK DONE, APRIL 1972.....	2
PROPERTY GEOLOGY.....	2

MAP:

Claims map	1" = 2000'
Geological Plan	1" = 500'

GEOLOGICAL REPORT ON THE
PROPERTY OF GRANDORA EXPLORATIONS LTD. (NPL)
HIGHLAND VALLEY, KAMLOOPS MINING DISTRICT, B.C.

INTRODUCTION:

Grandora Explorations Highland Valley property (formerly Adara Mining Ltd.) lies 15 miles south and 10 1/2 miles east of Ashcroft, on the southwest slope of South Forge Mountain. The property is in the National Topographic System area 92 I/11 (E) and is in the Kamloops Mining Division. The centre of the property is located latitude 50° 32'N, longitude 121° 03'W.

The property is accessible from Ashcroft by 25 miles of paved road. There is jeep road access within the property.

REGIONAL GEOLOGY:

The property is entirely within the Guichon Batholith, a complex intrusive emplaced in the Mid-Triassic to Lower Jurassic period. The batholith is cut by several major faults, one of which the Lornex Fault bisects the property.

Two phases of the Guichon Batholith have been identified on the property, namely the Bethlehem phase and the Beaver

phase (sometimes called Guichon) quartz diorites. Kamloops volcanics occur on the north end of the property, capping South Forge Mountain.

WORK DONE, APRIL 1972:

A geologist, D.P. Taylor, and two linecutters initiated an exploration program April 18th, 1972. Line cutting, clearing and marking of old lines and grids, and geological mapping was carried out on the property up to and including May 1, 1972. 45,000 feet of new line was cut and 80,000 feet of line and grid was remarked and cleared in this time. Reconnaissance mapping was conducted over the entire property below 5,500 feet in elevation (the deep snow level) and detailed mapping was completed on the grid over the entire area south of line 40N.

PROPERTY GEOLOGY:

Two rock types predominate on the property, the Bethlehem and the Beaver (Guichon) phases of the Guichon Batholith. Both rock types are quartz diorites but textured and potash feldspar content differences makes them fairly distinct.

The Bethlehem quartz diorite is a medium grained rock of quartz dioritic composition which tends to be fairly low in mafic content and may carry less than 8% potash feldspars.

This rock tends to weather fairly easily and is generally found at lower elevations.

The Beaver quartz diorite is a medium grained rock which is generally finer grained than the Bethlehem and lacks noticeable potash feldspars while being richer in mafics, particularly hornblende. In areas where there are Beaver - Bethlehem contacts the Beaver phase is frequently slightly altered by potash alteration, making it appear very similar to the Bethlehem phase.

The contact between the two phases is not well defined. It is locally broken, faulted, and interfingered with what are apparently large Beaver xenoliths in the Bethlehem, particularly along the east-west contact.

The Bethlehem-Beaver contact is north-south striking through DEN 37 to the area of DEN 29 which is covered by deep overburden. In this area the contact bears west and is very erratic but generally the contact zone can be said to cross DEN 21 and DEN 9 with an east-west strike.

The extreme north end of the property is apparently in Beaver quartz diorites but a tongue of Bethlehem comes very close to the property from the east and one outcrop was located on the southern boundary of LEM Fr. Too much snow was present at this high elevation for further mapping. There is also a tongue of Bethlehem quartz diorite off the

south eastern flank of the claim group, east of DEN 78 and NED 4 Fr. This area is covered with considerable overburden and the contact could not be accurately located.

Kamloops volcanics cap South Forge Mountain, apparently covering twelve to fifteen claims. These rocks are dark rhyolitic and andesitic tuffs moderately indurated, and apparently horizontal in attitude. Similar remnants are to be found east of DEN 79 and NED 4 Fr.

All rocks on the property are locally faulted and sheared. Strong north-south fracturing occurs locally over the entire property and must be related to the Lornex Fault which cuts the property from the west corner of DEN 17 through to west of DEN 52. West of the Lornex Fault shearing and faulting is predominantly oriented east-west, and north westerly. East of the Lornex Fault the faults and shears are predominantly northeasterly and northwesterly bearing. All fracturing is steep to vertical dipping.

Alteration is not particularly well developed in exposed sections of this property. Isolated chloritisation with epidote stringers is widespread. Secondary biotisation in and around fractures in Beaver quartz diorites is found, also in isolated occurrences. The Beaver quartz diorite is also frequently lightly altered by potash in areas close to the Bethlehem contact.

Exposed mineralisation is widely scattered in the rocks on the property. Surface weathering undoubtedly contributes to this. The mineralisation noted is predominantly bornite with malachite staining found in fine fractures. In open fractures mineralisation is generally accompanied by Kaolin though wallrock alteration is negligible. The extensive overburdened areas in the centre of the claim group around DEN 29 may be of interest in the search for concentrations of mineralisation. Drilling has shown the rocks in this area to be of a general grade of 0.01% copper. It is expected that most of the rocks seen would assay in this region should deep unweathered samples be taken. Structural weaknesses in the area may provide locations for increases, possibly to ore potential, in grade.

Extensive exploration is planned for the property starting in the late spring of 1972.

Submitted by: D.P. Taylor, Geologist.

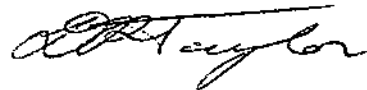

Endorsed by: R.H.D. Philp, P. Eng.



^{May}
~~March~~ 9, 1972

Kamloops, B.C.

CERTIFICATION

I, David Pelham Taylor of Vancouver, B.C. do hereby certify that:

1. I am an Exploration geologist residing at 2097 West 6th Avenue, Vancouver, B.C.
2. I am a graduate of the Royal School of Mines, London.
3. I have practiced as an exploration geologist in B.C. for four years.
4. Information contained in this report is based upon work performed by myself or at my direction between the period of April 18 to May 1, 1972.

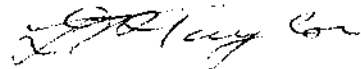

D.P. Taylor, B.A., D.I.C.

May 31, 1972

Vancouver, B.C.

MAP SHOWING LINE
CUTTING WORK DONE
IN APRIL, 1972

- NEWLY CUT LINE
- RE-MARKED AND MEASURED LINE

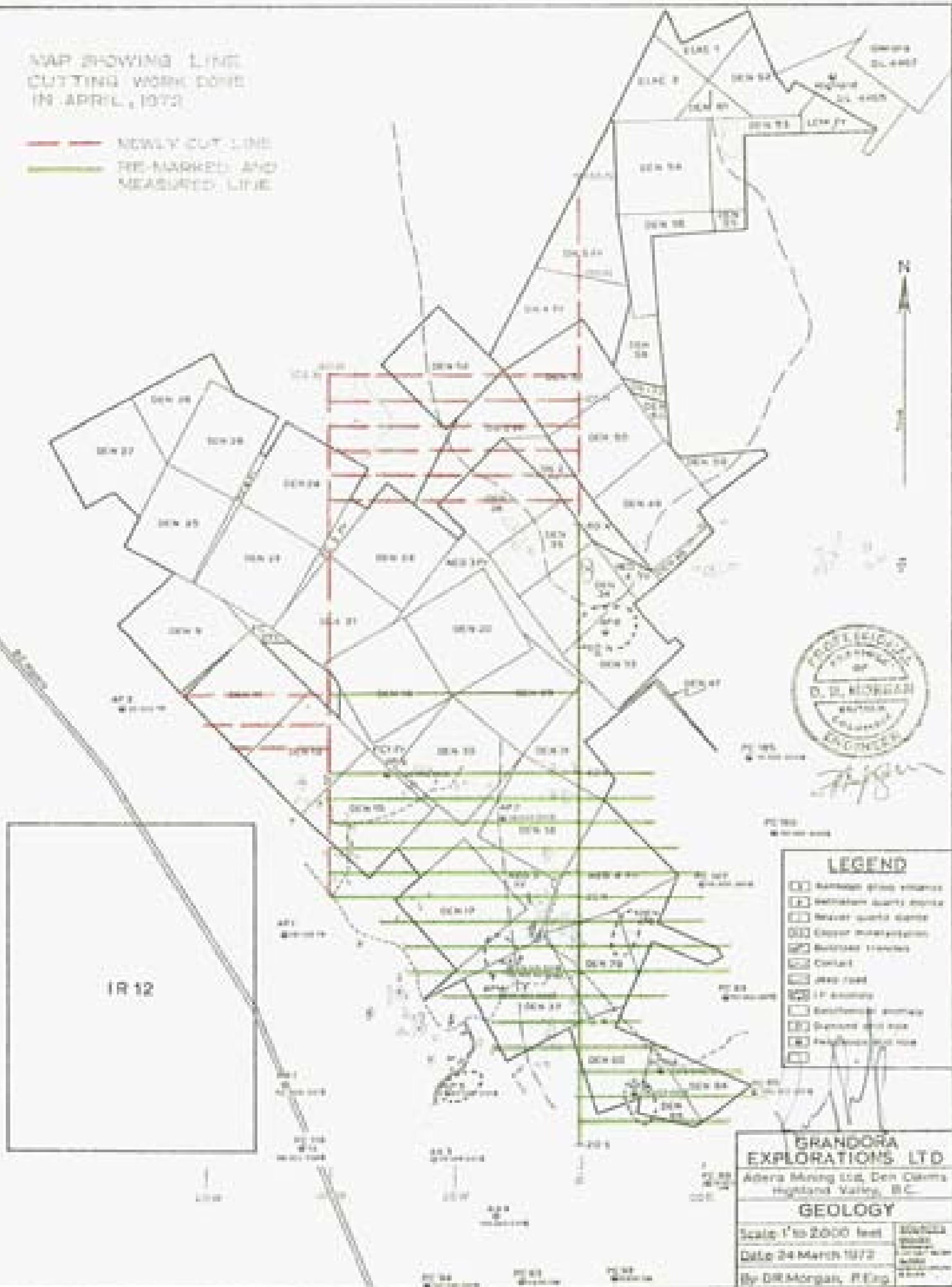

LEGEND

- Barrage grid zones
- Wetland areas zone
- Water table zone
- Slope boundaries
- Boundary lines
- Contact
- Access road
- 1/4 acre
- Sectional survey
- Section grid zone
- Re-marked and measured line

GRANDORA EXPLORATIONS LTD
Adena Mining Ltd, Den Cairns
Highland Valley, B.C.

GEOLOGY

Scale 1" to 2000 feet

Date 24 March 1972

By DR Morgan, P.Eng.

Department of
Mines and Petroleum Resources
ASSESSMENT REPORT
NO. 3660 MAP #1

DOMINION OF CANADA:
PROVINCE OF BRITISH COLUMBIA:
TO WIT:

In the Matter of the gridding and geological survey on the New Purple and New Green Groups Highland Valley, B.C.

I, Maria Tekler

of Agilis Exploration Services Ltd.
107 - 325 Howe Street,
Vancouver 1, B.C.

in the Province of British Columbia, do solemnly declare that the following costs were incurred and personnel employed in carrying out the work.

PERSONNEL:

R. Philp	- supervision - 2 days @ \$125./d	\$ 250.00
Dave Taylor	- geologist - field 14 days @ \$100.00/day	1,400.00
	- Office 2 days @ \$100.00/day	200.00
John Austin	- helper-14 days @ \$38.50/day	539.00
Mike Day	- helper-14 days @ \$38.50/day	<u>539.00</u>
		\$2,928.00

DISBURSEMENTS:

Assays	\$ 15.00	
Accommodation & board	419.30	
Meals and groceries	116.38	
Truck rental	216.58	
Gasoline and services	91.86	
Printing	8.65	
Supplies, equipment, draughting	<u>295.29</u>	
	\$1,163.06	1,163.06
+ 10% service charge		<u>116.30</u>
	Total	<u>\$4,207.36</u>

And I make this solemn declaration conscientiously believing it to be true, and knowing that it is of the same force and effect as if made under oath and by virtue of the "Canada Evidence Act."

Declared before me at the *City*
of *Vancouver*, in the
Province of British Columbia, this *16*
day of *May* 1972, A.D.

Maria Tekler

Julie Jensen
A Commissioner for taking Affidavits for British Columbia or
A Notary Public in and for the Province of British Columbia.

Sub-mining Recorder

In the Matter of

.....

.....

.....

.....

Statutory Declaration
(CANADA EVIDENCE ACT)

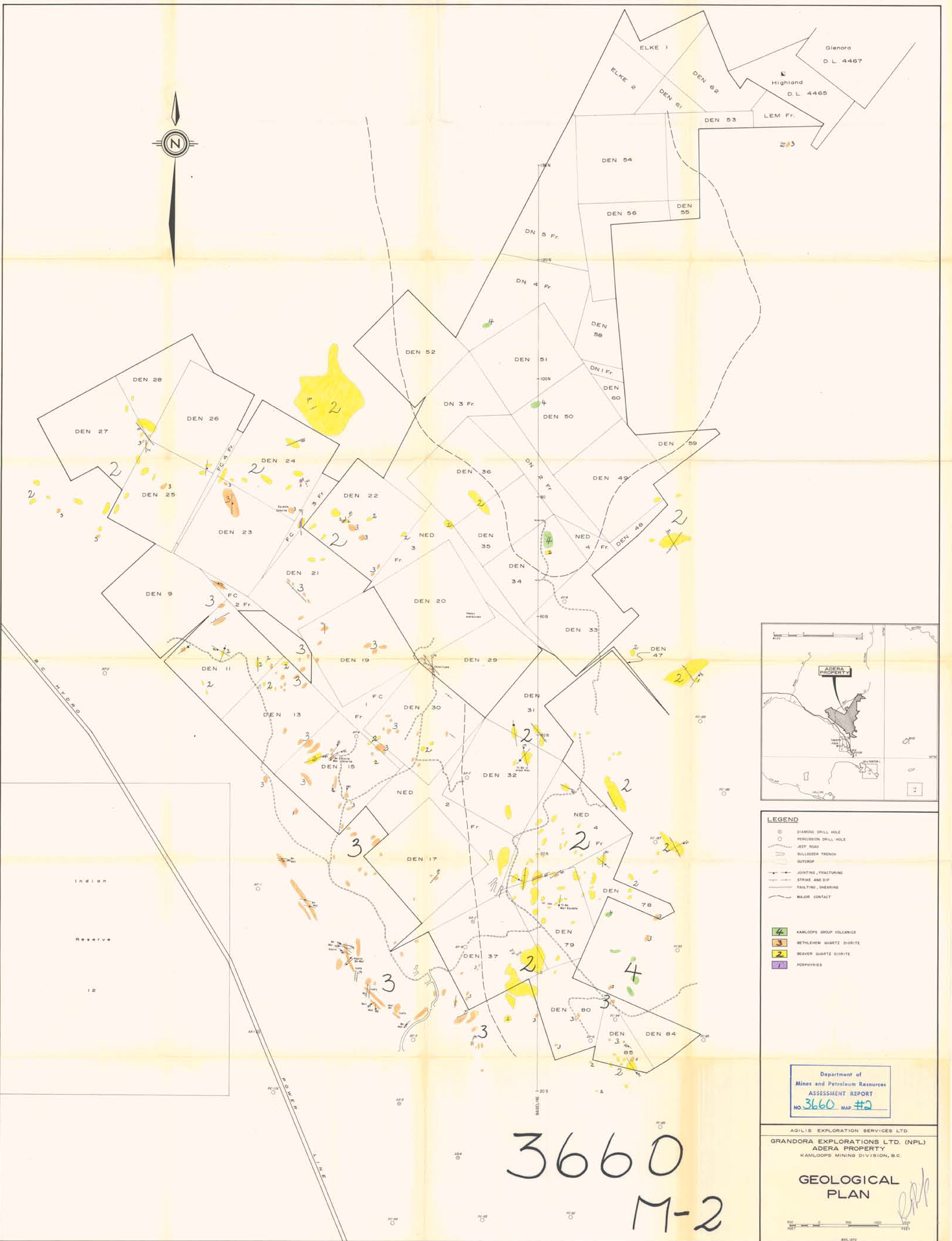

LEGEND

- ⊙ DIAMOND DRILL HOLE
- RECONSTRUCTION DRILL HOLE
- JEEP ROAD
- BULLDOZER TRENCH
- OUTCROP
- JOINTING, FRACTURING
- STRIKE AND DIP
- FAULTING, SHEARING
- MAJOR CONTACT

- 4 KAMLOOPS GROUP VOLCANICS
- 3 BETHLEHEM QUARTZ DiorITE
- 2 BEAVER QUARTZ DiorITE
- 7 PORPHYRIES

Department of
Mines and Petroleum Resources
ASSESSMENT REPORT
NO. 3660 MAP #2

AGILIS EXPLORATION SERVICES LTD.
GRANDORA EXPLORATIONS LTD. (NPL)
ADERA PROPERTY
KAMLOOPS MINING DIVISION, B.C.

GEOLOGICAL PLAN

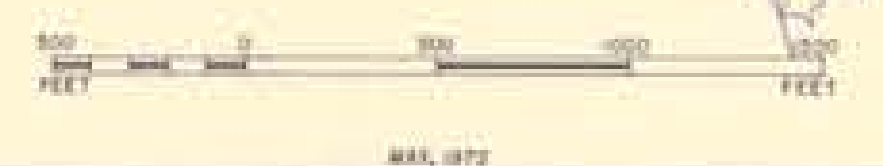

3660
M-2

epk