

Department of  
Mines and Petroleum Resources  
ASSESSMENT REPORT  
NO. 3717 MAP

17

REPORT ON THE GEOCHEMICAL WORK ON THE

KINGFISHER GROUP OF MINERAL CLAIMS

(DODGE, PAR, KINGFISHER, M&M4, M&M6, M&M8 )

Greenwood Mining Division  
Grand Forks, B.C.

82-E-9-SW

by  
P.S.Friesen, P.Eng.  
26 June 1972

General

This report describes the geochemical work done in 1972 on the KINGFISHER GROUP of mineral claims. Data for the report was supplied by Mr. Dewain Cox, P.O. Box 1165, Fabens, Texas - 79838, U.S.A.

The author examined the property in 1971.

Property

The Kingfisher Group consists of six claims as follows:

- DODGE 13038K
- PAR 13037K
- KINGFISHER 13036K
- M&M 4 E29276
- M&M 6 E29277
- M&M 8 E29278



7173

MAPS

#1. Geochemical Work

Property Location

The claims are situated in N.T.S. 82-E-9-SW in the Greenwood Mining Division, about 45 miles north of Grand Forks, B.C.

The UNION Mine lies immediately south of the claims.

Work Performed

Two pace-and-compass traverses were made across the property. Samples of soil were taken at 100 foot intervals along the lines and analysed for parts-per-million of lead, zinc, copper and silver.

Line A-A was made from south to northerly across the M&M<sup>8</sup> and M&M<sup>6</sup> mineral claims. Line B-B was made from west to easterly across the DODGE, M&M<sup>4</sup> and M&M<sup>6</sup> mineral claims.

Supervision

The work was supervised by Mr. Dewain Cox of Fabens, Texas. He is personally known to the author and is known to be capable of doing excellent work.

Work Periods

The collection of samples was carried out on April 24, 25 and 26, 1972.

The samples were analyzed June 8 and 12, 1972.



Employees

The actual collecting of samples was done by Mr. Clarence Gouthro and Ian McCallum, both of the Boundary District, B.C.

Method of Collecting Samples

Samples were collected with a shovel at a depth which assured that no organic material would be present in the sample. The samples were bagged individually and marked as indicated on the accompanying map.

Analysis of Samples

The soil samples were analysed by the atomic absorption method by:

El Paso Laboratories  
P.O. Box 1565  
El Paso, Texas 79948  
U.S.A.

Analysis Results

The analysis results of the soil samples are attached to this report. The corresponding number on the map shows the location from which the sample was taken.



Interpretation of Results

The geochemical results are extremely low and do not indicate the presence of any great concentration of lead, zinc, copper or silver in vein form. The lead and zinc values, however, increased as the Union Mine fault zone was approached.

The extent of the survey does not eliminate the possibility of High-grade veins or low-grade disseminations over larger areas occurring on the property.

This work can only be considered as a Logical step in the systematic survey of the claims where limited funds are available.

Cost of Survey

Two men for three days-plus truck rental -----	\$300.00
Assay report for lead and zinc -----	279.50
Assay report for copper and silver-----	258.00
Engineer's Report -----	100.00
TOTAL -----	\$937.50

Receipts for the above are appended; the original receipts are with the original report.

Not included in the costs are supervision fees of Dewain Cox which should be allowed.

Respectfully Submitted

  
P.S. Friesen, B.E., P.Eng.

26 June 1972

## EL PASO CHEMICAL LABORATORIES

Chemical, Environmental Testing  
Spectrographic-Atomic Absorption  
Assaying

P. O. Box 1585  
El Paso, Texas 79948

Lab. No. **39490** .....

**REPORT SHEET 1**

**Received**

Date **June 6, 1972** .....

**Reported:**

**June 8, 1972**

**Mr. Dewain M. Cox, Geologist**  
**P.O. Box 1165**  
**Fabens, Texas 79838**

**86 Geo-Chem samples rec: 6/6/72 for Pb and Zn marked as below; and reported in p.p.m.**

Sample Designation	Pb	Zn	Sample Designation	Pb	Zn
A-1	2.5	2.3	A-31	1.8	0.7
A-2	2.5	3.5	A-32	1.8	0.5
A-3	3.7	2.1	A-33	1.8	0.5
A-4	3.7	2.0	A-34	0.6	0.5
A-5	5.0	1.7	A-35	N11	0.8
A-6	3.7	1.2	A-36	1.8	1.2
A-7	2.5	0.6	A-37	2.5	1.0
A-8	5.0	1.2	A-38	1.2	1.3
A-9	1.2	1.3	A-39	1.2	1.0
A-10	1.8	6.1			
A-11	N11	0.8			
A-12	1.2	1.1			
A-13	1.2	1.2			
A-14	1.2	1.3			
A-15	N11	1.0			
A-16	1.8	1.0			
A-17	1.2	0.7			
A-18	N11	0.7			
A-19	1.3	0.8			
A-20	1.8	1.2			
A-21	1.2	0.9			
A-22	1.2	0.8			
A-23	2.5	1.0			
A-24	2.5	0.7			
A-25	1.2	0.8			
A-26	1.2	0.7			
A-27	1.8	0.4			
A-28	2.5	0.5			
A-29	1.2	0.5			
A-30	1.8	0.5			

# EL PASO CHEMICAL LABORATORIES

Chemical, Environmental Testing  
Spectrographic-Atomic Absorption  
Assaying

P. O. Box 1565  
El Paso, Texas 79948

Lab. No. 39493

REPORT SHEET 1

Received:

Date June 6, 1972

Reported:

June 12, 1972

Mr. Duwain M. Cox, Geologist  
P.O. Box 1165  
Fabens, Texas 79836

86 Geo-Chem samples rec: 6/6/72 for additional work ordered 8/9/72 for Silver and Copper  
as below: and reported in p.p.m.

Sample Designation	Ag	Cu	Sample Designation	Ag	Cu
A-1	N11	2.0	A-31	0.2	N11
A-2	N11	2.4	A-32	N11	N11
A-3	N11	1.2	A-33	N11	N11
A-4	N11	1.2	A-34	N11	N11
A-5	N11	0.8	A-35	0.5	N11
A-6	N11	5.2	A-36	N11	N11
A-7	N11	0.8	A-37	0.2	N11
A-8	N11	0.8	A-38	N11	0.8
A-9	N11	1.2	A-39	N11	0.4
A-10	N11	0.8			
A-11	N11	1.6			
A-12	N11	0.8			
A-13	N11	N11			
A-14	N11	0.4			
A-15	N11	1.6			
A-16	N11	0.8			
A-17	0.5	N11			
A-18	0.5	N11			
A-19	0.5	N11			
A-20	0.5	N11			
A-21	0.5	N11			
A-22	0.5	N11			
A-23	0.5	N11			
A-24	0.5	0.4			
A-25	0.5	0.4			
A-26	N11	N11			
A-27	N11	N11			
A-28	N11	N11			
A-29	N11	N11			
A-30	N11	N11			

# EL PASO CHEMICAL LABORATORIES

Chemical, Environmental Testing  
Spectrographic-Atomic Absorption  
Assaying

P. O. Box 1565  
El Paso, Texas 79948

Lab. No. 39490

REPORT SHEET -2

Received:  
Reported:

Date June 6, 1972  
June 8, 1972

Sample Designation	Pb	Zn	Sample Designation	Pb	Zn
B-1	2.5	1.0	B-26	1.2	1.2
B-2	1.2	0.7	B-27	Ni1	0.6
B-3	1.8	0.5	B-28	1.2	0.6
B-4	2.5	0.2	B-29	1.2	1.1
B-5	3.7	0.4	B-30	1.2	0.5
B-6	3.7	0.9	B-31	Ni1	0.6
B-7	2.5	0.8	B-32	Ni1	1.0
B-8	2.5	0.5	B-33	Ni1	0.5
B-9	1.2	1.4	B-34	Ni1	0.3
B-10	2.5	1.3	B-35	Ni1	0.3
B-11	1.8	0.7	B-36	1.2	0.6
B-12	3.1	0.6	B-37	1.8	1.3
B-13	2.5	0.7	B-38	0.6	2.9
B-14	2.5	1.6	B-39	0.6	1.8
B-15	2.5	1.1	B-40	1.2	1.2
B-16	1.2	0.6	B-41	1.2	1.1
B-17	1.2	1.3	B-42	1.2	0.8
B-18	1.8	0.9	B-43	0.6	0.7
B-19	1.2	0.8	B-44	1.2	1.3
B-20	1.2	1.3	B-45	1.2	1.1
B-21	1.8	0.8	B-46	Ni1	1.0
B-22	1.2	0.2	B-47	1.2	7.7
B-23	1.2	1.1			
B-24	1.2	0.8			
B-25	Ni1	0.8			

RESPECTFULLY SUBMITTED,

EL PASO CHEMICAL LABORATORIES

Leon Siegel, P.E., Director



# EL PASO CHEMICAL LABORATORIES

Chemical, Environmental Testing  
Spectrographic-Atomic Absorption  
Assaying

P. O. Box 1565  
El Paso, Texas 79948

Lab. No. 39493

REPORT SHEET 2 Received  
Reported:

Date June 6, 1972  
June 12, 1972

Mr. Dewain M. Cox, Geologist

Sample Designation	Ag	Cu	Sample Designation	Ag	Cu
B-1	N11	N11	B-26	N11	N11
B-2	N11	0.4	B-27	N11	N11
B-3	0.5	N11	B-28	N11	0.4
B-4	N11	0.4	B-29	0.2	0.4
B-5	N11	N11	B-30	N11	N11
B-6	N11	N11	B-31	N11	N11
B-7	N11	N11	B-32	0.5	0.4
B-8	N11	0.4	B-33	N11	0.4
B-9	N11	N11	B-34	N11	0.4
B-10	N11	N11	B-35	N11	N11
B-11	N11	0.4	B-36	N11	N11
B-12	N11	N11	B-37	N11	0.4
B-13	N11	0.4	B-38	N11	0.8
B-14	N11	0.4	B-39	N11	0.8
B-15	0.2	0.8	B-40	N11	0.8
B-16	0.5	0.4	B-41	N11	0.4
B-17	0.5	N11	B-42	N11	0.4
B-18	0.7	0.4	B-43	0.5	0.4
B-19	N11	N11	B-44	N11	0.4
B-20	N11	N11	B-45	N11	0.8
B-21	N11	0.4	B-46	N11	2.0
B-22	N11	N11	B-47	N11	0.4
B-23	N11	N11			
B-24	0.5	0.4			
B-25	N11	0.8			

RESPECTFULLY SUBMITTED,

EL PASO CHEMICAL LABORATORIES

Leon Seigel, P.E., Director

Laboratory  
2315 Myrtle Ave.

**CHEMICAL**  
EL PASO ~~LABORATORIES~~ LABORATORIES, LTD.

CHEMISTS —:— ENGINEERS

P. O. BOX 1565  
EL PASO, TEXAS

Phone  
~~544-7148~~

544-7148

INVOICE No. 20754

To: Mr. Dewain M. Cox, Geologist  
P.O. Box 1165  
Fabens, Texas 79836

June 12, 1972

LAB. NO.

39493

86 samples (Geo-Chem samples) rec: 6/6/72 for additional work for Silver and  
and Copper ordered 8/9/72

\$ 258.00

Invoices due and payable when rendered.

Laboratory  
2815 Myrtle Ave.

**CHEMICAL**  
**EL PASO TESTING LABORATORIES, LTD.**

Phone  
544-7148

CHEMISTS --- ENGINEERS  
P. O. BOX 1565  
EL PASO, TEXAS

INVOICE N<sup>o</sup> 20753

To: Mr. Dewain Cox  
P.O. Box 1165  
Fabens, Texas 79838

June 8, 1972

LAB. NO.		
39390	86 Geo. Chem. samples for Pb and Zn @ \$ 3.25 ea. rec: 6/6/72	\$ 279.50

Invoices due and payable when rendered.



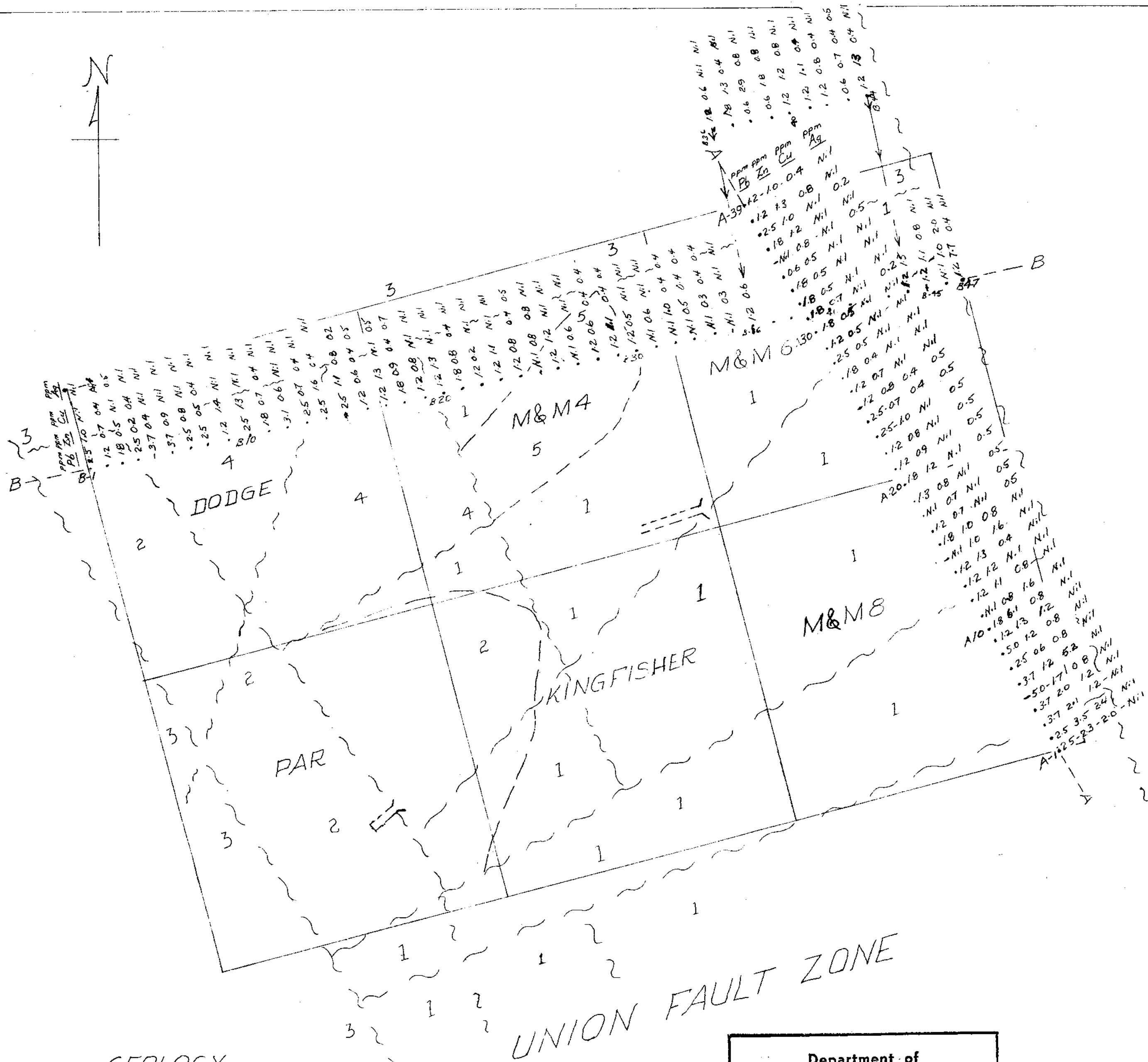

GEOLOGY

- 5 Arkasic Sandstone
- 4 Trachite Porphyry
- 3 Augite Syenite
- 2 Pyroxenite
- 1 Greenstone

Geology from Map by  
D.M. Cox dated 1-15-71

- Adit
- Assumed fault zones
- Geological Boundaries

3717  
M-1

*[Signature]*  
26 June 1972

Department of  
Mines and Petroleum Resources  
ASSESSMENT REPORT  
NO. 3717 MAP #1

KINGFISHER GROUP of CLAIMS  
GREENWOOD MINING DIVISION  
1972 GEOCHEMICAL WORK  
Scale: 1" = 400' 82-E-9-SW  
P.S. Friesen, Consulting Geological Engineer.  
to Accompany Report by P.S. Friesen dated 26 June '72