

92I/10W, 11E, 14E

LINE-CUTTING REPORT

HASSO, GEO, CHIEF Mineral Claims

OWNER: SUPERTEST INVESTMENTS & PETROLEUM LIMITED
MINING DIVISION: KAMLOOPS

WORK DONE: , 1972

3743

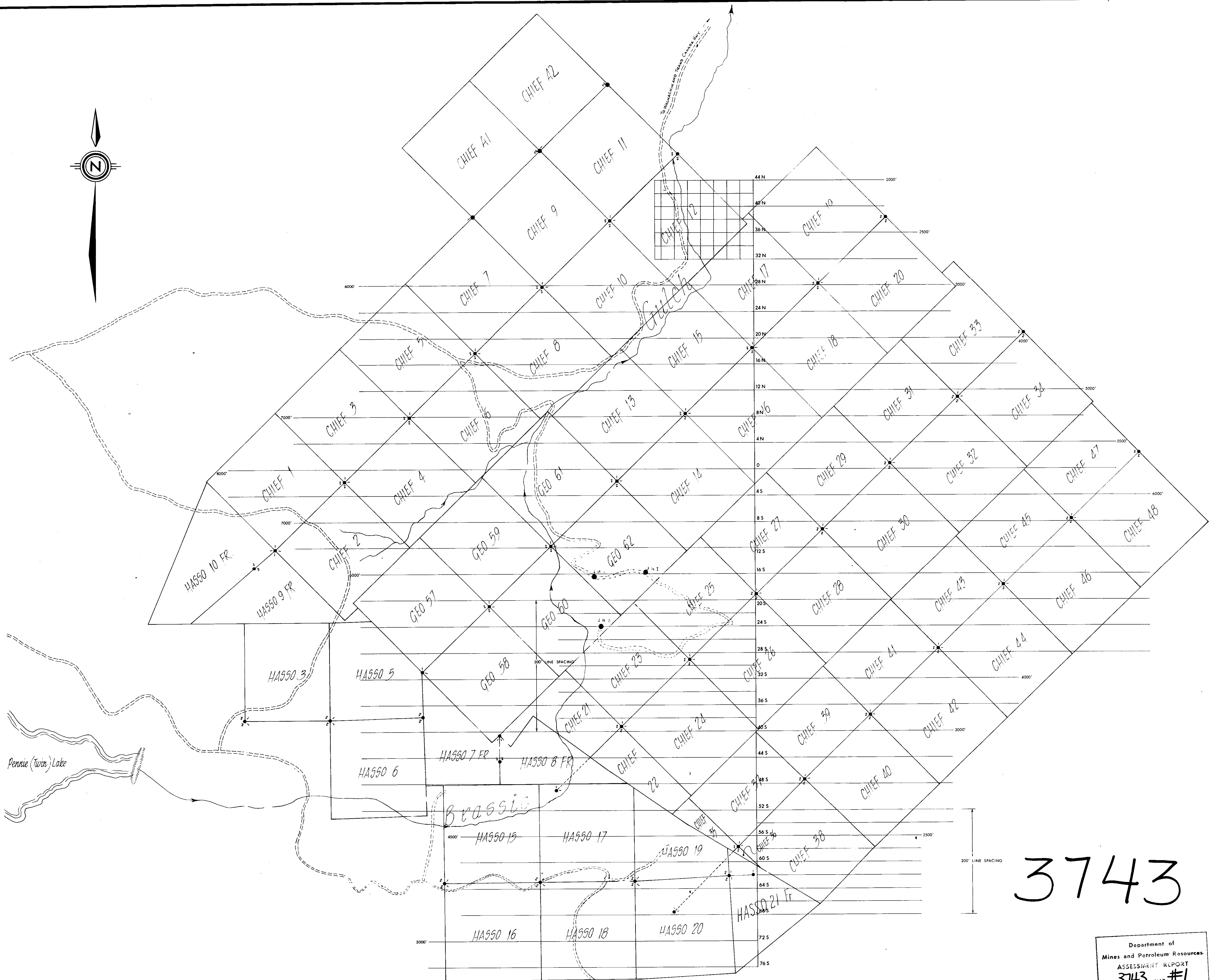
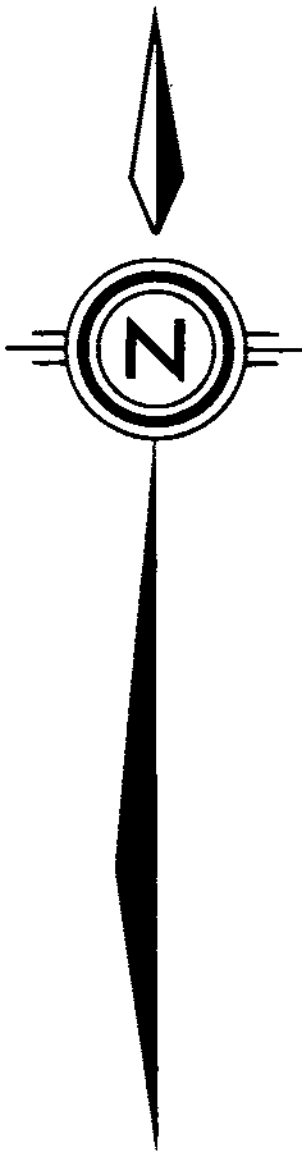

3743 M-1

Department of
Mines and Petroleum Resources
ASSESSMENT REPORT
NO. 3743 MAP #1

WALHACHIN PROPERTY of
Superbest Investments and Petroleum Ltd.

SCALE = 1" = 500'. *Jim McMillan* Kamloops 1972