

3759

GEOPHYSICAL REPORT  
CU-RL CLAIMS, ALLISON CREEK  
PRINCETON, B.C.

49° 120' 92H/10E  
FOR

NORTHAIR MINES LTD. (NPL)

BY

J. W. Hogan, B.A.Sc., P. Eng.  
JUNE 8-30, 1972.

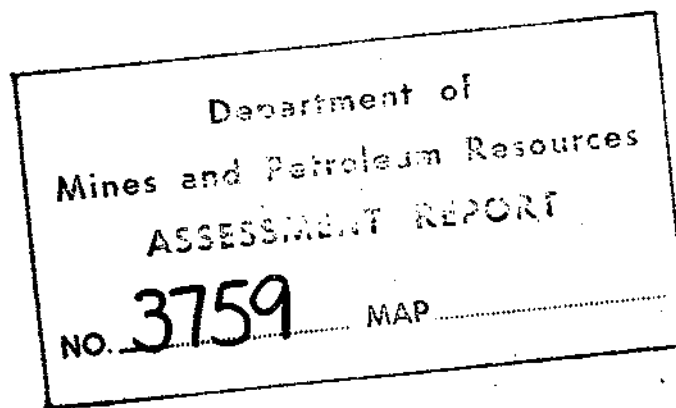

L. J. Manning & Associates Ltd.  
310 - 890 West Pender Street  
Vancouver 1, B.C.

July 28, 1972.

TABLE OF CONTENTS

	<u>PAGE</u>
INTRODUCTION	1
GENERAL GEOLOGY AND TOPOGRAPHY	1
MAGNETOMETER SURVEY TECHNIQUE	1
COMPILATION OF SURVEY DATA	1
SUMMARY AND CONCLUSIONS	1

DRAWINGS

#1 Drawing 1 - Grid lines with respect to claims	In pocket
#2 Drawing 2 - Geophysical plan - magnetic survey	In pocket

**L. J. MANNING & ASSOCIATES LTD.**  
CONSULTING MINING AND GEOLOGICAL ENGINEERS  
610-890 WEST PENDER STREET VANCOUVER 1, B.C.

OFFICE PHONE:  
683-5881

RESIDENTIAL PHONE:  
L. J. MANNING - 985-5690

INTRODUCTION:

The following report is on a ground magnetic survey over the CU-RL claims, Allison Creek, Princeton, B.C.

GENERAL GEOLOGY AND TOPOGRAPHY:

The east half of the property is underlain by Upper Triassic Nicola volcanics and sediments. The west half of the property is mainly underlain by quartz diorite.

Relief is moderate.

MAGNETOMETER SURVEY TECHNIQUE:

A McPhar model M 700 vertical force fluxgate magnetometer was used for the ground survey. This instrument has a readability of 10 gammas.

Stations were read at 100' intervals on a 400' line spacing. Established base stations were regularly read for diurnal variations.

COMPILATION OF SURVEY DATA:

The survey readings were corrected for diurnal changes as determined by baseline checks. Data were contoured on a 500 gamma interval. This was determined to be the most useful interval to show up gross magnetic features.

SUMMARY AND CONCLUSIONS:

The west part of the property of more regular magnetics is coincident with areas partly mapped as quartz diorite. The east part of the property with more irregular high and low magnetics is coincident with areas partly mapped as Nicola volcanics, while the general north-westerly trend corresponds with the regional attitude.

The intrusive-volcanic contact can be postulated as trending north-south through the centre of the claim group and swinging south-westerly through the south-west part of the property.

Respectfully submitted,  
L. J. MANNING & ASSOCIATES LTD.

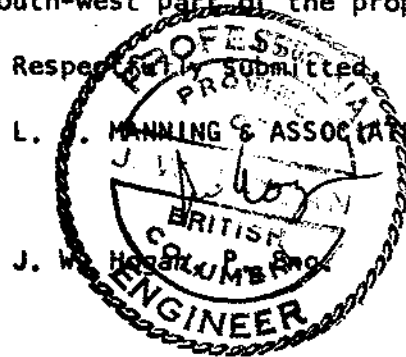

JWH:kd l

**L. J. MANNING & ASSOCIATES LTD.**  
CONSULTING MINING AND GEOLOGICAL ENGINEERS  
610-890 WEST PENDER STREET VANCOUVER 1, B.C.

OFFICE PHONE:  
683-5861

RESIDENTIAL PHONE:  
L. J. MANNING - 985-5690

July 28, 1972.

Chief Gold Commissioner,  
Victoria, B.C.

Dear Sir:

Line cutting costs - Allison Creek area, Princeton.  
CU & RL Claims

The costs incurred for line cutting in 1972 were required for touching up the base-line, re-blazing lines and re-chaining for 100' intervals for a magnetic survey. A road washout necessitated a daily walk to the grid of at least three miles.

I respectfully submit that these costs were necessary for the magnetic survey, since the line costs submitted in 1971 were only for a flagged grid suitable for reconnaissance geochemistry.

Respectfully submitted,

L. J. MANNING & ASSOCIATES LTD.



J. W. Hogan, P. Eng.  
Agent for Northair Mines Ltd. (NPL)

JWH:kd1

DOMINION OF CANADA:  
 PROVINCE OF BRITISH COLUMBIA.  
 To Wit:

In the Matter of

M.R. # \_\_\_\_\_ \$ \_\_\_\_\_  
 VANCOUVER, B. C.  
 x Northair Mines Ltd. (N.P.L.)  
 333 - 885 Dunsmuir Street  
 Vancouver, B.C.  
 F.M.C. 116936

I, J. W. Hogan  
 F.M.C. 116724

of 859 Prospect Ave  
 North Vancouver, B.C.

in the Province of British Columbia, do solemnly declare that the following work was done on the  
 CU 1-16, RL 33-44, RL 49-60 mineral claims in the Allison Creek area, Princeton,  
 B.C. - Similkameen M.D.

GRID PREPARATION

<u>Personnel Engaged</u>	<u>Time Expended</u>	<u>Wages</u>	
J. Doyle	12 days	\$ 481.20	
G. Zorn	12 days	481.20	
R. Apps	8 days	320.80	
B. L. Smith	8 days	320.80	
J. Nielsen	8 days	320.80	
D. Killips	8 days	320.80	
	<u>56 days</u>	<u>\$2,345.60</u>	\$2,345.60

DIRECT COSTS

2 wheel drive truck 12 days @ \$20.00 per day	240.00
Board & accommodation 56 man days	430.40
	<u>\$3,016.00</u>

MAGNETOMETER SURVEY

<u>Personnel Engaged</u>	<u>Time Expended</u>	<u>Wages</u>	
D. Turkington	16 days	\$ 641.60	
C. MacDonald	16 days	641.60	
	<u>32 days</u>	<u>\$1,283.20</u>	\$1,283.20

DIRECT COSTS

2 wheel drive truck 16 days @ \$20.00 per day	320.00
Board & accommodation 32 man days	281.80
	<u>\$1,885.00</u>

L. J. Manning & Associates Ltd. compilation & report

TOTAL LINES & MAGNETOMETER  
 SURVEY

300.00  
\$5,201.00

And I make this solemn declaration conscientiously believing it to be true, and knowing that it is of  
 the same force and effect as if made under oath and by virtue of the "Canada Evidence Act."

Declared before me at the *City*  
 of *Vancouver*, in the  
 Province of British Columbia, this *31*  
 day of *July* 1972, A.D.

*Jill Turner*  
 A Commissioner for taking Affidavits within British Columbia or  
 A Notary Public in and for the Province of British Columbia.  
 Sub-mining Recorder

**In the Matter of**

---

---

---

---

---

---

---

**Statutory Declaration**

(CANADA EVIDENCE ACT)

---

---

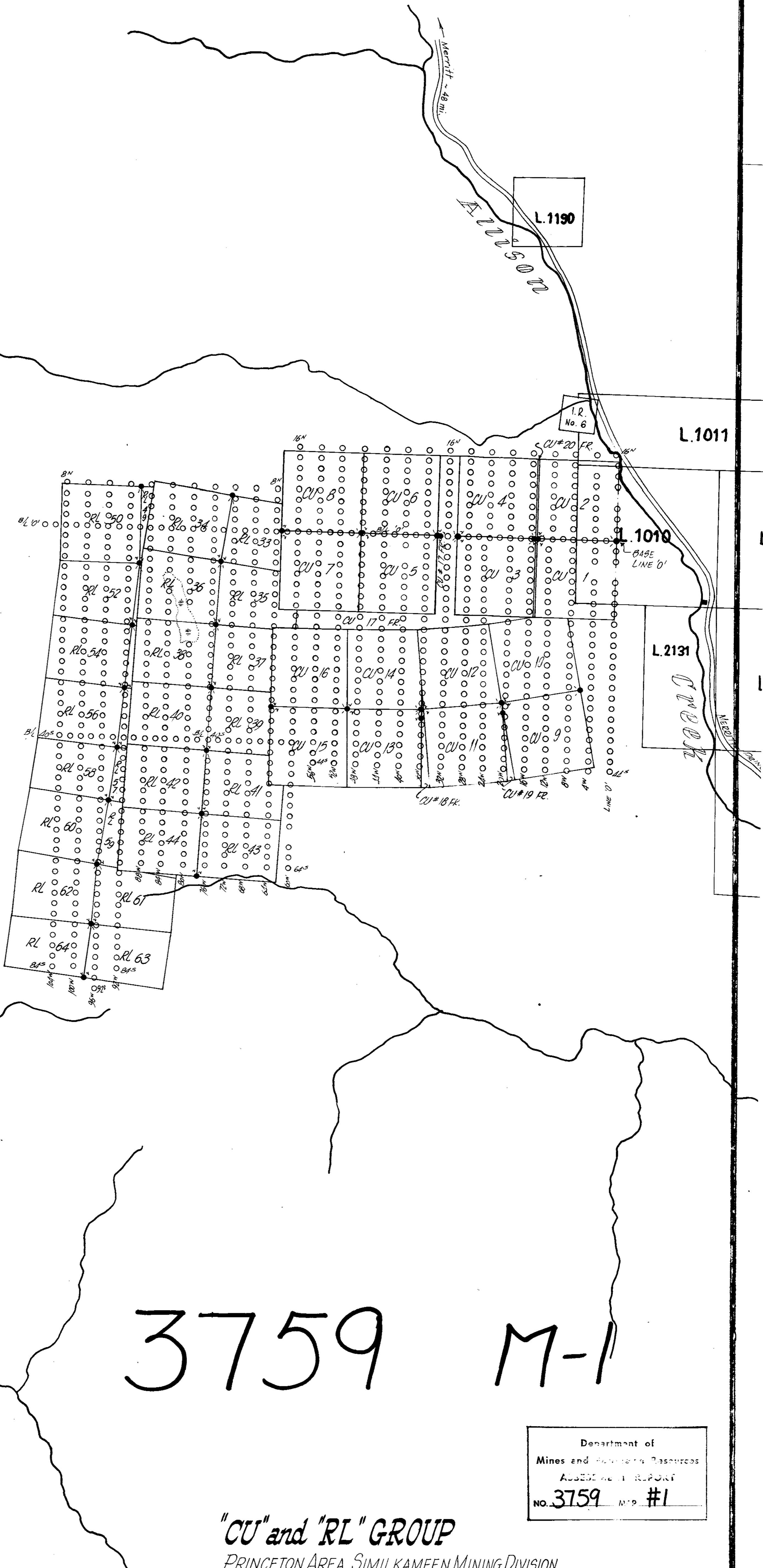
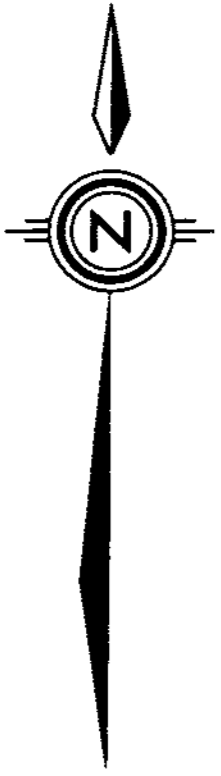

3759 M-1

Department of  
Mines and Geophysical Resources  
ASSESSMENT REPORT  
NO. 3759 MAP #1

"CU" and "RL" GROUP  
PRINCETON AREA, SIMILKAMEEN MINING DIVISION  
Scale: 1" = 1000'

L.J. Manning & Associates - Consultants

TO ACCOMPANY: GEOPHYSICAL REPORT  
BY J.W. HOGAN, P. ENG. ON THE CU & RL  
CLAIMS, PRINCETON & SIMILKAMEEN  
DATED JUNE 20/72

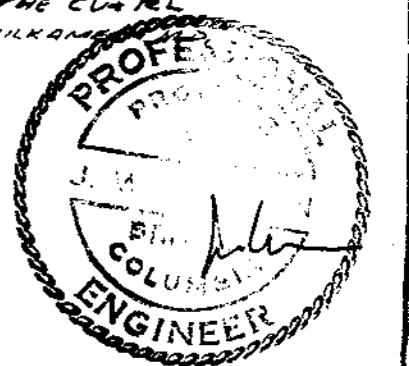



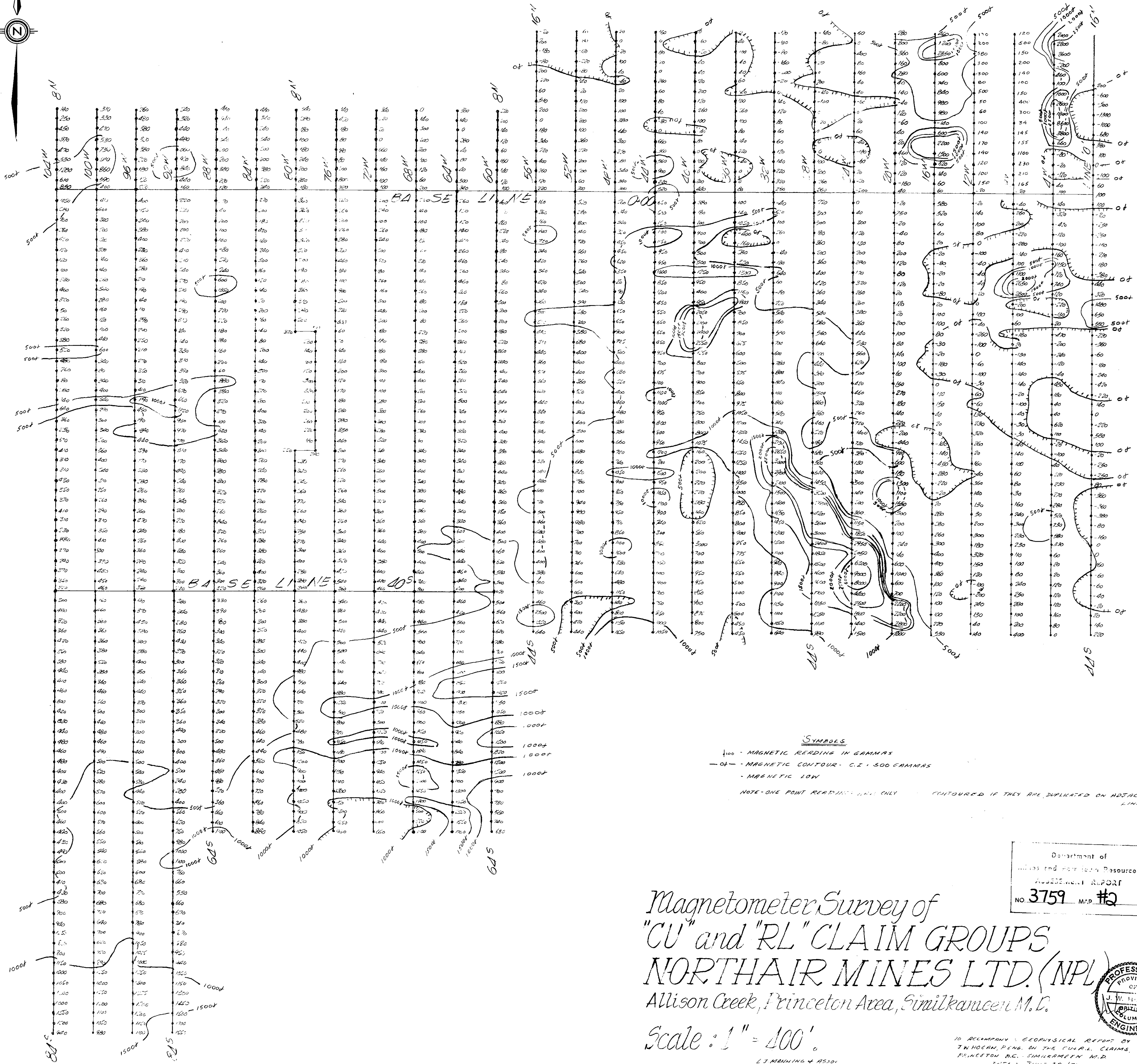

**SYMBOLS**

— 100 — MAGNETIC READING IN GAMMAS  
 — 0+ — MAGNETIC CONTOUR — C.I. 500 GAMMAS  
 — — — — — MAGNETIC LOW

NOTE - ONE POINT READINGS ONLY CONTOURED IF THEY ARE DUPLICATED ON ADJACENT LINES.

Magnetometer Survey of  
 "CU" and "RL" CLAIM GROUPS  
 NORTHAIR MINES LTD. (NPL)  
 Allison Creek, Princeton Area, Similkameen M.C.

Scale: 1" = 400'

Department of  
 Mines and Geological Resources  
 ASSISTANT REPORT  
 NO. 3759 MAP #2

J. W. H. J. N.  
 BRITISH COLUMBIA  
 ENGINEER

TO ACCOMPANY GEOPHYSICAL REPORT BY  
 T. HOGAN, P.E. ON THE CU-RL CLAIMS,  
 PRINCETON B.C., SIMILKAMEEN M.C.  
 DATE: JUNE 28, 1972

L.J. MANNING + ASSO.

