

GEOLOGICAL REPORT 920/2W
ON
ABC GROUP OF MINERAL CLAIMS
(WORK DONE BETWEEN
AUGUST 7 AND AUGUST 24, 1972.)
LOCATED ON RELAY CREEK
LILLOOET MINING DIVISION, B.C.
51⁰122⁰ S.W.

by
D. SYMONDS, B.Sc.
R. WOLFE, P.Eng.
September 8, 1972.

920/2W

3829

GEOLOGICAL REPORT

on

ABC GROUP OF MINERAL CLAIMS

(WORK DONE BETWEEN AUGUST 7 AND AUGUST 24, 1972.)

LOCATED ON RELAY CREEK

LILLOEET MINING DIVISION, B.C.

51⁰122⁰ S.W.

by

D. SYMONDS, B.Sc.

R. WOLFE, P.Eng.

SEPTEMBER 1, 1972.

Department of Mines and Petroleum Resources ASSESSMENT REPORT NO. 3829 M.P.
--

TABLE OF CONTENTS

	<u>Page</u>
SUMMARY	1
INTRODUCTION	2
LOCATION AND ACCESS	2
CLAIMS	2, 3
PHYSICAL WORK	4
ROAD SURVEY	4
GEOLOGY	4, 5
CONCLUSIONS AND RECOMMENDATIONS	5.

FIGURES

#1. LOCATION MAP	6
#2. CLAIM MAP	7
#3. COMPOSITE MAP	In back pocket

APPENDIX

I CERTIFICATES
II PERSONNEL AND DATES WORKED
III COST BREAKDOWN

SUMMARY

Edina Resources Ltd. holds title to 36 mineral claims, the ABC group, situated on Relay Creek in the Lillooet M.D. Road building through a previously located geochemical soil Cu, Mo, Zn anomaly shows weak pyrite-chalcopyrite-chalcocite mineralization associated with several exposures of a highly altered, leached, oxidized quartz-feldspar porphyry.

Bedrock was only reached in very few places leaving the shape and size of the porphyry body essentially unknown. A drilling program is recommended to a) obtain samples of primary unoxidized material through a series of short holes in the porphyry area and to b) drill deeper holes in areas of favourable mineralization outlined by the program in a).

INTRODUCTION

The following report describes a further investigation of geochemical anomalies on Relay Creek. These anomalies were described in a previous report by R. Wolfe, P.Eng. on the ABC group dated October 26, 1971.

LOCATION AND ACCESS

The ABC claim group is located at Lat. $51^{\circ}10'$, Long. $122^{\circ}52'$, about 25-air miles north of Bralorne. The property is reached by turning north off the Lillooet-Goldbridge road onto the Tyaughton Lake road (about 8 miles before reaching Goldbridge). The Tyaughton Lake road is followed for approximately 15 miles to the junction of Relay Creek and Tyaughton Creek and then the road on the northeast side of Relay Creek is followed for about 8 miles to reach the property. A pick-up truck equipped with good tires and positraction would be suitable to reach the property, but a 4-wheel drive vehicle would be better for work on the property itself.

CLAIMS

The ABC group consists of 36 full-sized claims: A1-12, B1-12, and C1-12 owned by Edina Resources Ltd. in the Lillooet Mining District.

<u>Claim Name</u>	<u>Certificate of Work No.</u>	<u>Record No.</u>	<u>Record Date</u>	<u>Expiry Date</u>
A1	40482	33646	Aug. 24/70	Aug. 24/73
A2	40483	33647	Aug. 24/70	Aug. 24/73
A3	40484	33648	Aug. 24/70	Aug. 24/73
A4	40485/6	33649	Aug. 24/70	Aug. 24/74

<u>Claim Name</u>	<u>Certificate of Work No.</u>	<u>Record No.</u>	<u>Record Date</u>	<u>Expiry Date</u>
A5	40487	33650	Aug. 24/70	Aug. 24/73
A6	40488/9	33651	Aug. 24/70	Aug. 24/74
A7	40490	33652	Aug. 24/70	Aug. 24/73
A8	40491/2	33653	Aug. 24/70	Aug. 24/74
A9	40493	33654	Aug. 24/70	Aug. 24/73
A10	40494/5	33655	Aug. 24/70	Aug. 24/74
A11	40496	33656	Aug. 24/70	Aug. 24/73
A12	40497	33657	Aug. 24/70	Aug. 24/73
B1	40498/9	33658	Aug. 24/70	Aug. 24/74
B2	40500	33659	Aug. 24/70	Aug. 24/74
B3	40501/2	33660	Aug. 24/70	Aug. 24/74
B4	40503	33661	Aug. 24/70	Aug. 24/74
B5	40504/5	33662	Aug. 24/70	Aug. 24/74
B6	40506	33663	Aug. 24/70	Aug. 24/74
B7	40507/8	33664	Aug. 24/70	Aug. 24/74
B8	40509	33665	Aug. 24/70	Aug. 24/73
B9	40510/11	33666	Aug. 24/70	Aug. 24/74
B10	40512	33667	Aug. 24/70	Aug. 24/73
B11	40513/14	33668	Aug. 24/70	Aug. 24/74
B12	40515	33669	Aug. 24/70	Aug. 24/74
C1 - 12	40516 - 27	33670-33681	Aug. 24/70	Aug. 24/73

The expiry dates shown for the claims in the ABC claim group are those which will hold after the 1972 field work has been applied.

PHYSICAL WORK

Approximately 9000 feet of road was constructed in order to facilitate further examination of the geochemical anomaly and to provide access for possible drilling. (See fig. 3)

Bedrock could only be reached in very few localities with the small bulldozer used.

ROAD SURVEY

To establish mapping control for the area around the geochemical anomaly, a chain and compass (with tripod) survey was conducted over the newly-constructed road. The new road was tied in to the pre-existing road, the claim group and to a prominent physical feature (a beaver dam) which appears on the 1:50,000 scale topographic map of the area (Tyaughton Creek, sheet 920/2 west half). The survey was corrected for slope using a clinometer and the results were plotted on a 1" = 200' map. The areas of outcrop were surveyed in and sample locations were plotted accurately on the map.

GEOLOGY

The major rock unit exposed in the geochemically anomalous area consists of a weakly mineralized quartz feldspar-porphyry. Since the unit is only exposed in three localities, it is not possible at this time to determine whether the porphyry was intruded as a stock, about 2,200 feet wide, a sill 2,200 feet long, or as a series of dykes. The porphyry is surrounded by a sequence of volcanic rocks, mainly andesites and rhyolites.

Porphyry specimens are highly weathered and extensively oxidized. Three grab samples were assayed (see fig. 3 for results) and found to contain less than 0.1% Cu. Substantial leaching of chalcopyrite is almost a certainty. Chalcocite can be observed surrounding grains of chalcopyrite. Alteration of the porphyry appears pervasive, the feldspars have been extensively Kaolinitized and the matrix silicified. The iron and copper sulphides occur both disseminated and in small fractures.

CONCLUSIONS AND RECOMMENDATIONS

Bulldozer cuts on the property did not provide sufficient bed-rock exposures to allow any conclusions regarding the geology.

Evidence of a quartz-feldspar porphyry has been found in three localities on a newly constructed access road. The porphyry has been extensively leached, oxidized, and hydrothermally altered making estimates of primary mineralization difficult. Sulphide mineralization, disseminated and in fractures (copper content less than 0.1%) is sufficiently encouraging to be followed up with further work. A series of short holes in the porphyry zone is therefore recommended to penetrate the oxidized and leached surface layer and obtain samples of primary mineralization. Once the zone of mineralization is thus outlined, deeper drilling could be contemplated.

Respectfully submitted



Don Symonds

D. SYMONDS, B.Sc.

R. WOLFE, P.ENG.

3829
M-1

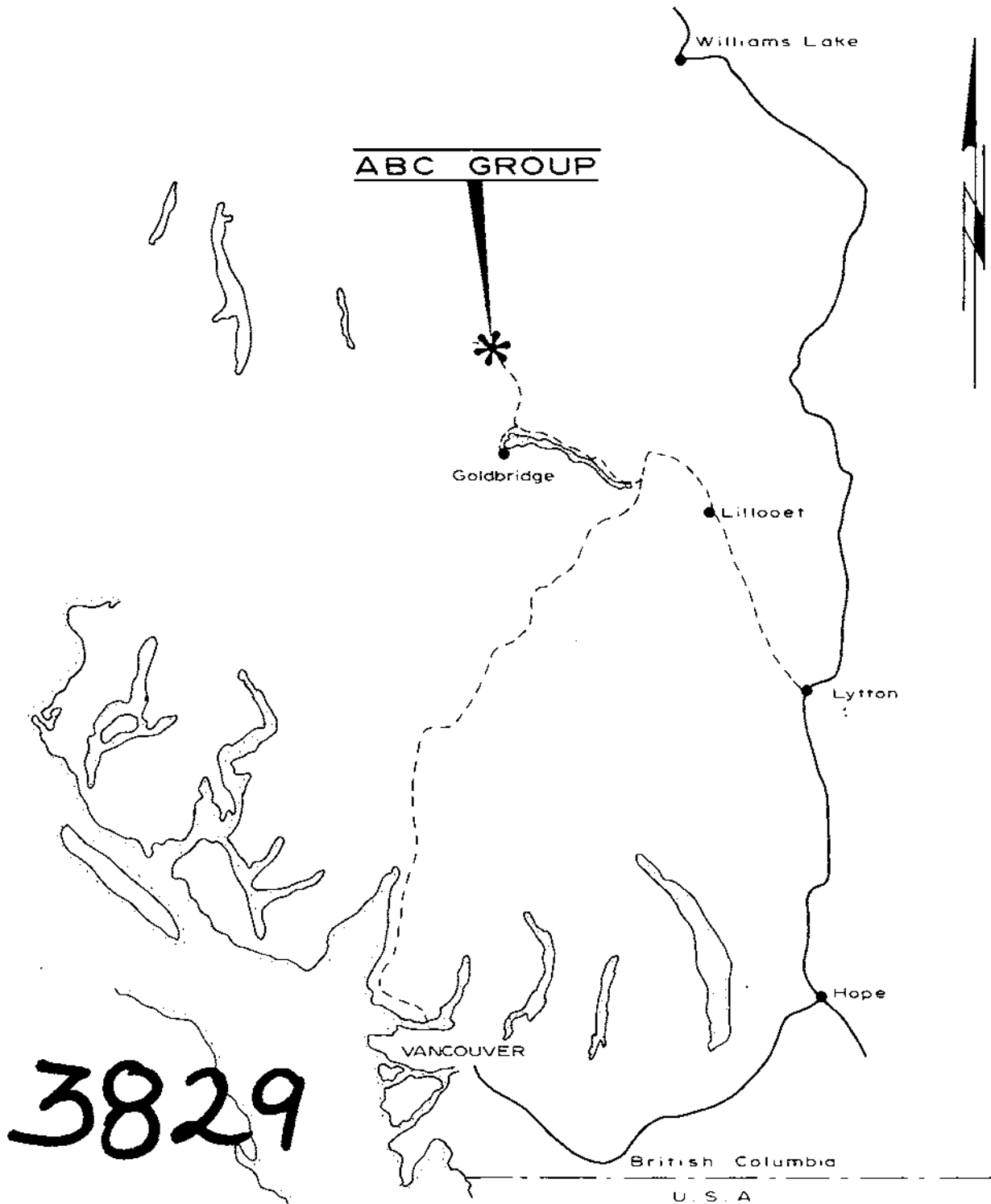
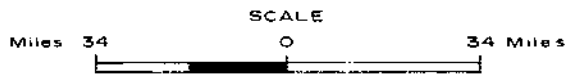

FIG. 1
EDINA RESOURCES LTD.
ABC GROUP
RELAY CREEK, B.C.
LOCATION MAP



To accompany a report by
D. Symonds, B.Sc. and
R. Wolfe, P. Eng.
Dated Sept 1, 1972

MONTGOMERY-WOLFE & ASSOCIATES LTD

Department of
Mines and Geotectonic Resources
ASSESSMENT REPORT
NO. 3829 MAP #1

3829
#1

Department of
 Mines and Technical Surveys
 REPORT
 NO. **3829** MAP **#2**

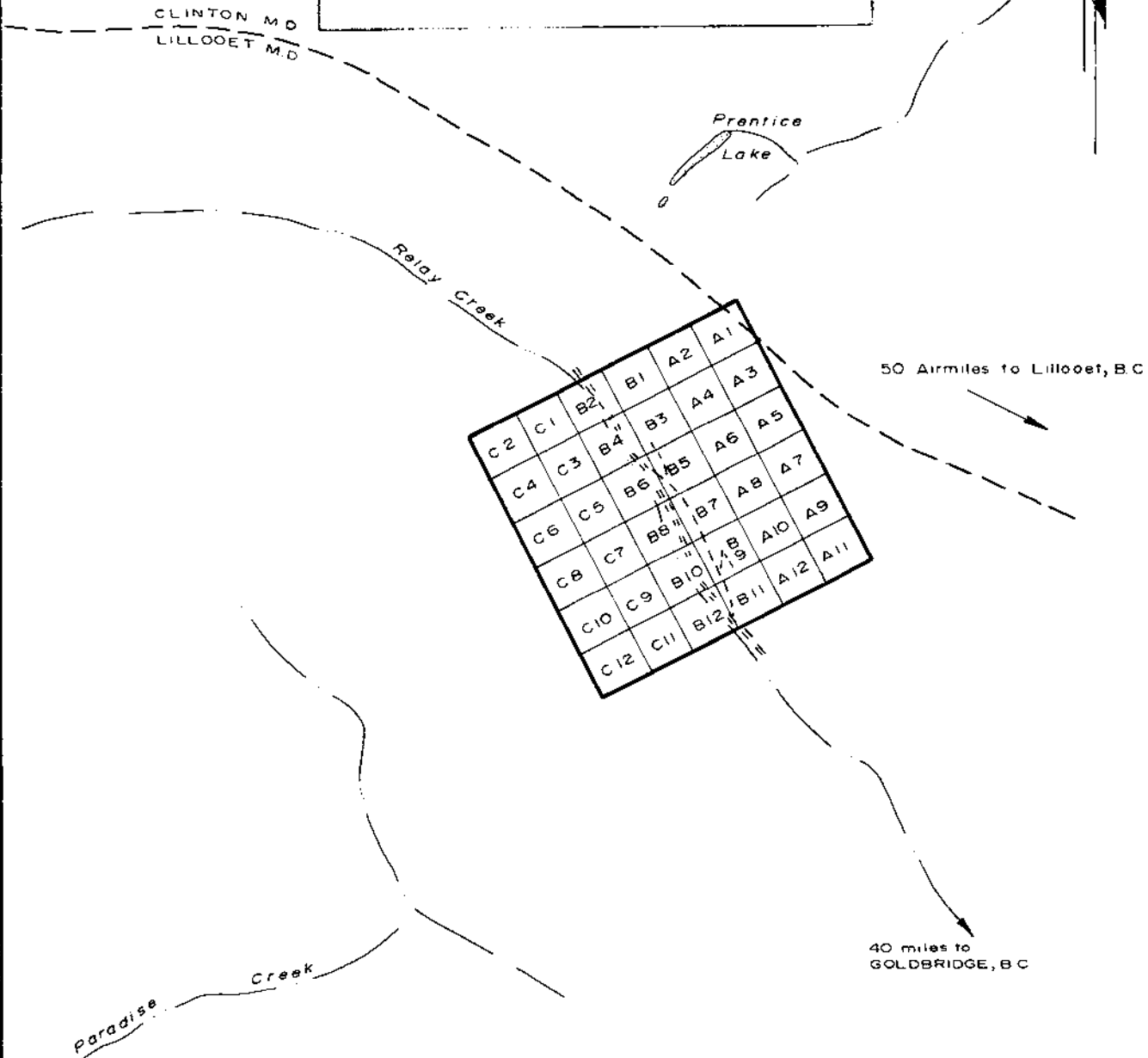

----- Location of road construction
 (see Figure 3 for detail)



FIG. 2
 EDINA RESOURCES LTD.
 ABC GROUP
 RELAY CREEK, B.C.
CLAIM MAP

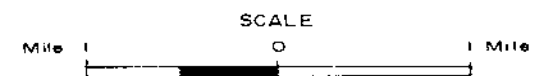

To accompany a report by
 D. Symonds, B.Sc. and
 R. Wolfe, P.Eng.
 Dated Sept. 1, 1972

MONTGOMERY-WOLFE & ASSOCIATES LTD.

APPENDIX I

CERTIFICATES

Al Page:

Survey helper, age 24, has worked for the author since the spring of 1972.

D. Symonds:

Geologist (B.Sc. U.B.C. 1972)

Experience in all phases of mineral exploration since 1966.

R. Wolfe, P.Eng:

Geological Consultant

B.Sc. (Alberta) 1963, Physics and Geology.

Engaged in the profession since 1963.

APPENDIX II

PERSONNEL AND DATES WORKED

A. Page:	August 7 - August 20, 1972	14 days @ \$30	\$420
D. Symonds, B.Sc:	August 7 - August 23, 1972	17 days @ \$40	680
	Field Supervision, geological mapping		
R. Wolfe, P.Eng:	August 7, 8, 13, 24, 25, 26, 27		
	7 days @ \$100		700
	Supervision and Report		
			<u>\$1,800</u>

APPENDIX III

COST BREAKDOWN

Wages (see Appendix II)		\$ 1,800.00
Transportation, truck rental	14 days @ \$17.00/day	238.00
	gas	20.00
Accommodation, meals etc.		180.00
Drafting, typing etc.		40.00
Roadbuilding, Bulldozer,	80 hours @ \$29.00/hour	2,320.00
	TOTAL	<u>\$4,598.00</u>

Declared before me at the
of
Province of British Columbia, this
day of

VANCOUVER, B. C.
SEP 1 - 1972
, A.D.

Sub Mining Recorder

A Commissioner for taking Affidavits within British Columbia or
A Notary Public in and for the Province of British Columbia

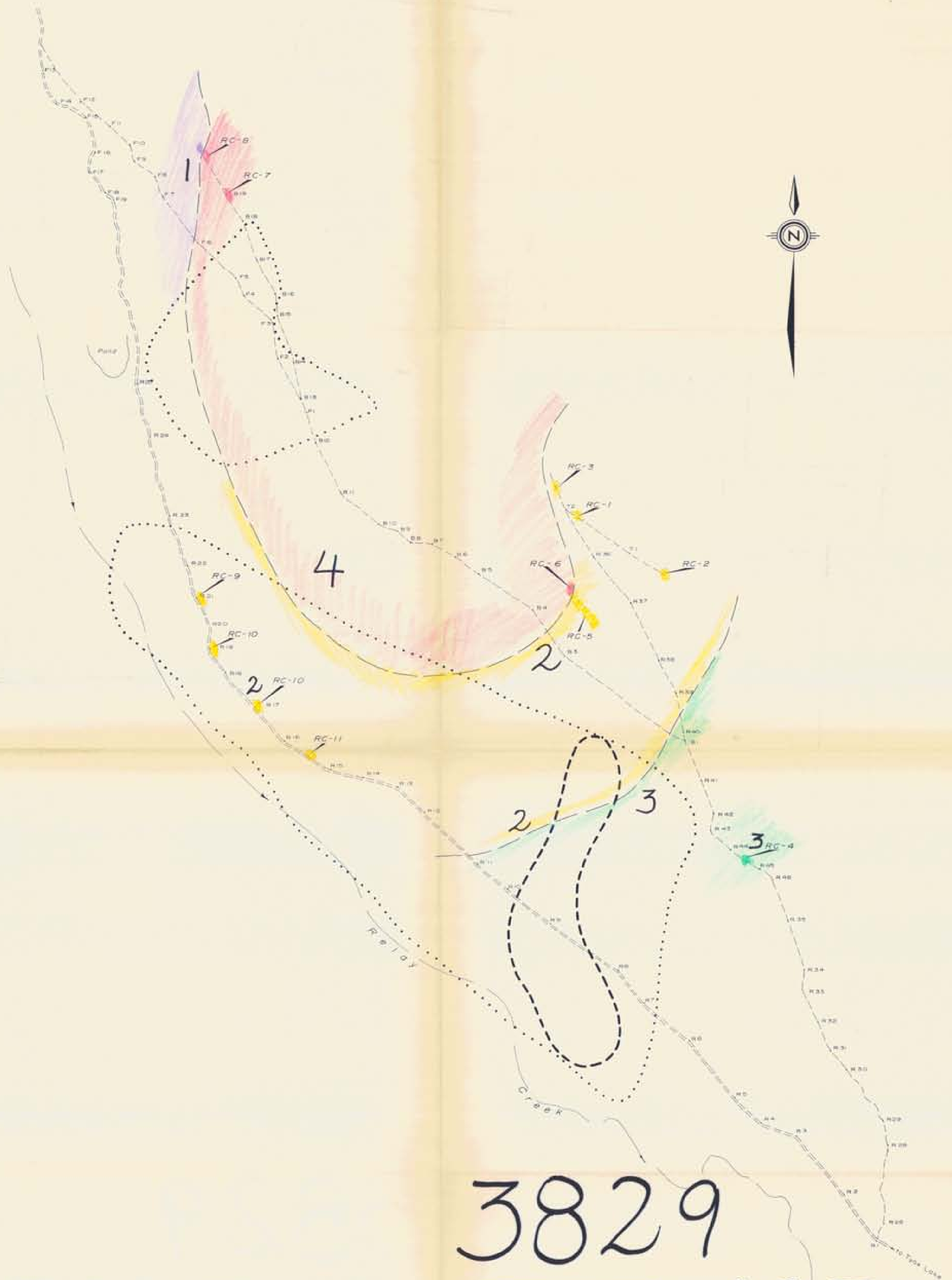

LEGEND

GEOLOGY

4	QUARTZ FELDSPAR MONOPHYME
3	TGAY
2	AMPHIBOL
1	BIOTIC

ASSAY RESULTS

Sample	RC-8	RC-7	RC-6	RC-5
Si	20.8	28	28	28
Mg	17	17	20	20
Al	8	11	8	8
Ca	11	8	8	8

SYMBOLS

	Boundaries
	Approximate Geological Boundaries
	Rock Sample
	Tracing Station
	Approximate Geological Boundaries
	Location of Tertiary Aquiferous System (at 100' depth)
	Location of Tertiary Aquiferous System (at 100' depth)

3829

M-3

Department of
Mines and Petroleum Resources
ASSESSMENT REPORT
NO. 3829 MAP #3



FIG 3
EDINA RESOURCES LTD.
ABC GROUP
RELAY CREEK, BC.
COMPOSITE PLAN

SCALE
FEET 200 0 200 400 FEET
MONTGOMERY-WOLFE & ASSOCIATES LTD.