

GEOCHEMICAL REPORT ON THE
Property of ATTILA RESOURCES LTD. (NPL)
NATION LAKES, BRITISH COLUMBIA.

MT 1-40; D 187-198.

Situated on the south shore of Chuchi
Lake, Omineca Mining Division.

55° 09'N 124° 30'W 95N/1WDE

Submitted by: D.P. Taylor, Geologist
Endorsed by: R.H.D. Philp, P. Eng.

Owner: ATTILA RESOURCES LTD. (NPL)

Work conducted by: Agilis Exploration
Services Ltd.

3852

GEOCHEMICAL REPORT

ON THE PROPERTY OF

ATTILA RESOURCES LTD. (N.P.L.)

MT AND D MINERAL CLAIM GROUPS

OMINECA MINING DIVISION, B. C.

Department of
Mines and Petroleum Resources
ASSESSMENT REPORT
NO. **3852** MAP

RECEIVED

AUG 29 1972

GOVERNMENT AGENT
SMITHERS, B. C.

AUGUST, 1972.

SMITHERS, B. C.

TABLE OF CONTENTS

	Page
INTRODUCTION.....	1
LOCATION AND ACCESS.....	2
PHYSIOGRAPHY.....	2
PROPERTY.....	2
WORK CONDUCTED.....	2
SAMPLING PROCEDURES.....	2
ANALYSIS.....	3
SURVEY RESULTS.....	3
INTERPRETATION.....	4
RECOMMENDATIONS.....	5

MAPS:

#1 Location Map	1" = 4 miles
#2 Geochemical Contour Map MT GROUP	1" = 400'
#3 Geochemical Value Map MT GROUP	1" = 400'
#4 Geochemical Contour Value Map D GROUP	1" = 400'

GEOCHEMICAL REPORT ON THE
PROPERTY OF ATTILA RESOURCES LTD. (N.P.L.)
MT AND D MINERAL CLAIM GROUPS
OMINECA MINING DIVISION, SMITHERS, BRITISH COLUMBIA

INTRODUCTION:

The MT and D mineral claims form two groups totalling 52 claims located south of Chuchi Lake, one of the Nation Lakes, in Central British Columbia.

In late June and early July of 1972 geochemical surveys were conducted over both of these properties, on a pre-existing grid on the MT group and on a grid established for the survey on the D group.

Work was conducted by personnel of Agilis Exploration Services Ltd. under the direction of M. Stadnyk, geologist. The author has not visited the property.

LOCATION AND ACCESS:

The two groups are located on the south shore of Chuchi Lake.

The MT group is located:-

Long. 124 30' W
Lat. 55 09' N

The D group is located approximately 6 miles east of the MT claims, in the Omineca Mining Division of B.C.

Access to the claims is by boat along Chuchi Lake, the eastern end of which is accessible by road from Fort St James, 50 miles to the south. Access is also possible by float plane.

PHYSIOGRAPHY:

Topographic relief is low in this area, particularly on the D group. The MT group occupies the north facing slope of a small hill south of Chuchi Lake. The area has some big timber but thick underbrush, with devils club, make travel difficult.

PROPERTY:

The property consists of two claim groups located in the Gmineca Mining Division of British Columbia.

<u>CLAIMS</u>	<u>RECORD NUMBERS</u>	<u>RECORDING DATES</u>
MT 1 - 40	102076-102115	August 11, 1971
D 187 - 198	101938-101949	August 10, 1971

WORK CONDUCTED:

A geochemical survey was conducted over both claim groups. A grid with north-south grid lines 400 feet apart with stations every 200 feet along the lines existed on the MT group and a similar grid with east-west lines was established on the D group. A party of four men was established and oriented on the property under the supervision of M. Stadnyk, geologist, and worked thereafter under the supervision of N. Newsom, foreman.

SAMPLING PROCEDURES:

Soil samples were taken at all available stations on both grids with mattocks. A sample was obtained from the "B" horizon whenever possible, at 10 to 14 inches depth. Record sheets were kept in the field noting particulars for each sample, sample depth, soil type, topography, slope, cover, and etc. A total of 746 samples

were analysed from the MT group and 116 samples from the D group. Samples were placed in Kraft bags provided by the laboratory and packed for shipment.

ANALYSIS:

All samples were analysed for ppm copper content at Core Laboratories Canada Ltd., 325 Howe St., Vancouver, B. C.

Samples were kiln dried and a minus 80 mesh fraction was digested for 2 hours in hot perchloric nitric acid. Quantitative analysis was conducted using a Gerald Ash 82800 atomic absorption machine.

SURVEY RESULTS:

D GROUP

Values obtained ranged from 10 ppm to 350 ppm. The mean of this population is just over 40 ppm and background level is considered to be 52 ppm. There are few anomalous samples in the population but the top 2.5% of the samples are greater than 90 ppm (6 samples) and form a significant anomaly on the lake shore between lines 12S and 20S.

Other High values on this grid are erratic and scattered and considered of insufficient magnitude or intensity to be of interest.

MT GROUP

Values obtained ranged from 4 ppm to >1000 ppm. The mean of this population is about 65 ppm.

Three samples gave values of >1000 ppm, the laboratories upper limit of accuracy. On this basis background can be established at about 75 ppm. samples of >150 ppm can be considered anomalous

(39 samples). The top 2.5% of the population are the 18 samples >220 ppm and are to be considered highly anomalous. Contour and spot value maps of these surveys accompany this report.

INTERPRETATION:

D. GROUP

One isolated anomaly exists by the shore of Chuchi Lake on the baseline between stations 12S and 20S. The remainder of the claim group seems to be consistently geologically and geochemically of little apparent interest. Other geochemically high values are isolated and discontinuous.

M. GROUP

Several anomalous areas occur within the survey area. These are of particular interest when correlated to structural lineations taken from photogeological interpretation. Five separate anomalies relate to these lineations.

The first is at the extreme south-west corner of the grid where a group of 4 highly anomalous samples are situated in a limited area which is cut by a strong northwesterly striking lineament. The area has no geologic exposure but is within a claim length of an inferred contact. This anomaly is apparently open off the grid to the south and the west.

The second area is on the extreme western line of the grid from station 12S to 24S. This area is cut by the same lineament as well as a smaller feature to the north. This anomaly covers the inferred intrusive volcanic contact. The anomaly is open to the west.

Anomaly 3 is on the western flank of the grid on lines 4W to 8W from the baseline to 12N. This area overlays an inferred contact between intrusives and volcanics, and is also open to the west. Anomaly 4 lies between lines 20E and 32E from the baseline on line 28E to station 10S on line 24E. The anomaly lies adjacent to the east, of a major north-northeasterly trending lineament and is cut by a less pronounced northeasterly trending lineament. The anomaly is apparently underlain by volcanics, but is in the vicinity of an inferred contact to the west; there is no outcrop noted on the anomaly. Two highly anomalous samples on line 40E, at the baseline and 2N may be related to this anomaly.

The fifth anomaly is centered on line 48E where highly anomalous samples were taken from stations 10N and 12N. This area is possibly over the hidden intersection of extensions of a strong northwesterly trending lineament and northeasterly trending features. A >1000 ppm sample to the northeast at 76E 20N may be related to this anomaly. Other highly anomalous samples from the survey occur as isolated highs, not considered to be significant at this time.

RECOMMENDATIONS:

The first three anomalies mentioned occur on the boundary of the grid and the claim group. All of these anomalies are open to the west. It is recommended that the ground to the west and southwest of the claim group be acquired if possible.

Detailed soil sampling of the anomalies should be carried out with careful control of sample horizon in all cases. A thorough search

for additional outcrop exposure should be made during this survey. On the advice of the consultant geologist the results of this survey should be used to direct geophysical (induced polarisation) surveys of the anomalies with a view to selecting drill targets. Due to the lack of outcrop, exposure on the anomalies the possibility of bull-dozer trenching should also be carefully considered.

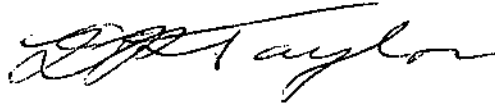

Submitted by: D.P. TAYLOR, Geologist.



ENDORSED by: R.H.D. PHILP, P. Eng.

August, 1972

Smithers, B. C.

CERTIFICATION

I, David Pelham Taylor of Vancouver, B.C. do hereby certify that:

1. I am an Exploration Geologist residing at 2097 West 6th Avenue, Vancouver 9, B. C.
2. I am a graduate of the Royal School of Mines, Imperial College, London, M.Sc., D.I.C. 1971.
3. I have practiced as an exploration geologist in B. C. for four years.
4. I have not visited the property subject of this report but that all pertinent data was available to me.



D.P TAYLOR, M.Sc., D.I.C.

August 14th, 1972.

Vancouver, B. C.

DOMINION OF CANADA:
PROVINCE OF BRITISH COLUMBIA.
To Wit:

In the Matter of the geological, magnetometer,
and geochemical surveys on the D GROUP.

I, B. Talbot,

of c/o 107-325 Howe Street, Vancouver, 1, B.C.

in the Province of British Columbia, do solemnly declare that the following personnel were employed and costs incurred in conducting the surveys.

PERSONNEL:

R. PHILP	- Supervision	- 1 day @ \$125.00	\$ 125.00
M. STADNYK	- Geologist	- 2 days @ 125.00	250.00
N. NEWSOM	- Party Chief 4 days	- 4 days @ 59.67	238.68
M. MCGARRY	- Helper	- 4 days @ 39.76	159.04
T. MCGARRY	- Helper	- 4 days @ 37.80	151.20
			<u>\$ 923.92</u>

DISBURSEMENTS:

CAMP CHARGES 14 MAN DAYS @ \$10/day	140.00	
TRUCK, BOAT CHARGES	110.00	
MISC. SUPPLIES, TELEPHONE ETC.	78.50	
DRAUGHTING	49.00	
GEOCHEMICAL TESTING	249.60	\$ 627.10
PLUS 10% SERVICE CHARGE		<u>62.71</u>
	TOTAL	<u>\$1,613.73</u>

And I make this solemn declaration conscientiously believing it to be true, and knowing that it is of the same force and effect as if made under oath and by virtue of the "Canada Evidence Act."

Declared before me at the City
of Vancouver, in the
Province of British Columbia, this 22
day of August 1972, A.D.

J. B. Talbot

Julie Turner
A Commissioner for taking Affidavits for British Columbia or
A Notary Public in and for the Province of British Columbia.

Sub-mining Recorder

In the Matter of

.....

.....

.....

.....

Statutory Declaration
(CANADA EVIDENCE ACT)

DOMINION OF CANADA:
PROVINCE OF BRITISH COLUMBIA.
To Wit:

In the Matter of The geological, magnetometer,
and geochemical surveys on the MT and TM GROUPS

I, B. Talbot

of c/o 107-325 Howe Street, Vancouver 1, B.C.

in the Province of British Columbia, do solemnly declare that the following personnel were employed and costs incurred in conducting the surveys.

PERSONNEL-1972

R. PHILP, D. TAYLOR	- Rept. Office Supervision	- 3 days @ \$125.00	\$ 375.00
N. NEWSOM	- Party Chief	-14 days @ \$ 59.67	835.38
M. MCGARRY	- Helper	-12 days @ \$ 39.76	477.12
J. MCGARRY	- Helper	-12 days @ \$ 37.80	453.60
M. TOEVS	- Helper	-11 days @ \$ 33.81	371.90
M. STADNYK	- Geologist, supervision	- 5 days @ \$125.00	625.00
B. TALBOT	- Draughting	- 36 hrs. @ \$7.00 per hr.	252.00
			<u>\$ 3,390.00</u>

DISBURSEMENTS-1972

GEOCHEMICAL TESTING	\$1,070.25	
TRANSPORTATION & GAS	156.24	
MEALS & ACCOMMODATION	89.60	
BOAT RENTAL	160.90	
SUPPLIES, TELEPHONE, PRINTS	205.34	
TRUCK RENTAL	350.00	
CAMP RENTAL	120.00	
CAMP CHARGES-54 MANDAYS @ \$10.00/day	540.00	
STADNYK-AIRCRAFT, MEALS & TRUCKS ETC.	352.58	\$ 3,044.91
PLUS 10% SERVICE CHARGE		<u>304.49</u>
	TOTAL	<u>\$ 6,739.40</u>

And I make this solemn declaration conscientiously believing it to be true, and knowing that it is of the same force and effect as if made under oath and by virtue of the "Canada Evidence Act."

Declared before me at the City
of Vancouver, in the
Province of British Columbia, this 23
day of August 1972, A.D.

J. B. Talbot

Julie Turner
A Commissioner for taking Affidavits for British Columbia or
A Notary Public in and for the Province of British Columbia.

Sub-mining Recorder

In the Matter of

.....

.....

.....

.....

Statutory Declaration
(CANADA EVIDENCE ACT)

.....

.....

.....

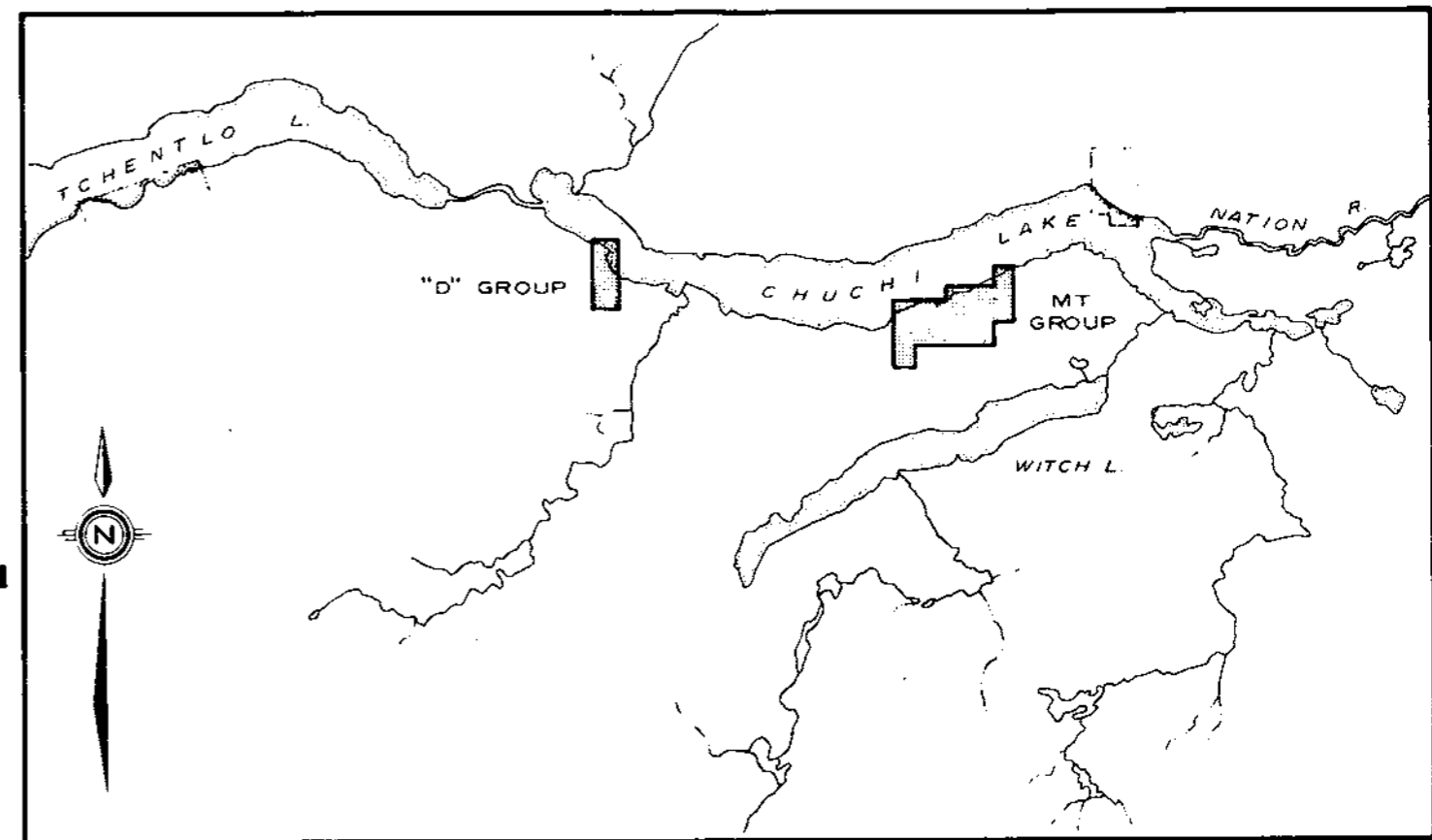
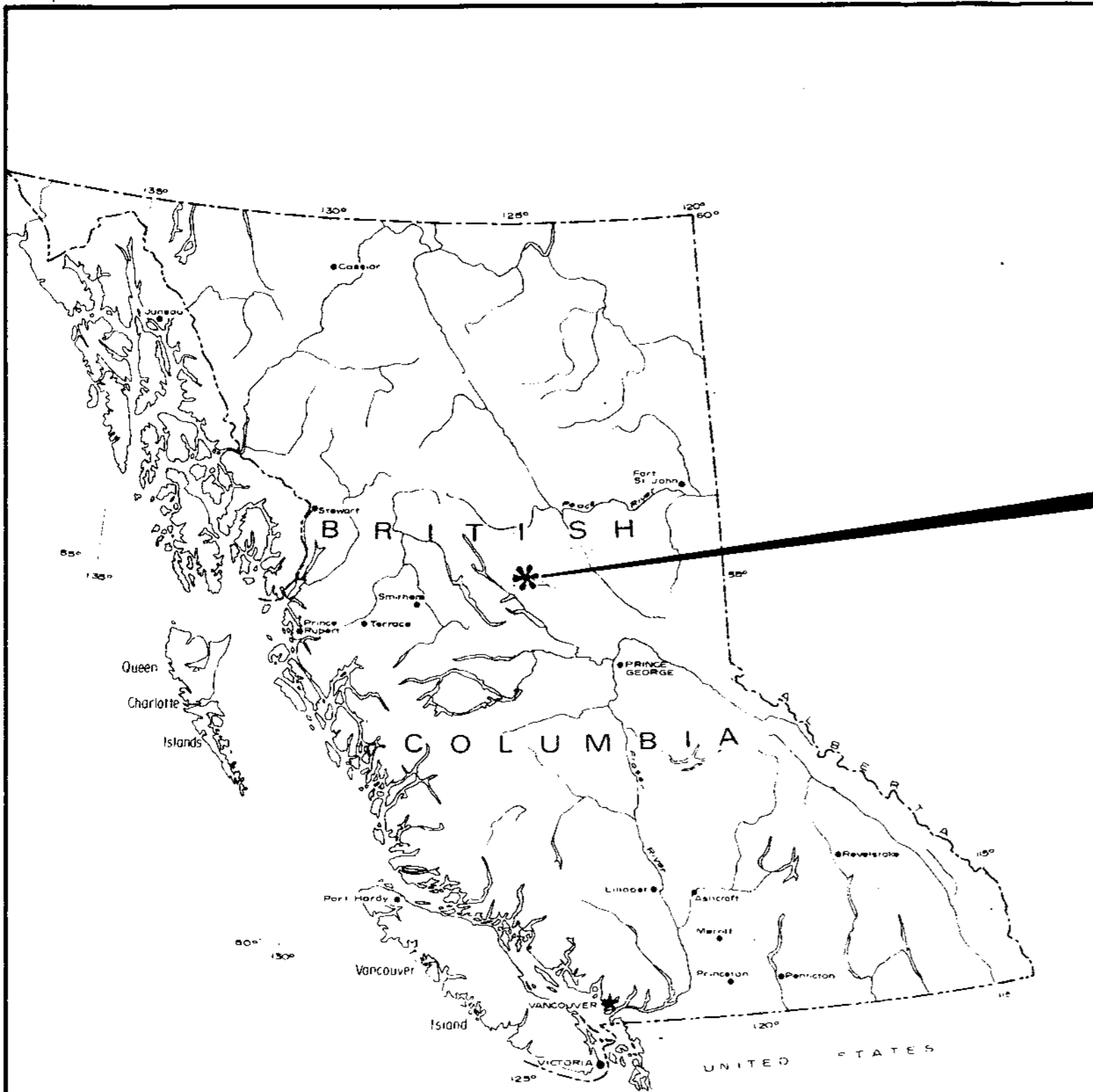

RPM

3852 M-1

AGILIS EXPLORATION SERVICES LTD.	
ATTILA RESOURCES LTD. (N.P.L.)	
LOCATION MAP	
D & MT CLAIMS	
DRAWN: ALTAIR	SCALE: 1" = 4 MI.
CHECKED: R.P.	DATE: AUG. 1971

Department of
Mines and Geology Resources
ASSESSMENT REPORT
NO. 3852 M.P. #1

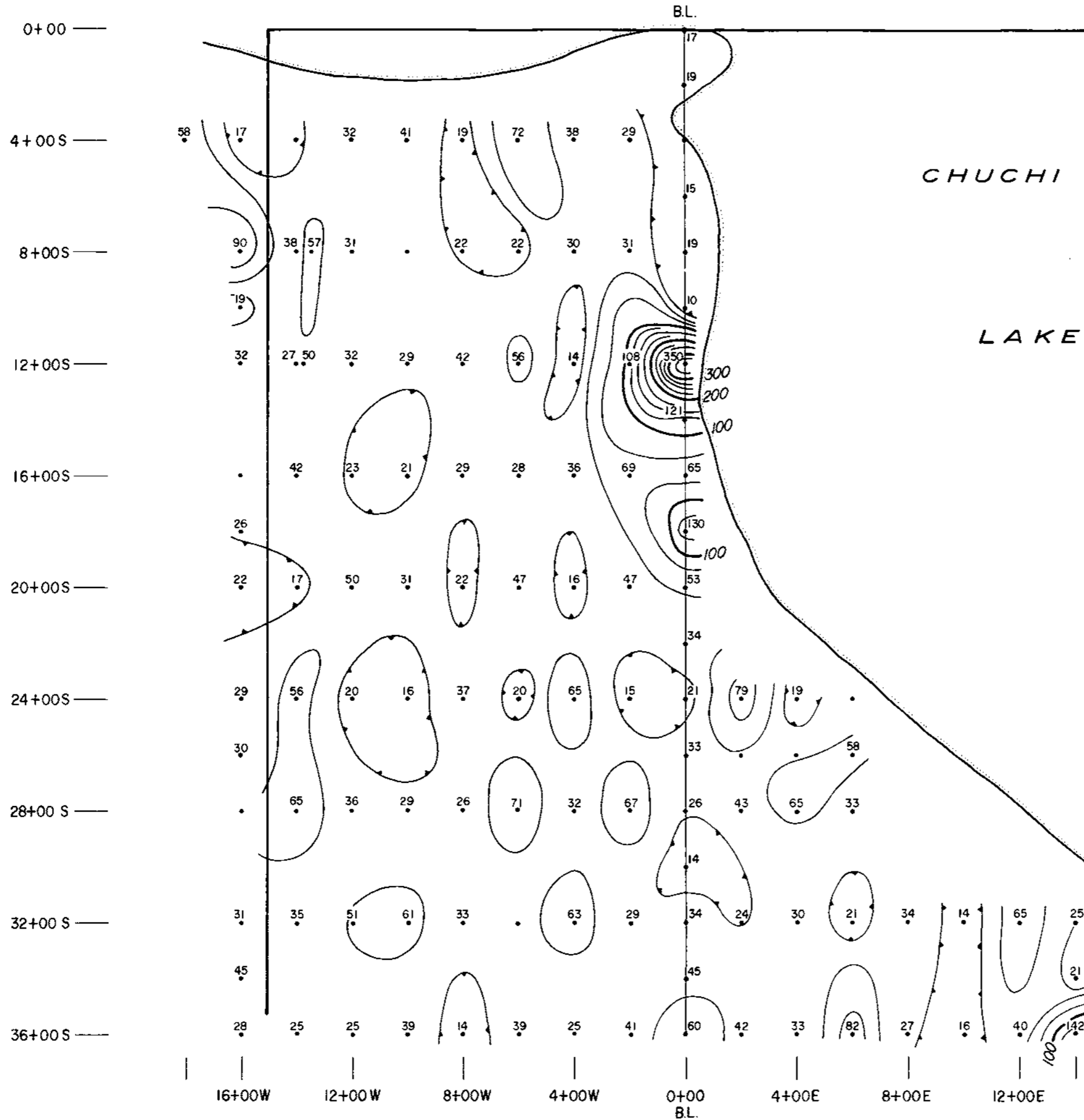

Department of
 Mines and Technical Resources
 ASSESSMENT REPORT
 NO. **3852** M/P **#4**

[Handwritten signature]

AGILIS EXPLORATION SERVICES LTD.
 ATTILA RESOURCES LTD. (NPL)
 D CLAIMS — CHUCHI LAKE, B.C.
 OMINECA MINING DIVISION
**GEOCHEMICAL
 SURVEY**
 Copper (ppm)
 Contour Interval — 25 ppm
 Scale — 1" = 400 ft

12+00W 8+00W 4+00W 0+00 4+00E 8+00E 12+00E 16+00E 20+00E 24+00E 28+00E 32+00E 36+00E 40+00E 44+00E 48+00E 52+00E 56+00E 60+00E 64+00E 68+00E 72+00E 76+00E 80+00E 84+00E 88+00E 92+00E 96+00E 100+00E 104+00E 108+00E 112+00E 116+00E 120+00E

56+00N
52+00N
48+00N
44+00N
40+00N
36+00N
32+00N
28+00N
24+00N
20+00N
16+00N
12+00N
8+00N
4+00N
BASELINE 0+00
4+00S
8+00S
12+00S
16+00S
20+00S
24+00S
28+00S
32+00S
36+00S

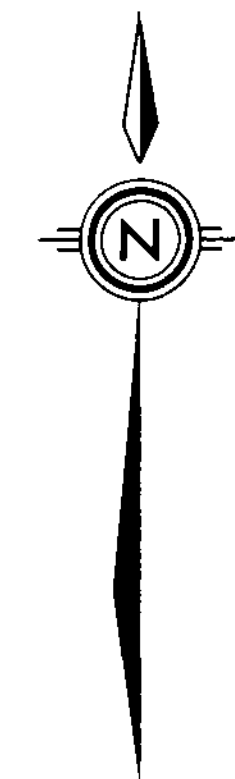

CHUCHI LAKE

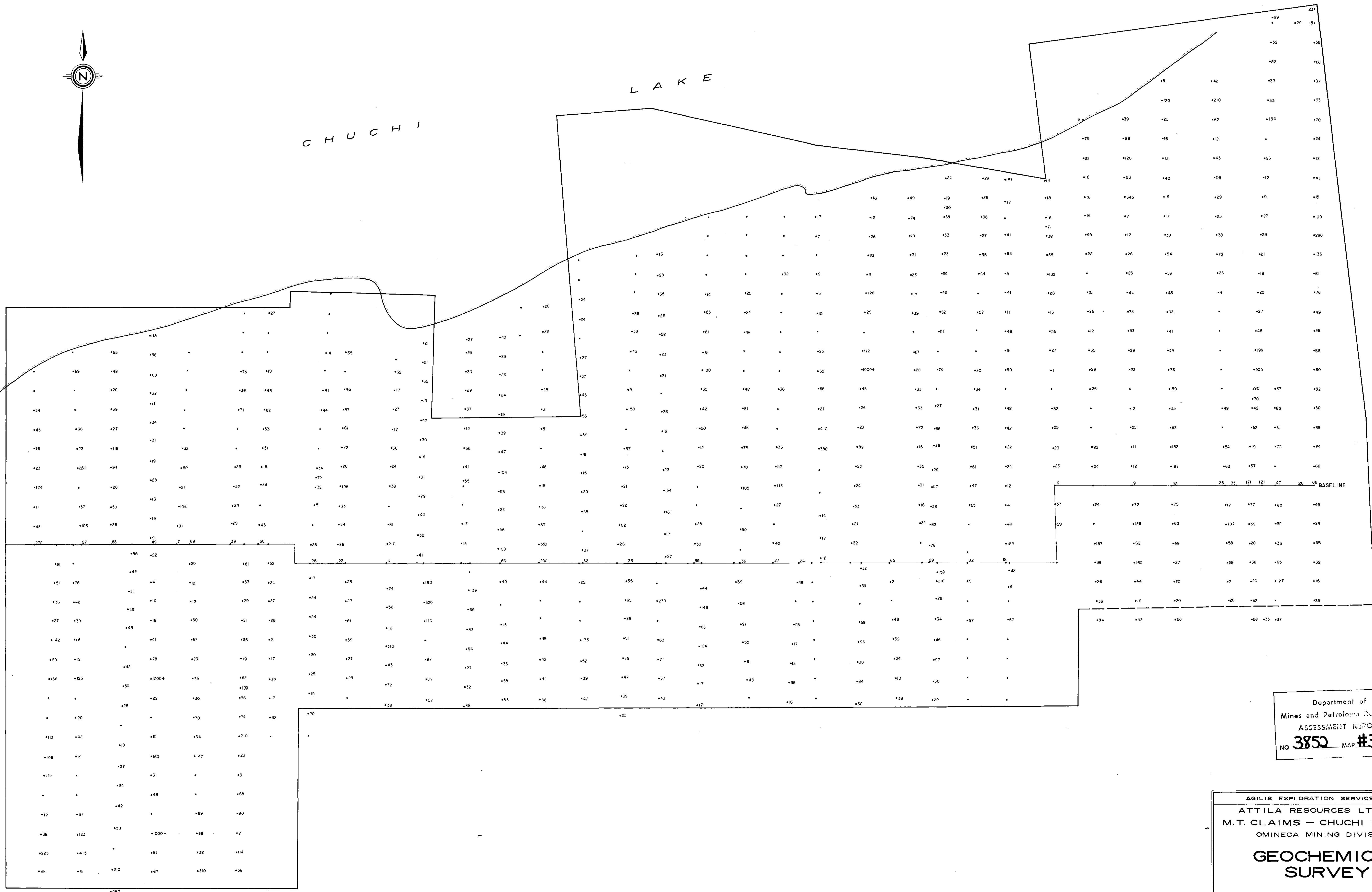

Department of
Mines and Petroleum Resources
ASSESSMENT REPORT
NO. 3850 MAP #3

AGILIS EXPLORATION SERVICES LTD.
ATTILA RESOURCES LTD. (NPL)
M.T. CLAIMS - CHUCHI LAKE, B.C.
OMINECA MINING DIVISION
GEOCHEMICAL SURVEY
COPPER (ppm) *R.M.H.*
SCALE IN FEET
0 400 800 1200
JULY 1972

12+00W 8+00W 4+00W 0+00 4+00E 8+00E 12+00E 16+00E 20+00E 24+00E 28+00E 32+00E 36+00E 40+00E 44+00E 48+00E 52+00E 56+00E 60+00E 64+00E 68+00E 72+00E 76+00E 80+00E 84+00E 88+00E 92+00E 96+00E 100+00E 104+00E 108+00E 112+00E 116+00E 120+00E

56+00 N
52+00 N
48+00 N
44+00 N
40+00 N
36+00 N
32+00 N
28+00 N
24+00 N
20+00 N
16+00 N
12+00 N
8+00 N
4+00 N
BASELINE 0+00
4+00 S
8+00 S
12+00 S
16+00 S
20+00 S
24+00 S
28+00 S
32+00 S
36+00 S



CHUCHI

LAKE

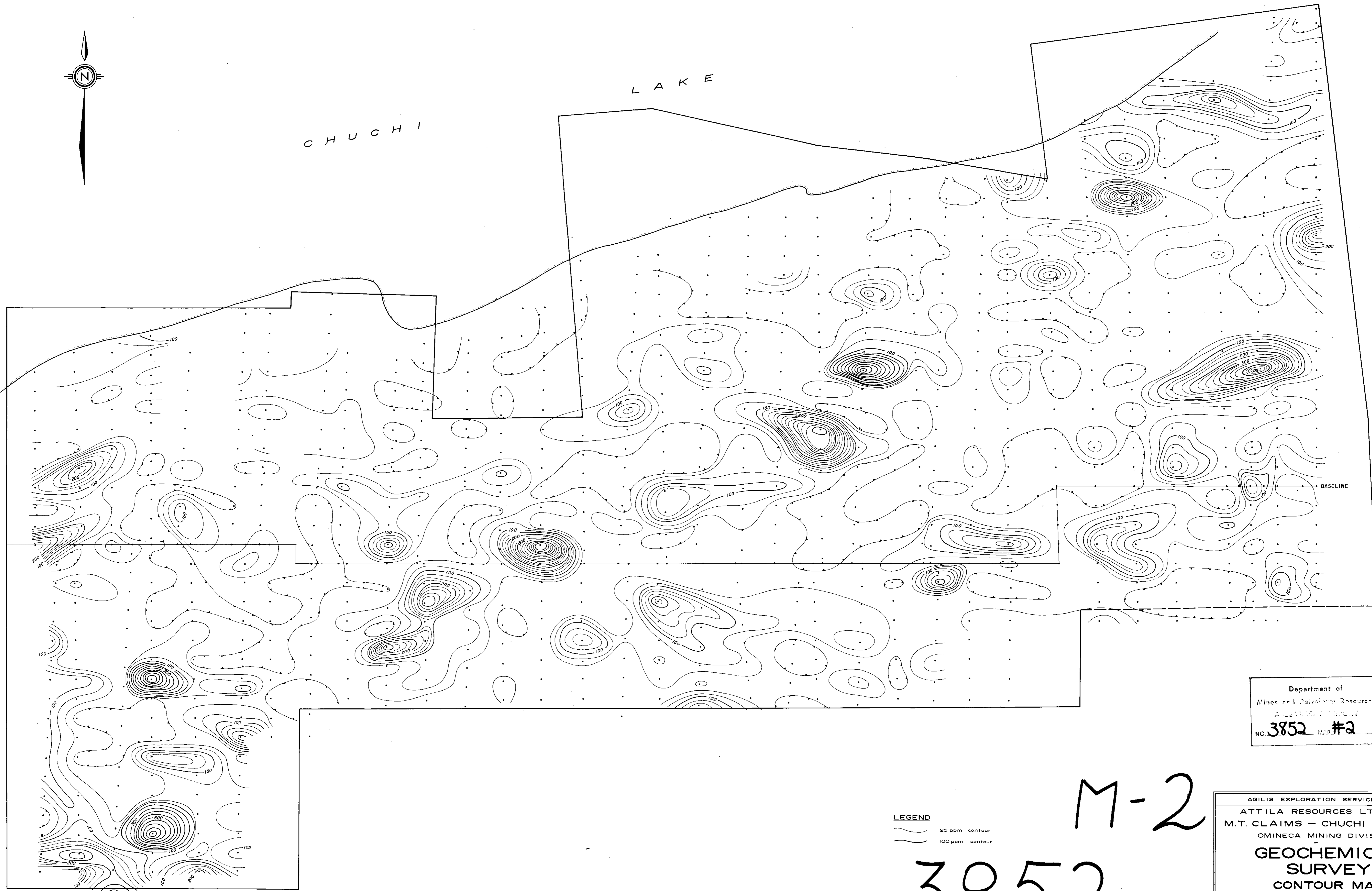

Department of
Mines and Petroleum Resources
A 1987/1988 REPORT
NO. 3852 MSP #2

LEGEND
— 25 ppm contour
— 100 ppm contour

M-2

3852

AGILIS EXPLORATION SERVICES LTD.
ATTILA RESOURCES LTD. (NPL)
M.T. CLAIMS - CHUCHI LAKE, B.C.
OMINECA MINING DIVISION
**GEOCHEMICAL
SURVEY
CONTOUR MAP
COPPER (ppm)**
CONTOUR INTERVAL - 25 ppm
SCALE IN FEET
400 0 400 800 1200
JULY 1972