

SUMMARY REPORT
CINDY GROUP OF CLAIMS
FRANKLYN ARM, CHILKO LAKE
CLINTON MINING DIVISION
SHOREWEST MINING CO. LTD (NPL)
W.G. Timmins, P. Eng. ^{92N/1E} Oct 25/72

3949

3949

SUMMARY REPORT

on the

CINDY GROUP OF CLAIMS
FRANKLYN ARM, CHILKO LAKE

CLINTON MINING DIVISION

for

SHOREWEST MINING CO. LTD., (N.P.L.)

by

Department of Mines and Petroleum Resources ASSESSMENT REPORT NO. 3949 MAP

W. G. TIMMINS, P.Eng.,
Consulting Geologist

October 25, 1972

Vancouver, B.C.

W. G. TIMMINS P. ENG. - MINING AND GEOLOGICAL CONSULTANT

TABLE OF CONTENTS

	Page
INTRODUCTION.....	1
PROPERTY.....	1
LOCATION AND ACCESS.....	1
TOPOGRAPHY.....	2
CLIMATE.....	4
VEGETATION AND TIMBER.....	5
WATER.....	5
POWER.....	5
SUPPLIES.....	6
HISTORY.....	6
GEOLOGY.....	7
WORK PROGRAMME.....	7
Geochemistry.....	7
Geology.....	8
Magnetometer Survey..	8
SUMMARY AND CONCLUSIONS.....	9
CERTIFICATE.....	10
REFERENCES	

APPENDICES

	APPENDIX "A"	GEOCHEMICAL ANALYSIS	
#1	APPENDIX "B"	GEOLOGICAL PLAN	1" - 1500 feet
#2	APPENDIX "C"	CLAIM LOCATION MAP	1" = 4500 feet

MAPS

#3	GEOCHEMICAL SURVEY - in pocket	1" = 800 feet
#4	MAGNETOMETER SURVEY - in pocket	1" = 800 feet

INTRODUCTION

This report was prepared on behalf of Shorewest Mining Co. Ltd., and is a summary of a reconnaissance field programme conducted on the Cindy 16-41 group of claims located on the north-west side of Franklyn Arm, Chilko Lake at $51^{\circ} 10'$ north latitude and $124^{\circ} 10'$ west longitude. This survey consisted of reconnaissance geological mapping, geochemical soil sampling and magnetometer survey conducted along chain and compass lines oriented in a north-south direction.

PROPERTY

The property consists of 26 located claims, Cindy 16 - 41, Record Numbers 19006-31 inclusive, recorded in the Clinton Mining Division, British Columbia, expiry date is September 12, 1972.

LOCATION AND ACCESS

Located 6,000 feet from the head of Franklyn Arm, Chilko Lake, the claims are 27 miles south of Chilko Landing.

Franklyn Arm is located on the west side of Chilko Lake, some 27 miles south of the head of the Lake where the Chilko River flows north and hence east to join the Fraser River. The Arm is about six miles long and has a southwest direction.

The air distance from the Arm to Vancouver, Williams Lake and Campbell River, are 140 miles south, 110 miles east, and 100 miles west.

Its approximate geographical location is $51^{\circ} 10'$ north latitude and $124^{\circ} 10'$ west longitude.

Access to the claims is by float plane from Campbell River, Vancouver or Williams Lake. An alternate car-boat route exists from Williams Lake via Highway 20, turning south at Tatla Lake.

Launches can be chartered at Chilko Lodge for the 27 mile water route to Franklyn Arm.

TOPOGRAPHY

Chilko Lake, elevation 3,860 feet, occupies a 50 mile long north-south glacial valley which varies in width from 1 to 5 miles. It has the characteristic "U" shape of a glacial

valley. A narrow beach terrace is present along most of the lake shore.

To the west and south is a broad belt, 100 miles wide, of extremely mountainous and rugged terrain of the Coast Range Mountains. Peaks have elevations of 10,000 to 13,000 feet. Most of the peaks have alpine glaciers and permanent snowfield. Cirques, many of them occupied by small lakes, are common features along with arretes and numataks.

Mount Good Hope is the highest peak in the vicinity and has an elevation of 10,615 feet and is located a few miles southeast of the Cindy claims.

To the east is a transitional zone of rapidly decreasing relief between the mountains and the Interior Plateau with its flat undulating topography.

Elevations on the claims range from 3,860 feet at Chilko Lake to 5,500 feet on the highest points.

The main stream in the area are Deschamps, Nine Mile, and two large unnamed streams, tentative called Camp Creek and Twin Lakes Creek, both of which start from the ice fields around Mount Good Hope.

The mouths of the Deschamps and Nine Mile Creeks merge into a common delta of gravel outwash, which is partly covered with a small pine or spruce and open patches of grass meadow. This area can readily be made into a landing strip for small aircraft. It was at one time considered as an emergency landing field for the Department of Transport. It is estimated that one week's work with a D7 or D8 bulldozer will be required to build a serviceable air strip.

CLIMATE

No climatic records are available for Chilko Lake or Franklyn Arm. The summer of 1967 was warm and equitable, with an occasional cool evening in early September. Rainfall was scanty during June, July and August, falling only on a total of 10 days. From September 15th to October 7th, 1967 a slight rain or drizzle fell almost every day towards evening.

In 1968 the weather was very much drier with little or no rain during August, September and October.

Wet snow fell in November, 1968 and by December 4th about 9 inches were present.

The month of August, 1969 was very dry and hot. September to December 14th was mild.

W. G. TIMMINS P. ENG. - MINING AND GEOLOGICAL CONSULTANT

The annual precipitation is estimated at 15 to 20 inches and falls mostly as snow.

It is considered that year-round exploration can be done on the Cindy claims with little or no loss of time from inclement weather conditions.

VEGETATION AND TIMBER

The lower reaches of the named creeks contain the only commercial timber in the area. It consists of fir, balsam, and pine. No cedar nor hemlock was seen.

Underbrush is not thick, except in the vicinity of some slide areas or water courses and consists entirely of tag alders.

WATER

Ample water for all mining, milling, diamond drilling, and domestic use is available from several small streams present and also Chilko Lake.

POWER

No hydro-electric power is present, although there are two possible power sites on or near the claims where power can be generated.

SUPPLIES

Supplies can be airlifted in from Vancouver or Williams Lake on a weekly or bi-weekly basis. Alternatively they can be sent from Williams Lake by truck and down the Arm by boat.

HISTORY

During the late 1960's, several hundred claims were staked in the area. The old Ducharme property reported on by V. Dolmage, 1924 Summary Report, Part A, of the Geological Survey of Canada, was the main interest in the area and detailed examination was carried out by Bethlehem Copper Mines Ltd.

During 1968 and 1969 Chapman, Wood and Griswold and Sumitomo Mining Co. Ltd., as well as other mining companies have carried out work on claims in close proximity to the Bethlehem copper Mines Ltd claims. Preliminary geology and geochemistry was carried out on a portion of the Cindy claims in 1971 by Mr. J. R. Poloni.

GEOLOGY

The claim group is underlain by Triassic volcanic and sedimentary rocks intruded by Coast Range quartz diorite and granodiorite.

W. G. TIMMINS P. ENG. - MINING AND GEOLOGICAL CONSULTANT

The volcanics are generally dark green andesitic members and contain very minor sulphides consisting mainly of pyrrhotite and pyrite. There occur minor interbeds of limestone, quartzite and slate.

These volcanic sequences of rocks are intruded by light coloured medium grained dioritic intrusive masses.

Several gossans particularly on claims 18 and 19 were tested during 1971 and it was found that the main sulphides occur as pyrrhotite with only chalcopyrite observed in minor amounts in two places on claims 17 and 20. During this year's mapping programme several gossan areas were observed, however, no base metal mineralization was noted.

WORK PROGRAMMES

Geochemistry

Soil samples were taken along pace and compass lines as noted on the geochemical maps at rear, at 200 and 400 foot spacings along four lines each a claim apart. The B horizon consisting of brown to red-brown sandy material was sampled and occurs beneath a recently burned humus layer approximately four inches thick. Geochemical analyses for molybdenum and copper were carried out by Crest Laboratories of Vancouver using the atomic absorption

method with the digestion method of HClO_4 plus HNO_3 . Analyses were done on 80 mesh material. A copy of the results is included in Appendix A.

Geology

Reconnaissance geological mapping programme was carried out over claim numbers 16 to 35 inclusive and claims 39 and 41 inclusive. In general Triassic volcanic and limey sedimentary rocks are intruded by units of Coast Range intrusive dioritic rock. Several south-facing scarps have been formed in the volcanic units making mapping and access difficult. A geological plan is included at the rear of this report as Appendix B.

Magnetometer Survey

A magnetometer survey was carried out over the claims utilizing pace and compass lines on the same basis as the geochemical survey. A Jalander Model W505 Serial No. 2517526 Magnetometer was used for the survey. In general the magnetics are relatively flat throughout the area with no significant anomalous zones, however, areas of intrusive rock can be distinguished from the volcanic areas.

SUMMARY AND CONCLUSIONS

The Cindy 16 to 41 group of mineral claims are located immediately north of Franklyn Arm on Chilko Lake, and are underlain by a sequence of Triassic volcanic and sedimentary rocks intruded by Coast Range dioritic rocks.

Geological mapping, magnetometer and geochemical soil sample surveys of a reconnaissance nature have been carried out over the claims. Geochemical results of samples taken at 200 and 400 foot intervals indicate low background values for copper and molybdenum with only occasional erratic high copper values which are not considered significant. The magnetometer survey does not indicate any significant anomalous zones.

Mineralization usually in the form of pyrrhotite and occasionally minor chalcopyrite occurs in limey members and in fine grained volcanic units of Triassic age.

During the 1971 programme of preliminary work anomalous geochemical sample at 22+00 N in the area of the gossan zone examined in Pit No. 4 was recorded and it is recommended that any further work undertaken should be carried out in this general area.

Respectfully submitted,

W. G. Timmins, P.Eng.,
Consulting Geologist

WGT:vsa

October 25, 1972

APPENDIX "A"

CERTIFICATE

I, WILLIAM G. TIMMINS, of the Province of British Columbia do certify that:

1. I am a geologist having been practising my profession continuously for eleven years and maintain an office at Suite 205-850 West Hastings Street, Vancouver, B.C.
2. I am a graduate of the Provincial Institute of Mining, Haileybury, Ontario and have attended Michigan Technological University, Houghton, Michigan.
3. I am a member of the Association of Professional Engineers of British Columbia.
4. I have no interest, direct or indirect, in the property or securities of Shorewest Mining Co. Ltd (NPL), nor do I expect to receive any such interest.
5. This report has been prepared by myself and is a summary of a reconnaissance field programme conducted on the Cindy 16-41 group of claims, a thorough study of government maps and reports, private reports and all pertinent data, and also personal knowledge of the area.

This report may be used in the prospectus of the Company and amendments thereto.

Dated at Vancouver, British Columbia, this 25th day of October, 1972.



W.G. Timmins, P.Eng.,

APPENDIX "B"

REFERENCES

Report on the Cindy Group of Claims, Franklyn Arm, Chilko Lake, Clinton Mining Division for Shorewest Mining Co. Ltd (NPL) by John R. Poloni, B.Sc., P.Eng., October 5, 1971.

Geological Report on the Cindy Group Franklyn Arm, Chilko Lake, B.C. by R.E. Renshaw, P.Eng., December, 1969.

Summary Report, 1924, Part A. Geological Survey, Canada., Chilko Lake and Vicinity, British Columbia, by Victor Dolmage.

APPENDIX "C"

CREST LABORATORIES (B.C.) LTD.B.C. REGISTERED ASSAYERS
GEOCHEMISTS1068 HOMER STREET,
VANCOUVER 3, B.C.

September 26, 1972

Ptarmigan Enterprises Ltd.,
205 - 850 West Hastings Street,
Vancouver, B.C.

Lab 919G

Geochemical analysis for molybdenum and copper

Mesh Size: - 80

Analytical Method: Atomic Absorption + Colorimetric

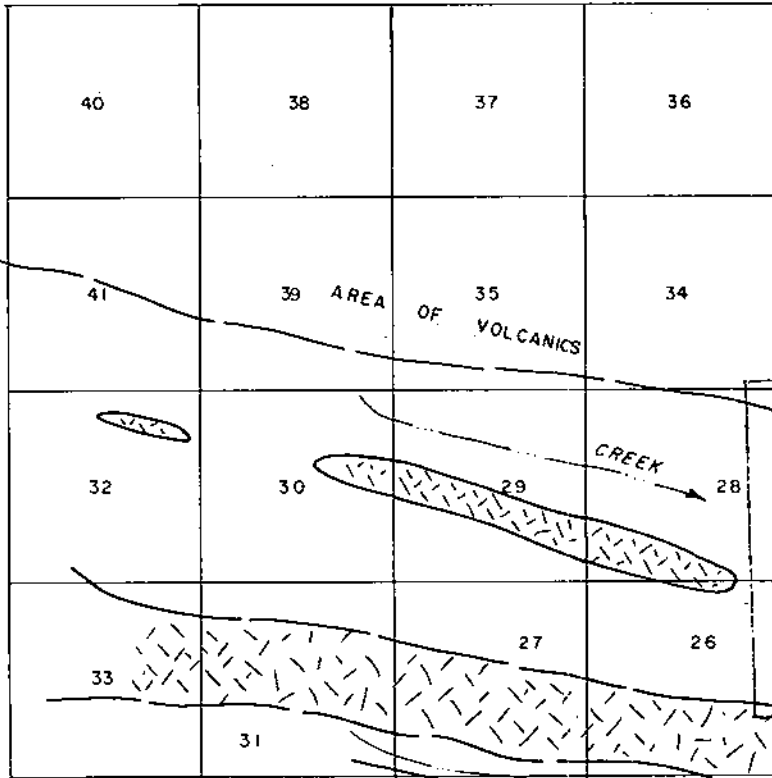

Digestion Method: $\text{HClO}_4 + \text{HNO}_3$

Sample Marked:	Moly ppm	Copper ppm	Sample Marked:	Moly ppm	Copper ppm
A - 1	2	40	B - 14	-2	40
2	-2	42	B - 15	-2	30
3	-2	46	C - 1	-2	54
4	-2	48	2	-2	41
5	-2	40	3	-2	20
6	-2	42	4	-2	12
7	-2	28	5	2	72
8	-2	22	6	-2	30
9	-2	40	7	-2	34
10	-2	46	8	-2	48
11	-2	26	9	2	50
12	-2	26	10	2	70
13	-2	16	11	2	58
14	-2	24	12	-2	36
A - 15	-2	36	13	-2	32
B - 1	2	40	14	2	44
2	-2	44	C - 15	-2	32
3	-2	12	D - 1	-2	40
4	-2	54	2	-2	28
5	-2	52	3	-2	45
6	-2	14	4	-2	185
7	-2	34	5	-2	38
8	-2	22	6	-2	46
9	42	37	7	-2	42
10	-2	22	8	-2	24
11	-2	26	9	-2	36
12	-2	29	10	-2	26
B - 13	-2	30	D - 11	-2	30

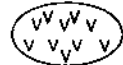

Department of
Mines and Petroleum Resources
ASSESSMENT REPORT
NO. **3949** MAP #1

LEGEND

-  DIORITE GRANODIORITE
-  VOLCANICS

W. J. [Signature]

SHOREWEST MINES LTD.
GEOLOGICAL PLAN

CHILKO LAKE AREA, CLINTON MD., B.C.

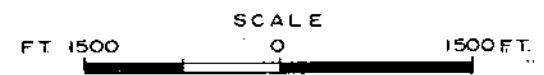



40	38	37	36
41	39	35	34
32	30	29	28
33	31	27	26
		25	24
		23	22
		21	20
		19	18
		17	16

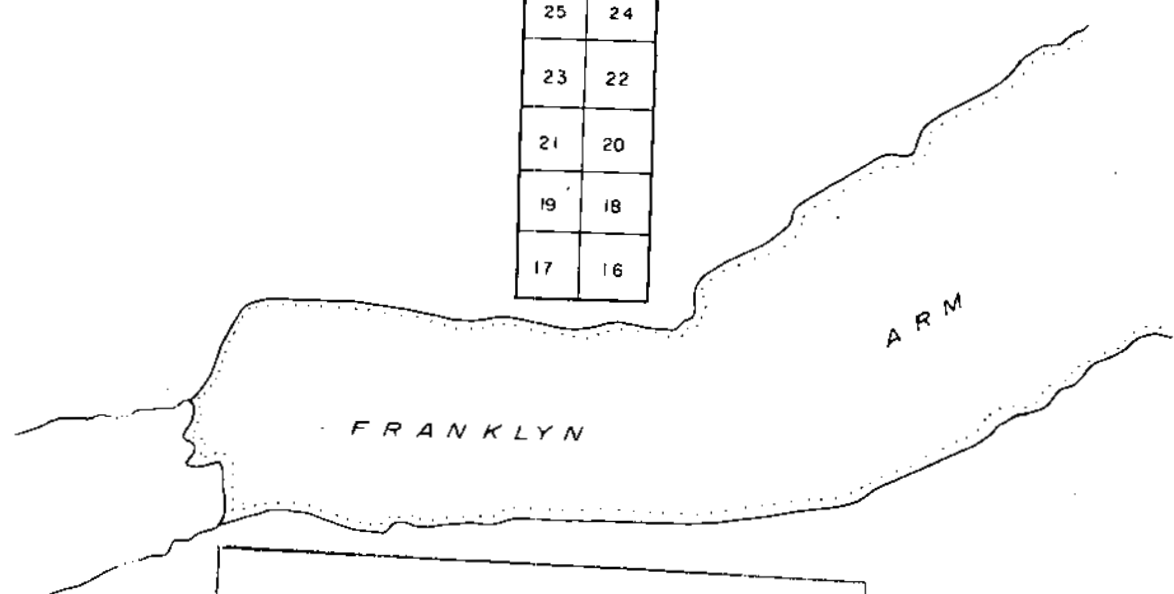

Department of
Mines and Petroleum Resources
ASSESSMENT REPORT
NO. **3949** MAP **#2**

SHOREWEST MINES LTD.
CINDY CLAIM GROUP
(16-41)
CHILKO LAKE AREA, CLINTON M.D., B.C.

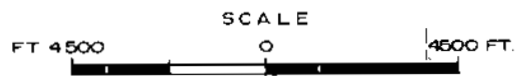

W. G. TIMMINS P. ENG. - MINING AND GEOLOGICAL CONSULTANT

205 - 850 West Hastings Street, Vancouver 1, B.C.

Office: (604) 681-1934

Res: (604) 936-9837

**SUMMARY OF PROGRAMME
EXPENDITURES**

Period August 30, 1971 to September 11 1971
Personnel Geologist and Assistant

GEOCHEMICAL SURVEY	
Wages 7 days at \$150 per day	\$1,050.00
GEOLOGY	
Wages 7 days at \$150 per day	1,050.00
MAGNETOMETER	
Wages 4 days at \$125 per day	500.00
GEOCHEMICAL ANALYSIS	135.00
FOOD AND CAMP COSTS	200.00
MAGNETOMETER RENTAL	75.00
	<hr/>
	\$3,010.00
	<hr/>

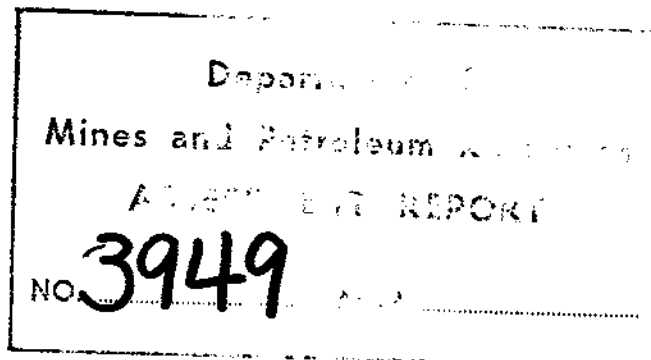

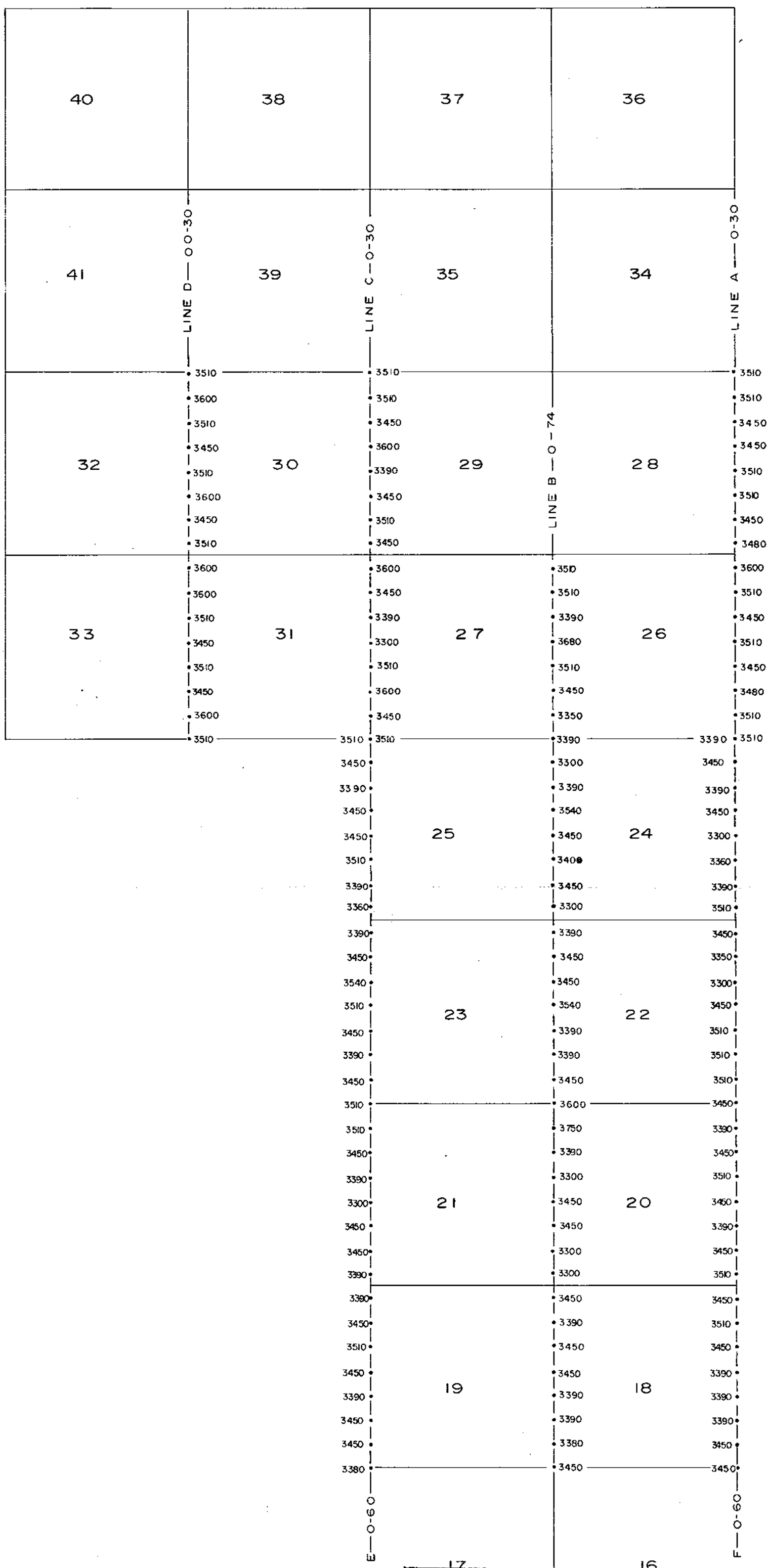

Department of
Mines and Petroleum Resources
ASSESSMENT REPORT
NO. 3949 #4

SHOREWEST MINES LTD.
MAGNETOMETER SURVEY

CHILKO LAKE AREA, CLINTON M.D., B.C.



Wish

