

LINE CUTTING OF SURVEY CONTROL FOR BASE LINE
AND PICKET LINES ON THE HEP-EXPO GROUPS 2 & 3
LOCATED TWENTY MILES SOUTH WEST OF PORT HARDY

50°, 127°, NW
by

A. ASCENCIOS

92L/12W

UTAH MINES LTD.

3958

3958

LINE CUTTING OF SURVEY CONTROL
FOR BASE LINE AND PICKET LINES
ON THE

HEP-EXPO GROUPS 2 AND 3

LOCATED

TWENTY MILES SOUTHWEST OF PORT HARDY

50°, 127°, N W

by

A. ASCENCIOS
UTAH MINES LTD.

Department of
Mines and Petroleum Resources
ASSESSMENT REPORT

NO. 3958 MAP

TABLE OF CONTENTS

	<u>PAGE</u>
INTRODUCTION	1
FIELD WORK	2
APPENDIX A STATEMENT OF COSTS	3

	<u>ILLUSTRATIONS</u>	<u>PLATE</u>
HEP-EXPO GROUPS 2 AND 3 MAPS		1 - 3
	SCALE 1 inch = 200 feet	
#1	Index Map	
#2	Line Cutting; Survey Control for Baseline & Picket Line	
#3	" " " " " " " "	
#4	" " " " " " " "	

M. J. Young

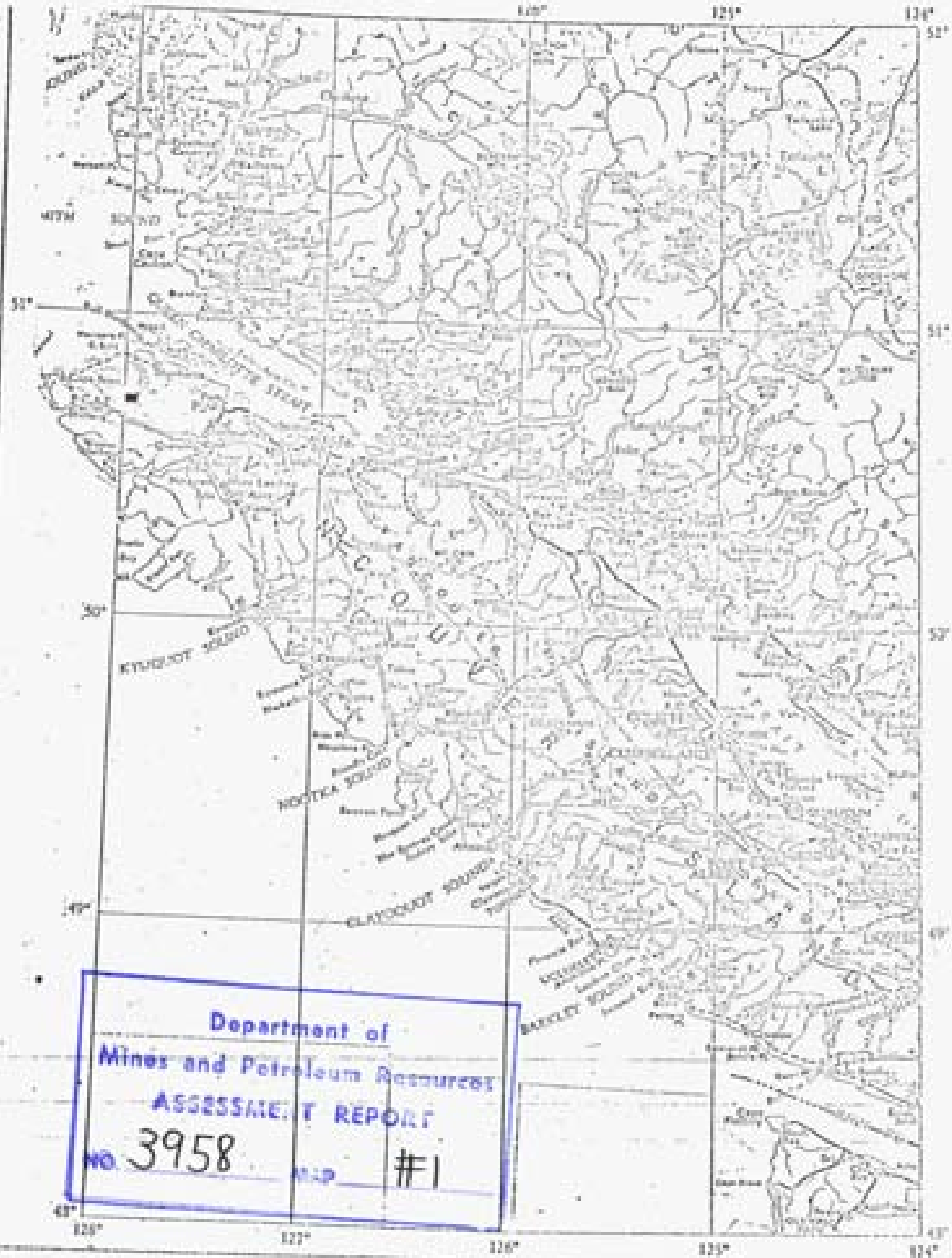

SCALE: 1 INCH = 50 MILES

INDEX MAP

■ REP - EXPO GROUPS & SAMPLES
 Mining Division

LINE CUTTING OF SURVEY CONTROL REPORT ON HEP-EXPO GROUPS 2 AND 3

INTRODUCTION

During September, 1972, line cutting and survey of control line for base lines and picket lines were carried out on the Hep-Expo Groups 2 and 3 by Underhill and Underhill Surveyors working for Utah Mines Ltd. under contract. Line cutting was carried out by sub-contract to Manex Mining of Vancouver. The claims specifically covered on this work include: Expo #1, #2, #3, #4, #5, #6, #7, #21 #23, #25, #42, #45, #47, #51, #52, #53, #60, #83 and Expo 41 Fraction.

The field work was carried out under the direction of D.T. Simons, B.C.L.S. and the supervision of D.P. Johansen, B.C.L.S. The senior party chief/transitman was P.M. Asher and the field assistants were: I. Douglas, A. Dupras, G. Lafontaine, P. Sinclair and T. Koivula. On Utah's behalf, A. Ascencios supervised the work for four days.

The above claims are part of a larger block of 836 claims located by Utah Mines Ltd. between 1963 and 1971, north of Holberg Inlet, about thirty miles west of Port Hardy, near the north end of Vancouver Island. The claims are accessible by the Forest Service road from Port Hardy to the west end of Nahwitti Lake, and then by Rayonier logging roads.

In next summer's field season, the above surveying, road traverse, base line and grid lines will be completed so that the detailed geological and geophysical mapping, started in 1970 at a scale of 1"=200', can be continued.



FIELD WORK

During September, 1972, it was decided to start the line cutting and surveying of the control for base lines and picket lines to be completed next year on the Hep-Expo Groups 2 and 3.

The survey was done in the period 5th to 18th September, 1972, using a Wild T-16 transit and 300 foot steel tape. Survey ties were made to strategic claim posts and photo points for orientation. A list of the personnel included with the survey and the number of days worked is shown in the attached Underhill and Underhill invoice.

Astronomic north was determined by solar observation and ties were made to photo points for co-ordinate origins providing the necessary correlation to the adjacent holdings of the company.

Enclosed Maps #1, #2 and #3 show the transit hubs (T.H.) consisting of wooden stakes which are driven into the ground. Plastic tags are marked showing the transit hub number, and they are nailed to the stakes.



A. Ascencios
Senior Geologist



M.J. Young, P. Eng.,
District Geologist

VANCOUVER, BRITISH COLUMBIA
6TH NOVEMBER, 1972.

APPENDIX A

STATEMENT OF COST

STATEMENT OF COST

SALARIES

Underhill & Underhill charges (invoice attached)	\$6,721.34
A. Ascencios - 4 days @ \$45/day from Sept. 15 to Sept. 18, 1972	180.00

VEHICLE RENTAL

From Sept. 15 to Sept. 18, 1972, I.G.M.C. 4 X 4 4 days @ \$10/day	40.00
--	-------

CAMP COST

78 Man Days @ \$8.60/man day	670.80
------------------------------	--------

REPORT AND MAP PREPARATION

<u>100.00</u>
\$7,712.14

M.J. Young, P. Eng.,
District Geologist,
Utah Mines Ltd.

VANCOUVER, BRITISH COLUMBIA
6TH NOVEMBER, 1972.





Underhill & Underhill

Professional Engineers - Dominion & B.C. Land Surveyors

Utah Mines Ltd.,
412 - 510 West Hastings Street,
VANCOUVER, B.C.

1646 West 7th Avenue
Vancouver 9, British Columbia

Attention : Mr. M.J. Young,
District Geologist

Telephone (604) 732-3384
Telex 04-53339

Our File: J-6428 DTS
Your File:

29th September, 1972
INVOICE No. 357

re: SURVEY BASE LINE, ROAD TRAVERSE, AND GRID LINES
FOR GEOCHEMICAL, GEOPHYSICAL AND GEOLOGICAL
MAPPING : EXPO MINERAL CLAIMS WEST OF NANWITTI
LAKE, SURROUNDING THE RED DOG GROUP

PERIOD: September, 1972

TO: Consultation with Messrs. Young, Ascencios
and Anderson;

Supplying personnel and equipment for
above survey work on Expo Mineral Claim
Nos. 1-88 (not inclusive);

Field survey completed, crews returned
to Vancouver and plan preparation underway.

Professional Services
Wages
Board and Lodging
Transportation
Field Expenses

1,875 00
3,856 00
86 35
844 80
59 19

\$6,721 34

TERMS: NET 30 (DAYS 1 1/2% per month interest charged on overdue accounts.)

CONSOLIDATION SHEET
 UNDERHILL & UNDERHILL

532 Burrard Street, Vancouver 1, B.C.

Client: *Utah Mines Ltd*
 (Red Dog Area)

Purchase Order:
 Account from: *Sept 1* to *Sept 20*

Invoiced By: *DTS*

Date: *September 23/75*

1975

PROFESSIONAL SERVICES		BOARD & LODGING		FIELD EXPENSES	
<i>W. P. Johnson, B.C.L.S.</i>		<i>Board & Lodging</i>		<i>Inst Photo</i>	20 00
<i>Instructions with assets</i>		<i>(Travel and overnight</i>		<i>Mining Records</i>	
<i>burg, Pascencios, Anderson</i>		<i>keeping expense to</i>		<i>(Photocopies, maps)</i>	16 50
<i>Field survey & supervision</i>		<i>job site.</i>	26 35	<i>H. Johnson</i>	2 05
<i>9 days @ 125⁰⁰</i>	1125 -			<i>L. D. Phillip</i>	20 64
<i>W. P. Johnson, B.C.L.S.</i>					
<i>Field survey & supervision</i>					
<i>7 days @ 125⁰⁰</i>	750 -				
	1875 -		35 35		54 19
WAGES		TRANSPORTATION		DRAUGHTING & PRINTING	
<i>PARTY CHIEF</i>		<i>PACIFIC LABORERS FUND</i>	49 00		
<i>8⁰⁰/hour @ 10 days</i>		<i>B.C. Ferries</i>	66 00		
<i>Rate 10 days.</i>	1000 -	<i>Taxi Vancouver, part</i>	42 30		
		<i>10113 Bus # 15 (15 days)</i>	100 -		
<i>ASSISTANTS:</i>		<i>10113 Bus # 21 (14 days)</i>	169 -		
<i>1⁰⁰/hour @ 49 days</i>					
<i>Duplas 14 days</i>					
<i>Part 10 "</i>					
<i>Duplas 10.5 "</i>					
<i>Laborkins 3.5 "</i>					
<i>Sinclair 6 "</i>					
<i>L. N. V. 8 "</i>					
<i>59</i>	2580 -				
	3956 -		35 35		61
				SUMMARY	
				<i>Professional Services</i>	1875 -
				<i>Wages</i>	2580 -
				<i>Board & Lodging</i>	35 35
				<i>Transportation</i>	347 30
				<i>Field Expenses</i>	54 19
				<i>Draughting & Printing</i>	
				<i>Miscellaneous</i>	
				<i>Engineering</i>	
				<i>Legal Survey</i>	
				<i>M. Young</i>	

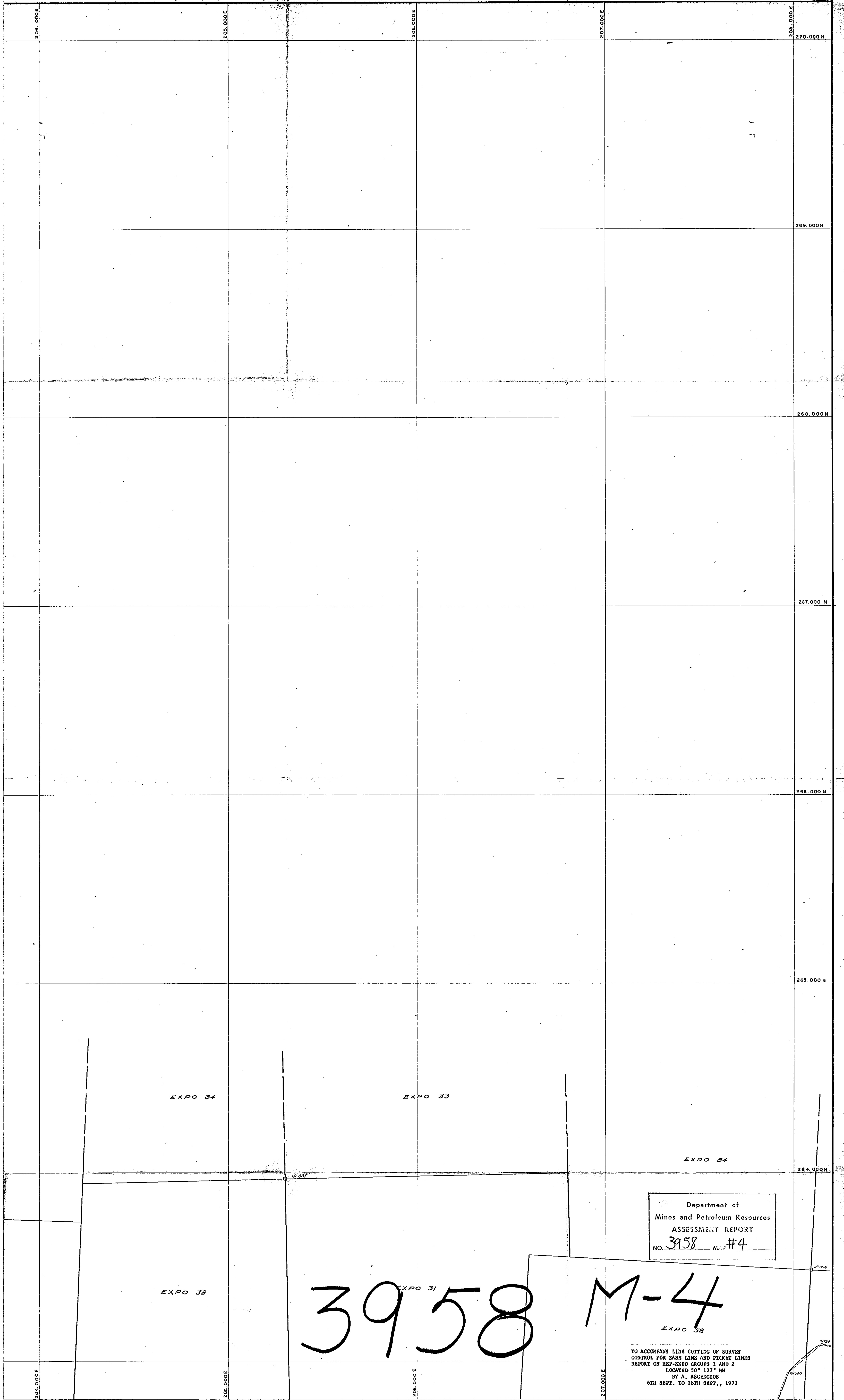

Legend

- TRANSIT SURVEY HUBS
- PICKET LINE:
SHOWING LINE AND STATION DESIGNATION
- HEP-EXPO CLAIM BOUNDARY UNSURVEYED:
SHOWING CLAIM NUMBER AND CLAIM POST
- RED DOG CLAIM BOUNDARY

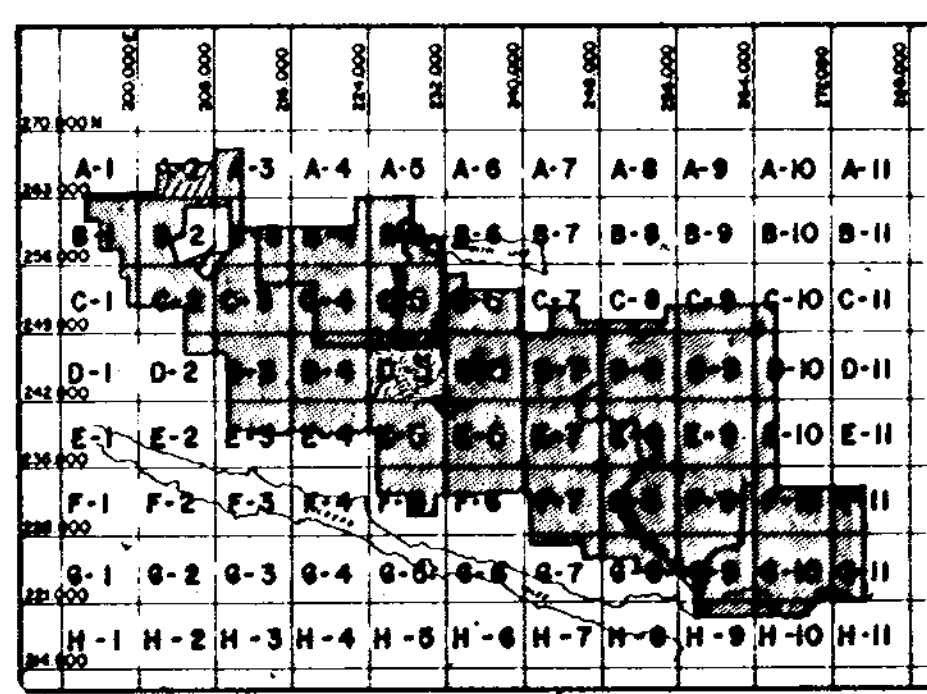

UTAH MINES LTD.
MINERAL EXPLORATION & DEVELOPMENT DEPARTMENT
VANCOUVER BRITISH COLUMBIA

**LINE CUTTING, SURVEY CONTROL
FOR BASELINE AND PICKET LINES**

HEP-EXPO GROUPS 2-3

VANCOUVER ISLAND BRITISH COLUMBIA

Work by: Underhill & Underhill Date: November 1972 NTS Ref:
Drawn by: C. Dundas Revised: MAP of A-2

200 100 0 200 400 600
SCALE IN FEET

Department of
Mines and Petroleum Resources
ASSESSMENT REPORT
NO. 3958 MAP #4

TO ACCOMPANY LINE CUTTING OF SURVEY
CONTROL FOR BASE LINE AND PICKET LINES
REPORT ON HEP-EXPO GROUPS 1 AND 2
LOCATED 50° 127' NW
BY A. ASCENCIO
6TH SEPT. TO 18TH SEPT., 1972

Plate 3

MINERAL

CLAIMS

EXPO 6

EXPO 5

EXPO 47

EXPO 48

EXPO 41 FR

EXPO 25

EXPO 48

EXPO 46

EXPO 44

EXPO 42

M-3

3958

Department of
Mines and Petroleum Resources
ASSESSMENT REPORT
NO. 3958 M-3 #3

TO ACCURATELY SHOW CUTTING OF
PICKET CONTROL FOR BASE LINE AND
PICKET LINES BEING IN
SCHEDULE GROUPS 1 AND 2
LAKED 36" 157" IN
BY A. ANDERSON
875 SURV. TO 1988 SURV. DATE

EXPO 24

Plate 2

UTAH MINES LTD.
MINERAL EXPLORATION & DEVELOPMENT DEPARTMENT
VANCOUVER BRITISH COLUMBIA

**LINE CUTTING, SURVEY CONTROL
FOR BASELINE AND PICKET LINES**

HEP-EXPO GROUPS 2-3

VANCOUVER ISLAND BRITISH COLUMBIA

Drawn by: C. Stevens
Checked by: C. Stevens
Scale: 1" = 200'

8-2

- Legend**
- TRANSIT SURVEY HOBS
 - PICKET LINE
SHOWING LINE AND STATION DESIGNATION
 - HEP-EXPO CLAIM BOUNDARY UNSURVEYED
SHOWING CLAIM NUMBER AND CLAIM AREA
 - RED 300' CLAIM BOUNDARY

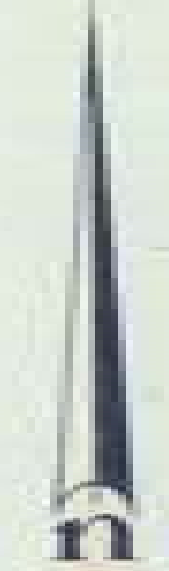
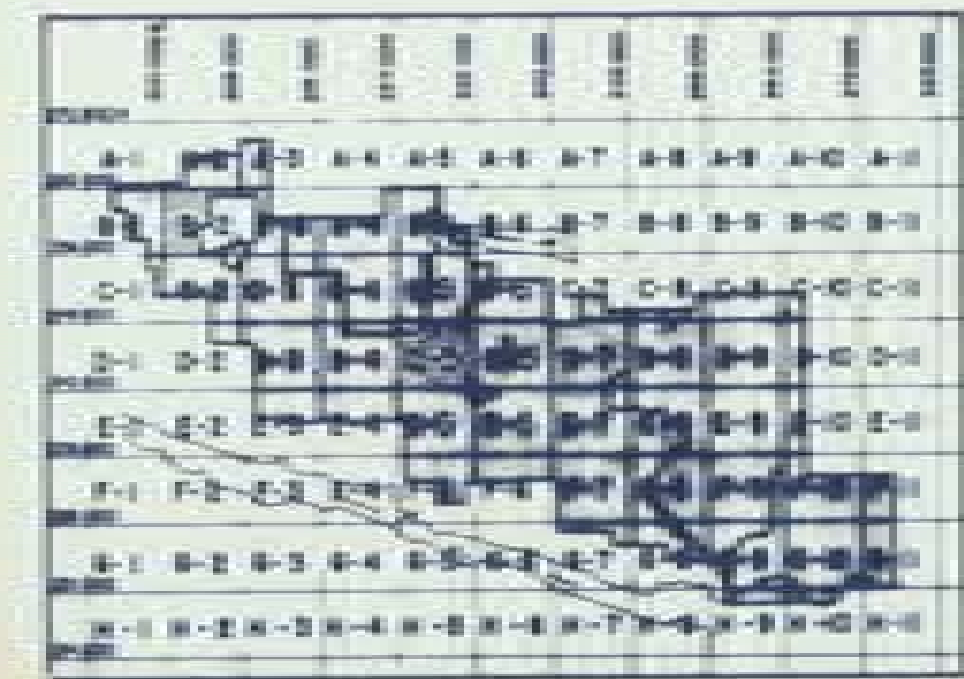

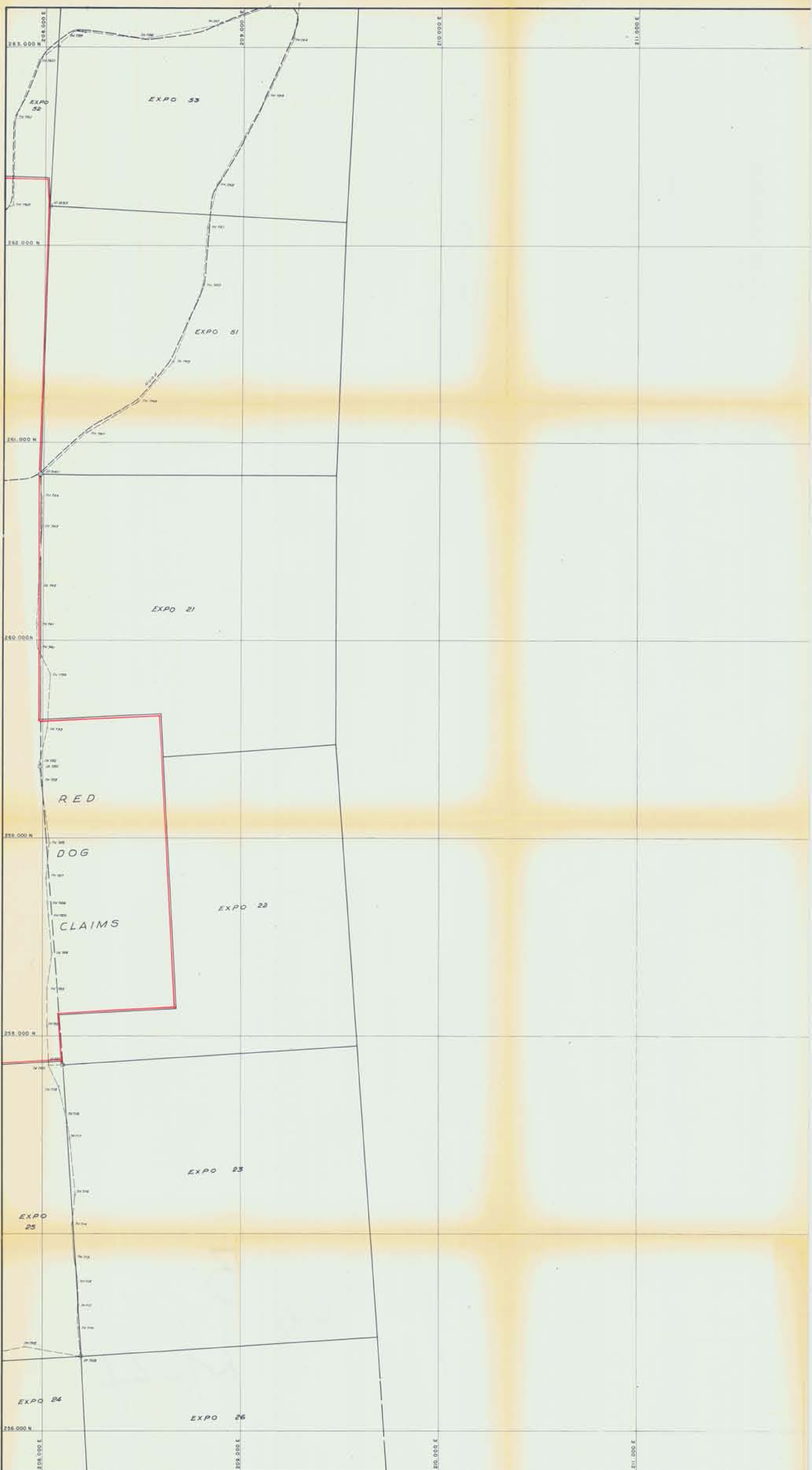

263.000 N
262.000 N
261.000 N
260.000 N
259.000 N
258.000 N
257.000 N
256.000 N
255.000 N
254.000 N
253.000 N
252.000 N
251.000 N

208.000 E
209.000 E
210.000 E
211.000 E

EXPO 52

EXPO 53

EXPO 51

EXPO 21

RED

DOG

CLAIMS

EXPO 22

EXPO 23

EXPO 25

EXPO 24

EXPO 26

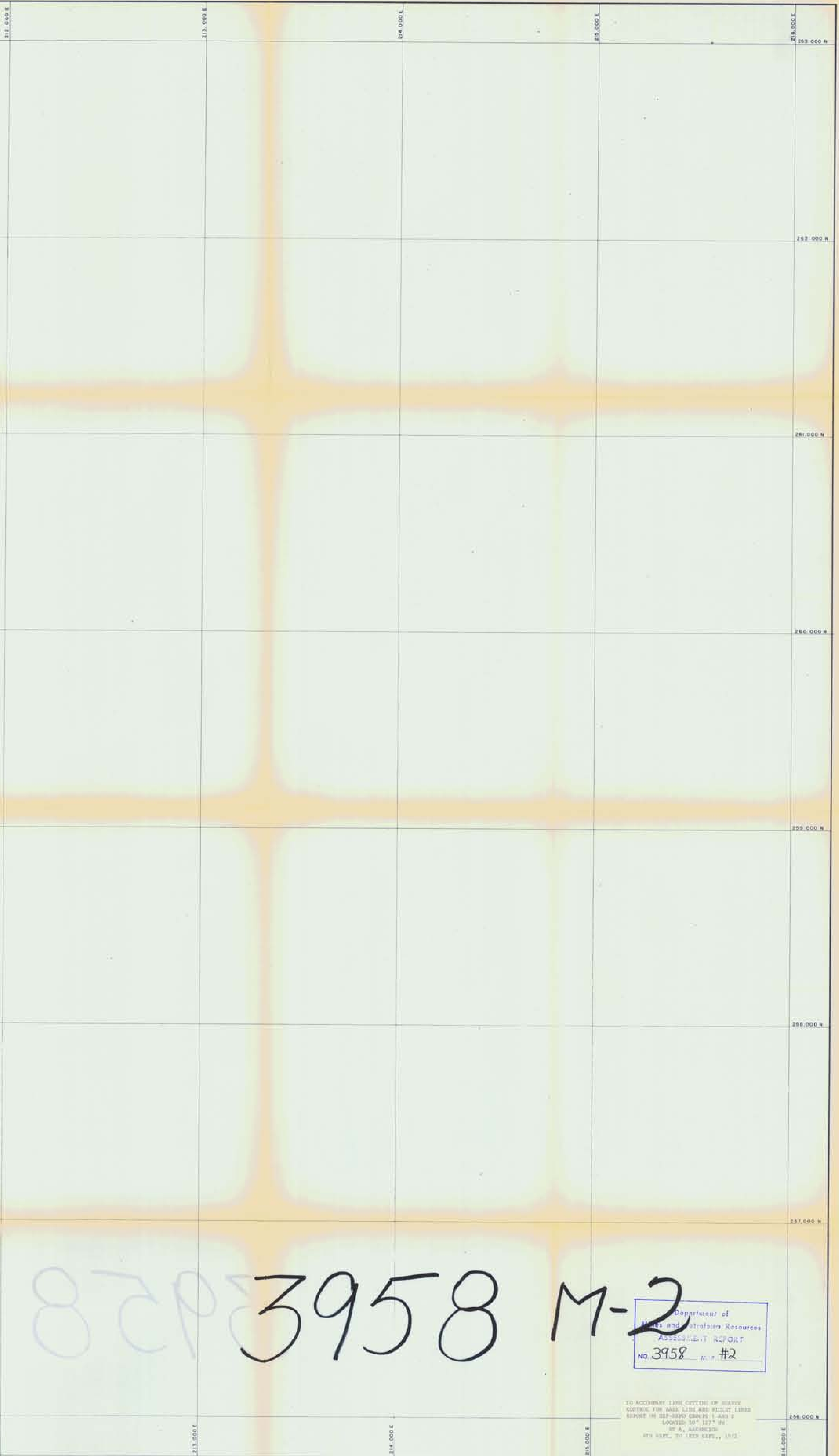

TO ACCOMPANY 1:5000 SCALE OF SURVEY CONTROL FOR BASE LINE AND PICKET LINES SHEET NO. HEP-EXPO GROUPS 1 AND 2 LOCATED 30° 12' 17" W BY A. AACHESON 27th SEPT. TO 12th SEPT., 1971

Plate 1

- Legend**
- TRANSIT SURVEY HUB
 - PICKET LINE
SHOWING LINE AND STATION DESIGNATION
 - HEP-EXPO CLAIM BOUNDARY UNSURVEYED
SHOWING CLAIM NUMBER AND CLAIM POST
 - RED DGS CLAIM BOUNDARY

STATION	100000	105000	110000	115000	120000	125000	130000	135000	140000	145000	150000
A-1	A-2	A-3	A-4	A-5	A-6	A-7	A-8	A-9	A-10	A-11	
B-1	B-2	B-3	B-4	B-5	B-6	B-7	B-8	B-9	B-10	B-11	
C-1	C-2	C-3	C-4	C-5	C-6	C-7	C-8	C-9	C-10	C-11	
D-1	D-2	D-3	D-4	D-5	D-6	D-7	D-8	D-9	D-10	D-11	
E-1	E-2	E-3	E-4	E-5	E-6	E-7	E-8	E-9	E-10	E-11	
F-1	F-2	F-3	F-4	F-5	F-6	F-7	F-8	F-9	F-10	F-11	
G-1	G-2	G-3	G-4	G-5	G-6	G-7	G-8	G-9	G-10	G-11	
H-1	H-2	H-3	H-4	H-5	H-6	H-7	H-8	H-9	H-10	H-11	

UTAH MINES LTD.
MINERAL EXPLORATION & DEVELOPMENT DEPARTMENT
VANCOUVER BRITISH COLUMBIA

**LINE CUTTING, SURVEY CONTROL
FOR BASELINE AND PICKET LINES**

HEP-EXPO GROUPS 2-3

VANCOUVER ISLAND BRITISH COLUMBIA

Work by	Date	NTS Ref
Drawn by	Revised	MAP
		of B-3

200 100 0 200 400 600
SCALE IN FEET

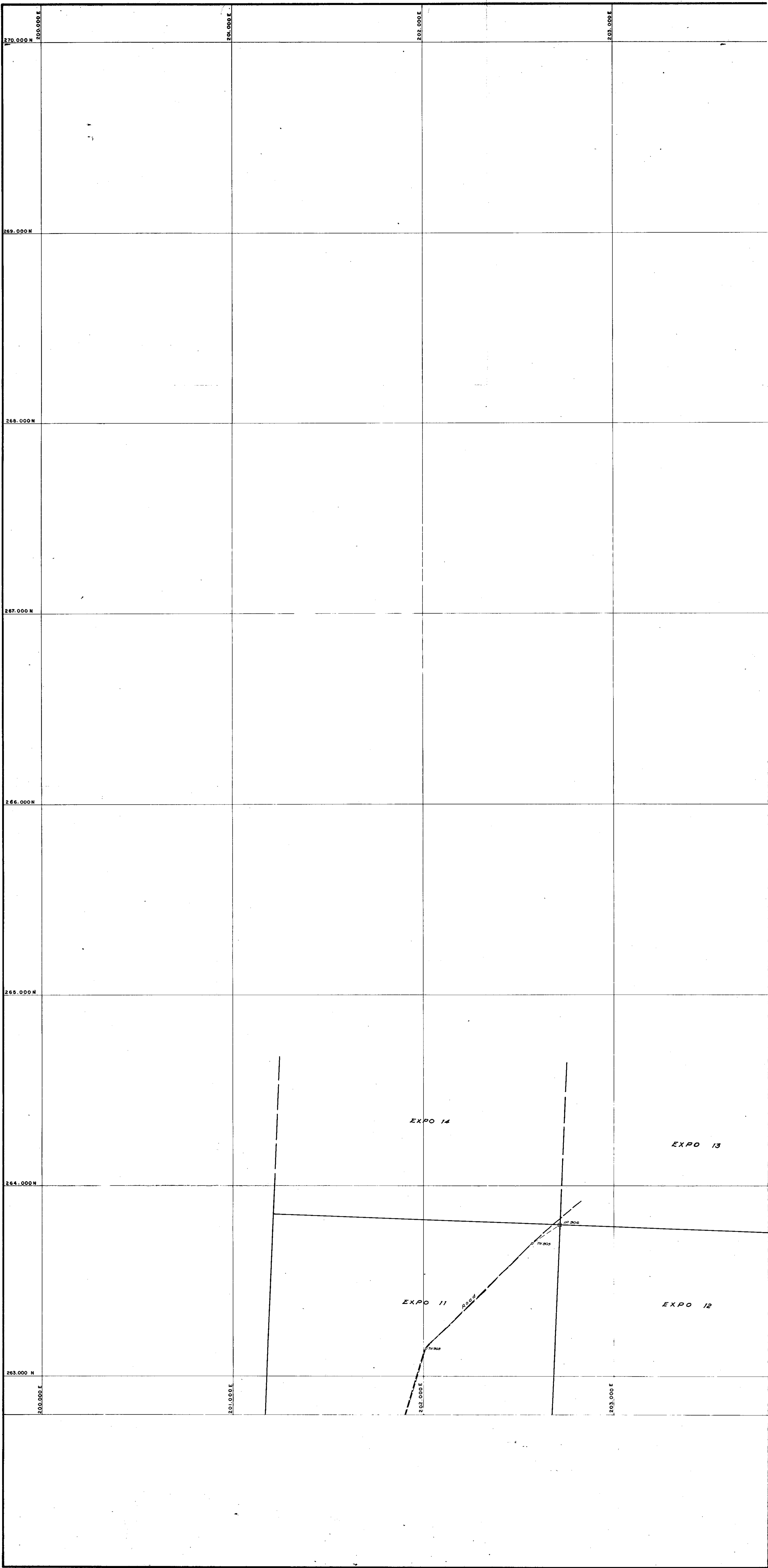

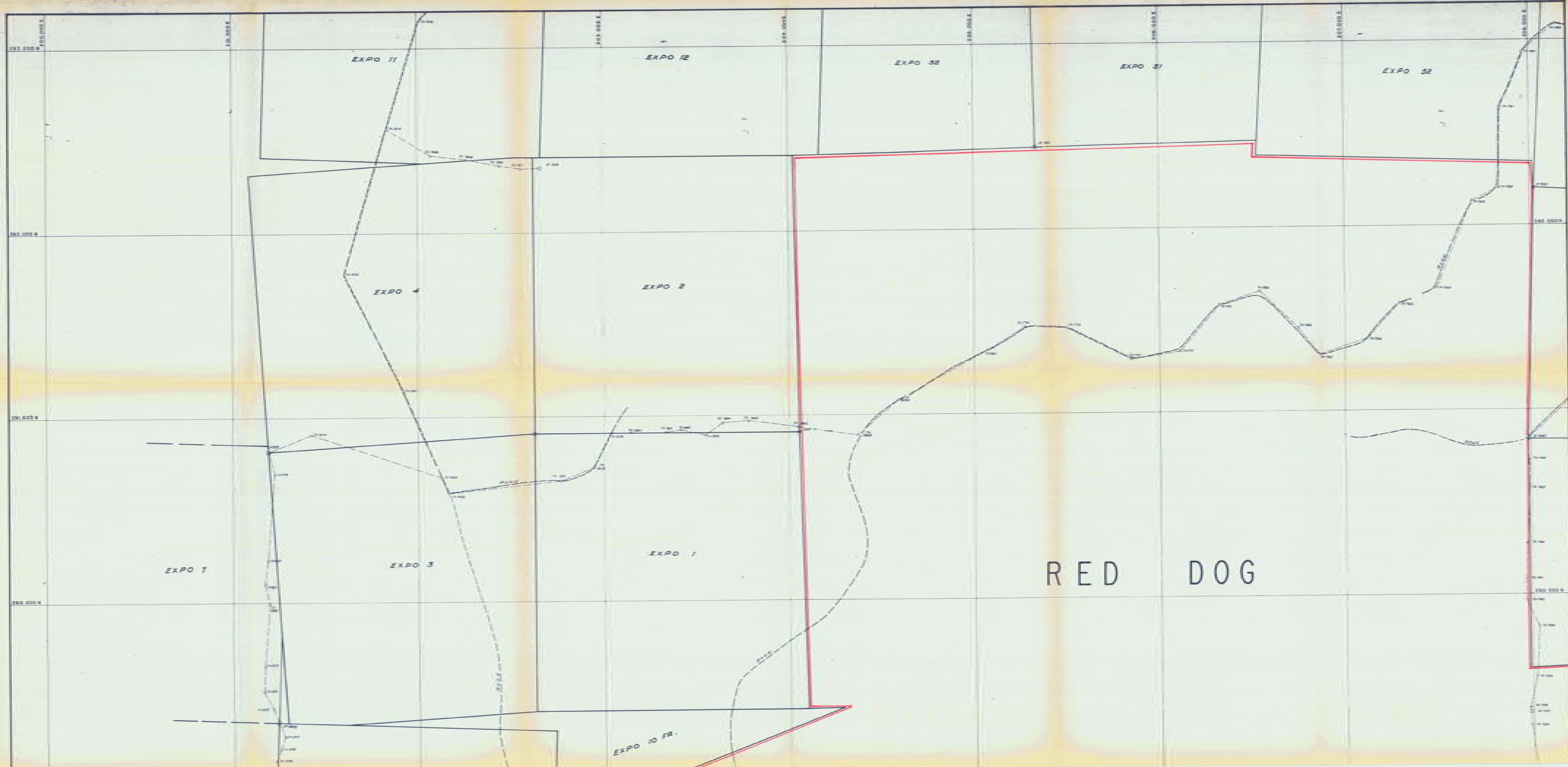

281,000 E
282,000 E
283,000 E
284,000 E
285,000 E

286,000 E
287,000 E
288,000 E
289,000 E
290,000 E

EXPO 11

EXPO 12

EXPO 32

EXPO 37

EXPO 52

EXPO 4

EXPO 2

EXPO 7

EXPO 3

EXPO 1

RED DOG

EXPO 10 FR.